

- GENERAL NOTES:**
1. It shall be the responsibility of the contractor to clear the right-of-way in accordance with the provisions of law as it affects each utility including irrigation lines and appurtenances and of no cost to the City.
 2. Construction shall be in accordance with the City of Riverside Department of Public Works, Standard Drawings and the Standard Specifications for Public Works Construction, 1992 edition.
 3. True edge of existing pavement where new pavement joins to a smooth, straight line. Construct match-up paving as shown on plan and overlay paving as directed in the field to produce a smooth section. Private Engineer estimates overlay to be 2.5" base.
 4. Curb and gutter shall be staked with 3' offsets at 25' intervals.
 5. Gradients shown are for information only and the City of Riverside is not responsible for their accuracy.
 6. All traffic signs shall be installed prior to opening the streets to traffic.
 7. Any traffic control striping obliterated and/or badly worn during construction shall be restored by the contractor within 5 days after notification from the City Inspectors.
 8. Final striping for traffic control and/or pavement marking to be the responsibility of the developer.
 9. All flagged elevations shall be staked in the field by the private engineer.
 10. The private engineer signing these plans is responsible for assuring the accuracy and acceptability of the work. No construction shall be permitted until the private engineer shall be responsible for determining an acceptable solution and revising the plans for approval by the City.
 11. The contractor shall call in a location request to Underground Service Alert (USA), Phone No. 1-800-942-4133, two days before digging. No construction permit will be issued by the Public Works Department if the contractor has not contacted USA. The contractor has been provided an inquiry identification number by USA.
 12. The private engineer preparing these plans shall be responsible for preserving or re-establishing and re-locating survey monuments destroyed, disturbed or buried as a result of construction.
 13. On all areas without public right-of-way where the fill is one (1) foot or greater, a letter will be required from the soils engineer, certifying the composition of the fill below subgrade, prior to the issuance of the Construction Permit/Job Sheets.
 14. The sewer contractor shall adjust manholes to final grade after paving is completed.
 15. Developer to give City Water Division two (2) working days written notice prior to start of construction and to allow City ten (10) working days for completion of work. (201-161)

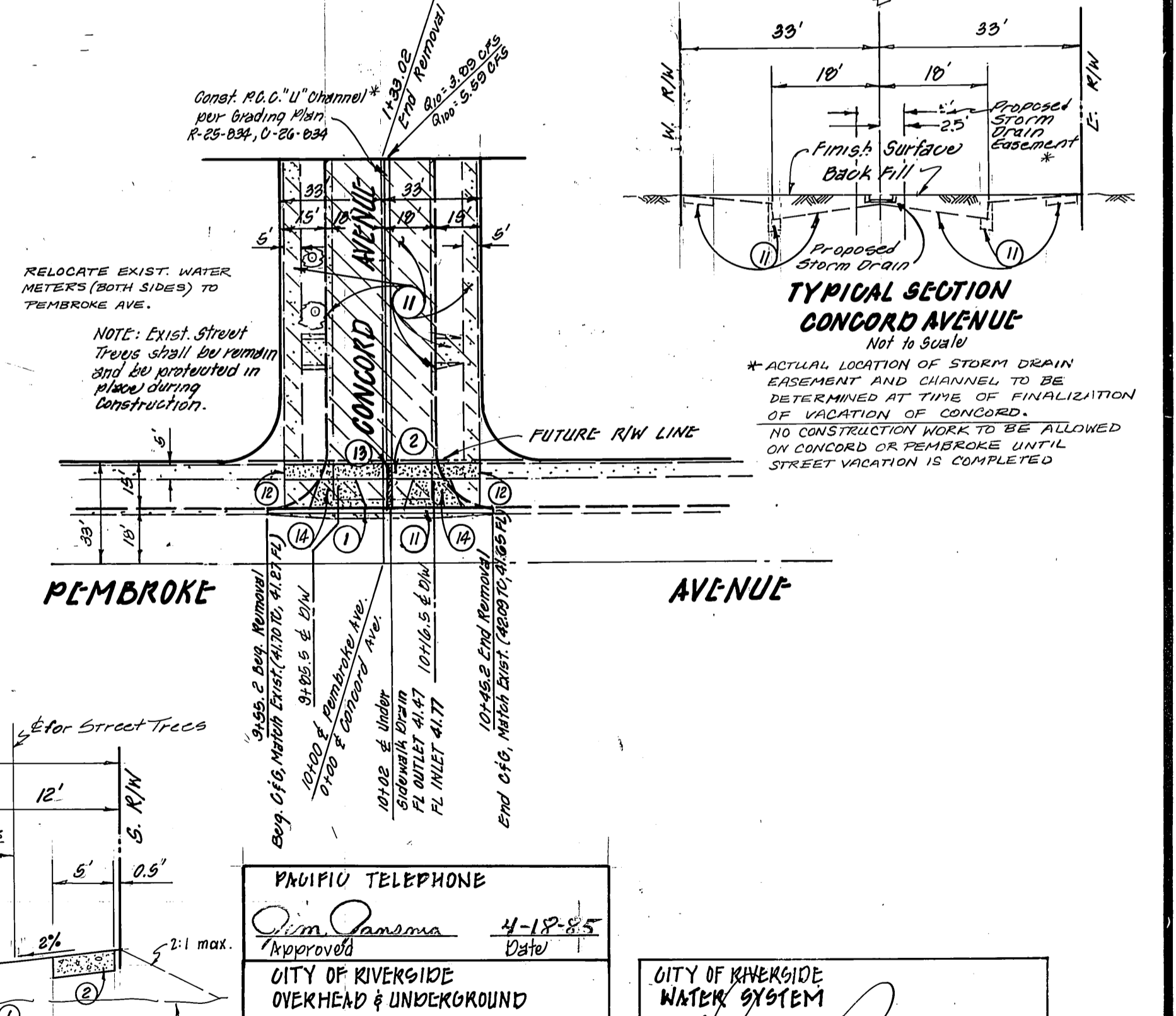

- CONSTRUCTION NOTES**
1. Construct "Type I" (6" O.P.) Curb & gutter per Std. 200
 2. Construct 5' wide R.O.C. Sidewalk per Std. 325
 3. Construct Variable thickness A.C. Overlay
 4. Construct 6" A.C. over "8" Crushed Aggregate Base, or 1 1/2" A.C. over compacted native per S.R. 302, R-12
 5. Existing A.C. Driveway to be removed
 6. Existing R.O.C. Driveway to be removed
 7. Construct "Type III" Curb (6" O.P.) per Std. 200
 8. Non-reinforced textured concrete paving, heavy leaf and colored to match existing paving at intersection of Arlington Ave. & Van Buren Blvd. Landscaping planting area configuration, automatic
 9. Construct Cross-gutter & Spandril per Std. 220
 10. Construct Wheelchair Ramp per Std. 304 - (Modified per Detail, this sheet)
 11. Remove all existing improvements (A.C., C&G, Sidewalk, etc.) and backfill per Typ. Section Saw-Cut
 12. Construct Under Sidewalk Drain per Std. 411
 13. Construct Driveway Approach per Std. 302: Type II, A-12

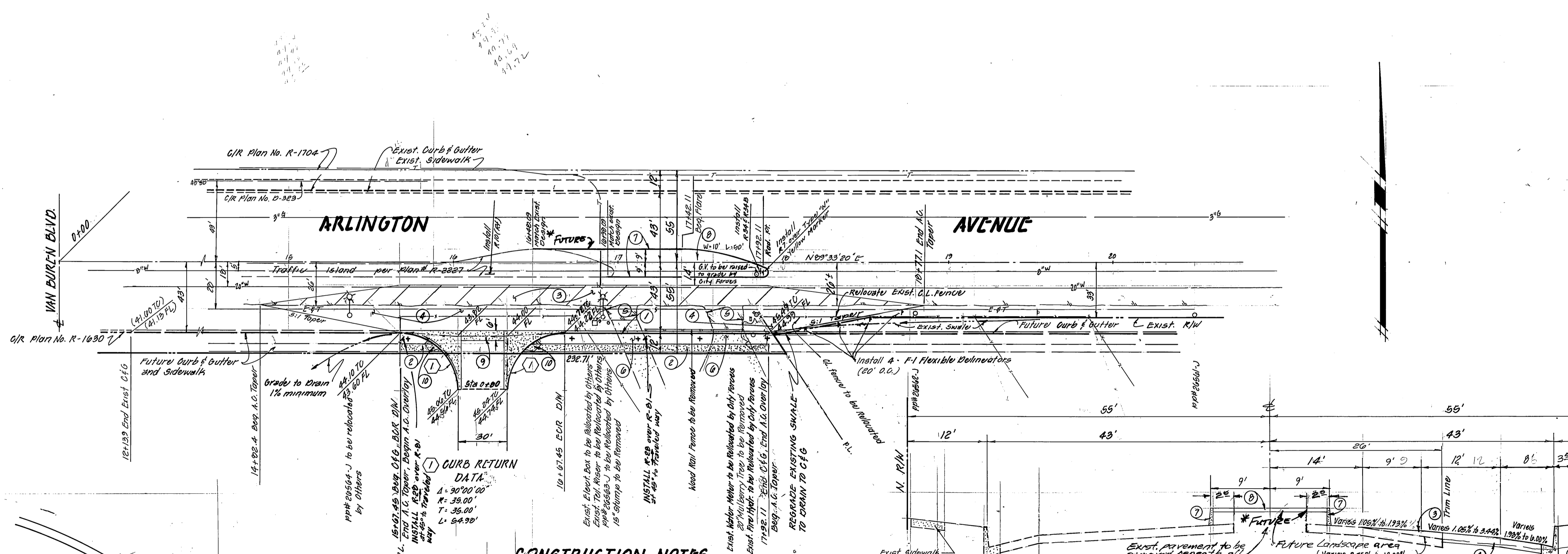
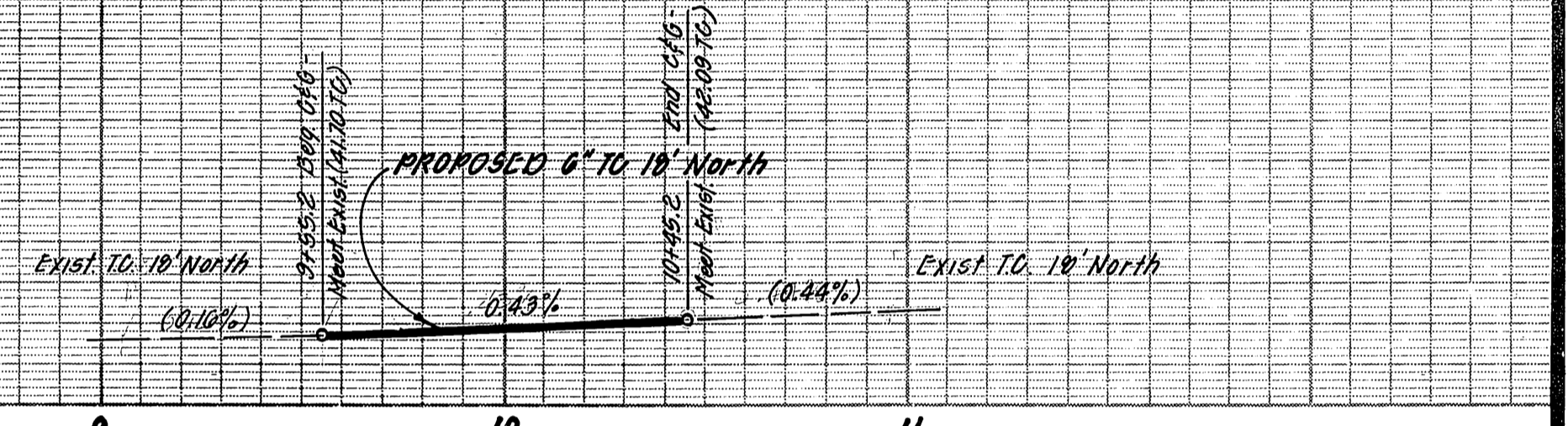
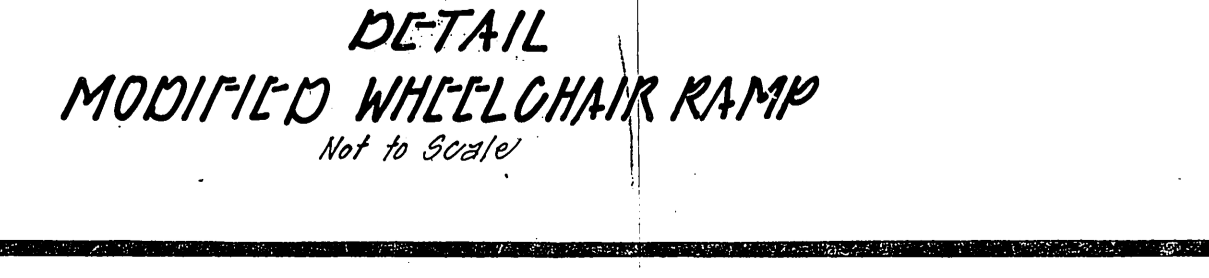

JAMES K. LANGONE
Land Surveys & Civil Engineering
582 N. Valley Blvd. Ste. 16
Colton, CA 92324
(714) 925-0303

CITY OF RIVERSIDE, CALIFORNIA
PUBLIC WORKS DEPARTMENT

PHOENIX TELEPHONE
Jim Panama 4-18-85
Approved Date
CITY OF RIVERSIDE
OVERHEAD & UNDERGROUND
John Johnson 4/10/85
Public Utilities Date

CITY OF RIVERSIDE
WATER SYSTEM
APPROVED
Date

STREET PLAN AND PROFILE
ARLINGTON AVENUE
FROM 1550' TO 1900' EAST OF VAN BUREN BLVD.
PEMBROKE AVENUE
FROM 50' WEST TO 50' EAST OF CONCORD AVE.
FOR Zoning Case R-25-834

INDEX
ACCOUNT No. DRAWING NUMBER
R-2673
SHEET 1 OF 1

APPROVED BY
PRINCIPAL ENGINEER
TRAFFIC DIVISION
CHIEF PUBLIC WORKS ENGINEER

DATE
MAY 20, 1985

SCALE: Horiz. 1"=40' Vert. 1"=4'

DESIGNED BY **DRAWN BY** **CHECKED BY**