

### GENERAL NOTES

- IT SHALL BE THE RESPONSIBILITY OF THE CONTRACTOR TO CLEAR THE RIGHT OF WAY IN ACCORDANCE WITH THE PROVISIONS OF LAW AS IT AFFECTS EACH UTILITY INCLUDING IRRIGATION LINES AND APPURTENANCES AND AT NO COST TO THE CITY.
- CONSTRUCTION SHALL BE IN ACCORDANCE WITH THE CITY OF RIVERSIDE DEPARTMENT OF PUBLIC WORKS, STANDARD DRAWINGS, AND THE STANDARD SPECIFICATIONS FOR PUBLIC WORKS CONSTRUCTION, 1985 EDITION.
- TRIM EDGE OF EXISTING PAVEMENT WHERE NEW PAVEMENT JOINS TO A SMOOTH, STRAIGHT LINE. CONSTRUCT MATCH-UP PAVING AS SHOWN ON PLAN AND OVERLAY PAVING AS DIRECTED IN THE FIELD TO PRODUCE A SMOOTH SECTION.
- CONSTRUCT DRIVEWAY APPROACHES PER STD. DWG. 302.
- CURB AND GUTTER SHALL BE STAKED WITH 3' OFFSETS AT 25' INTERVALS.
- LOCATION OF LATERALS TO BE DETERMINED IN THE FIELD AT THE DIRECTION OF THE OWNER. AVOID CONFLICT WITH PROPOSED AND/OR EXISTING FACILITIES.
- ALL TRAFFIC SIGNS SHALL BE INSTALLED PRIOR TO OPENING THE STREETS TO TRAFFIC.
- ANY TRAFFIC CONTROL STRIPING OBLITERATED AND/OR BADLY WORN DURING CONSTRUCTION SHALL BE RESTORED BY THE CONTRACTOR WITHIN FIVE DAYS AFTER NOTIFICATION FROM THE CITY INSPECTORS.
- FINAL STRIPING FOR TRAFFIC CONTROL AND/OR PAVEMENT MAKING TO BE THE RESPONSIBILITY OF THE DEVELOPER.
- STREET OPENING PERMIT FOR CONSTRUCTION AND/OR MODIFICATION OF TRAFFIC SIGNAL FACILITIES REQUIRED.
- SEE "STREET LIGHTING PLANS" FOR QUANTITY AND LOCATION OF REQUIRED STREET LIGHTS.
- ALL FLAGGED ELEVATIONS SHALL BE STAKED IN THE FIELD BY THE PRIVATE ENGINEER.
- THE PRIVATE ENGINEER SIGNING THESE PLANS IS RESPONSIBLE FOR ASSURING THE ACCURACY AND ACCEPTABILITY OF THE WORK HEREON. IN THE EVENT OF DISCREPANCIES ARISING DURING CONSTRUCTION, THE PRIVATE ENGINEER SHALL BE RESPONSIBLE FOR DETERMINING AN ACCEPTABLE SOLUTION AND REVISING THE PLANS FOR APPROVAL BY THE CITY.
- THE CONTRACTOR SHALL CALL IN A LOCATION REQUEST TO UNDERGROUND SERVICE ALERT (USA), PHONE NO. 1-800-422-4133, TWO WORKING DAYS BEFORE DIGGING. NO CONSTRUCTION PERMIT WILL BE ISSUED BY THE PUBLIC WORKS DEPARTMENT INVOLVING EXCAVATION FOR UNDERGROUND FACILITIES UNLESS THE APPLICANT HAS BEEN PROVIDED AN INQUIRY IDENTIFICATION NUMBER BY U.S.A.
- DEVELOPER TO GIVE CITY WATER DIVISION FIVE (5) WORKING DAYS WRITTEN NOTICE PRIOR TO START OF CONSTRUCTION AND ALLOW CITY TEN (10) WORKING DAYS FOR COMPLETION OF WORK. (787-7611)

### PARKS DEPARTMENT NOTES

- ALL RELATED WORK SHALL CONFORM TO THE CITY OF RIVERSIDE, PARK AND RECREATION DEPARTMENT STANDARDS.
- CONTACT THE PARK PROJECTS INSPECTOR A MINIMUM OF 48 HOURS IN ADVANCE AT 787-7223 TO SCHEDULE INSPECTIONS. INSPECTIONS SHALL BE REQUIRED: A) WHEN PLANT LOCATIONS HAVE BEEN SPOTTED IN THE FIELD PRIOR TO DIGGING PLANT PITS, B) WHILE DIGGING PLANT PITS AND PLANTING/RELOCATING TREES, C) AFTER PLANTING AND ALL OTHER INDICATED OR SPECIFIED WORK HAS BEEN COMPLETED FOR START OF MAINTENANCE, AND D) AT END OF MAINTENANCE/FINAL ACCEPTANCE THE DEVELOPER WILL BE RELEASED FROM MAINTENANCE ONLY UPON RECEIPT OF WRITTEN NOTIFICATION FROM THE CITY THAT THE PARK AND RECREATION DEPARTMENT IS ASSUMING MAINTENANCE RESPONSIBILITIES.
- THE DEVELOPER SHALL MAINTAIN ALL PLANTINGS FOR A MINIMUM PERIOD OF ONE (1) YEAR.
- A PUBLIC WORKS DEPARTMENT PERMIT IS REQUIRED PRIOR TO COMMENCEMENT OF TREE RELOCATION AND/OR REMOVAL WORK. FOR ALL TREES WITHIN THE ULTIMATE PAVEMENT AREA, BACKFILL OF ALL HOLES IS TO BE INSPECTED BY THE CITY FOR PROPER COMPACTION.
- STREET TREE PLANTING SHALL BE AS FOLLOWS:  
STREET NAME BOTANICAL NAME/COMMON NAME MIN. SIZE SPACING NO. REQ.  
a. VAN BUREN BLVD. LAGERSTROEMIA / CRAPE 15 GAL 45' 8  
INDICA MYRTLE
- ALL STREET TREES TO BE AUTOMATICALLY IRRIGATED.



### CONSTRUCTION NOTES

- CONSTRUCT 6" CURB & 5' GUTTER PER STD. 200 TYPE 1
- CONSTRUCT CURB SIDEWALK PER STD. 325
- CONSTRUCT 4.5" OF A.C. PAVING OVER 11" OF CRUSHED AGGREGATE BASE, INDICATED BY  ON PLAN
- CONSTRUCT DRIVEWAY APPROACHES PER STD. DWG. 302 TYPE IV, A=24, B=38.
- CONSTRUCT A.C. BERM, TYPE I, ON 2:1 TAPER, PER STD. 250.
- INSTALL F-1 FLEXIBLE DELINEATORS MAX, 20' ON CENTERS.

### NOTICE TO CONTRACTOR

THE EXISTENCE AND LOCATION OF ANY UNDERGROUND UTILITY PIPES OR STRUCTURES SHOWN ON THESE PLANS ARE OBTAINED BY A SEARCH OF THE AVAILABLE RECORDS. TO THE BEST OF OUR KNOWLEDGE, THERE ARE NO EXISTING UTILITIES EXCEPT THOSE SHOWN ON THESE PLANS.

THE CONTRACTOR IS REQUIRED TO TAKE DUE PRECAUTIONARY MEASURES TO PROTECT THE UTILITY LINES SHOWN AND ANY OTHER LINES NOT OF RECORD OR NOT SHOWN ON THESE PLANS.

CALL UNDERGROUND SERVICE ALERT (USA) 1-800-422-4133 AT LEAST 48 HOURS PRIOR TO EXCAVATION

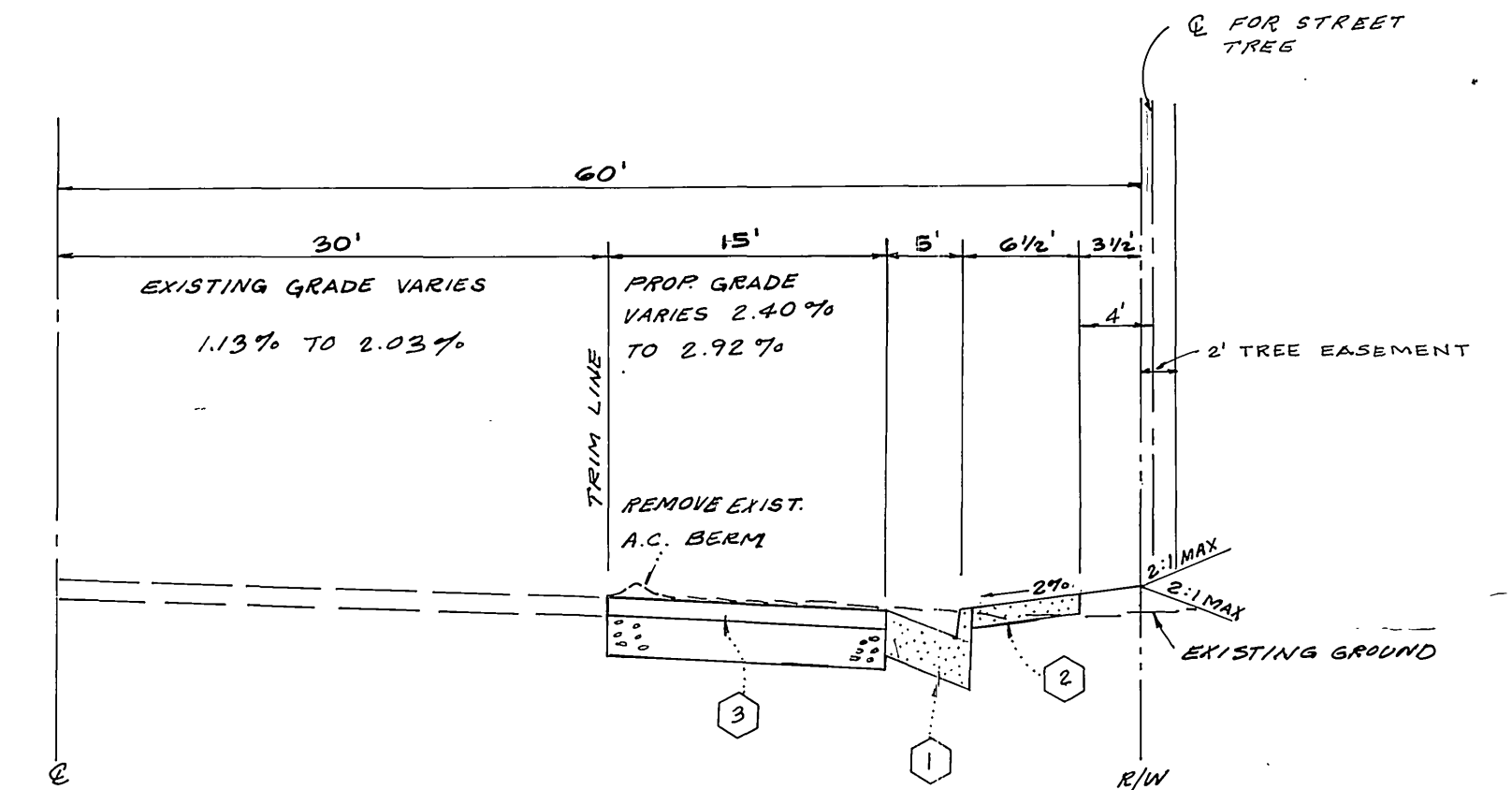

### TYPICAL SECTION

VAN BUREN BOULEVARD  
T.I. = 10

CITY OF RIVERSIDE  
WATER SYSTEM  
APPROVED DATE

**BENCH MARK**  
CITY OF RIVERSIDE PRECISE LEVEL B.M. FA-D  
P.K. NAIL AND CITY ENGINEER TAG IN  
MOST EASTERLY CURB RETURN @ VAN BUREN  
AND GARFIELD.  
ELEV = 771.483

ALBERT A. WEBB ASSOCIATES  
CIVIL ENGINEERS  
RIVERSIDE, CALIFORNIA  
APPROVED BY [Signature] DATE 3-27-85  
R.E. No. 27983

CITY OF RIVERSIDE, CALIFORNIA  
PUBLIC WORKS DEPARTMENT  
APPROVED BY [Signature] DATE 7-12-85  
PRINCIPAL ENGINEER [Signature] DATE 7-2-85  
PARK DEPARTMENT [Signature] DATE 5-7-85  
TRAFFIC DIVISION [Signature] DATE 3-2-85  
CHIEF PUB. WKS. ENGR. [Signature]

STREET IMPROVEMENT PLANS  
**I CARE CENTER**  
VAN BUREN BOULEVARD  
C-31-823

INDEX W.F.  
ACCOUNT No.  
DRAWING NUMBER  
**R-2689**  
SHEET 1 OF 2  
W.O. 84-39

DESIGNED BY RDP DRAWN BY RDP CHECKED BY J. J. [Signature]

PC 1719



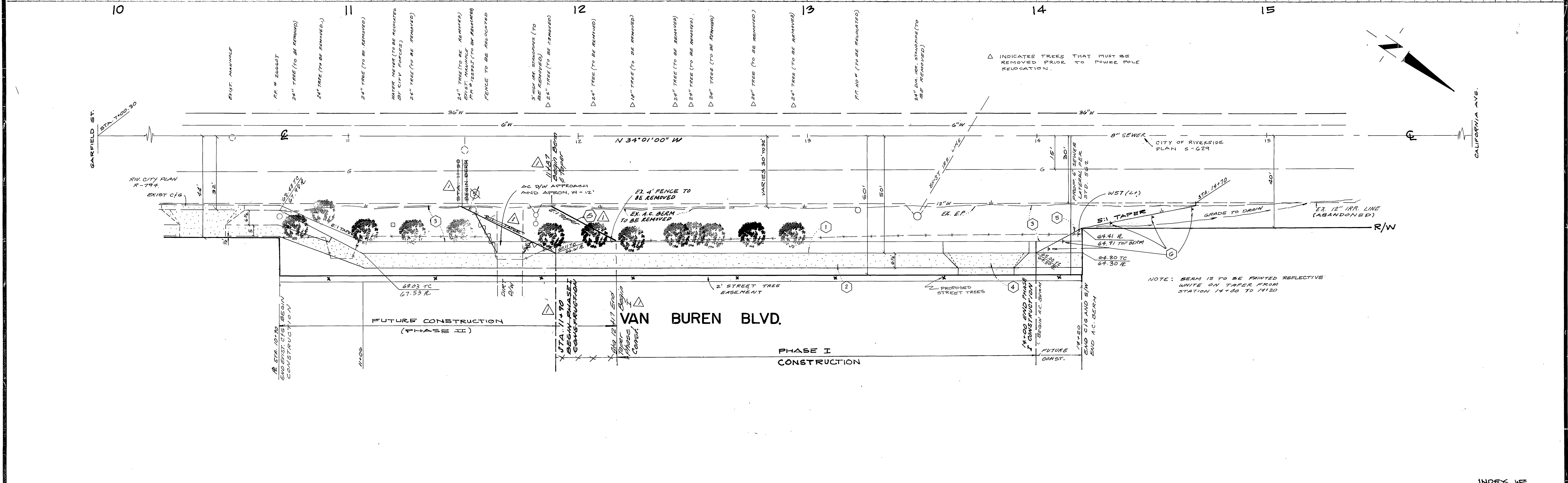
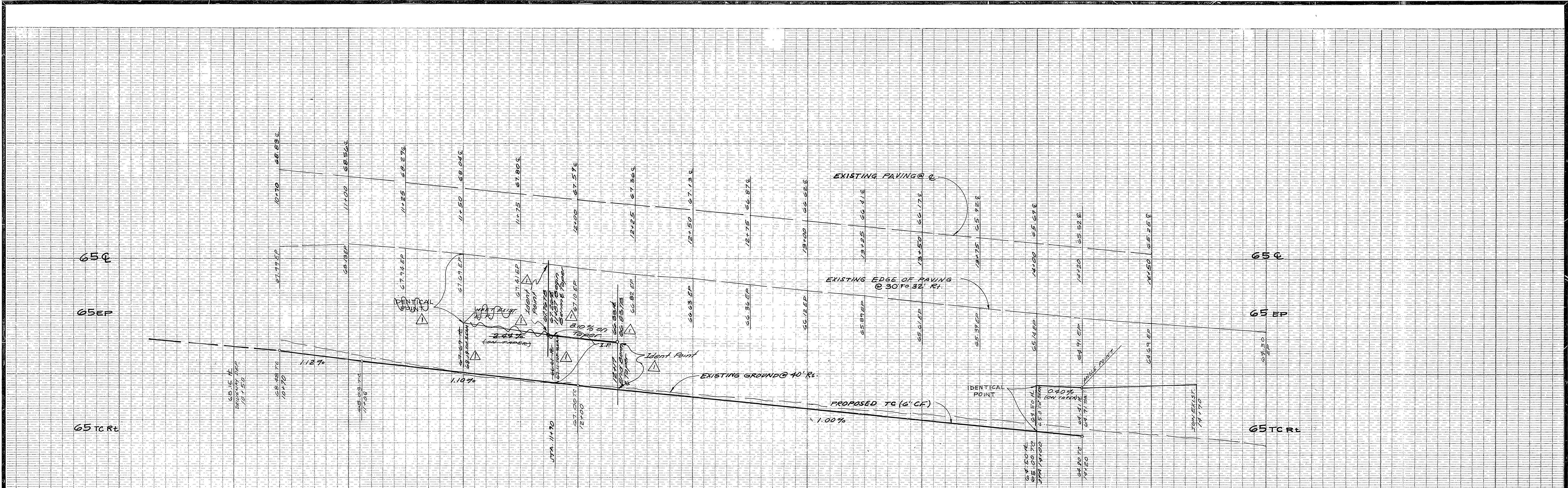

<b>CITY OF RIVERSIDE</b> OVERHEAD/ UNDERGROUND		<b>CITY OF RIVERSIDE</b> WATER SYSTEM		<b>BENCH MARK</b> CITY OF RIVERSIDE PRECISE LEVEL BM FA-D R.K. NAIL AND CITY ENGINEER TAG IN MOST EASTERLY CURB RETURN @ VAN BUREN AND GARFIELD. ELEV = 771.483		<b>ALBERT A. WEBB ASSOCIATES</b> CIVIL ENGINEERS RIVERSIDE, CALIFORNIA APPROVED BY: <i>[Signature]</i> DATE: 7/12/85 R.E. No. 27723		<b>CITY OF RIVERSIDE, CALIFORNIA</b> PUBLIC WORKS DEPARTMENT APPROVED BY: <i>[Signature]</i> DATE: 7-12-85 DIRECTOR OF PUBLIC WORKS		<b>STREET IMPROVEMENT PLANS</b> ACCOUNT No. <b>I CARE CENTER</b> <b>VAN BUREN BOULEVARD</b> C-31-823 SCALE: HORIZ. 1" = 20' VERT. 1" = 2'		<b>INDEX</b> ACCOUNT No. <b>R-2689</b> SHEET 2 OF 2 W.O. 84-39	
---	--	--	--	--	--	---	--	--	--	--	--	--	--