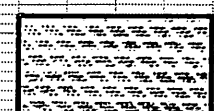
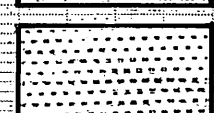
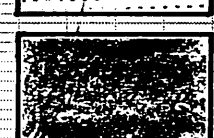

CONSTRUCTION LEGEND

-  CONSTRUCT STRUCTURAL SECTION OF 0.05' MIN. DGAC OVER 0.75' CRUSHED AGGREGATE BASE.
-  OVERLAY EXISTING AC PAVEMENT WITH 0.05' MIN. DGAC OVER VAR. THICKNESS DGAC OVERLAY.
-  CONSTRUCT A.C. SIDEWALK 0.21' THICK.

SPECIFIC CONSTRUCTION NOTES

NUMBERS ABOVE 100 IN A HEXAGON ON THE PLAN REFER TO THE RESPECTIVE STANDARD DRAWING AND SHALL BE CONSTRUCTED ACCORDINGLY UNLESS MODIFICATIONS ARE NOTED ON THE PLAN. OTHERWISE, THE NUMBER SHOWN BELOW THE STANDARD DRAWING NUMBER INDICATES THE SPECIFIC ALTERNATE TO BE CONSTRUCTED.

GENERAL CONSTRUCTION NOTES

1. EXISTING UTILITIES SHOWN ON THIS PLAN ARE PLOTTED FROM UTILITY RECORDS. THE CONTRACTOR IS REQUIRED TO TAKE DUE PRECAUTIONARY MEASURES TO LOCATE & PROTECT ALL UTILITIES WHICH ARE OR NOT SHOWN ON THIS PLAN. IF THE COVER OF A UTILITY IS KNOWN IT IS SHOWN IN THE PROFILE. UTILITIES SHOWN IN THE PROFILE AS "X" INDICATES THAT THE COVER IS UNKNOWN BUT THE UTILITY IS NOT EXPECTED TO INTERFERE WITH THE PROPOSED IMPROVEMENTS.
2. ALL ELEVATIONS SHOWN ON THE PLAN SHALL BE STAKED IN THE FIELD.
3. CONFLICTING UTILITIES SHOWN WITHIN CONSTRUCTION AREA WILL BE RELOCATED PRIOR TO CONSTRUCTION.

BENCHMARK E2-D
 PK IN SE CURB RETURN @ INDIANA AVE.
 E. CLINTON ST. PER PRECISE B.M. BOOK
 ELEV. 738.968

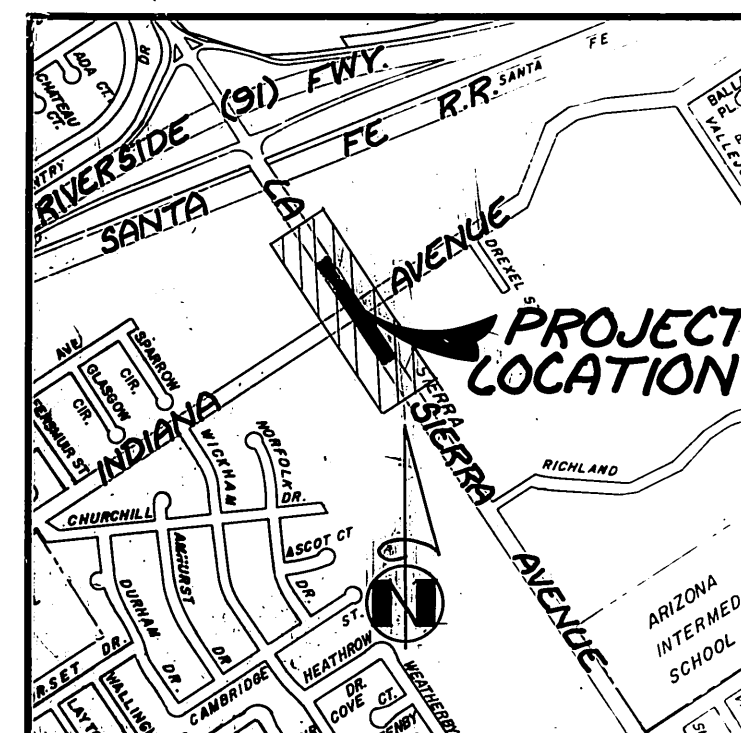
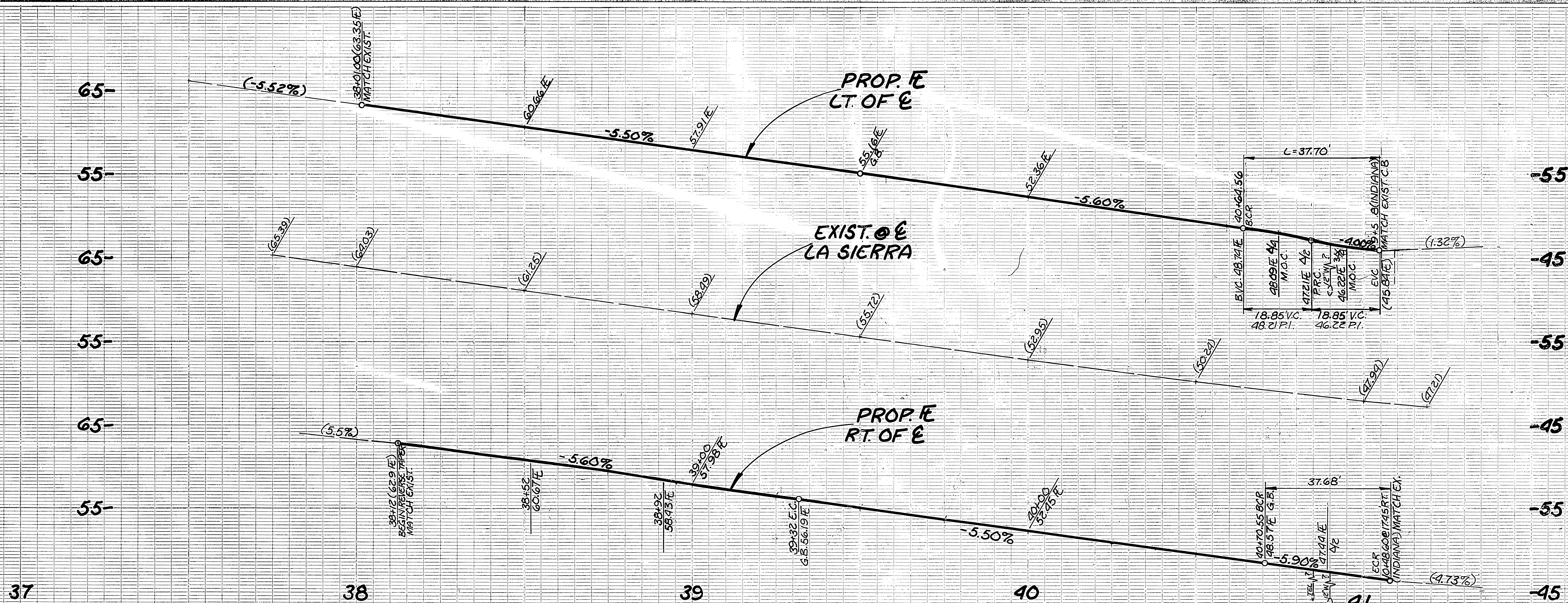

ITEM	QTY
UNCLASSIFIED EXCAV.	230 C.Y.
UNCLASSIFIED FILL	308 C.Y.
CRUSHED AGG. BASE	95 C.Y.
DENSE GRADED A.C.	178 TONS
OPEN GRADED A.C.	60 TONS
A.C. BERM (TYPE I)	970 L.F.
STRIPING	2159 L.F.
PAVT. MARKINGS	742 S.F.
STRIPING (MARKING REMOVAL)	767 S.F.
TYPE F MARKERS	5 EA.
SIGNS	1 EA.
A.C. SIDEWALK	2870 S.F.
A.C. SINGLE	225 S.F.
15" A.C.P. W/ R.C. COLLAR	26 L.F.
UNDER S/W DRAIN	1 EA.

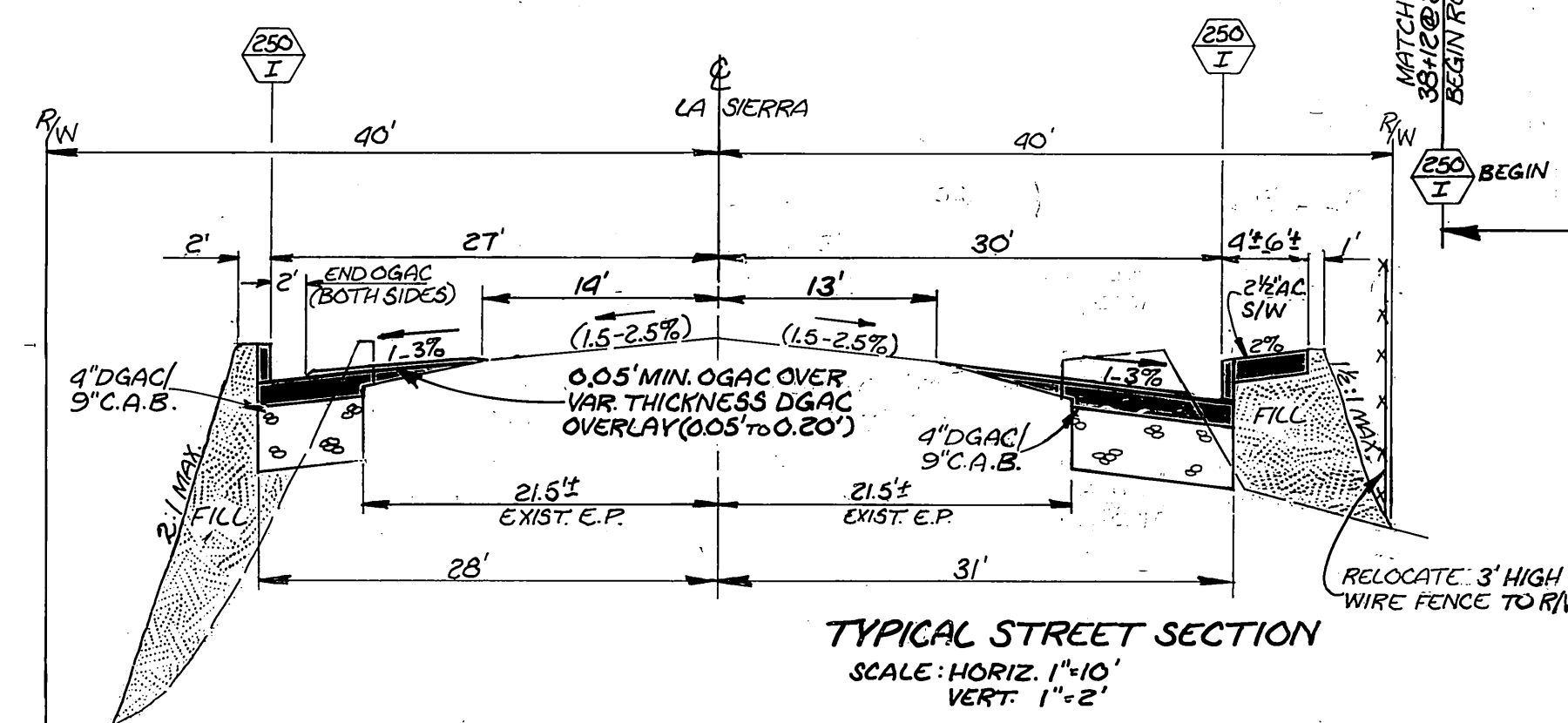
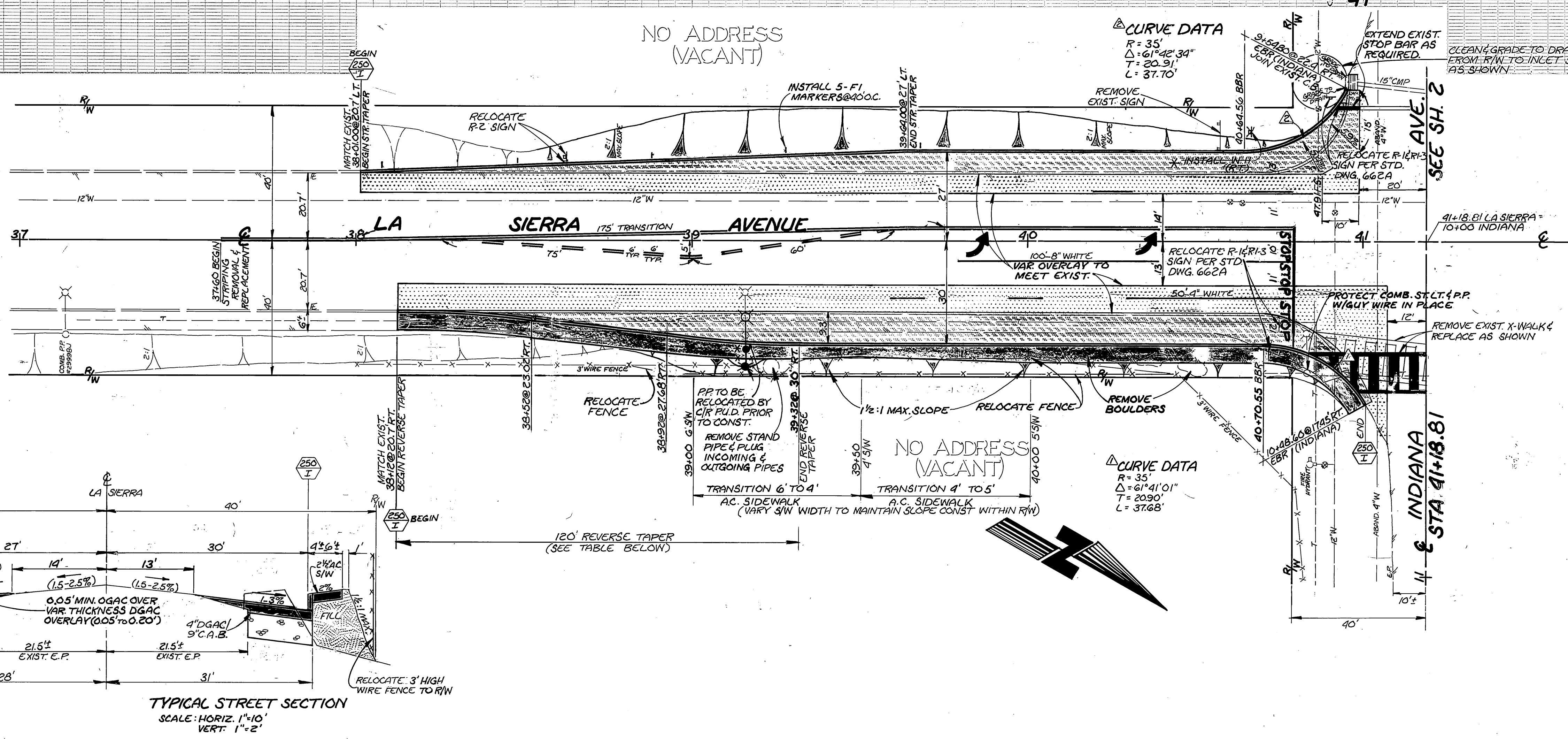

Underground Service Alert
 Call TOLL FREE
1-800-422-4133
 TWO WORKING DAYS BEFORE YOU DIG

120' REVERSE TAPER L=120' W=9.3'

X	10'	20'	30'	40'	60'	80'	90'	100'	110'	120'
Y	0.15'	0.58'	1.30'	2.32'	4.63'	6.98'	8.72'	9.15'	9.31'	9.31'

CITY OF RIVERSIDE
 PUBLIC WORKS DEPARTMENT

APPROVED BY: *[Signature]*
 DATE: 6-27-86

DESIGNED BY: *[Signature]* DRAWN BY: *[Signature]* CHECKED BY: *[Signature]*

LA SIERRA AVENUE WIDENING
 1300 1/2 S.W. OF INDIANA AVENUE
 TO 400 1/2 N.W. OF INDIANA AVENUE

INDEXED BY CD
 ACCOUNT NO. 30-575-361-07
R-2724
 SHEET 1 OF 2

HORIZ. SCALE: 1" = 20'
 VERT. SCALE: 1" = 8'

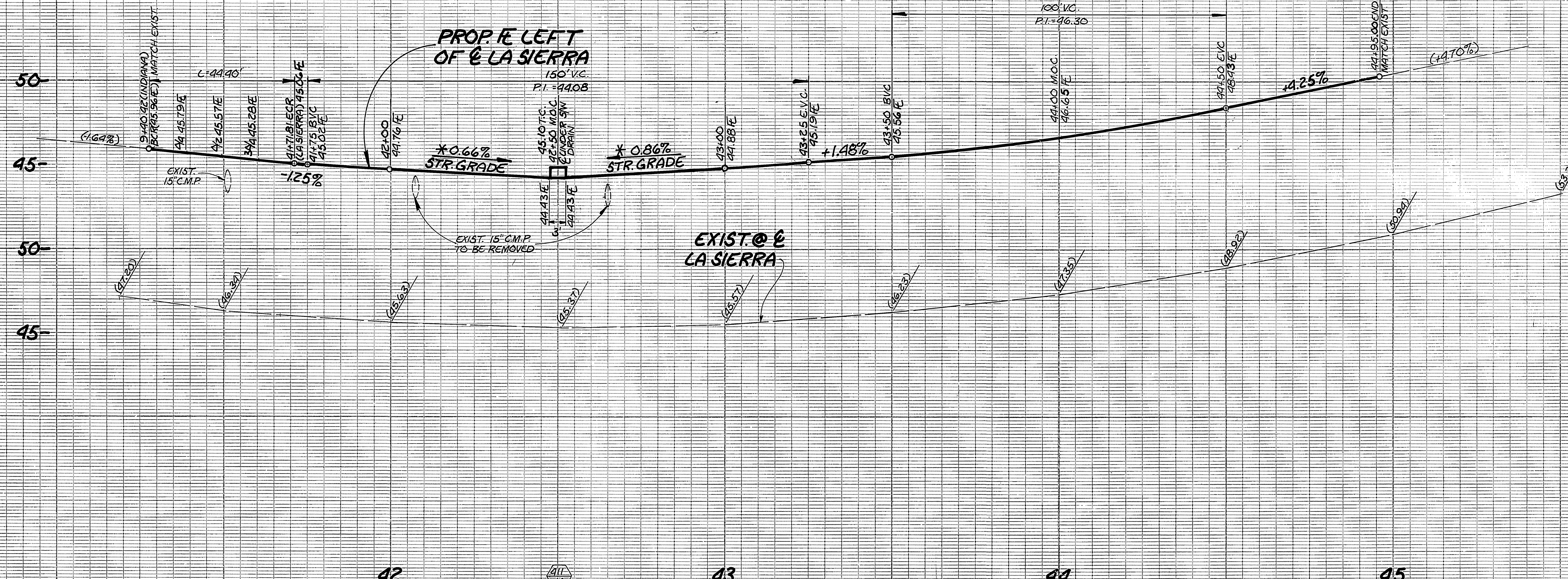

CURVE DATA
 R=35'
 Δ=72°40'50"
 T=65.15'
 L=44.40'

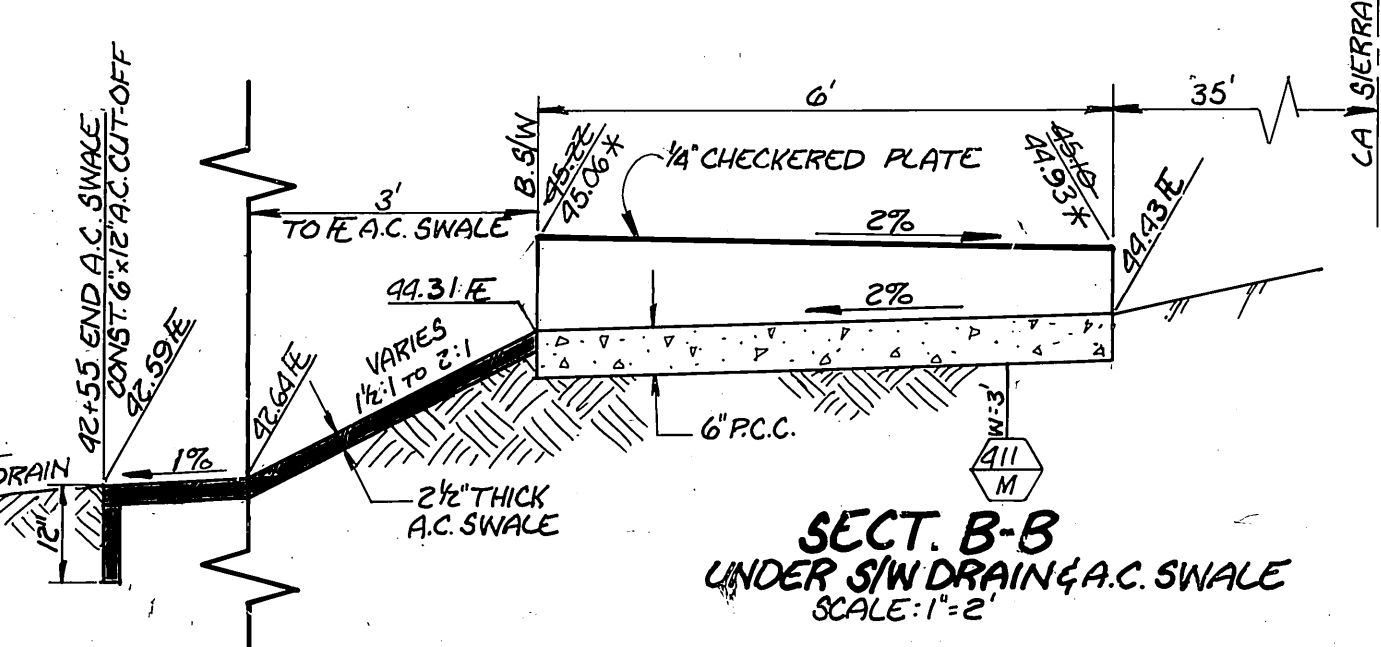
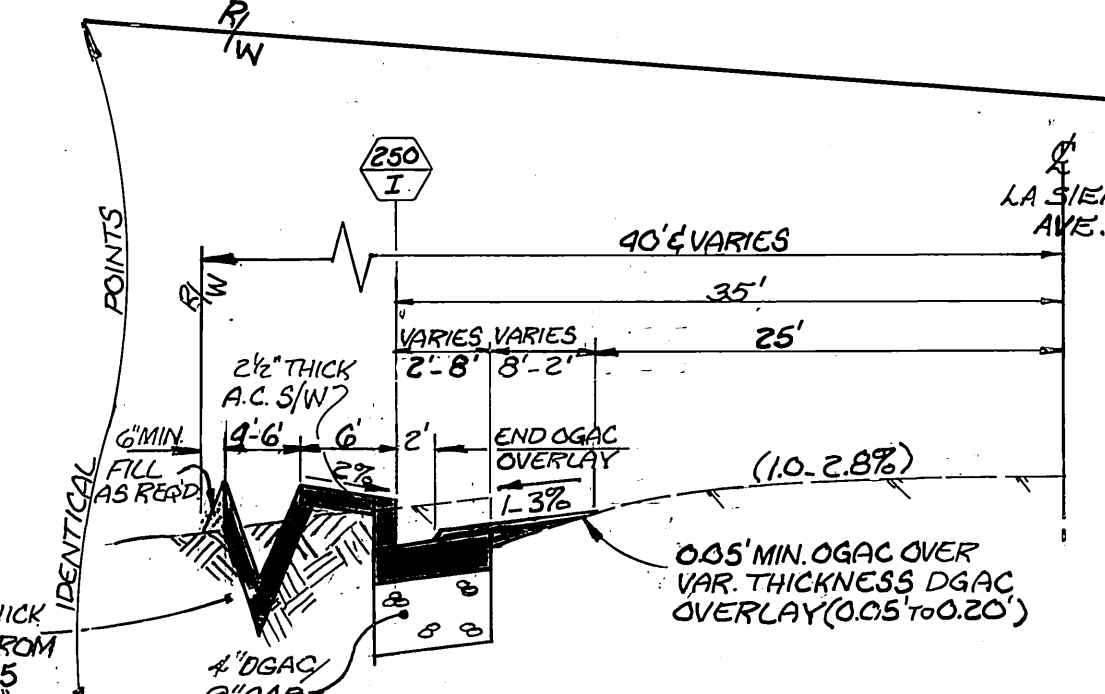
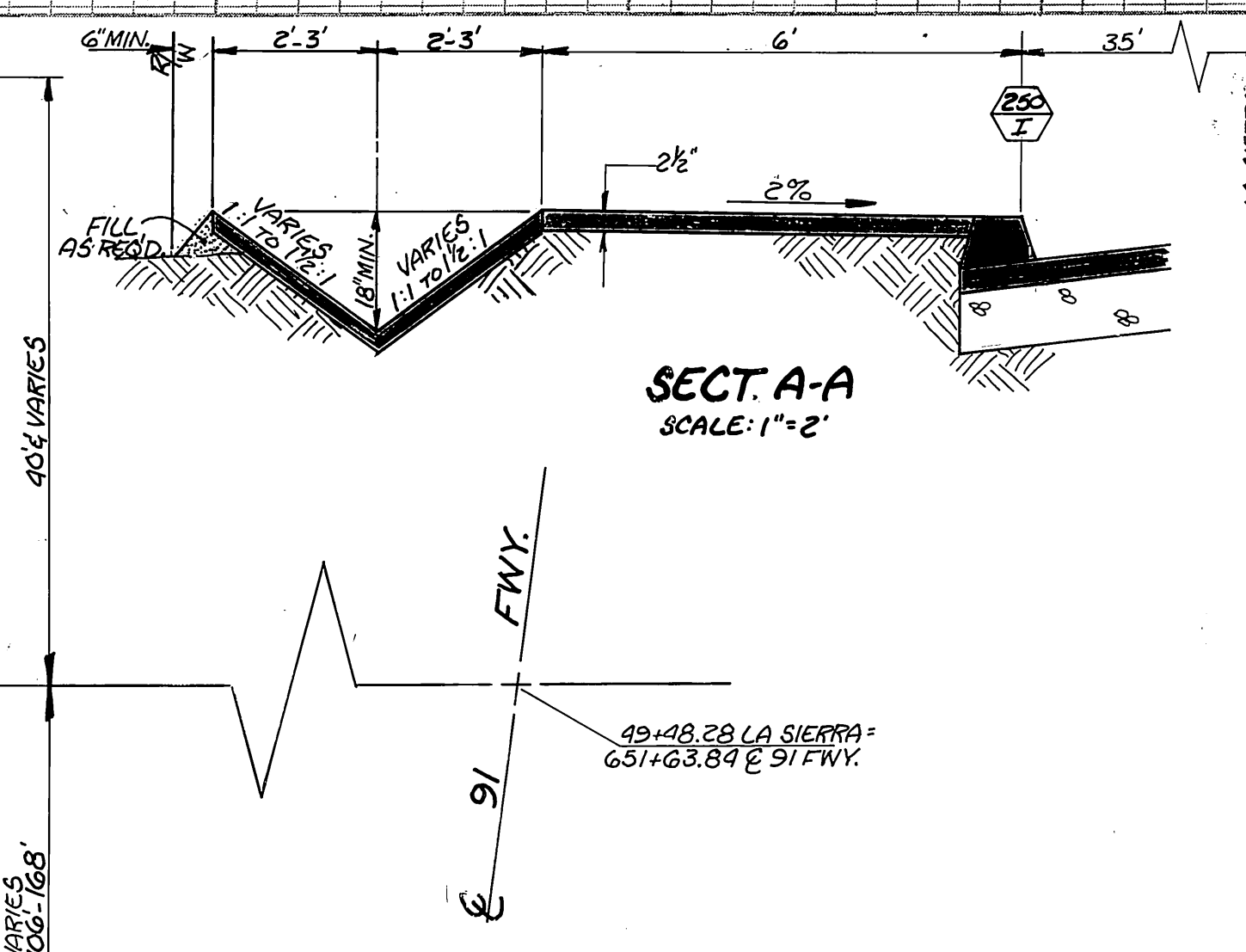
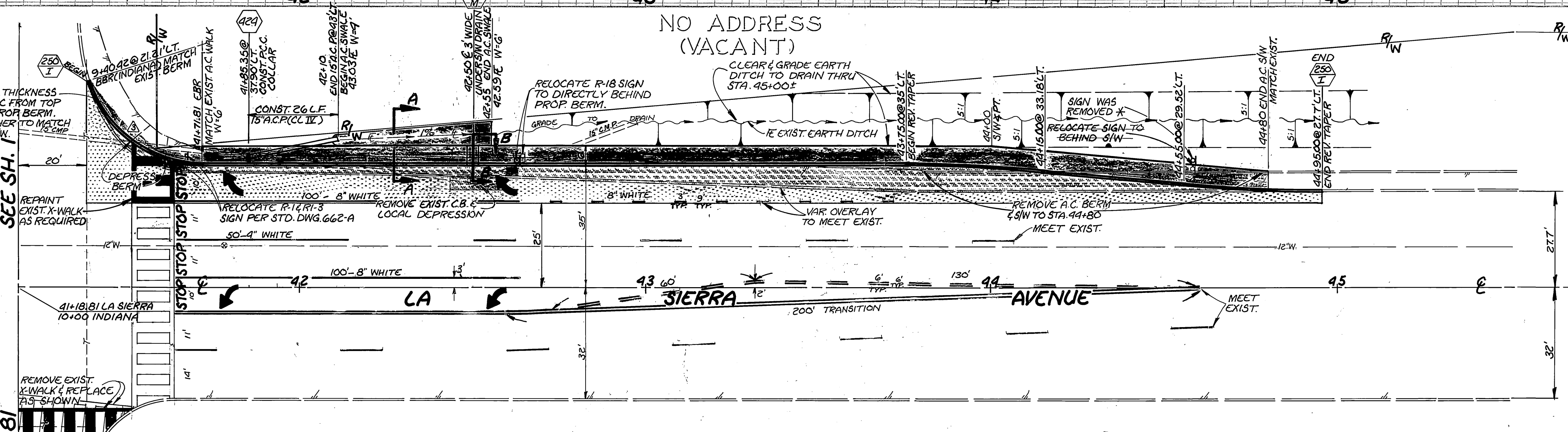

NOTE: RIGHT OF WAY PLOTTED PER RIVERSIDE COUNTY RECORDS IN BOOK 2, PAGE 160 OF STATE HIGHWAY MAPS, RECORDED AUGUST 19, 1959.

Underground Service Alert
 Call: TOLL FREE
1-800-422-4133
 TWO WORKING DAYS BEFORE YOU DIG

AS BUILT	R/C	2-23-87
DESIGNED BY	D.A.	DRAWN BY
CHECKED BY	RPM	SURVEYOR

CITY OF RIVERSIDE
 PUBLIC WORKS DEPARTMENT
 APPROVED BY: *Joseph A. Kamsatz*
 DATE: 6-27-86
 CHIEF P.W. INSPECTOR

LA SIERRA AVENUE WIDENING
 300'S'LY OF INDIANA TO 400'S'LY OF INDIANA
 ACCOUNT NO. 30-575-361-07
R-2724
 SHEET 2 OF 2
 HORIZ. SCALE: 1"=20' VERT. SCALE: 1"=4'