

CONSTRUCTION LEGEND

- CONST. STRUCTURAL SECTION OF:
 - ALT. I - 0.75" DGAC OVER NATIVE SOIL
 - ALT. II - 0.33" DGAC OVER 0.75" C.A.B. ON LINCOLN
 - 0.25" DGAC OVER 0.83" C.A.B. ON MAUDE
- OVERLAY EXIST. AC PAVEMENT WITH A VARIABLE THICKNESS OF DGAC.

SPECIFIC CONSTRUCTION NOTES

- NUMBERS ABOVE 100 IN A HEXAGON ON THE PLAN REFER TO THE RESPECTIVE STANDARD DRAWING AND SHALL BE CONSTRUCTED ACCORDINGLY UNLESS MODIFICATIONS ARE NOTED ON THE PLAN OR COVER SHEET. ANY NUMBER SHOWN BELOW THE STANDARD DRAWING NUMBER INDICATES THE SPECIFIC ALTERNATE TO BE CONSTRUCTED.
- PLANT FRAXINUS VELUTINA MODESTO (MODESTO ASH) AS LOCATED ON PLAN. 15 GAL. MIN. SIZE, TOTAL NO. 13

GENERAL CONSTRUCTION NOTES

- EXISTING UTILITIES SHOWN ON THIS PLAN ARE PLOTTED FROM UTILITY RECORDS. THE CONTRACTOR IS REQUIRED TO TAKE PRECAUTIONARY MEASURES TO LOCATE AND PROTECT ALL UTILITIES WHETHER SHOWN OR NOT. IF THE COVER OF A UTILITY IS KNOWN, IT IS SHOWN IN THE PROFILE UTILITIES SHOWN IN THE PROFILE AS "X" INDICATES THAT THE COVER IS UNKNOWN BUT THE UTILITY IS NOT EXPECTED TO CONFLICT WITH THE PROPOSED IMPROVEMENTS.
- ALL ELEVATIONS SHOWN ON THE PLAN SHALL BE STAKED IN THE FIELD.
- CONFLICTING UTILITIES SHOWN WITHIN THE CONSTRUCTION AREA WILL BE RELOCATED PRIOR TO CONSTRUCTION.
- PRIME CONTRACTORS BIDDING THIS WORK SHALL HAVE A CLASS A DREG LICENSE.

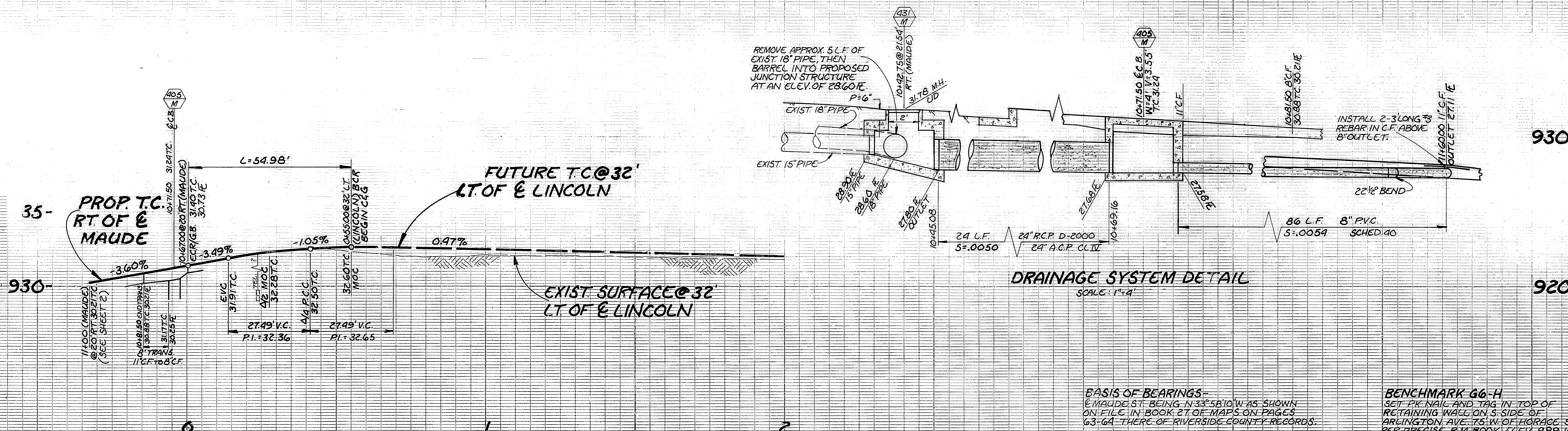

BASIS OF BEARINGS-
 E. MAUDE ST. BEING N 33° 58' 10" W AS SHOWN ON FILE IN BOOK 27 OF MAPS ON PAGES 63-64 THERE OF RIVERSIDE COUNTY RECORDS.

BENCHMARK 66-H-
 SET PILE AND TAG IN TOP OF RETAINING WALL ON S. SIDE OF ARINGTON AVE. 75' W. OF HORACE ST. PER PRECISE B.M. BOOK: ELEV. 889.160

GENERAL NOTES FOR PLANTING

- ALL RELATED WORK SHALL CONFORM TO THE CITY OF RIVERSIDE, PARK AND RECREATION DEPARTMENT STANDARDS.
- CONTACT THE PARKS PROJECTS INSPECTOR A MIN. OF 48 HRS. IN ADVANCE @ 787-7223 TO SCHEDULE INSPECTIONS. INSPECTIONS SHALL BE REQUIRED:
 - A) WHEN PLANT LOCATIONS HAVE BEEN SPOTTED IN THE FIELD PRIOR TO DIGGING PLANT PITS.
 - B) WHILE DIGGING PLANT PITS AND PLANTING TREES.
 - C) AFTER PLANTING AND ALL OTHER INDICATED OR SPECIFIED WORK HAS BEEN COMPLETED FOR START OF MAINTENANCE.
 - D) AT THE END OF MAINTENANCE/FINAL ACCEPTANCE (CALIF. SCHOOL FOR THE DEAF WILL BE RELEASED FROM MAINTENANCE ONLY UPON RECEIPT OF WRITTEN NOTIFICATION FROM THE CITY THAT THE PARK AND RECREATION DEPT. IS ASSUMING MAINTENANCE RESPONSIBILITIES.)
- CALIF. SCHOOL FOR THE DEAF SHALL MAINTAIN ALL PLANTINGS FOR A MINIMUM PERIOD OF ONE (1) YEAR.
- STREET TREE PLANTING SHALL BE AS FOLLOWS:

STREET NAME	BOTANICAL NAME/COMMON NAME	MIN. SIZE
MAUDE STREET	FRAXINUS VELUTINA MODESTO	15 GAL.
APPROX. SPACING	NO. REQ.	ASH
45'	13	

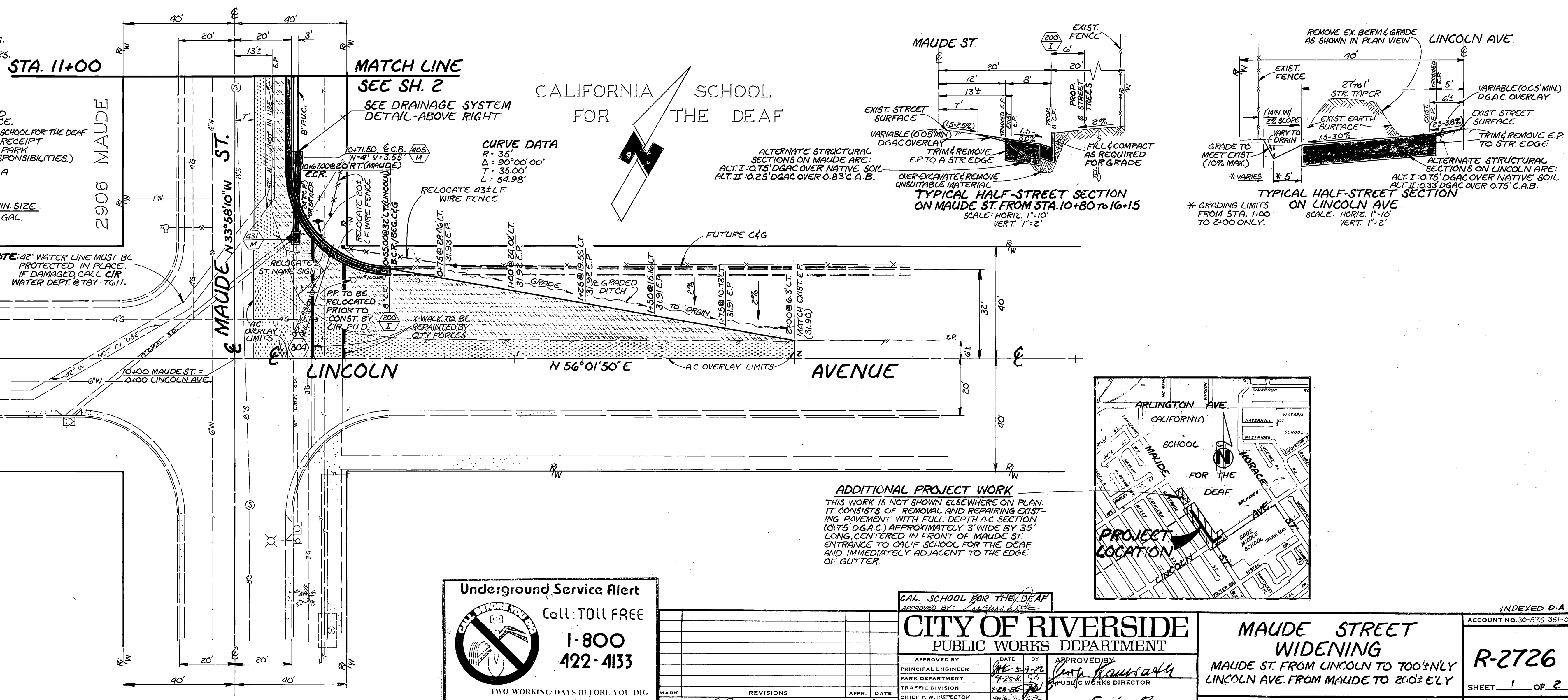

Underground Service Alert
 Call TOLL FREE
1-800-422-4133
 TWO WORKING DAYS BEFORE YOU DIG.

CITY OF RIVERSIDE
 PUBLIC WORKS DEPARTMENT

APPROVED BY: *[Signature]*
 DATE: 5-16-12

PRINCIPAL ENGINEER: *[Signature]*
 TRAFFIC DIVISION: *[Signature]*
 CHIEF P.W. INSPECTOR: *[Signature]*
 SURVEYOR: *[Signature]*

MAUDE STREET WIDENING
 MAUDE ST. FROM LINCOLN TO 700± NLY
 LINCOLN AVE. FROM MAUDE TO 200± E'LY

INDEXED D.A.
 ACCOUNT NO. 30-575-361-07
R-2726
 SHEET 1 OF 2

HORIZ. SCALE: 1" = 20'
 VERT. SCALE: 1" = 4'

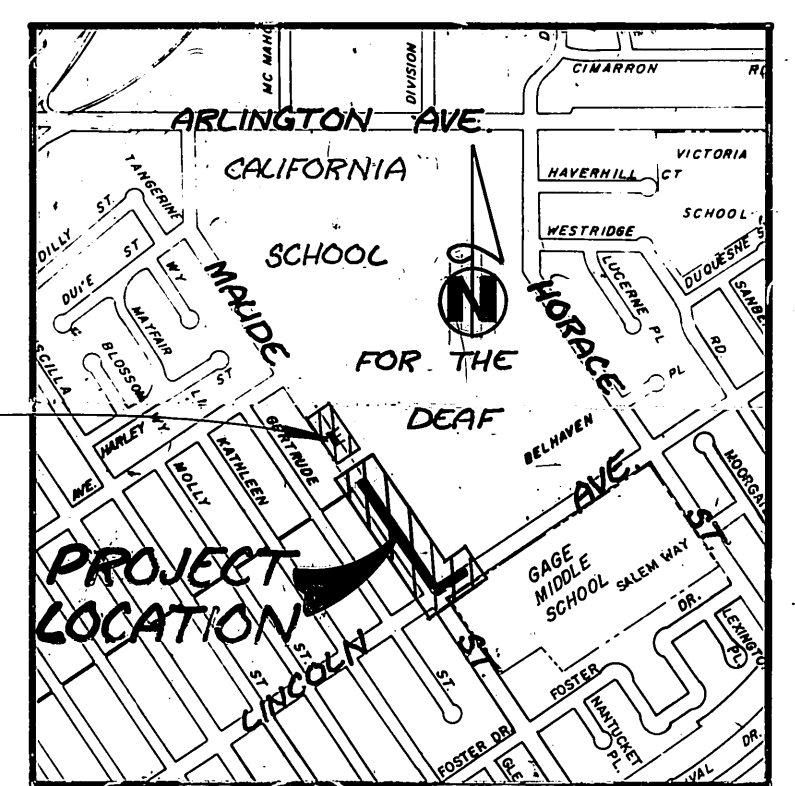

ADDITIONAL PROJECT WORK
 THIS WORK IS NOT SHOWN ELSEWHERE ON PLAN. IT CONSISTS OF REMOVAL AND REPAIRING EXISTING PAVEMENT WITH FULL DEPTH AC SECTION (0.75" DGAC) APPROXIMATELY 3' WIDE BY 35' LONG, CENTERED IN FRONT OF MAUDE ST. ENTRANCE TO CALIF. SCHOOL FOR THE DEAF AND IMMEDIATELY ADJACENT TO THE EDGE OF GUTTER.

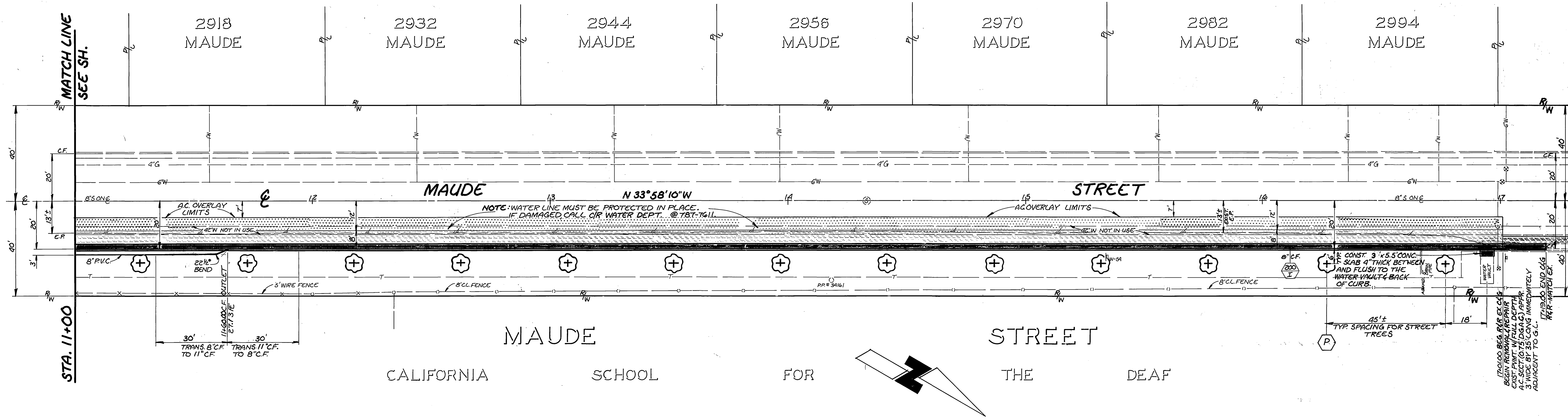
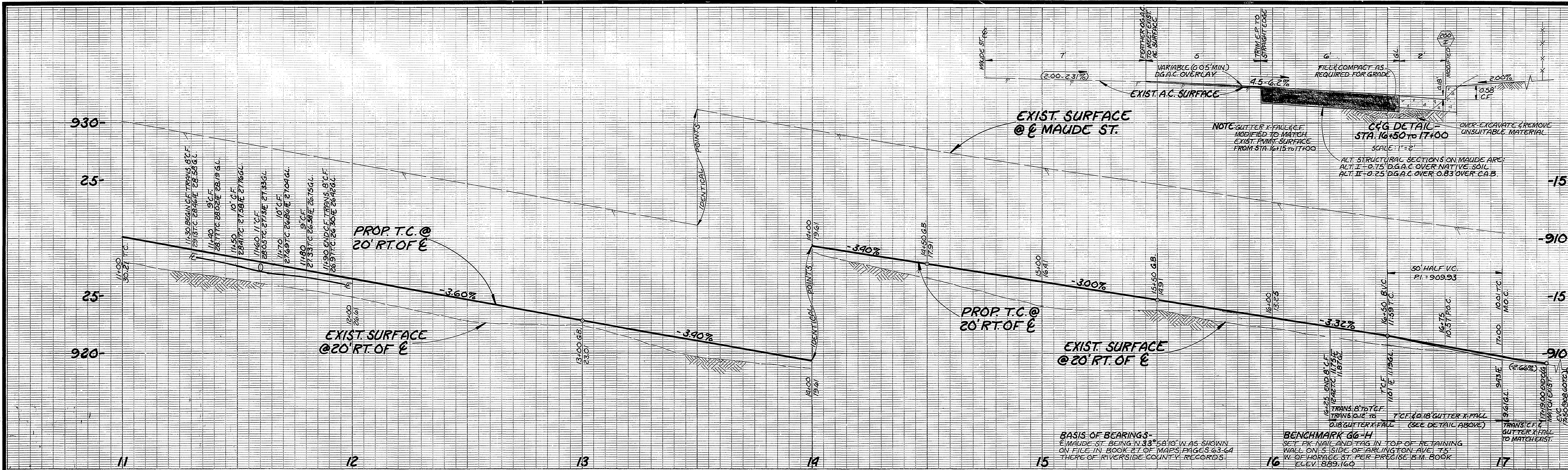

Underground Service Alert
 approved by: *[Signature]*
 Call: TOLL FREE
 1-800
 422-4133
 TWO WORKING DAYS BEFORE YOU DIG

CITY OF RIVERSIDE
 PUBLIC WORKS DEPARTMENT
 APPROVED BY: *[Signature]*
 DATE: 5-16-82
 PRINCIPAL ENGINEER: *[Signature]*
 PARK DEPARTMENT: *[Signature]*
 TRAFFIC DIVISION: *[Signature]*
 CHIEF P. W. INSPECTOR: *[Signature]*
 SURVEYOR: *[Signature]*

INDEXED D.A.
 ACCOUNT NO. 30-575-351-07
MAUDE STREET WIDENING
 MAUDE ST. FROM LINCOLN TO 200' ELY
 LINCOLN AVE. FROM MAUDE TO 200' ELY
R-2726
 SHEET 2 OF 2
 HORIZ. SCALE: 1" = 20'
 VERT. SCALE: 1" = 4'

B1630

02ALD-N01