

76
75
74

76
75
74

10

11

12

13

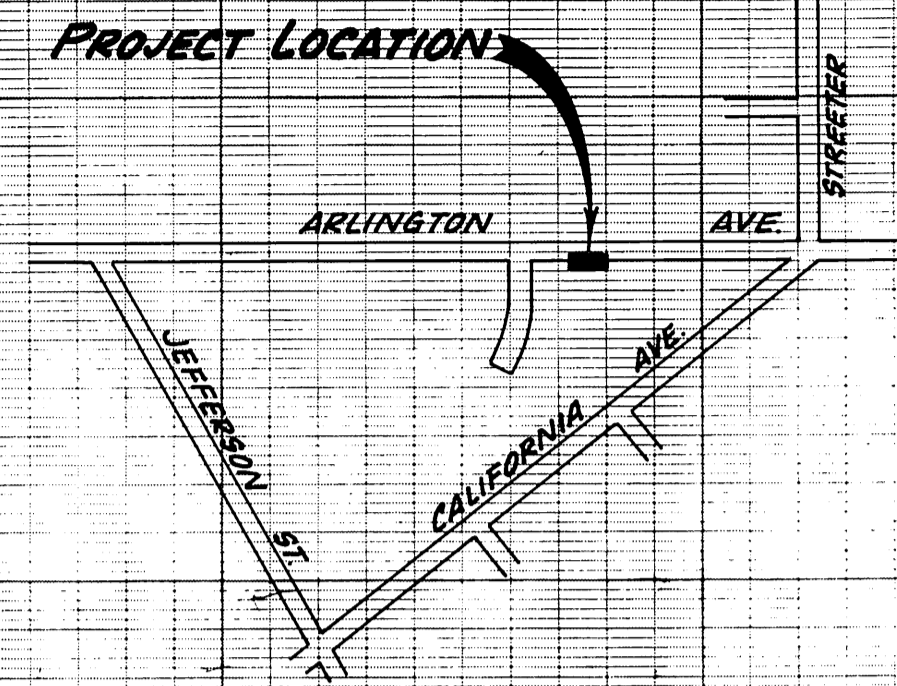

LOCATION MAP
N.T.S.

BENCH MARK

774.03 .. T.C. @ B.C.R. @ 10+45
PER PLAN R-1210

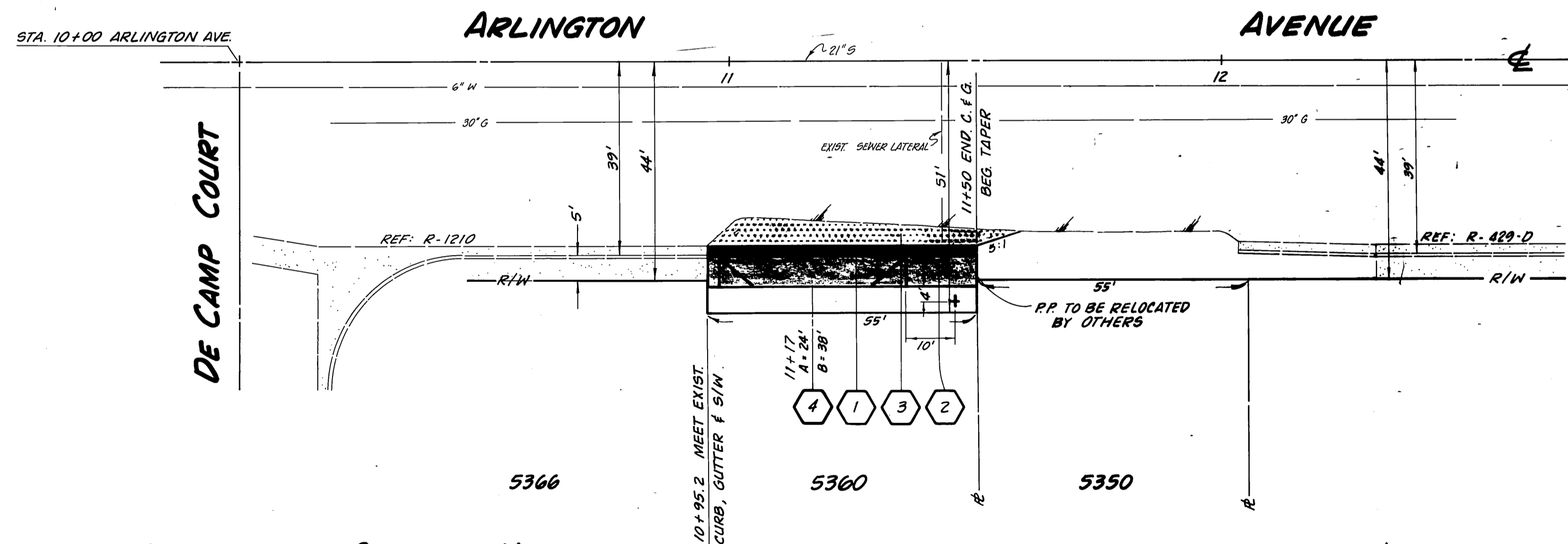

LANDSCAPING GENERAL NOTES

- ALL RELATED WORK SHALL CONFORM TO THE CITY OF RIVERSIDE, PARK AND RECREATION DEPT. STANDARDS.
- CONTACT THE PARK PROJECTS INSPECTOR A MIN. OF 2 WORKING DAYS IN ADVANCE AT 787-7223 TO SCHEDULE INSPECTIONS. INSPECTIONS SHALL BE REQUIRED:
 - WHEN TREE LOCATION HAS BEEN SPOTTED IN THE FIELD PRIOR TO DIGGING THE PIT.
 - WHILE DIGGING THE TREE PIT.
 - AFTER PLANTING AND ALL OTHER INDICATED OR SPECIFIED WORK HAS BEEN COMPLETED FOR START OF MAINTENANCE.
 - AT END OF MAINTENANCE/FINAL ACCEPTANCE (DEVELOPER WILL BE RELEASED FROM MAINTENANCE ONLY UPON RECEIPT OF WRITTEN NOTIFICATION FROM THE CITY THAT THE PARK AND RECREATION DEPT. IS ASSUMING MAINTENANCE RESPONSIBILITIES).
- THE DEVELOPER SHALL MAINTAIN ALL PLANTINGS FOR A MINIMUM PERIOD OF ONE (1) YEAR.
- THE STREET TREE SHALL BE MAGNOLIA GRANDIFLORA/ MAGNOLIA TREE, 15 GAL, LOCATED AS SHOWN WITH A "4".
- ALL STREET TREES TO BE AUTOMATICALLY IRRIGATED.

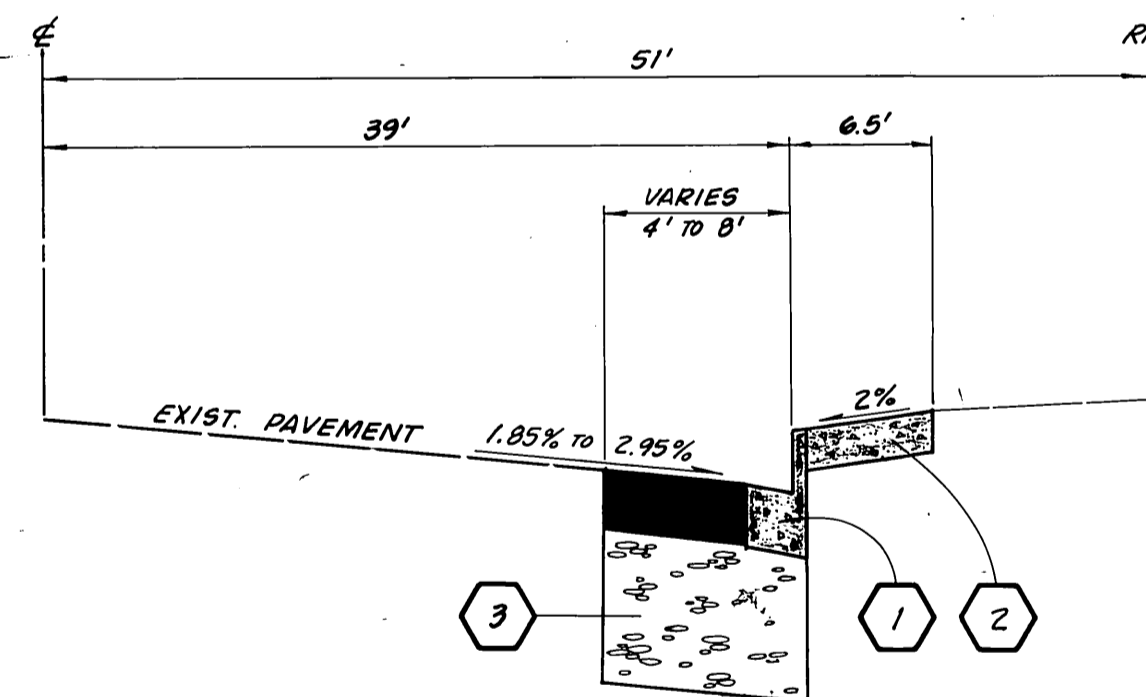

TYPICAL SECTION
ARLINGTON AVE.
NO SCALE
T.I. = 9

CITY TAX CERTIFICATE NO. 023977, UNTIL 8/87

GENERAL NOTES

- IT SHALL BE THE RESPONSIBILITY OF THE CONTRACTOR TO CLEAR THE RIGHT OF WAY IN ACCORDANCE WITH THE PROVISIONS OF LAW AS IT AFFECTS EACH UTILITY INCLUDING IRRIGATION LINES AND APPURTENANCES AND AT NO COST TO THE CITY.
- CONSTRUCTION SHALL BE ACCORDANCE WITH THE CITY OF RIVERSIDE, STANDARD DRAWINGS & STANDARD SPECS. FOR PUBLIC WORKS CONSTRUCTION 1985 EDITION.
- THE PRIVATE ENGINEER SIGNING THESE PLANS IS RESPONSIBLE FOR ASSURING THE ACCURACY & ACCEPTABILITY OF THE WORK HEREON. IN THE EVENT OF DISCREPANCIES ARISING DURING CONSTRUCTION, THE PRIVATE ENGINEER SHALL BE RESPONSIBLE FOR DETERMINING AN ACCEPTABLE SOLUTION & REVISING THE PLANS FOR APPROVAL BY THE CITY.
- TRIM EDGE OF EXIST. PAVEMENT WHERE NEW PAVEMENT JOINS TO A SMOOTH STRAIGHT LINE. CONST. MATCH UP PAVING AS SHOWN ON PLAN AND OVERLAY PAVING AS DIRECTED IN FIELD TO PRODUCE A SMOOTH SECTION.
- ANY TRAFFIC CONTROL STRIPING OBLITERATED AND/OR BADLY WORN DURING CONST. SHALL BE RESTORED BY THE CONTRACTOR WITHIN FIVE DAYS AFTER NOTIFICATION FROM THE CITY INSPECTORS.

CONSTRUCTION NOTES

- CONSTRUCT CURB & GUTTER AS PER STD. DWG. NO. 200. (TYPE I, 6" C.F.)
- CONSTRUCT CONC. SIDEWALK AS PER STD. DWG. NO. 325.
- CONSTRUCT .55' A.C. OVER .95' CLASS 2 BASE OR .90' FULL DEPTH A.C., PER R-1599
- CONSTRUCT CONC. DRIVEWAY APPROACH PER STD. DWG. NO. 304, A=24', B=38'.



CITY OF RIVERSIDE
PUBLIC UTILITIES ELECTRIC
John Johnson
ELECTRICAL ENGINEER
DATE 8/12/86

CHARLES W. STEVENS
REGISTERED CIVIL ENGINEER
15950 WINTERS LN., RIVERSIDE, CA. 92504
DATE 8/12/86

MARK	REVISIONS	APPR.	DATE

CITY OF RIVERSIDE PUBLIC WORKS DEPARTMENT			
APPROVED BY	DATE	BY	DATE
PRINCIPAL ENGINEER	08/12/86	W.D.	9/5/86
PARK DEPARTMENT	8-12-86	W.D.	8-12-86
TRAFFIC DIVISION	8-14-86	W.D.	8-14-86
CHIEF P.W. ENGINEER	9/5/86	W.D.	9/5/86

STREET IMPROVEMENTS FOR
R-41-856
(5360 ARLINGTON AVE.)
95' TO 231' EASTERLY OF DE CAMP COURT

INDEXED P&C CD.
ACCOUNT NO.
R-2801
SHEET 1 OF 1

HORIZ. SCALE: 1" = 20' VERT. SCALE: 1" = 2'