

RIVERSIDE CITY OF RIVERSIDE CALIFORNIA



PUBLIC WORKS DEPARTMENT

CHICAGO AVENUE WIDENING

500' ± S'LY OF MASSACHUSETTS TO 200' ± N'LY OF MASSACHUSETTS

CONSTRUCTION LEGEND



1 CONST. STRUCTURAL SECTION OF 4" DGAC OVER 4" CRUSHED AGGREGATE BASE.

2 OVERLAY EX. A.C. WITH A VARIABLE THICKNESS OF DGAC (0.03' - 0.30')

CONSTRUCT A.C. DRIVEWAY APPROACH AND SIDEWALK PER PLANS AND DETAILS. (2 1/2" THICK)

CONSTRUCT P.C.C. IMPROVEMENTS PER PLANS AND STD. DWGS.

EXISTING UNDERGROUND & TOPOGRAPHY LEGEND

EXISTING UNDERGROUND UTILITIES:

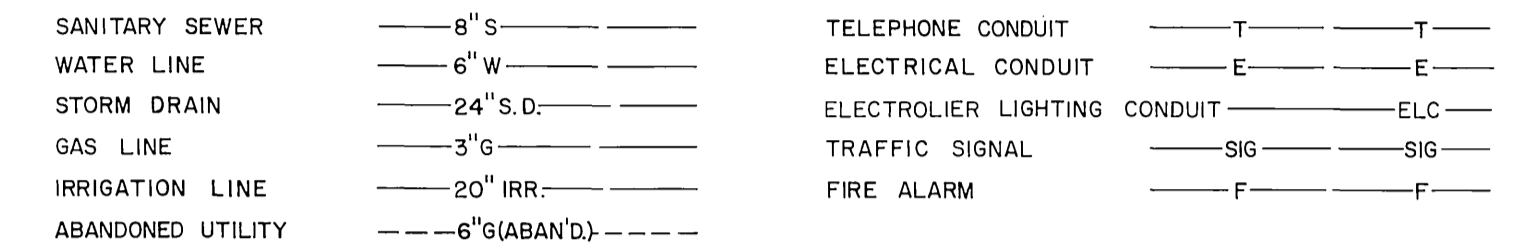

EXISTING TOPOGRAPHY:



SPECIFIC CONSTRUCTION NOTES

- NUMBERS ABOVE 100 IN A HEXAGON ON THE PLAN REFER TO THE RESPECTIVE STANDARD DRAWING AND SHALL BE CONSTRUCTED ACCORDINGLY, UNLESS MODIFICATIONS ARE NOTED ON THE PLAN OR COVER SHEET BELOW. ANY NUMBER SHOWN BELOW THE STANDARD DRAWING NUMBER INDICATES THE SPECIFIC ALTERNATE TO BE CONSTRUCTED.
- W TO BE RELOCATED OR ADJUSTED TO GRADE BY PUBLIC UTILITIES, WATER DIVISION. CONTRACTOR SHALL PROTECT IN PLACE.
- E TO BE RELOCATED OR ADJUSTED TO GRADE BY PUBLIC UTILITIES, ELECTRIC DIVISION.
- T TO BE RELOCATED OR ADJUSTED TO GRADE BY TELEPHONE CO.
- ADJ TO BE ADJUSTED TO GRADE BY CONTRACTOR
- 10 RECONST. EX. DRIVEWAY PER DETAIL BELOW-RIGHT
- 11 RECONSTRUCT EX. STAIRWAY PER DETAIL @ RIGHT
- 12 REMOVE OR TRANSPLANT TREE. ALL RELATED WORK SHALL CONFORM TO THE CITY OF RIVERSIDE PARK & RECREATION DEPT. STANDARDS. CLASS I - 6" TO 18" DIA. CLASS II - 18" TO 36" DIA.
- R REMOVE EX. CMP.

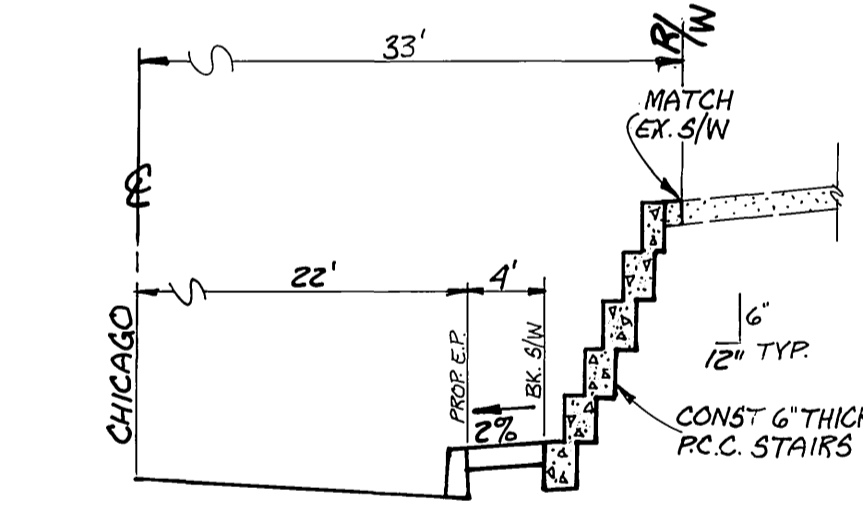

11 STAIR RECONST. DETAIL
SCALE: HORIZ. 1" = 10'
VERT. 1" = 2'

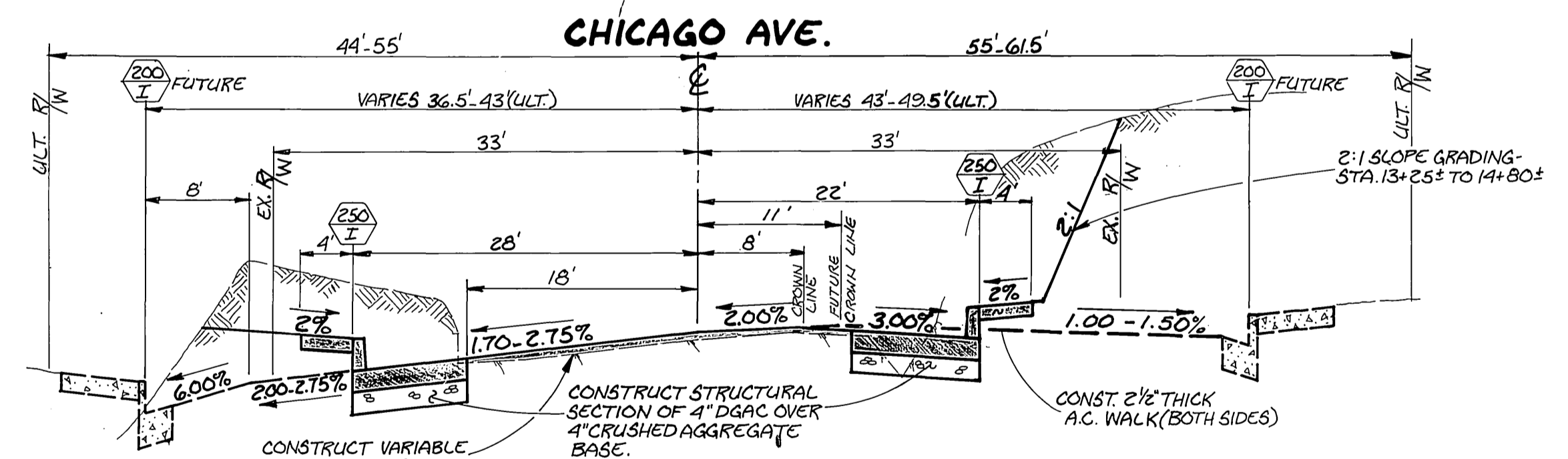
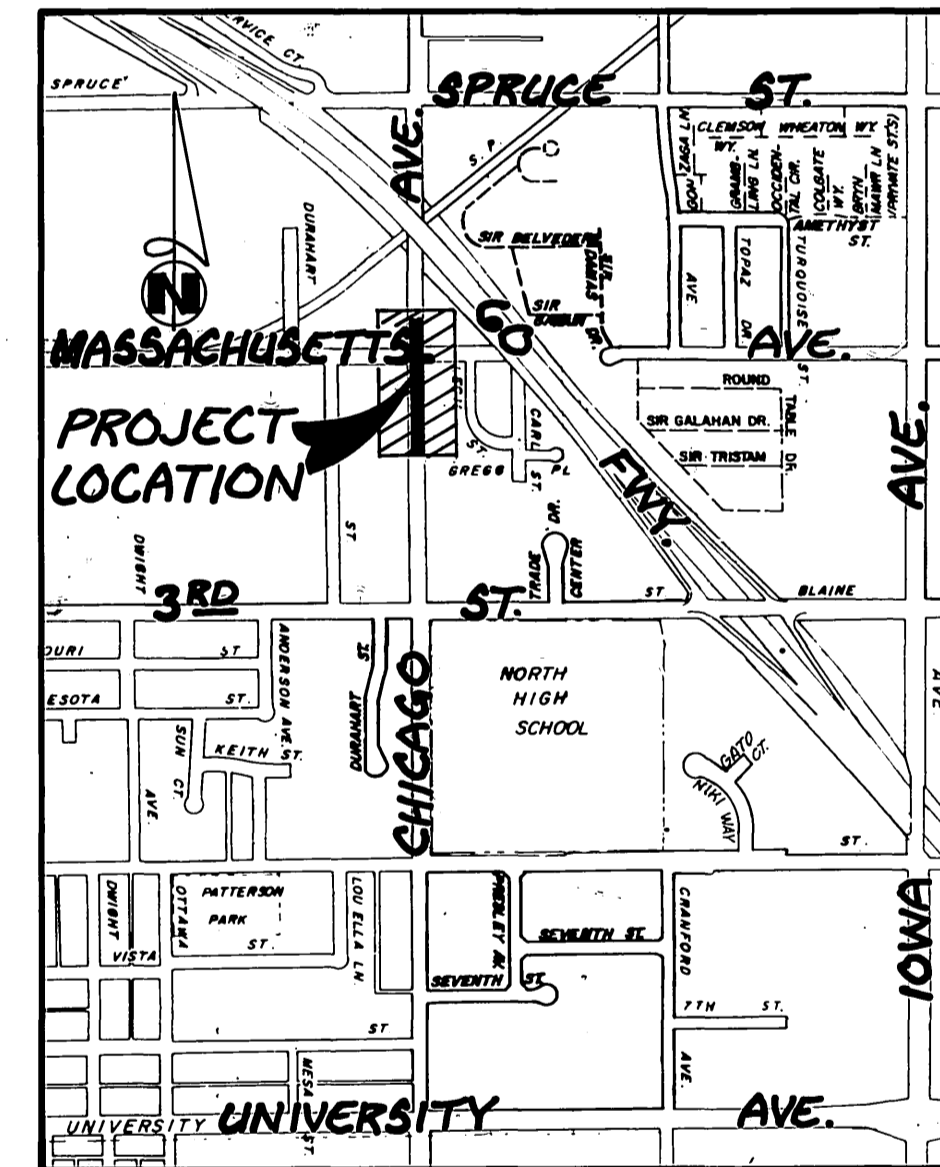

TYPICAL SECTION
STA. 12+50 ± TO STA. 16+50 ± LT. SIDE
STA. 11+40 ± TO STA. 14+80 ± RT. SIDE
SCALE: HORIZ. 1" = 10'
VERT. 1" = 2'

GENERAL CONSTRUCTION NOTES

- EXISTING UTILITIES SHOWN ON THIS PLAN ARE PLOTTED FROM UTILITY RECORDS. THE CONTRACTOR IS REQUIRED TO TAKE DUE PRECAUTIONARY MEASURES TO LOCATE & PROTECT ALL UTILITIES WHETHER OR NOT SHOWN ON THIS PLAN. IF THE COVER OF A UTILITY IS KNOWN, IT IS SHOWN IN THE PROFILE. UTILITIES SHOWN IN THE PROFILE AS -E- INDICATES THAT THE COVER IS UNKNOWN, BUT THE UTILITY IS NOT EXPECTED TO CONFLICT WITH THE PROPOSED IMPROVEMENTS.
- ALL ELEVATIONS SHOWN ON THE PLAN SHALL BE STAKED IN THE FIELD.
- RIGHTS OF ENTRY HAVE BEEN OBTAINED FOR WORK SHOWN OUTSIDE OF CITY RIGHT OF WAY.
- CONFLICTING UTILITIES SHOWN WITHIN CONSTRUCTION AREA WILL BE RELOCATED PRIOR TO CONSTRUCTION.
- PRIME CONTRACTORS BIDDING THIS WORK SHALL HAVE A CLASS A OR C-12 LICENSE.
- SEE PLAN D-542 FOR RELATED STORM DRAIN CONSTRUCTION AND TREE REMOVAL/RELOCATION WORK.
- CONTRACTOR SHALL CONTACT P.U. WATER DIVISION @ 782-5824 A MINIMUM OF 48 HOURS PRIOR TO COMMENCING WITH ANY WATER METER ADJUSTMENT WORK TO SCHEDULE INSPECTION OF SAID WORK.

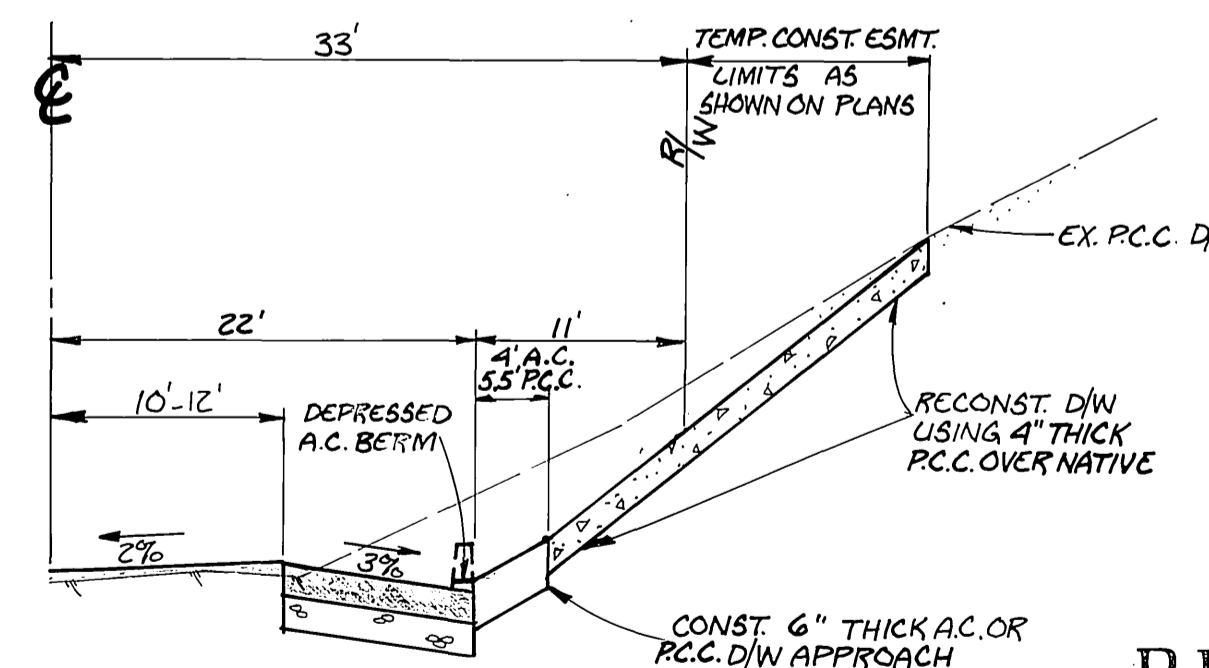

10 D/W RECONST. DETAIL
FOR D/W'S @ 11+52.61, 12+07.61,
12+75.91 & 16+20.20 ONLY
SCALE: HORIZ. 1" = 10'
VERT. 1" = 2'

PROJECT LOCATION PLAN

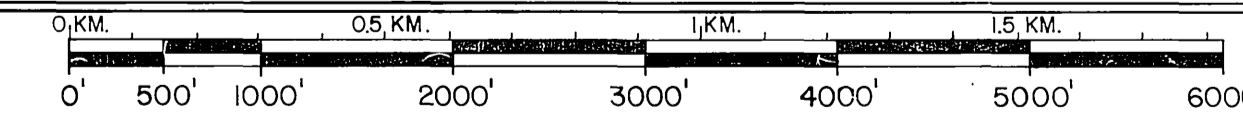

SCALE 1" = 1000'

Underground Service Alert
Call: TOLL FREE
1-800-422-4133
TWO WORKING DAYS BEFORE YOU DIG

ENGINEER IN RESPONSIBLE CHARGE
Ronald C. Mueller
RONALD C. MUELLER
RCE 29510 expires 3-31-91
DATE 8-3-88

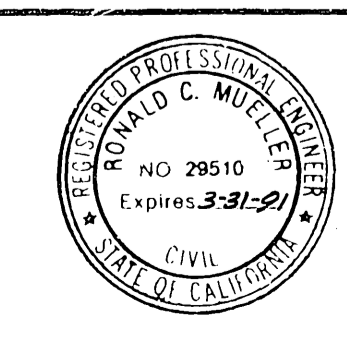

CITY OF RIVERSIDE PUBLIC WORKS DEPARTMENT
APPROVED BY: *Barry Bed*
PRINCIPAL ENGINEER
TRAFFIC DIVISION
DEPUTY P.W. DIRECTOR - ENG.
DATE 8/16/88

CHICAGO AVENUE WIDENING
500' ± S'LY OF MASSACHUSETTS TO 200' ± N'LY OF MASSACHUSETTS
DESIGNED BY: *SN* DRAWN BY: *RWZ* CHECKED BY: _____

ACCOUNT No. 30-575-394-07
DRAWING NUMBER
R-2832
SHEET 1 OF 3

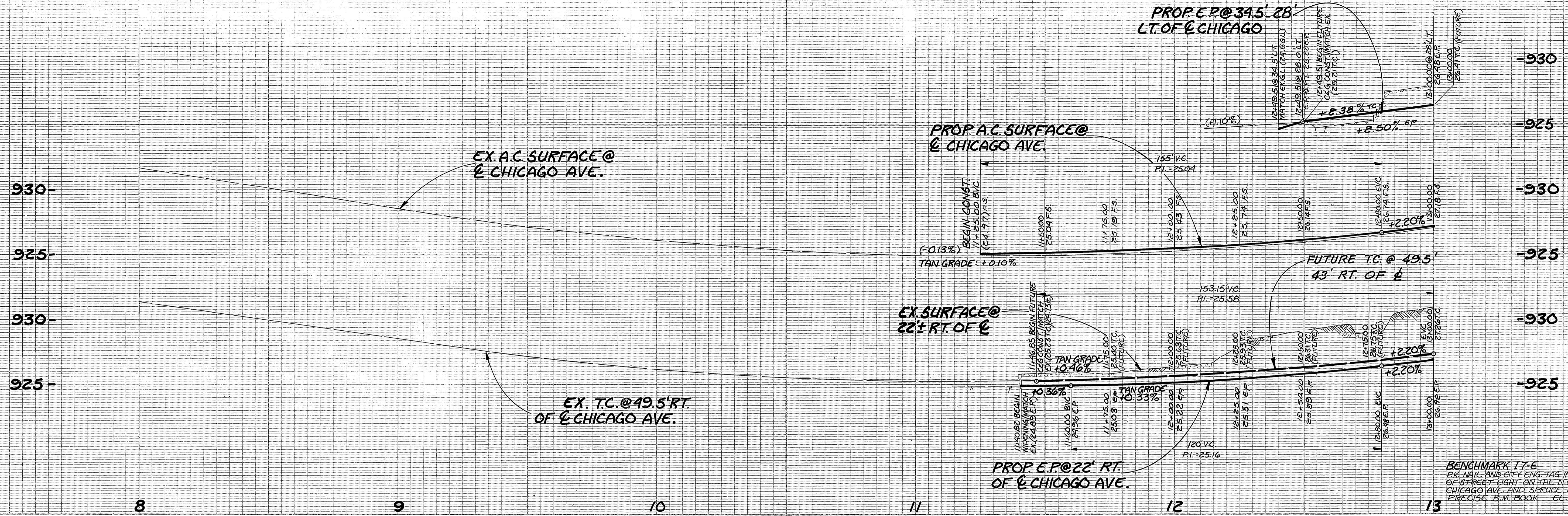

BENCHMARK I-7-C
 PK. NAIL AND CITY ENG. TAG IN CONC. BASE
 OF STREET LIGHT ON THE N.E. CORNER OF
 CHICAGO AVE AND SPRUCE ST. PER
 PRECISE B.M. BOOK - E.C. 310.3711

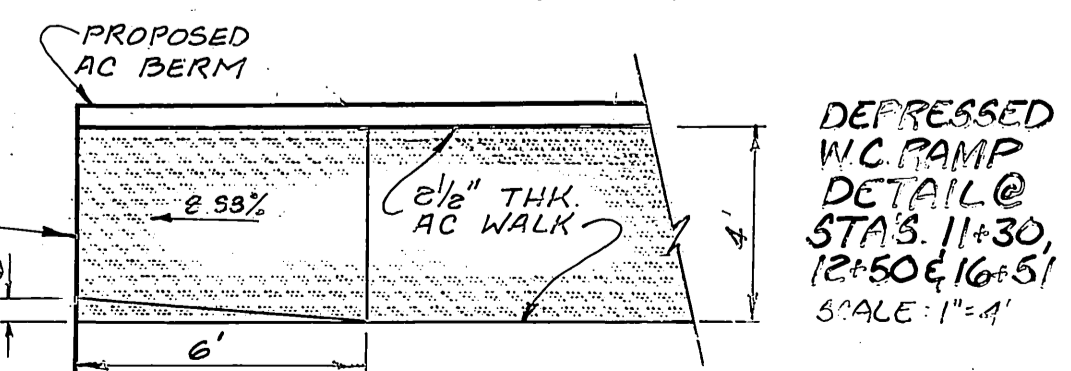
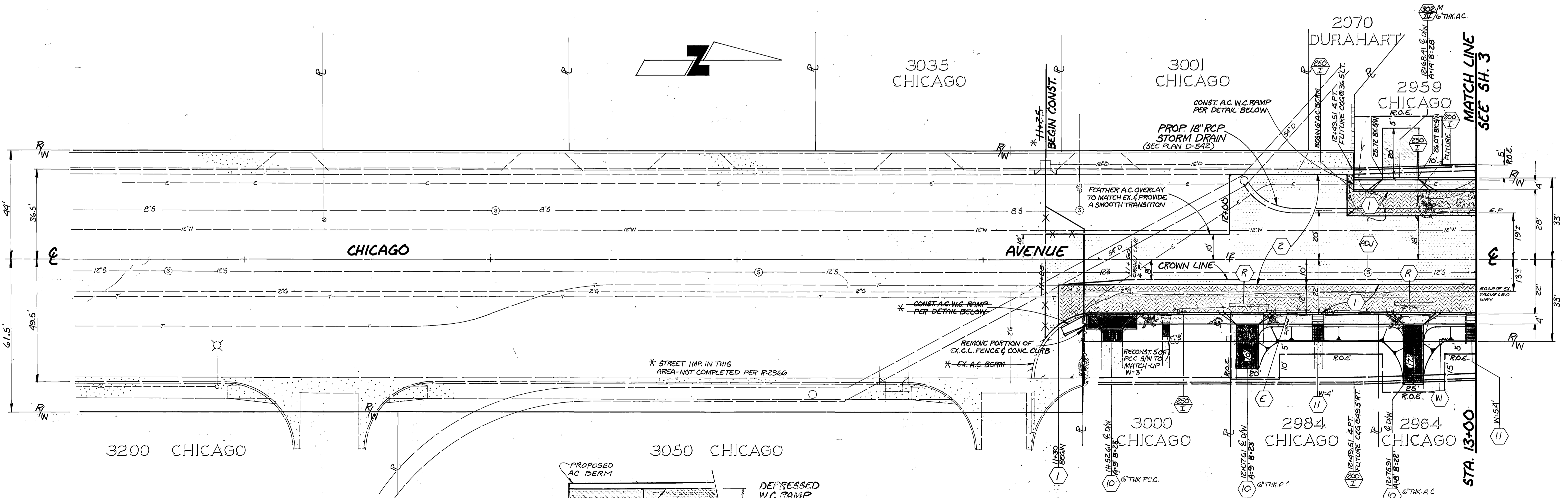

<p>*AS BUILT RVZ 140-89</p>		<p>CITY OF RIVERSIDE PUBLIC WORKS DEPARTMENT</p>		<p>CHICAGO AVENUE WIDENING</p>		<p>ACCOUNT NO. 30-575-394-07</p>	
<p>APPROVED BY: <i>[Signature]</i> DATE: 8/16/88</p>		<p>APPROVED BY: <i>[Signature]</i> DATE: 8/16/88</p>		<p>500' ± SLY OF MASSACHUSETTS TO 200' ± NLY OF MASSACHUSETTS</p>		<p>R-2832</p>	
<p>DESIGNED BY: SN DRAWN BY: EVZ CHECKED BY: [Signature]</p>		<p>DATE: 8/16/88</p>		<p>HORIZ. SCALE: 1" = 20' VERT. SCALE: 1" = 4'</p>		<p>SHEET 2 OF 3</p>	

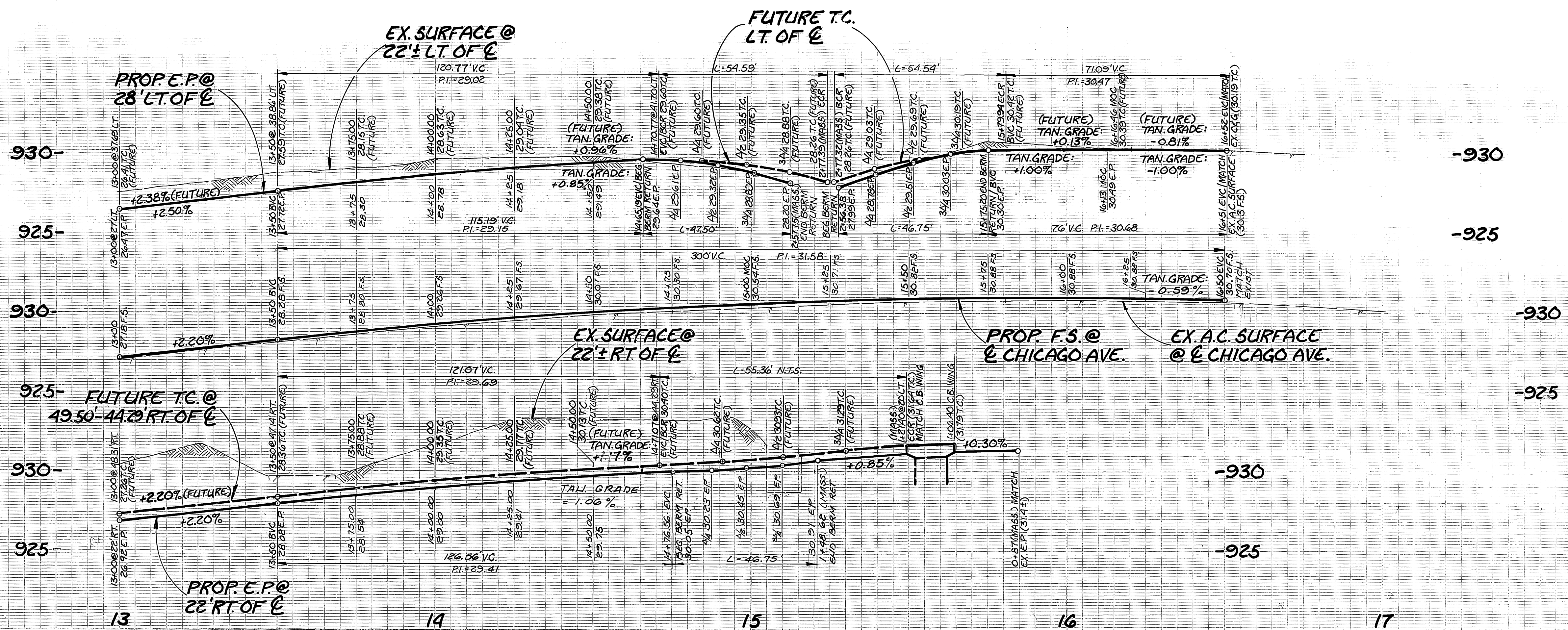

BENCHMARK IT-E
 P.K. NAIL AND CITY ENGR. TAG IN CONC.
 BASE OF STREET LIGHT ON THE N.E.
 CORNER OF CHICAGO AVE. AND SPRUCE ST.
 PER PRECISE B.M. BOOK CL-910.371

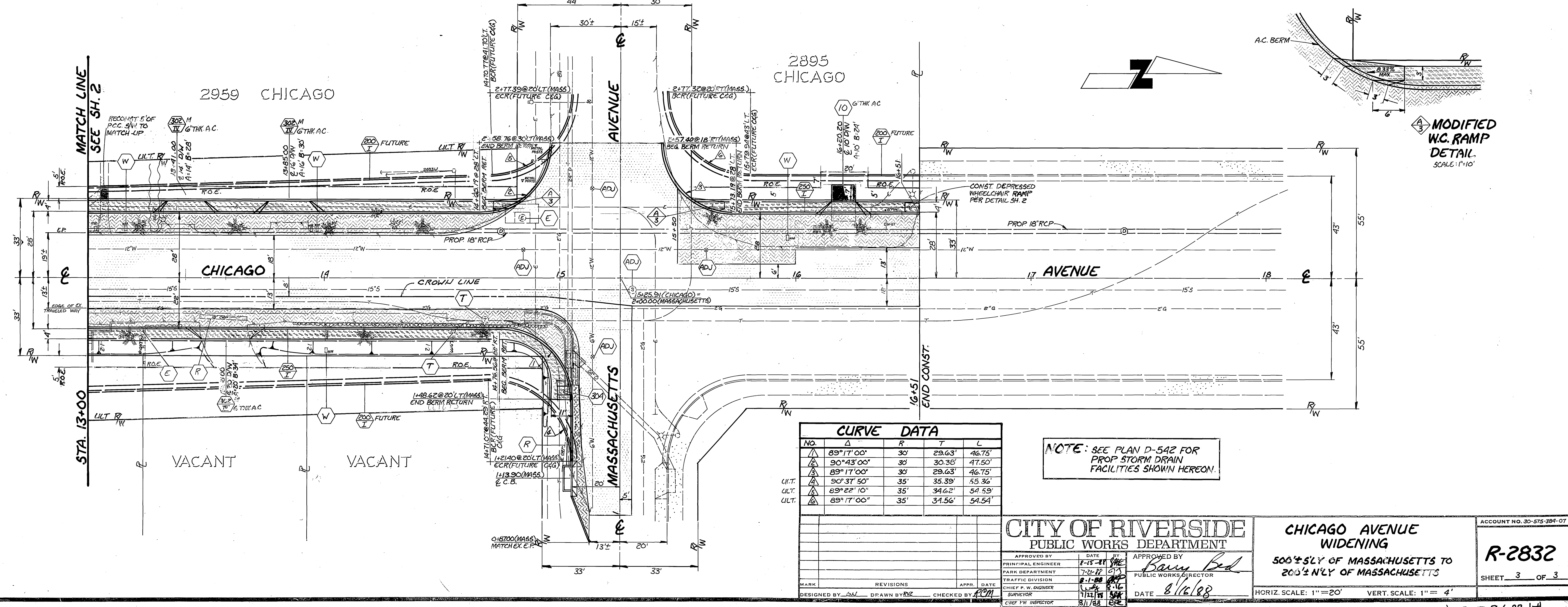

CURVE DATA				
NO.	Δ	R	T	L
▲	89°17'00"	30'	29.63'	46.75'
▲	90°43'00"	30'	30.38'	47.50'
▲	89°17'00"	30'	29.63'	46.75'
▲	90°37'50"	35'	35.39'	55.36'
▲	89°27'10"	35'	34.62'	54.59'
▲	89°17'00"	35'	34.56'	54.54'

NOTE: SEE PLAN D-542 FOR
 PROP. STORM DRAIN
 FACILITIES SHOWN HEREON.

CITY OF RIVERSIDE PUBLIC WORKS DEPARTMENT		CHICAGO AVENUE WIDENING 500'± SLY OF MASSACHUSETTS TO 200'± NLY OF MASSACHUSETTS		ACCOUNT NO. 30-575-394-07 R-2832 SHEET 3 OF 3
APPROVED BY PRINCIPAL ENGINEER PARK DEPARTMENT TRAFFIC DIVISION CHIEF P.W. ENGINEER SURVEYOR CHIEF P.W. INSPECTOR	DATE 8-15-81 7-29-81 8-1-81 7-21-81 8/1/88	APPROVED BY <i>Barry Bed</i> PUBLIC WORKS DIRECTOR DATE 8/16/88	HORIZ. SCALE: 1" = 20' VERT. SCALE: 1" = 4'	