

GENERAL NOTES

- It shall be the responsibility of the contractor to clear the right of way in accordance with the provisions of law as it affects each utility including irrigation lines and appurtenances and at no cost to the City.
- Construction shall be in accordance with the City of Riverside Department of Public Works, Standard Drawings, Standard Drawing No. 10 and the Specifications for Public Works Construction, current edition.
- The private engineer signing these plans is responsible for assuring the accuracy and acceptability of the work hereon. In the event of discrepancies arising during construction, the private engineer shall be responsible for determining an acceptable solution and revising the plans for approval by the City.
- Quantities shown are for information only and the City of Riverside is not responsible for their accuracy.
- The developer shall be responsible for preserving or re-establishing and referencing survey monuments destroyed, disturbed or buried as a result of construction shown hereon.
- All flagged elevations shall be staked in the field by the private engineer.
- Trim edge of existing pavement where new pavement joins to a smooth, straight line. Construct match-up paving as shown on plan and overlay paving as directed in the field to produce a smooth section.
- On all areas within public right of way where the fill is one (1) foot or greater, a letter will be required from the soils engineer, certifying the compaction of the fill below subgrade, prior to issuance of the Construction Permit/Cut Sheets.
- All traffic signs shall be installed prior to opening the streets to traffic.
- Any traffic control striping obliterated and/or badly worn during construction shall be restored by the contractor within five days after notification from the City Inspectors.
- Final striping for traffic control and/or pavement marking to be the responsibility of the developer.
- The contractor shall call in a location request to Underground Service Alert (USA), Phone No. 1-800-422-4133, two working days before digging. No construction permit will be issued by the Public Works Department involving excavation for underground facilities unless the applicant has been provided and inquiry identification number by U.S.A.
- DEVELOPER TO GIVE CITY WATER FIVE (5) WORKING DAYS WRITTEN NOTICE PRIOR TO START OF CONSTRUCTION AND TO ALLOW CITY TEN (10) WORKING DAYS FOR COMPLETION OF WORK. (787-7611)

GENERAL NOTES FOR STREET TREES

- All related work shall conform to the City of Riverside, Park and Recreation Department Standards.
- Contact the Park Projects Inspector a minimum of 48 hours in advance at 787-7223 to schedule inspections. Inspections shall be required:
 - When plant locations have been spotted in the field prior to digging plant pits.
 - While digging plant pits and planting/relocating trees.
 - After planting and all other indicated or specified work has been completed for start of maintenance.
 - At end of maintenance/final acceptance (contractor/developer will be released from maintenance only upon receipt of written notification from the city that the Park and Recreation Department is assuming maintenance responsibilities).
- The Contractor/Developer shall maintain all plantings for a minimum period of one (1) year.
- Street Tree planting shall be as follows:

Street Name	Botanical Name / Name	Common Name	Min. Size	Approx. Spacing	No. Req.
a. Mobley Ave.	Pyrus Calleryana / Pear	Bradford	15 Gal	45'	2
- Park and Recreation Department and Public Works Department permits are required prior to commencement of tree relocation and/or removal work. For all trees within the ultimate pavement area, backfill of all holes to be inspected by the City for proper compaction.

CONSTRUCTION NOTES

- CONSTRUCT 6" CURB & GUTTER PER CITY OF RIVERSIDE STD. DWG. NO. 200 TYPE I
- CONSTRUCT A.C. PAVING PER TYPICAL SECTION
- CONSTRUCT 20' DRIVEWAY PER CITY OF RIVERSIDE STD. DWG. NO. 302 "A-20" B-27
- CONSTRUCT SIDEWALK PER CITY OF RIVERSIDE STD. DWG. NO. 325
- PLANT STREET TREES TO THE SPECIFICATIONS OF THE PARK AND RECREATION DEPARTMENT

ESTIMATE OF QUANTITIES

(FOR BOND PURPOSES ONLY)

ASPHALT CONCRETE	274 SF
AGGREGATE BASE	274 SF
DRIVEWAY APPROACH	1EA.
SIDEWALK	420 SF
6" CURB & GUTTER	71 LF

LEGEND

- TC TOP OF CURB
- EL FLOWLINE
- AC ASPHALT CONCRETE
- EDGE OF PAVING
- EXISTING ELEVATION
- NEW A.C. PAVING
- + STREET TREE

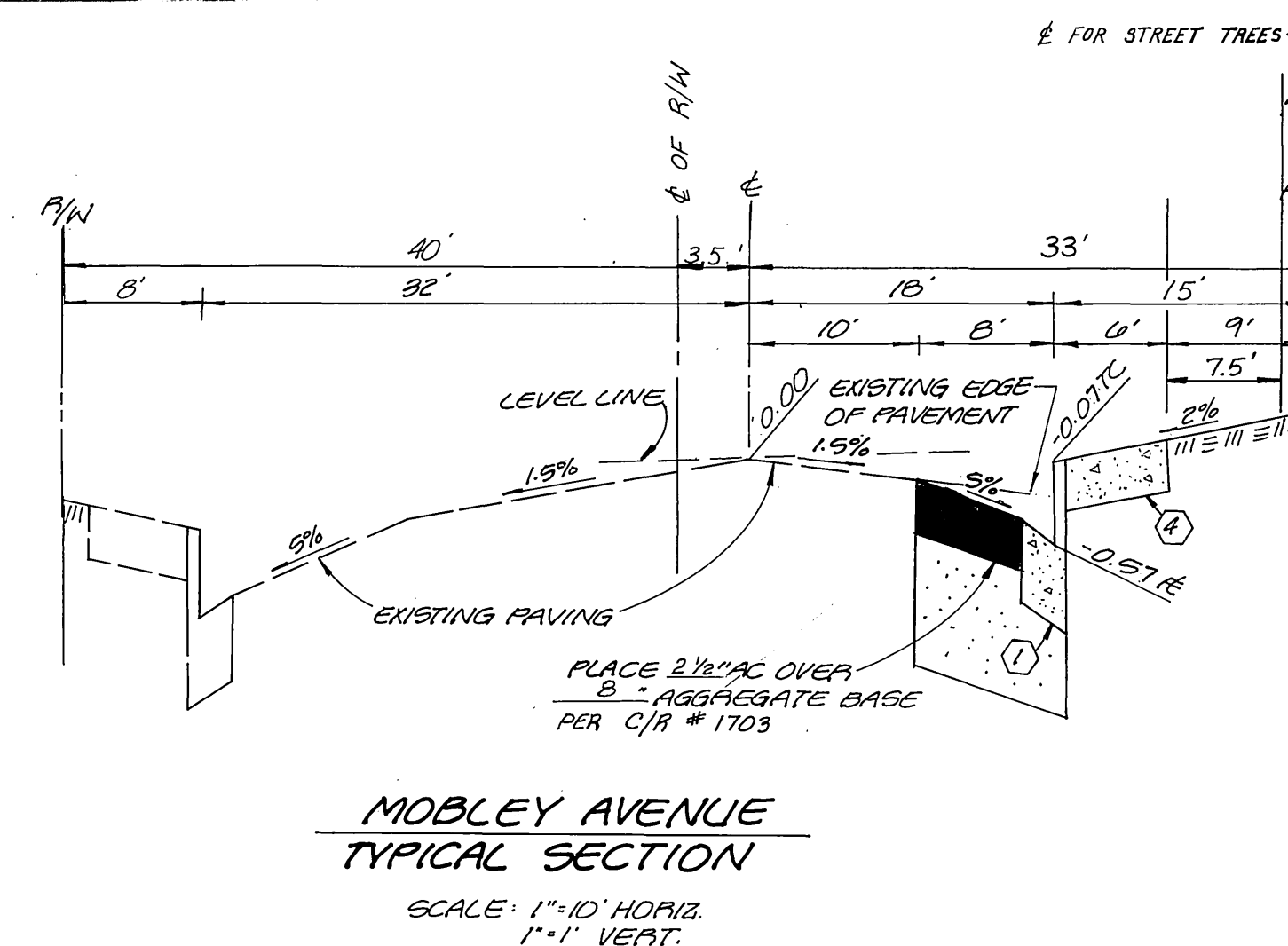
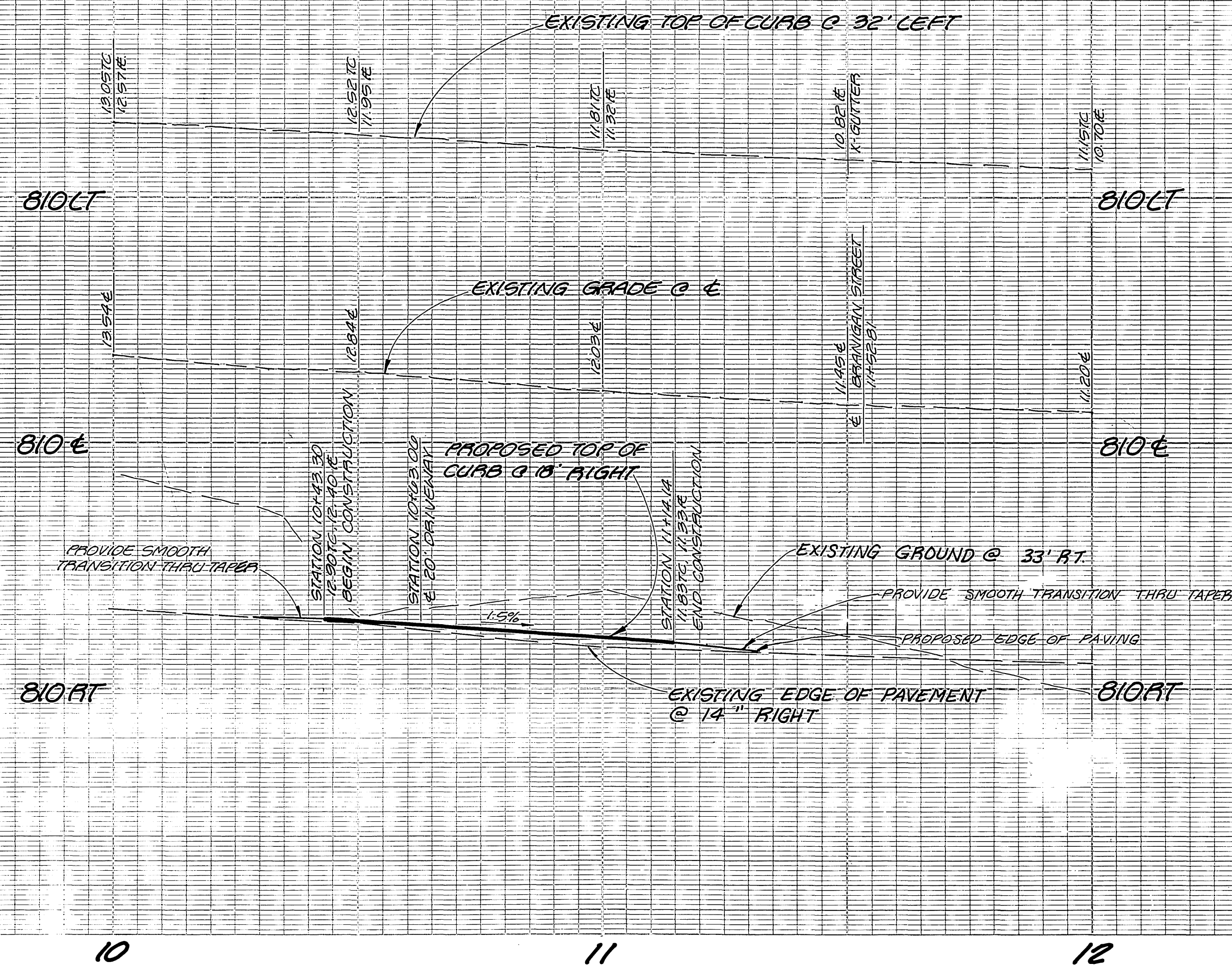

MOBLEY AVENUE
TYPICAL SECTION

SCALE: 1"=10' HORIZ.
1"=1' VERT.

VICINITY MAP

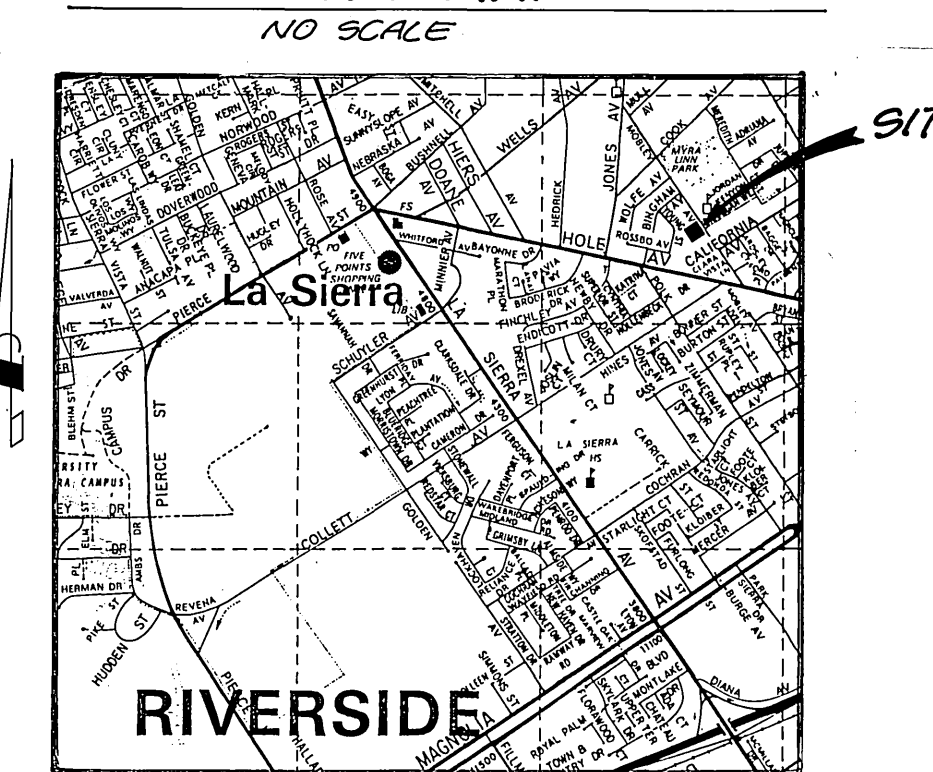

SITE

UNDERGROUND UTILITY NOTES:

- Locations of substructures as shown on plans are shown from the best available information, however, such locations as shown or failure to show existing substructures shall not relieve the contractors from the responsibility of verifying the location and protecting all substructures.
- It shall be the responsibility of the contractor to contact and make necessary arrangements with the appropriate utility companies prior to the beginning of construction.
- Contractor shall notify Underground Service Alert at least two days prior to construction. Phone: 800-422-4133.

Contractor agrees that he shall assume sole and complete responsibility for job site conditions during the course of construction of this Project, including safety of all persons and property; that this requirement shall apply continuously and not be limited to normal working hours; and that the Contractor shall defend, indemnify and hold the Owner and the Engineer harmless from any and all liability, real or alleged, in connection with the performance of work on this Project, excepting for liability arising from the sole negligence of the Owner or the Engineer.



PREPARED UNDER THE DIRECTION OF:
Robert S. Kippner
REGISTERED CIVIL ENGINEER NO. 13634
EXPIRATION DATE: MARCH 31, 1992 DATE: Aug. 23, 1986

J F DAVIDSON ASSOCIATES, INC.
CIVIL ENGINEERS • SURVEYORS • PLANNERS

P.O. BOX 493 11200 SO. MT. VERNON AVE., #D 73-080 EL PASO, #103
RIVERSIDE, CA 92502 COLTON, CA 92324 PALM DESERT, CA 92260
(714) 686-0844 (714) 825-1082 (619) 346-5691

SCALE: HORIZ: 1"=20'
VERT: 1"=4'
DATE: JULY 1986

BENCH MARK: FOUND BRASS DISC STAMPED P3-A, CAPPED AT THE INTERSECTION OF WELLS AVENUE & TYLER STREET. P3 720.12
P3-A ELEVATION 749.491

MARK	REVISIONS	APPR. DATE
1	EXISTING SEWER LINE	3/10/87
2	PROPOSED SEWER LINE	3/10/87

DESIGNED BY: MA DRAWN BY: CE CHECKED BY: MA

CITY OF RIVERSIDE, CALIFORNIA
DEPARTMENT OF PUBLIC WORKS

APPROVED BY: [Signature] DATE: 2-24-87
PRINCIPAL ENGINEER
PARK DEPARTMENT
TRAFFIC DIVISION

APPROVED BY: [Signature] DATE: 2-24-87
DIRECTOR OF PUBLIC WORKS

STREET PLAN & PROFILE
MOBLEY AVENUE
STA 10+43.30 TO STA 11+14.14
BUILDING PERMIT: 6420 MOBLEY AVENUE
(ACROSS BRANIGAN AVENUE ±) DWG. 35-856

HORIZ. SCALE: 1"=20'
VERT. SCALE: 1"=4'

INDEXED BY CD
PROJECT NO. R2840
SHEET 1 OF 1
FILE NO. 88-2878(1)