

PARKS DEPT - GENERAL NOTES

- 1- ALL RELATED WORK SHALL CONFORM TO THE CITY OF RIVERSIDE, PARK AND RECREATION DEPARTMENT STANDARDS.
- 2- CONTACT THE PARK PROJECTS INSPECTOR A MINIMUM OF 48 HOURS IN ADVANCE AT 787-7223 TO SCHEDULE INSPECTIONS. INSPECTIONS SHALL BE REQUIRED: A) WHEN PLANT LOCATIONS HAVE BEEN SPOTTED IN THE FIELD PRIOR TO DIGGING PLANT PITS; B) WHILE DIGGING PLANT PITS AND PLANTING/RELOCATING TREES; C) AFTER PLANTING AND ALL OTHER INDICATED OR SPECIFIED WORK HAS BEEN COMPLETED FOR START OF MAINTENANCE; AND D) AT END OF MAINTENANCE. FINAL ACCEPTANCE THE DEVELOPER WILL BE RELEASED FROM MAINTENANCE ONLY UPON RECEIPT OF WRITTEN NOTIFICATION FROM THE CITY THAT THE PARK AND RECREATION DEPARTMENT IS ASSUMING MAINTENANCE RESPONSIBILITIES.
- 3- THE DEVELOPER SHALL MAINTAIN ALL PLANTINGS FOR A MINIMUM PERIOD OF ONE (1) YEAR.
- 4- PUBLIC WORKS AND PARK AND RECREATION DEPARTMENT PERMITS ARE REQUIRED PRIOR TO COMMENCEMENT OF TREE RELOCATION AND/OR REMOVAL WORK FOR ALL TREES WITHIN THE ULTIMATE PAVEMENT AREA. BACKLOG OF ALL HOLES IS TO BE INSPECTED BY THE CITY FOR PROPER COMPLETION.
- 5- STREET TREE PLANTING SHALL BE AS FOLLOWS:
STREET NAME BOTANICAL / COMMON NAME MIN APPROX NO.
INDIANA AVE, BRAHEA EDULIS / ADAPALUM, 4' x 1/2", 45', 5, PALM, BEN.
- 6- ALL STREET TREES TO BE AUTOMATICALLY IRRIGATED.

GENERAL NOTES

- 1- IT SHALL BE THE RESPONSIBILITY OF THE CONTRACTOR TO CLEAR THE RIGHT OF WAY IN ACCORDANCE WITH THE PROVISIONS OF LAW AS IT AFFECTS EACH UTILITY INCLUDING IRRIGATION LINES AND APPURTENANCES AND AT NO COST TO THE CITY.
- 2- CONSTRUCTION SHALL BE IN ACCORDANCE WITH THE CITY OF RIVERSIDE DEPARTMENT OF PUBLIC WORKS STANDARD DRAWINGS, STANDARD DRAWING 100-10 AND THE STANDARD SPECIFICATIONS FOR PUBLIC WORKS CONSTRUCTION, CURRENT EDITION.
- 3- TRIM EDGE OF EXISTING PAVEMENT WHERE NEW PAVEMENT JOINS TO A SMOOTH STRAIGHT LINE. CONSTRUCT MATCH-UP PAVING AS SHOWN ON PLAN AND OVERLAY PAVING AS DIRECTED IN THE FIELD TO PRODUCE A SMOOTH SECTION.
- 4- CONSTRUCT DRIVEWAY APPROACHES PER STD. DWG. NO. 302 EXACT SIZE AND LOCATION AS SHOWN.
- 5- CURB AND GUTTER SHALL BE STAKED WITH 3' OFFSETS AT 25' INTERVALS.
- 6- ALL TRAFFIC SIGNS SHALL BE INSTALLED PRIOR TO OPENING THE STREETS TO TRAFFIC.
- 7- ANY TRAFFIC CONTROL STRIPING OBLITERATED AND/OR BADLY WORN DURING CONSTRUCTION SHALL BE REPAIRED BY THE CONTRACTOR WITHIN 5 DAYS AFTER NOTIFICATION FROM THE CITY INSPECTOR.
- 8- FINAL STRIPING FOR TRAFFIC CONTROL AND/OR PAVEMENT MARKING TO BE THE RESPONSIBILITY OF THE DEVELOPER.
- 9- IN ORDER TO COORDINATE THE CITY'S PORTION OF THE WORK, THE DEVELOPER AND/OR CONTRACTOR SHALL GIVE THE CITY 60 DAYS' NOTICE IN ORDER THAT THE DEVELOPER AND CITY'S WORK MAY BE INSTALLED CONCURRENTLY. THE DEVELOPER SHALL PREPARE AND CONTRACT WITH THE CITY SUBGRADE UNIT AND IS RESPONSIBLE FOR THE CONDITION OF THE SUBGRADE UNTIL ACCEPTED BY THE CITY AND UNTIL THE CITY'S CONTRACTOR STARTS WORKING. THE DEVELOPER IS ALSO RESPONSIBLE FOR OVERSIGHT DURING THIS TIME.
- 10- THE PRIVATE ENGINEER SIGNING THESE PLANS IS RESPONSIBLE FOR ASSURING THE ACCURACY AND ACCEPTABILITY OF THE WORK HEREIN. IN THE EVENT OF DISCREPANCIES ARISING DURING CONSTRUCTION, THE PRIVATE ENGINEER SHALL BE RESPONSIBLE FOR DETERMINING AN ACCEPTABLE SOLUTION AND REVISING THE PLANS FOR APPROVAL BY THE CITY.
- 11- THE CONTRACTOR SHALL CALL IN A LOCATION REQUEST TO UNDERGROUND SERVICE ALERT (USA), PHONE NO. 1-800-422-4133, 2 WORKING DAYS BEFORE DIGGING. NO CONSTRUCTION PERMIT WILL BE ISSUED BY THE PUBLIC WORKS DEPARTMENT UNLESS THE LOCATION REQUEST FOR UNDERGROUND FACILITIES UNLESS THE APPLICANT HAS BEEN PROVIDED AN INDUSTRY IDENTIFICATION NUMBER BY USA.
- 12- ALL FLAGGED ELEVATIONS SHALL BE STAKED IN THE FIELD BY THE PRIVATE ENGINEER.
- 13- THE DEVELOPER SHALL BE RESPONSIBLE FOR PRESERVING OR RE-ESTABLISHING AND REFERENCING SURVEY MONUMENTS DESTROYED, DISTURBED OR BURIED AS A RESULT OF CONSTRUCTION SHOWN HEREIN.
- 14- ON ALL AREAS WITHIN PUBLIC RIGHT OF WAY WHERE THE FULL IN ONE (1) FOOT OR GREATER, A LETTER WILL BE REQUIRED FROM THE SOILS ENGINEER, CERTIFYING THE COMPACTNESS OF THE FULL BEDDING SUBGRADE PRIOR TO ISSUANCE OF THE CONSTRUCTION PERMIT/UT SHEETS.
- 15- DEVELOPER TO GIVE CITY WATER DIVISION FIVE (5) WORKING DAYS WRITTEN NOTICE PRIOR TO START OF CONSTRUCTION AND TO ALLOW CITY TEN (10) WORKING DAYS FOR COMPLETION OF WORK - (787-7811)

CONSTRUCTION NOTES

- 1- CONSTRUCT STANDARD 200, CURB AND GUTTER (8" C.E.) TYPE I.
- 2- CONSTRUCT STANDARD 325, CURB SIDEWALK.
- 3- CONSTRUCT 4 1/2" AC PAVEMENT OVER COMPACTED NATIVE MATERIAL PER S.E. 913, 2'-6" G.
- 4- PLANT STREET TREES TO THE SPECIFICATIONS OF THE PARK AND RECREATION DEPARTMENT, LOCATION SHOWN BY +.
- 5- REMOVE EXISTING C&G, S/W, D/W, ETC.
- 6- CONSTRUCT DRIVEWAY PER STD. 302.
- 7- CONSTRUCT VARIABLE AC OVERLAY WHERE SHOWN.

NOTICE TO CONTRACTOR

- 1- THE EXISTENCE AND LOCATION OF ANY UNDERGROUND UTILITY PIPES OR STRUCTURES SHOWN ON THESE PLANS ARE OBTAINED BY A SEARCH OF THE AVAILABLE RECORDS TO THE BEST OF OUR KNOWLEDGE. THERE ARE NO EXISTING UTILITIES EXCEPT THOSE SHOWN ON THESE PLANS.
- 2- THE CONTRACTOR IS REQUIRED TO TAKE DUE PRECAUTIONARY MEASURES TO PROTECT THE UTILITY LINES SHOWN AND ANY OTHER LINES NOT OF RECORD OR NOT SHOWN ON THESE PLANS.
- 3- CALL UNDERGROUND SERVICE ALERT (USA) 1-800-422-4133 AT LEAST 48 HOURS PRIOR TO EXCAVATION.

* As built 2-3-89
INDEXED 4-15-88 LHH

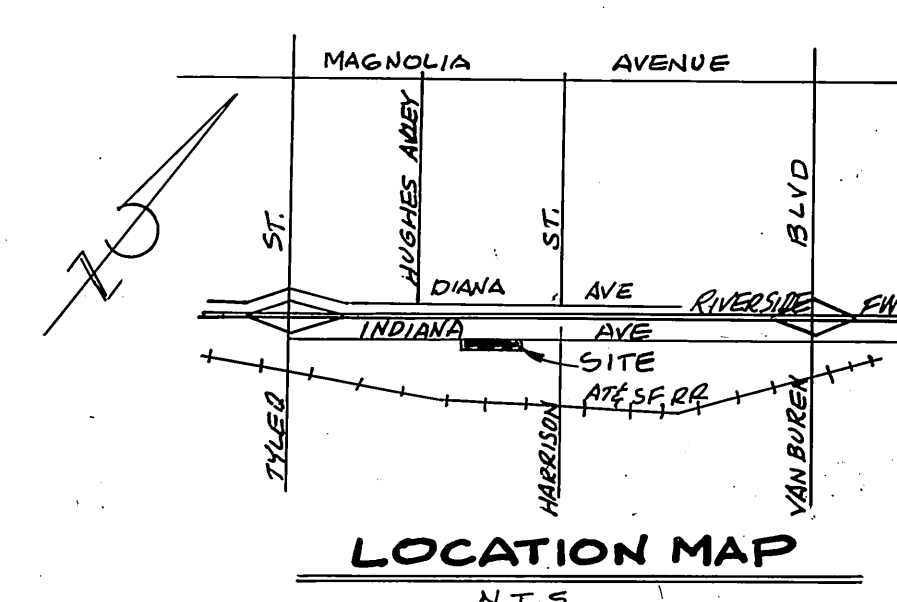

PACIFIC TELEPHONE
Reviewed by *Red W...* 12/23/86
CITY OF RIVERSIDE - PUBLIC UTILITIES
ELECTRIC
Reviewed by *John Johnson* 12/23/86
CITY OF RIVERSIDE WATER SYSTEM
Reviewed by *Carl A. ...* 2/2/88

ESGATE ENGINEERING SERVICES
CIVIL ENGINEERING
5355 KENDALL ST., RIVERSIDE, CALIFORNIA 92506
(714) 781-9626
BRIAN & ESGATE - REG. 21884
DATE 9/4/86

BENCH MARK ELEV = 780.012
BRONZE DISK IN CONCRETE
POST ON E. OF HARRISON ST.
137.5' NORTHWEST OF INDIANA AVENUE
GIR BM # 601-24-68

DESIGNED BY	DRAWN BY	CHECKED BY
REVISIONS	APPR. DATE	
MARK		

CITY OF RIVERSIDE
PUBLIC WORKS DEPARTMENT
APPROVED BY *Bruce Paul* 2/23/88
DATE 2/23/88

STREET PLAN & PROFILE
INDIANA AVENUE
SOUTH SIDE
STA 19+93.78 TO STA 23+12.00
WLY OF HARRISON STREET
FOR MP-B-789
HORIZ. SCALE: 1" = 40'
VERT. SCALE: 1" = 4'
ACCOUNT NO. **R-2864**
SHEET **1** OF **1**
86-17