

PROFILE SCALE  
 HORIZ. 1" = 20'  
 VERT. 1" = 2'

**QUANTITY ESTIMATES**

- 65 CY EXCAVATION
- 75 LF 6" P.C.C. CURB & GUTTER PER STD. 200, TYPE I
- 500 SF P.C.C. SIDEWALK & DRIVEWAY PER STD. 325
- 81 SF P.C.C. DRIVEWAY APPROACH PER STD. 302, TYPE II
- 1936 SF 2 1/2" A.C. PVMT. OVER 4" CRUSHED AGGREGATE PER R-1945
- 3 EA. INSTALL TYPE 'F-1' FLEXIBLE DELINEATORS

Contractor agrees that he shall assume sole and complete responsibility for job site conditions during the course of construction of this Project, including safety of all persons and property; that this requirement shall apply continuously and not be limited to normal working hours; and that the Contractor shall defend, indemnify and hold the Owner and the Engineer harmless from any and all liability, real or alleged, in connection with the performance of work on this Project, excepting for liability arising from the sole negligence of the Owner or the Engineer.

**BENCH MARK**

CITY OF RIVERSIDE B.M. NO. J7-K ELEV. 813.234  
 P.K. NAIL AND TAG IN EAST C.B. OF MAIN STREET, 18' S. SOUTH OF B.C.R. AT COLUMBIA AVE. F.B. 847/16.

**GENERAL NOTES FOR PLAN CHECK**

1. All related work shall conform to the City of Riverside Park and Recreation Department Standards.
2. Contact the Street Tree Inspector a minimum of 48 hours in advance at 391-6126 to schedule inspection. Inspections shall be required:
  - a) When plant locations have been spotted in the field prior to digging plant pits.
  - b) While digging plant pits and planting/relocating trees.
  - c) After planting and all other indicated or specified work has been completed for start of maintenance.
  - d) At end of maintenance/visual acceptance (contractor/developer will be released from maintenance only upon receipt of written notification from the City that the Park and Recreation Department is assuming maintenance responsibilities).
3. The Contractor/Developer shall maintain all plantings for a minimum period of one (1) year.
4. Street Tree planting shall be as follows:
 

Street Name	Botanical Name/Common Name	Min. Approx. No.	Size	Spacing	Spec.
a. COLUMBIA	PIED	BRADFORD	19 GAL.	45'	2
	GALLERYANA	PEAR			
5. Park and Recreation Department and Public Works Department permits are required prior to commencement of tree relocation and/or removal work. For all trees within the ultimate pavement area, backfill of all holes is to be inspected by the City for proper compaction.

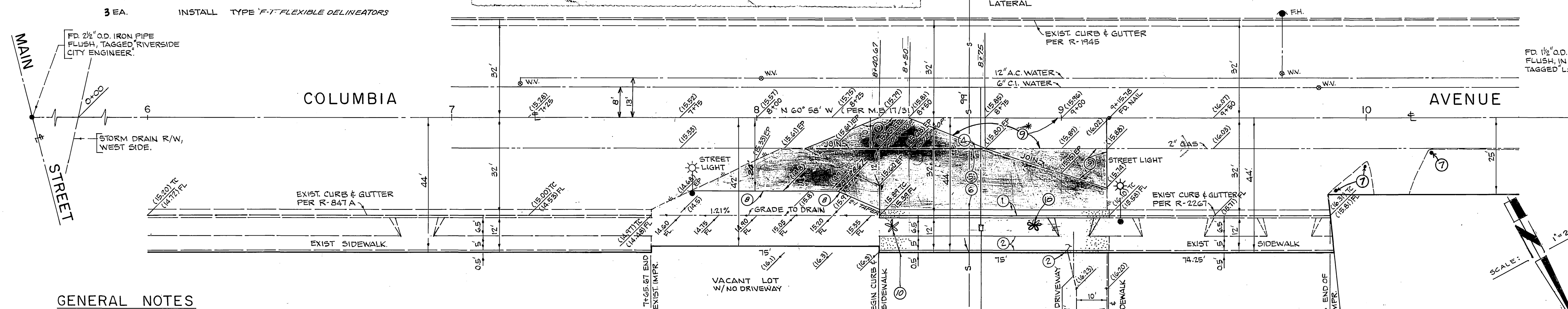

**GENERAL NOTES**

1. CONSTRUCTION SHALL BE IN ACCORDANCE WITH THE CITY OF RIVERSIDE DEPARTMENT OF PUBLIC WORKS, STANDARD DRAWINGS AND STAND. DRAW. NO. 10 AND THE STANDARD SPECIFICATIONS FOR PUBLIC WORKS CONSTRUCTION, CURRENT EDITION.
2. IT SHALL BE THE RESPONSIBILITY OF THE CONTRACTOR TO CLEAR THE RIGHT OF WAY IN ACCORDANCE WITH THE PROVISIONS OF LAW AS IT AFFECTS EACH UTILITY, INCLUDING IRRIGATION LINES AND APPURTENANCES AND AT NO COST TO THE CITY.
3. TRIM EDGE OF EXISTING PAVEMENT WHERE NEW PAVEMENT JOINS TO A SMOOTH STRAIGHT LINE. CONSTRUCT MATCH-UP PAVING AS SHOWN ON PLAN AND OVERLAY PAVING AS DIRECTED IN THE FIELD TO PRODUCE A SMOOTH SECTION.
4. CURB AND GUTTER SHALL BE STAKED WITH 3' OFFSETS AT 12.5' INTERVALS AND TWO ROWS OF NUMBER 3 REBAR SHALL BE PLACED IN GUTTER WHERE GRADE IS LESS THAN 0.40%. PLACE 3/4" DOWEL PINS AT ALL EXPANSION JOINTS.
5. QUANTITIES SHOWN ARE FOR INFORMATION ONLY AND THE CITY OF RIVERSIDE IS NOT RESPONSIBLE FOR THEIR ACCURACY.
6. ELEVATIONS SHOWN IN PARENTHESIS ARE EXISTING GRADES. ALL OTHERS ARE DESIGN GRADES, UNLESS OTHERWISE NOTED.
7. ALL FLAGGED ELEVATIONS FOR DESIGN GRADES SHALL BE STAKED IN THE FIELD BY THE PRIVATE ENGINEER.
8. THE PRIVATE ENGINEER SIGNING THESE PLANS IS RESPONSIBLE FOR ASSURING THE ACCURACY AND ACCEPTABILITY OF THE WORK HEREON. IN THE EVENT OF DISCREPANCIES ARISING DURING CONSTRUCTION AS A RESULT OF ERRORS OR OMISSIONS, THE PRIVATE ENGINEER SHALL BE RESPONSIBLE FOR DETERMINING AN ACCEPTABLE SOLUTION AND REVISING THE PLANS FOR APPROVAL BY THE CITY.
9. DEVELOPER TO GIVE CITY WATER DIVISION FIVE (5) WORKING DAYS WRITTEN NOTICE PRIOR TO START OF CONSTRUCTION AND TO ALLOW CITY TEN (10) WORKING DAYS FOR COMPLETION OF WORK. (351-6150)

**CONSTRUCTION LEGEND**

1. CONSTRUCT 6" P.C.C. CURB & GUTTER PER CITY STD. 200, TYPE I.
2. CONSTRUCT P.C.C. PROPERTY LINE SIDEWALK PER CITY STD. 325.
3. CONSTRUCT P.C.C. DRIVEWAY APPROACH PER CITY STD. 302, TYPE II.
4. SAW-CUT EXISTING PAVEMENT TO A SMOOTH STRAIGHT LINE.
5. CONSTRUCT 4" CRUSHED AGGREGATE BASE PER R-1945, R-160 PER SR. 941
6. CONSTRUCT 2 1/2" A.C. PAVEMENT.
7. INSTALL TYPE 'F-1' FLEXIBLE DELINEATORS
8. INSTALL 2"x4" REDWOOD HEADER
9. OVERLAY
10. PLANT STREET TREES TO SPECIFICATIONS OF THE PARK AND RECREATION DEPT.

**GENERAL NOTES CONTINUED**

10. The contractor shall call in a location request to Underground Service Alerts (USA), Phone No. 1-800-422-4133, two working days before digging. No construction permit will be issued by the Public Works Department involving excavation for underground facilities unless the applicant has been provided an inquiry identification number by U.S.A.
11. In residential areas 6" x 6" or 6" diameter blockouts for mailboxes are required in curb sidewalk 10' to 14' from curb face at the property line between adjacent residences. For mailboxes for business, mobilehome parks or apartment houses, developer to check with the U.S.P.S. for the number and location of mailboxes.
12. The private engineer preparing these plans shall be responsible for preserving or re-establishing and referencing survey monuments destroyed, disturbed or buried as a result of construction shown hereon.
13. On all areas within public right of way where the fill is one (1) foot or greater, a letter will be required from the soils engineer, certifying the compaction of the fill below subgrade, prior to issuance of the Construction Permit/Out Sheets.
14. Any traffic control striping obliterated and/or badly worn during construction shall be restored by the contractor within five days after notification from the City Inspectors.

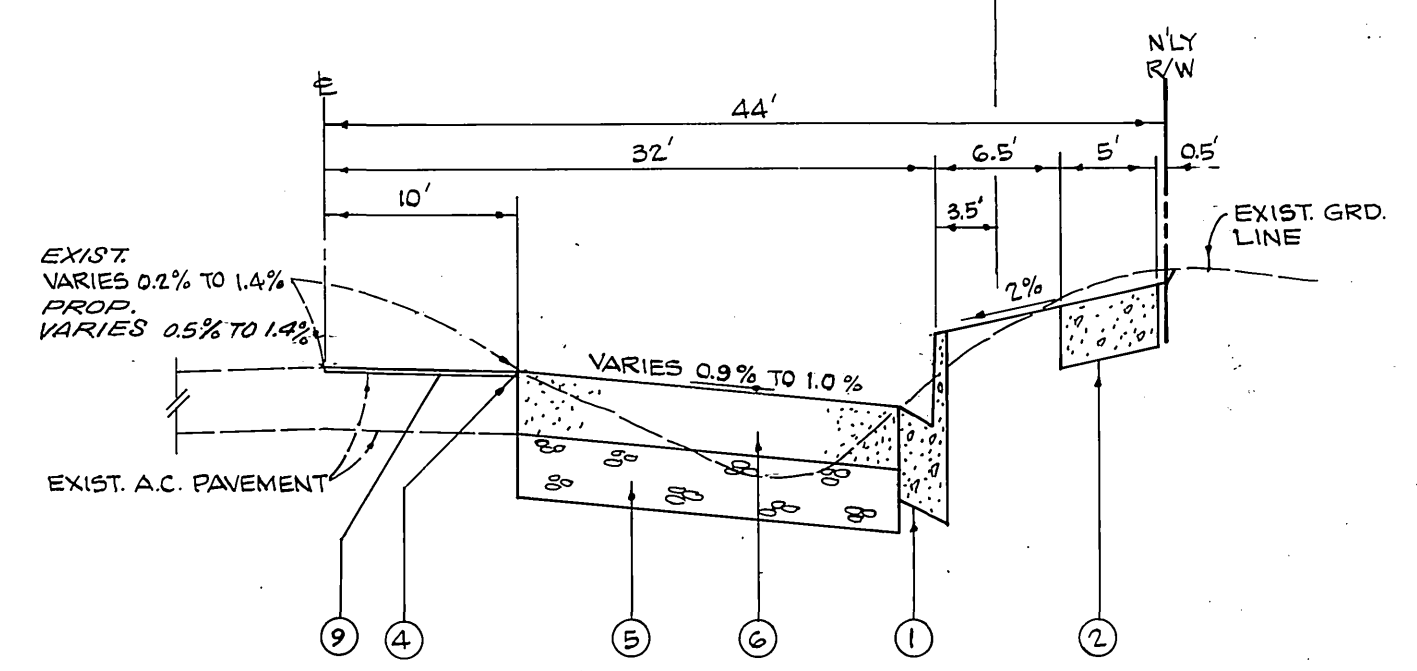

**TYPICAL SECTION**

NO SCALE  
 T.I. = 6

SOUTHERN CALIFORNIA GAS COMPANY  
 APPROVED BY *R. D. Laughman* 3-6-87  
 CHIEF ENGINEER DATE

CITY OF RIVERSIDE DOMESTIC WATER SYSTEM  
 APPROVED BY *Carl Wungartau* 5/11/87  
 DATE

CIVIL ENGINEER  
 MARLEN F. KRAUSE  
 556 RANCHO ALEGRE DRIVE  
 COVINA, CA. 91724  
 PH. (213) 399-8211  
*Marlen F. Krause* 1-25-82  
 R.C.E. 16643 DATE

MARK	REVISIONS	APPR. DATE

CITY OF RIVERSIDE, CALIFORNIA  
 PUBLIC WORKS DEPARTMENT  
 APPROVED BY *Darryl Bed* 5/27/87  
 DIRECTOR OF PUBLIC WORKS  
 DATE 5/27/87

BUILDING PERMIT  
 4711 COLUMBIA AVENUE  
 STA. 7+65.67 TO STA. 9+15.67  
 (N'LY SIDE COLUMBIA AVE.)  
 SCALE: HORIZ. 1" = 20' VERT. 1" = 2'

ACCOUNT NO.  
 DRAWING NUMBER  
**R-2873**  
 SHEET 1 OF 1