

- STREET TREE PLANTING NOTES**
- ALL RELATED WORK SHALL CONFORM TO THE CITY OF RIVERSIDE, PARK AND RECREATION DEPARTMENT STANDARDS.
 - CONTACT THE PARK PROJECTS INSPECTOR A MINIMUM OF 48 HOURS IN ADVANCE AT (714) 787-2223 TO SCHEDULE INSPECTIONS. INSPECTIONS SHALL BE REQUIRED: A) WHEN PLANT LOCATIONS HAVE BEEN SPOTTED IN THE FIELD PRIOR TO DIGGING PLANT PITS; B) WHEEL DIGGING PLANT PITS AND PLANTING/RELOCATING TREES; C) AFTER PLANTING AND ALL OTHER INDICATED OR SPECIFIED WORK HAS BEEN COMPLETED FOR START OF MAINTENANCE; AND D) AT THE END OF MAINTENANCE FINAL ACCEPTANCE (DEVELOPER WILL BE RELEASED FROM MAINTENANCE ONLY UPON RECEIPT OF WRITTEN NOTIFICATION FROM THE CITY THAT THE PARK AND RECREATION DEPARTMENT IS ASSUMING MAINTENANCE RESPONSIBILITIES).
 - THE DEVELOPER SHALL MAINTAIN ALL PLANTINGS FOR A MINIMUM PERIOD OF ONE (1) YEAR.
 - STREET TREE PLANTING SHALL BE AS FOLLOWS:
- | STREET NAME | BOTANICAL NAME/COMMON NAME | MIN. SIZE | SPACING | NO. REQUIRED |
|-------------------|--------------------------------|-----------|---------|--------------|
| A. CORRELL STREET | PODOCARPUS/FERN GRACILIOR/PINE | 15 GAL | 45' | 0 |
- PARK AND RECREATION DEPARTMENT AND PUBLIC WORKS DEPARTMENT PERMITS ARE REQUIRED PRIOR TO COMMENCEMENT OF TREE RELOCATION AND/OR REMOVAL WORK. FOR ALL TREES WITHIN THE ULTIMATE PAVEMENT AREA, BACKFILL OF ALL HOLES IS TO BE INSPECTED BY THE CITY FOR PROPER COMPACTION.
- GENERAL NOTES**
- CONSTRUCTION SHALL BE IN ACCORDANCE WITH THE CITY OF RIVERSIDE, DEPT. OF PUBLIC WORKS, STD. SPECS. FOR PUBLIC WORKS CONSTRUCTION, CURRENT EDITION, STANDARD DRAWINGS, AND STANDARD DRAWING NO. 10.
 - IT SHALL BE THE RESPONSIBILITY OF THE CONTRACTOR TO CLEAR THE RIGHT-OF-WAY IN ACCORDANCE WITH THE PROVISIONS OF LAW AS IT AFFECTS EACH UTILITY, INCLUDING IRIGATION LINES AND APPURTENANCES, AND AT NO COST TO THE CITY.
 - THE PRIVATE ENGINEER SIGNING THESE PLANS IS RESPONSIBLE FOR ASSESSING THE ACCURACY AND ACCEPTABILITY OF THE WORK HEREON. IN THE EVENT OF DISCREPANCIES ARISING DURING CONSTRUCTION, THE PRIVATE ENGINEER SHALL BE RESPONSIBLE FOR DETERMINING AN ACCEPTABLE SOLUTION AND REVISIONS TO THE PLANS FOR APPROVAL BY THE CITY.
 - CONSTRUCT OVERLAY-AS-DIRECTED IN THE FIELD TO PRODUCE A SMOOTH SECTION. ENGINEER ESTIMATES OVERLAY TO BE 3.5 TONS. TRIM EDGE OF EXISTING PAVEMENT WHERE NEW PAVEMENT JOINS TO A SMOOTH, STRAIGHT LINE.
 - PRIME COAT, SEAL COAT, AND PAINT BINDERS ARE REQUIRED.
 - CURB AND GUTTER SHALL BE STAKED WITH 3" OFFSETS AT 25' INTERVALS, AND ALL FINISHED ELEVATIONS SHOWN ON PLANS SHALL BE STAKED, IN THE FIELD, BY THE PRIVATE ENGINEER.
 - THE DEVELOPER SHALL BE RESPONSIBLE FOR PRESERVING OR RE-ESTABLISHING AND REFERENCING SURVEY MONUMENTS DESTROYED, DISTURBED OR PLACED AS A RESULT OF CONSTRUCTION SHOWN HEREON.
 - QUANTITIES SHOWN ARE FOR INFORMATION ONLY AND THE CITY OF RIVERSIDE IS NOT RESPONSIBLE FOR THEIR ACCURACY.
 - ALL FLAGGED ELEVATIONS SHALL BE STAKED IN THE FIELD BY THE PRIVATE ENGINEER.
 - DEVELOPER TO GIVE CITY WATER DIVISION FIVE (5) DAYS WRITTEN NOTICE PRIOR TO START OF CONSTRUCTION AND TO ALLOW CITY TEN (10) WORKING DAYS FOR COMPLETION OF WORK. (714) 351-6100
 - NOTICE TO CONTRACTOR: THE EXISTENCE AND LOCATION OF ANY UNDERGROUND UTILITY LINES OR STRUCTURES SHOWN ON THESE PLANS WERE OBTAINED BY A SEARCH OF THE AVAILABLE R.C. 718 TO THE BEST OF OUR KNOWLEDGE; THERE ARE NO EXISTING UTILITIES EXCEPT AS SHOWN ON THESE PLANS. THE CONTRACTOR IS REQUIRED TO TAKE DUE PRECAUTIONARY MEASURES TO PROTECT THE UTILITY LINES SHOWN, AND OTHER LINES NOT SHOWN ON THESE PLANS.
 - LOCATION OF MATERIALS TO BE DETERMINED IN THE FIELD AT THE DIRECTION OF THE OWNER. AVOID CONFLICT WITH PROPOSED AND/OR EXISTING FACILITIES.
 - THE DEVELOPER AND/OR CONTRACTOR SHALL CONTACT THE STREET DIVISION (714) 787-2223 TO PICK UP ANY EXISTING STD. 180 BARRICADES THAT ARE BEING REMOVED. THE CITY'S INSPECTOR WILL MAKE THE FINAL DETERMINATION ON WHETHER A BARRICADE CAN BE RELOCATED.

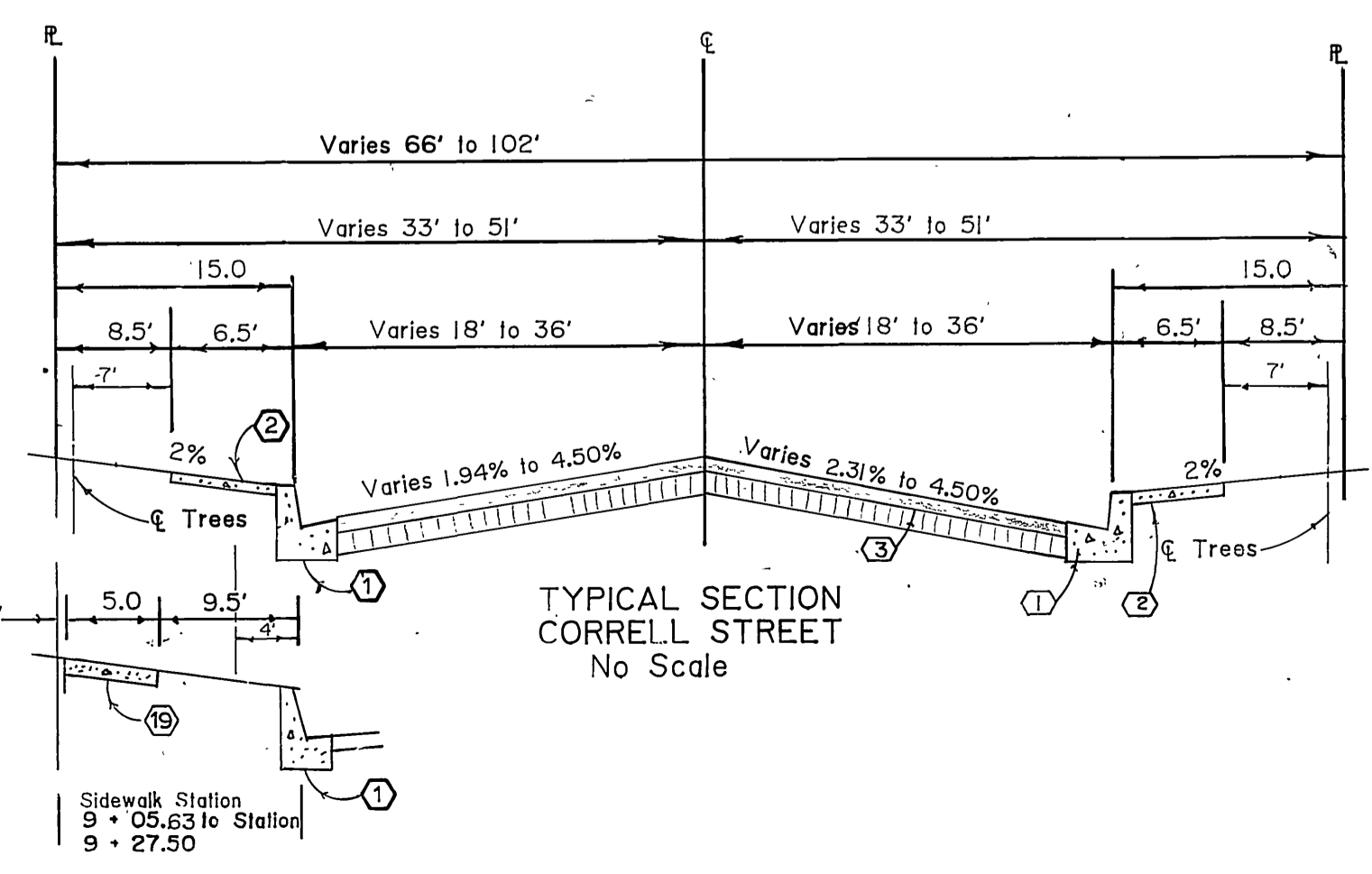
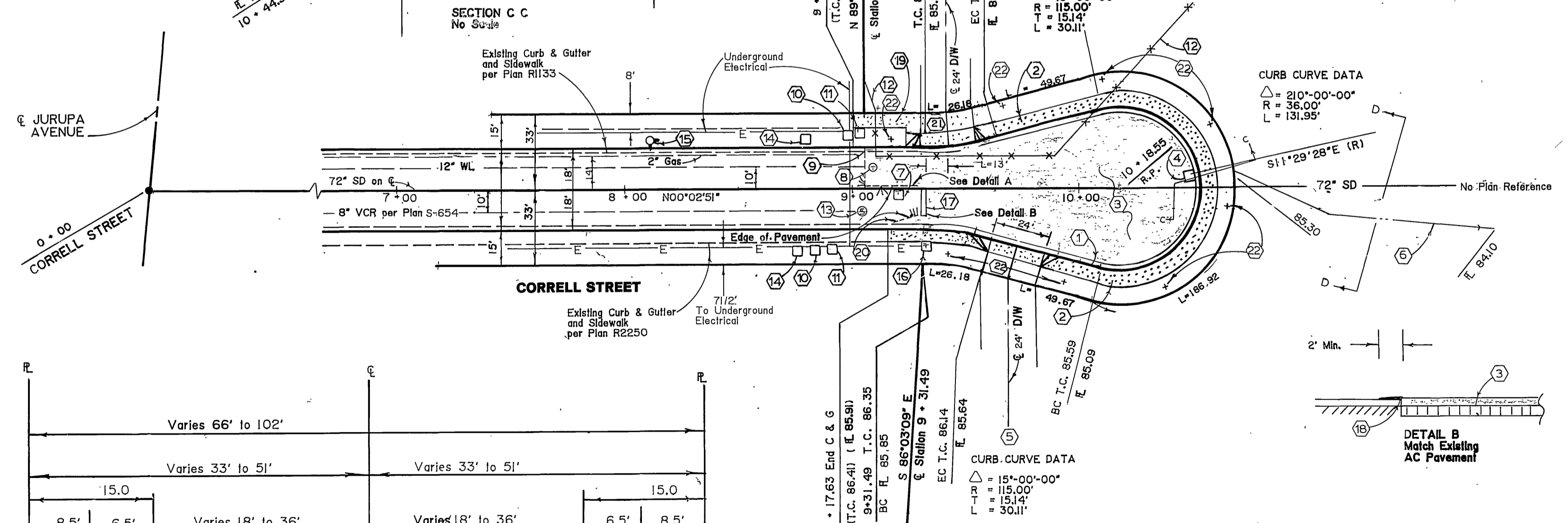
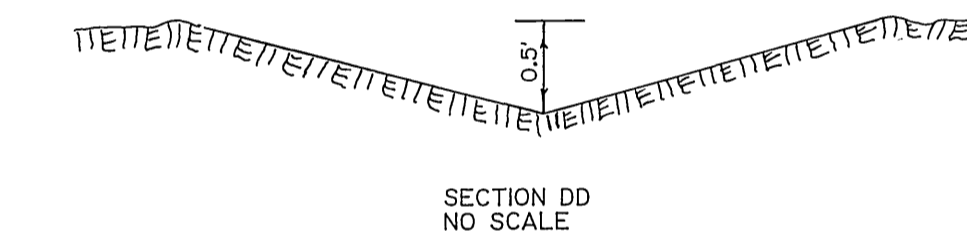
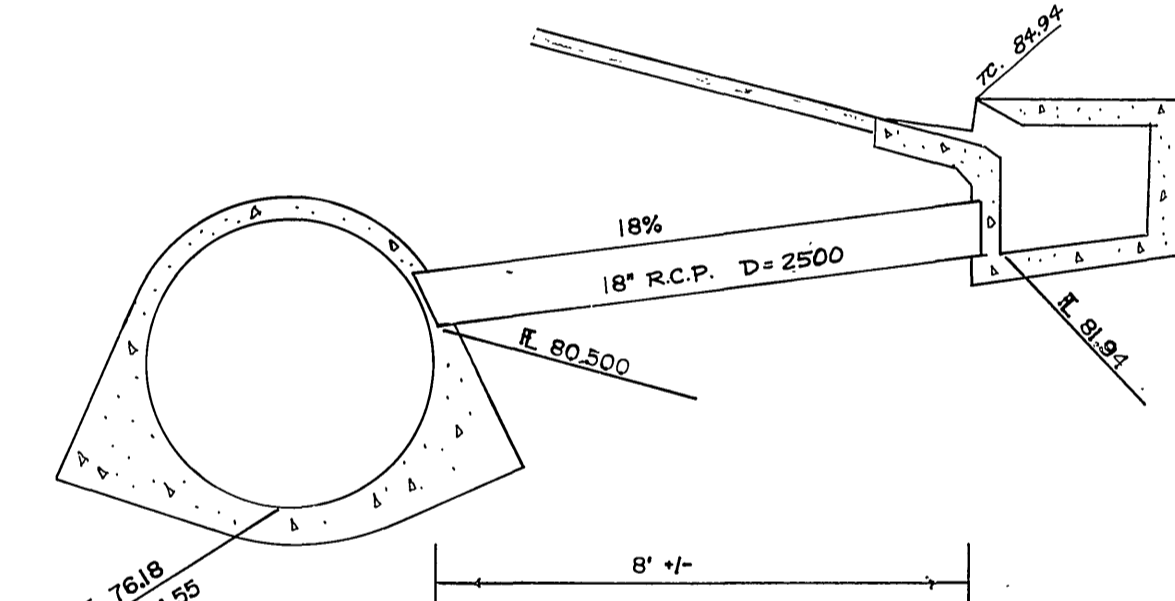

- CONSTRUCTION NOTES**
- Construct P.C.C. Curb and Gutter, Type 1, 6" C.F. per City Standard No. 200.
 - Construct P.C.C. Curb Line Sidewalk per City Standard No. 325.
 - Construct 2 1/2" AC over 8" Crushed Aggregate Base per City Plan No. R-1133.
 - Construct Storm Drain Catch Basin per City Standard No. 405, W=4, V=3.
 - Construct Driveway type IV per City Standard No. 302, A=24, B=38.
 - Construct swale per Section DD to accommodate possible overflow.
 - Existing Storm Drain access to remain.
 - Existing Blow Off Assembly and 12" Gate Valve Box to be salvaged by city forces (During installation of New Water System).
 - Existing drain to be removed.
 - Existing Electrical Box to Remain.
 - Existing Telephone Box to Remain: Protect in Place.
 - Existing fence to be removed.
 - Existing Sewer Manhole to remain.
 - Existing Television Cable Box to Remain.
 - Existing Fire Hydrant to remain.
 - Existing Electrical vault to remain: Protect in Place. Adjust to Grade.
 - Existing Barricade to be removed.
 - Remove existing Redwood Header: clean and feather.
 - Construct P.C.C. Property Line sidewalk per City Standard No. 325.
 - Sawcut and remove existing A.C. Shale.
 - Extend curb line sidewalk to match with driveway.
 - Plant street trees to the specification of the Park and Recreation Department.

ESTIMATE OF QUANTITIES

1. 6" Curb & Gutter	332 L.F.
2. Sidewalk	1755 Sq. Ft.
3. Drive Approach	1000 Sq. Ft.
4. A.C.	97 Tons
5. Base	309 Tons
6. Catch Basin	1 Each

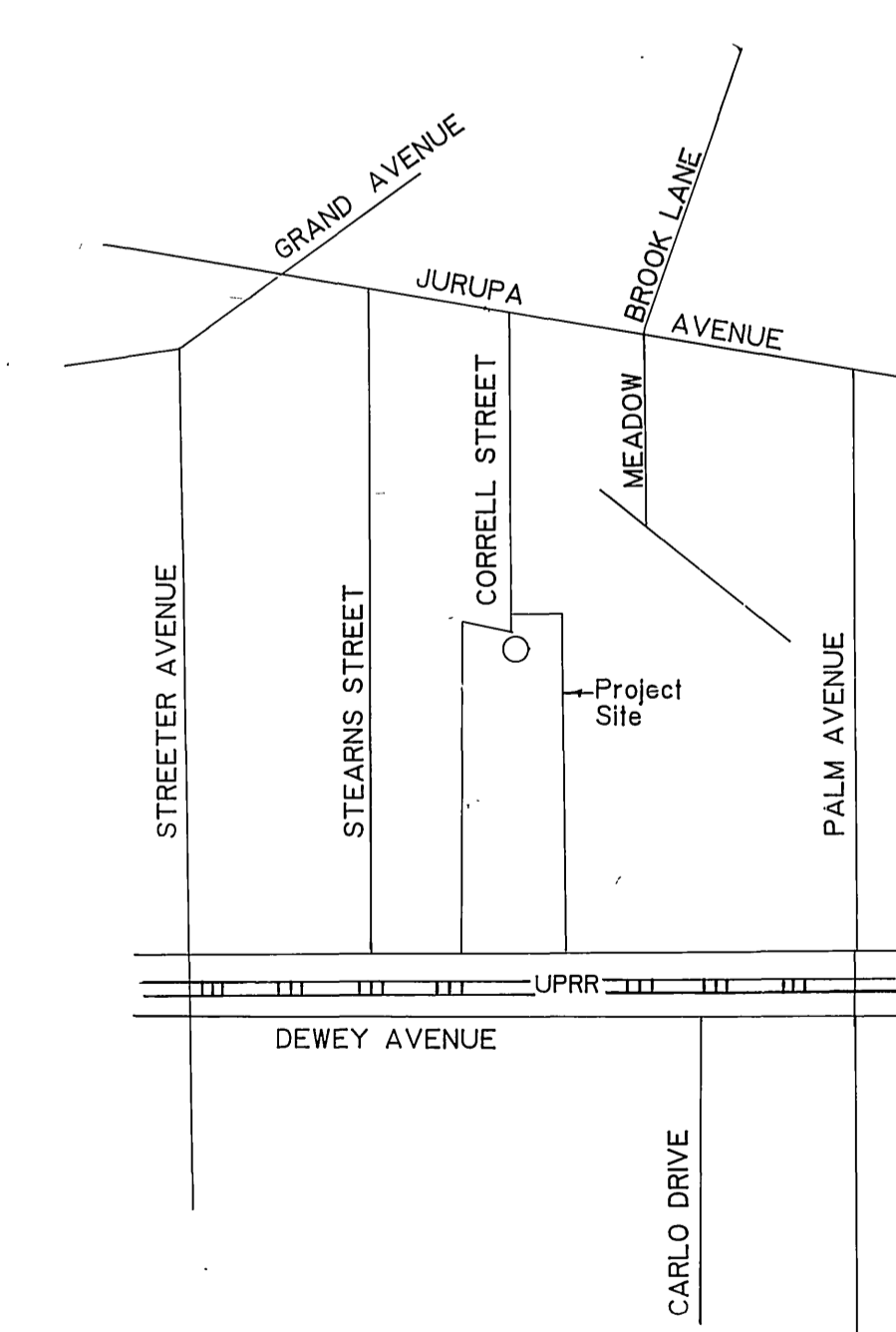

Electric Department	Pacific Bell Telephone	Southern Calif. Gas Co.	Water Department
Approved By <i>[Signature]</i>	Approved By <i>[Signature]</i>	Approved By <i>[Signature]</i>	Approved By <i>[Signature]</i>
BENCH MARK U.S.G.S. Brass Disk Why end of headwall So W. Stearns produced 32' N & Dewey U.S.G.S. B.M. Z-1142 Riv. Co. B.M. 602-5-69 ELEVATION 785.34	TUTTLE ENGINEERING 3462 Del Rosa Avenue San Bernardino, Ca 92404 (941) 886-7481 <i>[Signature]</i> WARREN D. TUTTLE Exp. Date: March 31, 1992 City Business Tax Certificate No. 027319 Exp. Date: April 4, 1993		

CITY OF RIVERSIDE
PUBLIC WORKS DEPARTMENT

STREET IMPROVEMENT PLAN
CORRELL STREET
From 930' to 1062' South of Jurupa
TRACT 21726

ACCOUNT NO. 95-28
R - 2877
SHEET 1 OF 1

APPROVED BY
[Signature]
PUBLIC WORKS DIRECTOR

DATE: 9/30/88

HORIZ. SCALE: 1" = 40'
VERT. SCALE: 1" = 4'

INDEXED S-1-89 41