

**GENERAL NOTES**

- IT SHALL BE THE RESPONSIBILITY OF THE CONTRACTOR TO CLEAR THE RIGHT OF WAY IN ACCORDANCE WITH THE PROVISIONS OF LAW AS IT AFFECTS EACH UTILITY INCLUDING IRRIGATION LINES AND APPURTENANCES AND AT NO COST TO THE CITY.
- CONSTRUCTION SHALL BE IN ACCORDANCE WITH THE CITY OF RIVERSIDE DEPARTMENT OF PUBLIC WORKS, STANDARD DRAWINGS, STANDARD DRAWING NO. 10 AND THE STANDARD SPECIFICATIONS FOR PUBLIC WORKS CONSTRUCTION, CURRENT EDITION.
- THE PRIVATE ENGINEER SIGNING THESE PLANS IS RESPONSIBLE FOR ASSURING THE ACCURACY AND ACCEPTABILITY OF THE WORK HEREON IN THE EVENT OF DISCREPANCIES ARISING DURING CONSTRUCTION, THE PRIVATE ENGINEER SHALL BE RESPONSIBLE FOR DETERMINING AN ACCEPTABLE SOLUTION AND REVISING THE PLANS FOR APPROVAL BY THE CITY.
- THE DEVELOPER SHALL BE RESPONSIBLE FOR PRESERVING OR REESTABLISHING AND REFERENCING SURVEY MONUMENTS DESTROYED, DISTURBED OR BURIED AS A RESULT OF CONSTRUCTION SHOWN HEREON.
- SEE "STREET LIGHTING PLANS" FOR QUANTITY AND LOCATION OF REQUIRED STREET LIGHTS.
- ALL FLAGGED ELEVATIONS SHALL BE STAKED IN THE FIELD BY THE PRIVATE ENGINEER.
- CONSTRUCT DRIVEWAY APPROACHES PER STANDARD DRAWING 302 EXACT SIZE AND LOCATION TO BE AS SHOWN.
- THE CONTRACTOR SHALL CALL IN A LOCATION REQUEST TO UNDERGROUND SERVICE ALERT (USA), PHONE NO. 1-800-422-4133, TWO WORKING DAYS BEFORE DIGGING. NO CONSTRUCTION PERMIT WILL BE ISSUED BY THE PUBLIC WORKS DEPARTMENT INVOLVING EXCAVATION FOR UNDERGROUND FACILITIES UNLESS THE APPLICANT HAS BEEN PROVIDED AN INQUIRY IDENTIFICATION NUMBER BY U.S.A.
- ALL TRAFFIC SIGNS SHALL BE INSTALLED PRIOR TO OPENING THE STREETS TO TRAFFIC.
- ANY TRAFFIC CONTROL STRIPING OBLITERATED AND/OR BADLY WORN DURING CONSTRUCTION SHALL BE RESTORED BY THE CONTRACTOR WITHIN FIVE DAYS AFTER NOTIFICATION FROM THE CITY INSPECTORS.
- FINAL STRIPING FOR TRAFFIC CONTROL AND/OR PAVEMENT MARKING TO BE THE RESPONSIBILITY OF THE DEVELOPER.
- TRIM EDGE OF EXISTING PAVEMENT WHERE NEW PAVEMENT JOINS TO A SMOOTH, STRAIGHT LINE. CONSTRUCT MATCH-UP PAVING AS SHOWN ON PLAN AND OVERLAY PAVING AS DIRECTED IN FIELD TO PRODUCE A SMOOTH SECTION.
- THE SUBDIVIDER SHALL ARRANGE FOR A SOIL TEST TO BE MADE BY A SOILS ENGINEER AFTER THE STREETS HAVE BEEN PREPARED TO ROUGH GRADE AND PRIOR TO CURB AND GUTTER CONSTRUCTION. DEPTH OF BASE MATERIAL AND A.C. PAVING SHALL BE DETERMINED BY THE CITY OF RIVERSIDE DESIGN STANDARDS AND TEST PROCEDURES.
- ON ALL AREAS WITHIN PUBLIC RIGHT OF WAY WHERE THE FILL IS ONE (1) FOOT OR GREATER, A LETTER WILL BE REQUIRED FROM THE SOILS ENGINEER, CERTIFYING THE COMPACTION OF THE FILL BELOW SUBGRADE, PRIOR TO ISSUANCE OF THE CONSTRUCTION PERMIT / CUT SHEETS.
- DEVELOPER TO GIVE CITY WATER DIVISION FIVE (5) WORKING DAYS WRITTEN NOTICE PRIOR TO START OF CONSTRUCTION AND ALLOW TEN (10) WORKING DAYS FOR COMPLETION OF WORK. (782-5611)

**PARKS DEPARTMENT NOTES**



- ALL RELATED WORK SHALL CONFORM TO THE CITY OF RIVERSIDE PARK AND RECREATION DEPARTMENT STANDARDS.
- CONTACT THE STREET TREE INSPECTOR A MINIMUM OF 48 HOURS IN ADVANCE AT 351-6126 TO SCHEDULE INSPECTIONS. INSPECTIONS SHALL BE REQUIRED:
  - WHEN PLANT LOCATIONS HAVE BEEN SPOTTED IN THE FIELD PRIOR TO DIGGING PLANT PITS.
  - WHILE DIGGING PLANT PITS AND PLANTING/RELOCATING TREES.
  - AFTER PLANTING AND ALL OTHER INDICATED OR SPECIFIED WORK HAS BEEN COMPLETED FOR START OF MAINTENANCE.
  - AT END OF MAINTENANCE/FINAL ACCEPTANCE (CONTRACTOR/DEVELOPER WILL BE RELEASED FROM MAINTENANCE ONLY UPON RECEIPT OF WRITTEN NOTIFICATION FROM THE CITY THAT THE PARK AND RECREATION DEPARTMENT IS ASSUMING MAINTENANCE RESPONSIBILITIES).
- THE CONTRACTOR/DEVELOPER SHALL MAINTAIN ALL PLANTINGS FOR A MINIMUM PERIOD OF ONE (1) YEAR.
- PARK AND RECREATION DEPARTMENT AND PUBLIC WORKS DEPARTMENT PERMITS ARE REQUIRED PRIOR TO COMMENCEMENT OF TREE RELOCATION AND/OR REMOVAL WORK. FOR ALL TREES WITHIN THE ULTIMATE PAVEMENT AREA, BACKFILL OF ALL HOLES IS TO BE INSPECTED BY THE CITY FOR PROPER COMPACTION.
- STREET TREE PLANTING SHALL BE AS FOLLOWS:

STREET NAME	BOTANICAL NAME/ COMMON NAME	MIN. SIZE	APPROX. SPACING	NO. REQ'D
CHICAGO AVE.	WASHINGTONIA FLIPERA// CALIFORNIA PEN PALM	RELOCATE AS SHOWN		2
CHICAGO AVE.	WASHINGTONIA FLIPERA// CALIFORNIA PEN PALM	4" DB BROWN TRUNK	45'	2

**NOTICE TO CONTRACTOR**

- THE EXISTENCE AND LOCATION OF ANY UNDERGROUND UTILITY PIPES OR STRUCTURES SHOWN ON THESE PLANS ARE OBTAINED BY A SEARCH OF THE AVAILABLE RECORDS. TO THE BEST OF OUR KNOWLEDGE, THERE ARE NO EXISTING UTILITIES EXCEPT THOSE SHOWN ON THESE PLANS.
- THE CONTRACTOR IS REQUIRED TO TAKE DUE PRECAUTIONARY MEASURES TO PROTECT THE UTILITY LINES SHOWN AND ANY OTHER LINES NOT OF RECORD OR NOT SHOWN ON THESE PLANS.
- CALL UNDERGROUND SERVICE ALERT (U.S.A.) 1-800-422-4133 AT LEAST 48 HOURS PRIOR TO EXCAVATION.

**CONSTRUCTION NOTES**

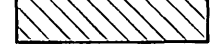
- CONSTRUCT STANDARD 200 CURB AND GUTTER-6" CURB FACE TYPE I
- CONSTRUCT STANDARD 325 CURBLINE SIDEWALK
- CONSTRUCT STANDARD 250, 6" ASPHALT BERM.
- CONSTRUCT STANDARD 304 WHEELCHAIR RAMP (MODIFIED AS SHOWN)
- PLANT OR RELOCATE STREET TREES TO THE SPECIFICATIONS OF THE PARK AND RECREATION DEPARTMENT.
- REMOVE EXISTING PAVING AS SHOWN 
- SAWCUT EXISTING PAVING TO A SMOOTH STRAIGHT LINE.
- CONSTRUCT OF A.C. PAVING OVER OF CRUSHED AGGREGATE 
- CONSTRUCT VARIABLE THICKNESS A.C. OVERLAY 
- CONSTRUCT STANDARD 220 CONCRETE CROSS GUTTER AND SPANDRELS.

**BENCH MARK**

FOUND BRASS DISK STAMPED (17A) IN CAPPED WELL AT THE INTERSECTION OF THIRD STREET AND CHICAGO AVENUE PER THE CITY OF RIVERSIDE PRECISE B.M. BOOK AND C.R.F.B. 717/68.

ELEV. = 941.005

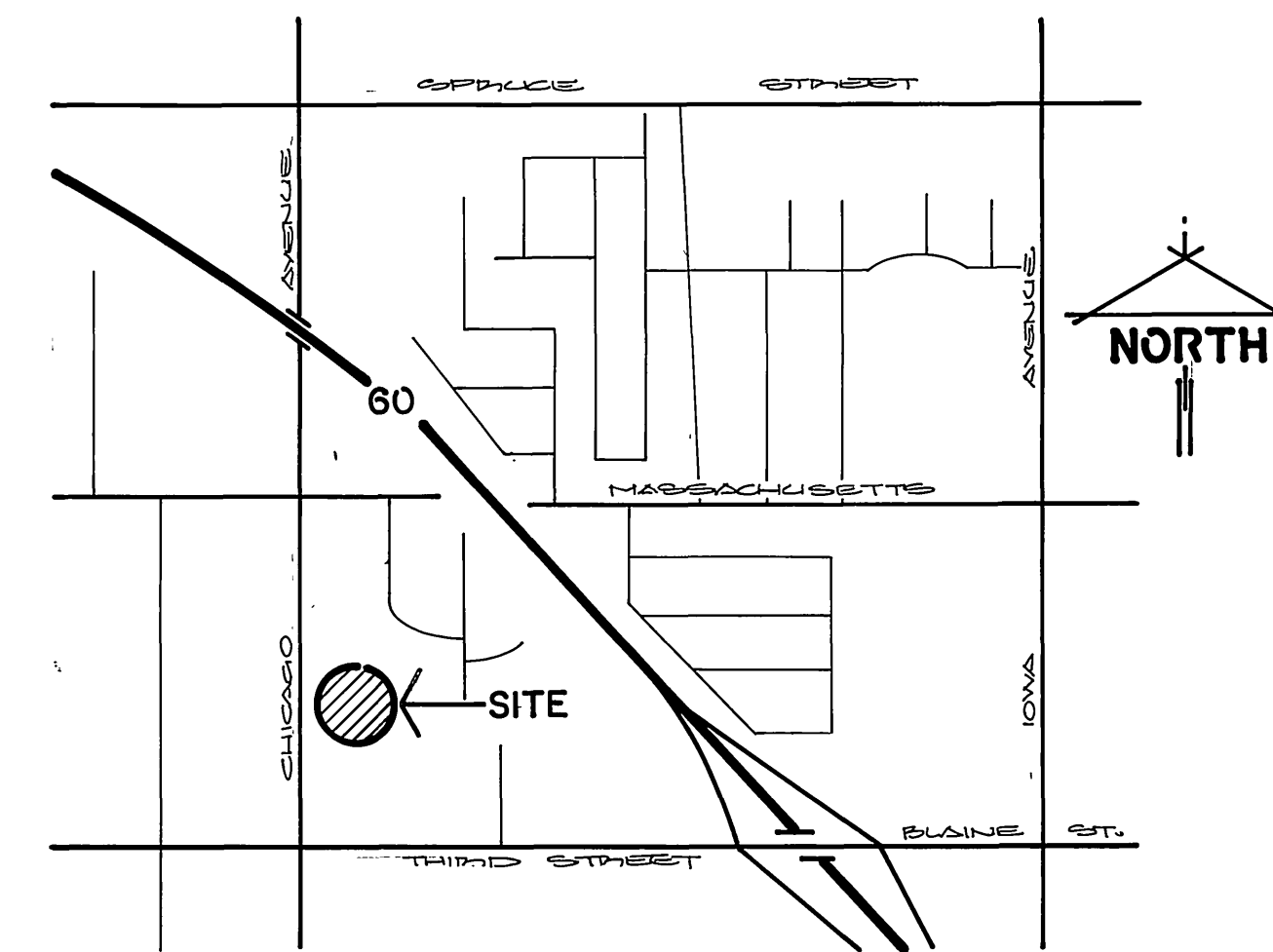

**LOCATION MAP**

NOT TO SCALE ±

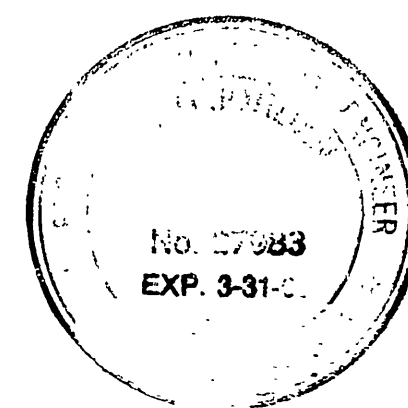

ALBERT A. WEBB ASSOCIATES CIVIL ENGINEERS RIVERSIDE, CALIFORNIA		CITY OF RIVERSIDE, CALIFORNIA PUBLIC WORKS DEPARTMENT		STREET IMPROVEMENT PLAN Z.C. R-27-878 <b>3050 CHICAGO AVENUE</b> EAST SIDE OF CHICAGO AVENUE FROM 595' N'LY OF THIRD STREET N'LY 350' ±		ACCOUNT No. 87-282 DRAWING NUMBER <b>R-2966</b> SHEET 008 OF 100	
APPROVED BY: <i>[Signature]</i> DATE: 2/15/00 R.E. No. 21002		APPROVED BY: <i>[Signature]</i> DATE: 8/24/88 DIRECTOR OF PUBLIC WORKS		SCALE: AS SHOWN		87-282	
W.O. 87-282 FOR: THAMMELL CHON CO. F.B.		DESIGNED BY: <i>[Signature]</i> DRAWN BY: <i>[Signature]</i> CHECKED BY: <i>[Signature]</i>		CHIEF PUB. WKS. ENGR. <i>[Signature]</i> DATE: 8/24/88		* As built 8-9-87 LE INDEXED 9-6-88 LH	

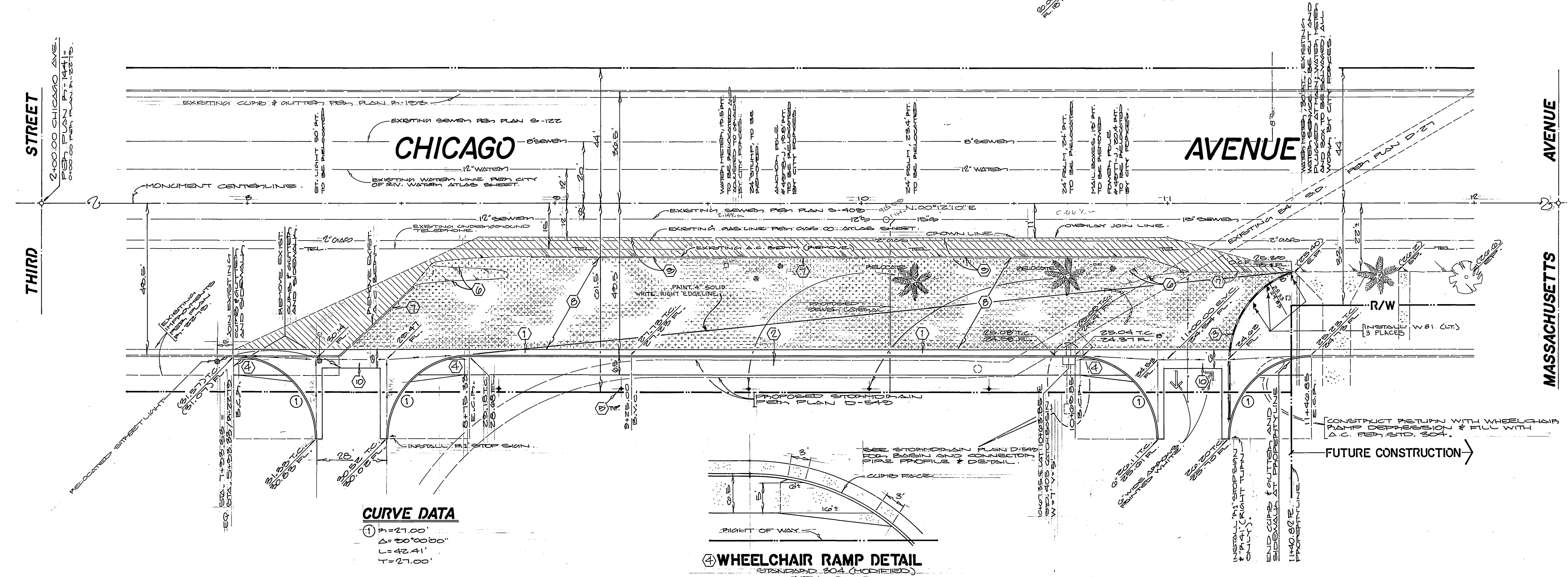
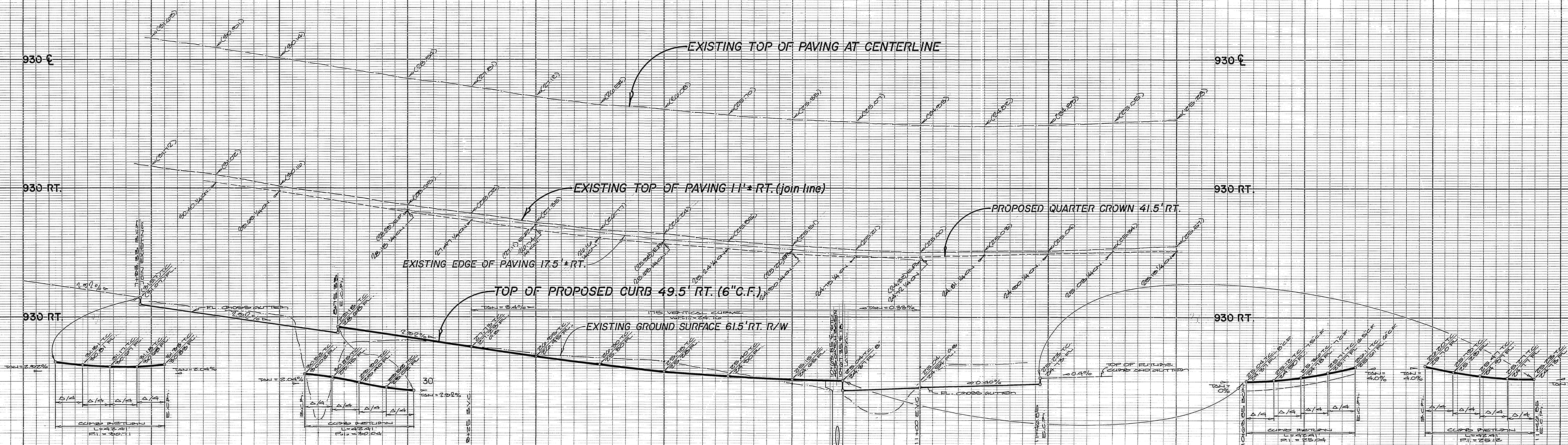

**CURVE DATA**  
 ① R=27.00'  
 Δ=50°00'00"  
 L=42.41'  
 T=27.00'

**WHEELCHAIR RAMP DETAIL**  
 STANDARD 304 (MODIFIED)  
 NOT TO SCALE...

**BENCH MARK**  
 FOUND BRASS DISH STAMPED (I-7A) IN  
 CARVED MONUMENT AT THE INTERSECTION  
 OF THIRD STREET AND CHICAGO AVENUE  
 PER THE CITY OF RIVERSIDE, TRACED  
 B.M. BOOK AND C.D.F.S. 11/7/88  
 ELEV. = 941.005



**ALBERT A. WEBB ASSOCIATES**  
 CIVIL ENGINEERS  
 RIVERSIDE, CALIFORNIA  
 APPROVED BY: [Signature] DATE: 2/25/88  
 R.E. No. 27983

**CITY OF RIVERSIDE, CALIFORNIA**  
**PUBLIC WORKS DEPARTMENT**  
 APPROVED BY: [Signature] DATE: 2/25/88  
 PRINCIPAL ENGINEER  
 PARK DEPARTMENT  
 TRAFFIC DIVISION  
 CHIEF PUB. WKS. ENGR.

**STREET IMPROVEMENT PLAN**  
 Z.C. R-27-878  
**3050 CHICAGO AVENUE**  
 EAST SIDE OF CHICAGO AVENUE  
 FROM 595' N'LY OF THIRD STREET  
 N'LY 350' ±  
 ACCOUNT No. 87-282  
 DRAWING NUMBER  
**R-2966**  
 SHEET TWO OF TWO  
 87-282

<b>CITY OF RIVERSIDE</b> WATER SYSTEM BY: Carl Weingarten DATE: 5/16/88	<b>CITY OF RIVERSIDE</b> OVERHEAD & UNDERGROUND BY: John Johnson DATE: 5-12-88
<b>PACIFIC BELL CO.</b> BY: [Signature] DATE: 2-2-88	<b>SOUTHERN CALIFORNIA</b> GAS CO. BY: George A. Amund DATE: 5-12-88

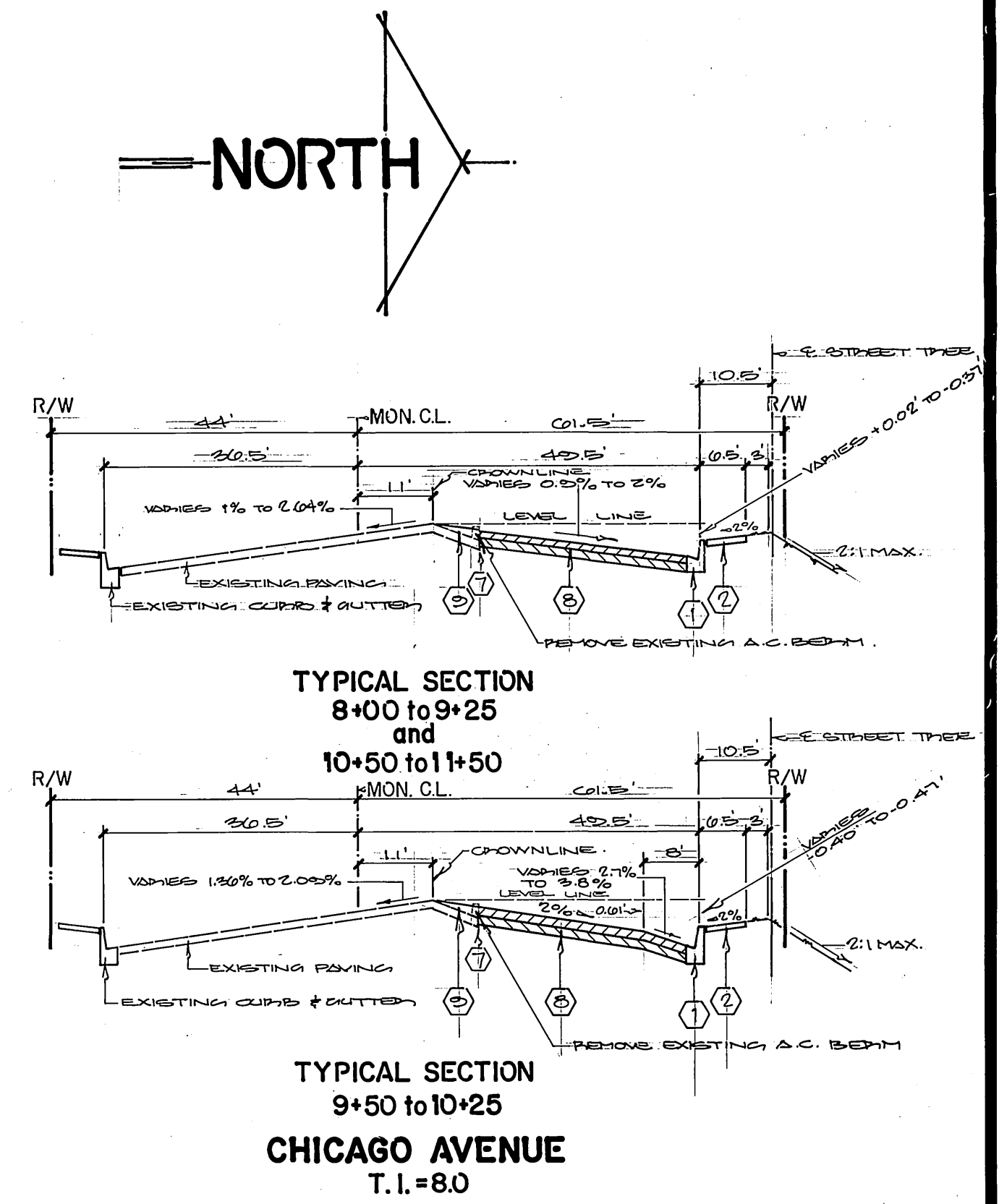

\* As built 8-9-87  
 INDEXED 9-6-88 LTH