

**PARKS AND RECREATION DEPARTMENT GENERAL NOTES**

- 1) ALL RELATED WORK SHALL CONFORM TO THE CITY OF RIVERSIDE PARKS AND RECREATION DEPARTMENT STANDARDS.
- 2) CONTACT THE STREET TREE INSPECTOR A MINIMUM OF 48 HRS. IN ADVANCE AT 351-6126 TO SCHEDULE INSPECTION. INSPECTIONS SHALL BE REQUIRED:
  - a) WHEN PLANT LOCATIONS HAVE BEEN SPOTTED IN THE FIELD PRIOR TO DIGGING PLANT PITS.
  - b) WHILE DIGGING PLANT PITS AND PLANTING/RELOCATING TREES.
  - c) AFTER PLANTING AND ALL OTHER INDICATED OR SPECIFIED WORK HAS BEEN COMPLETED FOR START OF MAINTENANCE.
  - d) AT END OF MAINTENANCE (FINAL ACCEPTANCE (CONTRACTOR/DEVELOPER WILL BE RELEASED FROM MAINTENANCE ONLY UPON RECEIPT OF WRITTEN NOTIFICATION FROM THE CITY THAT THE PARKS AND RECREATION DEPARTMENT IS ASSUMING MAINTENANCE RESPONSIBILITIES).
- 3) THE CONTRACTOR/DEVELOPER SHALL MAINTAIN ALL PLANTING FOR A MINIMUM PERIOD OF (ONE) YEAR.
- 4) STREET TREE PLANTING SHALL BE AS FOLLOWS:
 

STREET NAME	BOTANICAL NAME/COMMON NAME	MIN. APP. SIZE	NO. REQ.
INDIANA	ORANEA EDULIS/QUINQUELOBRAN	24"	1
	PAV. PALM TRUNK	24"	1
- 5) PARKS AND RECREATION DEPARTMENT AND PUBLIC WORKS DEPARTMENT PERMITS ARE REQUIRED PRIOR TO COMMENCEMENT OF TREE RELOCATION AND/OR REMOVAL. ALL HOLES SHALL BE INSPECTED BY THE CITY FOR PROPER COMPACTION.

SCALE: HORIZONTAL 1"=40' VERTICAL 1"=4'

- CONSTRUCTION NOTES**
- 1) CONSTRUCT 2" AC OVER 1" CRUSHED AGGREGATE BASE OR 6" AC OVER COMPACTED NATIVE MATERIAL PER STD. NO. 200.
  - 2) CONSTRUCT TYPE "I" CURBS & GUTTER (6" GP) PER STD. NO. 200.
  - 3) CONSTRUCT PROPERTY LINE SIDEWALK PER STD. NO. 325.
  - 4) CONSTRUCT DRIVEWAY APPROACH PER STD. NO. 302.
  - 5) CONSTRUCT AC OVERLAY TO GRADES AS SHOWN.
  - 6) PLANT STREET TREE TO THE SPECIFICATIONS OF THE PARKS AND RECREATION DEPT.
- GENERAL NOTES**
- 1) It shall be the responsibility of the contractor to clear the right of way in accordance with the provisions of law as it affects each utility including irrigation lines and appurtenances and at no cost to the City.
  - 2) Construction shall be in accordance with the City of Riverside Dept. of Public Works, Standard Drawings, Std. Dwg. No. 10, and the Standard Specifications for Public Works Construction, Current Edition.
  - 3) Trim edge of existing pavement where new pavement joins to a smooth, straight line. Construct match-up paving as shown on plan and overlay paving as directed in the field to produce a smooth section.
  - 4) Construct driveway approaches per Std. Dwg. 302. Exact size and location as shown.
  - 5) All flagged elevations shall be staked in the field by the private engineer.
  - 6) The private engineer signing these plans is responsible for assuring the accuracy and acceptability of the work hereon. In the event of discrepancies arising during construction, the private engineer shall be responsible for determining an acceptable solution and revising the plans for approval by the City.
  - 7) Contractor agrees that he shall assume sole and complete responsibility for job site conditions during the course of construction of this project, including safety of all persons and property; that this requirement shall apply continuously and not be limited to normal working hours; and that the contractor shall defend, indemnify and hold the owner and the engineer harmless from any and all liability, real or alleged, in connection with the performance of work on this project, excepting for liability arising from the sole negligence of the owner or engineer.

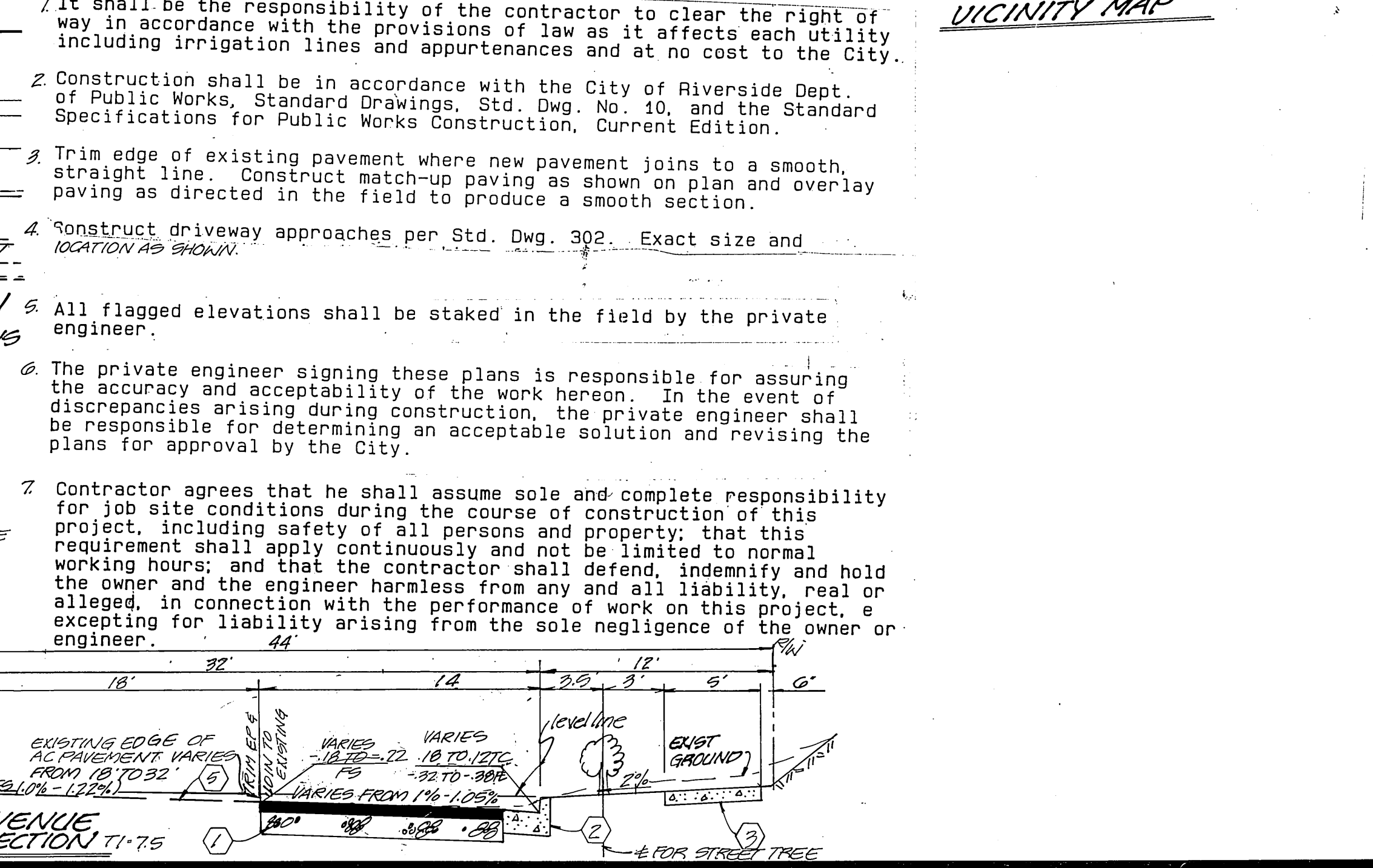
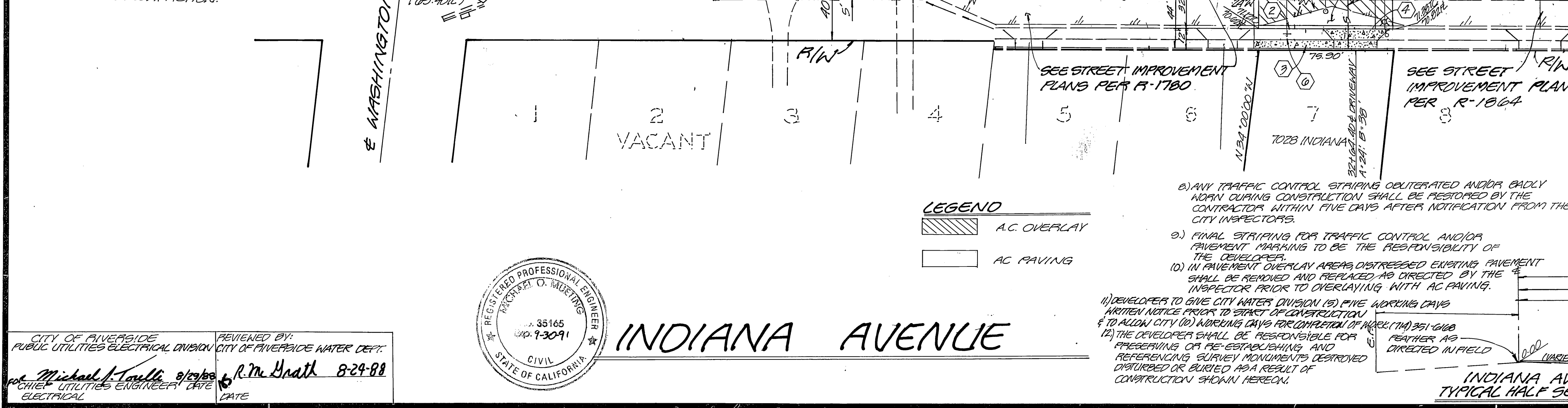
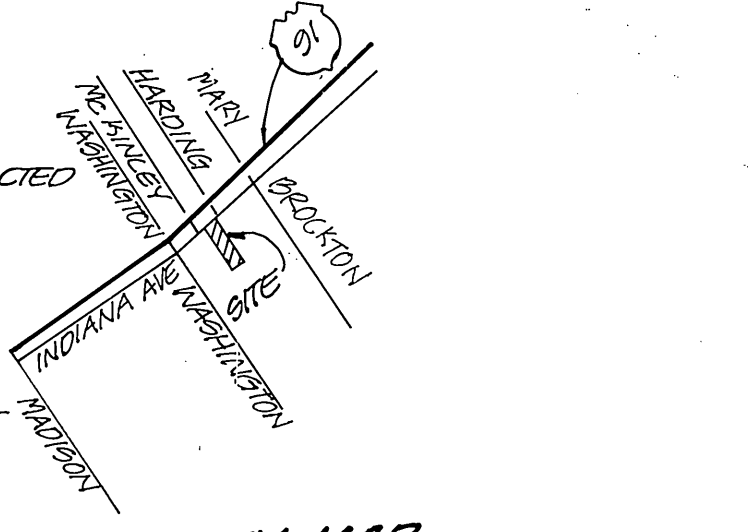

**Underground Service Alert**

Call: TOLL FREE 1-800-422-4133

TWO WORKING DAYS BEFORE YOU DIG

**PRIVATE ENGINEERING NOTE**

CONSTRUCTION CONTRACTOR AGREES THAT IN ACCORDANCE WITH GENERALLY ACCEPTED CONSTRUCTION PRACTICES, CONSTRUCTION CONTRACTOR WILL BE REQUIRED TO ASSUME SOLE AND COMPLETE RESPONSIBILITY FOR JOB SITE CONDITIONS DURING THE COURSE OF CONSTRUCTION OF THE PROJECT, INCLUDING SAFETY OF ALL PERSONS AND PROPERTY. THAT THIS REQUIREMENT SHALL BE MADE TO APPLY CONTINUOUSLY AND NOT BE LIMITED TO NORMAL WORKING HOURS, AND CONSTRUCTION CONTRACTOR FURTHER AGREES TO DEFEND, INDEMNIFY AND HOLD DESIGN PROFESSIONAL HARMLESS FROM ANY AND ALL LIABILITY, REAL OR ALLEGED, IN CONNECTION WITH THE PERFORMANCE OF WORK ON THIS PROJECT, EXCEPTING LIABILITY ARISING FROM THE SOLE NEGLIGENCE OF DESIGN PROFESSIONAL.

REGISTERED CIVIL ENGINEER NO. 35105

EXPIRATION DATE: 2-20-91 DATE: 6-27-88

PREPARED UNDER THE DIRECTION OF Michael J. Toule

**J.F. Davidson Associates, Inc.**

ENGINEERING PLANNING SURVEYING ARCHITECTURE LANDSCAPE ARCHITECTURE

3880 Lenon Street, Suite 300 P.O. Box 493 Riverside, CA 92502 (714) 688-0844 FAX 714-686-5954

11200 S. Mt. Vernon Ave., Suite "D" Colton, CA 92324 (714) 825-1082

73-080 El Paseo, Suite 106 Palm Desert, CA 92250 (619) 345-5891 FAX 619-345-0359

SCALE: 1"=40'

DATE: MAY 1988

BENCH MARK: (601-10-08) - C.S.D.H. BRASS DIRM IN WELL MARKED 25.00 FIN LINE & WASHINGTON, IN & WASHINGTON, 182' NLY & OF INDIANA

**CITY OF RIVERSIDE, CALIFORNIA DEPARTMENT OF PUBLIC WORKS**

APPROVED BY: Barry Red

DATE: 9/27/88

**STREET PLAN AND PROFILE**

**INDIANA AVENUE**

R-82-807 702B INDIANA

32' SIDE FROM STA 32+00.50 TO 32+05.40 ELY OF WASHINGTON STREET

PROJECT NO. R-3003

SHEET 1 OF 1

FILE NO. 870-9924