

BENCH MARK: Spike in P.P. No. 2102-J, at ANNA ST. and VICTORIA AVE., Elevation 963.87. City Engr. F.B. 433/1, c44/33

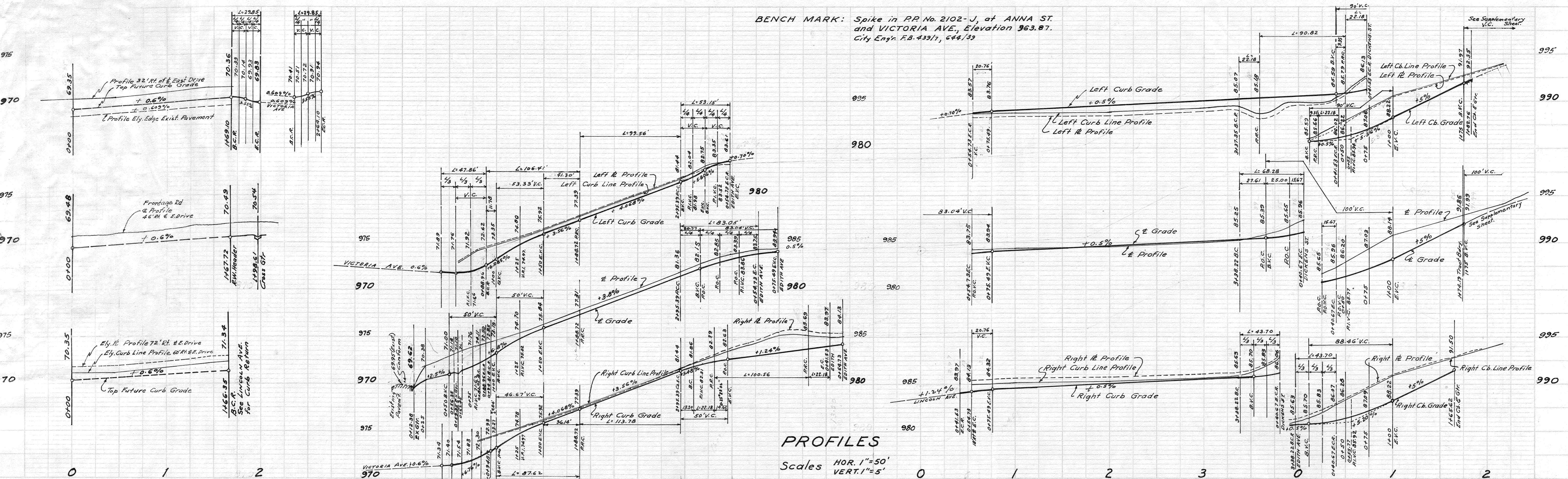

PROFILES

Scales HOR. 1"=50' VERT. 1"=5'

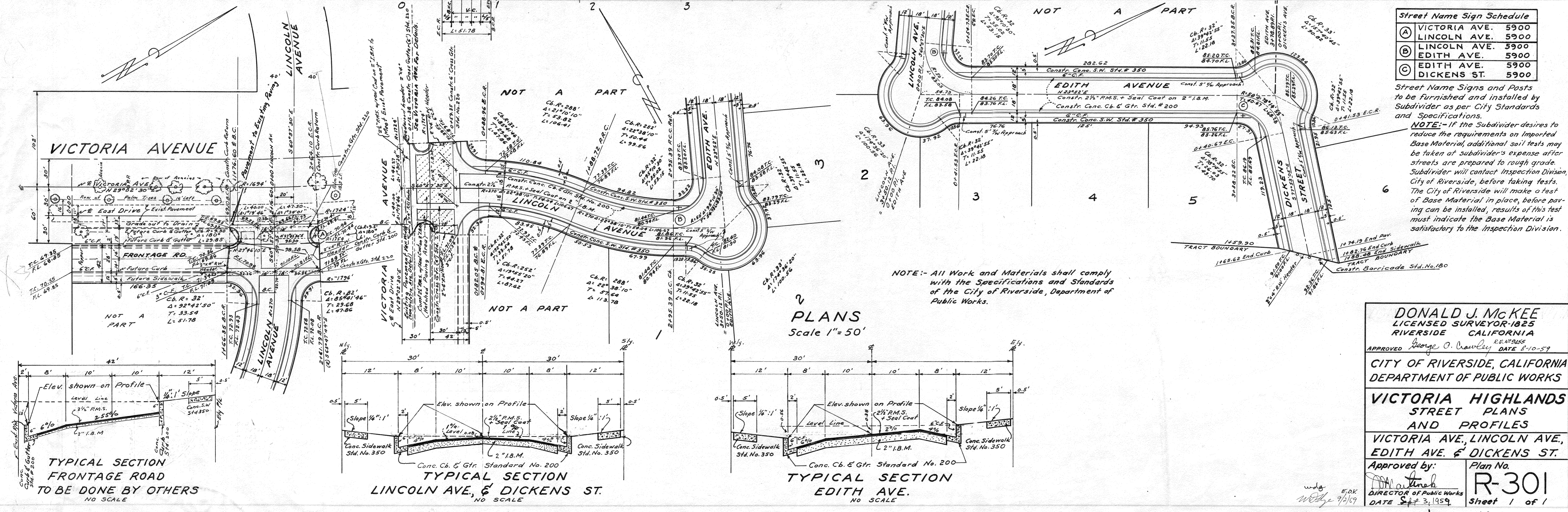

PLANS

Scale 1"=50'

Street Name Sign Schedule	
(A)	VICTORIA AVE. 5900
(A)	LINCOLN AVE. 5900
(B)	LINCOLN AVE. 5900
(B)	EDITH AVE. 5900
(C)	EDITH AVE. 5900
(C)	DICKENS ST. 5900

Street Name Signs and Posts to be furnished and installed by Subdivider as per City Standards and Specifications.

NOTE: - If the Subdivider desires to reduce the requirements on Imported Base Material, additional soil tests may be taken at subdivider's expense after streets are prepared to rough grade. Subdivider will contact Inspection Division, City of Riverside, before taking tests. The City of Riverside will make a test of Base Material in place, before paving can be installed, results of this test must indicate the Base Material is satisfactory to the Inspection Division.

NOTE: - All Work and Materials shall comply with the Specifications and Standards of the City of Riverside, Department of Public Works.

TYPICAL SECTION FRONTAGE ROAD TO BE DONE BY OTHERS NO SCALE

TYPICAL SECTION LINCOLN AVE. & DICKENS ST. NO SCALE

TYPICAL SECTION EDITH AVE. NO SCALE

DONALD J. McKEE
 LICENSED SURVEYOR-1825
 RIVERSIDE CALIFORNIA

APPROVED *George O. Crowley* DATE 8-10-59

CITY OF RIVERSIDE, CALIFORNIA
 DEPARTMENT OF PUBLIC WORKS

VICTORIA HIGHLANDS
 STREET PLANS
 AND PROFILES
 VICTORIA AVE., LINCOLN AVE.,
 EDITH AVE. & DICKENS ST.

Approved by: *[Signature]* Plan No. **R-301**
 DIRECTOR OF PUBLIC WORKS
 DATE 8-3-1959 Sheet 1 of 1

INDEXED 1959