

LT. 82  
81

RT. 82  
81

EXIST. GRADE AT 32' LT.

PROP. GRADE AT 32' LT.

EXIST. CURB RETURN  
PROPOSED SPANDREL R.

EXIST. SPANDREL & X-CUTTER R.

EXIST. GRADE AT Q

PROP. GRADE AT Q

**BENCHMARK:**  
P.K. 2 CITY ENGINEER TAG IN ELY  
CURB RETURN, ENTRANCE TO CITY  
CORPORATION YARD ON LINCOLN  
AVENUE PER LLB/36  
**ELEV. = 881.96**

CORPORATION YARD  
EXIT

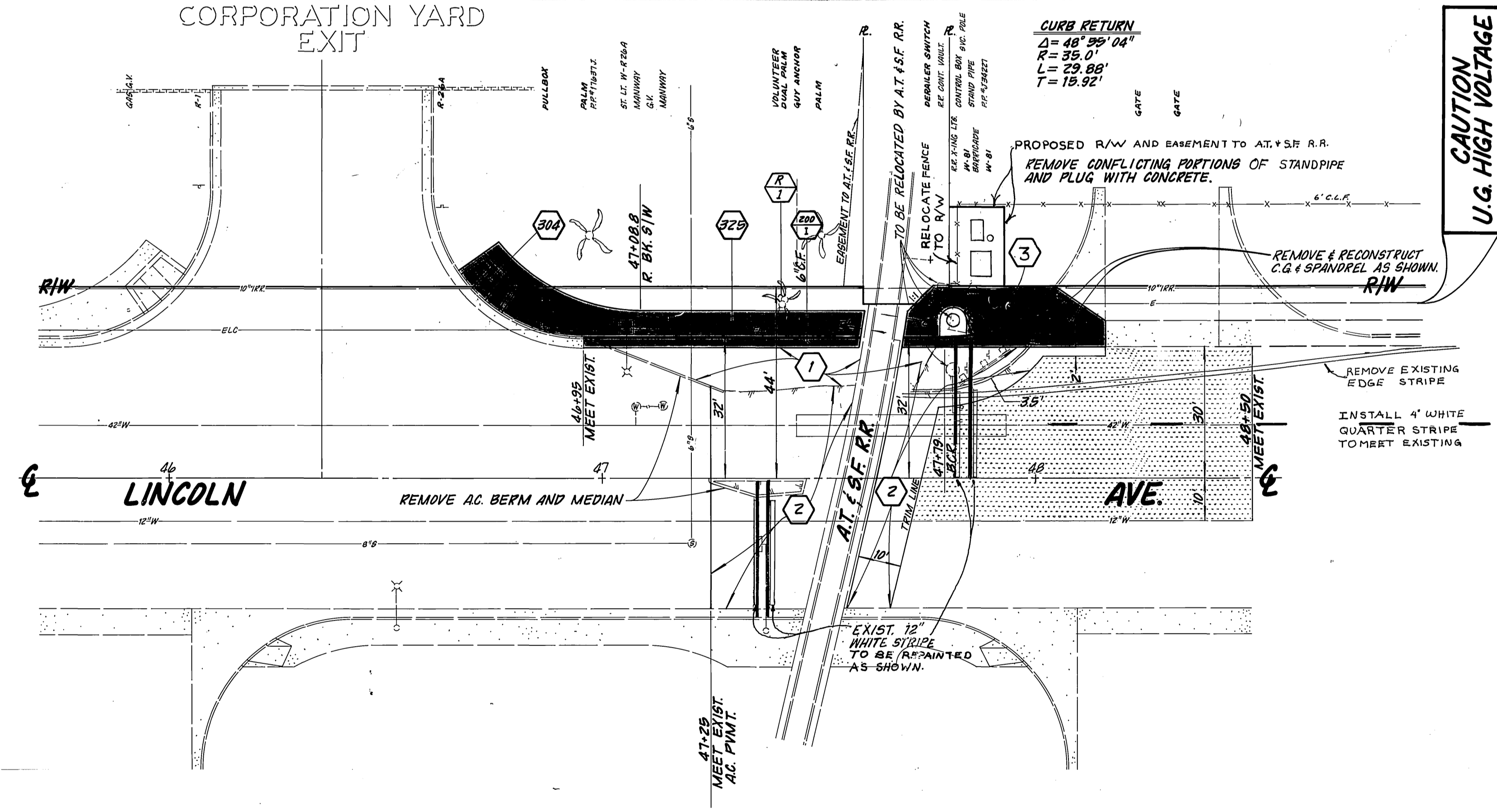

CAUTION  
U.G. HIGH VOLTAGE

**GENERAL NOTES:**

- A.C. OVERLAY
- NUMBERS ABOVE 100 IN A HEXAGON ON THE PLAN REFER TO THE RESPECTIVE STANDARD DRAWING AND SHALL BE CONSTRUCTED ACCORDINGLY, UNLESS MODIFICATIONS ARE NOTED ON THE PLAN. ANY NUMBER SHOWN BELOW THE STANDARD DRAWING NUMBER INDICATES THE SPECIFIC ALTERNATE TO BE CONSTRUCTED.
- CONSTRUCTION SHALL BE IN ACCORDANCE WITH THE CITY OF RIVERSIDE, DEPARTMENT OF PUBLIC WORKS, STANDARD DRAWINGS, AND THE STANDARD SPECIFICATIONS FOR PUBLIC WORKS CONSTRUCTION 1988 EDITION.
- PROTECT ALL POWER POLES IN PLACE.
- PAVEMENT MARKINGS INSTALLED BY CITY FORCES.

**CONSTRUCTION NOTES:**

- 1 STRUCTURAL SECTION: .25'A.C. OVER .67'A.B.
- 2 REMOVE EXISTING PAVEMENT & REPLACE WITH .25'A.C. OVER .67'A.B.
- 3 RAMP LOCATION AND TYPE TO BE DETERMINED AT TIME OF CONSTRUCTION.
- R REMOVE TREE CLASS AS NOTED IN LOWER HALF.

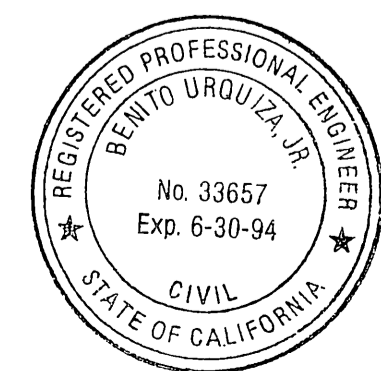

**ENGINEER IN RESPONSIBLE CHARGE**  
Ben Urquiza  
R.C.E. 33657 EXPIRES 6/30/94  
DATE DEC. 7, 1992

**CITY OF RIVERSIDE**  
PUBLIC WORKS DEPARTMENT

APPROVED BY	DATE	BY	APPROVED BY
PRINCIPAL ENGINEER	2/16/94	JS	Public Works Director
SUPERVISOR	12-19-92	WJH	
TRAFFIC DIVISION	12-19-92	SS	
DEPUTY P.W. ENGINEER	2-23-94	M.G.	
CHIEF P.W. INSPECTOR	2-14-92	WJ	
PARKS DEPARTMENT	12-15-92	WJ	
STREET SERVICES	2-23-94	WJ	

**LINCOLN AVENUE  
WIDENING**

CROSSING No. 2B-14.7C

HORIZ. SCALE: 1" = 20' VERT. SCALE: 1" = 2'

ACCOUNT NO. 30-575-347-07

**R-3012**

SHEET 1 OF 1

PC 3472-P

INDEXED 5-12-94 4/11