

RIVERSIDE CITY OF RIVERSIDE CALIFORNIA



PUBLIC WORKS DEPARTMENT

REHABILITATION OF MAJOR CITY STREETS 1989-1990

TRAFFIC R3050 STRIPING DWG.: PGS.

STREET	LIMITS	INDEX	LENGTH	SH. No.	DWG. : PGS.	
①	BROCTON AVE.	MAGNOLIA TO JURUPA	8.5	2838' - 0.5 MILE	2	XL - 236
②	CANYON CREST DR.	BLAINE TO WATKINS	7.0	1675' - 0.3 MILE	3	XL - 237
③	CHICAGO AVE.	SPRUCE TO COLUMBIA	10.5	3885' - 0.7 MILE	4&5	XL - 238
④	HARRISON/CALIFORNIA	GARFIELD TO VAN BUREN	8.0	2354' - 0.4 MILE	6	XL - 239
⑤	JACKSON ST.	INDIANA TO MAGNOLIA	9.0	2738' - 0.5 MILE	7	XL - 240
⑥	MADISON ST.	MAGNOLIA TO ARLINGTON	9.5	1970' - 0.4 MILE	8	XL - 241
⑦	SPRUCE ST.	CHICAGO TO IOWA	9.5	2564' - 0.5 MILE	9	XL - 242
⑧	STREETER AVE.	AT GRAND AVE.	8.5	288' - 0.05 MILE	10	XL - 243

TOTALS: 18,312' - 3.47 MILE

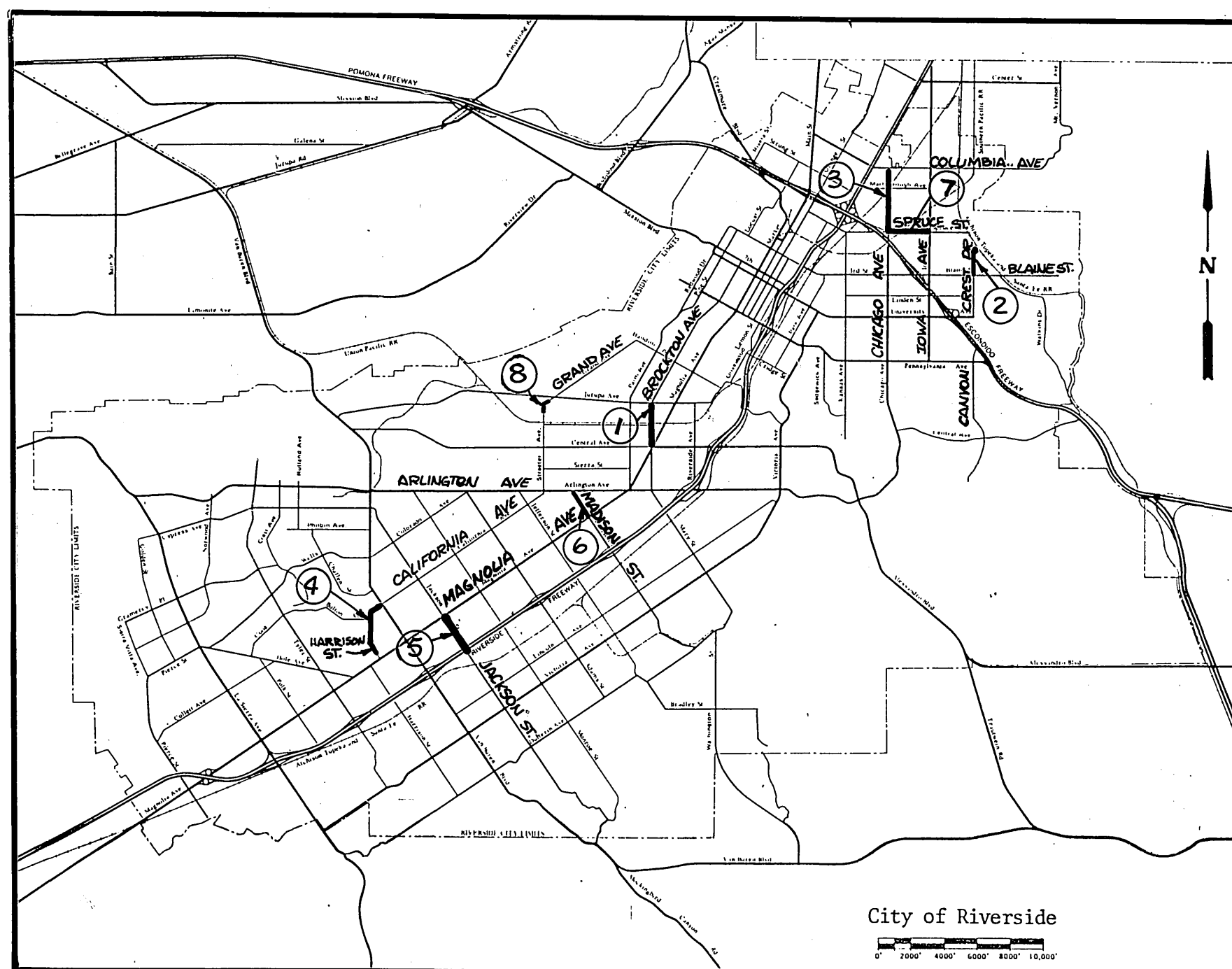

PROJECT LOCATION PLAN

CONSTRUCTION LEGEND

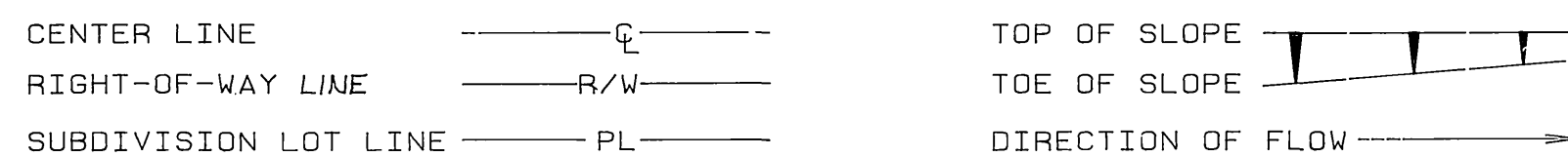

- ADJUST SEWER, STORM DRAIN, ELECTRIC OR WATER MANHOLE OR GATE VALVE TO GRADE. ADJUSTMENT TO GRADE OR RELOCATION OF GAS & TELEPHONE COMPANY'S FACILITIES WILL BE DONE BY OTHERS.
- 0.10' MIN. DGAC (DENSE GRADED AC) OVER ARSAT (ASPHALT RUBBER STRESS ABSORBING TREATMENT). NOTE: RUBBER CHIP (RC) IS THE SAME AS AND IS USED INTERCHANGEABLY WITH ARSAT.
- GRIND EX. AC 0.05 BELOW GUTTER LIP OR OUTER EDGE. "DAY-LIGHTING" IN 5" (TYPE 1 GRINDING) EXCEPT AS SHOWN OTHERWISE ON PLAN AND DESCRIBED IN SPECIAL PROVISIONS.
- TRAFFIC DETECTOR LOOP INSTALLATIONS
- NUMBER OF DETECTOR LOOPS
- PROTECT TRAFFIC DETECTOR LOOPS IN PLACE.
- REMOVE & REPLACE EX. STRUCT. SECT. (CHICAGO) WITH 0.93' DGAC OVER 1.17' CAB.*
- REMOVE & REPLACE EX. STRUCT. SECT. (CANYON CREST) WITH 0.75' DGAC OVER 0.70' CAB.*
- REMOVE & REPLACE EX. STRUCT. SECT. (HARRISON) WITH 0.60' DGAC OVER 0.40' CAB.*
- REMOVE & REPLACE EX. STRUCT. (MADISON & SPRUCE) WITH 0.99' DGAC OVER 0.90' CAB.*
- REMOVE & REPLACE EX. STRUCT. (SPRUCE) WITH 0.99' DGAC OVER 0.67' CAB.*
- *REMOVE ABANDONED TRAFFIC DETECTOR, FRAME AND FOUNDATION.

SPECIFIC CONSTRUCTION NOTES

NUMBERS ABOVE 100 IN A HEXAGON ON THE PLAN REFER TO THE RESPECTIVE STANDARD DRAWING AND SHALL BE CONSTRUCTED ACCORDINGLY. UNLESS MODIFICATIONS ARE NOTED ON THE PLAN OR COVER SHEET. ANY NUMBER SHOWN BELOW THE STANDARD DRAWING NUMBER INDICATES THE SPECIFIC ALTERNATE TO BE CONSTRUCTED.

GENERAL CONSTRUCTION NOTES

1. EXISTING UTILITIES SHOWN ON THIS PLAN ARE PLOTTED FROM UTILITY RECORDS. THE CONTRACTOR IS REQUIRED TO TAKE DUE PRECAUTIONARY MEASURES TO LOCATE AND PROTECT ALL UTILITIES WHETHER OR NOT SHOWN ON THIS PLAN. IF THE COVER OF A UTILITY IS KNOWN, IT IS SHOWN IN THE PROFILE. UTILITIES IN THE PROFILE AS INDICATES THAT THE COVER IS UNKNOWN, BUT THE UTILITY IS NOT EXPECTED TO CONFLICT WITH THE PROPOSED IMPROVEMENTS.
2. ALL ELEVATIONS SHOWN ON THE PLANS SHALL BE STAKED IN THE FIELD.
3. PRIME CONTRACTORS BIDDING THIS WORK SHALL HAVE A CLASS A OR C12 LICENSE.
4. MEDIAN GUTTERS SHALL BE OVERLAID TO THE CURB FACE WHERE ADJACENT RESURFACING OCCURS, UNLESS SHOWN OTHERWISE ON PLAN.
5. THE SEAM BETWEEN PASSES OF THE DENSE GRADED AC OVERLAY SHALL COINCIDE, AS CLOSE AS POSSIBLE, WITH THE LANE LINES.
6. AFTER REMOVAL & PRIOR TO CURB, C&G OR E.P. REPLACEMENTS, FOR DESIGNATED R&R LENGTHS GREATER THAN 50', THE CONTRACTOR SHALL ALLOW 48 HRS. TO REQUEST SURVEY PLUS AN ADDITIONAL 48 HRS. TO RECEIVE PROPOSED GRADES FOR REPLACEMENT IMPROVEMENTS.
7. TRANSVERSE AND LONGITUDINAL CRACKS 3/8" AND LARGER SHALL BE FILLED WITH A RUBBERIZED ASPHALT MATERIAL PRIOR TO OVERLAY OR APPLICATION OF THE RUBBERIZED ASPHALT STRESS ABSORBING TREATMENT (A.R.S.A.T.) WHEN THE PAVEMENT IS TO BE OVERLAID WITH DENSE GRADED AC ONLY ALL CRACKS SHALL BE FILLED WITH A RUBBERIZED ASPHALT MATERIAL (SEE SPECIAL PROVISIONS).
8. MANHOLES & VALVES WITHIN THE GRINDING OR PVMT. REPLACEMENT LIMITS SHALL NOT BE ADJUSTED TO GRADE. INSTEAD, ENOUGH GRINDING (OR PVMT. REMOVAL BY OTHER MEANS.) SHALL BE DONE TO PROVIDE A SMOOTH FINISHED SURFACE TRANSITION AROUND THE COMPLETE CIRCUMFERENCE OF THE STRUCTURE AS NOTED PER PLAN. EXCEPTIONS TO THIS, WHERE ADJUSTMENTS ARE NECESSARY, ARE WHERE MHS& VALVES ARE WITHIN PVMT. REMOVAL AREAS BUT ARE TOO CLOSE (3' OR LESS) TO THE ADJACENT PROPOSED AC OVERLAY.
9. THE RIDGE PRODUCED BY THE EDGE OF THE DENSE GRADED AC OVERLAY SHALL BE MINIMIZED. FEATHER THE DENSE GRADED AC AT INTERSECTIONS TO A MINIMUM THICKNESS (0.03') AT 5' BEYOND THE INDICATED EDGE OF THE OVERLAY.
10. PULL BOXES FOR SPLICING TRAFFIC LOOP DETECTOR CONDUCTORS AND LEAD-IN CABLE ARE NORMALLY ADJACENT TO DETECTORS, UNLESS OTHERWISE SHOWN ON PLAN.
11. RESURFACING LIMITS SHOWN AT INTERSECTIONS ARE NOT ABSOLUTE. THE INSPECTOR MAY REQUEST GRINDING & PAVING INTO SIDE STREETS TO IMPROVE RIDEABILITY.
12. PLANS DO NOT TYPICALLY INDICATE LOCATIONS OF WATER VALVES OR FIRE HYDRANTS TO SIMPLIFY PLAN PREPARATION EFFORT. HOWEVER, THESE FEATURES MUST BE LOCATED DURING CONSTRUCTION TO MAKE VALVE BOX ADJUSTMENTS AND BLUE HYDRANT MARKER INSTALLATIONS IF THESE CONTINGENCY ITEMS ARE AWARDED TO THE CONTRACTOR. EVEN IF THE VALVE BOX ADJUSTMENT CONTINGENCY ITEM IS NOT AWARDED, THE VALVE BOXES MUST BE "TIED OUT" AS PART OF THE CONTRACTOR'S OTHER WORK ORIGATION.

EXISTING UNDERGROUND & TOPOGRAPHY LEGEND

EXISTING UNDERGROUND UTILITIES:

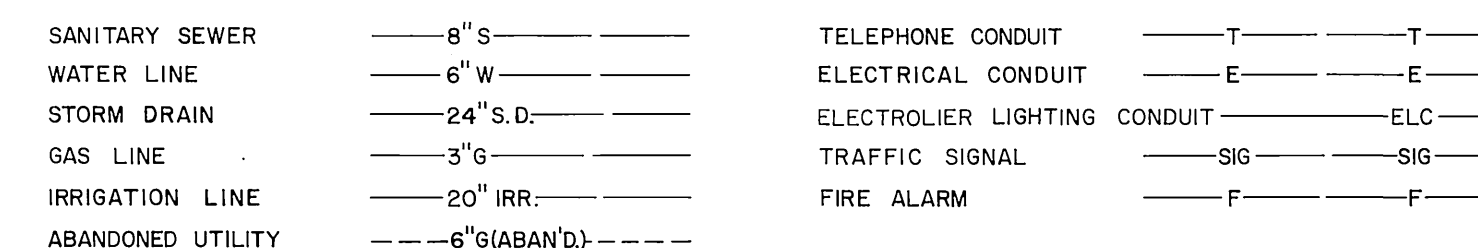

EXISTING TOPOGRAPHY:

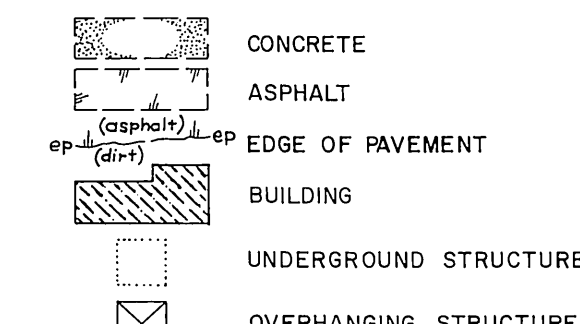
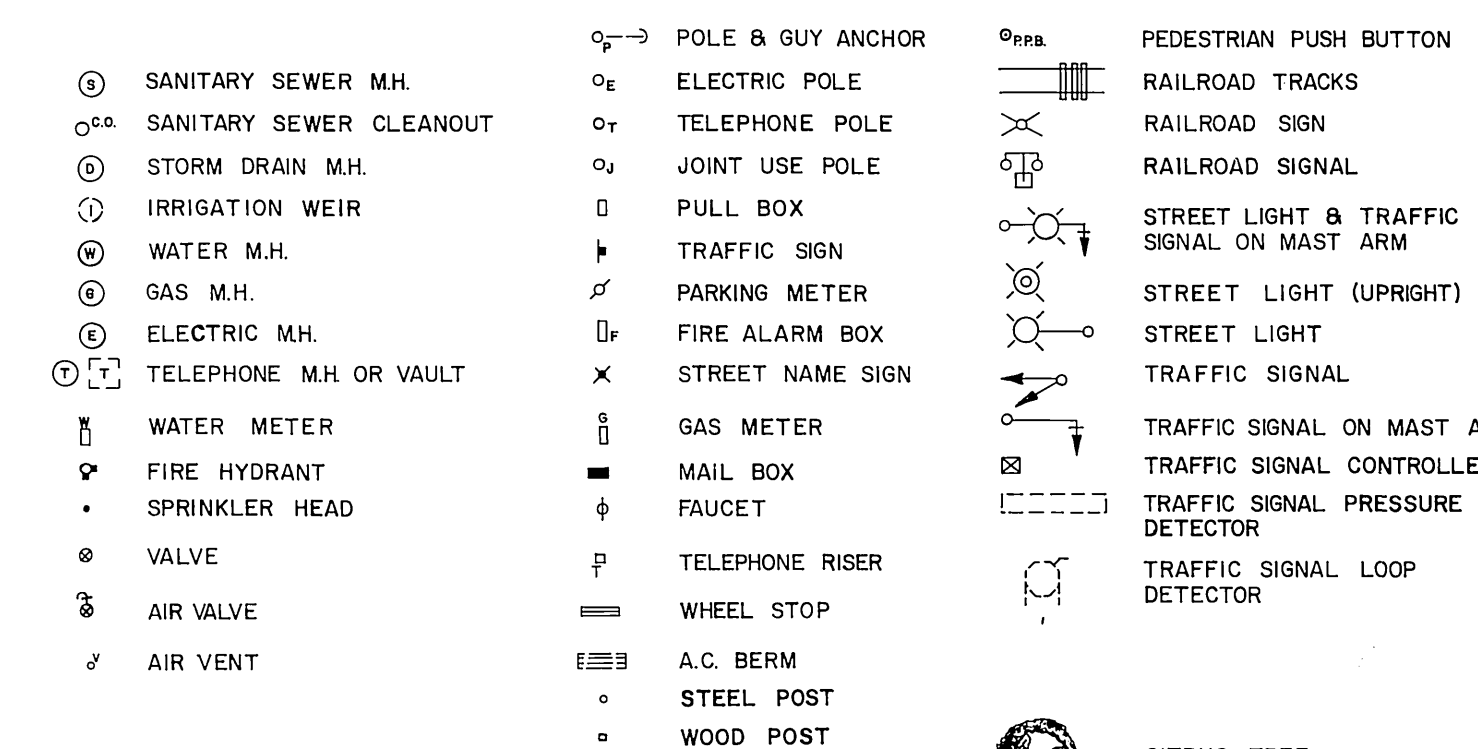
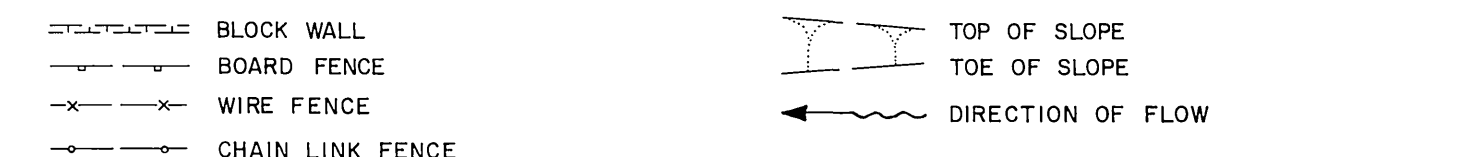

IMPORTANT NOTICE
Section 4216/4217 of the Government Code requires a Dig Alert Identification Number to be issued before a "Permit to Excavate" will be valid. For your Dig Alert I.D. Number call Underground Service Alert TOLL FREE 1-800-422-4133 Two working days before you dig.

<p>ENGINEER IN RESPONSIBLE CHARGE Ronald C. Mueller RONALD C. MUELLER R.C.E. 29510 expires 3-31-91</p>	<p>CITY OF RIVERSIDE PUBLIC WORKS DEPARTMENT</p> <p>APPROVED BY: <i>Barry Beal</i> PRINCIPAL ENGINEER DEPUTY P.W. ENGINEER TRAFFIC DIVISION CHIEF P.W. INSPECTOR SURVEYOR PARK & RECREATION</p>	<p>REHABILITATION OF MAJOR CITY STREETS 1989 - 1990</p> <p>DESIGNED BY JPH, SK DRAWN BY RJM, TP CHECKED BY RCM</p>	<p>ACCOUNT No. 38-575-283-15 DRAWING NUMBER R3050 SHEET 1 OF 10</p>
<p>DATE: 4/17/90</p>		<p>DATE: 4/17/90</p>	

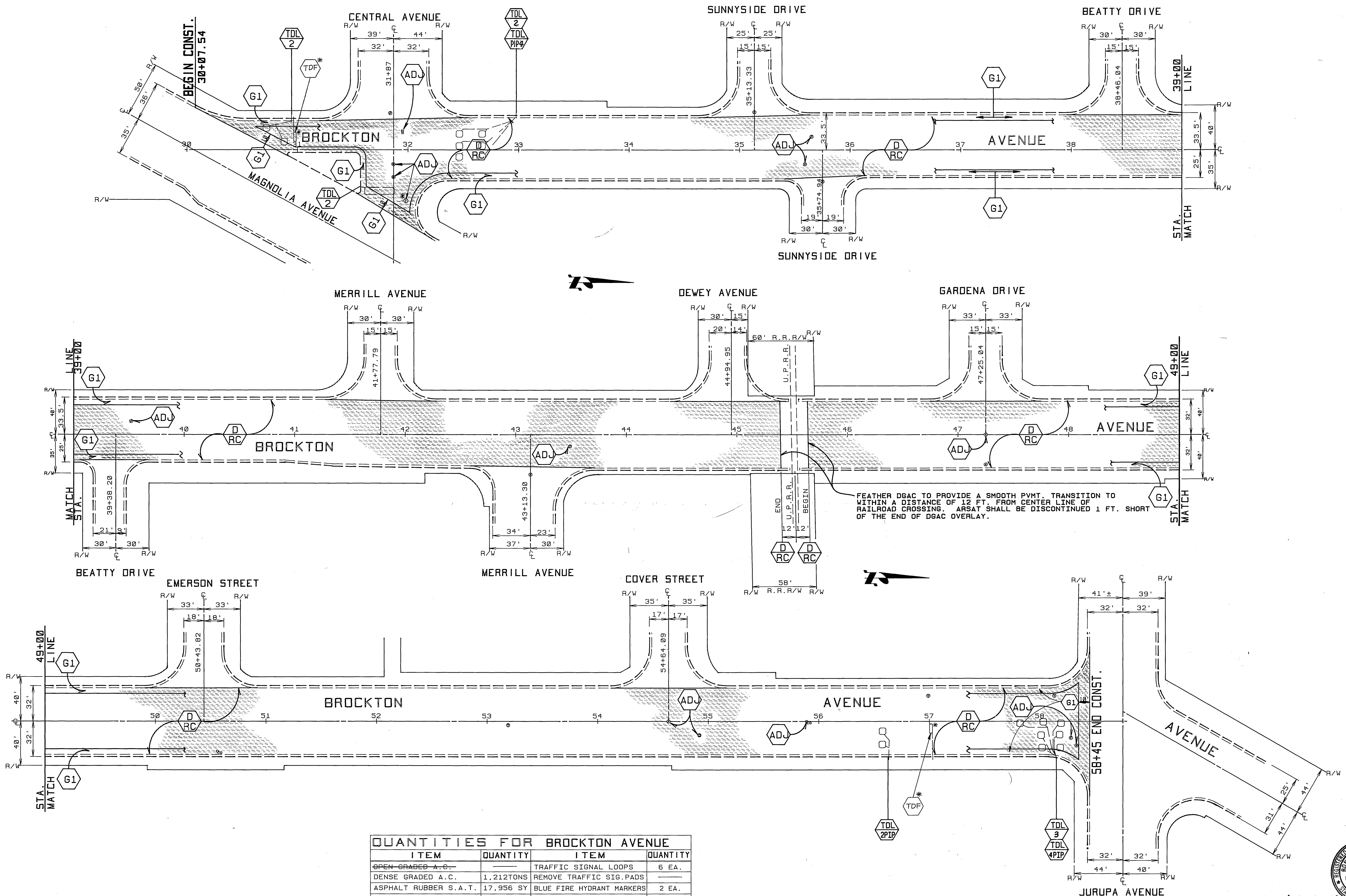

FEATHER DGAC TO PROVIDE A SMOOTH PVMT. TRANSITION TO WITHIN A DISTANCE OF 12 FT. FROM CENTER LINE OF RAILROAD CROSSING. ARSAT SHALL BE DISCONTINUED 1 FT. SHORT OF THE END OF DGAC OVERLAY.

QUANTITIES FOR BROCKTON AVENUE

ITEM	QUANTITY	ITEM	QUANTITY
OPEN GRADED A.C.	---	TRAFFIC SIGNAL LOOPS	6 EA.
DENSE GRADED A.C.	1,212 TONS	REMOVE TRAFFIC SIG. PADS	---
ASPHALT RUBBER S.A.T.	17,956 SY	BLUE FIRE HYDRANT MARKERS	2 EA.
A.C. PVMT. GRINDING, TYPE I	6,176 LF	SIDEWALK STD. DWG. 325	---
EXCAVATION, A.C. & BASE	---	ADJUST ELECTRIC M.H.	---
D/W APPR. PER STD. 302 IV	---	FRAME & COVER TO GRADE	1 EA.
ADJUST SWR. & S.D.M.H.	11 EA.	PAVEMENT PREPARATION 0.5' THICK	---
FRAME & COVER TO GRADE	---	ASPHALT CONCRETE REMOVAL	150 CY
ADJUST WATER GATE VALVE	13 EA.	D.S.A.C. REPLACEMENT	303 TONS
COVER TO GRADE	---		

CITY OF RIVERSIDE PUBLIC WORKS DEPARTMENT		REHABILITATION OF MAJOR CITY STREETS 1989 - 1990 BROCKTON AVENUE MAGNOLIA TO JURUPA		ACCOUNT NO. 30-575-283-15 R3050 SHEET 2 OF 10
APPROVED BY DEPUTY P.W. ENGINEER PRINCIPAL ENGINEER SURVEYOR CHIEF P.W. INSPECTOR TRAFFIC DIVISION PARK & RECREATION	DATE 4/17/90 4/18/90 4/18/90 4/18/90	APPROVED BY PUBLIC WORKS DIRECTOR <i>Ronald C. Mueller</i>	DATE 4/17/90	HORIZ. SCALE: 1" = 40' INDEXED 8-9-90



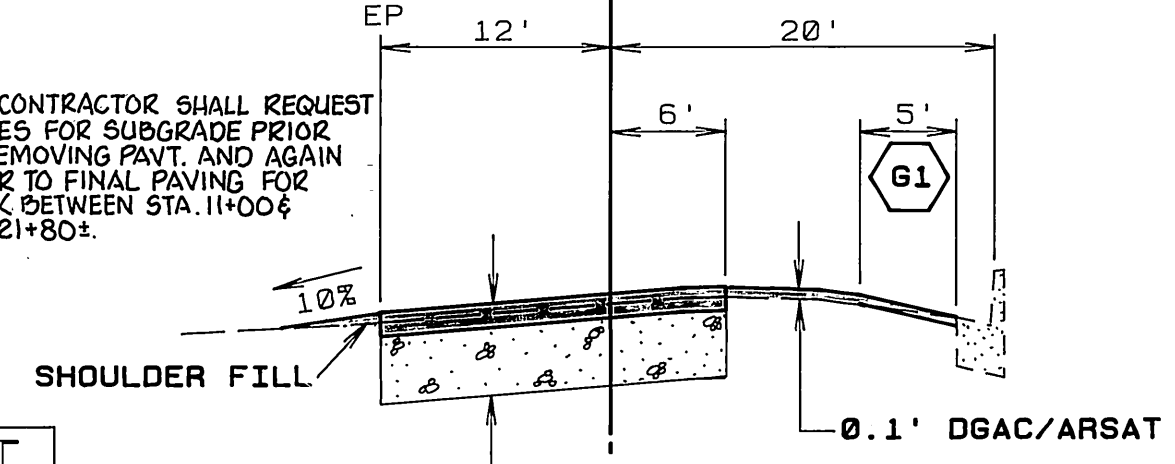
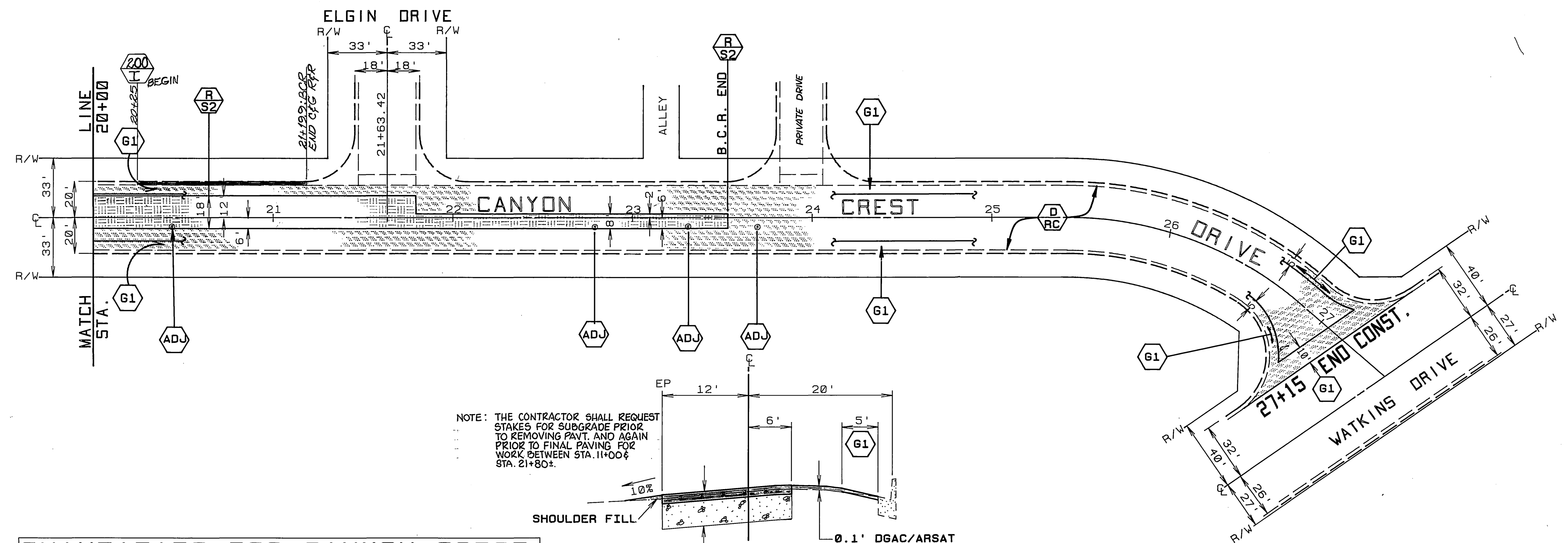
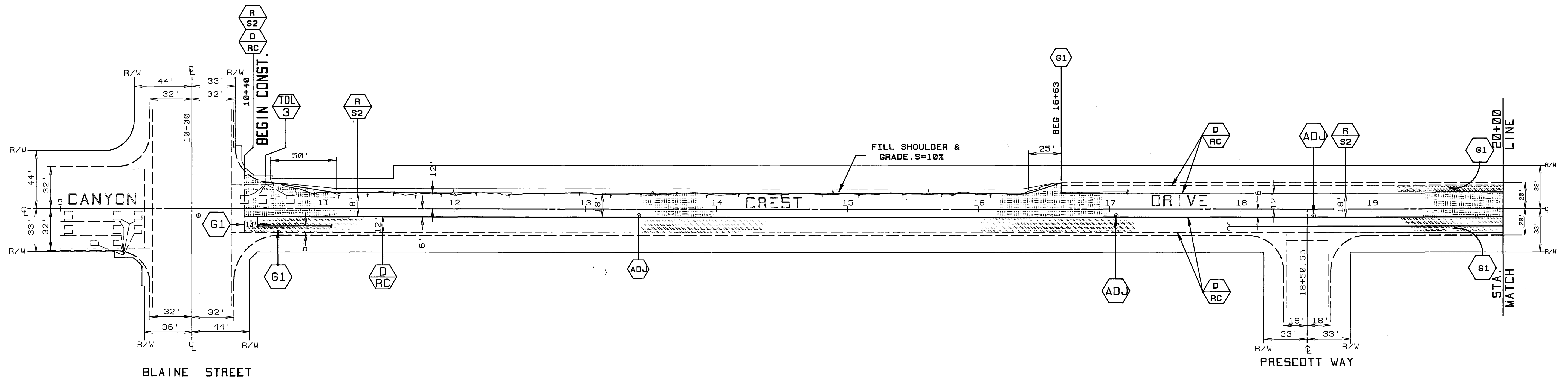

NOTE: THE CONTRACTOR SHALL REQUEST STAKES FOR SUBGRADE PRIOR TO REMOVING PAVT. AND AGAIN PRIOR TO FINAL PAVING FOR WORK BETWEEN STA. 11+00 & STA. 21+80.

QUANTITIES FOR CANYON CREST			
ITEM	QUANTITY	ITEM	QUANTITY
OPEN GRADED A.C.	—	TRAFFIC SIGNAL LOOPS	3 EA.
DENSE GRADED A.C.	691 TONS	REMOVE TRAFFIC SIG. PADS	—
ASPHALT RUBBER S.A.T.	6,435 SY	BLUE FIRE HYDRANT MARKERS	5 EA.
A.C. PVMT. GRINDING, TYPE I	2984 SY	SIDEWALK STD. DWG. 325	—
EXCAVATION, A.C. & BASE	720 CY	WHEEL CHAIR RAMP STD. 304	—
D/W APPR. PER STD. 302 IV	—	CRUSHED AGGREGATE BASE	591 CY
ADJUST SWR. & S.D.M.H. FRAME & COVER TO GRADE	7 EA.	R&R C&G, 200I, 6" C.F.	147 LF
ADJUST WATER GATE VALVE COVER TO GRADE	12 EA.	PAVEMENT PREPARATION 0.5' THICK	—
ENGINEERING FABRIC	—	ASPHALT CONCRETE REMOVAL	26 CY
		D.G.A.C. REPLACEMENT	54 TONS

TYP. SECTION
STA. 11+10 TO 16+28
HOR. SCALE: 1"=10' VERT. SCALE: 1"=2'

CITY OF RIVERSIDE
PUBLIC WORKS DEPARTMENT

APPROVED BY: *[Signature]* DATE: 4/17/90
DEPUTY P.W. ENGINEER

APPROVED BY: *[Signature]* DATE: 4/18/90
PRINCIPAL ENGINEER

APPROVED BY: *[Signature]* DATE: 4/18/90
SURVEYOR

APPROVED BY: *[Signature]* DATE: 4/18/90
CHIEF P.W. INS.

APPROVED BY: *[Signature]* DATE: 4/18/90
TRAFFIC DIVISION

APPROVED BY: *[Signature]* DATE: 4/18/90
PARK & RECREATION

REHABILITATION OF MAJOR CITY STREETS 1989 - 1990

CANYON CREST DRIVE
BLAINE TO WATKINS

HORIZ. SCALE: 1"=40'



Ronald C. Mueller

ACCOUNT NO. 38-575-283-15

R3050

SHEET 3 OF 10

INDEXED 8-9-90

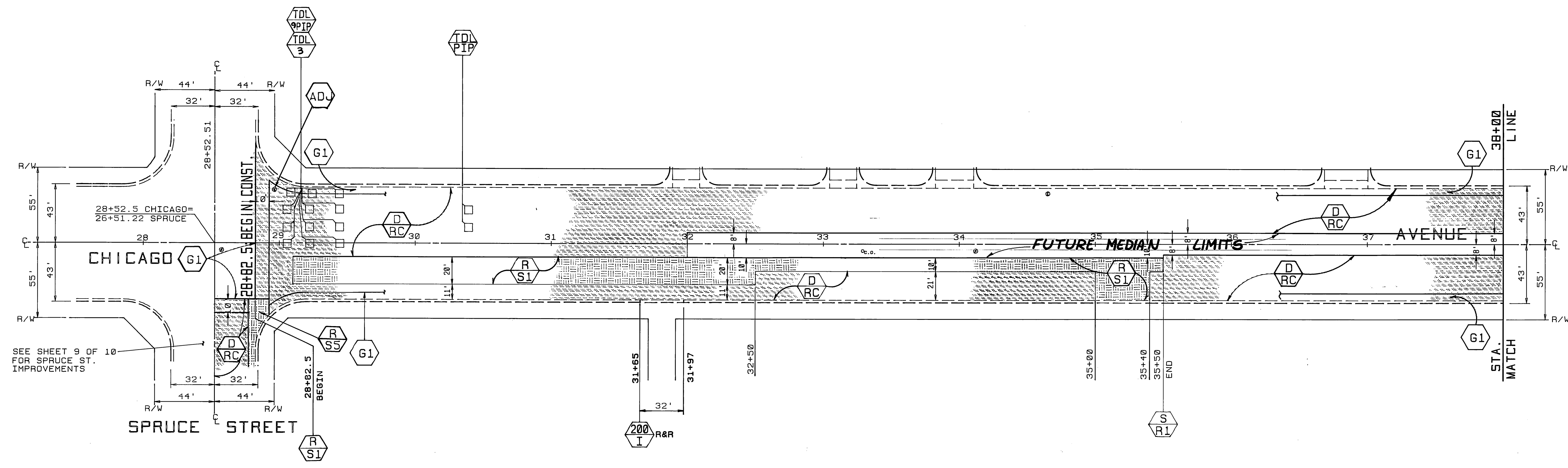

SEE SHEET 9 OF 10 FOR SPRUCE ST. IMPROVEMENTS

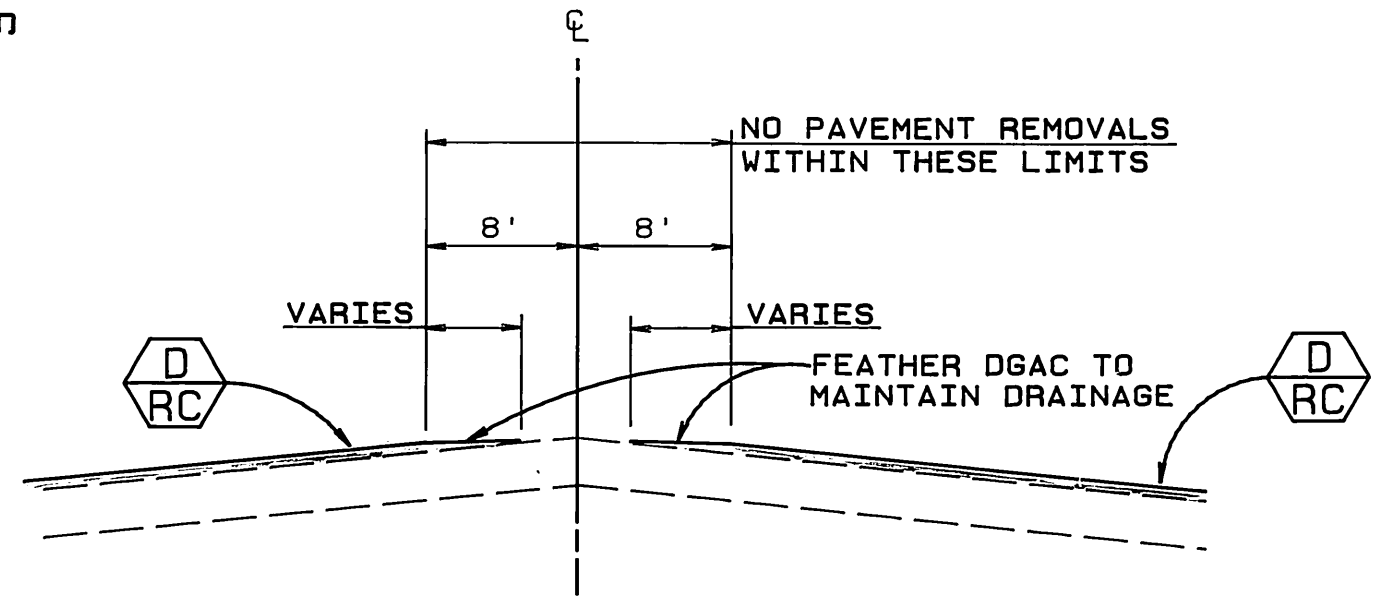
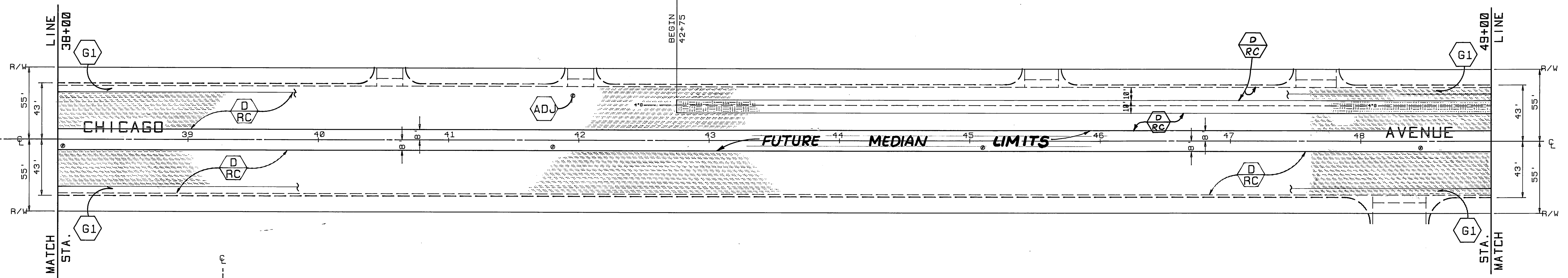

TYP. SECTION
 STA. 32+00 TO 54+50
 HORIZ. SCALE: 1"=10' VERT. SCALE: 1"=2'

QUANTITIES FOR CHICAGO AVE.			
ITEM	QUANTITY	ITEM	QUANTITY
OPEN GRADED A.C.	—	TRAFFIC SIGNAL LOOPS	3 EA.
DENSE GRADED A.C.	2,600 TONS	REMOVE TRAFFIC SIG. PADS	—
ASPHALT RUBBER S.A.T.	29,707 SY	BLUE FIRE HYDRANT MARKERS	8 EA.
A.C. PVMT. GRINDING, TYPE I	8,514 LF	ADJUST ELECTRIC MH FRAME & COVER TO GRADE	4 EA.
EXCAVATION, A.C. @BASE	1,105 CY	CRUSHED AGGREGATE BASE	862 CY
D/W APPR. PER STD. 302 IV	—	⊕ PAVEMENT PREPARATION @.5' THICK	—
ADJUST SWR. & S.D.M.H. FRAME & COVER TO GRADE	6 EA.	ASPHALT CONCRETE REMOVAL	263 CY
ADJUST WATER GATE VALVE COVER TO GRADE	20 EA.	D.G.A.C. REPLACEMENT	532 TONS
C&G R&R STD 200, TYPE I	32 LF		

CITY OF RIVERSIDE
 PUBLIC WORKS DEPARTMENT

REHABILITATION OF MAJOR CITY STREETS 1989 - 1990
 CHICAGO AVENUE
 SPRUCE TO COLUMBIA

APPROVED BY: [Signature] DATE: 4/17/90
 DEPUTY P.W. ENGINEER
 SURVEYOR: [Signature] DATE: 4/13/90
 CHIEF P.W. INSPECTOR: [Signature] DATE: 4/18/90
 TRAFFIC DIVISION: [Signature] DATE: 4/17/90

APPROVED BY: [Signature] DATE: 4/17/90
 PUBLIC WORKS DIRECTOR

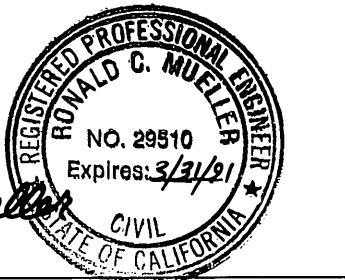

Ronald C. Mueller

AS BUILT 2/23/93 RJM

ACCOUNT NO. 30-575-263-15

R3050

SHEET 4 OF 10

DESIGNED BY: JRM DRAWN BY: RJM, TP CHECKED BY: ACM

HORIZ. SCALE: 1"=40'

INDEXED 8-9-90

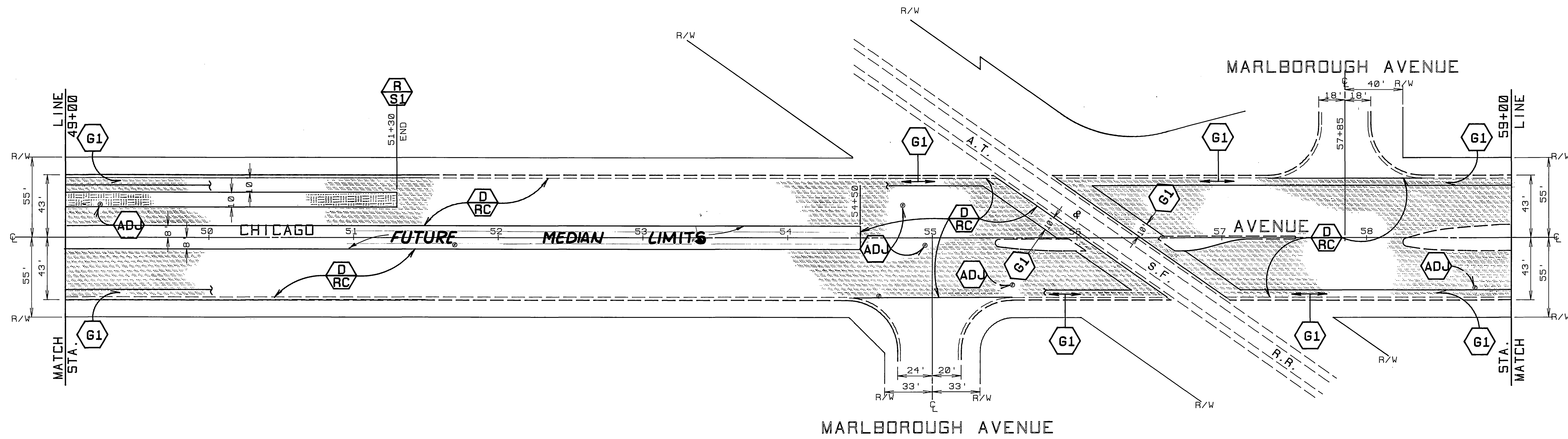

MARBOROUGH AVENUE

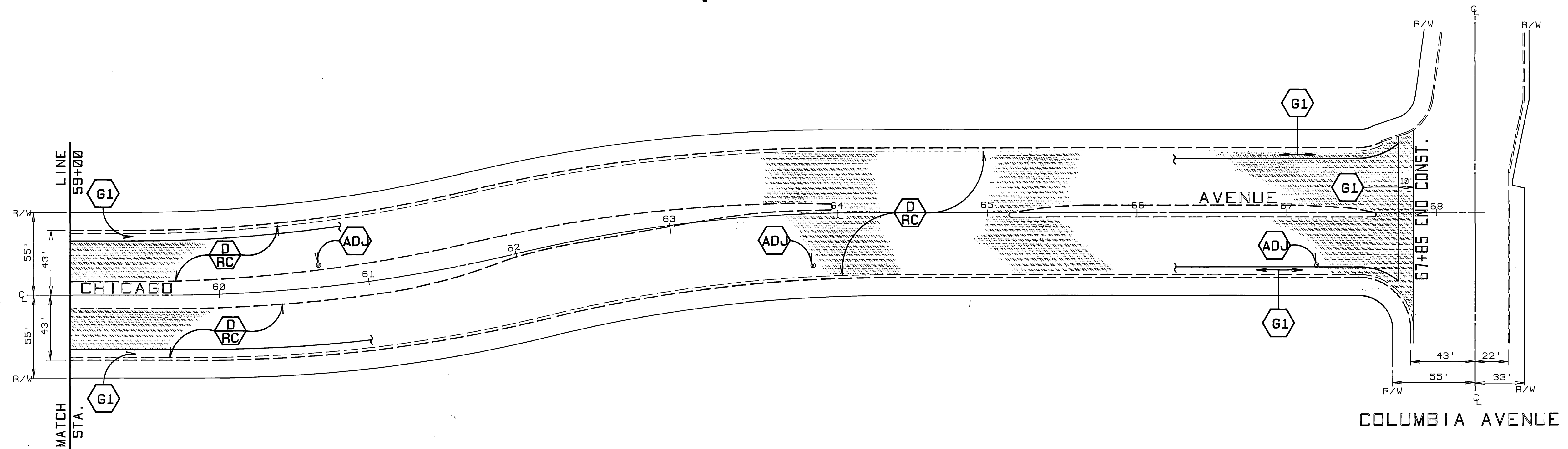

COLUMBIA AVENUE

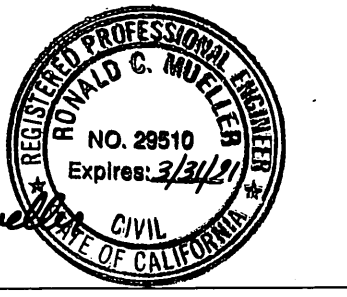

Ronald C. Mueller

AS BUILT 8/23/93 RJM

CITY OF RIVERSIDE PUBLIC WORKS DEPARTMENT		REHABILITATION OF MAJOR CITY STREETS 1989 - 1990		ACCOUNT NO. 38-575-283-15	
		CHICAGO AVENUE SPRUCE TO COLUMBIA		R3050 SHEET 5 OF 10	
APPROVED BY DEPUTY P.W. ENGINEER PRINCIPAL ENGINEER SURVEYOR	DATE 4/17/90 4/13/90 4/13/90	APPROVED BY PUBLIC WORKS DIRECTOR	DATE 4/17/90	HORIZ. SCALE: 1" = 40' INDEXED 8-9-90	
DESIGNED BY JRH, DRAWN BY RJM, CHECKED BY REM		TRAFFIC DIVISION PARK & RECREATION			

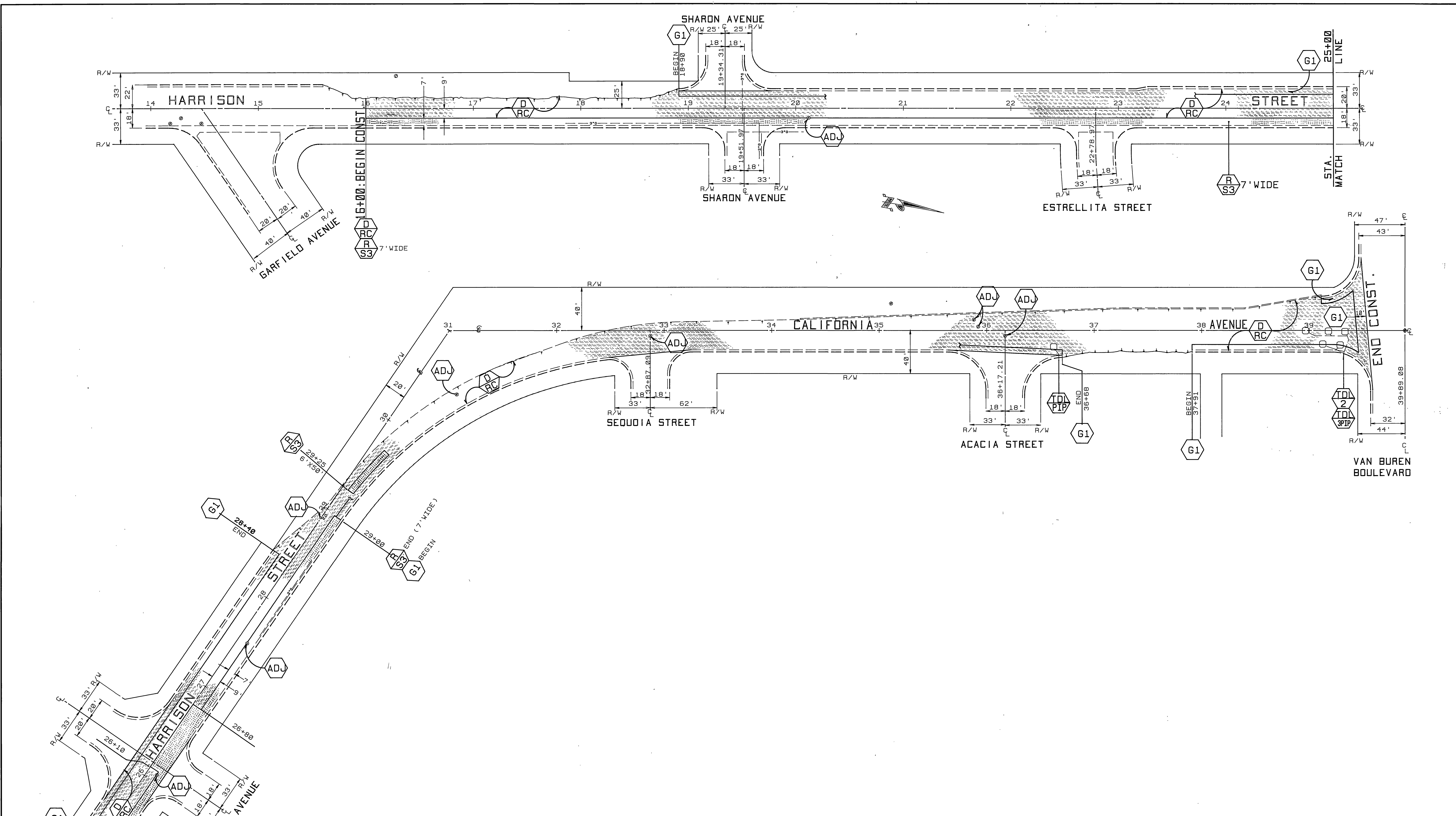

QUANTITIES FOR HARRISON / CALIF.			
ITEM	QUANTITY	ITEM	QUANTITY
OPEN GRADED A.C.	---	TRAFFIC SIGNAL LOOPS	2 EA.
DENSE GRADED A.C.	780 TONS	REMOVE TRAFFIC SIG.PADS	---
ASPHALT RUBBER S.A.T.	8,063 SY	BLUE FIRE HYDRANT MARKERS	3 EA.
A.C.PVMT. GRINDING, TYPE I	2,148 LF	CRUSHED AGGREGATE BASE	150 CY
EXCAVATION, A.C.&BASE	260 CY	WHEEL CHAIR RAMP STD.304	---
D/W APPR. PER STD.302 IV	---	ADJUST WATER M.H. FRAME & COVER TO GRAD TO GRADE	1 EA.
ADJUST SWR. & S.D.M.H. FRAME & COVER TO GRADE	7 EA.	⊕ PAVEMENT PREPARATION 0.4" THICK	---
ADJUST WATER GATE VALVE COVER TO GRADE	15 EA.	ASPHALT CONCRETE REMOVAL	54 CY
		D.G.A.C. REPLACEMENT	109 TONS

AS BUILT 2/23/93 R.M. *Ronald C. Mueller*

CITY OF RIVERSIDE
PUBLIC WORKS DEPARTMENT

APPROVED BY	DATE	BY	APPROVED BY
DEPUTY P.W. ENGINEER	4/17/90	RMG	APPROVED BY
PRINCIPAL ENGINEER	4/15/90	---	---
SURVEYOR	4/15/90	---	---
CHIEF P.W. INSPECTOR	4/15/90	---	---
TRAFFIC DIVISION	---	---	---
PARK & RECREATION	---	---	---

DATE: 4/17/90

REHABILITATION OF MAJOR CITY STREETS 1989 - 1990

HARRISON / CALIFORNIA
GARFIELD TO VAN BUREN

ACCOUNT NO. 98-575-283-15
R3050
SHEET 6 OF 10

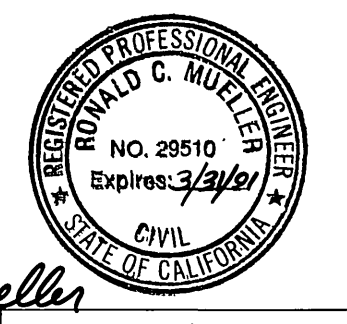

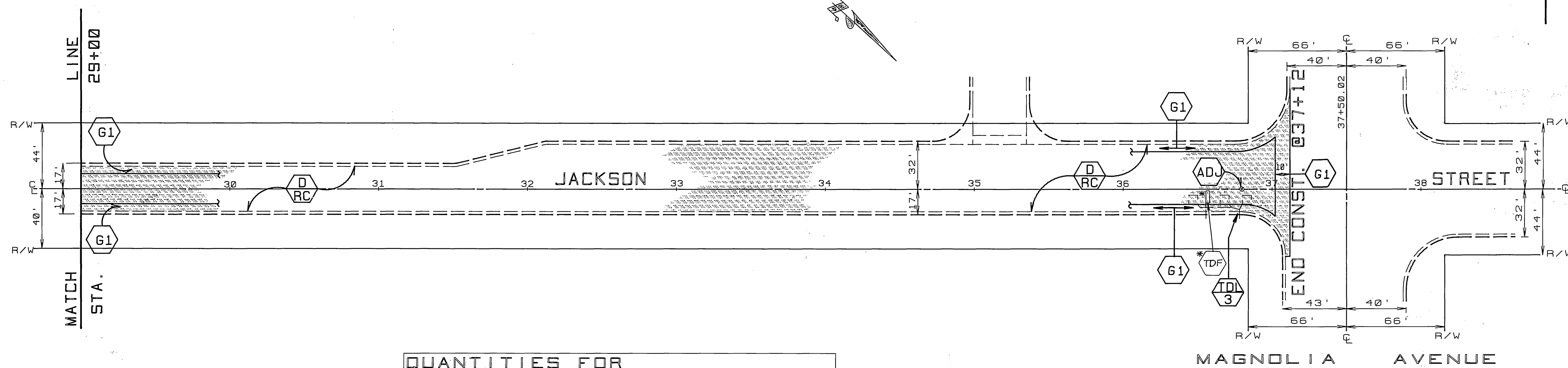
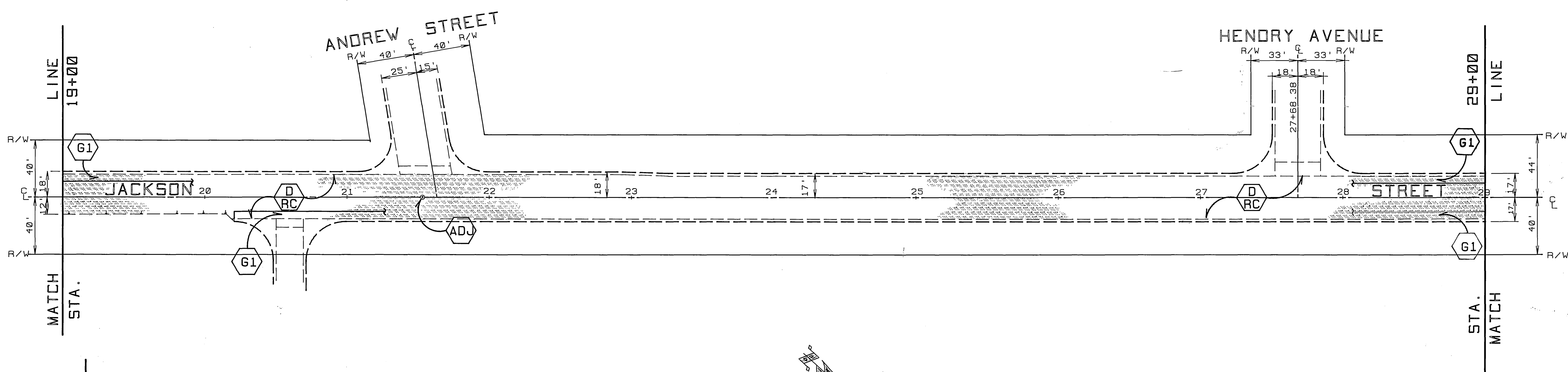
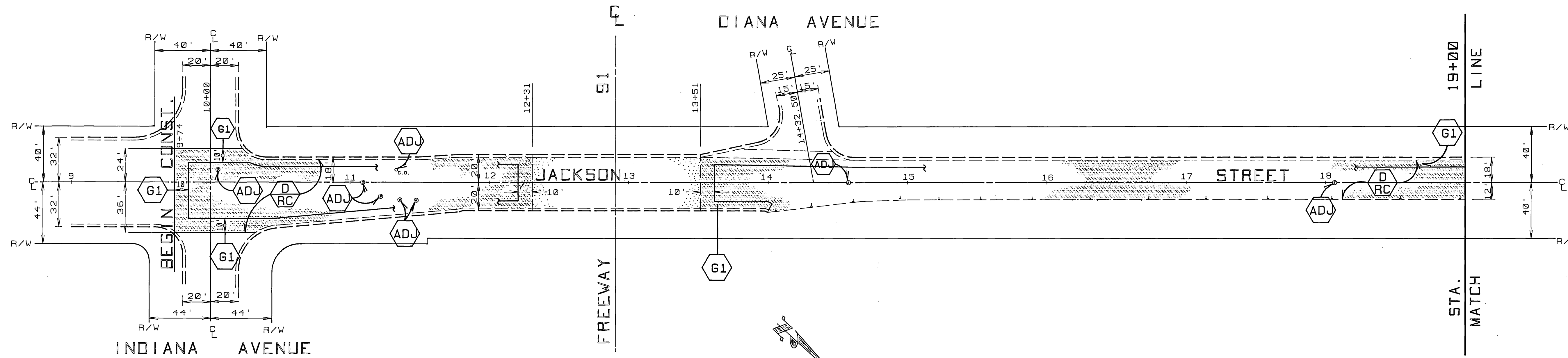

QUANTITIES FOR			
ITEM	QUANTITY	ITEM	QUANTITY
OPEN GRADED A.C.	—	TRAFFIC SIGNAL LOOPS	3 EA.
DENSE GRADED A.C.	687 TONS	REMOVE TRAFFIC SIG.PADS	—
ASPHALT RUBBER S.A.T.	10,174 SY	BLUE FIRE HYDRANT MARKERS	6 EA.
A.C.PVMT. GRINDING, TYPE I	4,890 LF	SIDEWALK STD.DWG.325	—
EXCAVATION, A.C.&BASE	—	WHEEL CHAIR RAMP STD.304	—
D/W APPR. PER STD.302 IV	—	ADJUST WATER MANHOLE FRAME & COVER TO GRADE	3 EA.
ADJUST SWR. & S.D.M.H. FRAME & COVER TO GRADE	7 EA.	⊕ PAVEMENT PREPARATION 0.25" THICK	—
ADJUST WATER GATE VALVE COVER TO GRADE	21 EA.	ASPHALT CONCRETE REMOVAL	42 CY
		D.G.A.C. REPLACEMENT	86 TONS

CITY OF RIVERSIDE PUBLIC WORKS DEPARTMENT		REHABILITATION OF MAJOR CITY STREETS 1989 - 1990 JACKSON STREET INDIANA TO MAGNOLIA		ACCOUNT NO. 38-575-283-15 R3050 SHEET 7 OF 10
APPROVED BY: _____ DATE: _____ DEPUTY P.W. ENGINEER	APPROVED BY: <i>Benny Boal</i> DATE: 4/17/90 PUBLIC WORKS DIRECTOR	DESIGNED BY: <i>JRH</i> DRAWN BY: <i>BJM</i> CHECKED BY: <i>ACM</i>	CHIEF P.W. INSPECTOR: _____ DATE: 4/17/90 TRAFFIC DIVISION PARK & RECREATION	*AS BUILT 2/23/93 RUM <i>Ronald C. Mueller</i> REGISTERED PROFESSIONAL ENGINEER NO. 29510 Expires: 3/31/91 CIVIL STATE OF CALIFORNIA

HORIZ. SCALE: 1" = 40'
 INDEXED 8-9-90

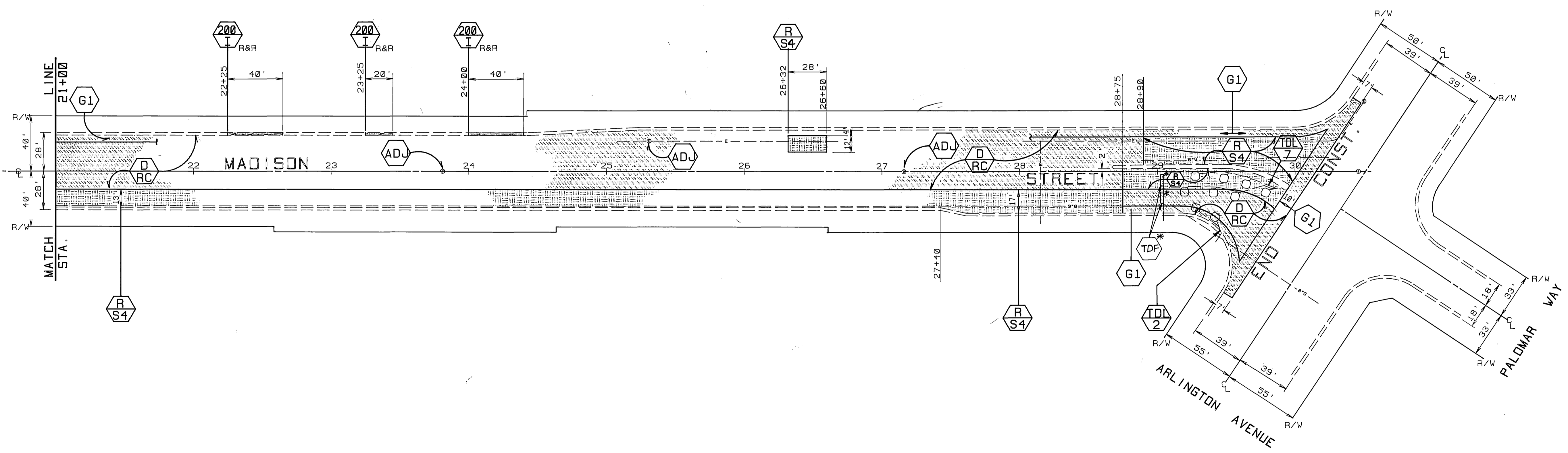
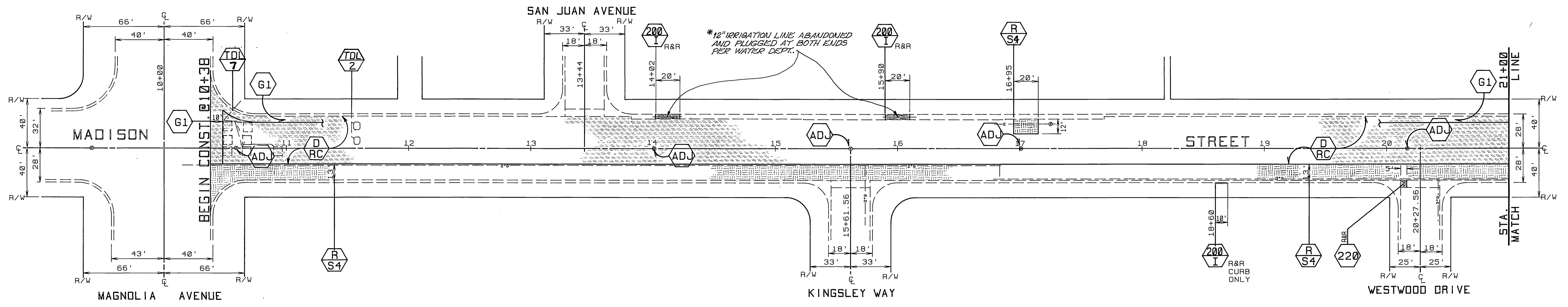

QUANTITIES FOR MADISON STREET			
ITEM	QUANTITY	ITEM	QUANTITY
OPEN GRADED A.C.	—	TRAFFIC SIGNAL LOOPS	18 EA.
DENSE GRADED A.C.	2,090 TONS	REMOVE TRAFFIC SIG.PADS	—
ASPHALT RUBBER S.A.T.	12,092 SY	BLUE FIRE HYDRANT MARKERS	3 EA.
A.C.PVMT. GRINDING, TYPE I	2,225 LF	ADJUST ELECTRIC MH FRAME & COVER TO GRADE	1 EA.
EXCAVATION, A.C.&BASE	1332 CY	CRUSHED AGGREGATE BASE	975 CY
D/W APPR. PER STD.302 IV	—	R&R CURB&GUTTER STD.DWG.200	150 LF
ADJUST SWR. & S.D.M.H. FRAME & COVER TO GRADE	7 EA.	PAVEMENT PREPARATION 0.33' THICK	—
ADJUST WATER GATE VALVE COVER TO GRADE	5 EA.	ASPHALT CONCRETE REMOVAL	49 CY
R&R CROSS GUTTER	30 SF	D.G.A.C. REPLACEMENT	100 TONS

CITY OF RIVERSIDE
PUBLIC WORKS DEPARTMENT

REHABILITATION OF MAJOR CITY STREETS 1989 -1990
MADISON STREET
MAGNOLIA TO ARLINGTON

*AS BUILT 2/23/93 RUM
Ronald C. Mueller
ACCOUNT NO. 38-575-283-15

R3050
SHEET 8 OF 10

HORIZ. SCALE: 1" = 40'
INDEXED 8-9-90

APPROVED BY: DATE: APPROVED BY: DATE:
DEPUTY P.W. ENGINEER: 4/17/90: PRINCIPAL ENGINEER: Barry Best: 4/17/90:
SURVEYOR: 4/18/90: CHIEF P.W. INSPECTOR: 4/17/90:
TRAFFIC DIVISION: PARK & RECREATION: DATE: 4/17/90

DESIGNED BY: JURH DRAWN BY: R.M.J.P. CHECKED BY: RUM

SEE SHEET 4 OF 10
FOR CHICAGO AVE.
IMPROVEMENTS.

26+51.22 SPRUCE ST. =
28+52.51 CHICAGO AVE.

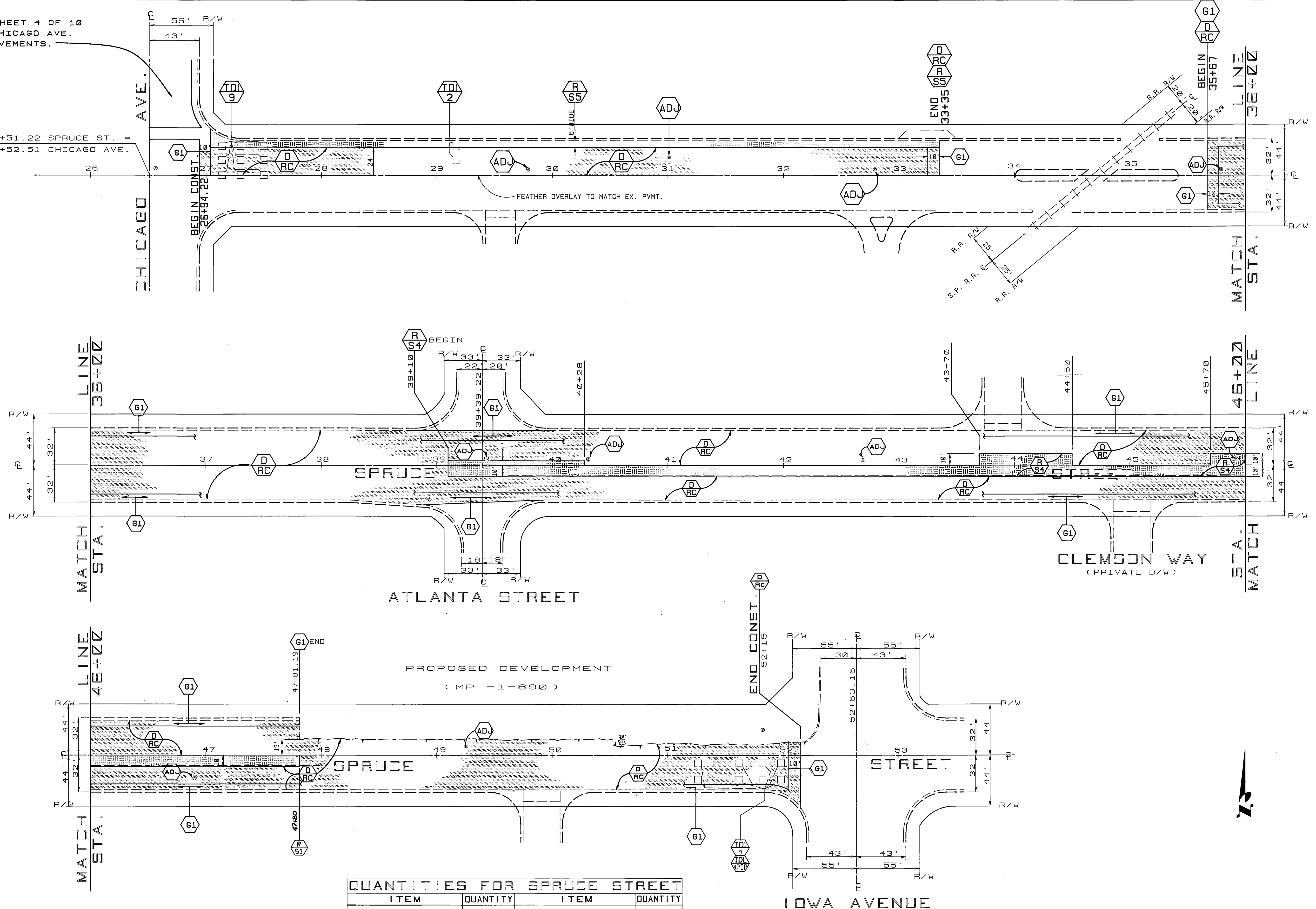

QUANTITIES FOR SPRUCE STREET			
ITEM	QUANTITY	ITEM	QUANTITY
OPEN GRADED A.C.		TRAFFIC SIGNAL LOOPS	15 EA.
DENSE GRADED A.C.	1,136 TONS	REMOVE TRAFFIC SIG. PADS	
ASPHALT RUBBER S.A.T.	11,598 SY	BLUE FIRE HYDRANT MARKERS	3 EA.
A.C. PVMT. GRINDING, TYPE I	3,190 LF	SIDEWALK STD. DWG. 325	
EXCAVATION, A.C. & BASE	528 CY	WHEEL CHAIR RAMP STD. 304	
D/W APPR. PER STD. 302 IV		CRUSHED AGGREGATE BASE	350 CY
ADJUST SWR. & S.D.M.H. FRAME & COVER TO GRADE	8 EA.	⊕ PAVEMENT PREPARATION 0.33" THICK	
ADJUST WATER GATE VALVE COVER TO GRADE	11 EA.	ASPHALT CONCRETE REMOVAL	46 CY
ADJ. WATER VAULT TO GRADE	1 EA.	D.G.A.C. REPLACEMENT	93 TONS

CITY OF RIVERSIDE PUBLIC WORKS DEPARTMENT		REHABILITATION OF MAJOR CITY STREETS 1989 - 1990		ACCOUNT NO. 38-575-283-15
APPROVED BY: <i>[Signature]</i> DATE: 4/17/90		APPROVED BY: <i>[Signature]</i> DATE: 4/17/90		R-3050
DESIGNED BY: JRH DRAWN BY: BJM, TP CHECKED BY: RMM		AS BUILT 2/23/93 RUM Ronald C. Mueller CIVIL ENGINEER STATE OF CALIFORNIA		SHEET 9 OF 10

INDEXED 8-2-90

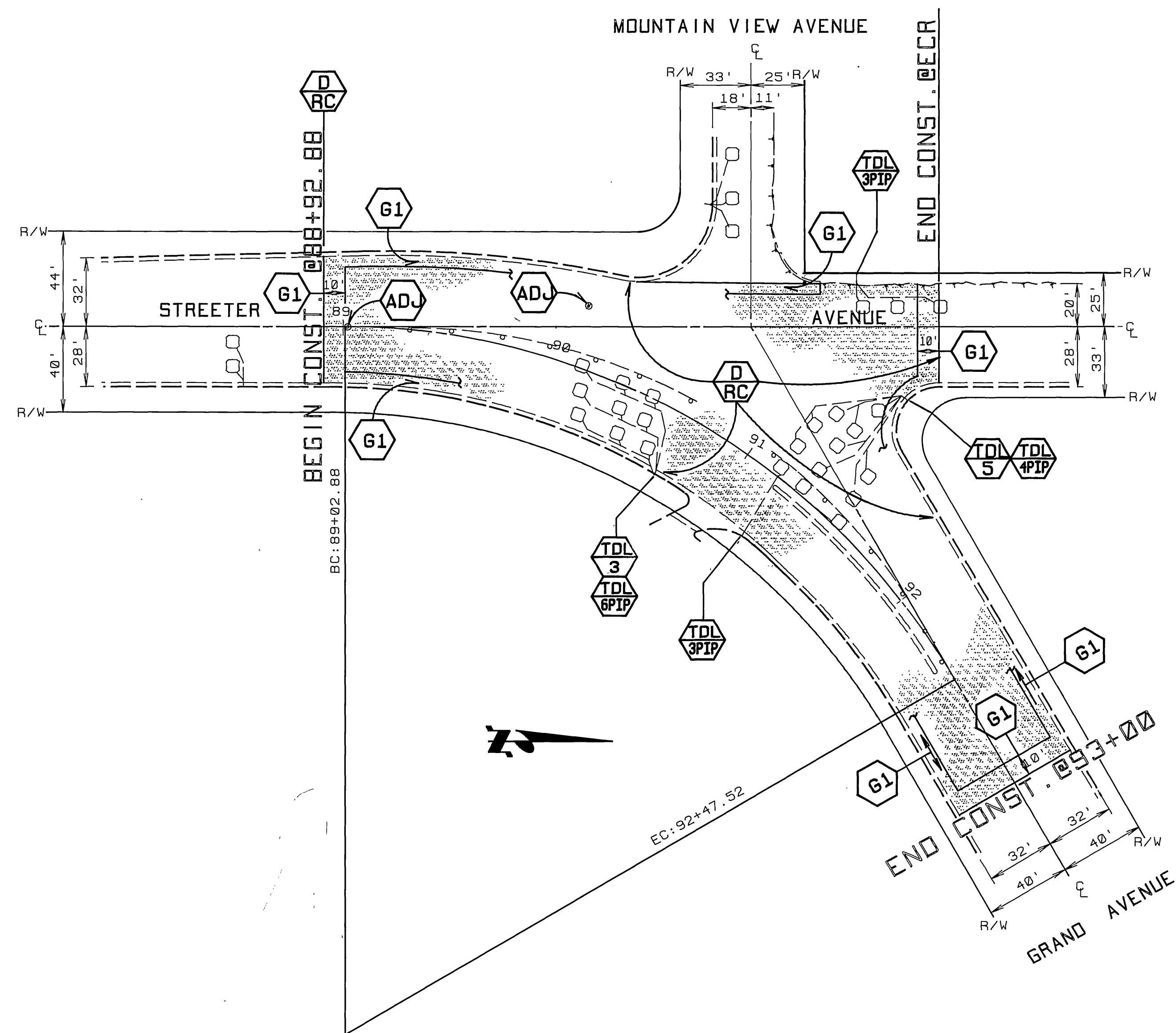

QUANTITIES FOR STREETER @ GRAND

ITEM	QUANTITY	ITEM	QUANTITY
OPEN GRADED A.C.	—	TRAFFIC SIGNAL LOOPS	8 EA.
DENSE GRADED A.C.	249 TONS	REMOVE TRAFFIC SIG. PADS	—
ASPHALT RUBBER S.A.T.	3,684 SY	BLUE FIRE HYDRANT MARKERS	1 EA.
A.C. PVMT. GRINDING, TYPE I	1129 LF	SIDEWALK STD. DWG. 325	—
EXCAVATION, A.C. & BASE	—	WHEEL CHAIR RAMP STD. 304	—
D/W APPR. PER STD. 302 IV	—	CL. 2 CRUSHED AGGREGATE BASE	—
ADJUST SWR. & S.D.M.H. FRAME & COVER TO GRADE	1 EA.	⊕ PAVEMENT PREPARATION @ .5" THICK	—
ADJUST WATER MAN HOLE COVER TO GRADE	1 EA.	ASPHALT CONCRETE REMOVAL	31 CY
ADJUST WATER G. V. TO GRADE	3 EA.	D.G.A.C. REPLACEMENT	63 TONS

DESIGNED BY <u>JRM</u> DRAWN BY <u>RJM</u> CHECKED BY <u>PCD</u>		CITY OF RIVERSIDE PUBLIC WORKS DEPARTMENT		REHABILITATION OF MAJOR CITY STREETS 1989 - 1990 STREETER AT GRAND AVENUE	
APPROVED BY	DATE	APPROVED BY	DATE	ACCOUNT NO. 38-575-283-15	R3050 SHEET 10 OF 10
DEPUTY P.W. ENGINEER	4/17/90	DEPUTY P.W. ENGINEER	4/17/90	NO. 29510	
PRINCIPAL ENGINEER	4/17/90	PRINCIPAL ENGINEER	4/17/90	Expires: 4/17/91	
SURVEYOR	4/18/90	SURVEYOR	4/18/90	CIVIL	
CHIEF P.W. INSPECTOR	4/18/90	CHIEF P.W. INSPECTOR	4/18/90	STATE OF CALIFORNIA	
TRAFFIC DIVISION	4/17/90	TRAFFIC DIVISION	4/17/90		
PARK & RECREATION		PARK & RECREATION			



AS BUILT 2/23/93 RJM Ronald C. Mueller

HORIZ. SCALE: 1" = 40'

INDEXED 8-2-90