

FOURTEENTH STREET

THIRTEENTH STREET

TWELFTH STREET

ELEVENTH STREET

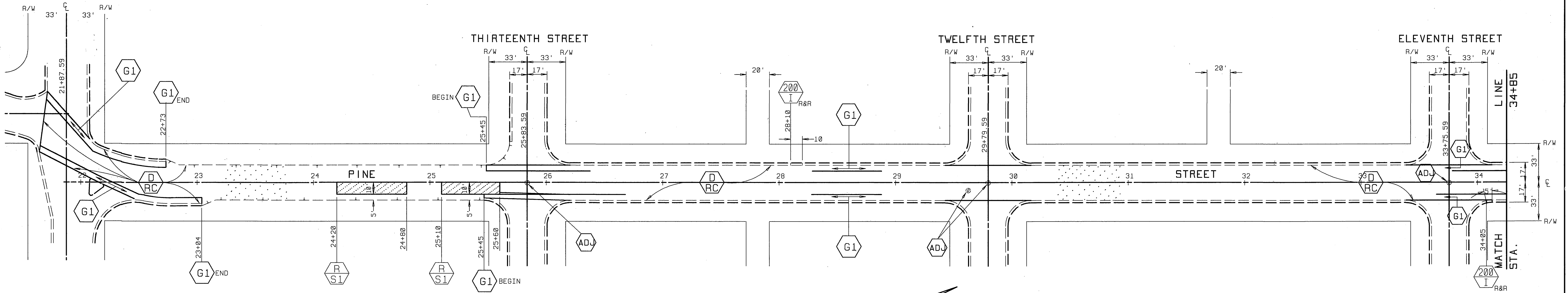

TENTH STREET

NINTH STREET

UNIVERSITY AVENUE

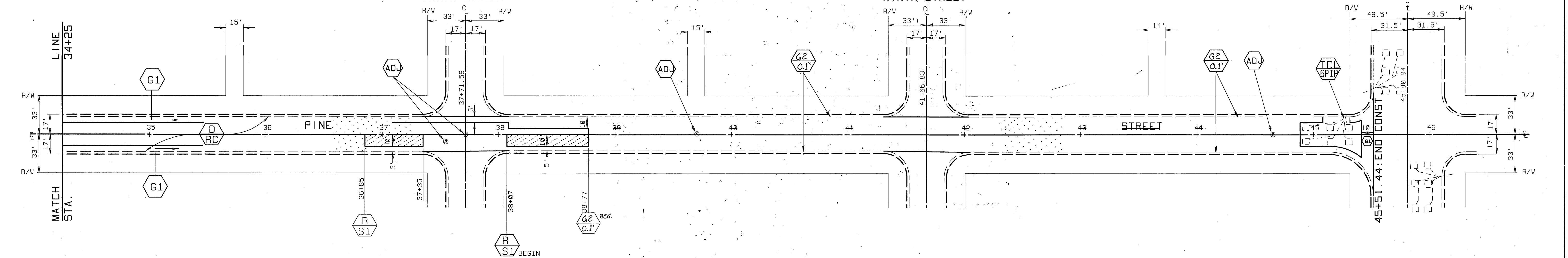

QUANTITIES FOR PINE STREET

ITEM	QUANTITY	ITEM	QUANTITY
DENSE GRADED A.C.	620 TONS	TACK COAT UNDER ARSAT	389 GAL.
ASPHALT RUBBER S. A. T.	8036 SY	BLUE FIRE HYDRANT MARKERS	5 EA.
A.C. PVMT. GRINDING, TYPE I	4352 LF	CRACK SEALING	4800 LF
EXCAVATION, A.C. & BASE	45 CY		
R&R C&G, 200-I (6" CF)	10 LF		
ADJUST SWR. & S.D.M.H.	8 EA.		
FRAME & COVER TO GRADE		⊕ PAVEMENT PREPARATION (0.5' THICK)	
ADJUST WATER GATE VALVE	11 EA.	ASPHALT CONCRETE REMOVAL	67 CY
COVER TO GRADE		D.G.A.C. REPLACEMENT	134 TONS

CITY OF RIVERSIDE  
PUBLIC WORKS DEPARTMENT

REHABILITATION OF MAJOR  
CITY STREETS 89-90

ACCOUNT NO. 38-575-283-96

APPROVED BY: [Signature]  
DEPUTY P.W. ENGINEER  
DATE: 2/14/92  
PRINCIPAL ENGINEER  
DATE: 2/14/92  
CHIEF P.W. INSPECTOR  
DATE: 2/14/92  
TRAFFIC DIVISION  
STREET SERVICES

APPROVED BY: [Signature]  
PUBLIC WORKS DIRECTOR  
DATE: 2/14/92

R-3143A

SHEET 1 OF 1

HORIZ. SCALE: 1" = 40' VERT. SCALE: 1" =

INDEXED 11-24-92 G/H

