

GENERAL TREE PLANTING NOTES:

- All related work shall conform to the City of Riverside Park and Recreation Dept. Standards and City of Riverside Street Tree Policies.
- When calling for inspections, contact the Street Tree Inspector a minimum of 24 hours in advance, at (714) 351-4138 to schedule an inspection. A final notice will be issued as written approval for each stage of inspection. A verbal will not be acceptable. Inspections are required:
 - After completion of final grading of the lot and where all utility services and sewer laterals have been marked, but prior to digging plant pits, all final street tree locations are to be spotted in the field by the street tree inspector.
 - While digging plant pits and planting/relocating trees.
 - After planting and all other indicated or specified work has been completed, for start of maintenance.
 - At the end of the maintenance period, the contractor/developer shall call the street tree inspector at (714) 351-4138 for a final acceptance inspection in order to be released from maintenance. Developers bonds will not be released until after receipt of written notification from the City that the trees pass final inspection and the park and recreation department is assuming maintenance responsibilities.
- ALL STREET TREES ARE TO BE PLANTED PRIOR TO OCCUPANCY.
- The developer shall be responsible to acceptably maintain all plantings for a minimum period of one (1) year.
- Street tree planting shall be as follows:

Street Name	Botanical Name / Common Name	Min. Size	Approx. Spacing	No. Req'd
Arlington Ave	Magnolia Grandiflora / Majestic Beauty / Magnolia	15 gallon	45'	7
- Both a street tree relocation/removal permit as issued by the Park and Recreation Department and a Street Opening Permit as issued by the Public Works Department are required prior to the commencement of tree relocation and/or removal work. For all existing trees within what will ultimately be the Public Right-of-way pavement area, backfill of all holes must be inspected by the Public Works Inspector for proper completion.
- All street trees must be automatically irrigated where adjacent to single family or duplex residential uses.

GENERAL NOTES:

- It shall be the responsibility of the contractor to clear the right-of-way in accordance with the provisions of the law as it affects each utility including irrigation lines and appurtenances and at no cost to the City.
- Construction shall be in accordance with the City of Riverside Department of Public Works, Standard Drawings, Standard Drawing No. 10 and the Standard Specifications for Public Works Construction, current edition.
- The private engineer signing these plans is responsible for assuring the accuracy and acceptability of the work herein. In the event of discrepancies arising during construction, the private engineer shall be responsible for determining an acceptable solution and revising the plans for approval by the City.
- The Developer shall be responsible for preserving or re-establishing and referencing survey monuments destroyed, disturbed or buried as a result of construction shown hereon.
- All flagged elevations shall be taken in the field by the private engineer.
- Trim edge of existing pavement where new pavement joins to a smooth straight line. Construct match-up paving as shown on plan and overlay paving as directed in the field to produce a smooth section.
- Construct driveway approaches per Standard Drawing 302. Exact size and location to be as shown.
- Any traffic control striping obliterated and/or badly worn during construction shall be restored by the contractor within five days after notification from the City Inspectors.
- Final striping for traffic control and/or pavement marking to be the responsibility of the developer.
- The contractor shall call in a location request to Underground Service Alert (U.S.A.), Phone No. 1-800-422-4133, two working days before digging. No construction permit will be issued by the Public Works Department involving excavation for underground facilities unless the applicant has provided an identity identification number by U.S.A.
- The Traffic Signal work requires a "Street Opening" Permit obtained at the Public Works counter on the Third Floor of City Hall.
- Contact the Traffic Signal Maintenance (782-5748) 48 hours in advance to schedule inspections of the work performed. Inspection fee for Traffic Signal Modifications will be at the rate of \$29.35 per hour.
- In pavement overlay areas, distressed existing pavement shall be removed and replaced as directed by the Inspector prior to overlaying with W.C. paving.
- NOTICE TO CONTRACTOR:** The existence and location of any underground utility pipes or structures shown on these plans were obtained by a search of the available records. To the best of our knowledge there are no existing utilities except as shown on these plans. The Contractor is responsible for taking precautionary measures to protect the utility lines not of record or not shown on these plans.
- Developer to give City Meter Division five (5) working days written notice prior to start of construction and to allow the City ten (10) working days for completion of work (351-4160).
- Construction Work that will cause damage to the Detector Loop(s) shall not be performed until Traffic Signal Maintenance personnel have been notified at (714) 782-5748 and the necessary timing adjustments made to maintain Signal operation.
- Splicing of Traffic Signal Conductors is not permitted.

CONSTRUCTION NOTES:

- Construct conc. curb & gutter (6") Type 1 spec, CIR Std. No. 200 w/ gutter width of 5".
- Construct curb line sidewalk per CIR Std. 302.
- Construct driveway approach per CIR Std. 302, Type 35 as 30' B.S.P. concrete.
- Trim edge of pavement where new pavement joins to a smooth straight line.
- Construct AC overlay, feather to provide smooth transition as directed in the field by the inspector.
- Existing water service line to be cut and plugged at main, existing water metering box to be salvaged by City Forces (Water).
- Existing water service line to be extended, existing water meter and box to be relocated by City Forces (Water).
- Existing fire hydrant to be relocated by City Forces (Water).
- Existing power pole and/or street light to be relocated by City Forces (Electric).
- Relocate item shown.
- Remove item shown.
- Place street flag to the specifications of the Park & Recreation Dept.
- Construct 2" AC over 19" crushed A.B. 302 Type 35 as 30' B.S.P. concrete.
- Install Type F.I. Marker per CIR Std. Dwg 665. (20' o/c)
- Existing elec. vault to be adjusted to grade by City Forces (Electrical).
- Denotes construction that will be done in accordance with the specifications of the affected City agencies.

GENERAL NOTES (CONT)

18. In order to coordinate the City's portion of work, the developer and/or contractor shall give the City 60 day's notice in order that the developer's and the City's work may be installed concurrently.

When budgeting on City portion of work, need to include \$990 to remove the water dept. for water and sewer. The water services at 5860 and 5870. (See spec 1/20/92 note in R-65-889 file for details) 1/20/92

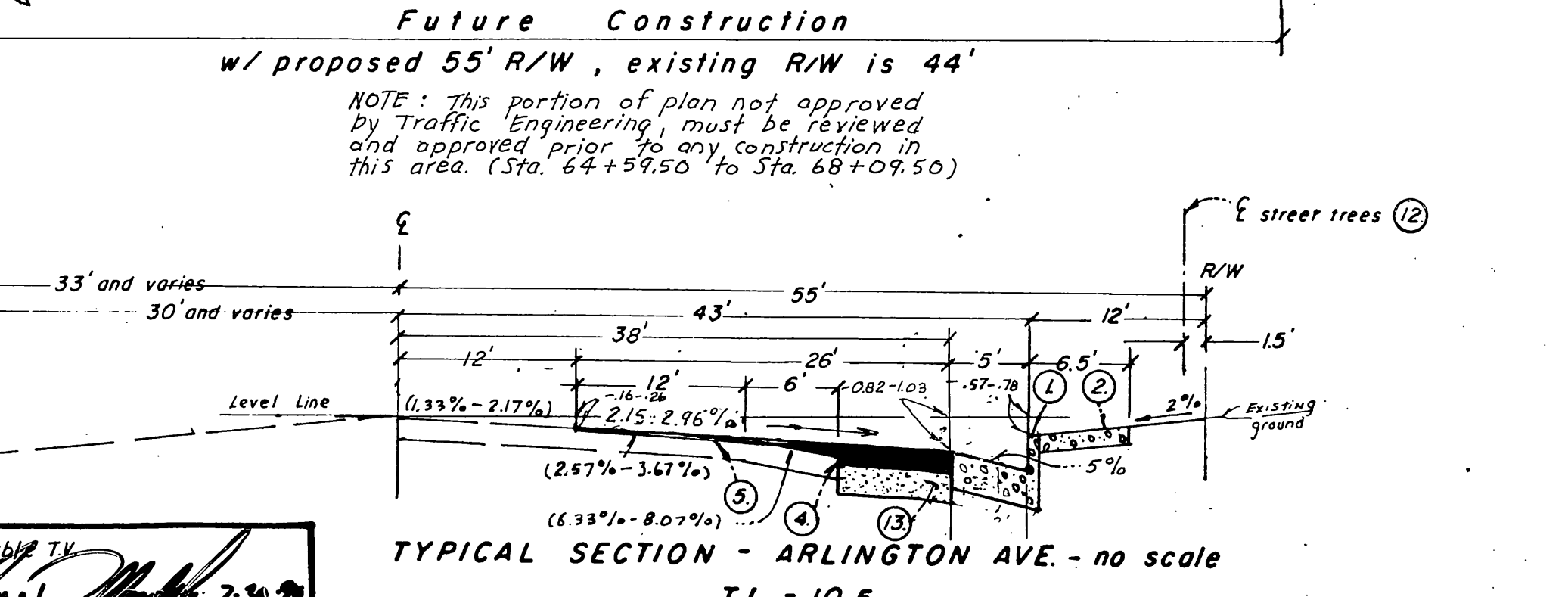
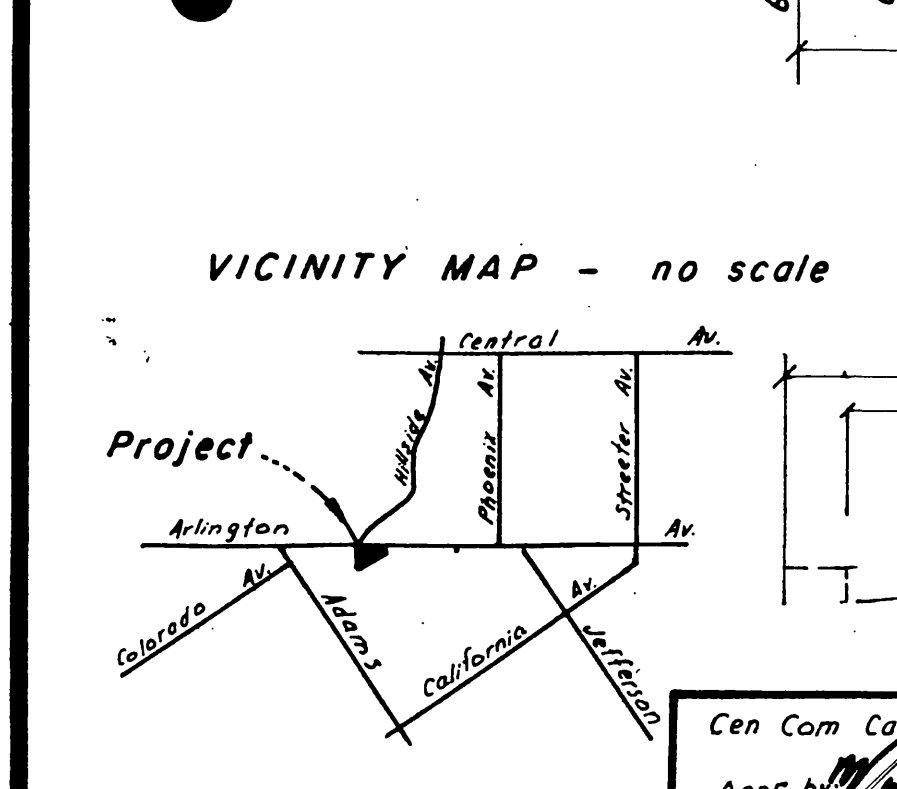
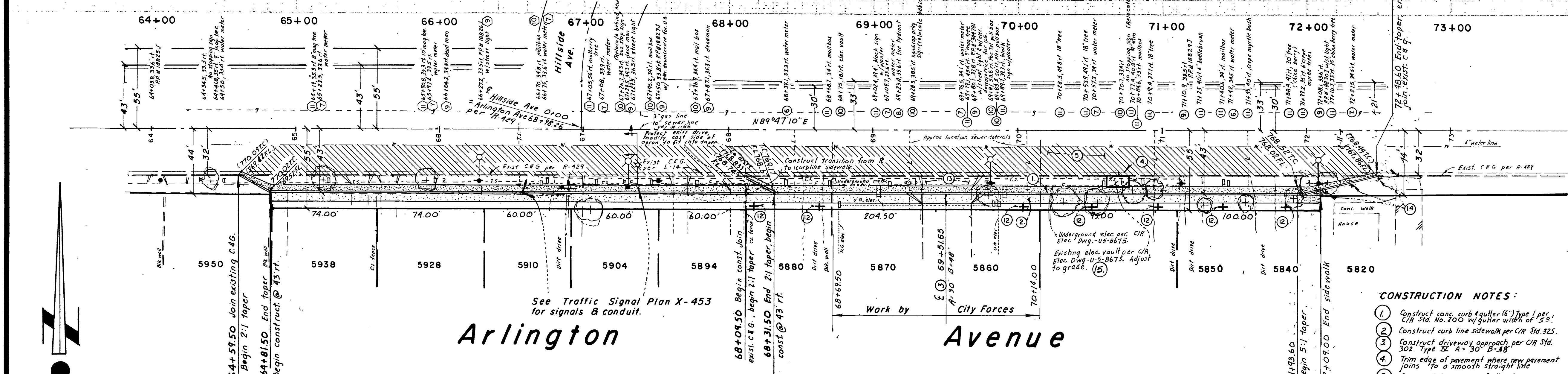
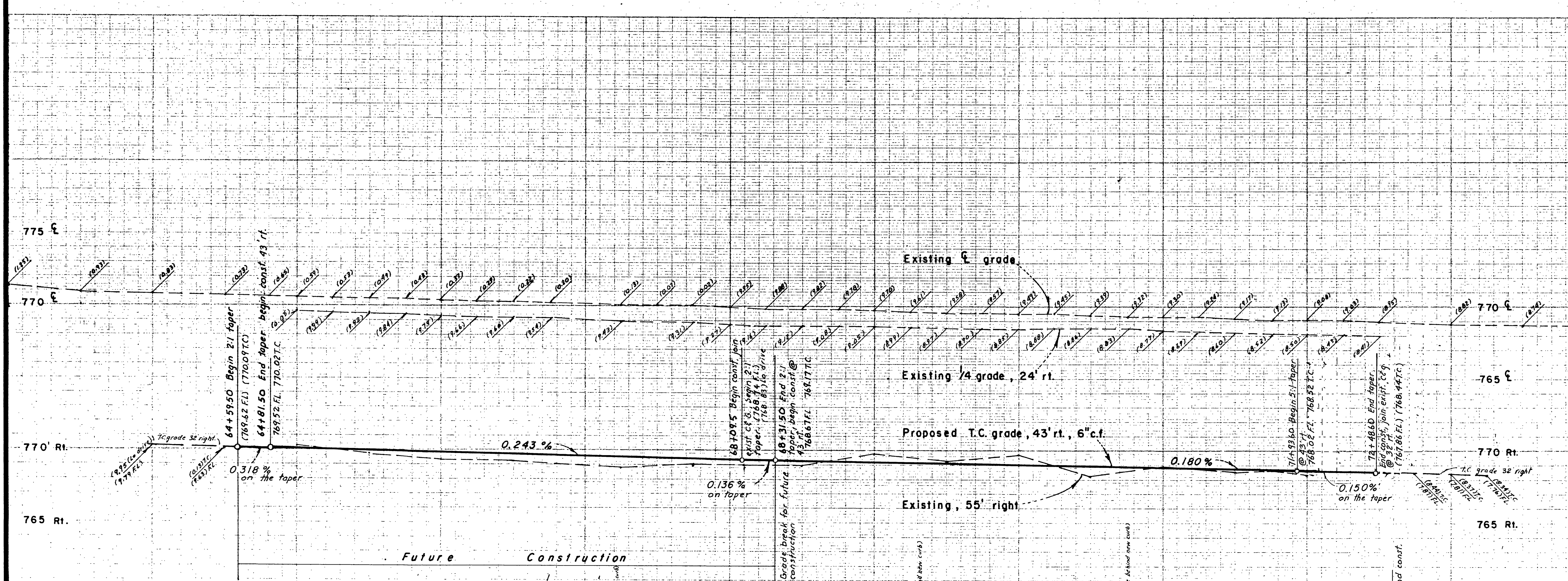

TWO WORKING DAYS BEFORE YOU DIG CALL U.S.A. TOLL FREE 800-422-4133

City of Riverside, Electric
 Appr. by: [Signature] Date 7-20-90
 Pacific Telephone
 Appr. by: [Signature] Date 7-19-90

City of Riverside, Water
 Appr. by: [Signature] Date 7-30-90
 So. Cal. Gas Co.
 Appr. by: [Signature] Date 7-19-90

ROBERT L. TAYLOR - Civil Engineer
 5830 Magnolia Ave.
 Riverside, CA. 92506 714-683-0617
 Approved by: [Signature] Date 12/20/89
 Robert L. Taylor (C.E.C. 10470)

CITY OF RIVERSIDE PUBLIC WORKS DEPARTMENT

APPROVED BY	DATE	BY
PRINCIPAL ENGINEER	8/31/90	[Signature]
PAVING DEPARTMENT	1-30-90	[Signature]
TRAFFIC DIVISION	8/17/90	[Signature]
CHIEF P.W. ENGINEER	8/11/90	[Signature]

MARK REVISIONS
 DESIGNED BY: [Signature] DRAWN BY: [Signature] CHECKED BY: [Signature]

STREET PLAN & PROFILE
Arlington Avenue
 From 68+09.50 to 72+64.00 s'y side,
 R-65-889 5870 Arlington Ave.

ACCOUNT NO. **R-3154**
 SHEET 1 OF 1
 M-19

HORIZ. SCALE: 1" = 40' VERT. SCALE: 1" = 4'

INDEXED: 11.5.90 L.H.