

GENERAL NOTES:

- CONSTRUCTION SHALL BE IN ACCORDANCE WITH THE CITY OF RIVERSIDE, DEPARTMENT OF PUBLIC WORKS, STD. DRAWINGS, AND THE STD. SPECIFICATIONS FOR PUBLIC WORKS CONSTRUCTION 1988 EDITION, 1989 SUPPLEMENT, AND 1990 SUPPLEMENT.
- TRIM EDGE OF EXISTING PAVEMENT WHERE NEW PAVEMENT JOINS TO A SMOOTH, STRAIGHT LINE.

CONSTRUCTION NOTES

- NUMBERS ABOVE 100 IN A HEXAGON ON THE PLAN REFER TO THE RESPECTIVE STANDARD DRAWING AND SHALL BE CONSTRUCTED ACCORDINGLY, UNLESS MODIFICATIONS ARE NOTED ON THE PLAN. ANY NUMBER SHOWN BELOW THE STANDARD DRAWING NUMBER INDICATES THE SPECIFIC ALTERNATE TO BE CONSTRUCTED.
- 1 REMOVE EXISTING PAVEMENT AND CONSTRUCT .25' A.C. OVER .75' C.A.B.
- 2 EXIST. 10" C.I. STORM DRAIN IS TO BE PLUGGED WITH CONCRETE AND ABANDONED IN PLACE; THE CATCH BASIN IS TO BE FILLED AND ABANDONED IN PLACE.
- 405 USE 3 1/2" X 3 1/2" X 1/2" ANGLE IRON, INSTEAD OF FACE PLATE. (SEE STD. DWG. 400)

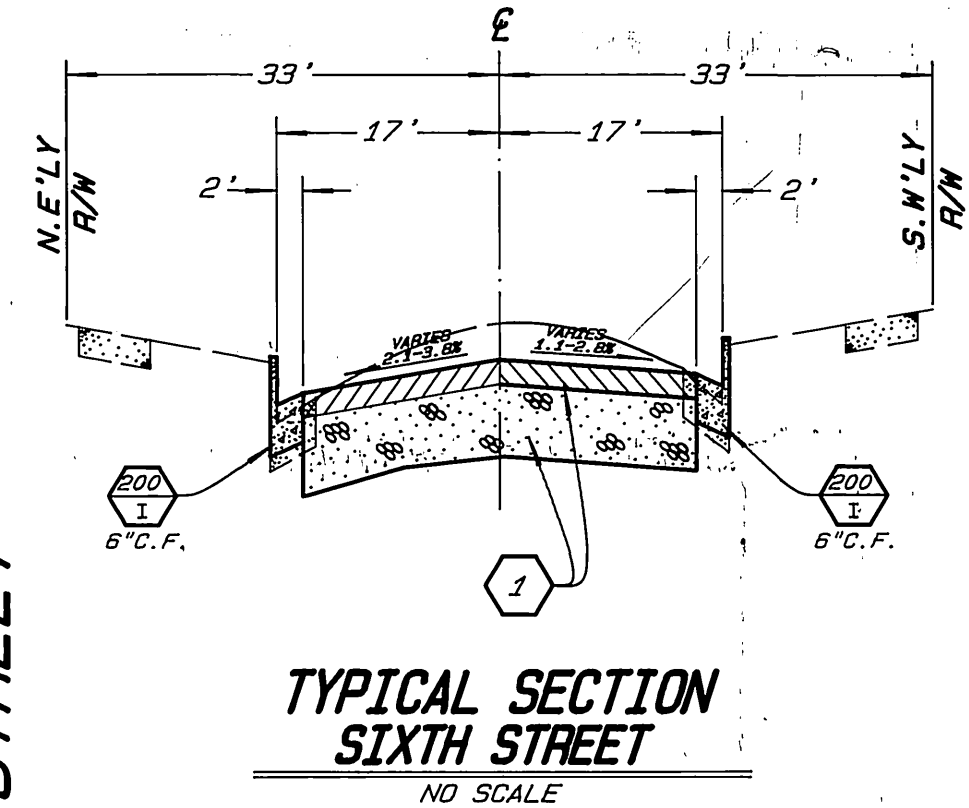
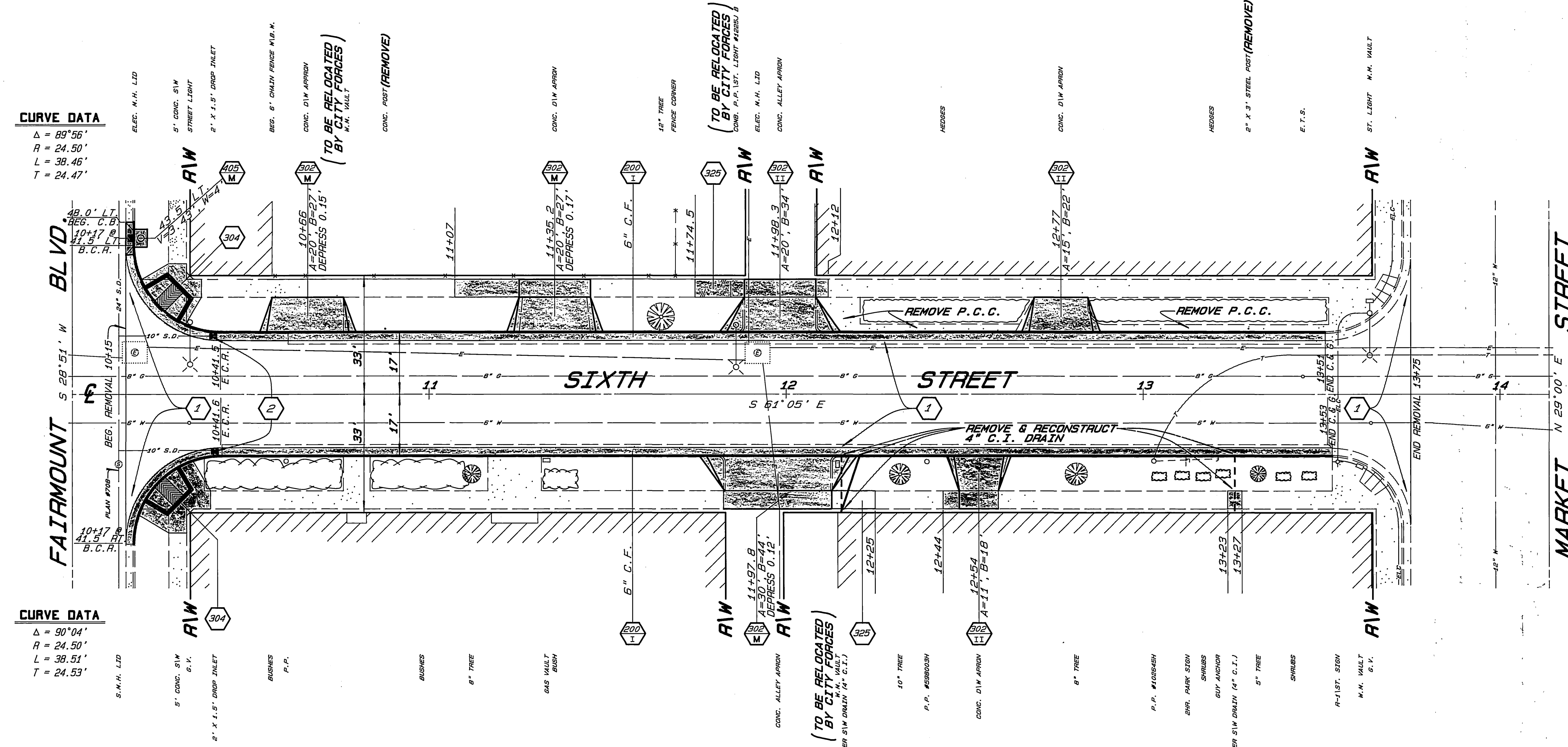

BENCH MARK:
CHISELED "D" SQUARE IN CORNER OF PLANTER CURB.
S'ELY CORNER OF SIXTH ST. & ORANGE ST.
F.B. LL25/27A
ELEV. = 854.53

ENGINEER IN RESPONSIBLE CHARGE
HANS J. KAMRATH
R.C.E. 14712 expires 3/31/93
DATE 9/12/1990

REGISTERED PROFESSIONAL ENGINEER
HANS J. KAMRATH
NO: 14712
CIVIL

CITY OF RIVERSIDE
PUBLIC WORKS DEPARTMENT

APPROVED BY: [Signature]
DATE: 9/13/90

DESIGNED BY: [Signature] DRAWN BY: [Signature] CHECKED BY: [Signature]

SIXTH STREET RECONSTRUCTION
Fairmount Blvd. to Market St.

ACCOUNT NO. 30-575-324-07
R-3175

SHEET 1 OF 1

HORIZ. SCALE: 1" = 20' VERT. SCALE: 1" = 2'

INDEXED 1-10-91 LHM