

PROFILE  
 NORTH SIDE GRADES CHECKED  
 BY  
 STATIONING INDICATED

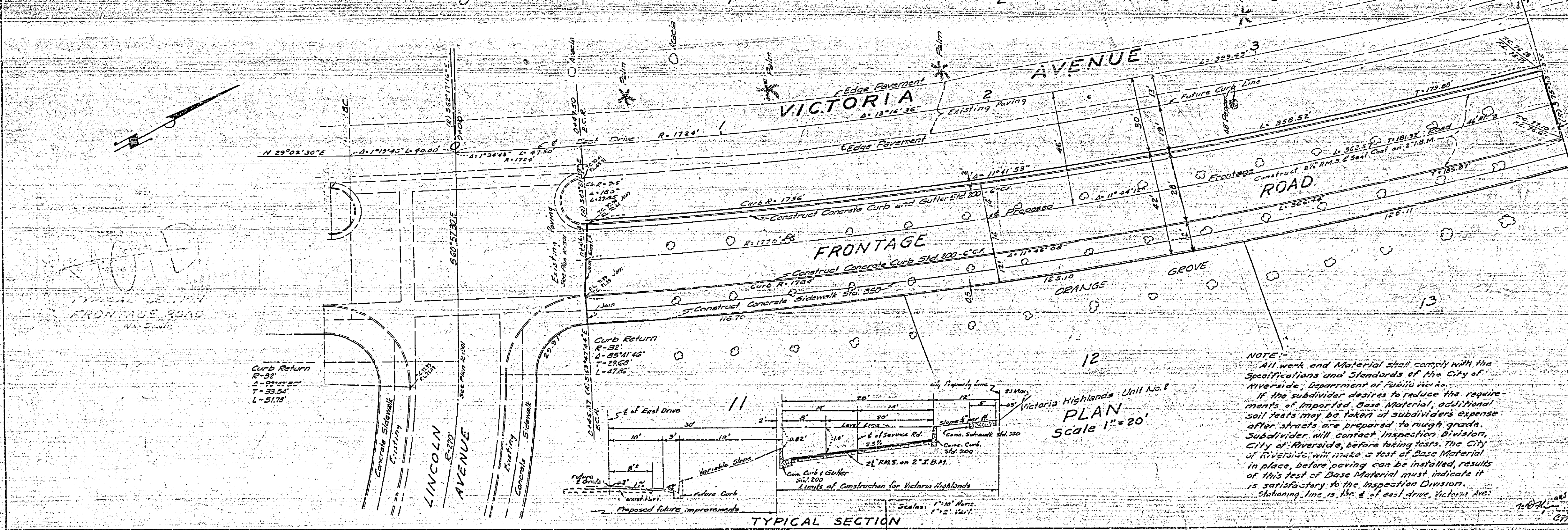

MCKEE AND CRAWLEY  
 SURVEYORS AND ENGINEERS  
 RIVERSIDE CALIFORNIA  
 APPROVED *George O. Crawley* REVISION DATE 12-1-57  
 CITY OF RIVERSIDE, CALIFORNIA  
 DEPARTMENT OF PUBLIC WORKS  
 VICTORIA HIGHLANDS UNIT #2  
 STREET PLANS  
 AND PROFILES  
 FRONTAGE ROAD (EAST)  
 VICTORIA AVENUE  
 Approved by *[Signature]* Plan No. R-318  
 Date: Jan. 30, 1959 Sheet 1 of 1

PLAN  
 NORTH SIDE GRADES CHECKED  
 BY  
 STATIONING INDICATED

TYPICAL SECTION  
 FROM THIS ROAD  
 AS SHOWN

NOTE:  
 All work and Material shall comply with the Specifications and Standards of the City of Riverside, Department of Public Works.  
 If the subdivider desires to reduce the requirements of Imported Base Material, additional soil tests may be taken at subdividers expense after streets are prepared to rough grade. Subdivider will contact Inspection Division, City of Riverside, before taking tests. The City of Riverside will make a test of Base Material in place, before paving can be installed, results of this test of Base Material must indicate it is satisfactory to the Inspection Division. Stationing line is the E. of east drive, Victoria Ave.

TYPICAL SECTION

PLAN  
 Scale 1"=20'