

WHEELCHAIR RAMP CONSTRUCTION

SITE	INTERSECTION	CORNER	RAMP TYPE	C&G L.F.	COMMENTS
1.	MAGNOLIA @ TIBBETS	NE	3	16	SEE SHEET NO. 2 FOR DETAIL
2.	MAGNOLIA @ McCRAY	NE	2	10	SEE SHEET NO. 3 FOR DETAIL
		SE	2	15	SEE SHEET NO. 3 FOR DETAIL
		SW	2	10	SEE SHEET NO. 3 FOR DETAIL
		NW	2	58	SEE SHEET NO. 3 FOR DETAIL
3.	MAGNOLIA @ LUTHER	SW	2	11	SEE SHEET NO. 2 FOR DETAIL
4.	MAGNOLIA @ SCHOOL CIRCLE	NW	2	10	SEE SHEET NO. 2 FOR DETAIL
5.	MAGNOLIA @ BROCKTON	NE	1	12	SEE SHEET NO. 2 FOR DETAIL
		SE	1	20	SEE SHEET NO. 2 FOR DETAIL
6.	LOCATION DELETED				
7.	BROCKTON @ SUNNYSIDE	SE	3	24	
		SW	3	16	
		NW	3	16	
8.	BROCKTON @ BEATTY	SW	3	16	
		NW	3	16	
9.	BROCKTON @ MERRILL	SW	3	16	
		NW	3	16	
10.	BROCKTON @ DEWEY	SW	3	16	
		NW	3	16	
11.	BROCKTON @ GARDENA	SW	3	16	
		NW	3	16	
12.	BROCKTON @ EMERSON	SW	3	16	
13.	BROCKTON @ COVER	SW	1	12	TRM YUCCA
		NW	1	12	
14.	BROCKTON @ TIBBETS	SW	3	16	
		NW	1	12	SEE S/W CONST @ 6949 BROCKTON
15.	BROCKTON @ NELSON	NE	1	32	SEE SHEET NO. 3 FOR DETAIL
		SE	2	32	SEE SHEET NO. 3 FOR DETAIL
		SW	2	10	SEE SHEET NO. 3 FOR DETAIL
16.	BROCKTON @ SAN SIMEON	NE	3	19	
	@ EXISTING CROSSWALK	SW	1	12	
17.	MAGNOLIA @ SUNNYSIDE	NE	2	14	
	@ EXISTING CROSSWALK	SE	3	16	
		SW	3	16	
		NW	3	16	
		NW	2	12	+10 L.F. CURB, STD 200 II, 6" C.F.
18.	MAGNOLIA @ MERRILL	SW	1	12	
19.	BEATTY BETWEEN MAGNOLIA & DE ANZA	W	2	20	
	WESTERLY DRIVEWAY	E	2	15	
	EASTERLY DRIVEWAY	SE	3	16	
		SE	2	20	
20.	DE ANZA @ BEATTY	NE	3	16	
21.	DE ANZA @ SHASTA	NE	3	16	
		SE	3	16	
22.	DE ANZA @ YOSEMITE	SW	3	16	
		NW	3	16	
23.	DE ANZA @ SAN SIMEON	SW	3	16	
		NW	3	16	
24.	DE ANZA @ NELSON	NE	3	22	R&R 78 S.F. OF STREET A.C. PAVING
		SE	3	19	R&R 78 S.F. OF STREET A.C. PAVING
25.	DE ANZA @ NELSON	SW	3	16	
		NW	3	16	
26.	DE ANZA @ RAINIER N'LY	NE	3	16	
		SE	3	16	
27.	DE ANZA @ GLACIER	S	3	16	
28.	DE ANZA @ RAINIER S'LY	NE	3	16	
		SE	3	16	
29.	ARLINGTON @ YELLOWSTONE	NE	3	16	
		NW	3	16	
30.	ARLINGTON @ DE ANZA	NE	3	16	
		NW	3	16	
31.	ARLINGTON @ MT. WHITNEY	NE	1	12	+144 S.F. OF S/W
		NW	1	12	+114 S.F. OF S/W
32.	SAN DIEGO @ NELSON	SE	3	16	R&R 75 S.F. OF A.C. PAVING & R&R 15 L.F. OF CONCRETE BLOCK PLANTER.
		SW	3	16	
33.	RIVERSIDE @ BRYCE	SW	3	16	
		NW	3	16	R&R 44 S.F. OF S/W
34.	RIVERSIDE @ NELSON	SW	3	16	R&R 32 S.F. OF STREET A.C. PAVING
		NW	3	16	R&R 32 S.F. OF STREET A.C. PAVING
35.	RIVERSIDE @ CARLSBAD	SW	3	16	R&R 32 S.F. OF STREET A.C. PAVING
36.	RIVERSIDE @ LAURA	SW	3	34	SEE SHEET NO. 2 FOR DETAIL
		NW	1	12	SEE SHEET NO. 2 FOR DETAIL
37.	RIVERSIDE @ SUNNYSIDE	NE	1	12	RELOCATE ST. NAME SIGN & RAIL FENCE
		SE	—	—	+102 S.F. OF S/W
		SE	—	—	+70 S.F. OF S/W BEHIND EXIST. RAMP
38.	RIVERSIDE @ TIPPERARY	NE	1	12	+16 S.F. OF S/W & R&R 24 S.F. OF A.C. PAVING
39.	RIVERSIDE @ ELIZABETH	SW	3	16	
		NW	3	16	R&R 55 S.F. OF S/W
40.	RIVERSIDE @ JURUPA	NE	3	19	
		SE	3	16	
		SW	3	18	
		NW	3	16	
41.	RIVERSIDE @ MERRILL	NW	1	12	+13 S.F. OF S/W
42.	MAGNOLIA @ JURUPA	NE	—	—	R&R 32 S.F. OF STREET A.C. PAVING
43.	MAGNOLIA NORTH OF BRISCOE @ EXISTING CROSSWALK	E	1	12	+53 S.F. OF S/W
		W	1	40	
44.	MAGNOLIA @ OAKWOOD	SW	2	17	R&R 64 S.F. OF S/W & R&R 48 S.F. OF STREET A.C. PAVING
		NW	—	—	R&R 48 S.F. OF STREET A.C. PAVING
45.	MAGNOLIA @ LINWOOD	NW	—	—	R&R 68 S.F. OF STREET A.C. PAVING
		NE	—	—	R&R 48 S.F. OF STREET A.C. PAVING
46.	MAGNOLIA @ BANDINI	NE	—	—	R&R 48 S.F. OF STREET A.C. PAVING
		SE	—	—	R&R 48 S.F. OF STREET A.C. PAVING
47.	PANORAMA @ OLIVEWOOD	S	3	16	
48.	MAGNOLIA @ TERRACINA	NE	3	18	
		NW	3	21	

RAMP LEGEND
 TYPE 1 - STANDARD DRAWING NO. 304
 TYPE 2 - ONE DIRECTIONAL PER DETAIL
 TYPE 3 - GALVANIS STD. NB-B CASE C.

IMPORTANT NOTICE
 Section 4216/4217 of the Government Code requires a Dig Alert Identification Number to be issued before a "Permit to Excavate" will be valid. For your Dig Alert I.D. Number call Underground Service Alert. TOLL FREE 1-800-422-4133. Two working days before you dig.

SIDEWALK REPAIR

ADDRESS	SIDEWALK S.F.	COMMENTS
5725 MAGNOLIA	50	
5597 MAGNOLIA	225	
5511 MAGNOLIA	50	
5490 MAGNOLIA	60	
5411 MAGNOLIA	200	
5375 MAGNOLIA	50	
5327 MAGNOLIA	—	+100 S.F. CONC. D/W APPROACH
5279 MAGNOLIA	—	+210 S.F. CONC. D/W APPROACH
5229 MAGNOLIA	50	
5195 MAGNOLIA	50	
5081 MAGNOLIA	100	
5037 MAGNOLIA	125	
4957 MAGNOLIA	125	
4941 MAGNOLIA	50	
4911 MAGNOLIA	265	
TOTAL	1400	S.F. OF SIDEWALK R&R

SIDEWALK CONSTRUCTION

ADDRESS	SIDEWALK S.F.	COMMENTS
6574 SAN DIEGO ON RIVERSIDE	505	RELOCATE 45 L.F. OF WOOD FENCE
6517 RIVERSIDE	212	R&R 13 L.F. OF BRICK PLANTER
6395 & 6377 RIVERSIDE	30	WIDEN EXISTING SIDEWALK 2.5' AND R&R 8 L.F. OF CONC. BLOCK PLANTER
6377 RIVERSIDE	30	WIDEN EXISTING SIDEWALK 2.5'
6349 & 6337 RIVERSIDE	20	WIDEN EXISTING SIDEWALK 2.5' AND R&R 15 L.F. OF CONC. BLOCK WALL
6949 BROCKTON	375	
TOTAL	1172	S.F. OF SIDEWALK

ADDITIONAL WORK

ADDRESS	DESCRIPTION
6754 BROCKTON	REMOVE EXIST INLET & CONST CATCH BASIN STD. 406, W=2'-11 3/8", V=2.40'

GENERAL CONSTRUCTION NOTES:

- EXISTING UTILITIES SHOWN ON THIS PLAN ARE PLOTTED FROM UTILITY RECORDS. THE CONTRACTOR IS REQUIRED TO TAKE DUE PRECAUTIONARY MEASURES TO LOCATE AND PROTECT ALL UTILITIES WHETHER OR NOT SHOWN ON THIS PLAN.
- PRIME CONTRACTORS BIDDING THIS WORK SHALL HAVE A CLASS A OR C LICENSE.
- CONFLICTING UTILITIES SHOWN WITHIN THE CONSTRUCTION AREA WILL BE RELOCATED PRIOR TO CONSTRUCTION.
- TREES & SHRUBS AFFECTED BY THE PROPOSED SIDEWALK CONSTRUCTION SHALL BE TRIMMED TO AT LEAST 3' VERTICALLY ABOVE THE SIDEWALK SURFACE AND TO AT LEAST 3' LATERALLY OF THE SIDEWALK, WHERE RIGHT-OF-WAY PERMITS.
- MAILBOXES INTERFERING WITH PROPOSED SIDEWALK CONSTRUCTION SHALL BE TEMPORARILY RELOCATED TO ENABLE PROPERTY OWNERS TO RECEIVE THEIR MAIL AND BE REINSTALLED IN FINAL POSITION BY THE CONTRACTOR.
- WATER METERS, GAS METERS AND STREET LIGHT FULL BOXES AFFECTED BY CONSTRUCTION SHALL BE ADJUSTED TO THE PROPOSED SIDEWALK GRADE.
- EXISTING SPRINKLERS AND IRRIGATION LINES AFFECTED BY THE CONSTRUCTION OF THE PROPOSED SIDEWALK SHALL BE RELOCATED TO THE BACK OF THE SIDEWALK.

SPECIFIC CONSTRUCTION NOTES

- NUMBERS ABOVE 100 IN A HEXAGON ON THE PLAN REFER TO THE RESPECTIVE STANDARD DRAWING AND SHALL BE CONSTRUCTED ACCORDINGLY, UNLESS MODIFICATIONS ARE NOTED ON THE PLAN OR COVER SHEET. ANY NUMBER SHOWN BELOW THE STANDARD DRAWING NUMBER INDICATES THE SPECIFIC ALTERNATE TO BE CONSTRUCTED.
- STATE OF CALIFORNIA, BUSINESS AND TRANSPORTATION AGENCY, DEPT. OF TRANSPORTATION, STANDARD PLANS, DATED JULY 1992.
- INDICATES DETAIL.
- INDICATES SHEET NO.
- REMOVE AND REPLACE EXISTING STRUCTURAL SECTION WITH FULL DEPTH OR MIN. 6" DENSE GRADED ASPHALT CONCRETE

CITY OF RIVERSIDE, CALIFORNIA PUBLIC WORKS DEPARTMENT		ENGINEER IN RESPONSIBLE CHARGE Ronald C. Mueller RONALD C. MUELLER R.C.E. No. 29510 expires 3/31/95 DATE 5/11/93		ACCT. NO. 220-528200-453002-0000 R-3204 SHEET 1 OF 3 FILE NO.
APPROVED BY: [Signature] DEPUTY P.W. DIRECTOR PRINCIPAL ENGINEER CHIEF P.W. INSPECTOR SURVEYOR TRAFFIC DIVISION	BY: [Signature] DATE: 5/18/93	APPROVED BY: [Signature] PUBLIC WORKS DIRECTOR	DATE: 5/18/93	DESIGNED BY: R.G. FANN DRAWN BY: CURT CHECKED BY: PEM

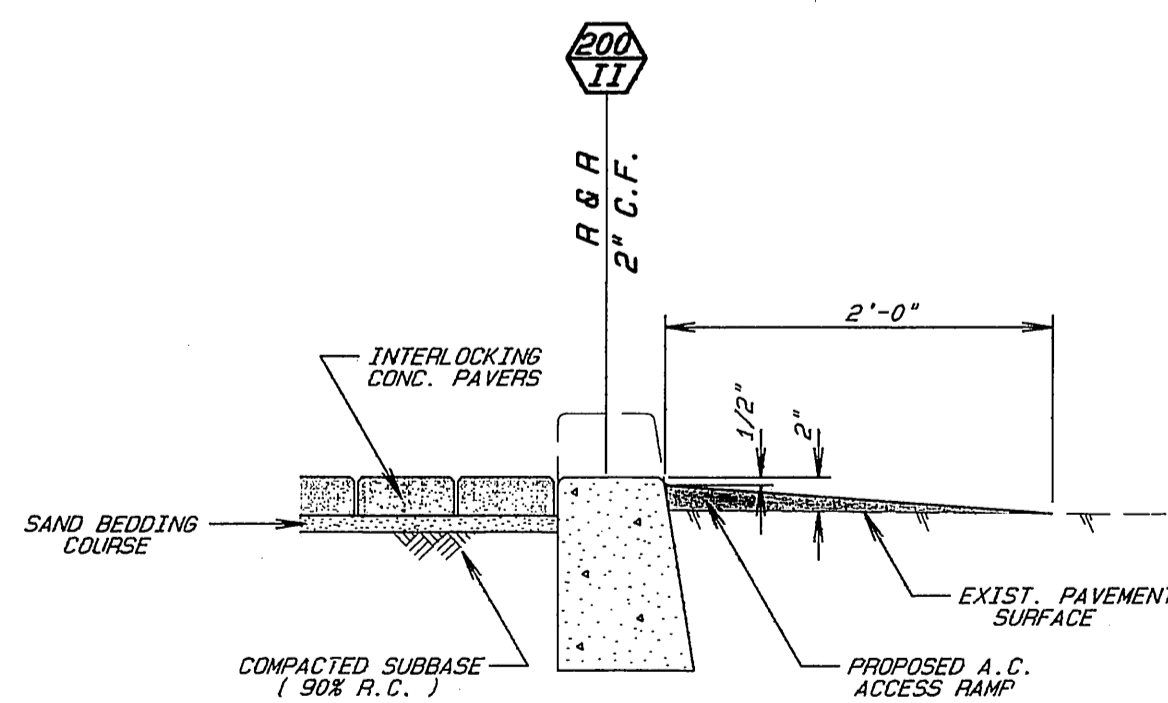
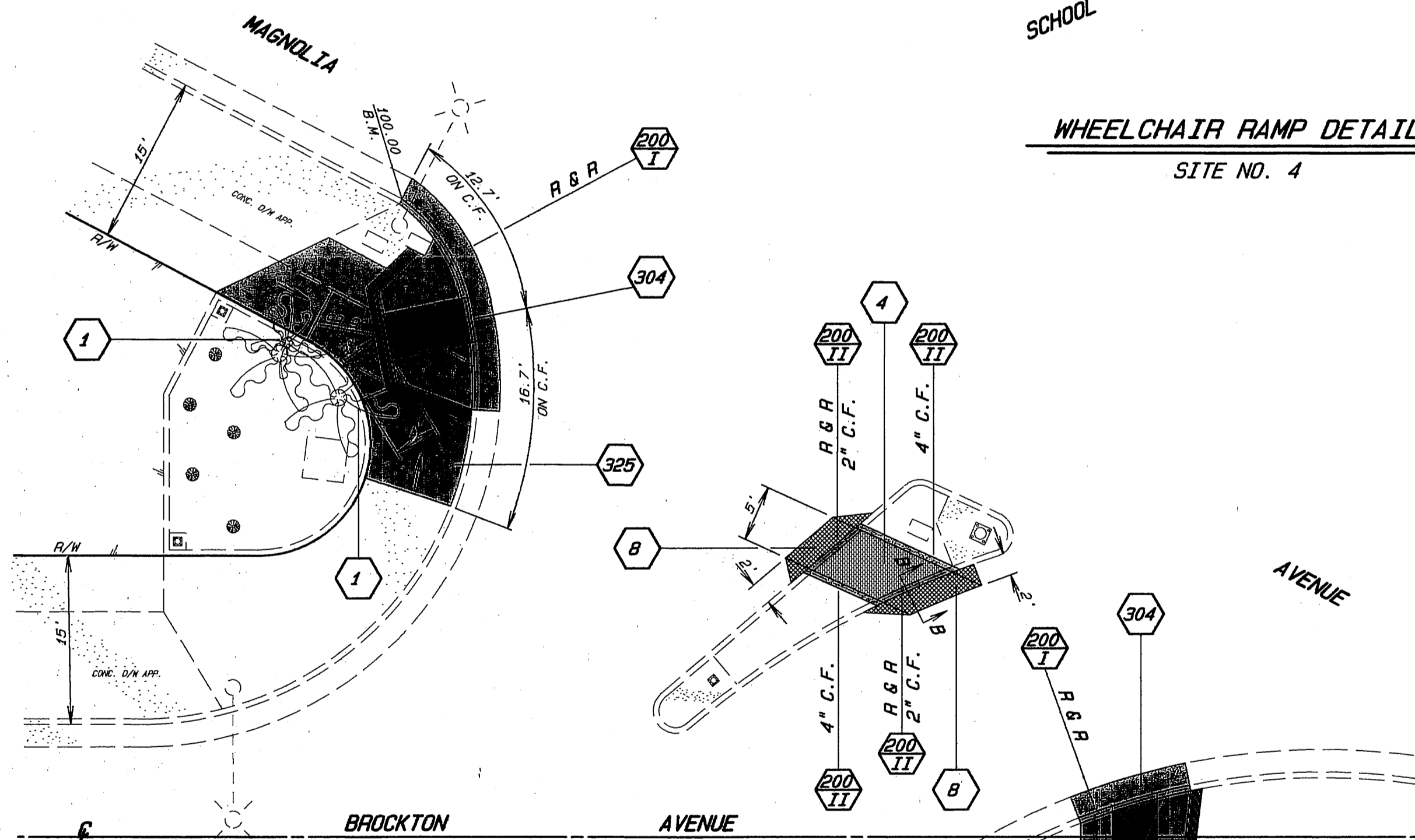
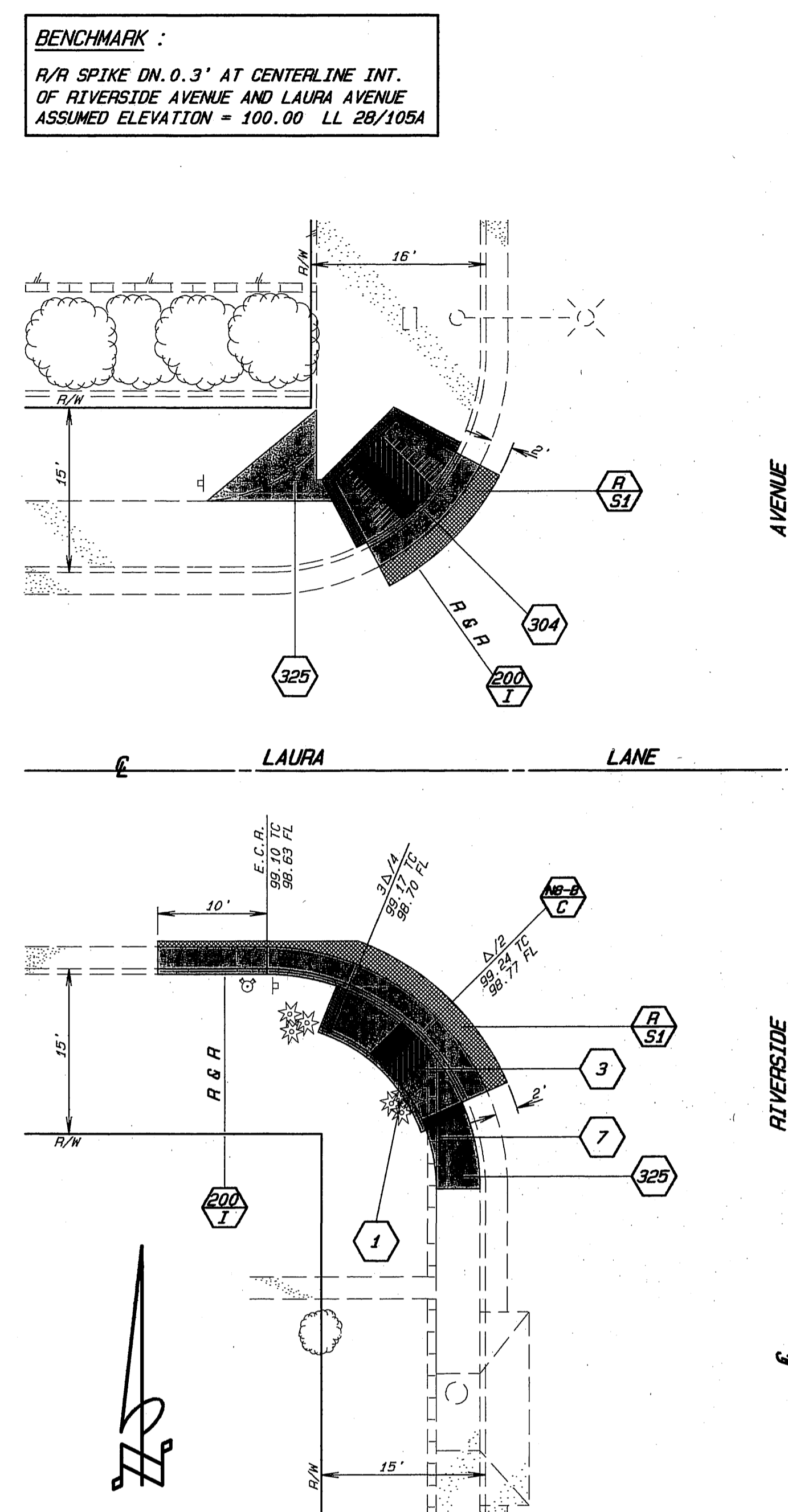
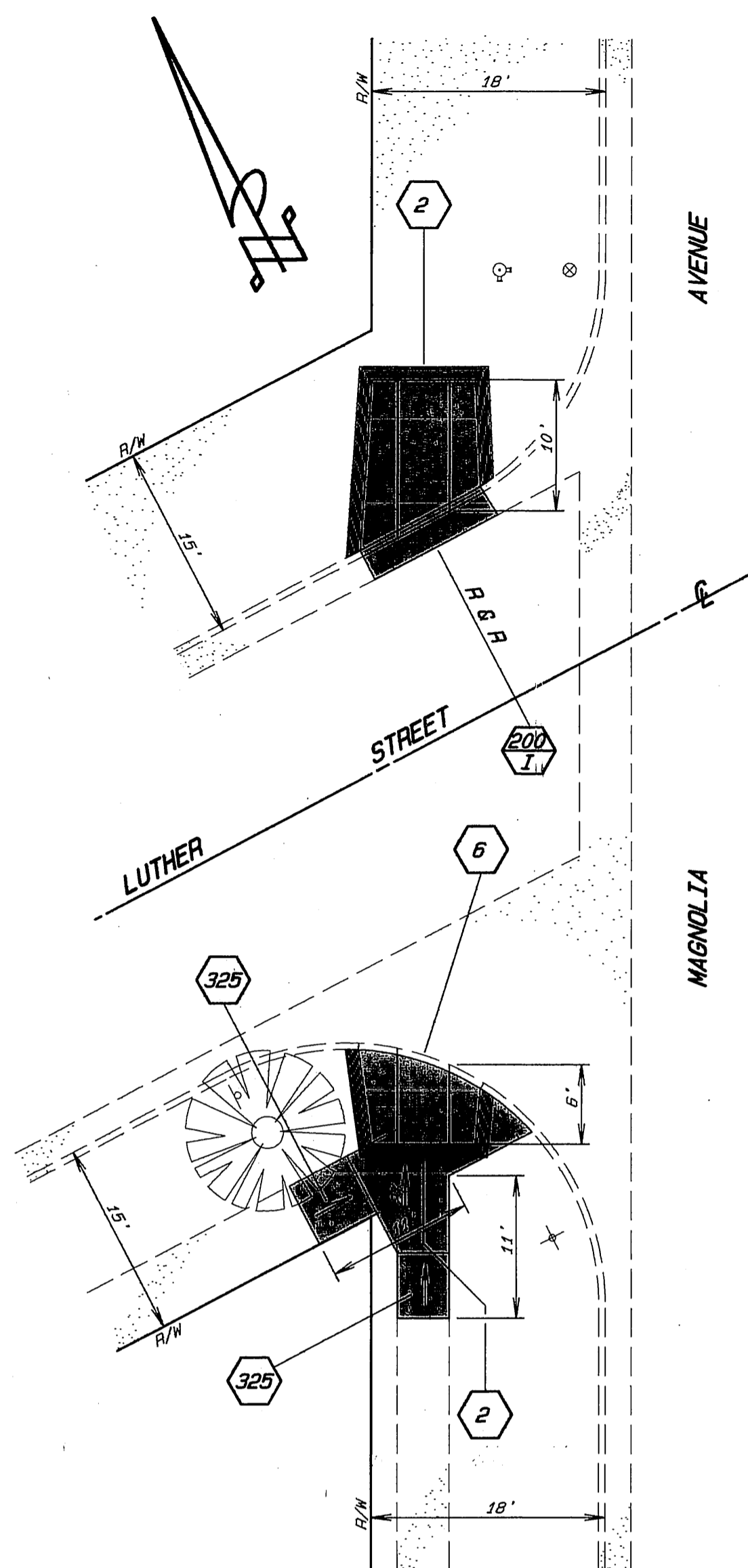
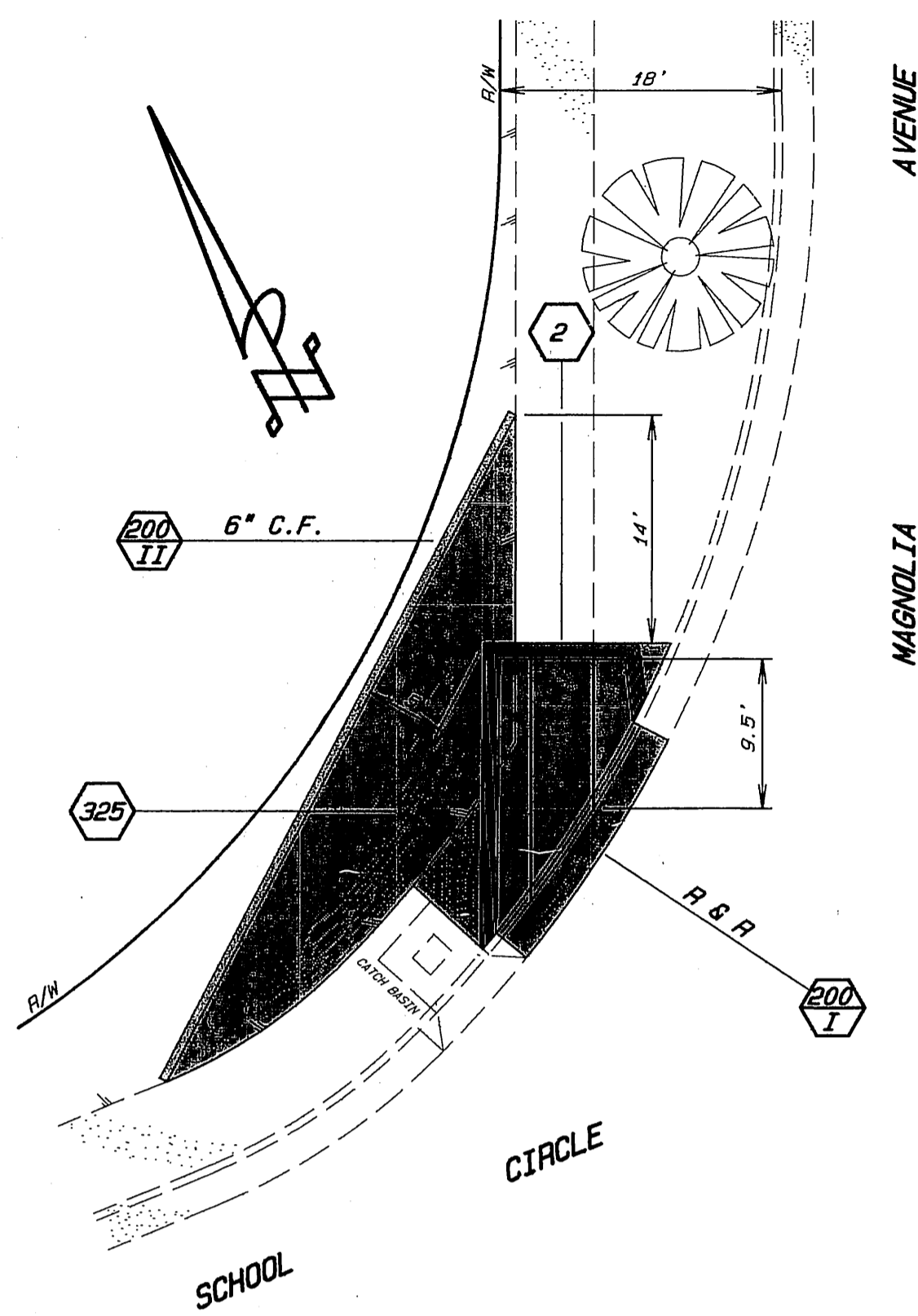
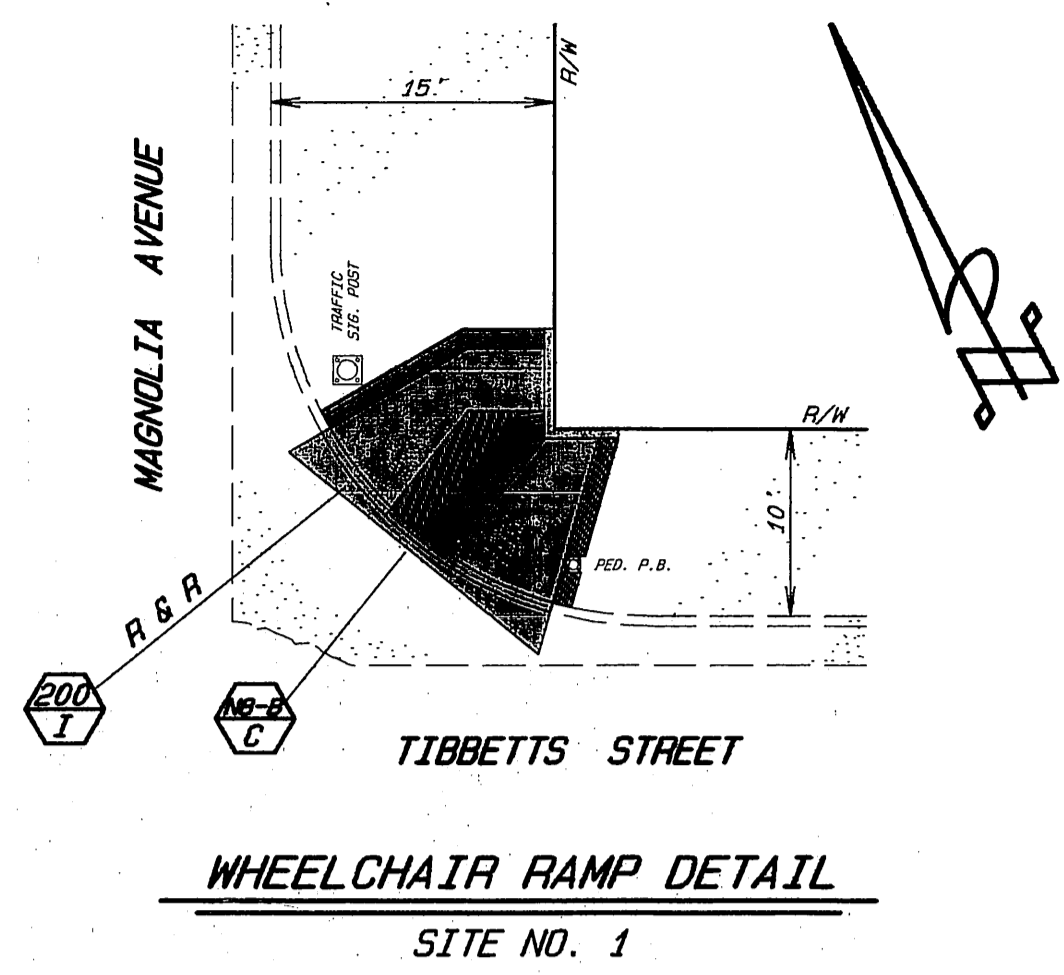

SECTION B-B
SCALE 1"=1'

BENCHMARK :
R/R SPIKE DN. 0.3' AT CENTERLINE INT. OF RIVERSIDE AVENUE AND LAURA AVENUE ASSUMED ELEVATION = 100.00 LL 28/105A

BENCHMARK :
TOP OF CURB AT B.C.R., S.E. CORNER OF MAGNOLIA AVENUE AND BROCKTON AVENUE ASSUMED ELEVATION = 100.00

- CONSTRUCTION NOTES**
- 1 TRIM EXISTING HEDGE, SHRUBS, BUSHES, AND TREE BRANCHES WHICH OVERHANG THE SIDEWALK TO 9" ABOVE SIDEWALK.
 - 2 CONSTRUCT TYPE 2 WHEELCHAIR RAMP PER DETAIL "A" SHEET 3.
 - 3 RELOCATE EXISTING STREET SIGN AND POST AS DIRECTED BY THE ENGINEER.
 - 4 RELAY EXISTING INTERLOCKING PAVERS TO EXISTING STREET GRADE.
 - 5 CUT AND OR GRIND WHEELCHAIR RAMP DEPRESSION INTO EXISTING CURB FACE PER STANDARD DRAWING NO. 304.
 - 6 REMOVE INTERFERING PORTIONS OF EXISTING CONCRETE BLOCK WALL.
 - 7 CONSTRUCT A.C. ACCESS RAMP
 - 8 STATE OF CALIFORNIA, BUSINESS AND TRANSPORTATION AGENCY, DEPT. OF TRANSPORTATION, STANDARD PLANS, DATED JULY 1992.

- CONSTRUCTION LEGEND**
- REMOVE AND REPLACE EXISTING STRUCTURAL SECTION WITH FULL DEPTH OR MIN. 6" DENSE GRADED ASPHALT CONCRETE.



<p>CITY OF RIVERSIDE PUBLIC WORKS DEPARTMENT</p>		<p>WHEELCHAIR RAMPS PHASE II MAGNOLIA CENTER</p>		<p>ACCT. NO. 220-528200-453002-00000</p> <p>R-3204</p> <p>SHEET 2 OF 3</p>
<p>APPROVED BY: [Signature]</p> <p>DATE: 5/18/93</p>	<p>BY: [Signature]</p> <p>DATE: 5/18/93</p>	<p>APPROVED BY: [Signature]</p> <p>DATE: 5/18/93</p>	<p>DATE: 5/18/93</p>	<p>HORIZ. SCALE: 1" = 10'</p>
<p>DESIGNED BY: R.G. FANN</p> <p>DRAWN BY: R.G. FANN</p> <p>CHECKED BY: RCM</p>	<p>REVISIONS:</p>	<p>APPR. DATE:</p>	<p>TRAFFIC DIVISION</p> <p>3/10/93</p>	<p>STREET SERVICES</p> <p>5-033</p>

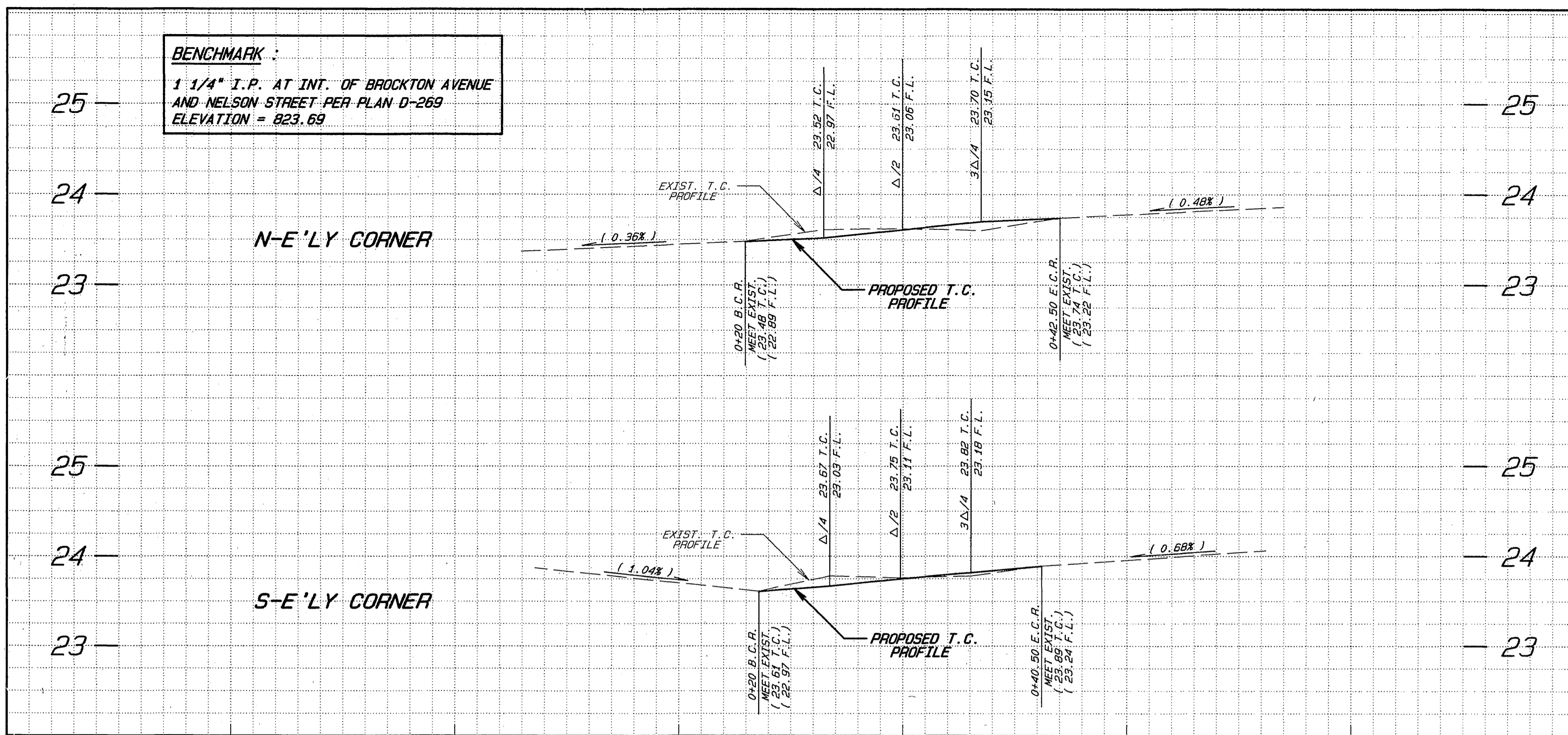

CONSTRUCTION LEGEND

R REMOVE AND REPLACE EXISTING STRUCTURAL SECTION WITH FULL DEPTH OR MIN. 6" DENSE GRADED ASPHALT CONCRETE.

BENCHMARK :
NAIL AT CENTERLINE INTERSECTION OF MAGNOLIA AVENUE AND MCCRAY STREET ASSUMED ELEVATION = 100.00

CURB RETURN DATA
 $\Delta = 62^\circ 21' 00''$
 $R = 13.00'$
 $L = 14.15'$
 $T = 7.67'$

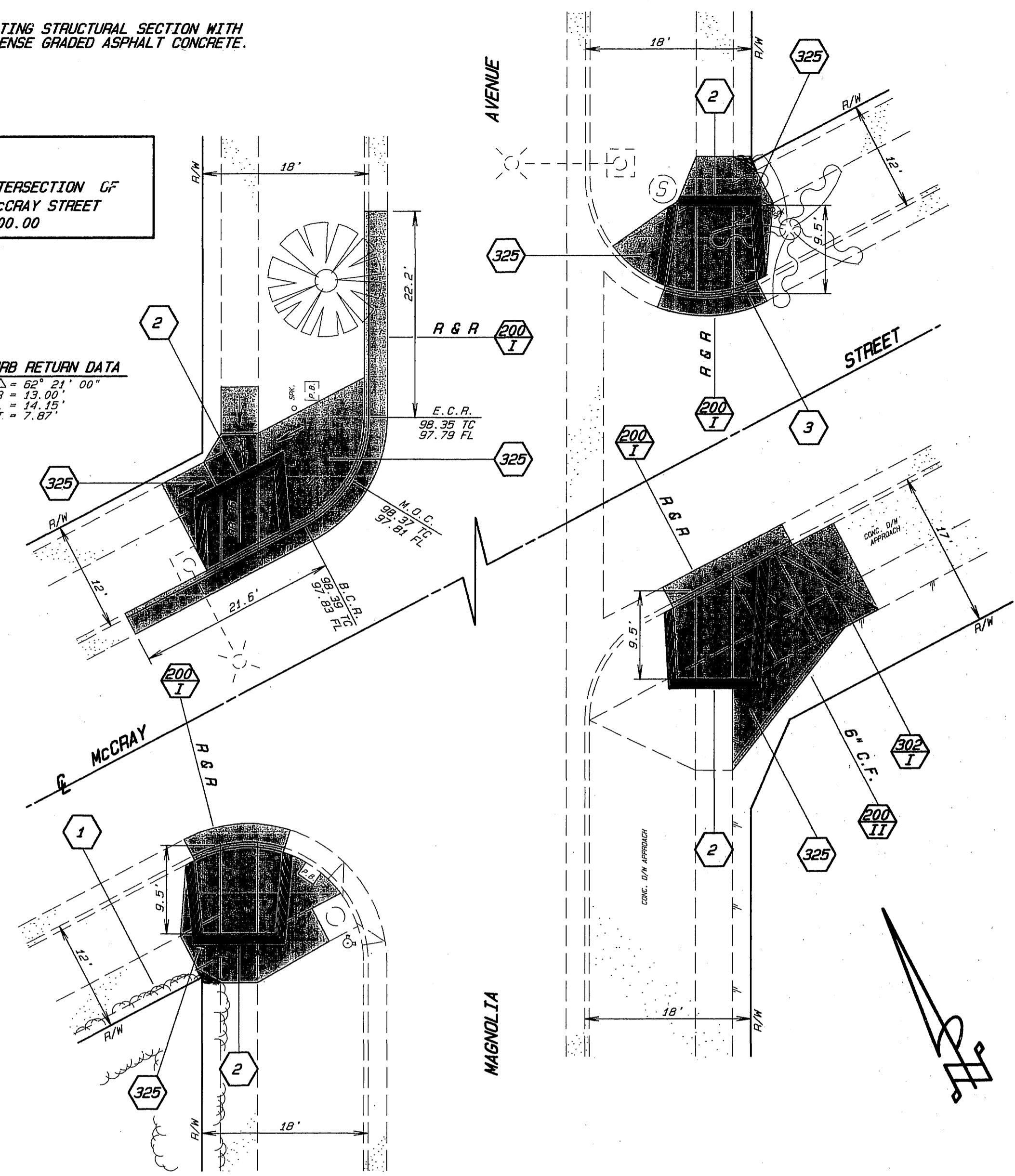

CONSTRUCTION NOTES

- 1 TRIM EXISTING HEDGE, SHRUBS, BUSHES AND TREE BRANCHES WHICH OVERHANG THE SIDEWALK TO 9" ABOVE SIDEWALK.
- 2 CONSTRUCT TYPE 2 WHEELCHAIR RAMP PER DETAIL "A" SHEET 3.
- 3 RELOCATE EXISTING STREET SIGN AND POST AS DIRECTED BY THE ENGINEER.
- 5 REMOVE EXISTING DRAINAGE STRUCTURE AND PLUG ABANDONED PIPES.

CURB RETURN DATA
 $\Delta = 90^\circ 00' 00''$
 $R = 20.00'$
 $L = 31.42'$
 $T = 10.00'$

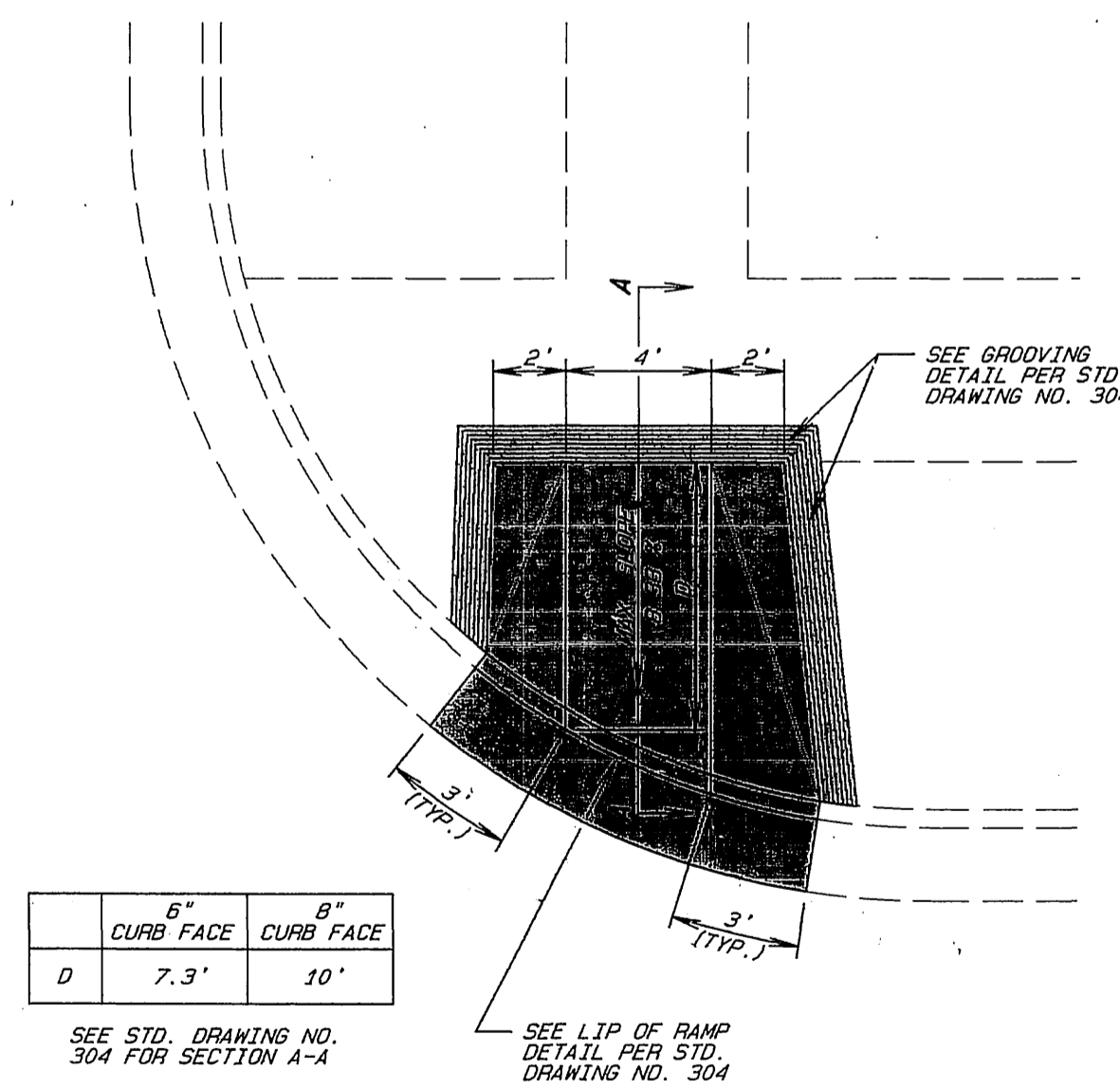

TYPE 2 WHEELCHAIR RAMP DETAIL

SCALE 1" = 5'

WHEELCHAIR RAMP DETAIL

SITE NO. 2

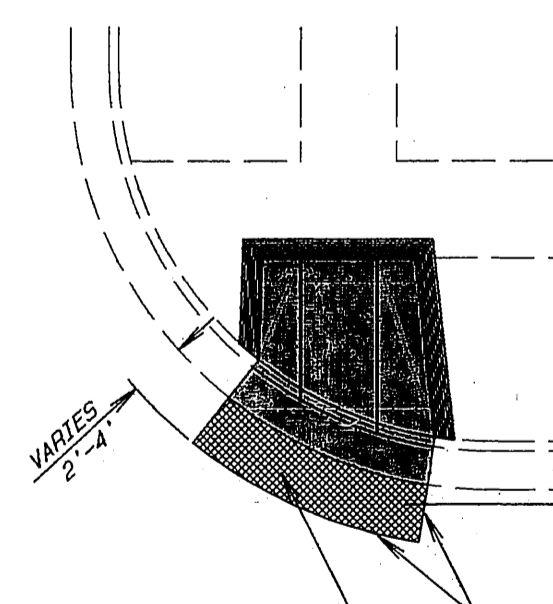

TYPICAL R&R LOCATION

R&R STREET A.C. PAVING ONLY TO PROVIDE PROPER MATCH UP WITH WHEELCHAIR RAMPS OR WHERE NEEDED TO REDUCE EXIST. STREET CROSS SLOPE TO 0.3% OR LESS.

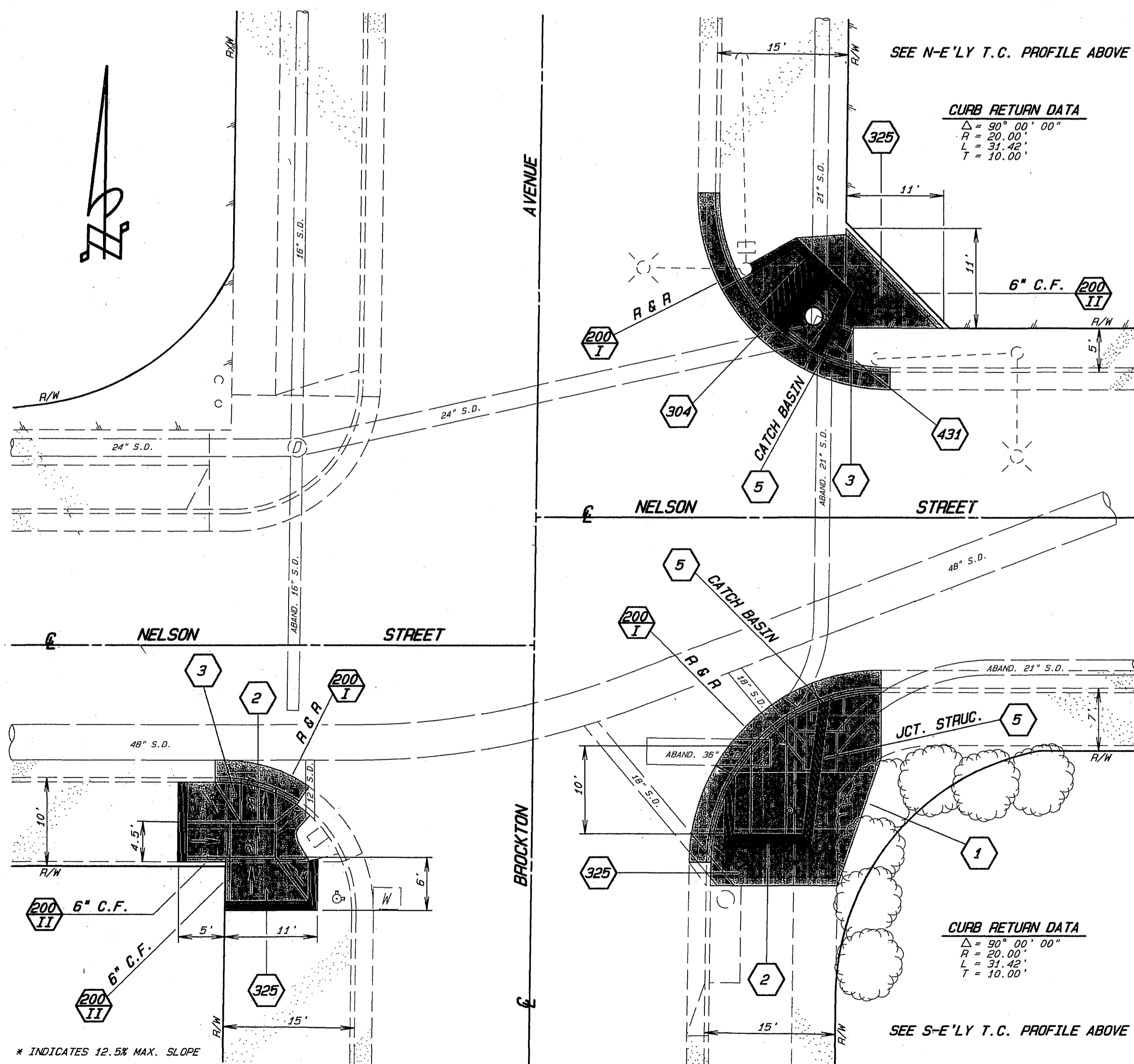

WHEELCHAIR RAMP DETAIL

SITE NO. 15

* INDICATES 12.5% MAX. SLOPE

CITY OF RIVERSIDE
PUBLIC WORKS DEPARTMENT

APPROVED BY	DATE	BY	APPROVED BY	DATE
DEPUTY P.W. DIRECTOR	5/19/93	RJG	PUBLIC WORKS DIRECTOR	5/18/93
PRINCIPAL ENGINEER	5/15/93	EE		
CHIEF P.W. INSPECTOR	5/15/93	EE		
SURVEYOR	5/10/93	EE		
TRAFFIC DIVISION				
PAVING DEPARTMENT				
STREET SERVICES				

WHEELCHAIR RAMPS
PHASE II
MAGNOLIA CENTER

ACCT. NO. 220-528200-453002-00000

R-3204

SHEET 3 OF 3

HORIZ. SCALE: 1" = 10' VERT. SCALE: 1" = 1'

INDEXED 12-7-94 LHM

