

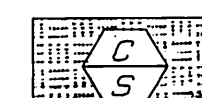

**CONSTRUCTION LEGEND**

-  CONSTRUCT STRUCTURAL SECTION OF 0.55" DGAC (DENSE GRADED ASPHALT CONCRETE) OVER 0.95" CL.2 CAB.
-  REMOVE & REPLACE EXISTING STRUCTURAL SECTION WITH 0.55" DGAC OVER 0.95" CL.2 CAB
-  VARIABLE THICKNESS DGAC OVERLAY (0.03' TO 0.40') OVER EXISTING A.C.

 PROTECT IN PLACE.

**SPECIFIC CONSTRUCTION NOTES**

NUMBERS ABOVE 100 IN A HEXAGON ON THE PLAN REFER TO THE RESPECTIVE STANDARD DRAWING AND SHALL BE CONSTRUCTED ACCORDINGLY. UNLESS MODIFICATIONS ARE NOTED ON THE PLAN OR COVER SHEET. ANY NUMBER SHOWN BELOW THE STANDARD DRAWING NUMBER INDICATES THE SPECIFIC ALTERNATE TO BE CONSTRUCTED.

- 1 ADJUST STORM DRAIN MANHOLE FRAME & COVER.
- 2 AIR VALVE & GUARD POST WILL BE RELOCATED BY CITY FORCES.

**GENERAL CONSTRUCTION NOTES**

- 1 EXISTING UTILITIES SHOWN ON THIS PLAN ARE PLOTTED FROM UTILITY RECORDS. THE CONTRACTOR IS REQUIRED TO TAKE DUE PRECAUTIONARY MEASURES TO LOCATE AND PROTECT ALL UTILITIES WHETHER OR NOT SHOWN ON THIS PLAN. IF THE COVER OF A UTILITY IS KNOWN, IT IS SHOWN IN THE PROFILE. UTILITIES IN THE PROFILE AS  INDICATES THAT THE COVER IS UNKNOWN, BUT THE UTILITY IS NOT EXPECTED TO CONFLICT WITH THE PROPOSED IMPROVEMENTS.
- 2 ALL ELEVATIONS SHOWN ON THE PLANS SHALL BE STAKED IN THE FIELD.
- 3 PRIME CONTRACTORS BIDDING THIS WORK SHALL HAVE A CLASS A OR C-12 LICENSE.
- 4 CONFLICTING UTILITIES SHOWN WITHIN THE CONSTRUCTION AREA WILL BE RELOCATED PRIOR TO CONSTRUCTION.
- 5 CURB & GUTTER SHALL BE STAKED WITH 3' OFFSETS AT 12.5' INTERVALS AND TWO ROWS OF #3 REBAR SHALL BE PLACED IN GUTTER WHERE GRADE IS LESS THAN 0.4%. PLACE 3/4" DOWEL PINS AT ALL EXPANSION JOINTS

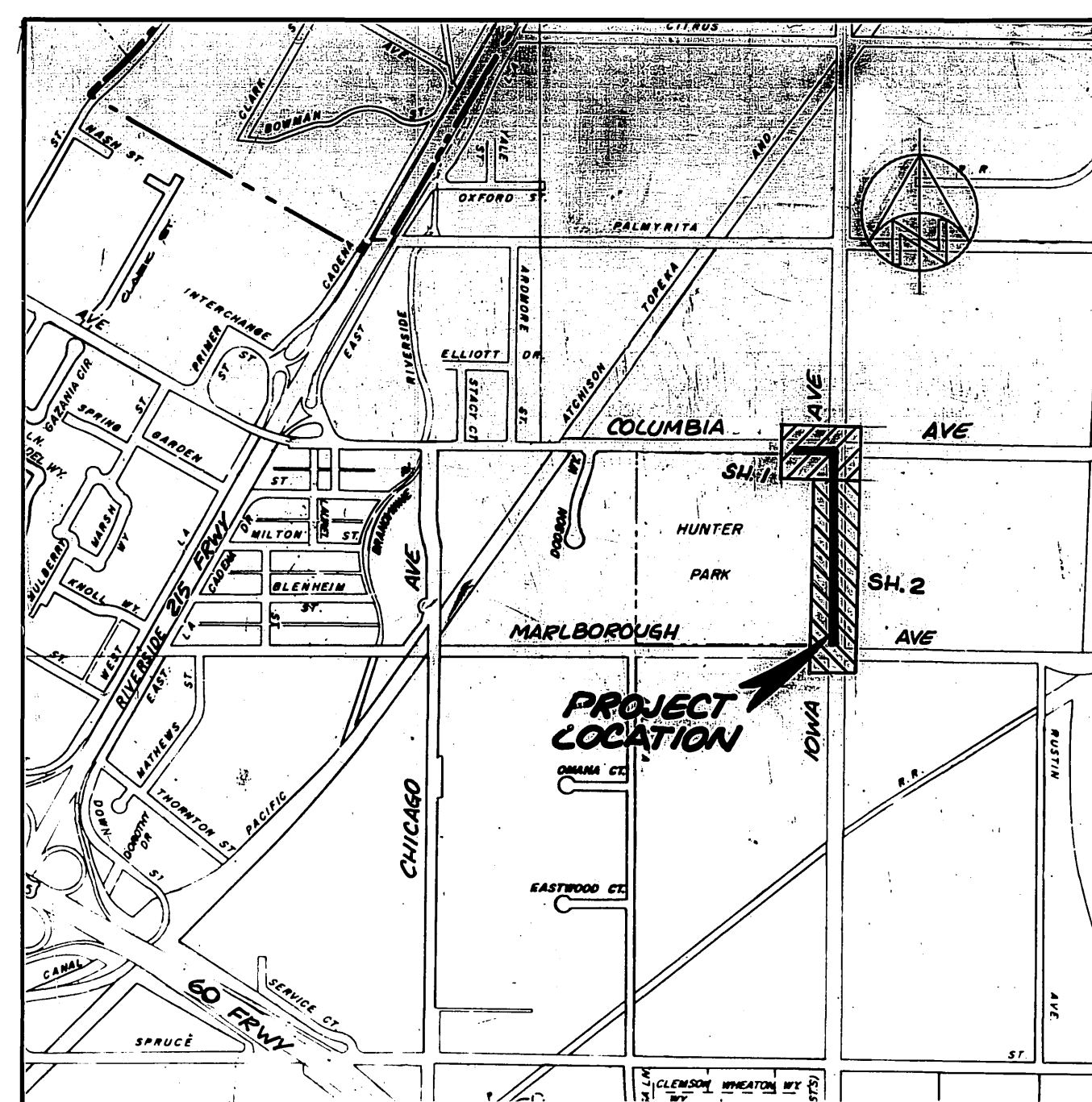
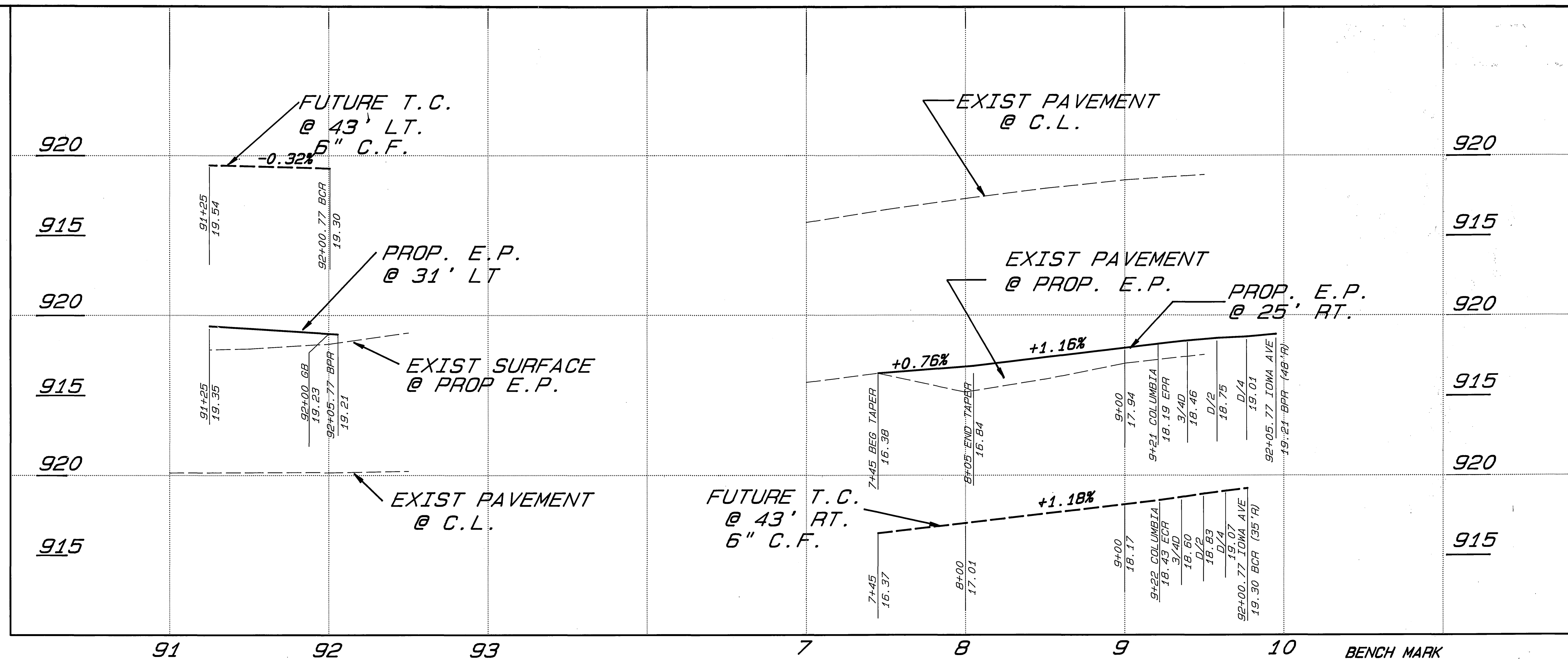

**PROJECT LOCATION MAP**

SCALE: 1"=1000'

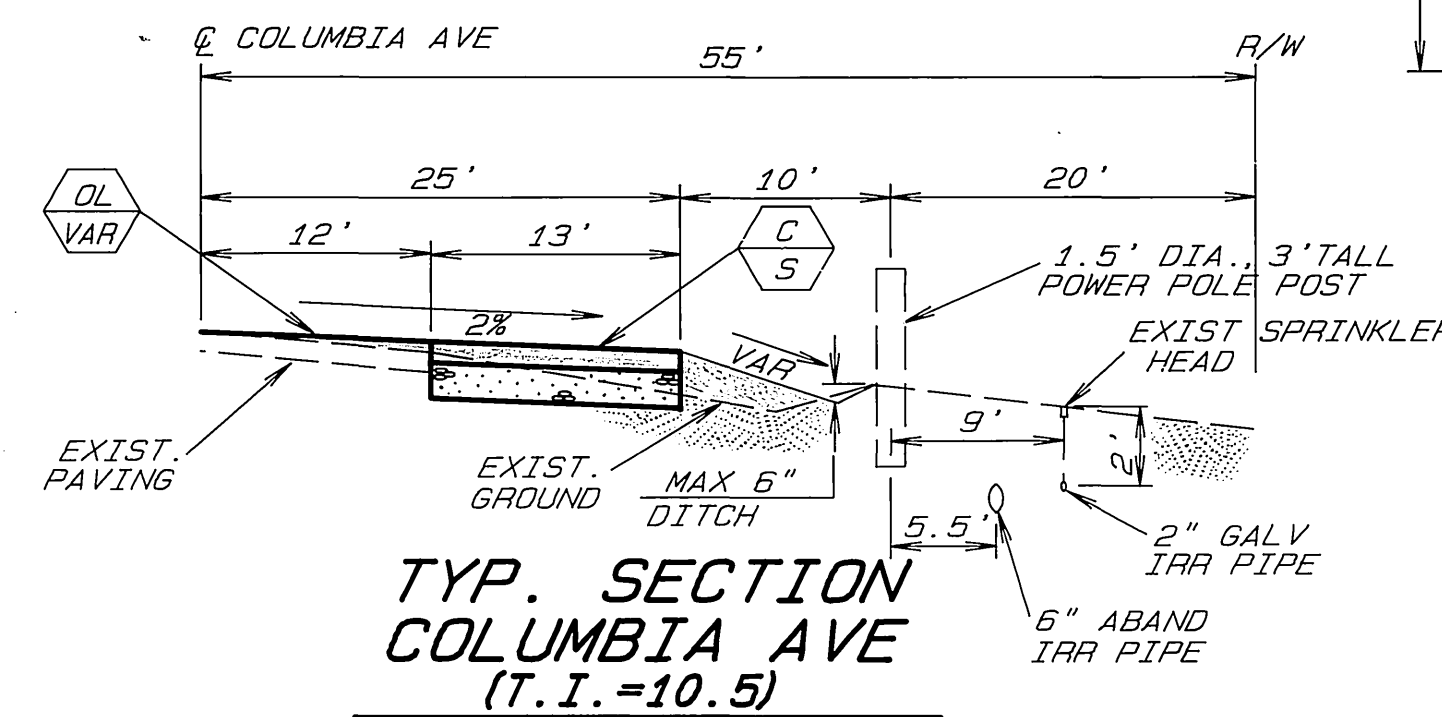
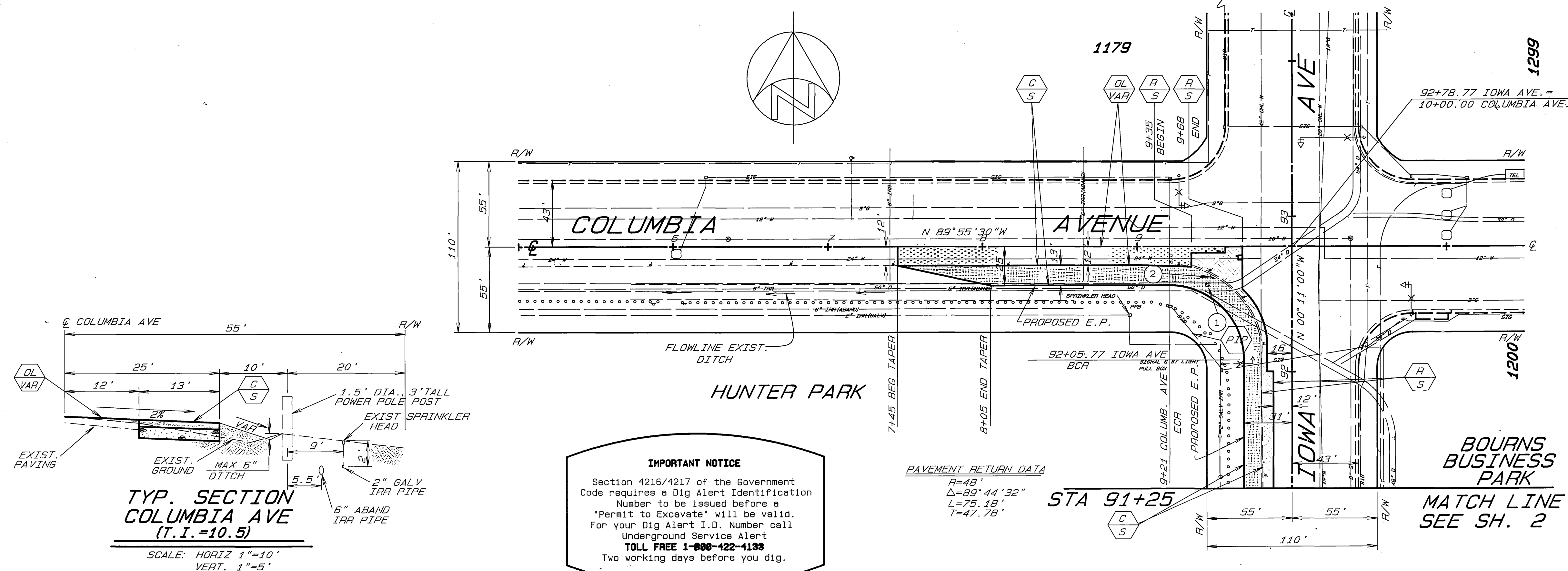

**TYP. SECTION COLUMBIA AVE (T.I. = 10.5)**

SCALE: HORIZ 1"=10' VERT. 1"=5'

**IMPORTANT NOTICE**  
Section 4216/4217 of the Government Code requires a Dig Alert Identification Number to be issued before a "Permit to Excavate" will be valid. For your Dig Alert I.D. Number call Underground Service Alert **TOLL FREE 1-800-422-4138** Two working days before you dig.

**PAVEMENT RETURN DATA**  
R=48'  
Δ=89°44'32"  
L=75.18'  
T=47.78'

**ENGINEER IN RESPONSIBLE CHARGE**  
Ronald C. Mueller  
RONALD C. MUELLER  
R.C.E. 29510 expires 3/31/05  
DATE 6/6/01



CITY OF RIVERSIDE PUBLIC WORKS DEPARTMENT			
APPROVED BY	DATE	BY	
DEPUTY P.W. DIRECTOR	6/7/01	R.H.G.	
PRINCIPAL ENGINEER	6/6/01	CS	
CHIEF P.W. INSPECTOR	6/3/01	CS	
SURVEYOR	5-28-01	SKP	
TRAFFIC DIVISION	6-3-01	CS	
STREET SERVICES	6-31-01	CS	

**IOWA AVENUE WIDENING  
MARLBOROUGH TO COLUMBIA**

ACCOUNT NO. 30-575-322-12  
**R-3209**  
SHEET 1 OF 2

HORIZ. SCALE: 1"=40' VERT. SCALE: 1"=4'

INDEXED 1-23-02

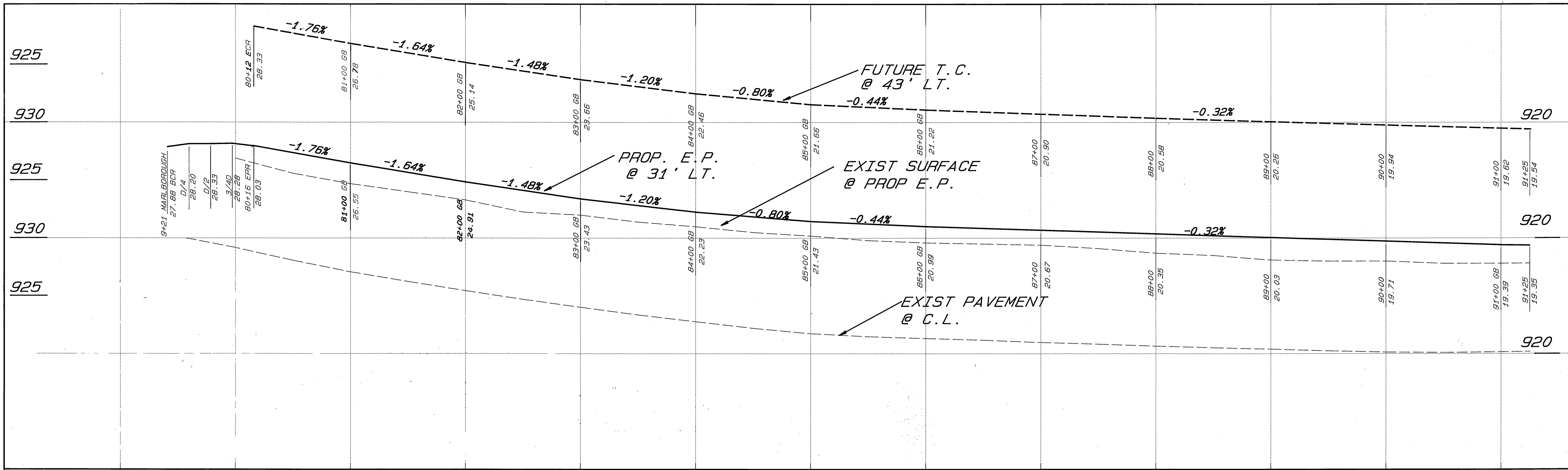

925  
930  
925  
930  
925  
920  
920  
920  
920

80 81 82 83 84 85 86 87 88 89 90 91

**BENCH MARK**  
BRASS DISC STAMPED JBA AT @ INT.  
OF MARLBOROUGH AVE AND IOWA AVE  
ELEV. 929.11

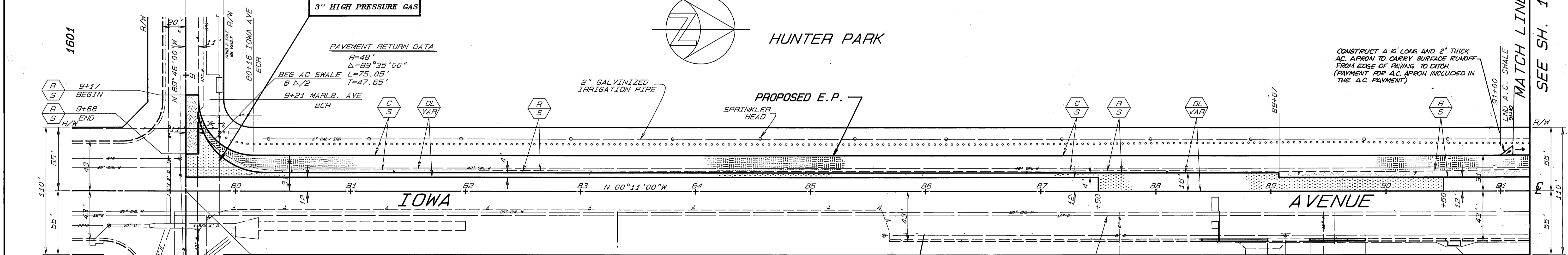

**CAUTION!!!**  
3" HIGH PRESSURE GAS

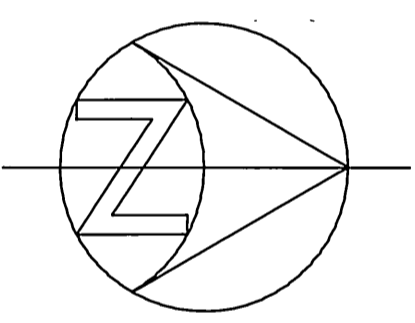

HUNTER PARK

CONSTRUCT A 10' LONG AND 2' THICK  
AC APRON TO CARRY SURFACE RUNOFF  
FROM EDGE OF PAVING TO DITCH  
(PAYMENT FOR A.C. APRON INCLUDED IN  
THE A.C. PAYMENT)

MATCH LINE  
SEE SH. 1

**PAVEMENT RETURN DATA**  
R=48'  
Δ=89°35'00"  
BEG AC SWALE @ D/2  
L=75.05'  
T=47.65'

2" GALVANIZED IRRIGATION PIPE

PROPOSED E.P.

SPRINKLER HEAD

79+57.00 IOWA AVE. =  
10+00.00 MARLBOROUGH AVE.

DAVIS DEVELOPMENTS (VACANT)

**CAUTION!!!**  
12" HIGH PRESSURE GAS

BOURNS BUSINESS PARK

NOTE: AFTER REMOVAL AND PRIOR TO C&G OR E.P. REPLACEMENT  
THE CONTRACTOR SHALL ALLOW 48 HRS. TO REQUEST SURVEY  
PLUS AN ADDITIONAL 48 HRS. TO RECEIVE PROPOSED GRADES  
FOR REPLACEMENT IMPROVEMENTS.

MARLBOROUGH AVENUE

**A.C. SWALE DETAIL**  
STA. 79+83 TO 91+00

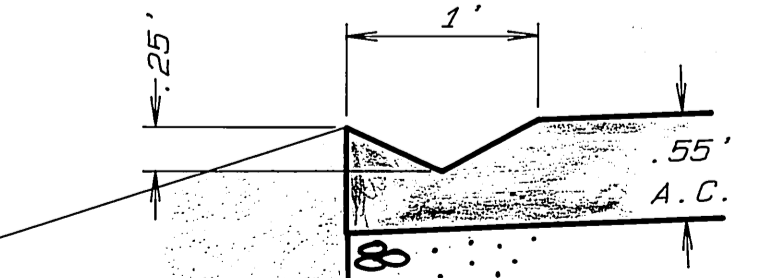

SCALE: 1"=1'

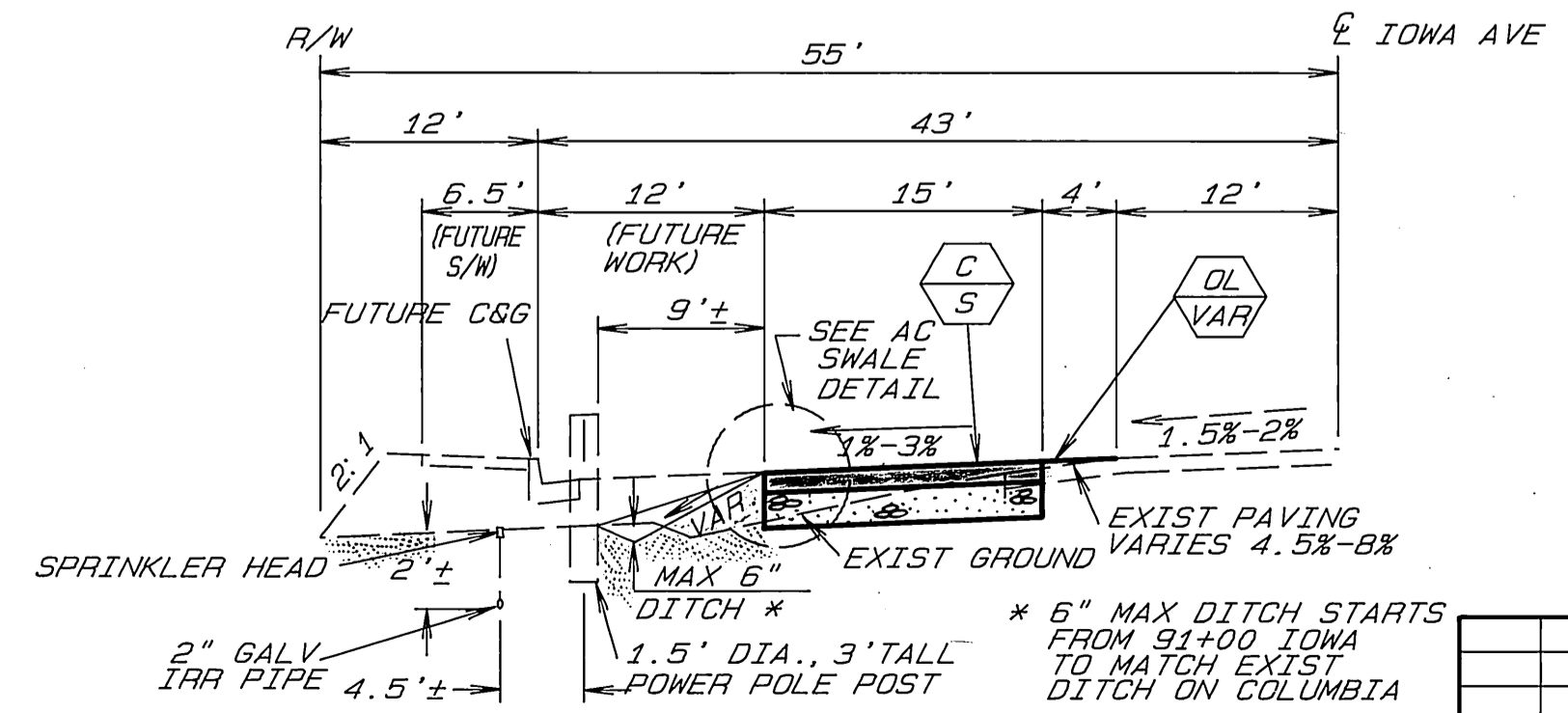

**TYP. SECTION IOWA AVE**  
STA. 80+23 TO 92+05

SCALE: HORIZ 1"=10', VERT 1"=5'  
(T. I. = 10.5)

<p><b>CITY OF RIVERSIDE</b> PUBLIC WORKS DEPARTMENT</p>				<p><b>IOWA AVENUE</b> WIDENING MARLBOROUGH TO COLUMBIA</p>		<p>ACCOUNT NO. 30-575-322-12 <b>R-3209</b></p>	
APPROVED BY	DATE	BY	DATE	APPROVED BY	DATE	BY	DATE
DEPUTY P.W. DIRECTOR	6/17/91	R.H.C.		PUBLIC WORKS DIRECTOR	6/12/91	Bary Paul	
PRINCIPAL ENGINEER	6/17/91	CS		DATE	6/12/91		
CHIEF P.W. INSPECTOR	5-28-91	AP					
SURVEYOR	5-28-91	AP					
DESIGNED BY	F.Y.L.	DRAWN BY	C.S.	CHECKED BY	K.C.M.		
TRAFFIC DIVISION	5-28-91						
STREET SERVICES	5-28-91						

HORIZ. SCALE: 1"=40' VERT. SCALE: 1"=4'

INDEXED 1-23-92 44