

GENERAL CONSTRUCTION NOTES

- EXISTING UTILITIES SHOWN ON THIS PLAN ARE PLOTTED FROM UTILITY RECORDS. THE CONTRACTOR IS REQUIRED TO TAKE DUE PRECAUTIONARY MEASURES TO LOCATE AND PROTECT ALL UTILITIES WHETHER OR NOT SHOWN ON THIS PLAN.
- PRIME CONTRACTORS BIDDING THIS WORK SHALL HAVE A CLASS A OR C-B LICENSE.
- CONFLICTING UTILITIES SHOWN WITHIN THE CONSTRUCTION AREA WILL BE RELOCATED PRIOR TO CONSTRUCTION.
- RIGHTS OF ENTRY HAVE BEEN OBTAINED FOR WORK SHOWN OUTSIDE OF CITY RIGHT-OF-WAY.
- TREES & SHRUBS AFFECTED BY THE PROPOSED SIDEWALK CONSTRUCTION SHALL BE TRIMMED TO AT LEAST 6' VERTICALLY ABOVE THE SIDEWALK SURFACE AND TO AT LEAST 3' LATERALLY OF THE SIDEWALK WHERE RIGHT-OF-WAY PERMITS.
- MAILBOXES INTERFERING WITH PROPOSED SIDEWALK CONSTRUCTION SHALL BE TEMPORARILY RELOCATED TO ENABLE PROPERTY OWNERS TO RECEIVE THEIR MAIL AND BE REINSTALLED IN FINAL POSITION BY THE CONTRACTOR.
- WATER METERS, GAS METERS AND STREET LIGHT PULL BOXES AFFECTED BY CONSTRUCTION SHALL BE ADJUSTED TO THE PROPOSED SIDEWALK GRADE.
- EXIST SPRINKLERS AND IRRIGATION LINES AFFECTED BY THE CONSTRUCTION OF THE PROPOSED SIDEWALK SHALL BE RELOCATED TO THE BACK OF THE SIDEWALK.

SPECIFIC CONSTRUCTION NOTES

- NUMBERS ABOVE 100 IN A HEXAGON ON THE PLAN REFER TO THE RESPECTIVE STANDARD DRAWING AND SHALL BE CONSTRUCTED ACCORDINGLY UNLESS MODIFICATIONS ARE NOTED ON THE PLAN OR COVER SHEET. ANY NUMBER SHOWN BELOW THE STANDARD DRAWING NUMBER INDICATES THE SPECIFIC ALTERNATE TO BE CONSTRUCTED.
- R I** REMOVE EXISTING TREE CLASS I-6 TO 18 CLASS II-18 TO 36 CLASS III-OVER 36
- ST** PLANT STREET TREE (24 BOX 12 PLACES) AS DIRECTED BY TREE INSPECTOR AND AS DESCRIBED IN PARK & RECREATION SECTION OF THE ACCOMPANYING SPECIAL PROVISIONS AND AS SPECIFIED HEREON.
- NB-D C** STATE OF CALIFORNIA BUSINESS AND TRANSPORTATION AGENCY DEPT. OF TRANSPORTATION STANDARD PLANS DATED JANUARY 1988
- W** WATER METER TO BE RELOCATED BY P U WATER DIVISION
- E** P POLE GUY TO BE RELOCATED BY P U ELECTRIC DIVISION

GENERAL NOTES FOR TREE PLANTING

- ALL RELATED WORK SHALL CONFORM TO THE CITY OF RIVERSIDE PARK AND RECREATION DEPARTMENT STANDARDS.
- CONTACT THE STREET TREE INSPECTOR A MINIMUM OF 48 HOURS IN ADVANCE AT 351-6126 TO SCHEDULE INSPECTION. INSPECTIONS SHALL BE REQUIRED:
 - WHEN PLANT LOCATIONS HAVE BEEN SPOTTED IN THE FIELD PRIOR TO DIGGING PLANT PITS.
 - WHILE DIGGING PLANT PITS AND PLANTING/RELOCATING TREES.
 - AFTER PLANTING AND ALL OTHER INDICATED OR SPECIFIED WORK HAS BEEN COMPLETED FOR START OF MAINTENANCE.
 - AT END OF MAINTENANCE/FINAL ACCEPTANCE (CONTRACTOR WILL BE RELEASED FROM MAINTENANCE ONLY UPON RECEIPT OF WRITTEN NOTIFICATION FROM THE CITY THAT THE PARK AND RECREATION DEPARTMENT IS ASSUMING MAINTENANCE RESPONSIBILITIES).
- THE CONTRACTOR SHALL MAINTAIN ALL PLANTINGS FOR A MINIMUM PERIOD OF ONE (1) YEAR.
- STREET TREE PLANTING SHALL BE AS FOLLOWS:

STREET NAME	BOTANICAL NAME/COMMON NAME	MIN SIZE	APPROX NO	SPACING	REQ
a) MADISON ST	MAGNOLIA GRANDIFLORA (MAJESTIC BEAUTY)	MAGNOLIA 24 BOX	60	60	12
- PARK AND RECREATION DEPARTMENT AND PUBLIC WORKS DEPARTMENT PERMITS ARE REQUIRED PRIOR TO COMMENCEMENT OF TREE RELOCATION AND/OR REMOVAL WORK. FOR ALL TREE REMOVALS BACKFILL OF ALL HOLES IS TO BE INSPECTED BY THE CITY FOR PROPER COMPACTION.
- ANY STREET TREES REQUIRING ROOT PRUNING SHALL BE INSPECTED BY THE STREET TREE INSPECTOR PRIOR TO PRUNING TO INSURE AGAINST EXCESSIVE ROOT DAMAGE AND TREE INSTABILITY. ROOTS SHALL BE PRUNED TO 12" BELOW THE SUBGRADE.

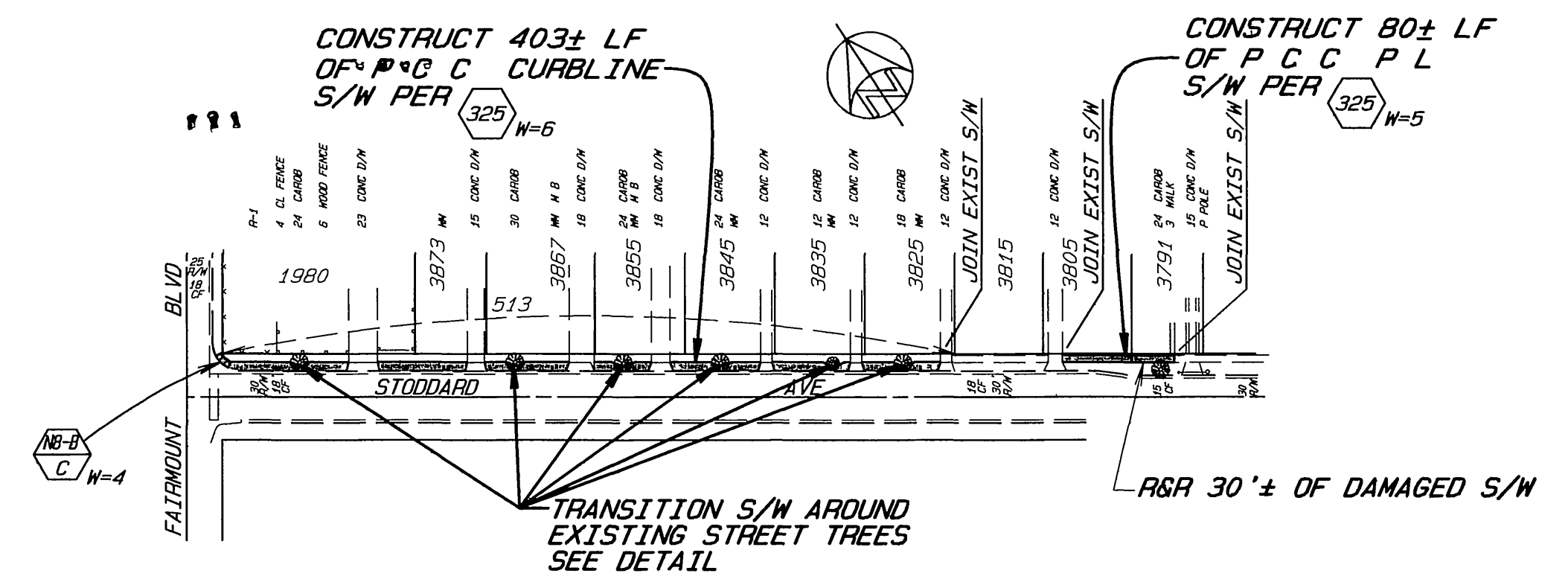
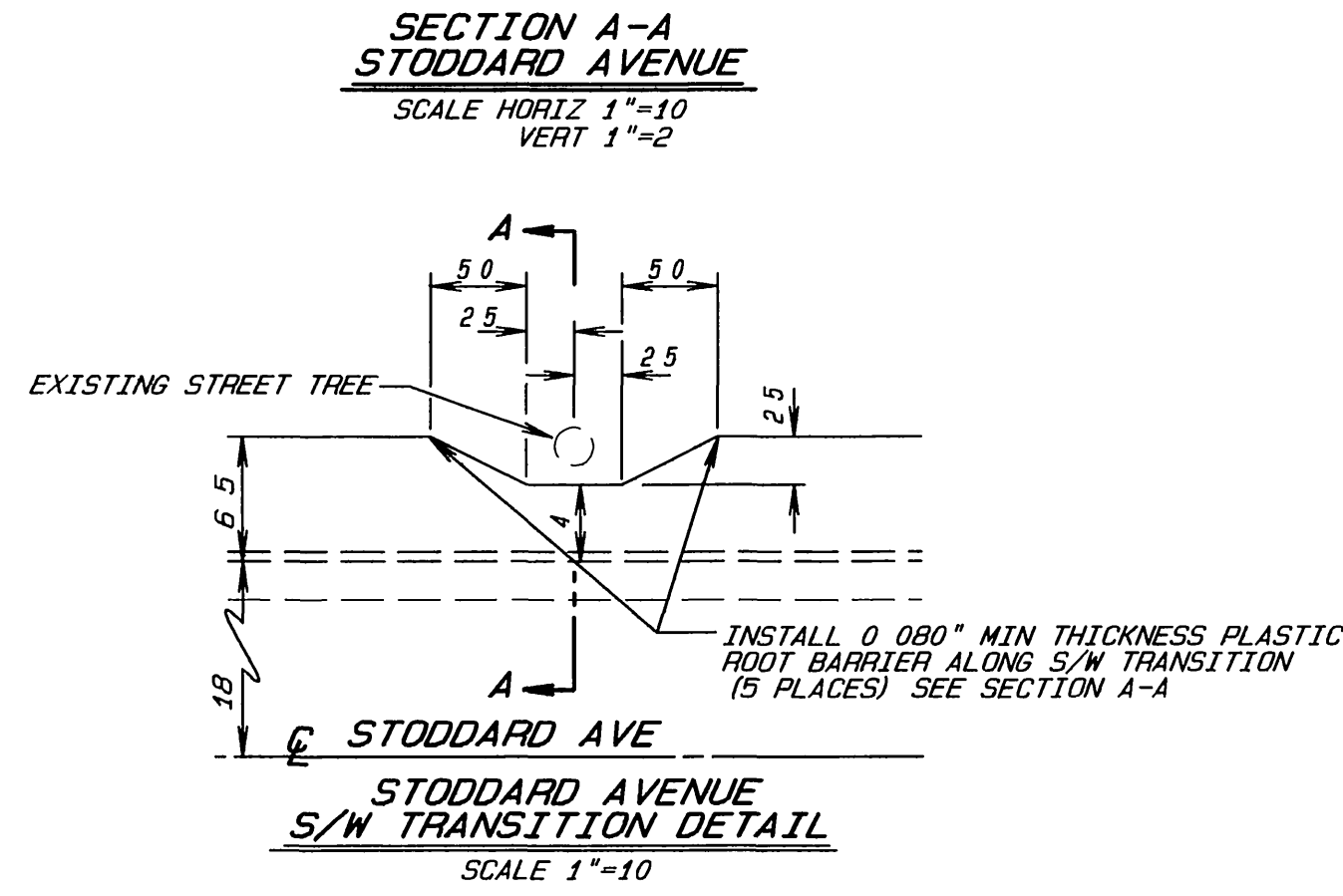
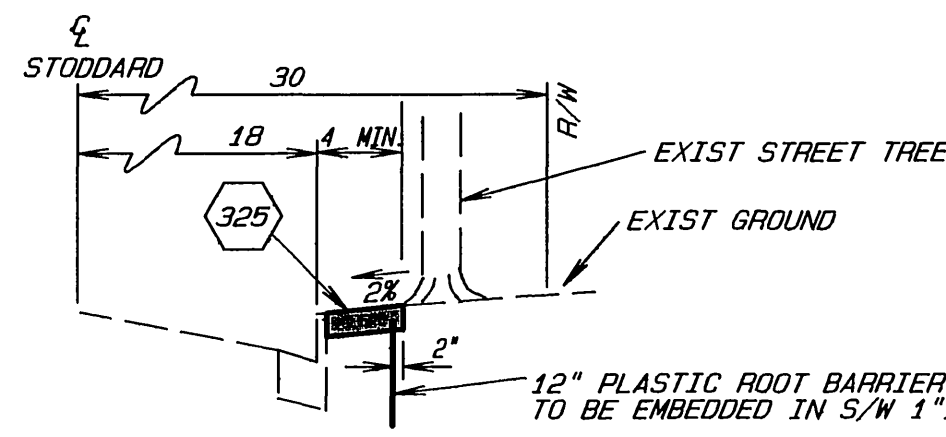

② STODDARD AVE (N'LY SIDE) - FAIRMOUNT TO 600'± E'LY

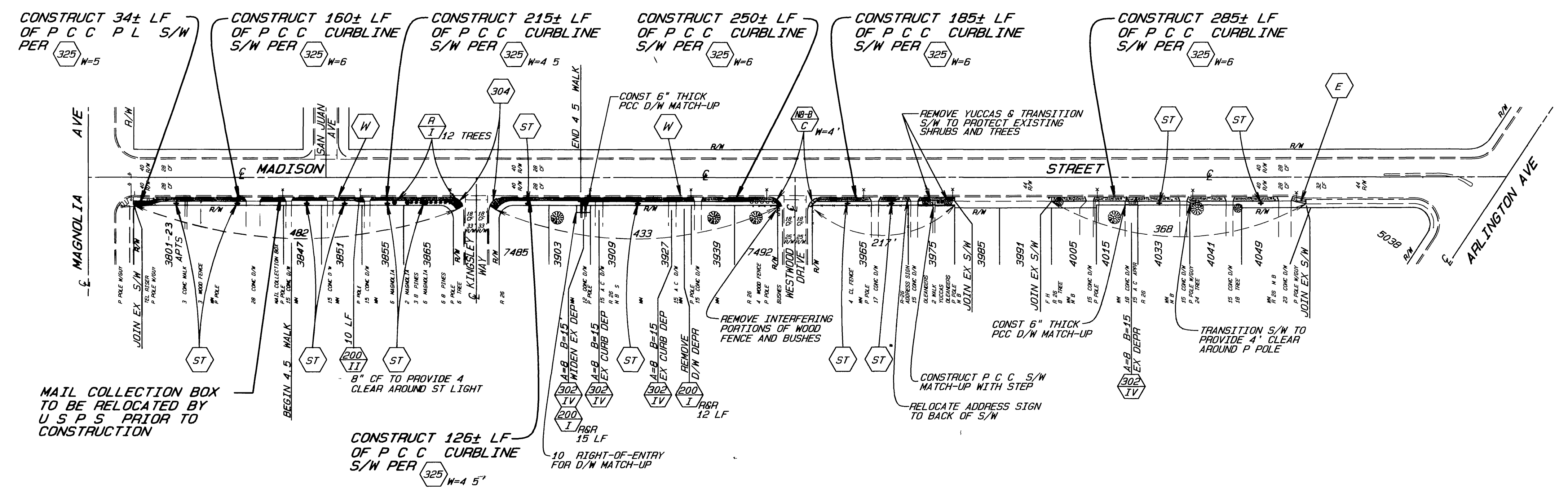
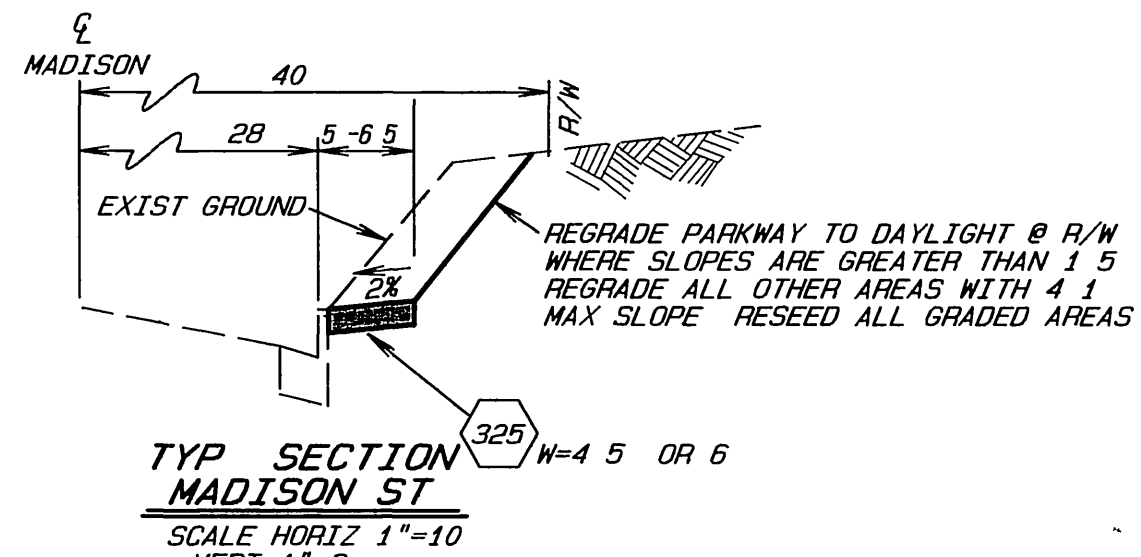

① MADISON STREET (E'LY SIDE) - MAGNOLIA TO ARLINGTON

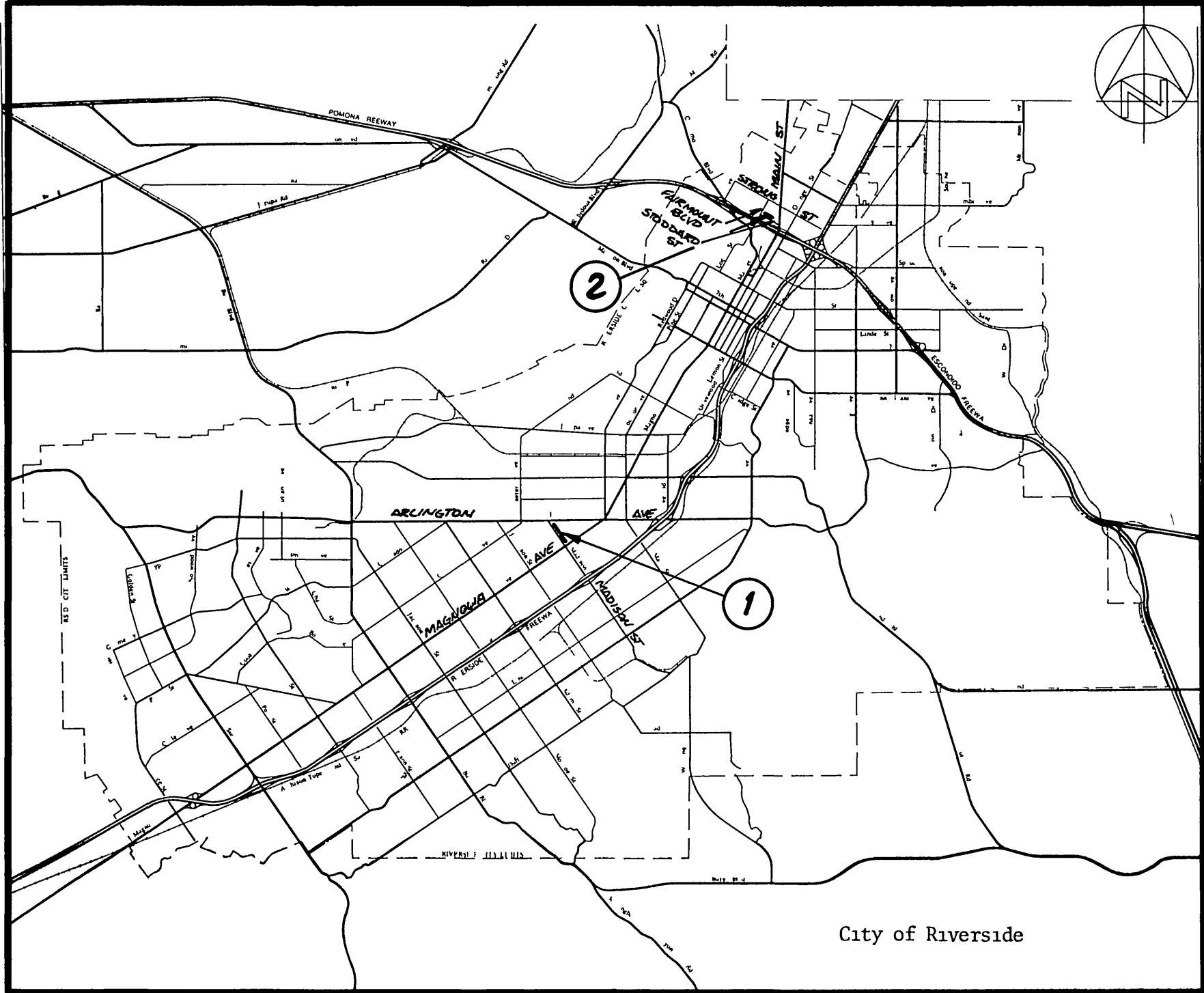

PROJECT LOCATION MAP

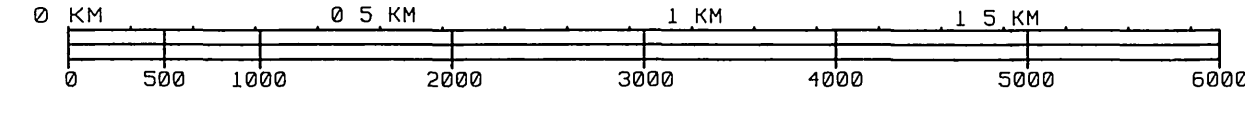

SCALE: 1"=8,000'

IMPORTANT NOTICE
 Section 4216/4217 of the Government Code requires a Dig Alert Identification Number to be issued before a Permit to Excavate will be valid. For your Dig Alert ID Number call Underground Service Alert TOLL FREE 1-800-422-4133 Two working days before you dig.

ENGINEER IN RESPONSIBLE CHARGE
 Ronald C. Mueller
 RONALD C. MUELLER
 R C E 29510 expires 3/31/95
 DATE 6/11/92

CITY OF RIVERSIDE
 PUBLIC WORKS DEPARTMENT

APPROVED BY: [Signature] DATE: 6/18/92
 DEPUTY P.W. DIRECTOR
 PRINCIPAL ENGINEER
 CHIEF P.W. INSPECTOR

APPROVED BY: [Signature] DATE: 6/18/92
 PUBLIC WORKS DIRECTOR

DESIGNED BY: CS DRAWN BY: CS CHECKED BY: ACM

S/W CONSTRUCTION @ VARIOUS LOCATIONS 1991/1992

ACCOUNT NO 30-575-342-09
R-3247
 SHEET 1 OF 1

HORIZ SCALE 1"=100 VERT SCALE 1"=N/A

INDEXED 7-29-99 LH