

RIVERSIDE CITY OF RIVERSIDE CALIFORNIA

PUBLIC WORKS DEPARTMENT CHICAGO AVENUE MEDIANS S.P.R.R. TO COLUMBIA AVENUE

CONSTRUCTION LEGEND

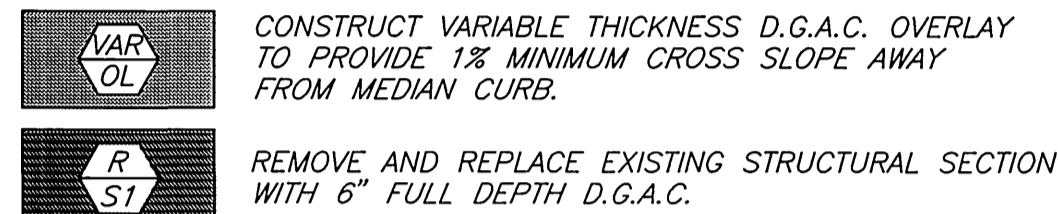
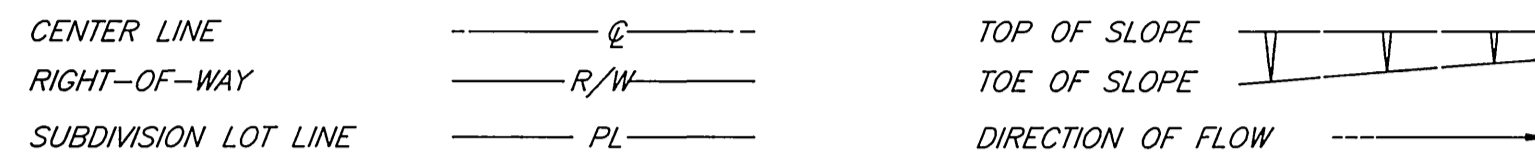

SPECIFIC CONSTRUCTION NOTES

- NUMBERS ABOVE 100 IN A HEXAGON ON THE PLAN REFER TO THE RESPECTIVE STANDARD DRAWING AND SHALL BE CONSTRUCTED ACCORDINGLY. UNLESS MODIFICATIONS ARE NOTED ON THE PLAN OR COVER SHEET. ANY NUMBER SHOWN BELOW THE STANDARD DRAWING NUMBER INDICATES THE SPECIFIC ALTERNATE TO BE CONSTRUCTED.
- ADJ. ADJUST SEWER, STORM DRAIN, ELECTRIC OR WATER MANHOLE OR GATE VALVE TO GRADE. ADJUSTMENT TO GRADE OR RELOCATION OF GAS & TELEPHONE COMPANY'S FACILITIES WILL BE DONE BY OTHERS.
- TDL 3- TRAFFIC DETECTOR LOOP INSTALLATIONS. NUMBER OF DETECTOR LOOPS.
- TDL PIP PROTECT TRAFFIC DETECTOR LOOPS IN PLACE.
- B INDICATES DETAIL.
- L3 INDICATES SHEET NO.
- 1 REMOVE EXISTING CURB FROM MEDIAN NOSE.
- 2 CONSTRUCT 4" THICK STAMPED CONCRETE. COLOR SHALL BE ADOBE TAN, C-21. USE 12" X 12" TILE PATTERN OR CITY APPROVED EQUAL.
- 3 CONSTRUCT 20 L.F. 18" R.C.P., 1000 D. (SEE DETAIL "C" SHEET 5)
- 4 INSTALL R-7 TRAFFIC CONTROL SIGN PER STD. 666.
- 5 CONSTRUCT CURB AROUND EXISTING SEWER MANHOLE.
- 6 REMOVE EXIST. STRUCTURAL SECTION BETWEEN PROPOSED CURBS AND FILL WITH CLEAN EARTHEN MATERIAL.
- 7 CONSTRUCT SUPER FIRE HYDRANT PER STD. CWD-700.
- 8 GRADE TO DRAIN. (0.5% MIN.)
- 9 INSTALL R-10 TRAFFIC CONTROL SIGN PER STD. 666
- 10 INSTALL R-34-2 TRAFFIC CONTROL SIGN PER STD. 666

GENERAL CONSTRUCTION NOTES

- EXISTING UTILITIES SHOWN ON THIS PLAN ARE PLOTTED FROM UTILITY RECORDS. THE CONTRACTOR IS REQUIRED TO TAKE DUE PRECAUTIONARY MEASURES TO LOCATE AND PROTECT ALL UTILITIES WHETHER OR NOT SHOWN ON THIS PLAN. IF THE COVER OF A UTILITY IS KNOWN, IT IS SHOWN IN THE PROFILE. UTILITIES SHOWN IN THE PROFILE AS " " INDICATES THAT THE COVER IS UNKNOWN, BUT THE UTILITY IS NOT EXPECTED TO CONFLICT WITH THE PROPOSED IMPROVEMENTS.
- ALL ELEVATIONS SHOWN ON THE PLANS SHALL BE STAKED IN THE FIELD.
- PRIME CONTRACTORS BIDDING THIS WORK SHALL HAVE A CLASS A OR C-B LICENSE.
- CONSTRUCTION SHALL BE IN ACCORDANCE WITH THE CITY OF RIVERSIDE STANDARD DWGS AND STANDARD SPECIFICATIONS FOR PUBLIC WORKS CONSTRUCTION, 1994 EDITION.
- EXISTING 18" R.C.P. AT STA. 52+60 SHALL BE EXPOSED AND ELEVATIONS VERIFIED BY CITY SURVEYORS PRIOR TO THE ISSUANCE OF GRADE SHEETS.

EXISTING UNDERGROUND & TOPOGRAPHY LEGEND

EXISTING UNDERGROUND UTILITIES:

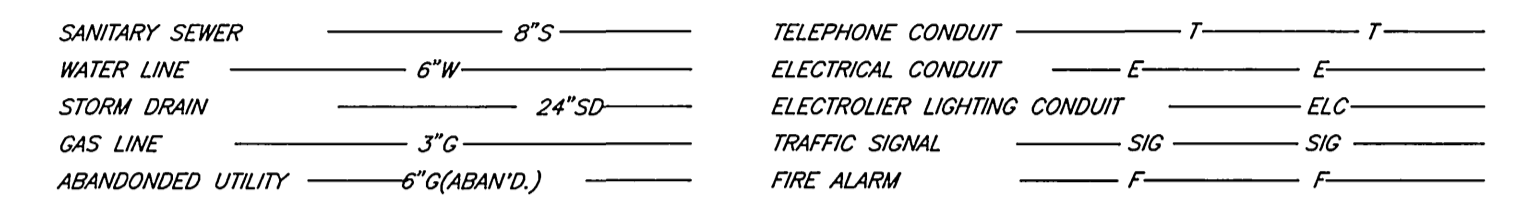

EXISTING TOPOGRAPHY:

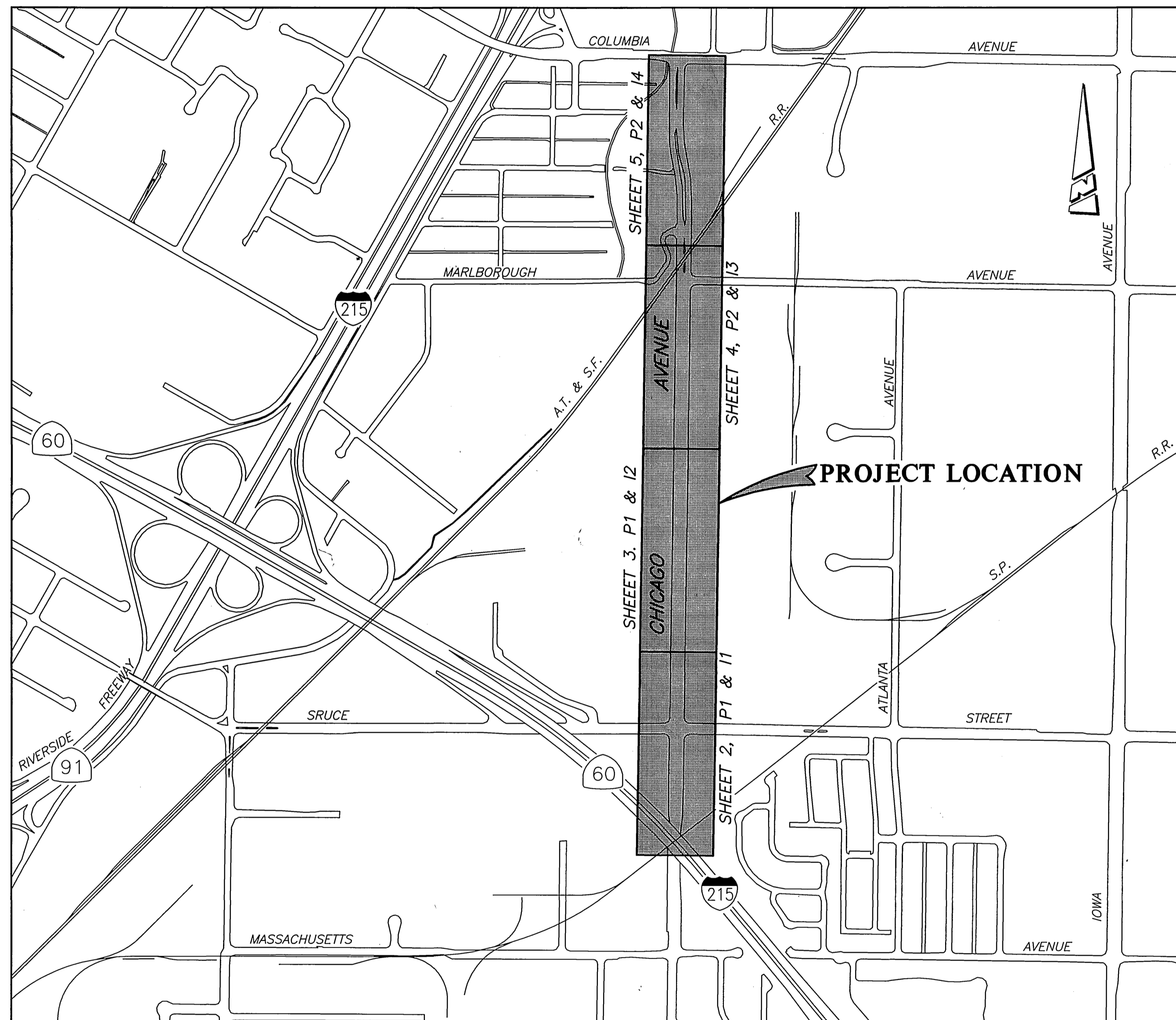
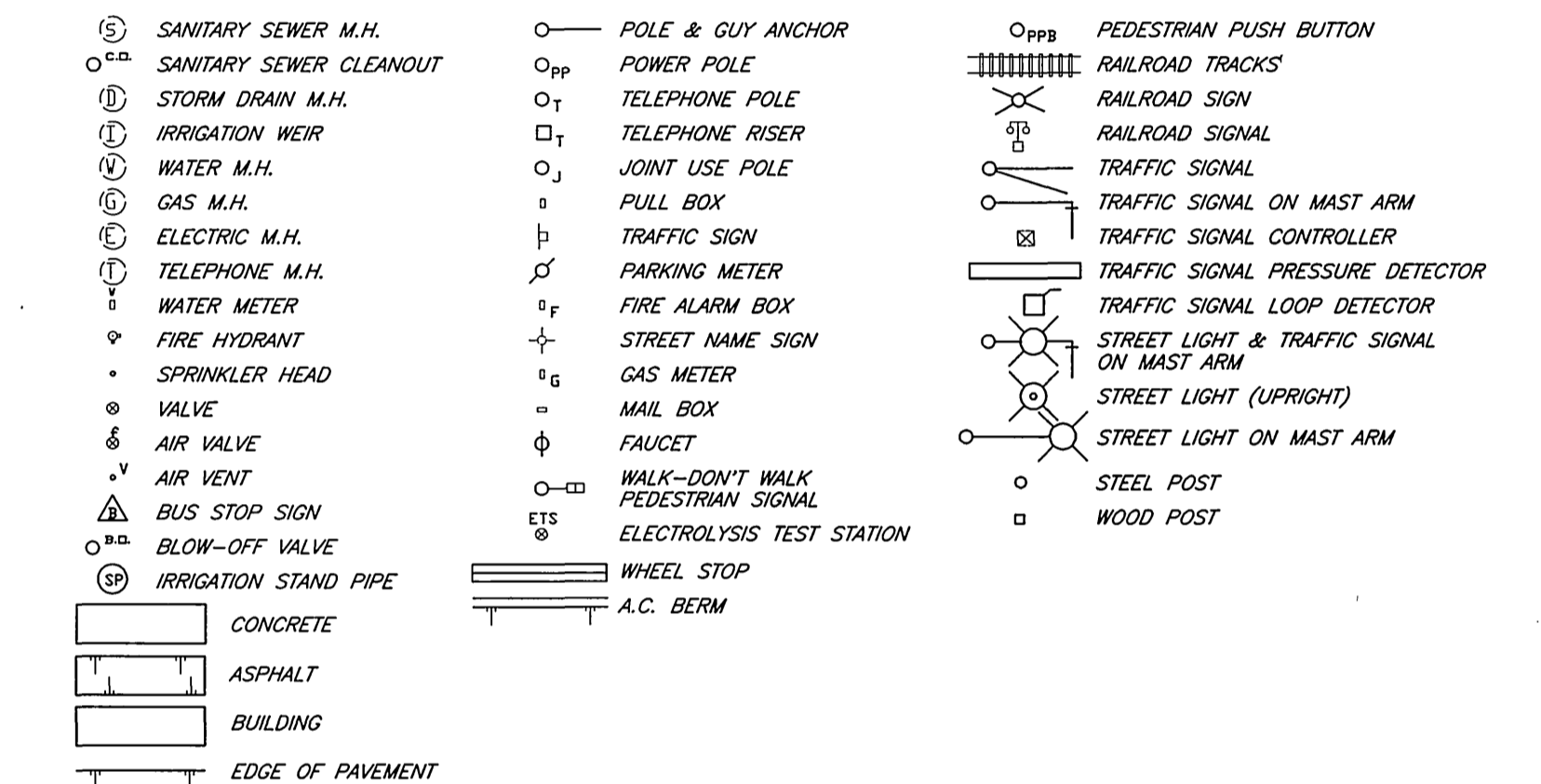
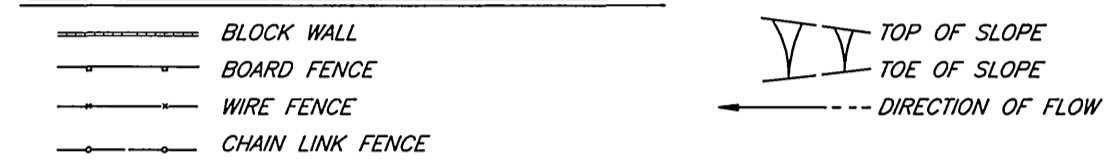

PROJECT LOCATION PLAN

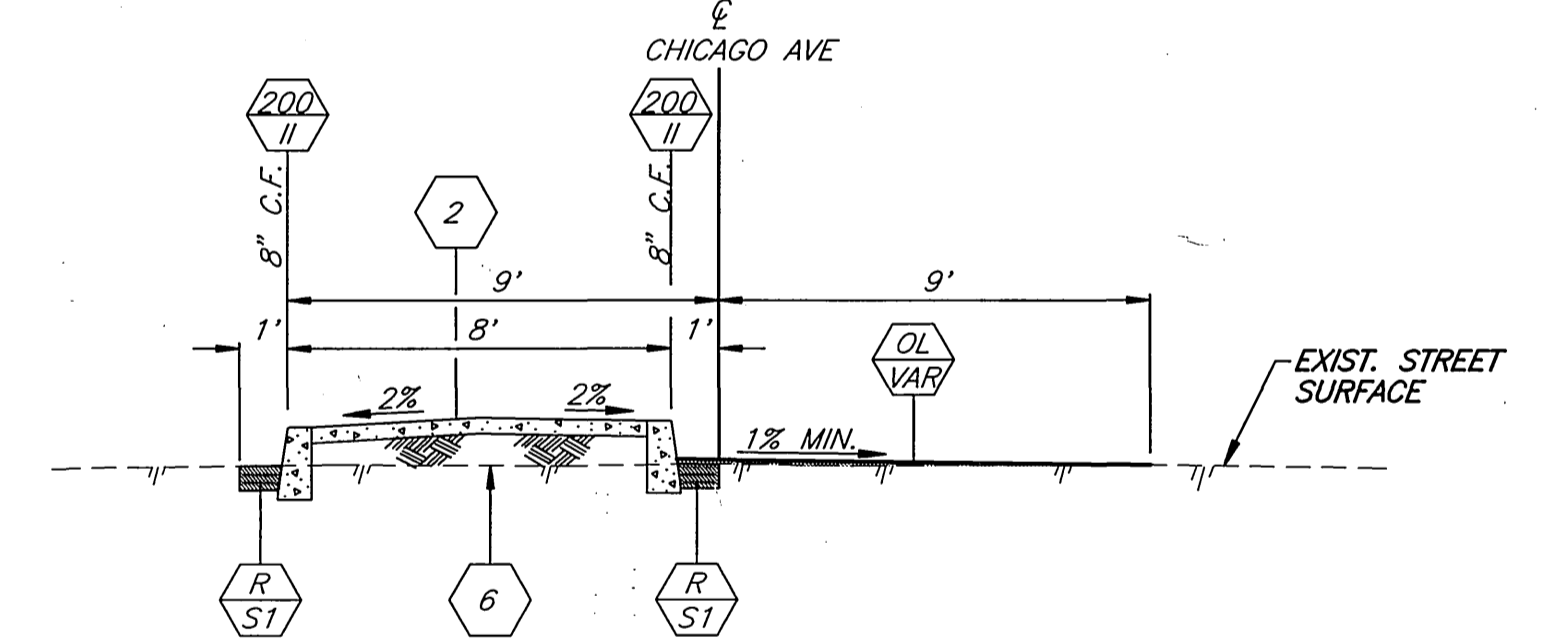
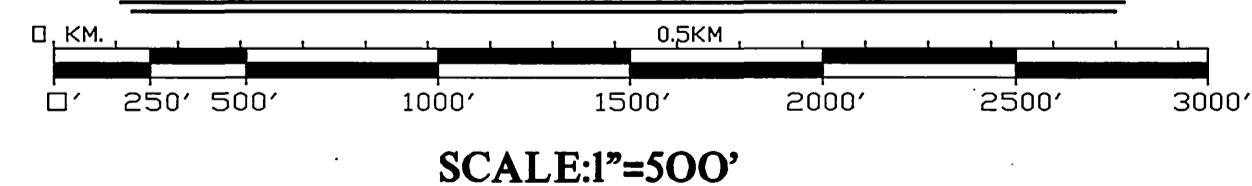

TYPICAL SECTION LEFT TURN POCKET
SCALE: 1"=4'

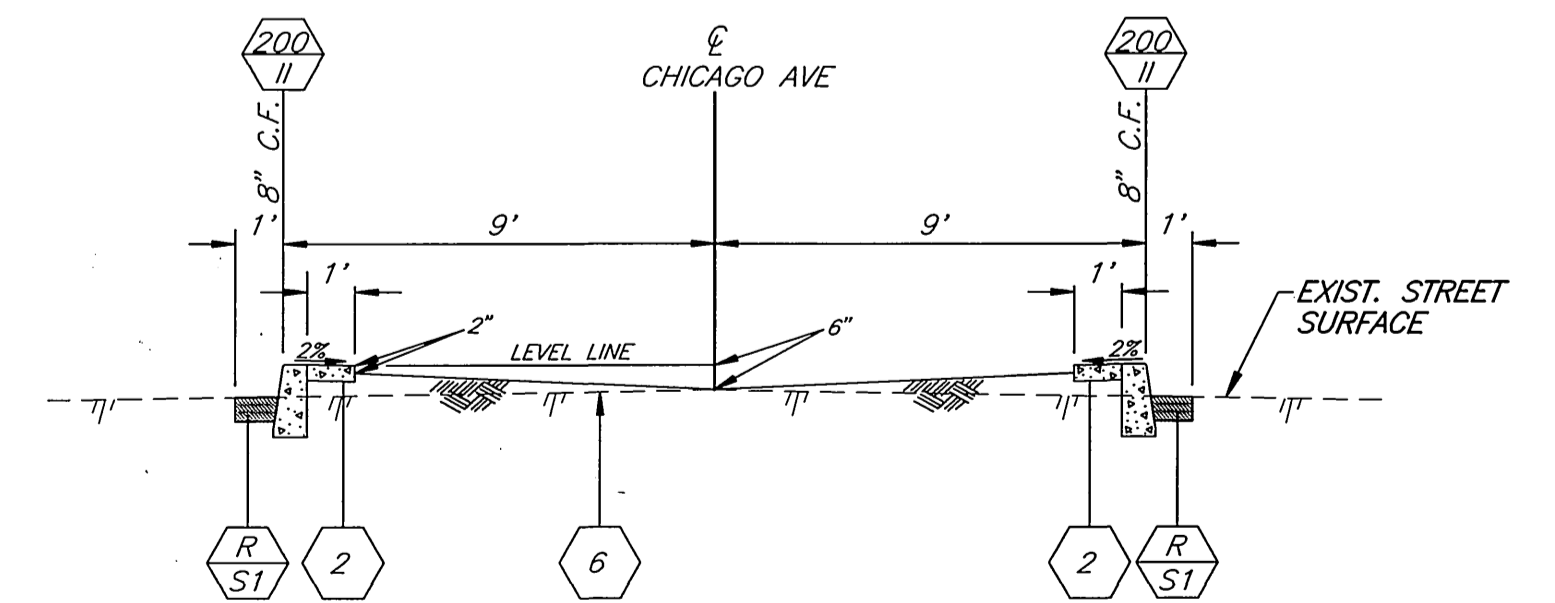

TYPICAL SECTION FULL MEDIAN WIDTH
SCALE: 1"=4'

IMPORTANT NOTICE
Section 4216/4217 of the Government Code requires a Dig Alert Identification Number to be issued before a "Permit to Excavate" will be valid. For your Dig alert I.D. Number call CALL TOLL FREE 48 HOURS BEFORE YOU DIG UNDERGROUND SERVICE ALERT 1-800-227-2600

ENGINEER IN RESPONSIBLE CHARGE
Ronald C. Mueller
RONALD C. MUELLER
R.C.E. No. 29510 expires 3/31/99
DATE 5-14-97

REGISTERED PROFESSIONAL ENGINEER
RONALD C. MUELLER
No. 29510
Exp. 3-31-99
CIVIL
STATE OF CALIFORNIA

MARK REVISIONS APPR. DATE
DESIGNED BY R.G. FANN DRAWN BY CURT CHECKED BY RCM

CITY OF RIVERSIDE, CALIFORNIA
PUBLIC WORKS DEPARTMENT
APPROVED BY [Signature] DATE 5/16/97
DEPUTY P.W. DIRECTOR
PRINCIPAL ENGINEER
CHIEF P.W. INSPECTOR
STREET SERVICES
SURVEYOR
TRAFFIC DIVISION
PARKS DEPARTMENT

CHICAGO AVENUE
MEDIANS
S.P.R.R. TO COLUMBIA AVE

AS BUILT 7/2/98 R/M
ACCT. NO. 430-541500-440222-30083
R-3256
SHEET 1 OF 6
FILE NO.

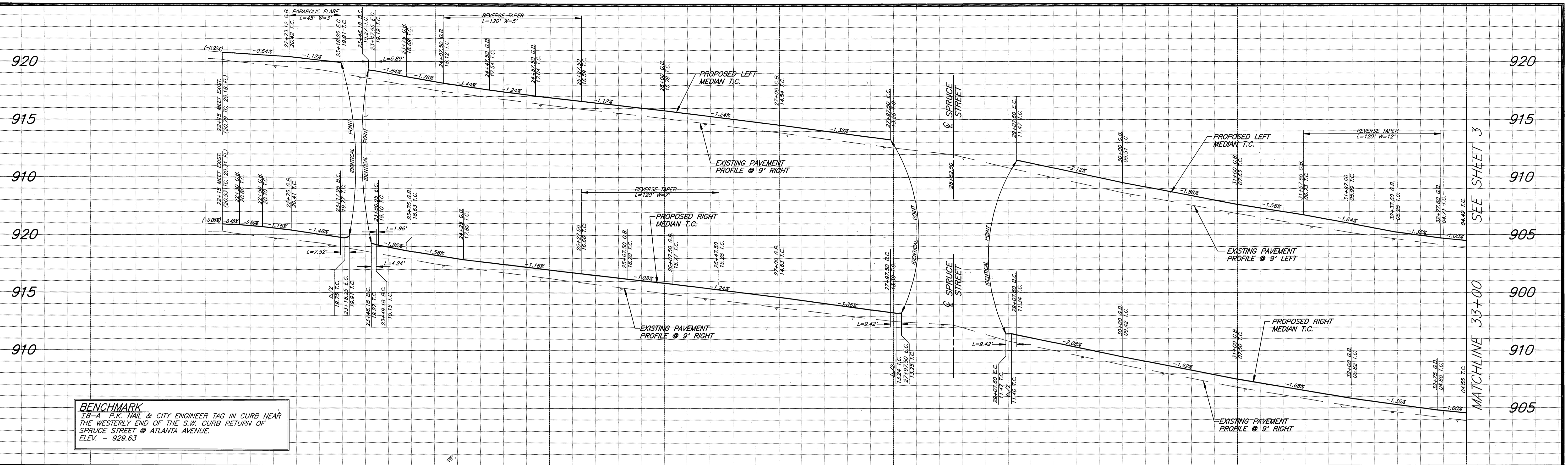

BENCHMARK
 18-A P.K. NAIL & CITY ENGINEER TAG IN CURB NEAR THE WESTERLY END OF THE S.W. CURB RETURN OF SPRUCE STREET @ ATLANTA AVENUE. ELEV. = 929.63

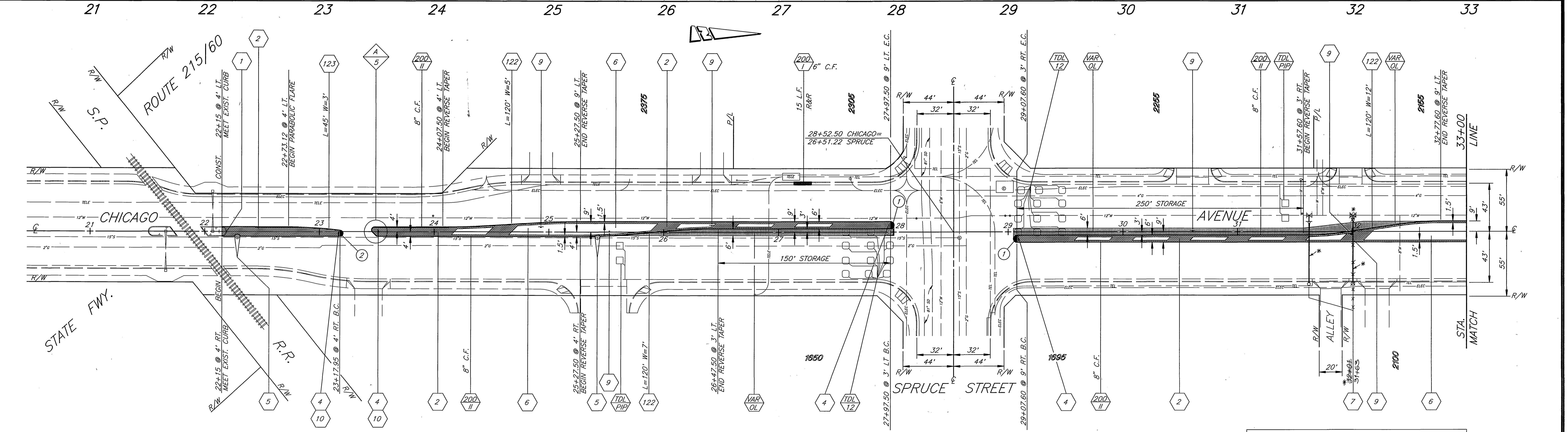

CONSTRUCTION NOTES

- 1 REMOVE EXISTING CURB FROM MEDIAN ISLAND NOSE
- 2 CONSTRUCT 4" THICK STAMPED CONCRETE. COLOR SHALL BE ADOBE TAN, C-21. USE 12" X 12" TILE PATTERN OR CITY APPROVED EQUAL.
- 4 INSTALL R-7 TRAFFIC CONTROL SIGN PER STD. 666.
- 5 CONSTRUCT CURB AROUND EXISTING SEWER MANHOLE.
- 6 REMOVE EXIST. STRUCTURAL SECTION BETWEEN PROPOSED CURBS AND FILL WITH CLEAN EARTHEN MATERIAL.
- 7 CONSTRUCT SUPER FIRE HYDRANT PER STD. CWD-700.
- 9 INSTALL R-10 TRAFFIC CONTROL SIGN PER STD. 666.
- 10 INSTALL R-34-2 TRAFFIC CONTROL SIGN PER STD. 666.

CONSTRUCTION LEGEND

CONSTRUCT VARIABLE THICKNESS D.G.A.C. OVERLAY TO PROVIDE 1% MINIMUM CROSS SLOPE AWAY FROM MEDIAN CURB.

CURVE DATA				
	△	R	L	T
1	180° 00' 00"	3.00'	9.42'	
2	172° 24' 19"	2.50'	7.52'	37.67'

ENGINEER IN RESPONSIBLE CHARGE
Ronald C. Mueller
 RONALD C. MUELLER
 R.C.E. No. 29510 expires 3/31/99
 DATE 5-14-97

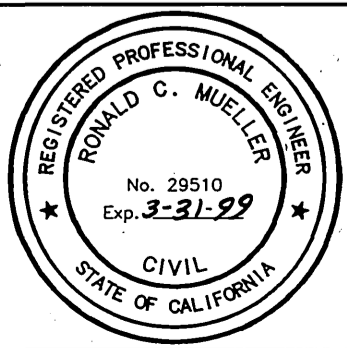

CITY OF RIVERSIDE, CALIFORNIA
 PUBLIC WORKS DEPARTMENT
 APPROVED BY: *[Signature]*
 DEPUTY P.W. DIRECTOR
 PRINCIPAL ENGINEER
 CHIEF P.W. INSPECTOR
 SUPERVISOR
 TRAFFIC DIVISION
 PARKS DEPARTMENT

CHICAGO AVENUE
 MEDIANS
 S.P.R.R. TO COLUMBIA AVENUE

*AS BUILT 7/7/98 B.M.
 ACCT. NO. 430-541500-44022-30083
R-3256
 SHEET 2 OF 6
 FILE NO.

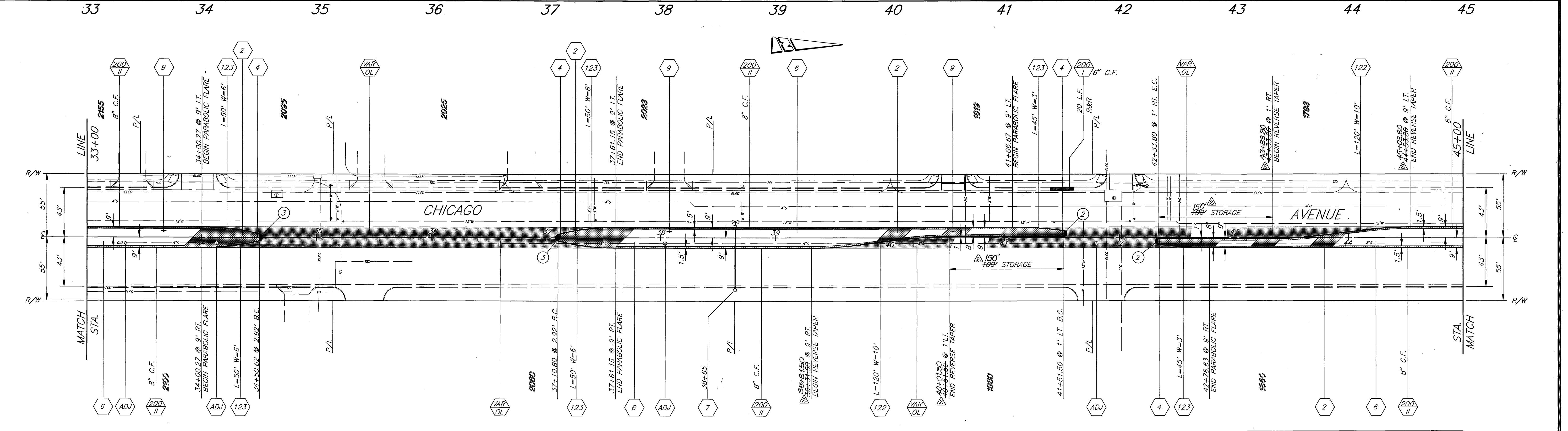
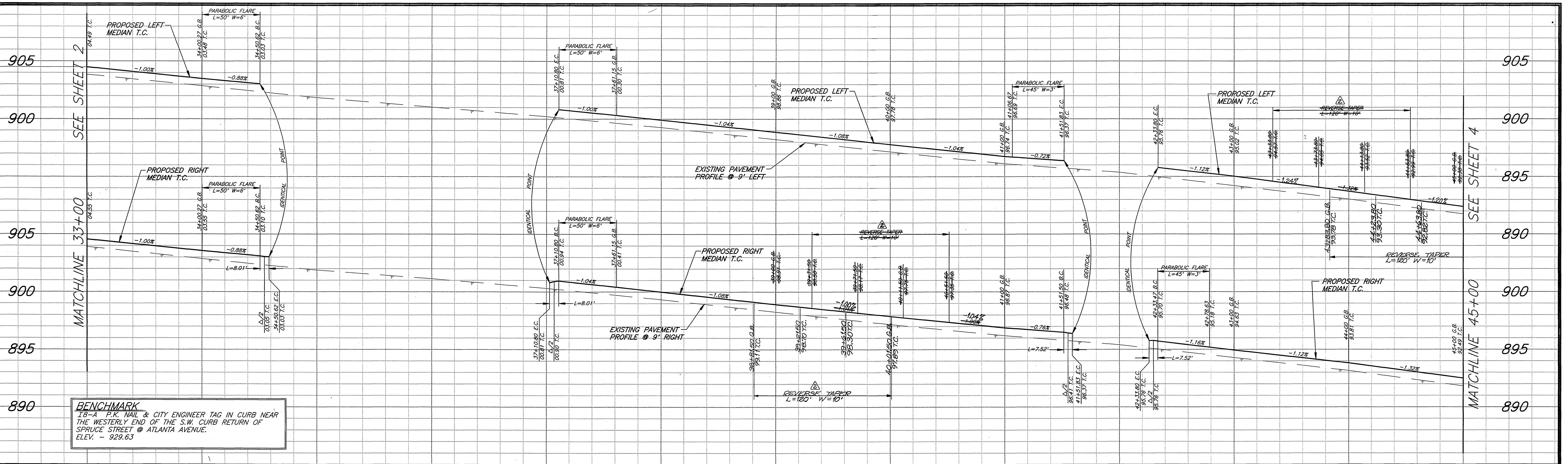

- CONSTRUCTION NOTES**
- 2 CONSTRUCT 4" THICK STAMPED CONCRETE. COLOR SHALL BE ADOBE TAN, C-21. USE 12" X 12" TILE PATTERN OR CITY APPROVED EQUAL.
 - 4 INSTALL R-7 TRAFFIC CONTROL SIGN PER STD. 666
 - 6 REMOVE EXIST. STRUCTURAL SECTION BETWEEN PROPOSED CURBS AND FILL WITH CLEAN EARTHEN MATERIAL.
 - 7 CONSTRUCT SUPER FIRE HYDRANT PER STD. CWD-700.
 - 9 INSTALL R-10 TRAFFIC CONTROL SIGN PER STD. 666

CONSTRUCTION LEGEND

CONSTRUCT VARIABLE THICKNESS D.G.A.C. OVERLAY TO PROVIDE 1% MINIMUM CROSS SLOPE AWAY FROM MEDIAN CURB.

CURVE DATA

	R	L	T
2	172' 24" 19"	2.50'	37.67'
3	153' 00" 30"	3.00'	8.01'

ENGINEER IN RESPONSIBLE CHARGE
Ronald C. Mueller
 RONALD C. MUELLER
 R.C.E. No. 29510 expires 3/31/99
 DATE 5-14-97



CITY OF RIVERSIDE, CALIFORNIA
 PUBLIC WORKS DEPARTMENT

APPROVED BY: *[Signature]*
 DEPUTY P.W. DIRECTOR
 PRINCIPAL ENGINEER
 CHIEF P.W. INSPECTOR
 STREET SERVICES
 SURVEYOR
 TRAFFIC DIVISION
 PARKS DEPARTMENT

DATE 5/16/97

CHICAGO AVENUE
 MEDIANS
 S.P.R.R. TO COLUMBIA AVENUE

R-3256
 SHEET 3 OF 6

HORIZ. SCALE: 1" = 40' VERT. SCALE: 1" = 4'

INDEXED 1-6-98 4H

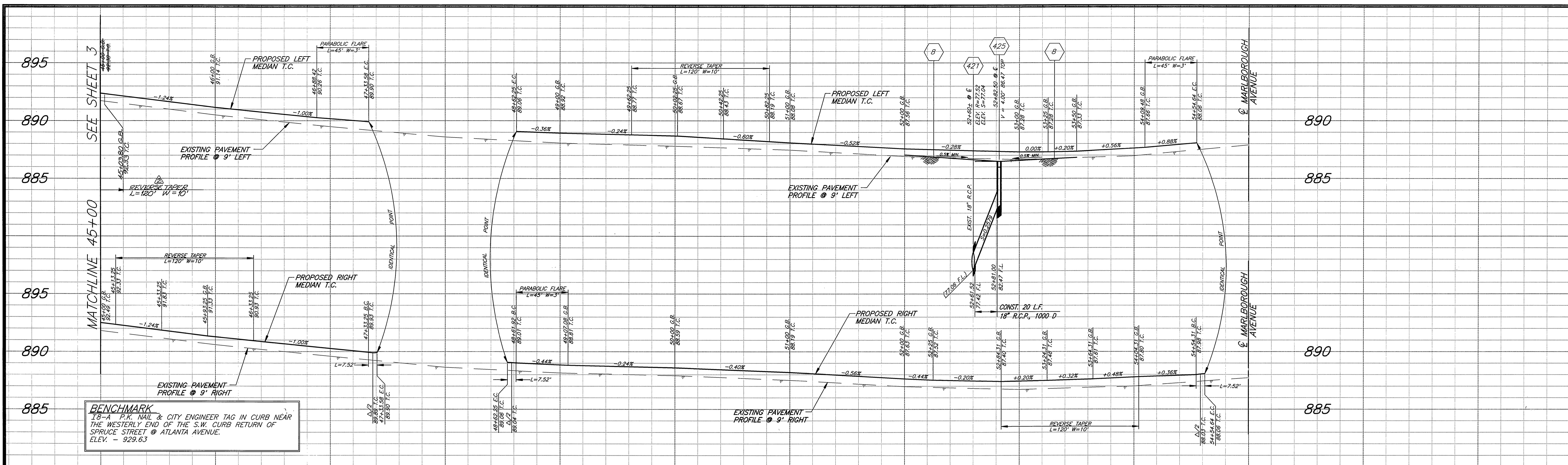

CURVE DATA

Station	R	L	T
45+00.00	172' 24" 19"	2.50'	37.67'

CONSTRUCTION LEGEND

CONSTRUCT VARIABLE THICKNESS D.G.A.C. OVERLAY TO PROVIDE 1% MINIMUM CROSS SLOPE AWAY FROM MEDIAN CURB.

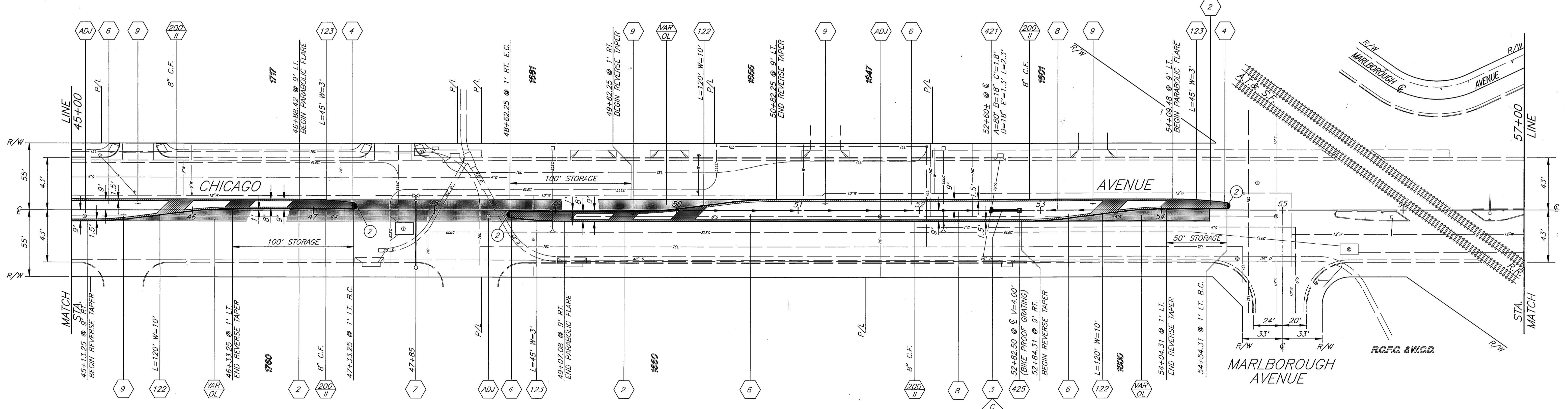

- CONSTRUCTION NOTES**
- 2 CONSTRUCT 4" THICK STAMPED CONCRETE. COLOR SHALL BE ADOBE TAN, C-21, USE 12" X 12" TILE PATTERN OR CITY APPROVED EQUAL.
 - 3 CONSTRUCT 20 L.F. 18" R.C.P., 1000 D. (SEE DETAIL "C" SHEET 5)
 - 4 INSTALL R-7 TRAFFIC CONTROL SIGN PER STD. 666
 - 6 REMOVE EXIST. STRUCTURAL SECTION BETWEEN PROPOSED CURBS AND FILL WITH CLEAN EARTHEN MATERIAL.
 - 7 CONSTRUCT SUPER FIRE HYDRANT PER STD. CWD-700.
 - 8 GRADE TO DRAIN. (0.5% MIN.)
 - 9 INSTALL R-10 TRAFFIC CONTROL SIGN PER STD. 666

ENGINEER IN RESPONSIBLE CHARGE
Ronald C. Mueller
 RONALD C. MUELLER
 R.C.E. No. 29510 expires 3/31/99
 DATE 6-14-97

CITY OF RIVERSIDE, CALIFORNIA
 PUBLIC WORKS DEPARTMENT

APPROVED BY: **R.G. FANN** (R.G. FANN)
 DEPUTY P.W. DIRECTOR
 DATE: 7/14/97

APPROVED BY: **CURT** (CURT)
 CHIEF P.W. INSPECTOR
 DATE: 7/14/97

DESIGNED BY: R.G. FANN, DRAWN BY: CURT, CHECKED BY: AEM

CITY OF RIVERSIDE, CALIFORNIA
 PUBLIC WORKS DEPARTMENT

APPROVED BY: **Bamford** (Bamford)
 SUPERVISOR
 DATE: 5/16/97

APPROVED BY: **Bamford** (Bamford)
 TRAFFIC DIVISION
 DATE: 5/16/97

**CHICAGO AVENUE
 MEDIANS
 S.P.R.R. TO COLUMBIA AVENUE**

AS BUILT 7/1/98 RIM
 ACC. NO. 430-541500-440222-30083
R-3256
 SHEET 4 OF 6
 FILE NO.

HORIZ. SCALE: 1" = 40'
 VERT. SCALE: 1" = 4'

CURVE DATA				
Circle	Triangle	R	L	T
4	135° 00' 00"	2.50'	5.89'	6.04'
5	45° 00' 00"	2.50'	1.96'	1.04'

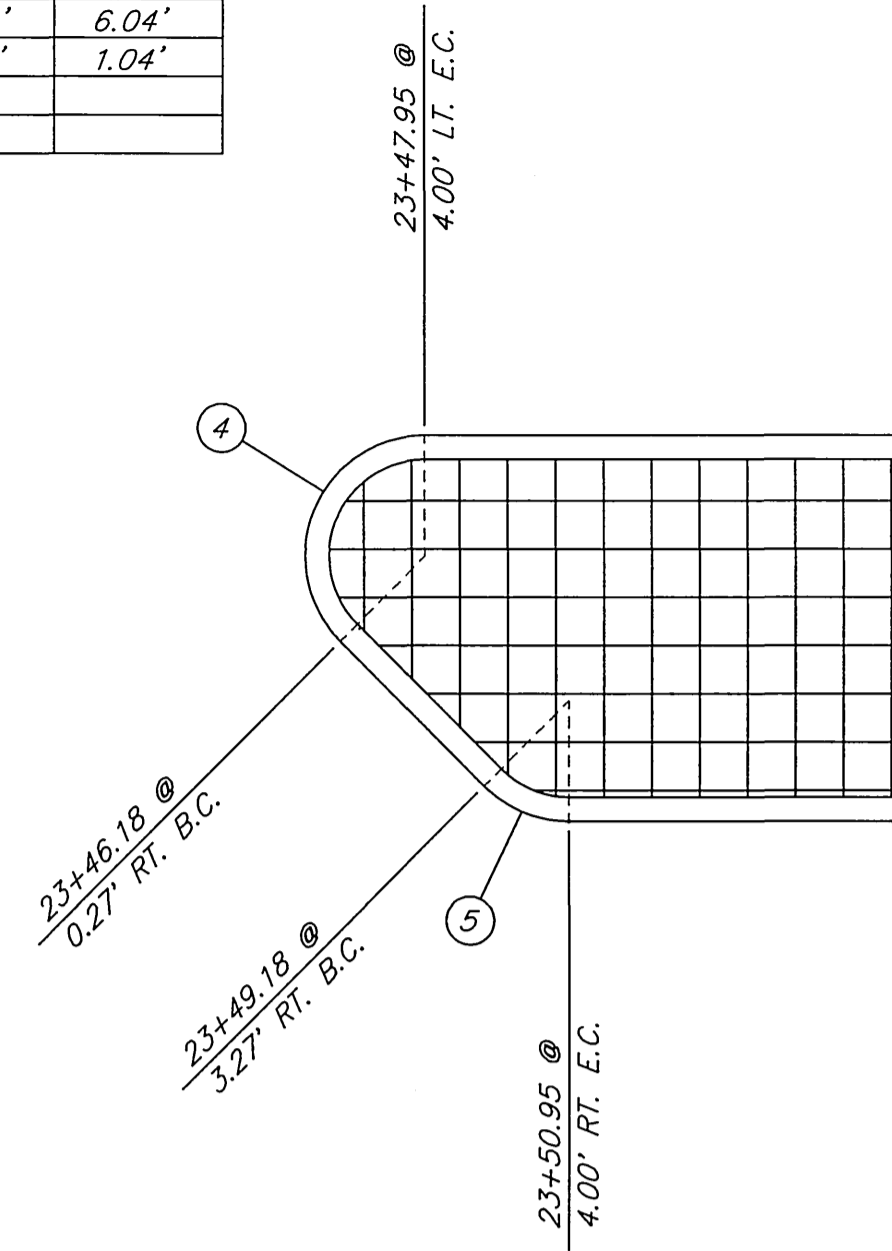

A
5 DRIVEWAY MEDIAN OPENING DETAIL (STA. 23+40±)
SCALE: 1"=4'

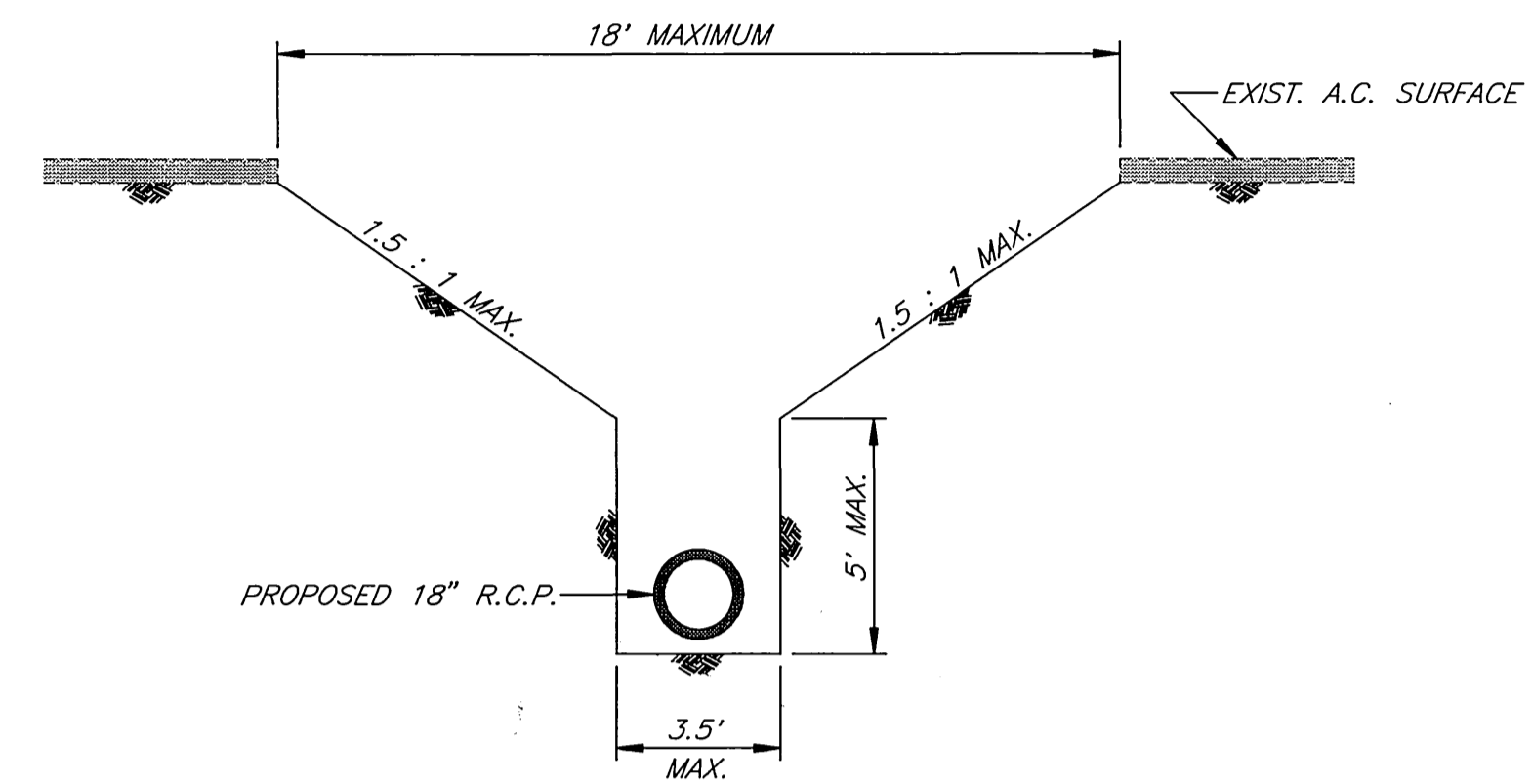

C
5 OPEN TRENCH DETAIL (STA. 52+70±)
SCALE: 1"=4'

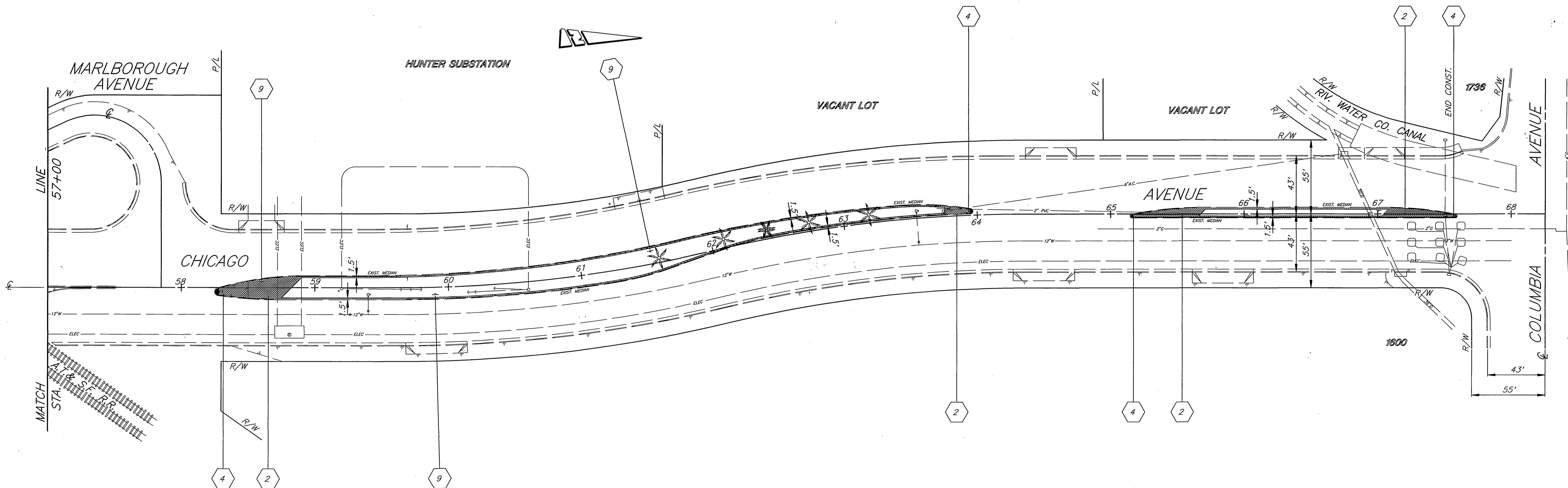

CONSTRUCTION NOTES

- 2 CONSTRUCT 4" THICK STAMPED CONCRETE. COLOR SHALL BE ADOBE TAN, C-21. USE 12" X 12" TILE PATTERN OR CITY APPROVED EQUAL.
- 4 INSTALL R-7 TRAFFIC CONTROL SIGN PER STD. 666
- 9 INSTALL R-10 TRAFFIC CONTROL SIGN PER STD. 666

ENGINEER IN RESPONSIBLE CHARGE
Ronald C. Mueller
RONALD C. MUELLER
R.C.E. No. 28510 expires 3/31/99
DATE 5-14-97

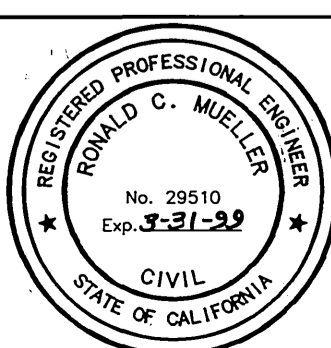

MARK	REVISIONS	APPR.	DATE

CITY OF RIVERSIDE, CALIFORNIA
PUBLIC WORKS DEPARTMENT

APPROVED BY	BY	DATE	APPROVED BY	DATE
DEPUTY P.W. DIRECTOR	R.T.C.	5/12/97	<i>[Signature]</i>	5/16/97
PRINCIPAL ENGINEER	R	5/15/97	PUBLIC WORKS DIRECTOR	
CHEF P.W. INSPECTOR	R	5/15/97		
STREET SERVICES	R	5/15/97		
SURVEYOR	R	5/15/97		
TRAFFIC DIVISION	R	5/15/97		
PARKS DEPARTMENT	R	5/15/97		

CHICAGO AVENUE
MEDIANS
S.P.R.R. TO COLUMBIA AVENUE

HORIZ. SCALE: 1" = 40'
VERT. SCALE: 1" = 4'

AS BUILT 7/1/98 RUM
ACCT. NO. 430-541500-440222-30083
R-3256
SHEET 5 OF 6
FILE NO.

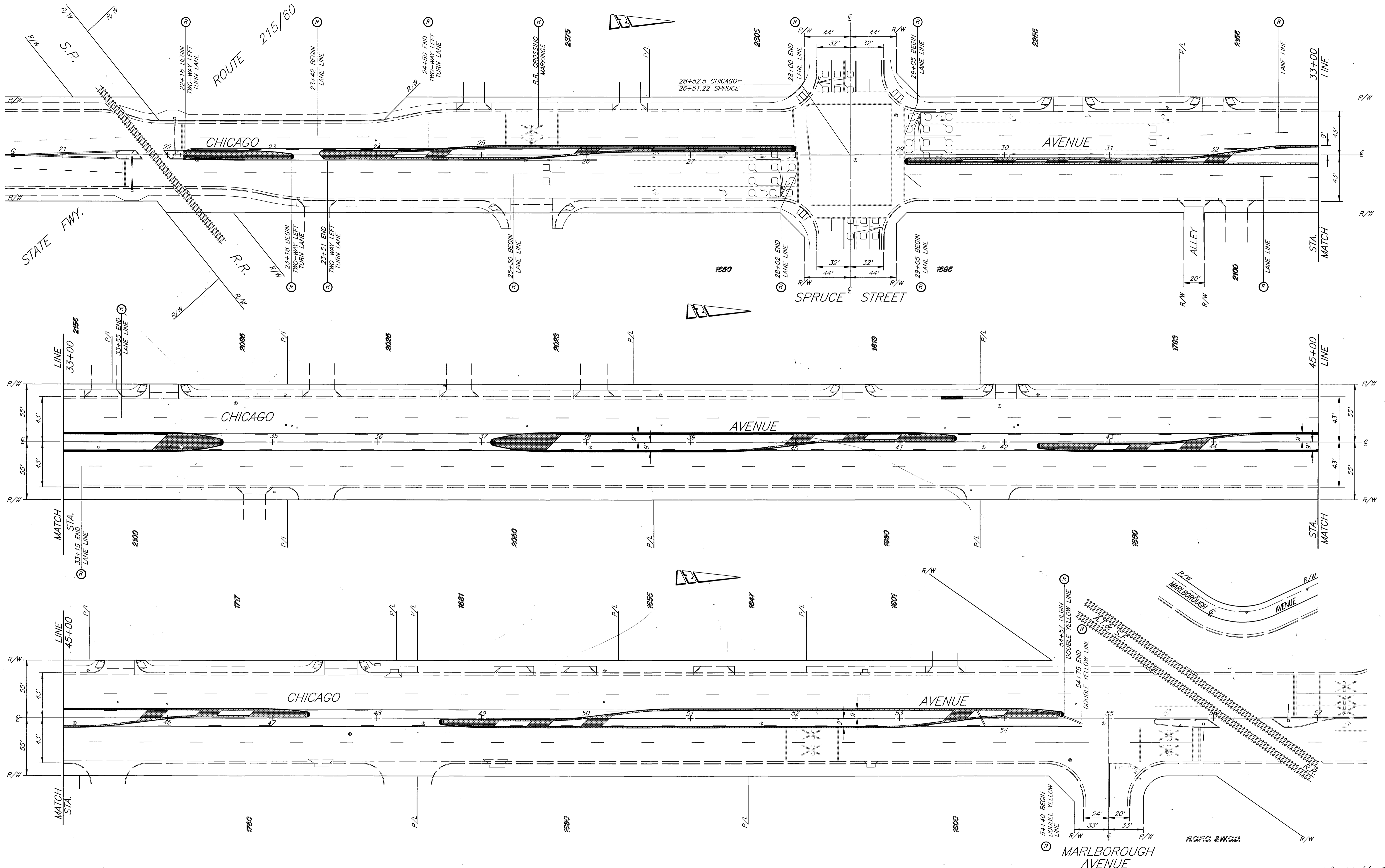

STRIPING & MARKING LEGEND
 (R) REMOVE EXISTING STRIPING OR MARKINGS.

ENGINEER IN RESPONSIBLE CHARGE
 Ronald C. Mueller
 R.C.E. No. 29510 expires 3/31/99
 DATE 5-14-97

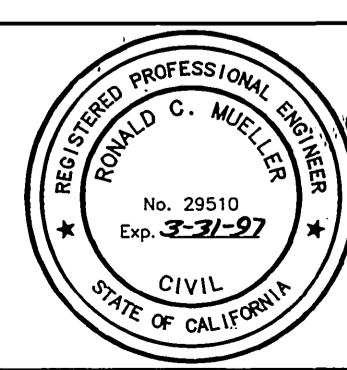

MARK	REVISIONS	APPR.	DATE

CITY OF RIVERSIDE, CALIFORNIA
PUBLIC WORKS DEPARTMENT

APPROVED BY: [Signature] DATE: 5/16/97
 DEPUTY P.W. DIRECTOR
 PRINCIPAL ENGINEER: [Signature] DATE: 5/15/97
 CHIEF P.W. INSPECTOR: [Signature] DATE: 5/15/97
 SURVEYOR: [Signature] DATE: 5/15/97
 TRAFFIC DIVISION: [Signature] DATE: 5-11-97
 PARKS DEPARTMENT: [Signature] DATE: 5-11-97

STRIPING AND MARKING REMOVAL PLAN
CHICAGO AVENUE
MEDIANS
S.P.R.R. TO COLUMBIA AVENUE

AS BUILT 7/2/98 RIM
 ACCT. NO. 430-541500-44022-30083
R-3256
 SHEET 6 OF 6
 FILE NO.

INDEXED 1-6-98 4H