

- It shall be the responsibility of the contractor to clear the right of way in accordance with the provisions of law as it affects each utility including irrigation lines and appurtenances and at no cost to the City.
- Construction shall be in accordance with the City of Riverside Department of Public Works, Standard Drawings, Standard Drawing No. 10 and the Standard Specifications for Public Works Construction.
- The private engineer signing these plans is responsible for assuring the accuracy and acceptability of the work hereon. In the event of discrepancies arising during construction, the private engineer shall be responsible for determining an acceptable solution and revising the plans for approval by the City.
- Quantities shown are for information only and the City of Riverside is not responsible for their accuracy.
- The developer shall be responsible for preserving or re-establishing and referencing survey monuments destroyed, disturbed or buried as a result of construction shown hereon.
- All flagged elevations shall be staked in the field by a private engineer.
- Trim edge of existing pavement where new pavement joins to a smooth straight line. Construct match-up paving as shown on plan and overlay paving as directed in the field to produce a smooth section.
- Construct driveway approaches per Standard Drawing No. 302. As indicated on these plans.
- Any traffic control striping obliterated and/or badly worn during construction shall be restored by the contractor within five days after notification from the City Inspector.
- The contractor shall call in a location request to Underground Service Alert (USA), Phone # (909) 422-4133, two working days before digging. No construction permit will be issued by the Public Works Department involving excavation for underground facilities unless the applicant has been provided an inquiry identification number by USA.
- In pavement overlay areas, Distressed existing pavement shall be removed and replaced as directed by the Inspector prior to overlaying with A.C. paving.
- All traffic signs shall be installed prior to opening the streets to traffic.
- Final striping for traffic control and/or pavement marking to be the responsibility of the developer.

**STREET TREE PLANTING AND RELOCATION GENERAL NOTES**

- All related work shall conform to the City of Riverside Park and Recreation Department Standards and City of Riverside Street Tree policies.
- When calling for inspections contact the Street Tree Inspector a minimum of 48 hours in advance at (714) 351-6126 to schedule an inspection. A field Notice will be issued as written approval for each stage of inspection. A verbal approval will not be acceptable. Inspections are required:
  - After completion of final grading of the lots and when all utility services and sewer lateral have been marked, but prior to digging plant pits, all final street tree locations are to be spotted in the field by the street tree inspector;
  - While digging plant pits and planting/relocating trees;
  - After planting and all other indicated or specified work has been completed, for start of maintenance;
  - At end of the maintenance period, the contractor/developer shall call the Street Tree Inspector at (714) 351-6126 for final acceptance inspection in order to be released from maintenance. Developers bonds will not be released until after receipt of written notification from the City that the trees pass final inspection and the Park and Recreation department is assuming maintenance responsibilities;
- ALL STREET TREES ARE TO BE PLANTED PRIOR TO OCCUPANCY.
- The Developer shall be responsible to acceptably maintain all plantings for a minimum period of one (1) year.
- Street tree planting shall be as follows:
 

STREET NAME	BOTANICAL NAME / COMMON NAME	MIN. SIZE	APPROXIMATE QUANTITY
7047 MARGUERITA	PELLEUS CERASIFERA / RED KNUZZER VESUVIUS / LEFF PLUM	15 GALLON	45'
7047 MARGUERITA	CYPRESS	REMOVE	1

- Both a street tree Relocation/Removal permit as issued by the Park and Recreation Department and a Street Opening permit as issued by the Public Works Department are required prior to commencement of tree relocation and/or removal work. For all existing trees within what will ultimately be the Public Right-of-Way pavement area, backfill of all holes must be inspected by the Public Works Inspector for proper compaction.
  - All Street Trees must be automatically irrigated, except where adjacent to single family or duplex residential uses.
- \*NOTE: In the interest of public safety and maintenance the Street Tree Inspector shall have the authority to revise the street tree quantities and locations shown on approved plans based upon field conditions found at the time of installation of the trees

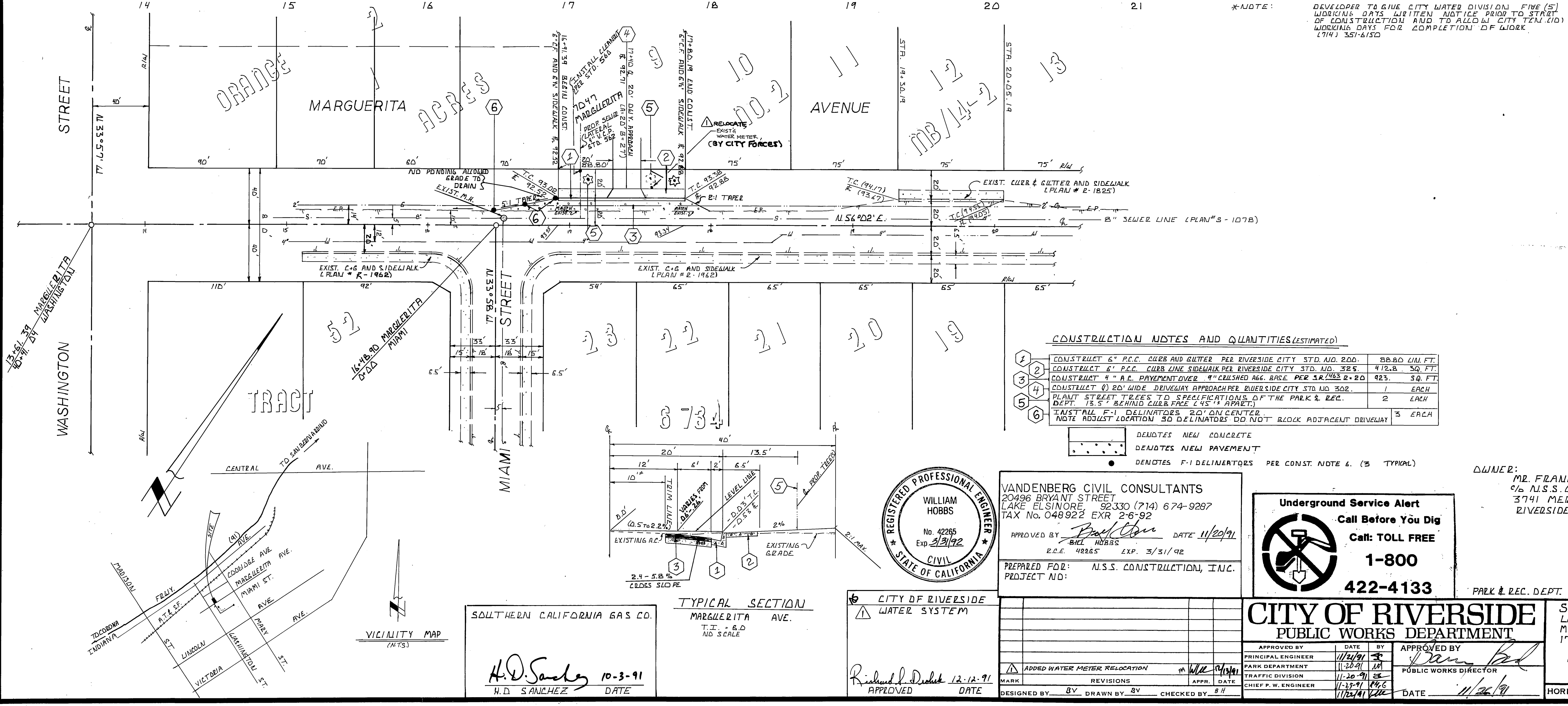
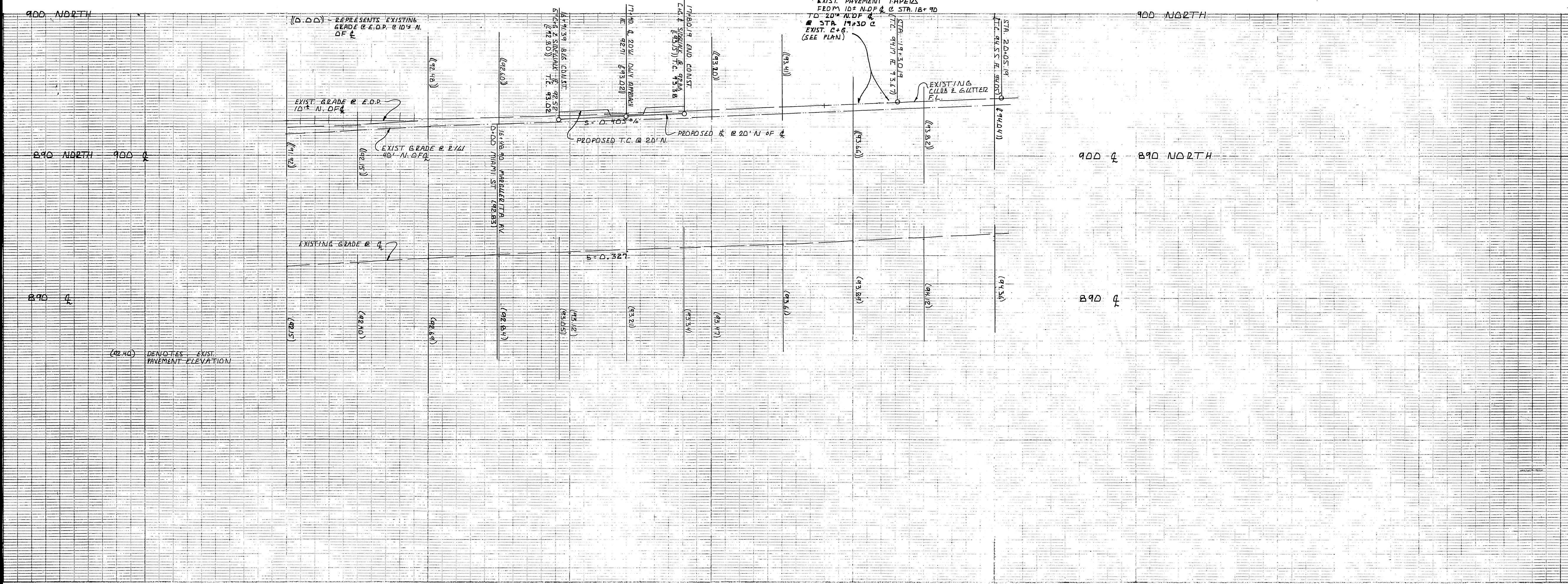

**REGISTERED PROFESSIONAL ENGINEER**  
 WILLIAM HOBBS  
 No. 42285  
 Exp. 3/31/92  
 CIVIL  
 STATE OF CALIFORNIA

**VANDENBERG CIVIL CONSULTANTS**  
 20496 BRYANT STREET  
 LAKE ELSINORE, CA 92530 (714) 674-9287  
 TAX No. 048922 EXR 2-6-92

APPROVED BY: *Paul C...* DATE 11/20/91  
 R.C.E. 42285 EXP. 3/31/92

PREPARED FOR: N.S.S. CONSTRUCTION, INC.  
 PROJECT NO:

**Underground Service Alert**  
 Call Before You Dig  
 Call: TOLL FREE  
**1-800-422-4133**

OWNER: MR. FRANK SALAME  
 c/o N.S.S. CONSTRUCTION, INC.  
 3741 MERCED DR. STE. E-2  
 RIVERSIDE CAL. 92503  
 (714) 353-9911

BENCH MARK  
 PK. 101 & TR. 101 WESTERLY CURB  
 BETWEEN WASHINGTON & LINCOLN  
 ELEV. 912.466 CITY B.M. 66-J

**CITY OF RIVERSIDE**  
 WATER SYSTEM

APPROVED: *Richard L. Deibel* 12-12-91  
 DATE

APPROVED BY	DATE	BY	APPROVED BY	DATE
PRINCIPAL ENGINEER	11/20/91	W.H.	PUBLIC WORKS DIRECTOR	11/26/91
PARK DEPARTMENT	11/20/91	W.H.		
TRAFFIC DIVISION	11/20/91	W.H.		
CHIEF P.W. ENGINEER	11/20/91	W.H.		

DESIGNED BY: BY, DRAWN BY: BY, CHECKED BY: B.H.

**CITY OF RIVERSIDE**  
 PUBLIC WORKS DEPARTMENT

**STREET IMPROVEMENT PLAN**  
 LOT 9, ORANGE ACRES No. 2, MB/14-2  
 MARGUERITA AVENUE STA. 16+91.39 TO  
 17+80.19 CITY OF RIVERSIDE, CALIF.

ACCOUNT NO. **R-3257**  
 SHEET **1** OF **1**

HORIZ. SCALE: 1" = 40' VERT. SCALE: 1" = 4'