

B.M. 838.11 - X ON BOLT ON TOP F.H. S.  
 W. COR. ORANGE ST & STRONG ST.  
 F.B. 666 / 20732  
 SCALE: HOR. 1"=50'  
 VERT. 1"=5'

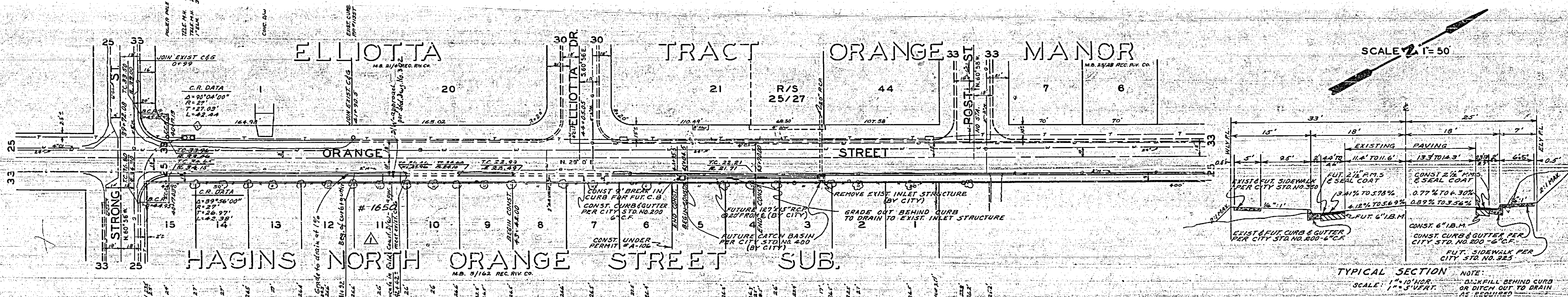

SCALE 1"=50'

NOTE: 1. It shall be the responsibility of the Contractor to clear the right of way in accordance with the provisions of the law as it affects each utility including irrigation lines and appurtenances and of no cost to the City.  
 2. Trim edge of paving to clean straight line. Constructed match-up paving as shown and verify exact paving as shown in the field to produce a smooth even surface.

4-3-64 Added improvements for house # 1650 (5th 42nd St) [Signature]

TYPICAL SECTION NOTE: 1. 1"=10' HOR. 2. 1"=5' VERT. 3. FILL BEHIND CURB OR DITCH OUT TO DRAIN AS REQUIRED.

ALIFORNIA IC WORKS

ORANGE STREET CURB & GUTTER BET. STRONG ST. & POST ST.

L.L.P. [Signature] R-327  
 Nov. 16, 1959

