

STREET TREE NOTES

- All related work shall conform to the City of Riverside Park and Recreation Department standards and the City of Riverside Street Tree Policies.
- When calling for inspections, contact the Street Tree Inspector a minimum of 48 hours in advance, at (714) 351-6126. A Field Notice will be issued as written approval for each stage of inspection. A verbal approval will not be acceptable. Inspections are required:
 - After completion of final grading of the lots and when all utility services and sewer laterals have been marked, but prior to digging plant pits. All final street tree locations are to be spotted in the field by the street tree inspector.
 - White digging plant pits and planting/relocating trees.
 - After planting and all other indicated or specified work has been completed for start of maintenance.
 - At the end of the maintenance period, the contractor/developer shall call the Street Tree Inspector at (714) 351-6126 for a final acceptance inspection, in order to be released from maintenance. Developer's bonds will not be released until after receipt of written notification from the City that the trees pass final inspection and the Park and Recreation Department is assuming maintenance responsibilities.
- All street trees are to be planted prior to occupancy.
- The developer shall be responsible to acceptably maintain all plantings for a minimum of one (1) year.
- Street tree plantings shall be as follows:

Street Name	Botanical/Common Name	Minimum Size	Approx. Spacing	No. Req.
Eleventh Street	Schinus molle/ California Pepper	Existing (on-site, protect in place)	Adjacent	
Howard Avenue	Washingtonia filifera/ California Fan Palm	4" Bm trunk	45'	2
Tenth Street	Magnolia Grand De Flora 'Magestic Beauty'/Southern Magnolia	15' Gal	45'	2

LEGEND

- Existing concrete sidewalk, curb & gutter (TO REMAIN IN PLACE)
- Remove existing concrete sidewalk
- Remove and replace curb, gutter & sidewalk
- Remove and replace A.C.
- Proposed concrete sidewalk
- Trim Line
- Existing utilities (size & type noted)

QUANTITY ESTIMATE

REMOVAL	
Tenth St.	
CONCRETE CURB & GUTTER	132 L.F.
CONCRETE SIDEWALK	1960 S.F.
A.C. PAVING	262 S.F.
Eleventh St.	
CONCRETE CURB & GUTTER	78 L.F.
A.C. PAVING	156 S.F.
REPLACEMENT	
Tenth St.	
CONCRETE CURB & GUTTER	132 L.F.
CONCRETE SIDEWALK	655 S.F.
A.C. PAVING	262 S.F.
DRIVEWAY APPROACH	1 EA.
Eleventh St.	
CONCRETE SIDEWALK	1800 S.F.
DRIVEWAY APPROACHES	2 EA.
NEW HANDICAP RAMP	1 EA.
A.C. PAVING	156 S.F.
SEWER IMPROVEMENTS	
Tenth St.	
4" SEWER LATERAL	30 L.F.
6" SEWER LATERAL	30 L.F.
SEWER CLEANOUT	2 EA.

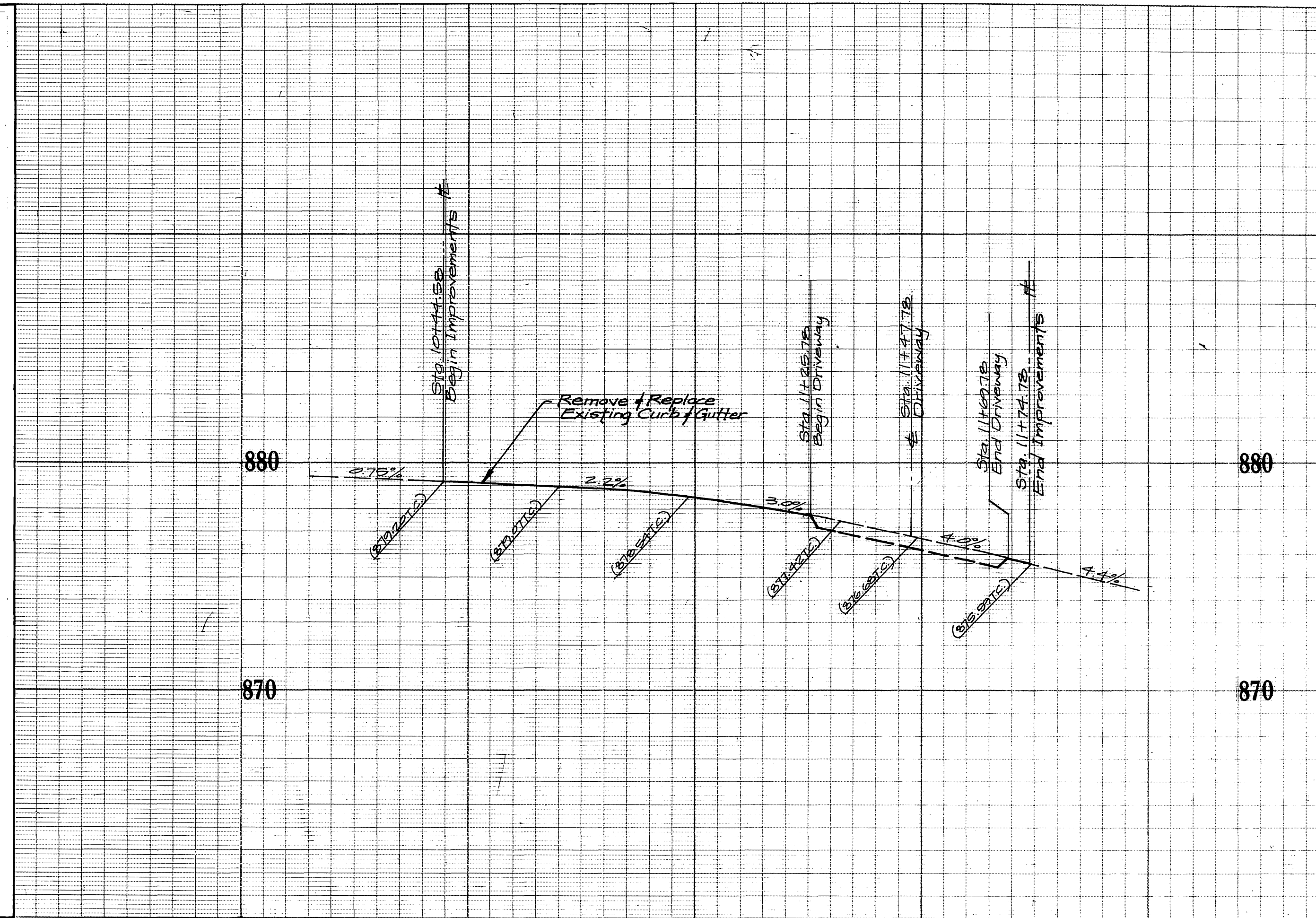

GENERAL NOTES

- It shall be the responsibility of the CONTRACTOR to clear the right-of-way, in accordance with the provisions of law as it affects each utility including irrigation lines and appurtenances and at no cost to the CITY.
- Construction shall be in accordance with the CITY OF RIVERSIDE Department of Public Works, Standard Drawings, Standard Drawing No. 10 and the Standard Specifications for Public Works construction, current edition.
- Trim edge of existing pavement where new pavement joins, to a smooth straight line. Construct match-up paving as shown on plan and overlay paving as directed in field to produce a smooth section.
- Quantities shown are for information only and the CITY OF RIVERSIDE is not responsible for their accuracy.
- The ENGINEER signing these plans is responsible for assuring the accuracy and acceptability of the work hereon. In the event of discrepancies arising during construction as a result of errors or omissions, the PRIVATE ENGINEER shall be responsible for determining an acceptable solution and revising the plans for approval by the CITY.
- The CONTRACTOR shall call in a location request to Underground Service Alert (USA), Phone No. 1-800-422-4133, two working days before digging. No construction permit will be issued by the Public Works Department involving excavation for underground facilities unless the applicant has been provided an inquiry identification number by USA.
- All flagged elevations shall be staked in the field by the PRIVATE ENGINEER.
- The developer shall be responsible for preserving or re-establishing and referencing survey monuments destroyed, disturbed or buried as a result of construction shown hereon.
- The existence and location of underground utilities were obtained from public records. It shall be the responsibility of the CONTRACTOR to locate, maintain, and protect all utilities during construction. Any utilities damaged during the performance of the work shall be repaired or replaced to the satisfaction of the CITY OF RIVERSIDE at the CONTRACTOR'S expense.
- All stationing is based on street centerline.
- Construct driveway approaches per Standard Drawing 302. Exact size and location to be staked by the Private Engineer prior to construction of the curb and gutter.
- Any traffic control striping obliterated and/or badly worn during construction shall be restored by the contractor within five days after notification from the City Inspectors.

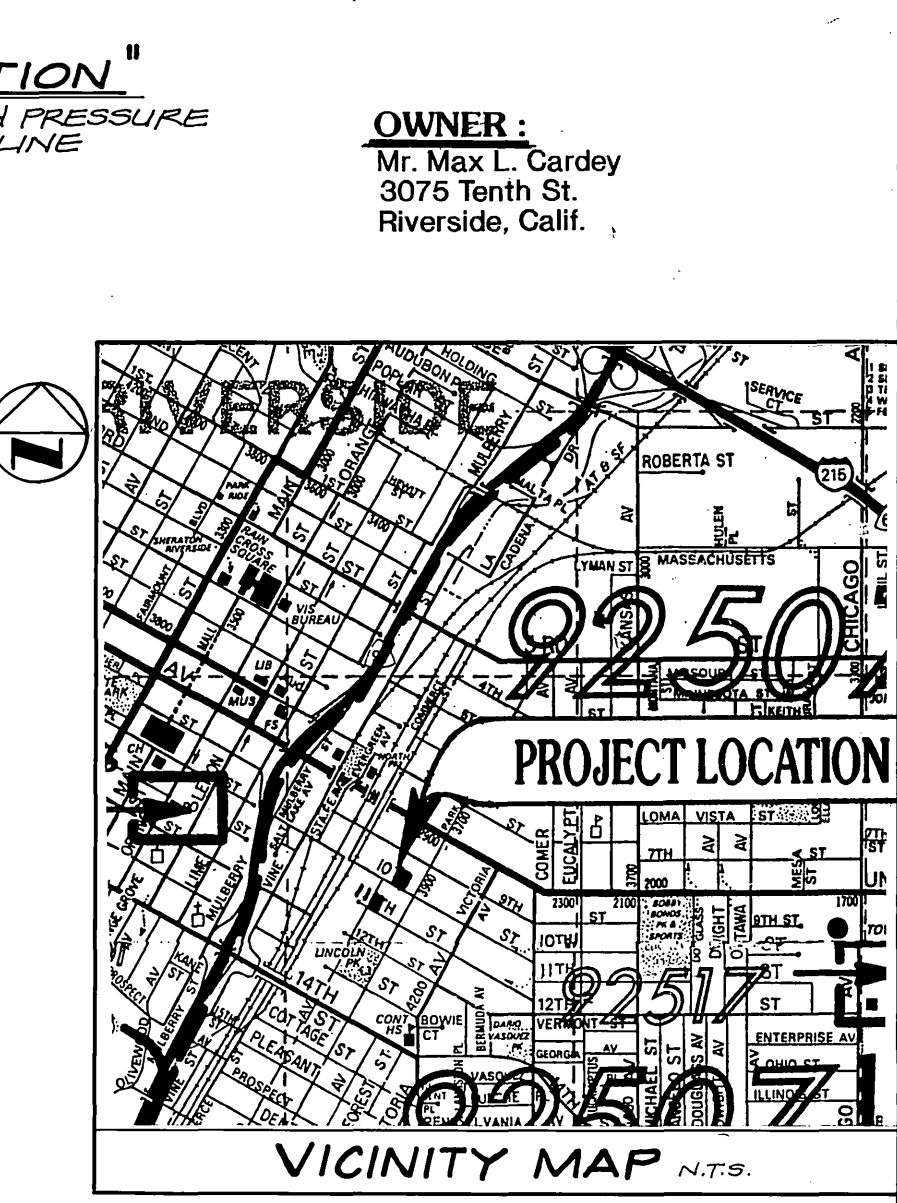
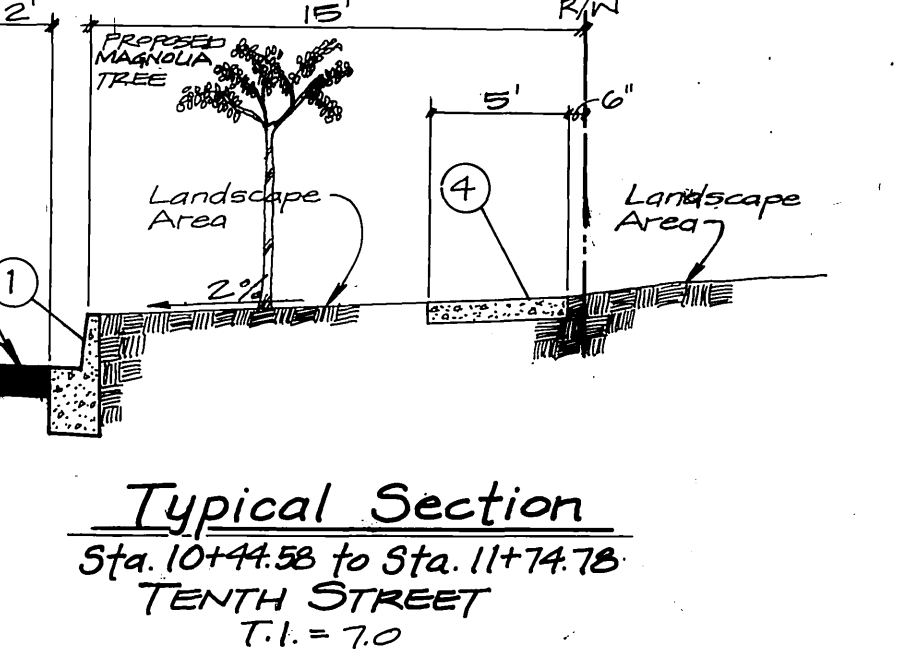
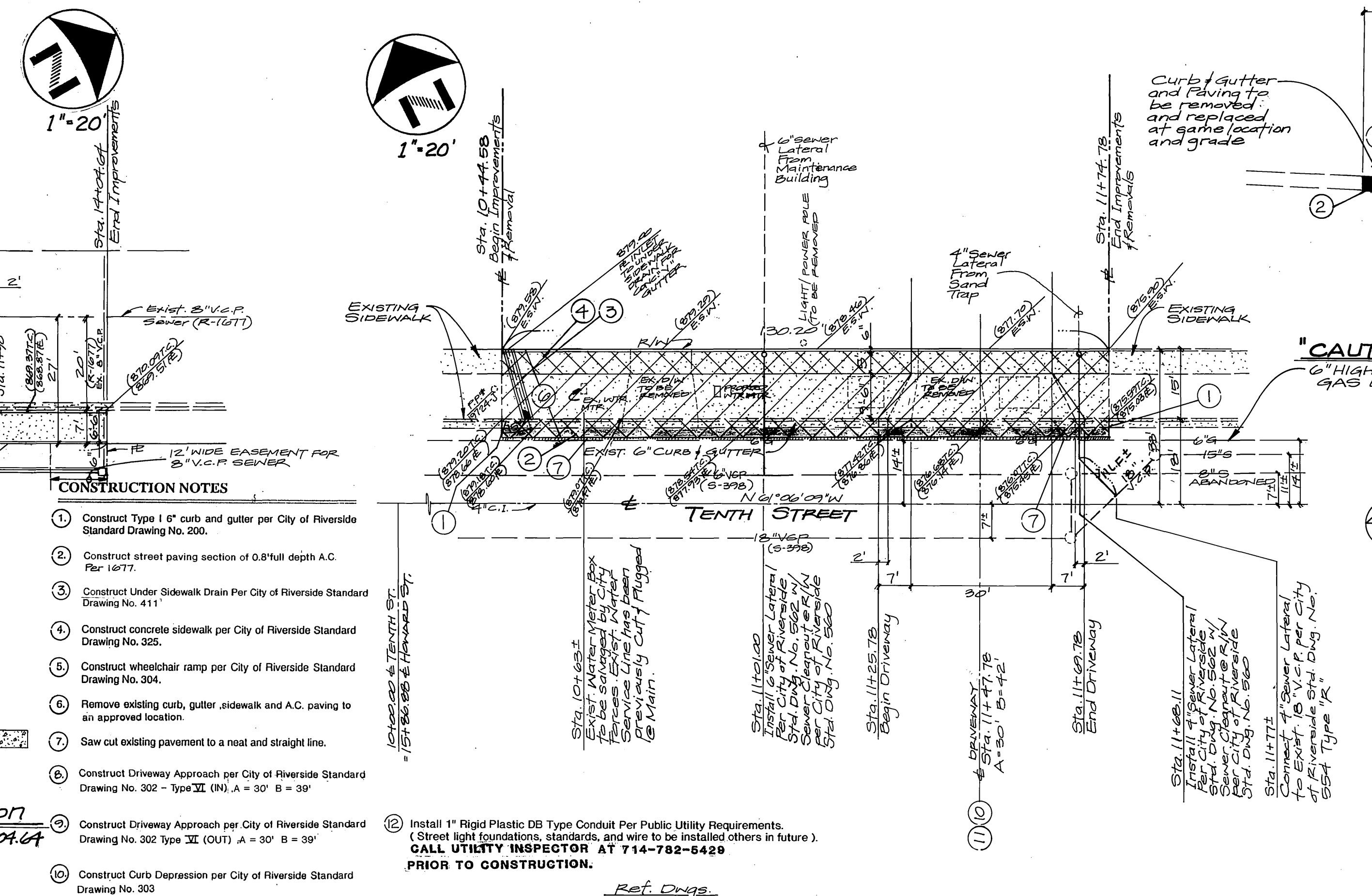
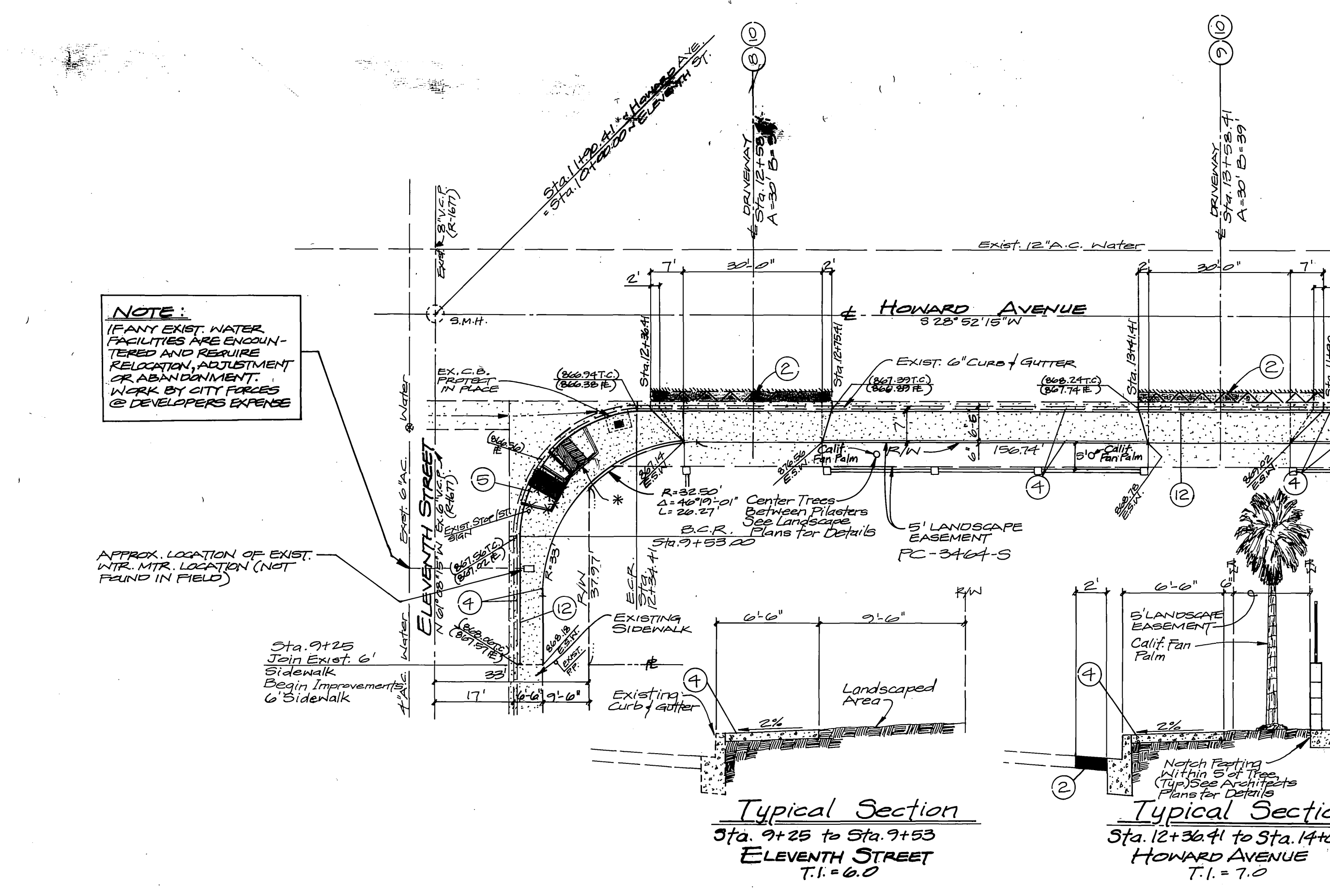

Benchmark: 17 J
P.K. nail and City Engineer tag in center of Northerly headwall of the R.W.C. Canal, 110' N.W. of the Intersection of Commerce St. and Tenth St., 14' S.E. of the Easterly rail at S.F.R.R.
Elevation 876.441

Southern California Gas Co. APPROVED BY: <i>H.D. Savelly</i> DATE: 4-22-92	City of Riverside, Public Utilities, WATER APPROVED BY: <i>Richard J. Dredel</i> DATE: 4-1-92
--	---

City of Riverside, Public Utilities, ELECTRIC
APPROVED BY: *Mital J. Toulhi* 4/1/92

KRIEGER & STEWART INCORPORATED
ENGINEERING CONSULTANTS
3802 University Av. • Riverside, CA 92501 • 714-684-6900
APPROVED BY: *Mark J. Kraus* DATE 3/2/92
RCE 47600

CITY BUSINESS TAX REGISTRATION
ACCT. NO. 027899 Exp. 12/31/92

CITY OF RIVERSIDE
PUBLIC WORKS DEPARTMENT

APPROVED BY: *David Paul*
DATE: 5/1/92

PRINCIPAL ENGINEER
DATE: 5/1/92
TRAFFIC DIVISION
DATE: 5/1/92
CHIEF P.W. ENGINEER
DATE: 5/1/92

DESIGNED BY: *LUM* DRAWN BY: *LUM* CHECKED BY: *MARCA*

CITY CASE No. DR-26-912 / DR-37-889 AS BUILT 2/25/93 RUM

2995 Eleventh St. / 2989 Tenth St.
STREET IMPROVEMENT PLANS

ACCOUNT NO. **R-3280**
SHEET **11** OF **11**
741-1

HORIZ. SCALE: 1" = 20' VERT. SCALE: 1" = 4'

INDEXED 2/24/96 LHM