

- ### SPECIFIC CONSTRUCTION NOTES
- NUMBERS ABOVE 100 IN A HEXAGON ON THE PLAN REFER TO THE RESPECTIVE STANDARD DRAWING AND SHALL BE CONSTRUCTED ACCORDINGLY UNLESS MODIFICATIONS ARE NOTED ON THE PLAN OR COVER SHEET. ANY NUMBER SHOWN BELOW THE STANDARD DRAWING NUMBER INDICATES THE SPECIFIC ALTERNATE TO BE CONSTRUCTED.
 - DRIVEWAY APPROACH TO BE BUILT PER STANDARD EXCEPT THAT THE BACK SHALL BE DEPRESSED 0.20' TO FACILITATE MATCH-UPS.
 - WATER SERVICES TO BE RELOCATED BY THE P.U. WATER DIVISION PRIOR TO CONSTRUCTION.
 - POWER POLE TO BE RELOCATED BY THE P.U. ELECTRIC DIVISION PRIOR TO CONSTRUCTION.
 - REMOVE EXISTING TREE: CLASS I-6" TO 18", CLASS II-18" TO 36", CLASS III-OVER 36".
 - TRANSPLANT EXISTING PALM TREE OFF SITE, AS DIRECTED BY STREET TREE INSPECTOR AND AS DESCRIBED IN PARK & RECREATION SECTION OF THE ACCOMPANYING SPECIAL PROVISIONS. LOCATION TO BE DETERMINED BY THE STREET TREE INSPECTOR.
 - PLANT STREET TREE (CREPE MYRTLE, 24" BOX, 4 PLACES) AS DIRECTED BY STREET TREE INSPECTOR AND AS DESCRIBED IN PARK & RECREATION SECTION OF THE ACCOMPANYING SPECIAL PROVISIONS AND AS DESCRIBED HEREON.
 - STATE OF CALIFORNIA, DEPT. OF TRANSPORTATION, STANDARD PLANS, DATED JAN. 1988.
- ### GENERAL CONSTRUCTION NOTES
- EXISTING UTILITIES SHOWN ON THIS PLAN ARE PLOTTED FROM UTILITY RECORDS. THE CONTRACTOR IS REQUIRED TO TAKE DUE PRECAUTIONARY MEASURES TO LOCATE AND PROTECT ALL UTILITIES WHETHER OR NOT SHOWN ON THIS PLAN. IF THE COVER OF A UTILITY IS KNOWN, IT IS SHOWN IN THE PROFILE. UTILITIES SHOWN IN THE PROFILE AS INDICATES THAT THE COVER IS UNKNOWN, BUT THE UTILITY IS NOT EXPECTED TO CONFLICT WITH THE PROPOSED IMPROVEMENTS.
 - ALL ELEVATIONS SHOWN ON THE PLANS SHALL BE STAKED IN THE FIELD.
 - PRIME CONTRACTORS BIDDING THIS WORK SHALL HAVE A CLASS A OR C-10 LICENSE.
 - CONFLICTING UTILITIES SHOWN WITHIN CONSTRUCTION AREA WILL BE RELOCATED PRIOR TO CONSTRUCTION.
 - RIGHTS OF ENTRY HAVE BEEN OBTAINED FOR WORK SHOWN OUTSIDE OF CITY RIGHT OF WAY.
- ### CONSTRUCTION LEGEND
- CONSTRUCT STRUCTURAL SECTION OF:
 - ALT. 0.21' D.G.A.C. OVER 0.95" P.A.B.
 - ALT. 0.67' FULL DEPTH A.C.
 - REMOVE AND REPLACE EXIST. A.C. PAVEMENT WITH 0.50" D.G.A.C.
 - CONSTRUCT A VARIABLE THICKNESS DGAC OVERLAY (0.03' TO 0.20')

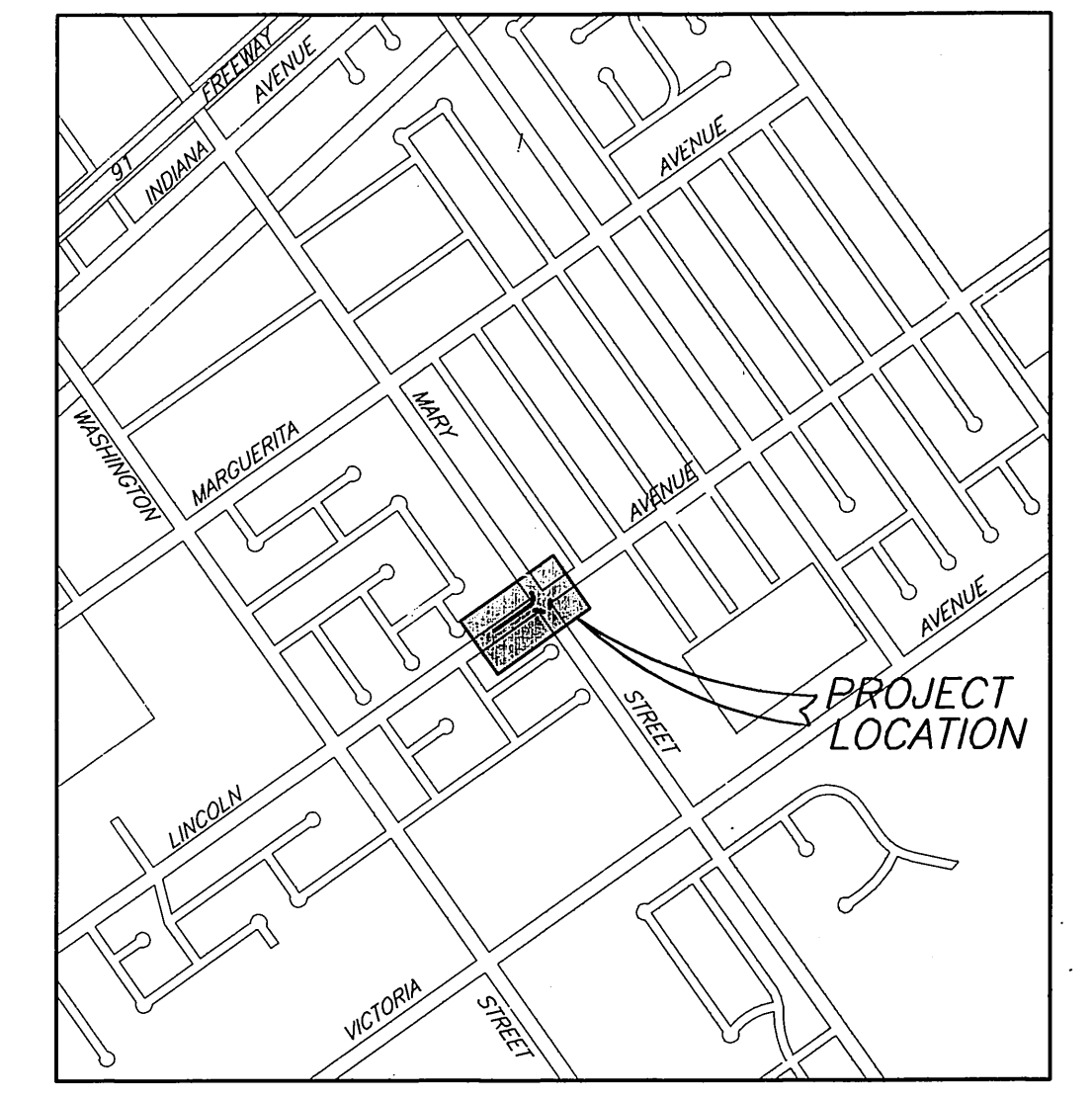
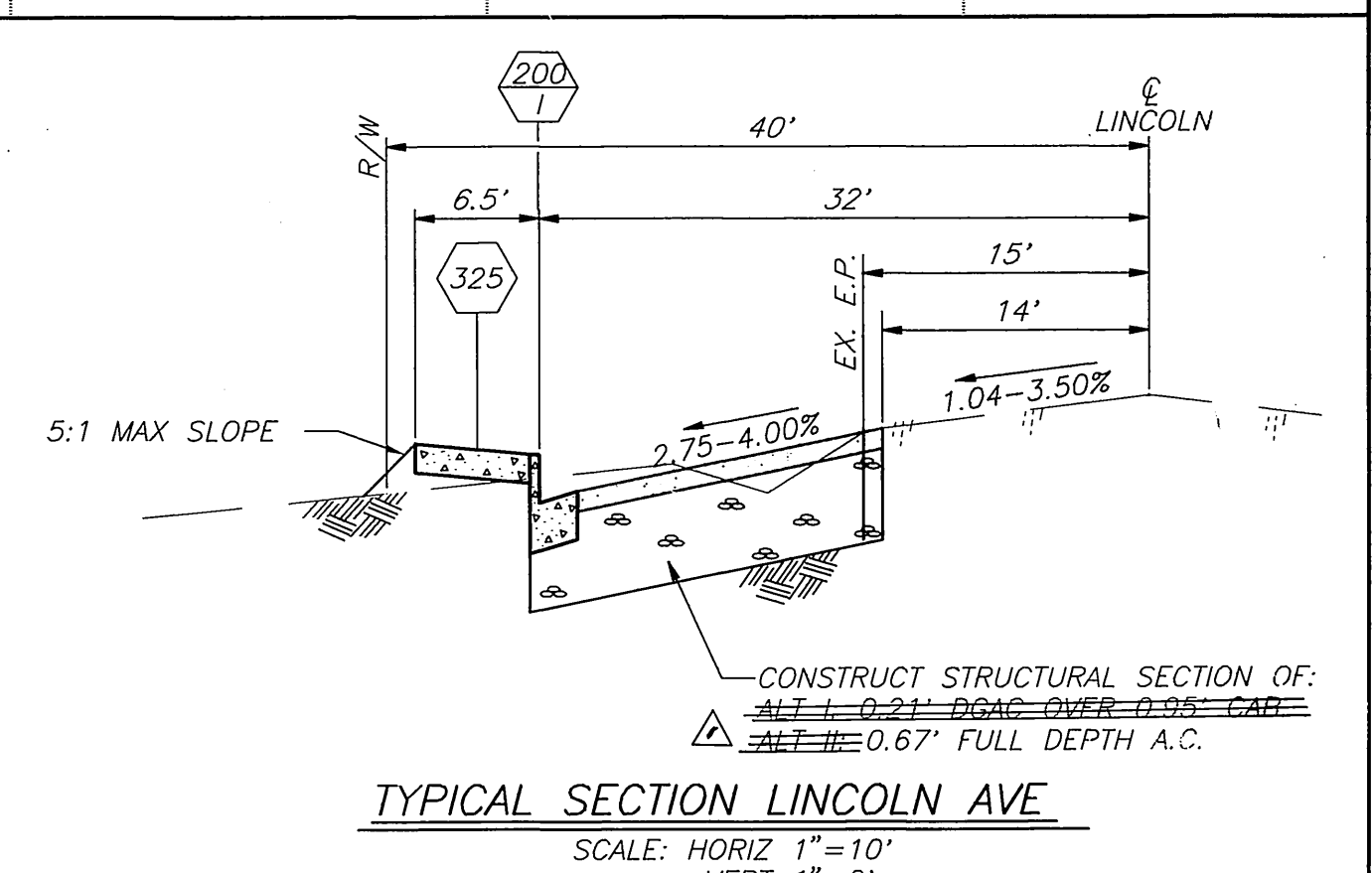
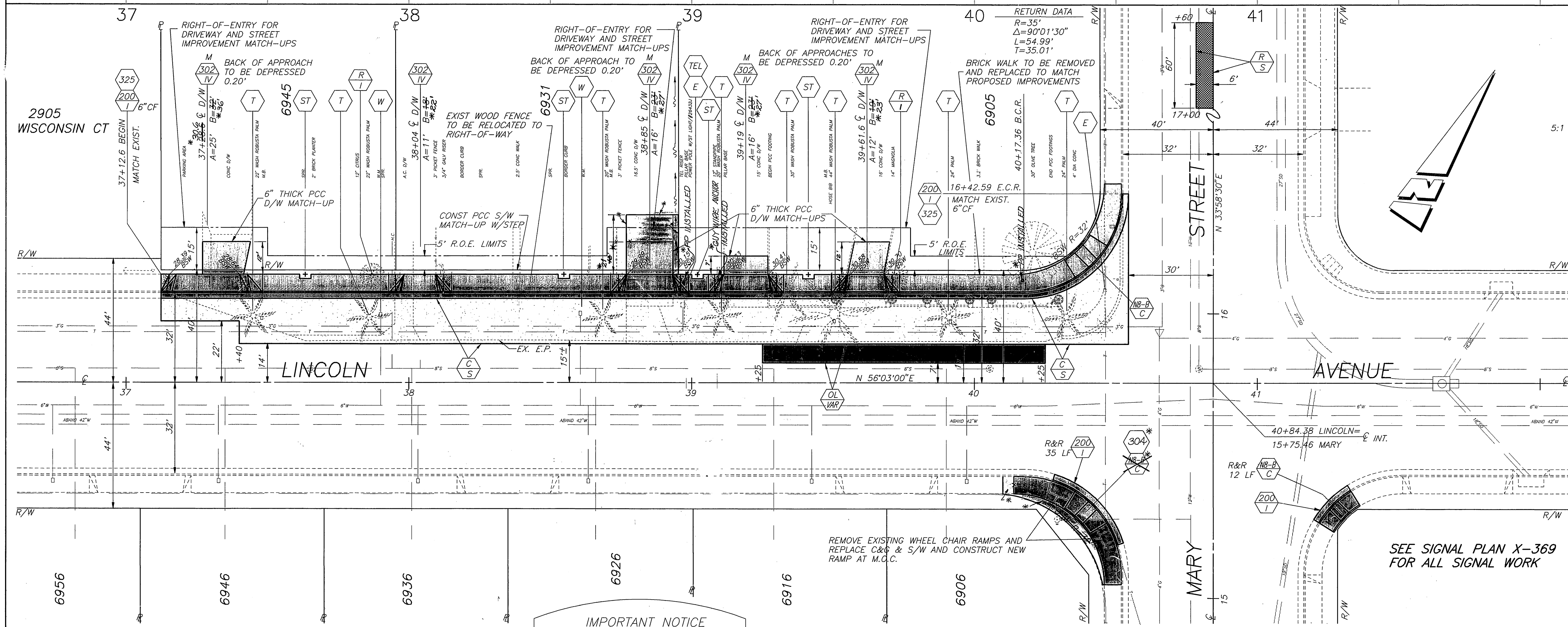

BENCHMARK:
 3/4" IP @ P.I. OF LINCOLN AVE.
 & MARY ST. PER LL 17/61A
 ELEV. 932.61

IMPORTANT NOTICE
 Section 4216/4217 of the Government Code requires a Dig Alert Identification Number to be issued before a "Permit to Excavate" will be valid. For your Dig Alert I.D. Number call Underground Service Alert. TOLL FREE 1-800-422-4133. Two working days before you dig.

ENGINEER IN RESPONSIBLE CHARGE
Ronald C. Mueller
 RONALD C. MUELLER
 R.C.E. No. 29510 expires 3/31/95
 DATE 2-4-93



City of Riverside, California
 DEPARTMENT OF PUBLIC WORKS
 APPROVED BY: *[Signature]* DATE: 3/8/93
 DEPUTY P.W. DIRECTOR
 PRINCIPAL ENGINEER
 CHIEF P.W. INSPECTOR
 SUPERVISOR
 STREET SERVICES
 PARKS DEPARTMENT

CITY OF RIVERSIDE, CALIFORNIA
 DEPARTMENT OF PUBLIC WORKS
 APPROVED BY: *[Signature]* DATE: 3/8/93
 DEPUTY P.W. DIRECTOR
 PRINCIPAL ENGINEER
 CHIEF P.W. INSPECTOR
 SUPERVISOR
 STREET SERVICES
 PARKS DEPARTMENT

LINCOLN AVE WIDENING
 W'LY OF MARY ST
 N'LY SIDE OF LINCOLN AVENUE
 FROM MARY STREET TO 400' W'LY

PROJECT LOCATION MAP
 SCALE 1"=1000'

PROJECT LOCATION
 SCALE 1"=1000'

ACCT. NO. 430-591500-40223-30201
R-3296
 SHEET 1 OF 1
 FILE NO.

INDEXED 2-11-97 4-11

PC 3542-5