

BENCHMARK  
 R.R. SPIKE IN EASTERLY SIDE OF POWER  
 POLE 28' EASTERLY OF SNACK BAR  
 NEAR TOT LOT AT FAIRMOUNT PARK.  
 ELEVATION 797.58'

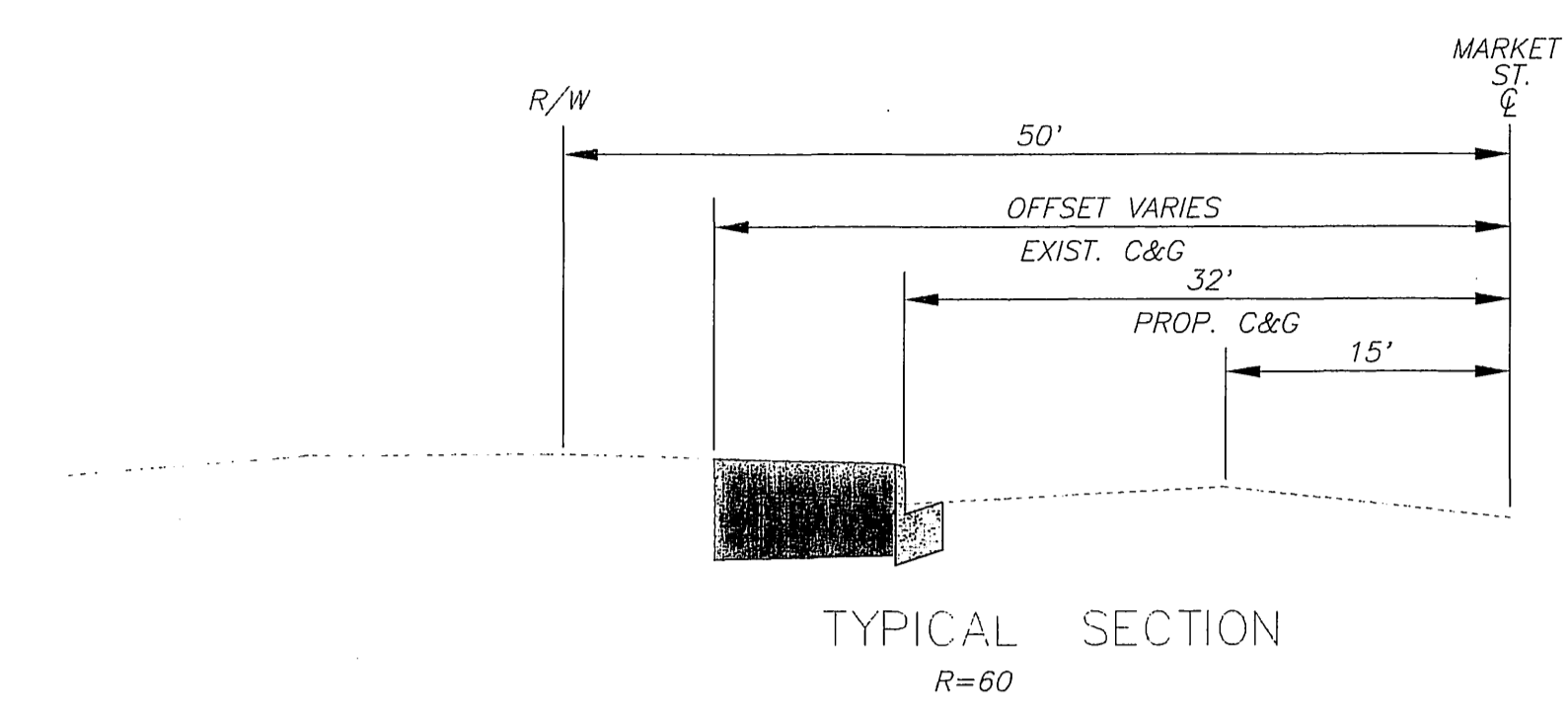

BENCHMARK  
 R.R. SPIKE IN E'LY SIDE OF  
 COMB. POWER POLE 28' +/- E'LY OF  
 SNACK BAR (BAND SHELL & PLAY  
 GROUND AREA) PER LL15/14  
 ELEVATION 797.58

13 GENERAL NOTES 14

- 1 EXISTING UTILITIES SHOWN ON THE PLAN ARE PLOTTED FROM UTILITY RECORDS. THE CONTRACTOR IS REQUIRED TO TAKE DUE PRECAUTIONARY MEASURES TO LOCATE AND PROTECT ALL UTILITIES WHETHER OR NOT SHOWN ON THIS PLAN.
- 2 PRIME CONTRACTORS BIDDING THIS WORK SHALL HAVE A CLASS "A" OR CLASS "C-10" LICENSE.
- 3 ALL ELEVATIONS SHOWN ON THE PLANS SHALL BE STAKED IN THE FIELD. FINAL GRADES SHALL BE DETERMINED AT TIME OF CONSTRUCTION.
- 4 CONSTRUCTION SHALL BE IN ACCORDANCE WITH THE CITY OF RIVERSIDE STANDARD DRAWINGS AND STANDARD SPECIFICATIONS FOR PUBLIC WORKS CONSTRUCTION, 1991 EDITION.
- 5 CONFLICTING UTILITIES IN THE CONSTRUCTION AREA SHALL BE RELOCATED OR ABANDONED.
- 6 SEE C/R PLAN X-160 FOR SIGNALIZATION, STRIPING, DISPOSITION OF SIGNS, RETAINING WALL @ STA.16+34, AND STREET LIGHTING.
- 7 CONTACT TIM YOUNG, C/R PARK SUPERVISOR, AT TEL. 909-782-5401 FOR COORDINATION OF LANDSCAPING IRRIGATION IN MEDIAN ISLAND.

CONSTRUCTION NOTES

- 1 REMOVE EXISTING IMPROVEMENTS. REPLACE WITH 4" AC OVER NATIVE.
- 2 REMOVE EXISTING IMPROVEMENTS. REPLACE WITH CLEAN FILL MATERIAL.
- 3 CONSTRUCT WHEELCHAIR RAMP PER CALTRANS STD HSP-A88, CASE C. REMOVE 20 LF OF 24" RCP. REPLACE WITH 20 LF 18" RCP, 2500 D. PIPE. INSTALLATION INCLUDES COLLAR CONNECTION TO CATCH BASIN AND 24" RCP.

WHEELCHAIR RAMP AND STORM DRAIN REPLACEMENT

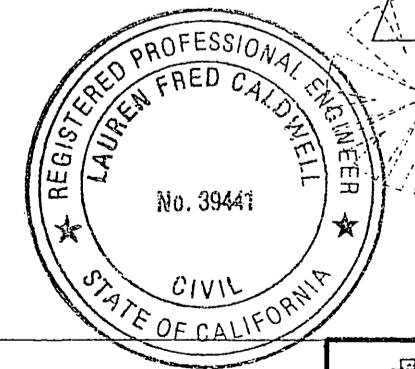
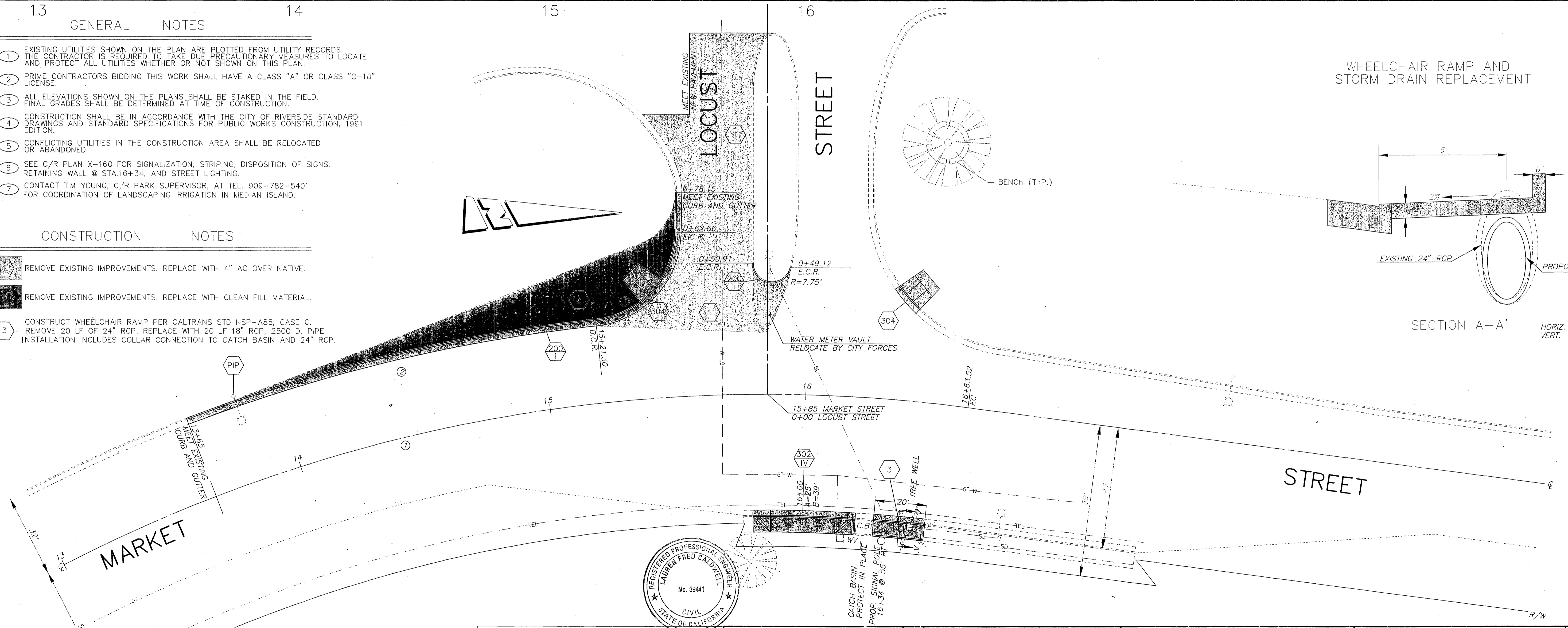
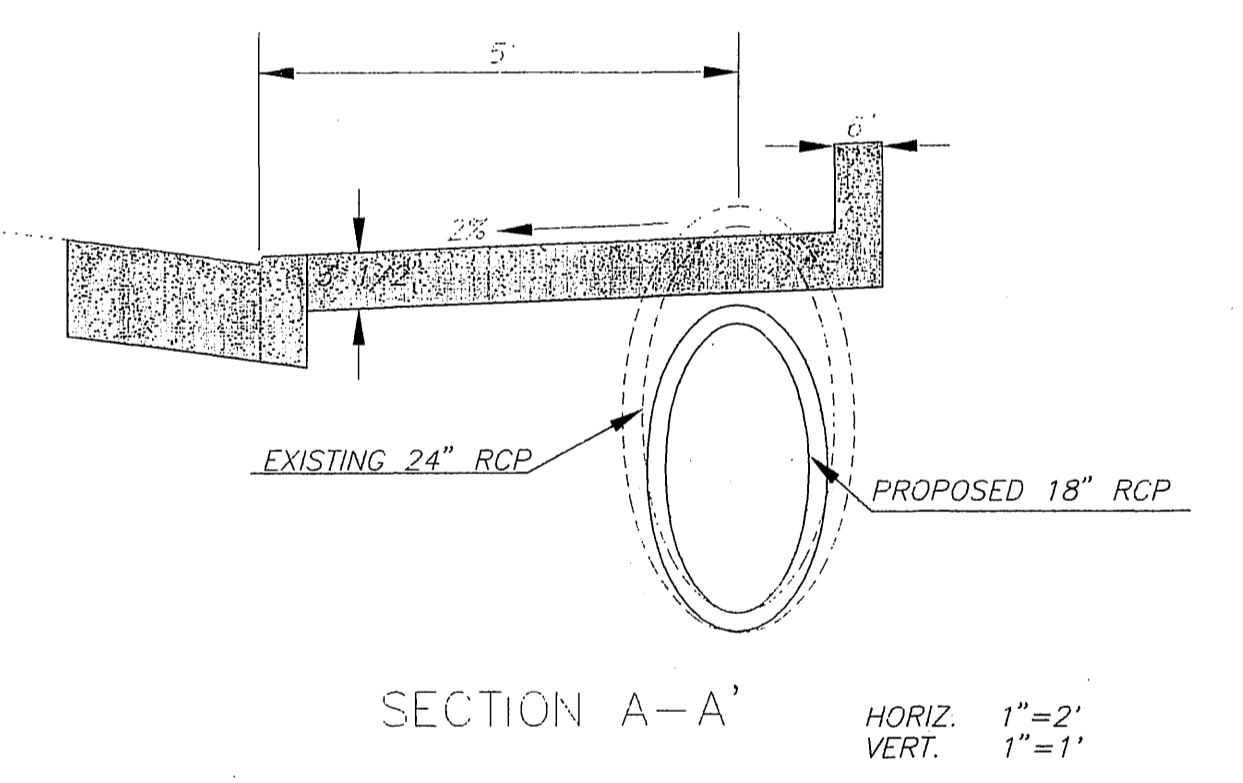

CURVE DATA				
Station	Δ	R	L	T
1	14° 55' 33"	600'	156.30'	78.60'
2	14° 55' 33"	632'	164.64'	82.79'
3	82° 57' 45"	35'	50.68'	30.94'

ENGINEER IN CHARGE  
 LAUREN F. CALDWELL  
 R.C.E. No. 39441 expires 12/31/97  
 DATE 1/21/98

CITY OF RIVERSIDE, CALIFORNIA  
 PUBLIC WORKS DEPARTMENT  
 APPROVED BY: [Signature]  
 DEPUTY P.W. DIRECTOR  
 PRINCIPAL ENGINEER  
 CHIEF P.W. INSPECTOR  
 SUPERVISOR  
 DATE 1/27/98

LOCUST STREET  
 AT  
 MARKET STREET  
 HORIZ. SCALE: 1" = 20' VERT. SCALE: 1" = 4'

REFERENCE PLANS  
 444A  
 444, SHEET 9  
 R-542  
 ACCT. NO.  
 411-552200-440301-90048  
 R-3320  
 SHEET 1 OF 1  
 FILE NO.

