

GENERAL NOTES

- IT SHALL BE THE RESPONSIBILITY OF THE CONTRACTOR TO CLEAR THE RIGHT OF WAY IN ACCORDANCE WITH THE PROVISIONS OF LAW AS IT AFFECTS EACH UTILITY INCLUDING IRRIGATION LINES AND APPURTEANCES AND AT NO COST TO THE CITY.
- CONSTRUCTION SHALL BE IN ACCORDANCE WITH THE CITY OF RIVERSIDE DEPARTMENT OF PUBLIC WORKS, STANDARD DRAWINGS, STANDARD DRAWING NO. 10 AND THE STANDARD SPECIFICATIONS FOR PUBLIC WORKS CONSTRUCTION, CURRENT EDITION.
- THE PRIVATE ENGINEER SIGNING THESE PLANS IS RESPONSIBLE FOR ASSURING THE ACCURACY AND ACCEPTABILITY OF THE WORK HEREON. IN THE EVENT OF DISCREPANCIES ARISING DURING CONSTRUCTION, THE PRIVATE ENGINEER SHALL BE RESPONSIBLE FOR DETERMINING AN ACCEPTABLE SOLUTION AND REVISING THE PLANS FOR APPROVAL BY THE CITY.
- THE DEVELOPER SHALL BE RESPONSIBLE FOR PRESERVING OR RE-ESTABLISHING AND REFERENCING SURVEY MONUMENTS DESTROYED, DISTURBED OR BURIED AS A RESULT OF CONSTRUCTION SHOWN HEREON.
- ALL FLAGGED ELEVATIONS SHALL BE STAKED IN THE FIELD BY THE PRIVATE ENGINEER.
- TRIM EDGE OF EXISTING PAVEMENT WHERE NEW PAVEMENT JOINS TO A SMOOTH, STRAIGHT LINE. CONSTRUCT MATCH-UP PAVING AS SHOWN ON PLAN AND OVERLAY PAVING AS DIRECTED IN THE FIELD TO PRODUCE A SMOOTH SECTION.
- ALL OVERHANGING TREE LIMBS THAT ARE LESS THAN 14' ABOVE THE STREET GRADE SHALL BE TRIMMED BACK.
- ALL TRAFFIC SIGNS SHALL BE INSTALLED PRIOR TO OPENING THE STREETS TO TRAFFIC.
- ANY TRAFFIC CONTROL STRIPING OBLITERATED AND/OR BADLY WORN DURING CONSTRUCTION SHALL BE RESTORED BY THE CONTRACTOR WITHIN FIVE DAYS AFTER NOTIFICATION FROM THE CITY INSPECTORS.
- FINAL STRIPING FOR TRAFFIC CONTROL AND/OR PAVEMENT MARKING TO BE THE RESPONSIBILITY OF THE DEVELOPER.
- THE CONTRACTOR SHALL CALL IN A LOCATION REQUEST TO UNDERGROUND SERVICE ALERT (USA), PHONE NO. 1-800-422-4133, TWO WORKING DAYS BEFORE DIGGING. NO CONSTRUCTION PERMIT WILL BE ISSUED BY THE PUBLIC WORKS DEPARTMENT INVOLVING EXCAVATION FOR UNDERGROUND FACILITIES UNLESS THE APPLICANT HAS BEEN PROVIDED AN INQUIRY IDENTIFICATION NUMBER BY U.S.A.
- IN PAVEMENT OVERLAY AREAS, DISTRESSED EXISTING PAVEMENT SHALL BE REMOVED AND REPLACED AS DIRECTED BY THE INSPECTOR PRIOR TO OVERLAYING WITH A.C. PAVING.
- DEVELOPER TO GIVE CITY WATER DIVISION FIVE (5) WORKING DAYS WRITTEN NOTICE PRIOR TO START OF CONSTRUCTION AND TO ALLOW CITY TEN (10) WORKING DAYS FOR COMPLETION OF WORK. (714) 351-6150.
- CONTRACTOR TO NOTIFY THE CITY OF RIVERSIDE PUBLIC UTILITIES DEPARTMENT ELECTRICAL ENGINEERING AT 782-5404 PRIOR TO START OF CONSTRUCTION.
- CONTRACTOR TO PROVIDE INFORMATION SATISFACTORY TO THE DEPARTMENT ASSURING PROTECTION OF THE EXISTING HIGH VOLTAGE DUCT BANK.

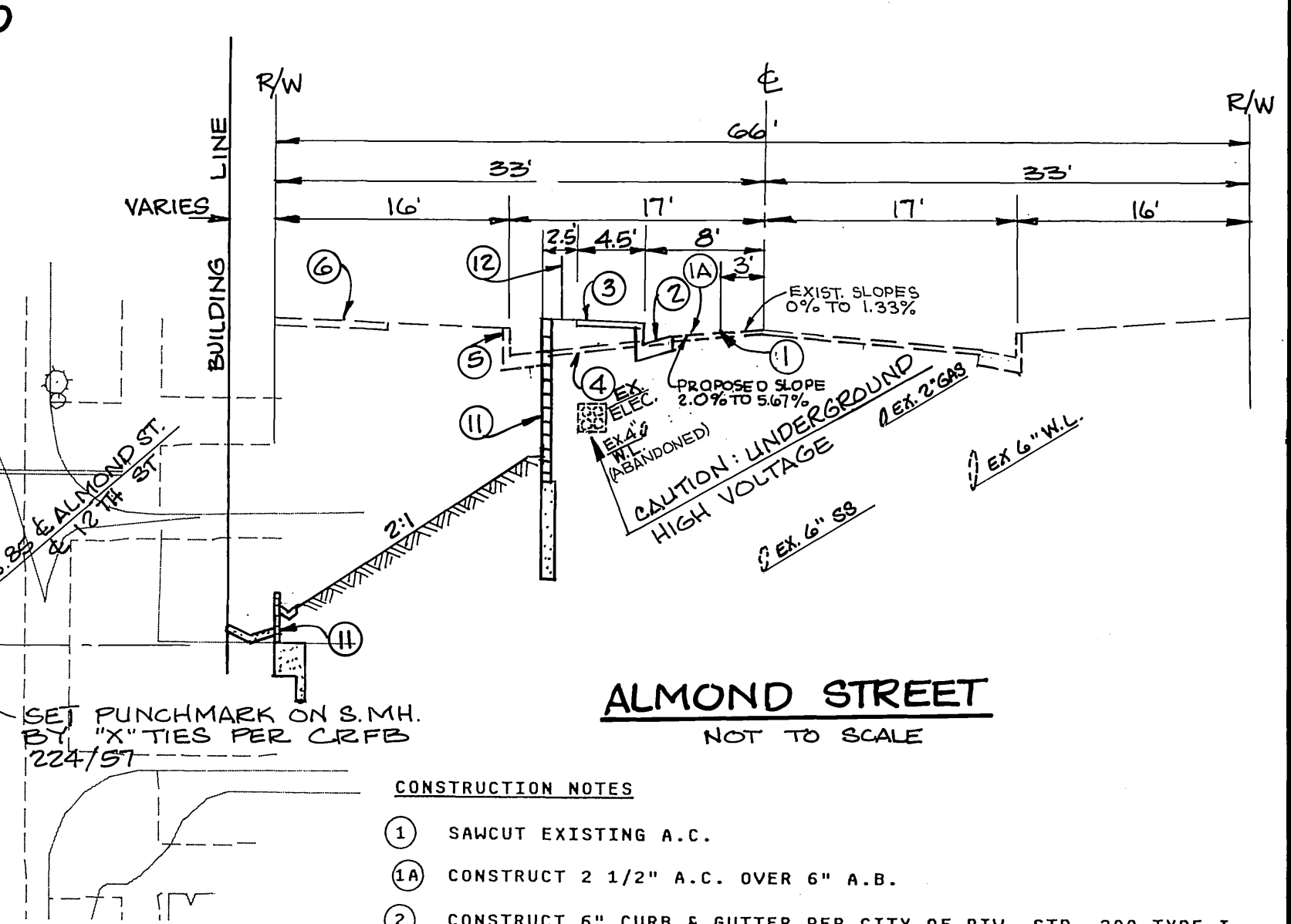
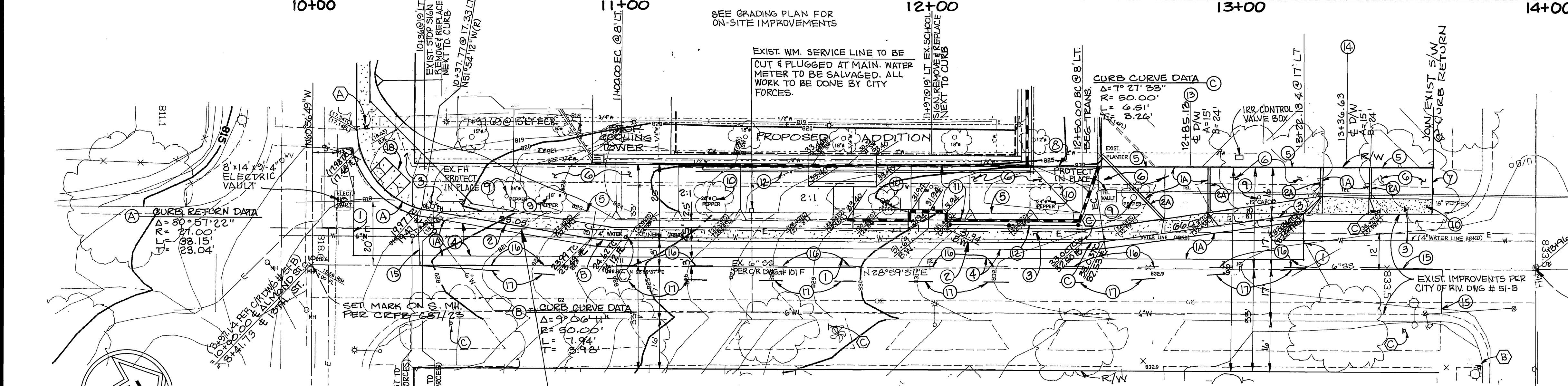
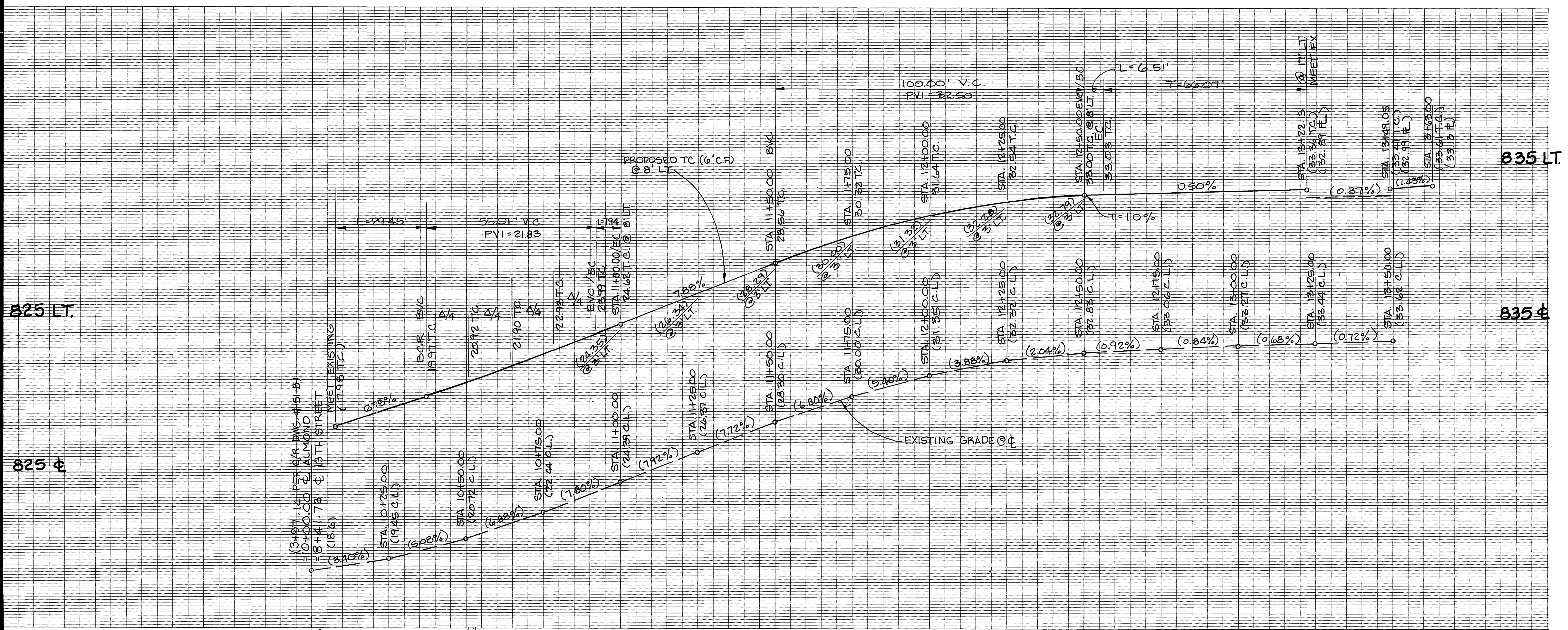

**TRAFFIC & STREET NAME SIGN SCHEDULE**

(A)	ALMOND STREET (PVT)	4300
(B)	13 TH STREET	3900
(C)	ALMOND STREET (PVT)	4200
(D)	12 TH STREET	3900
(E)	R-26 "NO PARKING"	

CONST. PER C/R STD'S 662A & 666

**CONSTRUCTION NOTES**

- SAWCUT EXISTING A.C.
- CONSTRUCT 2 1/2" A.C. OVER 6" A.B.
- CONSTRUCT 6" CURB & GUTTER PER CITY OF RIV. STD. 200 TYPE I.
- CONSTRUCT 6" CURB PER CITY OF RIVERSIDE STD 200 TYPE II.
- CONSTRUCT 4.5" WIDE SIDEWALK PER CITY OF RIVERSIDE STD 325 (MODIFIED)
- REMOVE EXISTING A.C.
- REMOVE EXISTING CURB & GUTTER
- REMOVE EXISTING SIDEWALKS
- REMOVE EXISTING RETAINING WALL
- PROTECT TREES
- REMOVE EXISTING TREES
- CONSTRUCT RETAINING WALLS PER GRADING PLAN
- CONSTRUCT HANDRAIL PER ARCHITECT PLAN.
- REMOVE EXISTING DRIVEWAY AND REPLACE PER CITY OF RIV. STD. 302 (TYPE VI IN)
- REMOVE EXISTING DRIVEWAY AND REPLACE PER CITY OF RIV STD 302 (TYPE VI OUT).

CAUTION: UNDERGROUND HIGH VOLTAGE

SCALE: 1" = 20'

NORTH

**UNDERGROUND SERVICE ALERT**

**CITY OF RIVERSIDE WATER SYSTEM**

**CITY OF RIVERSIDE ELECTRICAL SYSTEM**

**PAC-BELL TELEPHONE CO.**

**SOUTHERN CALIFORNIA GAS CO.**

**GABEL, COOK & BECKLUND**  
Civil Engineering - Surveying - Planning  
Hydrology - Environmental  
647 N. Main St., Suite 1-B Riverside, Ca. 92501  
Tel. (714) 788-8092 FAX 788-5184  
CITY BUSINESS TAX CERTIFICATE NO. 012144 EXP. 12-31-93

**CITY OF RIVERSIDE PUBLIC WORKS DEPARTMENT**

**STREET IMPROVEMENTS PLAN AND PROFILE**  
ALMOND STREET (PRIVATE STREET)  
FROM 13TH STREET NLY TO 12TH STREET  
VAC-14-912

**R-3323**

**INDEXED 5/21/93**

OFFICE OF THE STATE ARCHITECT  
ACCESS COMPLIANCE SECTION  
APPLICATION PER W. 440 B005  
5796  
DEC 16 92  
APPROVAL OF THIS PLAN DOES NOT CONSTITUTE OR APPROVE ANY DESIGN OR DETAIL FROM APPLICABLE REGULATIONS.  
Reviewed by: [Signature]