

GENERAL CONSTRUCTION NOTES:

- 1 EXISTING UTILITIES SHOWN ON THE PLAN ARE PLOTTED FROM UTILITY RECORDS. THE CONTRACTOR IS REQUIRED TO TAKE DUE PRECAUTIONARY MEASURES TO LOCATE AND PROTECT ALL UTILITIES WHETHER OR NOT SHOWN ON THIS PLAN.
- 2 ALL ELEVATIONS SHOWN ON THE PLANS SHALL BE STAKED IN THE FIELD.
- 3 ALL TREES SHALL BE PROTECTED IN PLACE.
- 4 CONSTRUCTION SHALL BE IN ACCORDANCE WITH THE CITY OF RIVERSIDE STANDARD DRAWINGS AND STANDARD SPECIFICATIONS FOR PUBLIC WORKS CONSTRUCTION, 1991 EDITION, INCLUDING 1992 SUPPLEMENT.
- 5 CONFLICTING UTILITIES IN THE CONSTRUCTION AREA SHALL BE RELOCATED OR ABANDONED.

CONSTRUCTION LEGEND:

- NUMBERS ABOVE 100 IN A HEXAGON ON THE PLAN REFER TO THE RESPECTIVE STANDARD DRAWING AND SHALL BE CONSTRUCTED ACCORDINGLY, UNLESS MODIFICATIONS ARE NOTED ON THE PLAN. ANY NUMBER SHOWN BELOW THE STANDARD DRAWING NUMBER INDICATES THE SPECIFIC ALTERNATE TO BE CONSTRUCTED.
- CONSTRUCT VARIABLE THICKNESS AC OVERLAY.
- ADJUST TO GRADE.
- GRADE TO MATCH PROPOSED IMPROVEMENTS, ADJUST EXISTING SPRINKLER SYSTEM AND RESEED SLOPE.
- RELOCATE EXISTING STREET LIGHT EASTERLY, REPLACE CONDUIT AND CABLE FROM STA 19+44 TO NEW FOUNDATION. CONSTRUCT FOUNDATION AS SHOWN AT RIGHT. INSTALL #4 TRIPLEX FOR TEMPORARY FEED AFTER RELOCATION OF POLE. ALL STREET LIGHTING WORK TO BE PER PUD SPECIFICATIONS 2-6 AND UGS-800.
- REMOVE EXISTING DRIVEWAY APPROACH AND IMPROVEMENTS TO R/W LINE. IMPORT FILL AND REGRADE TO MATCH ADJOINING AREAS. EXTEND SPRINKLER SYSTEM AND RESEED.
- CONSTRUCT STD 411 UNDER SIDEWALK DRAIN. CHECKERED PLATE THICKNESS SHALL BE 3/8" MINIMUM. WALL HEIGHT SHALL BE ADJUSTED TO MATCH ADJOINING CURBS. CHECKERED PLATE SHALL EXTEND FROM CURB FACE TO 1' BEHIND BACK OF SIDEWALK.
- SIDEWALK WIDTH AND SCORING SHALL MATCH EXISTING.
- 1" RIGID PLASTIC (DB) CONDUIT W/2-#8 CU. 600 V. CABLES.
- PULLBOX (10"x17"x12") PER ITEM #P-1 OF UGS-800, INSTALL PER UGS-320.

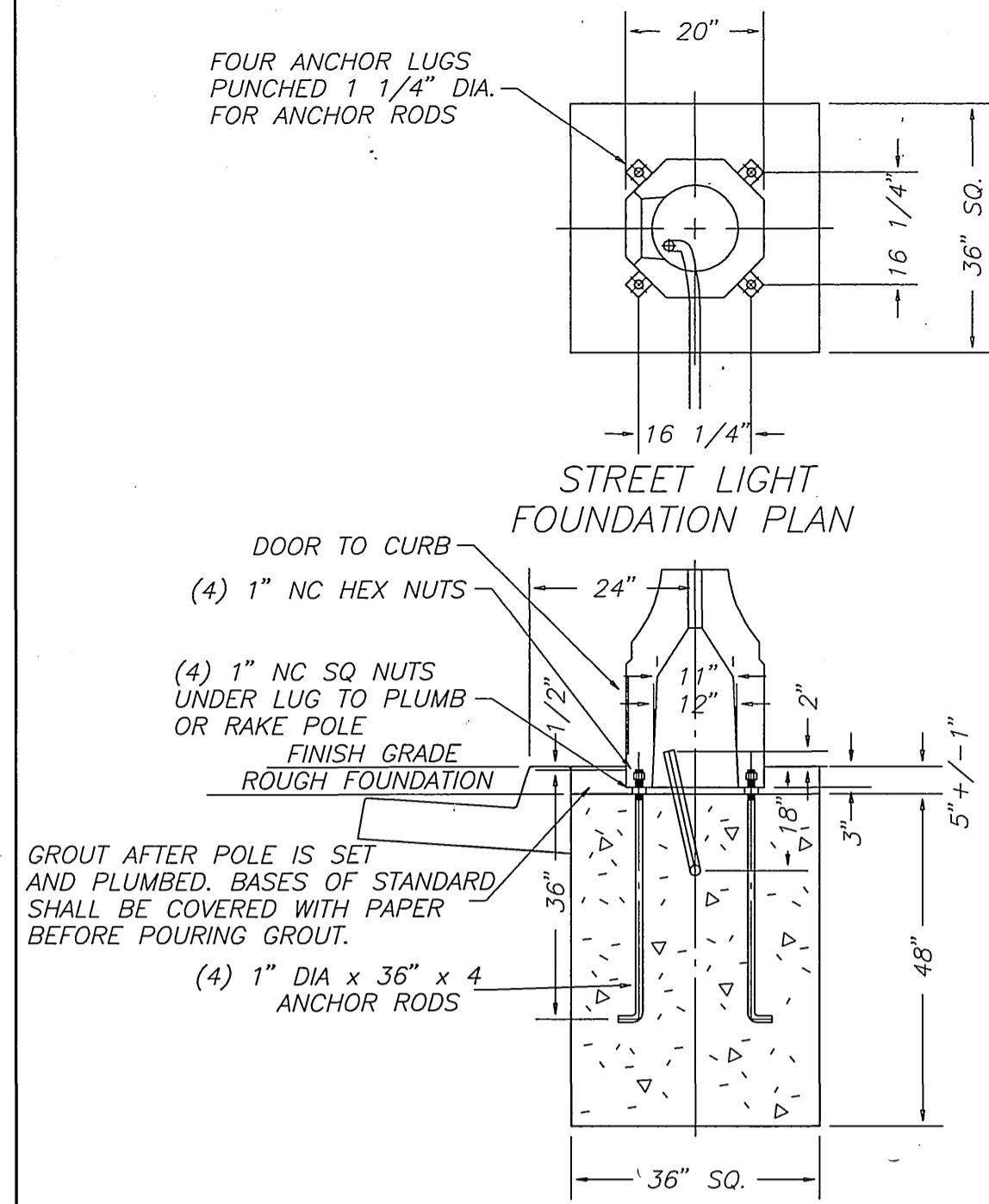

- STREET LIGHT NOTES:**
- 1 ALL STREET LIGHT FACILITIES INSTALLED BY CONTRACTOR SHALL BE INSPECTED BY THE PUBLIC UTILITIES DEPARTMENT INSPECTOR. CONTRACTOR SHALL CONTACT THE INSPECTOR AT TELEPHONE # 782-5429.
 - 2 CONTRACTOR TO MAINTAIN STREET LIGHT SERVICE DURING CONSTRUCTION.
 - 3 CONTRACTOR TO REMOVE EXISTING FOUNDATION, CONDUIT AND CABLE.
 - 4 EXCAVATION FOR STREET LIGHT FOUNDATION AND CONDUITS MUST BE DONE AFTER INSTALLATION OF CURBS AND GUTTERS. FOUNDATION LOCATION SHALL BE APPROVED PRIOR TO EXCAVATION.

BENCHMARK
 (16-G) BRASS DISC IN MON. WELL
 C.L. INTERSECTION OF 14TH STREET
 AND MARKET STREET PER B.M. BOOK
 ELEVATION 834.134

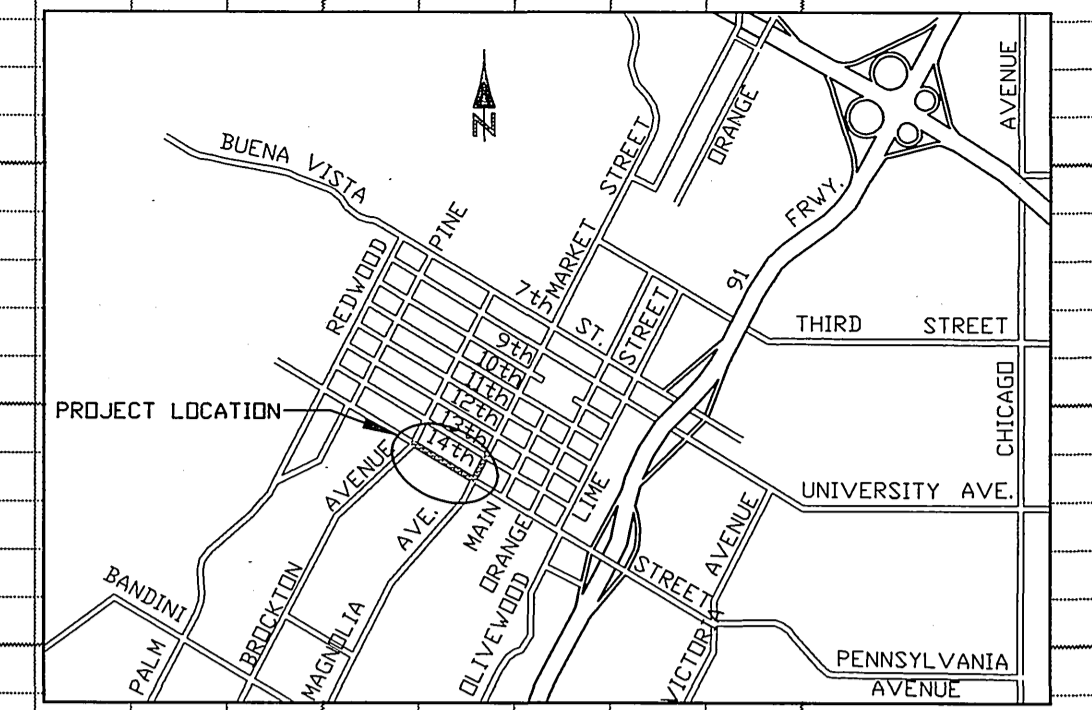
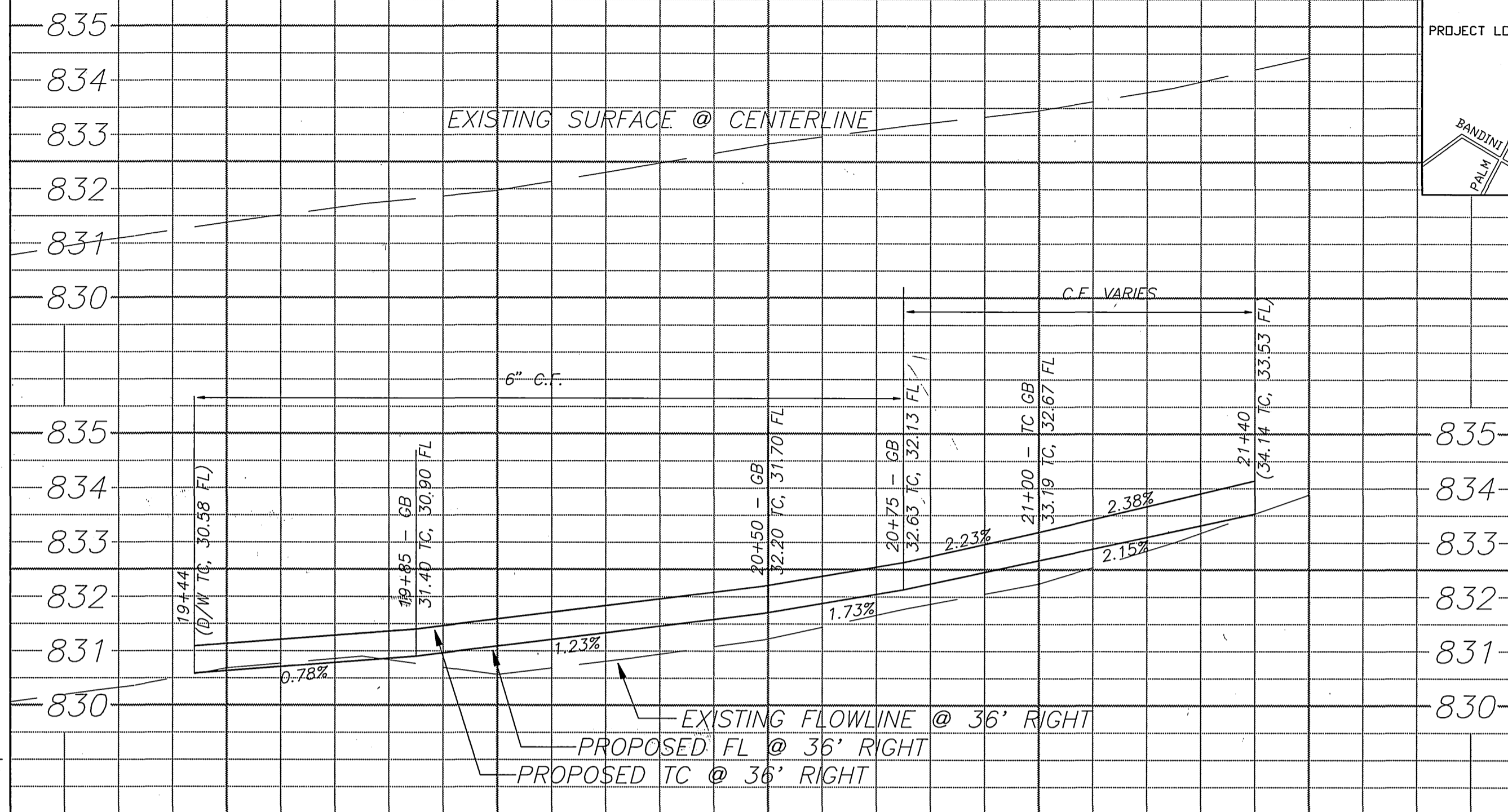

IMPORTANT NOTICE
 Section 4216/4217 of the Government Code requires a Dig Alert Identification Number to be issued before a "Permit to Excavate" will be valid. For your Dig Alert I.D. Number call Underground Service Alert TOLL FREE 1-800-422-4133 Two working days before you dig.

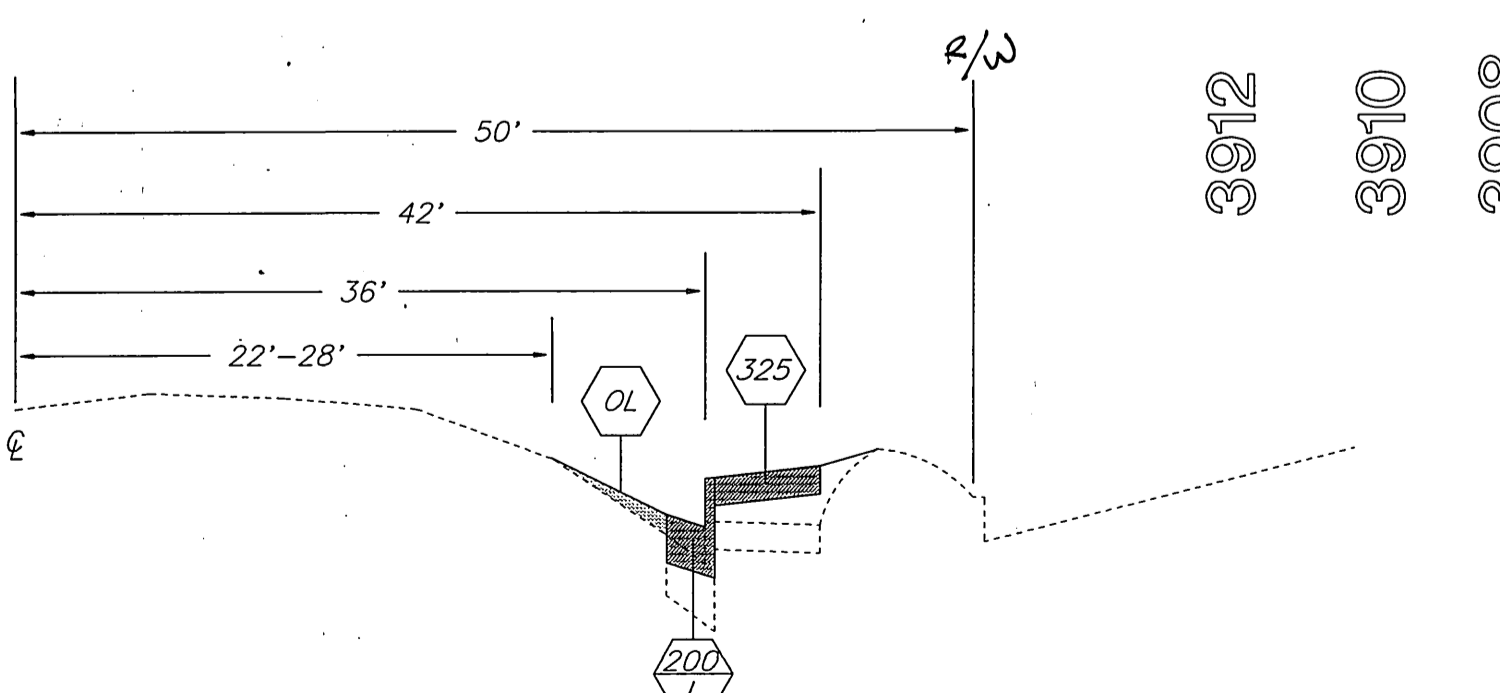
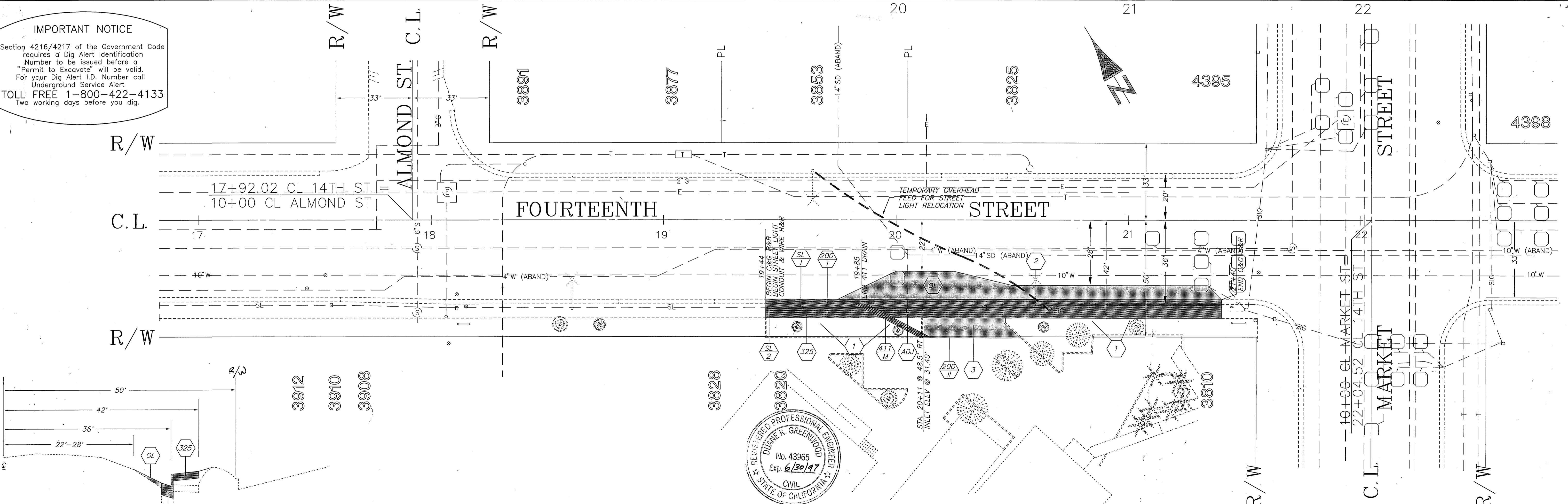

REGISTERED PROFESSIONAL ENGINEER
 DUANE GREENWOOD
 No. 43965
 Exp. 6/30/97
 CIVIL
 STATE OF CALIFORNIA

| | | | |
|---|--|--|--|
| CITY OF RIVERSIDE PUBLIC UTILITIES DEPARTMENT STREET LIGHTING APPROVED BY: <i>[Signature]</i> DATE: Nov. 29, 1994 | ENGINEER IN RESPONSIBLE CHARGE Duane Greenwood R.C.E. No. 43965 expires 6/30/97 DATE: 10/13/94 | CITY OF RIVERSIDE, CALIFORNIA PUBLIC WORKS DEPARTMENT APPROVED BY: <i>[Signature]</i> DATE: 12/6/94 | ACCT. NO. 230-541500-440223-30065 |
| | | | FOURTEENTH STREET IMPROVEMENTS SOUTHERLY SIDE WESTERLY OF MARKET STREET HORIZ. SCALE: 1" = 20' VERT. SCALE: 1" = 2' |
| DESIGNED BY: <i>[Signature]</i> DRAWN BY: <i>[Signature]</i> CHECKED BY: <i>[Signature]</i> | | SHEET 1 OF 1 FILE NO. | |

INDEXED 1-25-95 G-H