

GENERAL NOTES

- ALL CONSTRUCTION SHALL BE IN ACCORDANCE WITH THE CITY OF RIVERSIDE DEPARTMENT OF PUBLIC WORKS STANDARD DRAWINGS AND THE STANDARD SPECIFICATIONS FOR PUBLIC WORKS CONSTRUCTION, CURRENT EDITION.
- TRIM EDGE OF EXISTING PAVEMENT WHERE NEW PAVEMENT JOINS TO A SMOOTH, STRAIGHT LINE. CONSTRUCT MATCH-UP PAVING AS SHOWN ON THE PLAN OR AS DIRECTED IN THE FIELD BY THE ENGINEER.

CONSTRUCTION NOTES

- NUMBERS ABOVE 100 IN A HEXAGON ON THE PLAN REFER TO THE RESPECTIVE STANDARD DRAWING AND SHALL BE CONSTRUCTED ACCORDINGLY, UNLESS MODIFICATIONS ARE NOTED ON THE PLAN. ANY NUMBER SHOWN BELOW THE STANDARD DRAWING NUMBER INDICATES THE SPECIFIC ALTERNATE TO BE CONSTRUCTED.
- 1 CONSTRUCT MODIFIED WHEELCHAIR RAMP PER DETAIL SHOWN BELOW.
- 2 CUT EXIST. SLOPE AT 1:1 MAX.
- 3 CONSTRUCT VARIABLE DEPTH AC OVERLAY.
- 4 CONSTRUCT 14" FULL DEPTH ASPHALT PAVING.
- 5 RELOCATE AS DIRECTED IN THE FIELD BY THE ENGINEER.
- 6 PROTECT IN PLACE.
- 7 REMOVE EXIST. AC SWALE AND RECONSTRUCT WITH A ROLLED EDGE.
- 304 M CONSTRUCT WHEELCHAIR RAMP IN ASPHALT. SAWCUT EXIST. BERM OR DEPRESS NEW BERM AS REQUIRED TO CONSTRUCT RAMP. CENTER RAMP OF EXIST. PAINTED CROSSWALK.
- 325 M CONSTRUCT 3" AC SIDEWALK AND 1.5" WIDE AC SWALE.
- 411 M CONSTRUCT DOUBLE UNDER-SIDEWALK DRAINS, SIDE BY SIDE, WITH A COMMON WALL, ANGLED AT A 45° RELATIVE TO THE CURB FACE. NET OPENING FOR EACH DRAIN SHALL BE 3" MEASURED ALONG THE CURB.

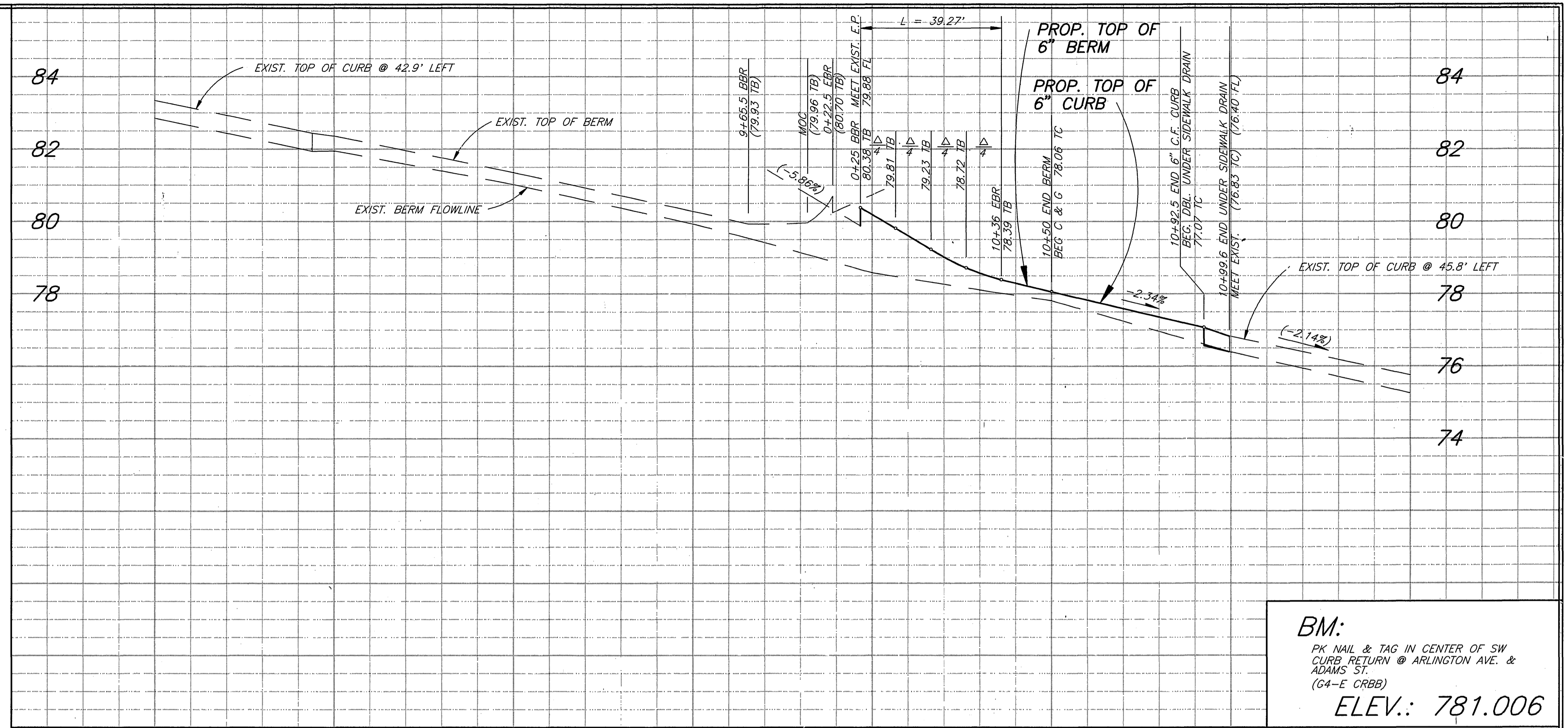

BM:
PK NAIL & TAG IN CENTER OF SW CURB RETURN @ ARLINGTON AVE. & ADAMS ST.
(G4-E CRBB)
ELEV.: 781.006

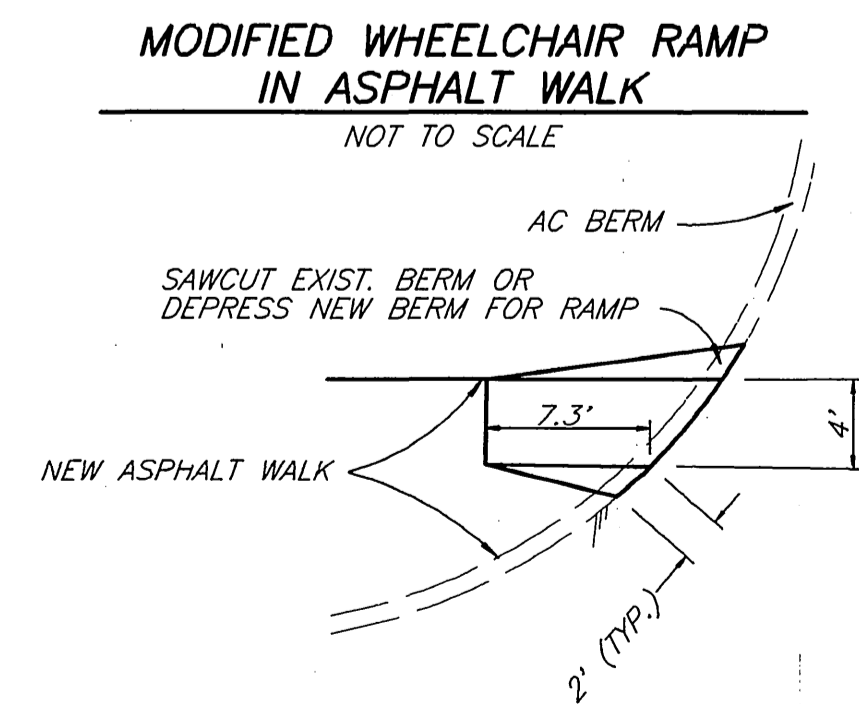
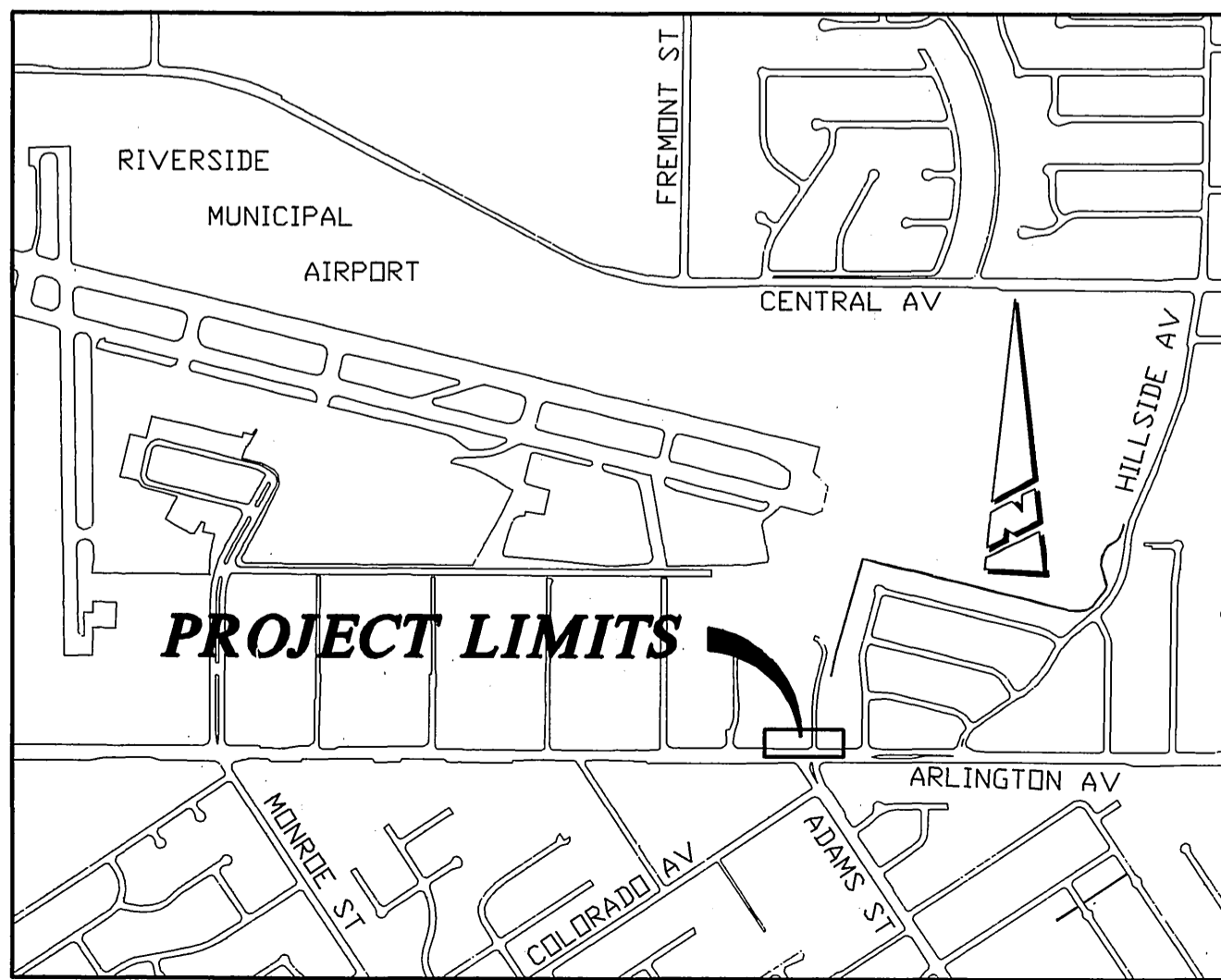
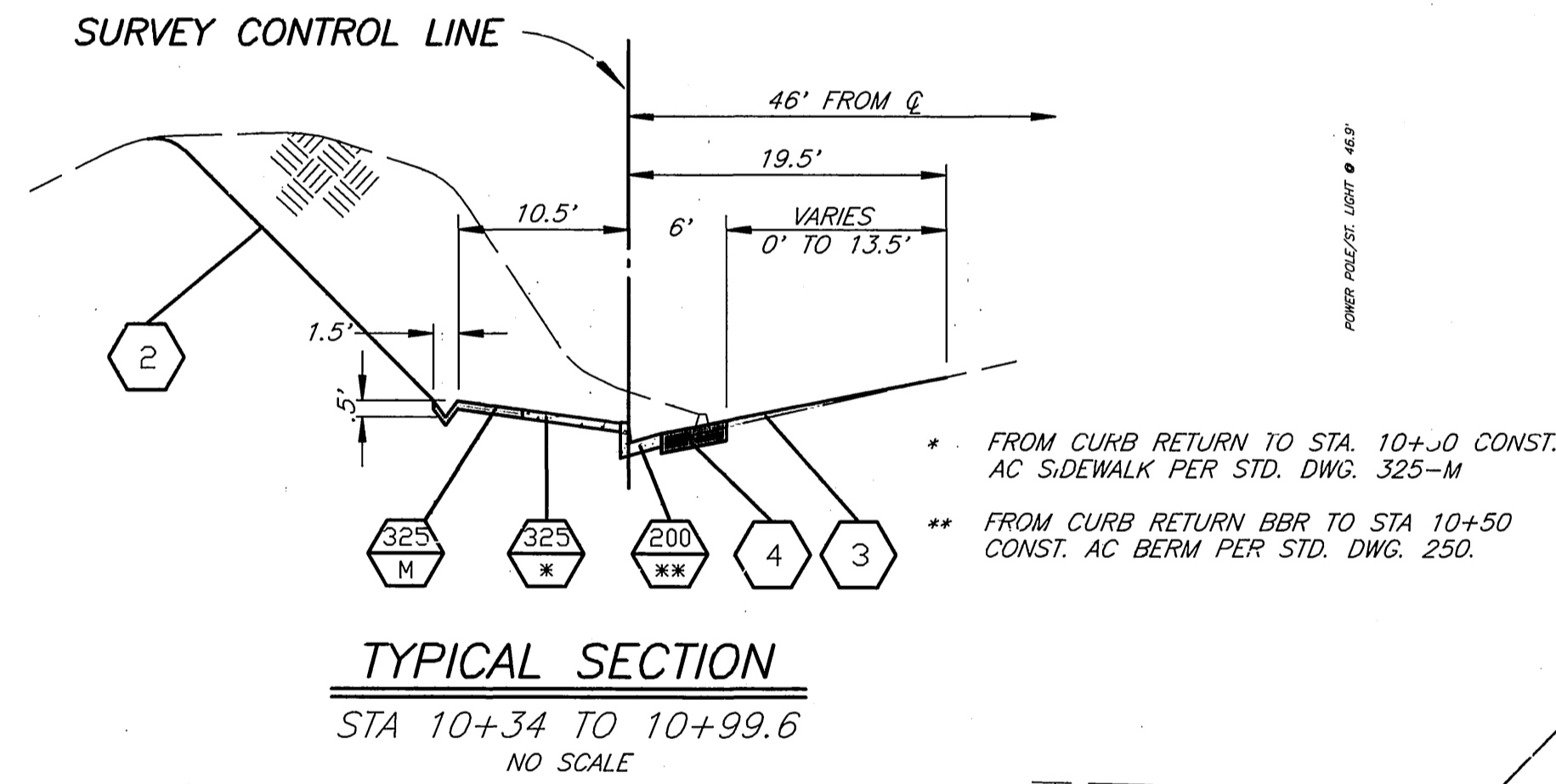
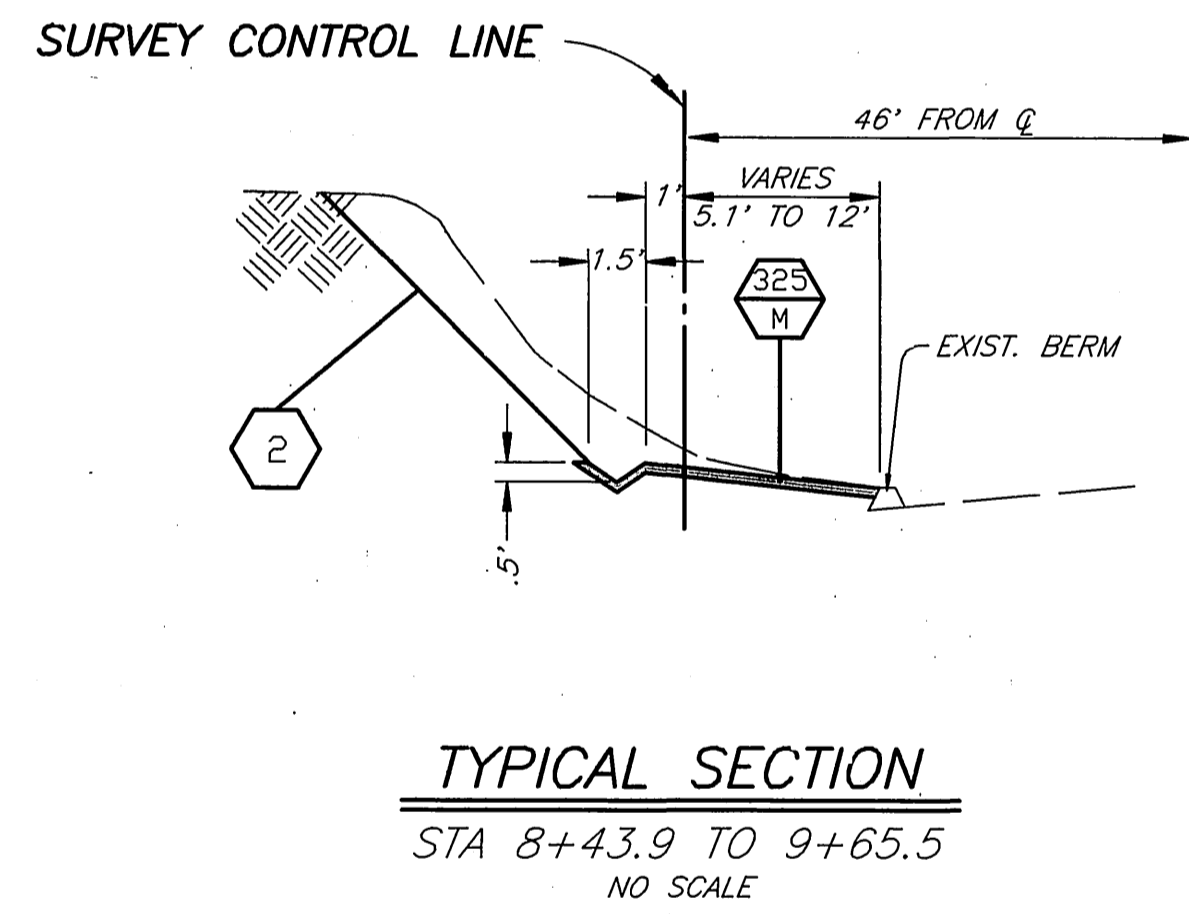

NOTE:
* FROM CURB RETURN TO STA. 10+00 CONST. AC SIDEWALK PER STD. DWG. 325-M
** FROM CURB RETURN BBR TO STA 10+50 CONST. AC BERM PER STD. DWG. 250.

NOTE:
PROTECT EXIST. TRAFFIC SIGNAL CONDUITS, WIRING AND PULLBOXES IN PLACE. NOTIFY JOE BRODERMAN, 351-6096, TWO WORKING DAYS PRIOR TO ANY EXCAVATION.

BERM CURVE DATA

R = 25'
Δ = 90°00'00"
L = 39.27'
T = 25'

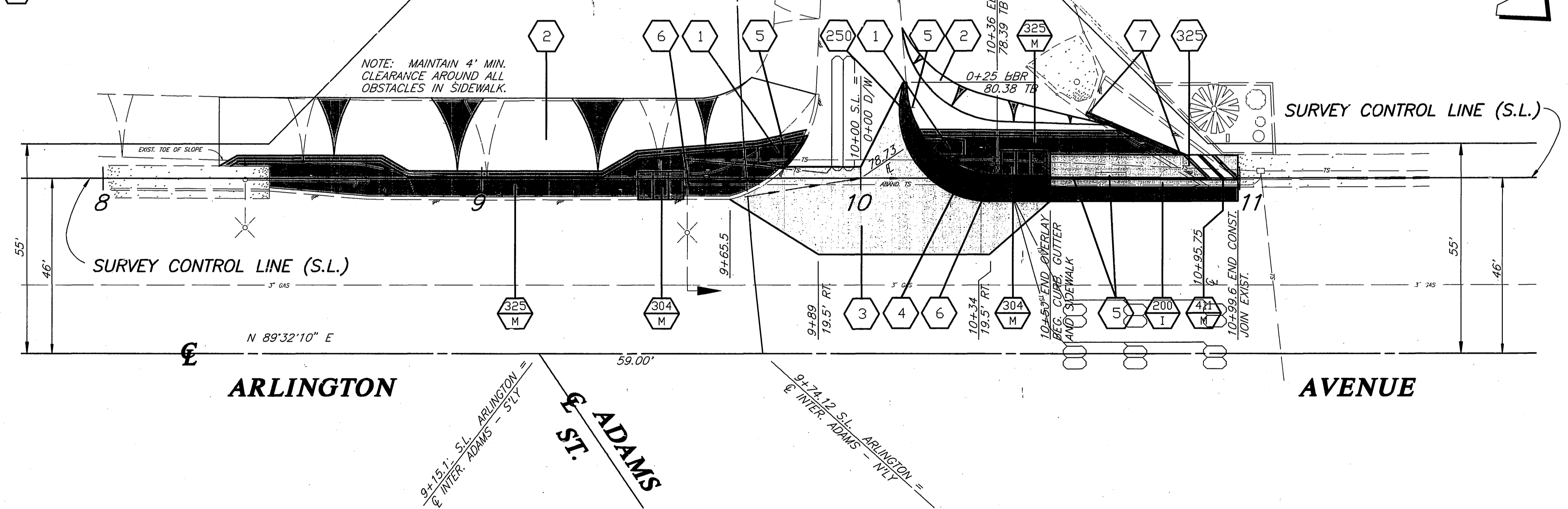

IMPORTANT NOTICE
Section 4131.4217 of the Government Code requires a Dig Alert identification Number to be issued before a "Permit to Excavate" will be valid for your Dig Alert ID Number call.
CALL TOLL FREE
48 HOURS BEFORE YOU DIG
UNDERGROUND SERVICE ALERT
1-800-422-4133



ENGINEER IN RESPONSIBLE CHARGE
MICHAEL KATUSIAN
R.C.E. No. 36686 expires 6/30/96
DATE 7/27/94

DESIGNED BY: MIKE
DRAWN BY: KARL
CHECKED BY:

CITY OF RIVERSIDE, CALIFORNIA PUBLIC WORKS DEPARTMENT	
APPROVED BY:	DATE:
DEPUTY P.W. DIRECTOR	7/28/94
PRINCIPAL ENGINEER	7/28/94
TRAFFIC DIVISION	7/28/94
PARKS DEPARTMENT	7/28/94
CHIEF P.W. INSPECTOR	7/28/94
SURVEYOR	7/28/94
PRINCIPAL ENGINEER	7/28/94

ARLINGTON AVENUE WIDENING
FROM 100' W'LY TO 185' E'LY OF ADAMS

ACCT. NO. 230-541500-440223-30024
R-3387
SHEET 1 OF 1
FILE NO.

REVISED 7-28-94