

GENERAL CONSTRUCTION NOTES:

- 1 CONSTRUCTION SHALL BE IN ACCORDANCE WITH THE CITY OF RIVERSIDE STANDARD DRAWINGS AND STANDARD SPECIFICATIONS FOR PUBLIC WORKS CONSTRUCTION, 1988 EDITION, INCLUDING 1989 & 1990 SUPPLEMENTS.
- 2 EXISTING UTILITIES SHOWN ON THE PLAN, ARE PLOTTED FROM UTILITY RECORDS. THE CONTRACTOR IS REQUIRED TO TAKE DUE PRECAUTIONARY MEASURES TO LOCATE AND PROTECT ALL UTILITIES WHETHER OR NOT SHOWN ON THIS PLAN.
- 3 ALL ELEVATIONS SHOWN ON THE PLANS SHALL BE STAKED IN THE FIELD.
- 4 REFER TO TRAFFIC SIGNAL MODIFICATION AND STRIPING PLANS FOR APPLICABLE ADDITIONAL INTERSECTION IMPROVEMENTS.

CONSTRUCTION LEGEND:

- HEXAGONS ABOVE 100 IN A HEXAGON ON THE PLAN REFER TO THE RESPECTIVE STANDARD DRAWING AND SHALL BE CONSTRUCTED ACCORDINGLY, UNLESS MODIFICATIONS ARE NOTED ON THE PLAN. ANY NUMBER SHOWN BELOW THE STANDARD DRAWING NUMBER INDICATES THE SPECIFIC ALTERNATE TO BE CONSTRUCTED.
- OL CONSTRUCT A VARIABLE THICKNESS DGAC OVERLAY.
- S CONSTRUCT A STRUCTURAL SECTION OF 9" FULL DEPTH AC.
- T1 TRANSPLANT PALM TREES ALONG JACKSON ST. AT 22' RIGHT OF CENTERLINE TO THE STATION LOCATION SHOWN IN TREE RELOCATION SCHEDULE.

EXISTING UNDERGROUND & TOPOGRAPHY LEGEND:

- EXISTING UNDERGROUND UTILITIES:**
- SANITARY SEWER 8" S
 - WATER LINE 6" W
 - STORM DRAIN 24" SD
 - GAS LINE 3" G
 - ABANDONED UTILITY 6" G (ABAND.)
 - TELEPHONE CONDUIT
 - ELECTRICAL CONDUIT
 - ELECTROLUER LIGHTING CONDUIT ELC
 - TRAFFIC SIGNAL SIG
 - FIRE ALARM

EXISTING TOPOGRAPHY:

- BLOCK WALL
- BOARD FENCE
- WIRE FENCE
- CHAIN LINK FENCE
- POLE & GUY ANCHOR
- POWER POLE
- TELEPHONE POLE
- TELEPHONE RISER
- JOINT USE POLE
- PULL BOX
- ELECTRIC M.H.
- TRAFFIC SIGNAL
- PARKING METER
- FIRE ALARM BOX
- STREET NAME SIGN
- GAS METER
- MAIL BOX
- AIR VALVE
- AIR VENT
- BUS STOP SIGN
- BLOW-OFF VALVE
- IRRIGATION STAND PIPE
- CONCRETE
- TOP OF SLOPE
- TOE OF SLOPE
- DIRECTION OF FLOW
- CENTER LINE
- RIGHT-OF-WAY
- SUBDIVISION LOT LINE
- PEDESTRIAN PUSH BUTTON
- RAILROAD TRACKS
- RAILROAD SIGNAL
- TRAFFIC SIGNAL
- TRAFFIC SIGNAL ON MAST ARM
- TRAFFIC SIGNAL CONTROLLER
- TRAFFIC SIGNAL LOOP DETECTOR
- TRAFFIC SIGNAL PRESSURE DETECTOR
- STREET LIGHT & TRAFFIC SIGNAL ON MAST ARM
- STREET LIGHT (UPRIGHT)
- STREET LIGHT ON MAST ARM
- STEEL POST
- WOOD POST
- BUILDING
- EDGE OF PAVEMENT
- WHEEL STOP
- A.C. BERM
- ASPHALT

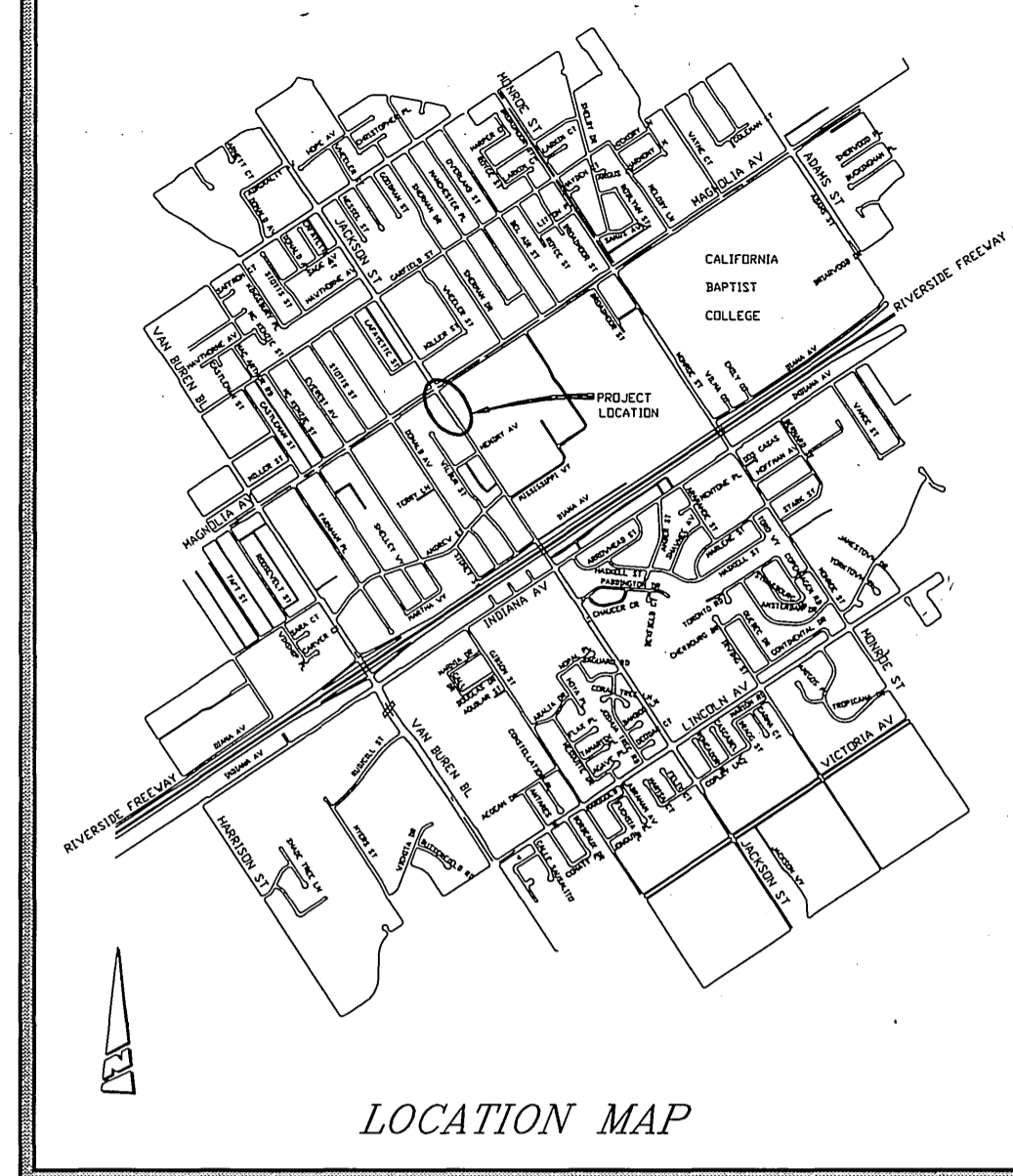

TREE RELOCATION SCHEDULE

TREE NO.	TREE SIZE AND TYPE	TREE STATIONING FROM	TO
T1	24" DIAMETER PALM	STA. 136+49.79	STA. 125+30.51
T2	26" DIAMETER PALM	STA. 136+09.79	STA. 123+40.01
T3	24" DIAMETER PALM	STA. 135+69.79	STA. 121+86.01
T4	26" DIAMETER PALM	STA. 135+29.79	STA. 118+88.97
T5	26" DIAMETER PALM	STA. 134+89.79	STA. 116+78.47
T6	25" DIAMETER PALM	STA. 134+49.79	STA. 115+97.34
T7	24" DIAMETER PALM	STA. 134+10.29	STA. 115+52.09

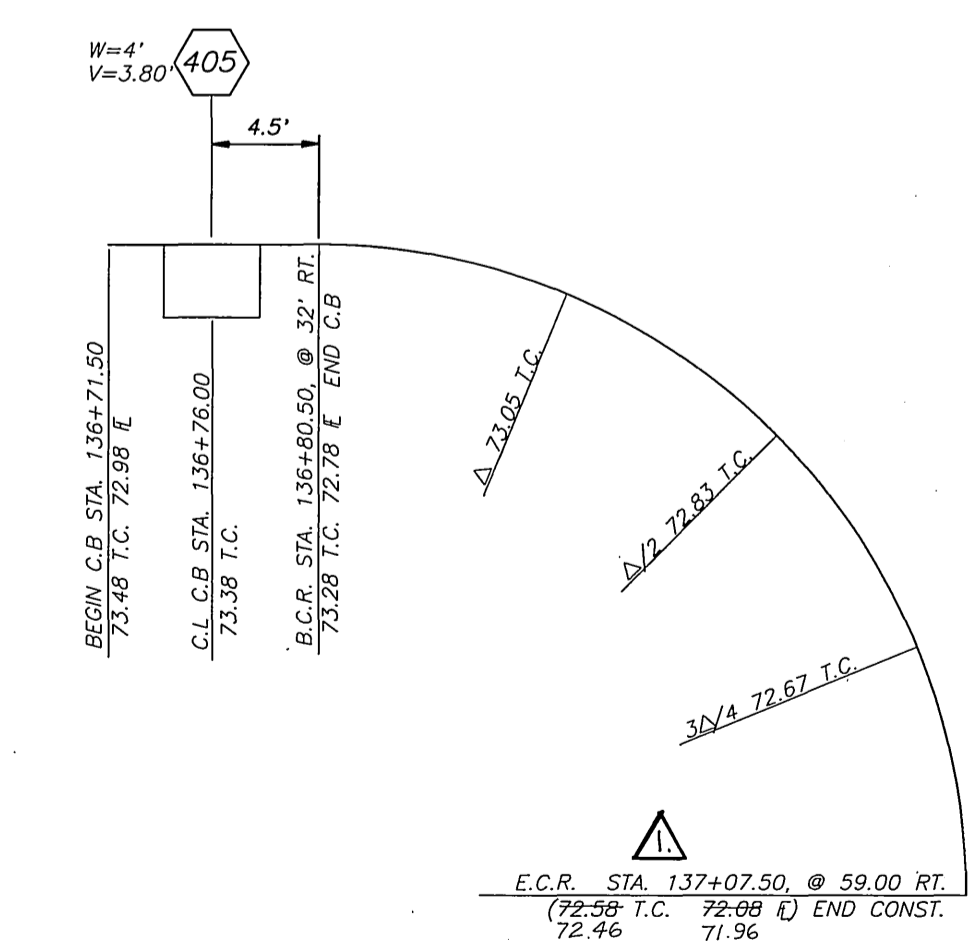
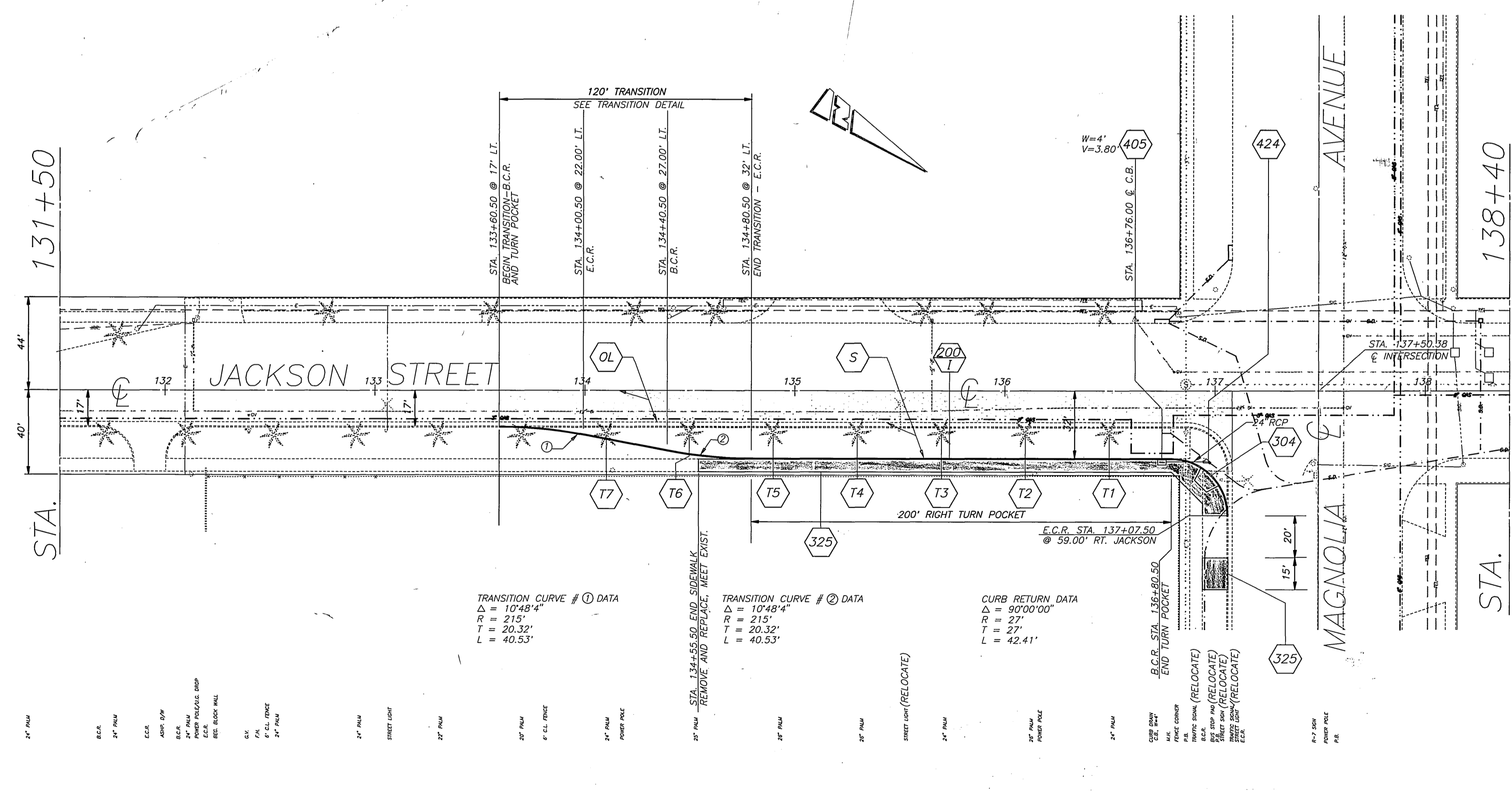

CURB RETURN DETAIL
N.T.S.

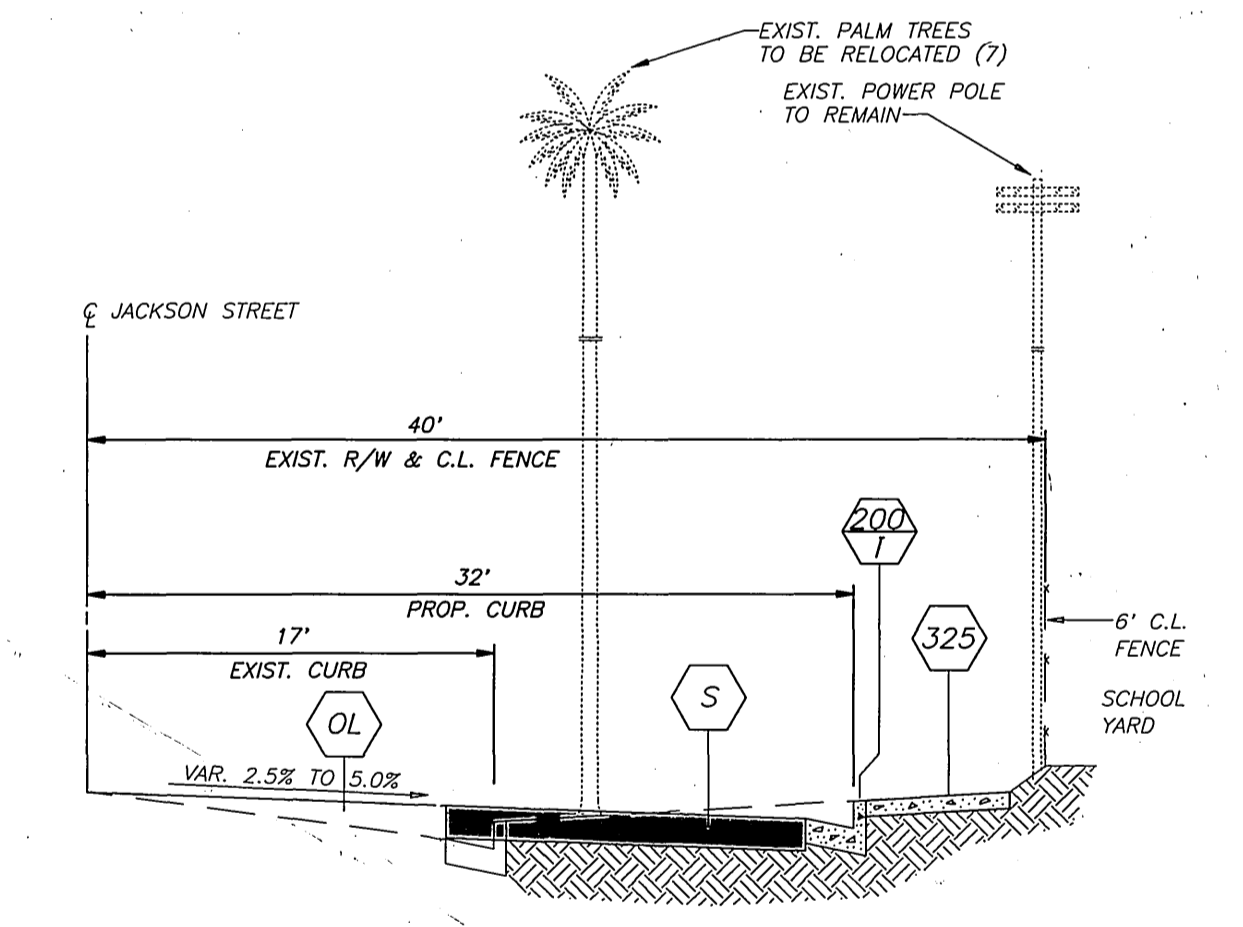

TYPICAL SECTION - STA. 134+79.32 TO 136+79.32
N.T.S.

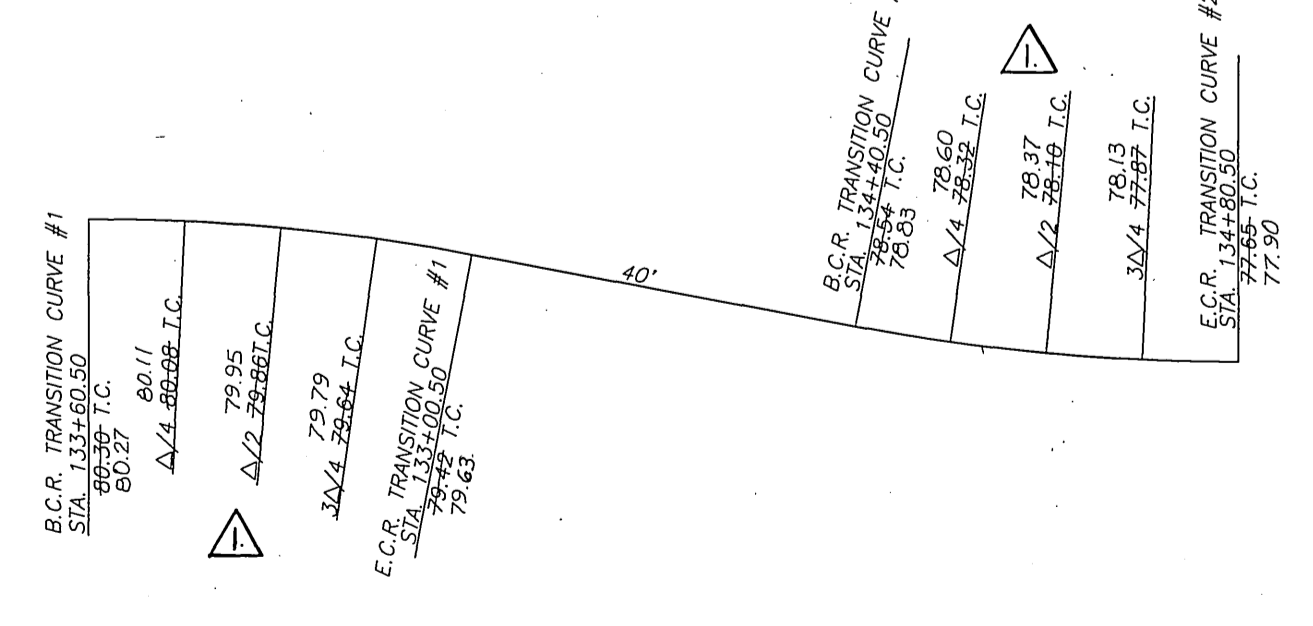

TRANSITION CURB DETAIL
N.T.S.

BENCHMARK
601-22-68, CSDH BRONZE DISK
IN CONC. POST IN METAL WELL
AT INTERSECTION OF JACKSON ST.
AND DANNA ST.
ELEVATION 821.737'

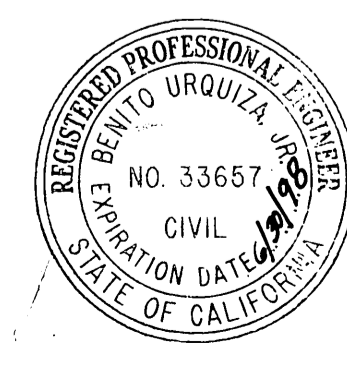

ENGINEER IN RESPONSIBLE CHARGE
Ben Urquiza
BEN URQUIZA
R.C.E. No. 33657 expires 6/30/98
DATE 5/27/97

MARK	REVISIONS	APPR.	DATE
△	REVISED PROFILE		9/25/97

**CITY OF RIVERSIDE, CALIFORNIA
PUBLIC WORKS DEPARTMENT**

APPROVED BY: *Danny Bell*
DATE: 5/29/97

**JACKSON STREET
RIGHT TURN LANE
MAGNOLIA AVE. TO
340' S'LY**

AS BUILT 12/11/98 RUM
ACCT. NO.: 432-541500-440302-30347
R-3413
SHEET 1 OF 1
FILE NO.