

RIVERSIDE CITY OF RIVERSIDE CALIFORNIA

PUBLIC WORKS DEPARTMENT

REHABILITATION OF ARTERIAL STREETS 1995-1996 STPL -5058 (035)

SPECIFIC CONSTRUCTION NOTES

- ① NUMBERS ABOVE 100 IN A HEXAGON ON THE PLAN REFER TO THE RESPECTIVE STANDARD DRAWING AND SHALL BE CONSTRUCTED ACCORDINGLY. UNLESS MODIFICATIONS ARE NOTED ON THE PLAN OR COVER SHEET, ANY NUMBER SHOWN BELOW THE STANDARD DRAWING NUMBER INDICATES THE SPECIFIC ALTERNATE TO BE CONSTRUCTED.
- ADJ ADJUST SEWER, STORM DRAIN, ELECTRIC OR WATER FACILITY FRAME AND COVER TO GRADE. ADJUSTMENT TO GRADE OR RELOCATION OF GAS AND TELEPHONE COMPANY'S FACILITIES WILL BE DONE BY OTHERS.
- ARHM 0.17 CONSTRUCT ASPHALT RUBBER HOT MIX GAP GRADED (ARHM-GG) OVERLAY. OVERLAY THICKNESS
- G1 GRIND EX. AC 0.05' BELOW GUTTER LIP OR ADJACENT PAVEMENT, "DAY-LIGHTING" IN A MIN. OF 5' (TYPE I GRINDING) EXCEPT AS SHOWN OTHERWISE ON PLAN AND DESCRIBED IN SPECIAL PROVISIONS.
- G2 0.27 GRIND EX. AC TO A UNIFORM DEPTH BELOW EX. AC SURFACE OR ADJACENT PCC GUTTER. DEPTH OF GRINDING
- MWD MANHOLE FRAME AND COVER TO BE ADJUSTED TO GRADE BY METROPOLITAN WATER DISTRICT. CONTRACTOR SHALL NOTIFY THE METROPOLITAN WATER DISTRICT AT (213) 250-6000 TO COORDINATE THE WORK.
- R&R 0.40 REMOVE AND REPLACE EX. AC PAVEMENT. PAVEMENT REPLACEMENT THICKNESS
- TDL B TRAFFIC DETECTOR LOOP INSTALLATIONS. NUMBER OF DETECTOR LOOPS
- TDL PIP PROTECT TRAFFIC DETECTOR LOOP INSTALLATIONS IN PLACE.
- TDF REMOVE ABANDONED TRAFFIC DETECTOR FRAME AND FOUNDATION.
- A INDICATES DETAIL
- 3 INDICATES SHEET NO.

GENERAL CONSTRUCTION NOTES

- ① CONSTRUCTION SHALL BE IN ACCORDANCE WITH THE CITY OF RIVERSIDE STANDARD DRAWINGS AND STANDARD SPECIFICATIONS FOR PUBLIC WORKS CONSTRUCTION 1994 EDITION AND 1995 SUPPLEMENT.
- ② EXISTING UTILITIES SHOWN ON THIS PLAN ARE PLOTTED FROM UTILITY RECORDS. THE CONTRACTOR IS REQUIRED TO TAKE DUE PRECAUTIONARY MEASURES TO LOCATE AND PROTECT ALL UTILITIES WHETHER OR NOT SHOWN ON THIS PLAN.
- ③ ALL ELEVATIONS SHOWN ON THE PLANS SHALL BE STAKED IN THE FIELD.
- ④ PRIME CONTRACTORS BIDDING THIS WORK SHALL HAVE A CLASS A OR C-12 LICENSE.
- ⑤ THE SEAM BETWEEN PASSES OF THE FINAL OVERLAY SHALL COINCIDE, AS CLOSE AS POSSIBLE, WITH THE LANE LINES.
- ⑥ AFTER REMOVAL OF CURB OR C&G FOR R&R LENGTHS GREATER THAN 50', THE CONTRACTOR SHALL SUBMIT A REQUEST FOR SURVEY AND SHALL ALLOW 4 WORKING DAYS FOR COMPLETION OF THE SURVEY AND THE ISSUANCE OF GRADE SHEETS.
- ⑦ CRACKS IN PAVEMENT WHICH ARE 1/8" AND LARGER SHALL BE FILLED WITH A RUBBERIZED ASPHALT MATERIAL PRIOR TO APPLICATION OF THE ARHM. (SEE SPECIAL PROVISIONS).
- ⑧ MANHOLES AND VALVES WITHIN THE GRINDING OR PAVEMENT REPLACEMENT LIMITS SHALL NOT BE ADJUSTED TO GRADE. INSTEAD, ENOUGH GRINDING (OR PVMT. REMOVAL BY OTHER MEANS) SHALL BE DONE TO PROVIDE A SMOOTH FINISHED SURFACE TRANSITION AROUND THE COMPLETE CIRCUMFERENCE OF THE STRUCTURE AS NOTED PER PLAN. EXCEPTIONS TO THIS ARE WHERE MH'S AND VALVES ARE WITHIN PVMT. REMOVAL AREAS, BUT ARE TOO CLOSE (WITHIN 3') TO THE ADJACENT PROPOSED A.C. OVERLAY.
- ⑨ PULL BOXES FOR SPLICING TRAFFIC LOOP DETECTOR CONDUCTORS AND LEAD-IN CABLE ARE NORMALLY ADJACENT TO DETECTORS, UNLESS OTHERWISE SHOWN ON THE PLAN.
- ⑩ RESURFACING LIMITS SHOWN AT INTERSECTIONS ARE NOT ABSOLUTE. THE INSPECTOR MAY REQUEST GRINDING AND PAVING INTO SIDE STREETS TO IMPROVE RIDE QUALITY AND OTHER STREET CONDITIONS.
- ⑪ PLANS DO NOT TYPICALLY INDICATE LOCATIONS OF WATER VALVES OR FIRE HYDRANTS TO SIMPLIFY PLAN PREPARATION EFFORT; HOWEVER, THESE FACILITIES MUST BE LOCATED DURING CONSTRUCTION TO MAKE VALVE BOX ADJUSTMENTS AND BLUE HYDRANT MARKER INSTALLATIONS. THE VALVE BOXES MUST BE "TIED OUT" AS PART OF THE CONTRACTORS WORK.
- ⑫ PAVEMENT PREPARATION CONSISTS OF R&R OF DETERIORATED PAVEMENT AREAS AS DETERMINED BY THE INSPECTOR. THESE AREAS ARE TYPICALLY SEVERAL HUNDRED FEET IN LENGTH AND VARYING IN WIDTH (6' MINIMUM). SOME SMALLER ISOLATED AREAS MAY ALSO REQUIRE R&R.

EXISTING UNDERGROUND & TOPOGRAPHY LEGEND

EXISTING UNDERGROUND UTILITIES:

| | | | |
|-------------------|---------------|----------------------|-----|
| SANITARY SEWER | 8" S | TELEPHONE CONDUIT | T |
| WATER LINE | 6" W | ELECTRICAL CONDUIT | E |
| STORM DRAIN | 24" SD | ELECTROLIGHT CONDUIT | ELC |
| GAS LINE | 3" G | TRAFFIC SIGNAL | SIG |
| ABANDONED UTILITY | 6" G (ABAND.) | FIRE ALARM | F |

EXISTING TOPOGRAPHY:

| | | |
|------------------|-----------------------------------|---|
| BLOCK WALL | POLE & GUY ANCHOR | PEDESTRIAN PUSH BUTTON |
| BOARD FENCE | POWER POLE | RAILROAD TRACKS |
| WIRE FENCE | TELEPHONE POLE | RAILROAD SIGNAL |
| CHAIN LINK FENCE | TELEPHONE RISER | TRAFFIC SIGNAL |
| | JOINT USE POLE | TRAFFIC SIGNAL ON MAST ARM |
| | PULL BOX | TRAFFIC SIGNAL CONTROLLER |
| | TRAFFIC SIGN | TRAFFIC SIGNAL PRESSURE DETECTOR |
| | PARKING METER | TRAFFIC SIGNAL LOOP DETECTOR |
| | FIRE ALARM BOX | STREET LIGHT & TRAFFIC SIGNAL ON MAST ARM |
| | STREET NAME SIGN | STREET LIGHT (UPRIGHT) |
| | GAS METER | STREET LIGHT ON MAST ARM |
| | MAIL BOX | STEEL POST |
| | FAUCET | WOOD POST |
| | AIR VENT | |
| | WALK-DON'T WALK PEDESTRIAN SIGNAL | |
| | BUS STOP SIGN | |
| | BLOW-OFF VALVE | |
| | IRRIGATION STAND PIPE | |
| | CONCRETE | |
| | ASPHALT | |
| | BUILDING | |
| | EDGE OF PAVEMENT | |

CONSTRUCTION LEGEND

| | |
|----------------------|-----|
| CENTER LINE | C |
| RIGHT-OF-WAY | R/W |
| SUBDIVISION LOT LINE | PL |

| STREET | LIMITS | TRAFFIC INDEX | LENGTH | SH. NO. |
|--------------------|------------------------|---------------|-------------------|---------|
| ① CALIFORNIA AVE. | MONROE TO JEFFERSON | 8.0 | 5,450' - 1.0 MILE | 2 & 3 |
| ② CANYON CREST DR. | CENTRAL TO MONTE VISTA | 8.5 | 2,369' - 0.4 MILE | 4 |
| ③ MARKET STREET | FIRST TO FOURTEENTH | 8.5 | 5,234' - 1.0 MILE | 5 & 6 |
| ④ VAN BUREN BLVD. | RUDISILL TO INDIANA | 9.0 | 685' - 0.1 MILE | 7 |

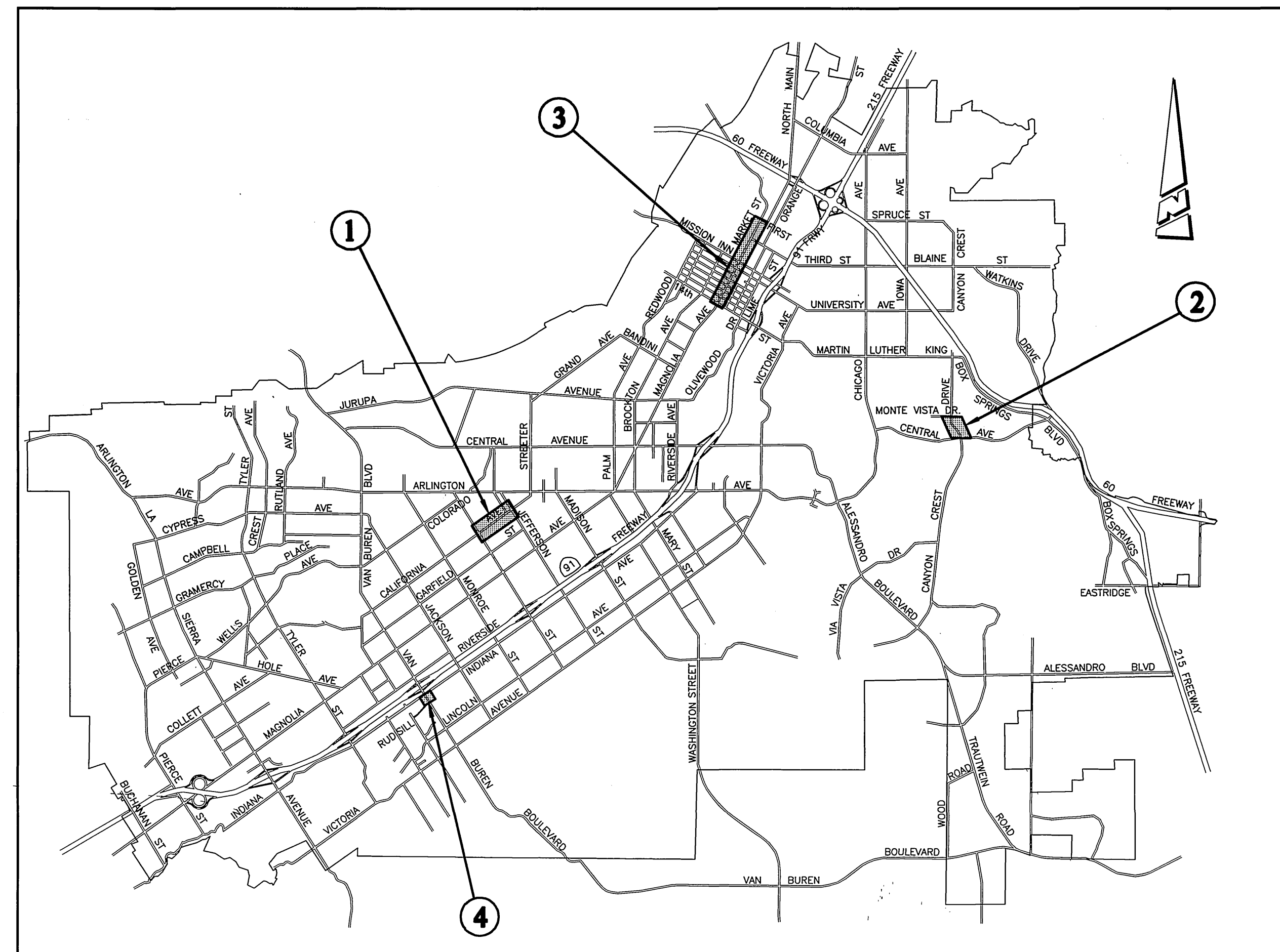

PROJECT LOCATION PLAN

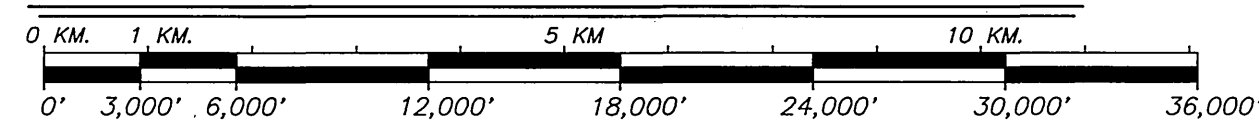

SCALE: 1" = 6,000'

| STREET | T.I. | R-VALUE | SECTION |
|---------------------|------|---------|-----------------------|
| CALIFORNIA AVENUE | 8.0 | 29 | 0.20' ARHM/0.40' DGAC |
| CANYON CREST DRIVE | 8.5 | 70 | 0.10' ARHM/0.20' DGAC |
| MARKET STREET | 8.5 | 16 | 0.10' ARHM/0.75' DGAC |
| VAN BUREN BOULEVARD | 9.0 | 64 | 0.10' ARHM/0.30' DGAC |

IMPORTANT NOTICE
Section 4216/4217 of the Government Code requires a Dig Alert Identification Number to be placed before a "Permit to Excavate" will be issued. For your Dig Alert I.D. Number call CALL TOLL FREE TWO WORKING DAYS BEFORE YOU DIG UNDERGROUND SERVICE ALERT 1-800-422-4133

ENGINEER IN RESPONSIBLE CHARGE
Ronald C. Mueller
R.C.E. No. 29510 expires 3/31/99
DATE 5-29-96

REGISTERED PROFESSIONAL ENGINEER
RONALD C. MUELLER
No. 29510
Exp. 3-31-99
CIVIL
STATE OF CALIFORNIA

MARK REVISIONS APPR. DATE
DESIGNED BY: RVZ DRAWN BY: RUM CHECKED BY: RCM

CITY OF RIVERSIDE, CALIFORNIA
PUBLIC WORKS DEPARTMENT
APPROVED BY: [Signature]
DEPUTY P.W. DIRECTOR
PRINCIPAL ENGINEER
CHIEF P.W. INSPECTOR
SUPERVISOR
TRAFFIC DIVISION
PARKS DEPARTMENT

REHABILITATION OF ARTERIAL STREETS
STPL -5058 (035) 1995-96
AS BUILT 9/12/97 RUM
ACCT. NO. 432-541500-440125-30037
R-3418
SHEET 1 OF 7

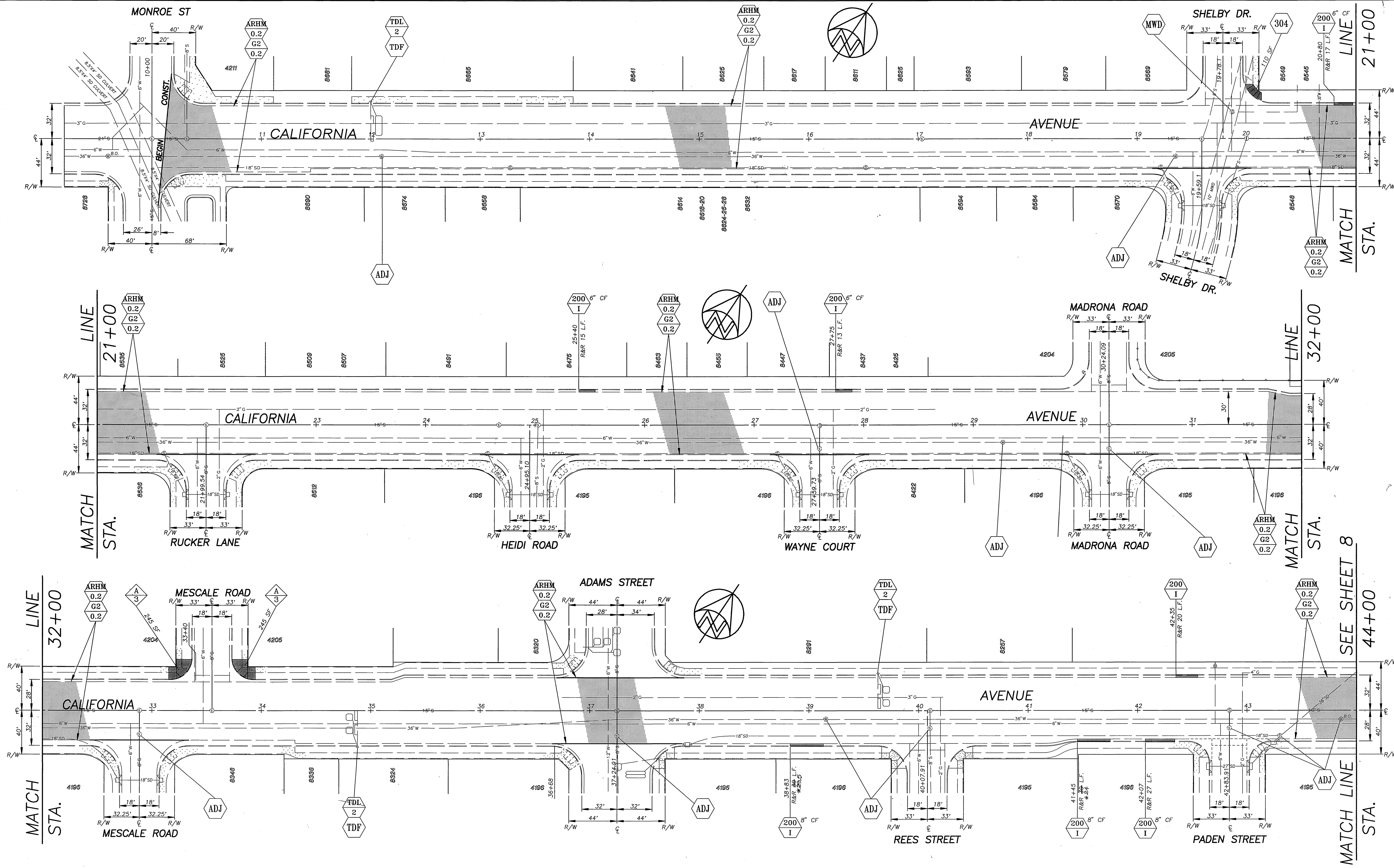

| QUANTITIES FOR CALIFORNIA AVENUE | | | |
|---|------------|-----------------------------------|-------------|
| ITEM | QUANTITY | ITEM | QUANTITY |
| COLD MILLING, TYPE II | 302,032 SF | CONSTRUCT PCC SIDEWALK | 2,880 SF |
| ADJUST WATER M.H. TO GRADE | 7 EA. | TACK COAT | 1,678 GALS. |
| ARHM-GG | 4,530 TONS | TRAFFIC SIGNAL LOOPS | 8 EA. |
| R&R C&G, STD. 200-1 (6" CF) | 139 LF | REMOVE TRAFFIC SIGNAL FOUNDATION | 7 EA. |
| R&R C&G, STD. 200-1 (8" CF) | 172 LF | RAISED PAVEMENT MARKERS | 14 EA. |
| ADJUST SEWER & S.D. M.H. FRAME & COVER TO GRADE | 10 EA. | PAVEMENT PREPARATION (0.4" THICK) | |
| ADJUST WATER GATE VALVE COVER TO GRADE | 45 EA. | A.C. REMOVAL | 1,254 CY |
| | | A.C. REPLACEMENT (DGAC) | 2,538 TONS |

ENGINEER IN RESPONSIBLE CHARGE
Ronald C. Mueller
 RONALD C. MUELLER
 R.C.E. No. 29510 expires 3/31/99
 DATE 5-22-96



DESIGNED BY RVZ DRAWN BY RJM CHECKED BY PEM

CITY OF RIVERSIDE, CALIFORNIA
 PUBLIC WORKS DEPARTMENT

APPROVED BY: *Barry Bell*
 PUBLIC WORKS DIRECTOR
 DATE: 6/3/96

REHABILITATION OF ARTERIAL STREETS
 STPL -5058 (035) 1995-96

CALIFORNIA AVENUE
 MONROE STREET TO JEFFERSON STREET

HORIZ. SCALE: 1" = 40'

* AS BUILT 8/12/97 AM
 ACCT. NO. 430-541500-440301-30037

R-3418
 SHEET 2 OF 7
 FILE NO.

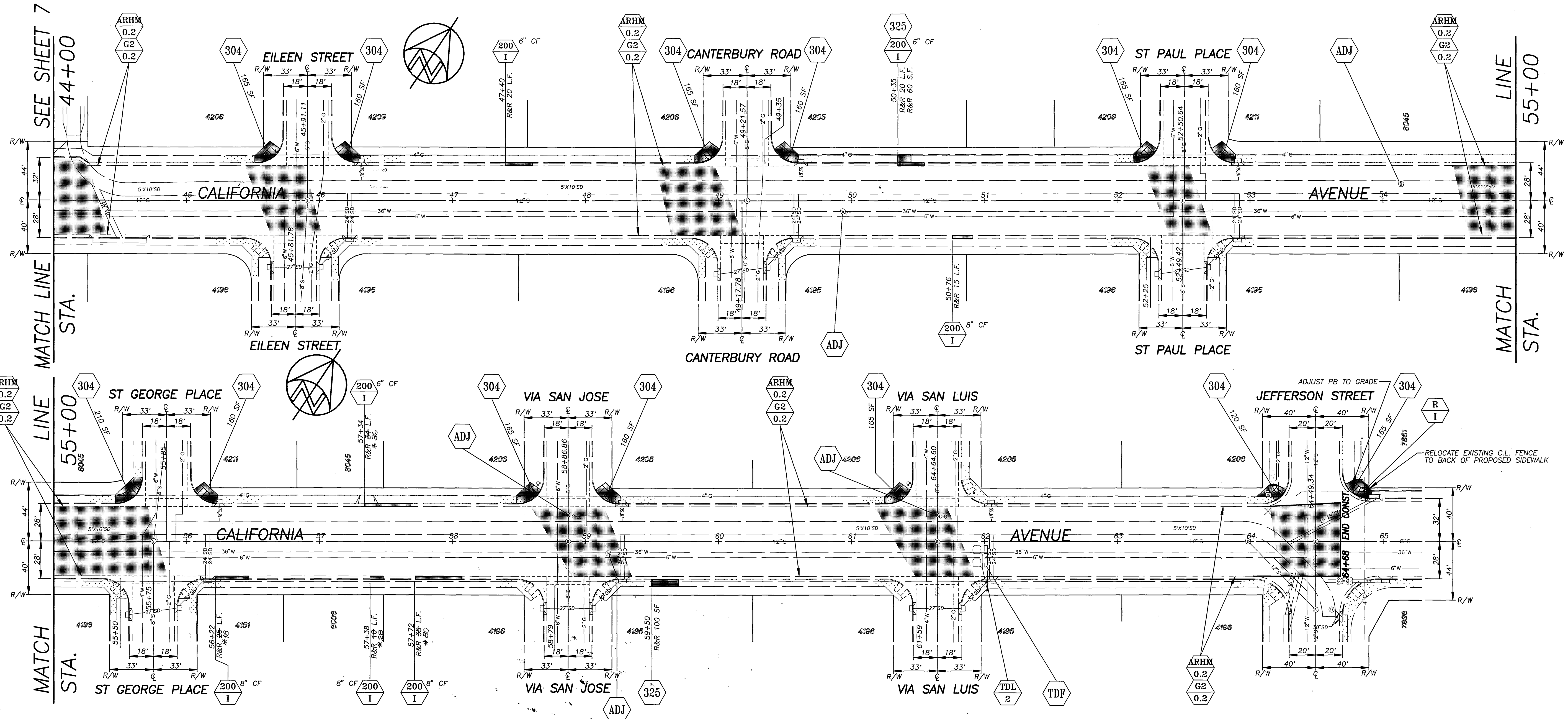

CONCRETE CROSS-GUTTERS AND SPANDRELS SHOWN AS ON THE PLANS, HAVE BEEN OVERLAYED WITH A VARIABLE THICKNESS OF AC. CONTRACTOR SHALL MAINTAIN EXISTING AC, IN PLACE, OVER THESE CROSS-GUTTERS AND SPANDRELS. (13 PLACES) COLD MILLING SHALL CONTINUE IN A STRAIGHT LINE BETWEEN GUTTER LIPS ON EACH SIDE OF THE INTERSECTION TO A DEPTH OF 0.10'.

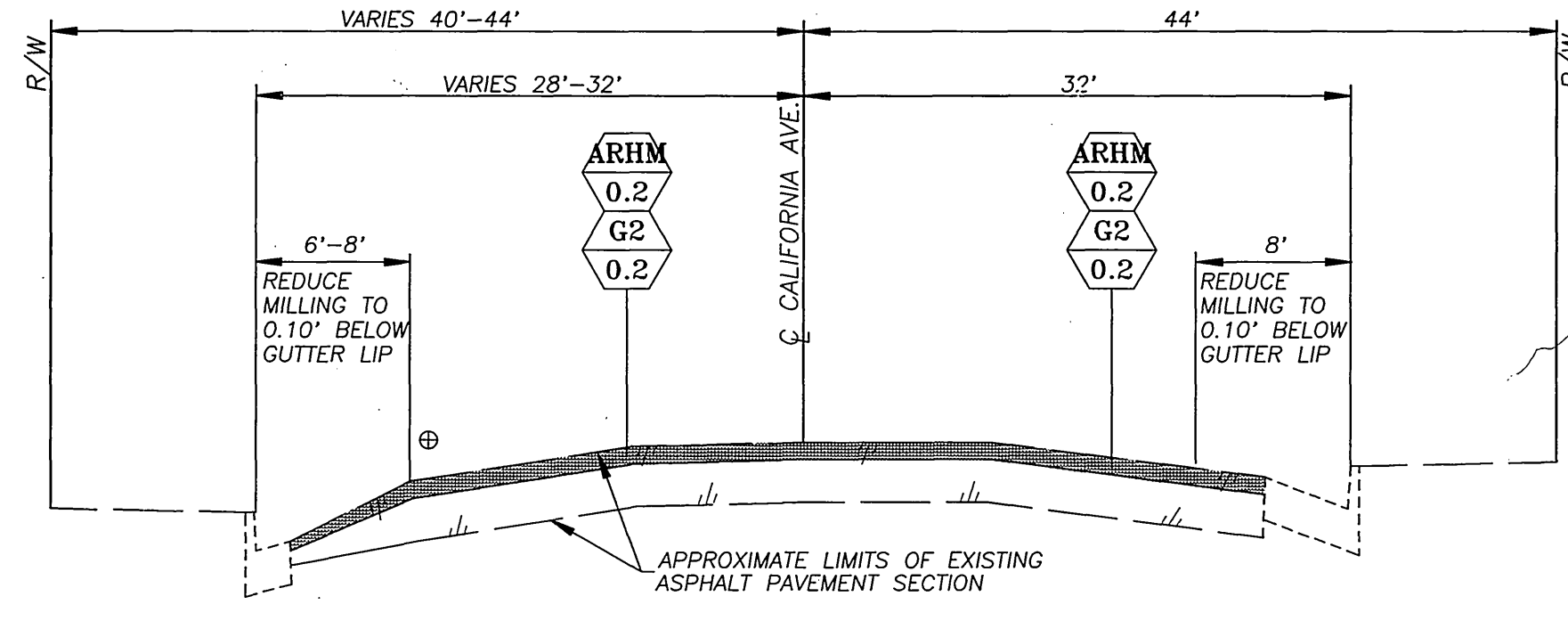
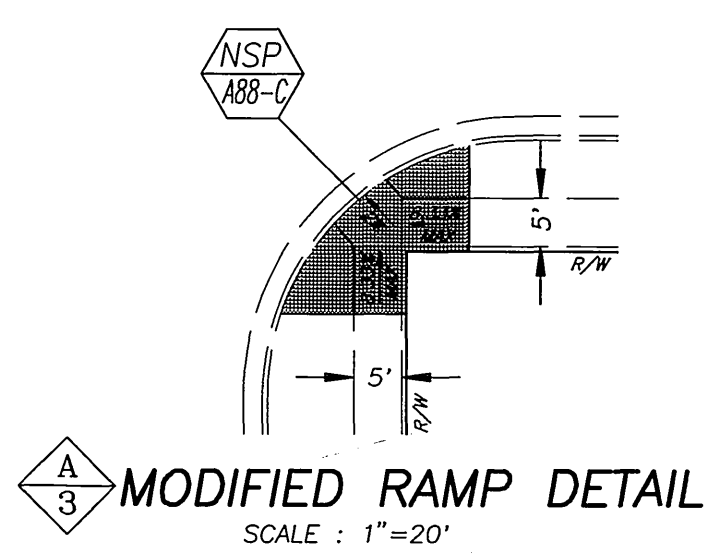

TYPICAL SECTION
SCALE: HORIZ. 1"=10'
VERT. 1"=2'

LEFT SIDE STA. 10+25± TO 35+25±
RIGHT SIDE STA. 11+25± TO 34+25±

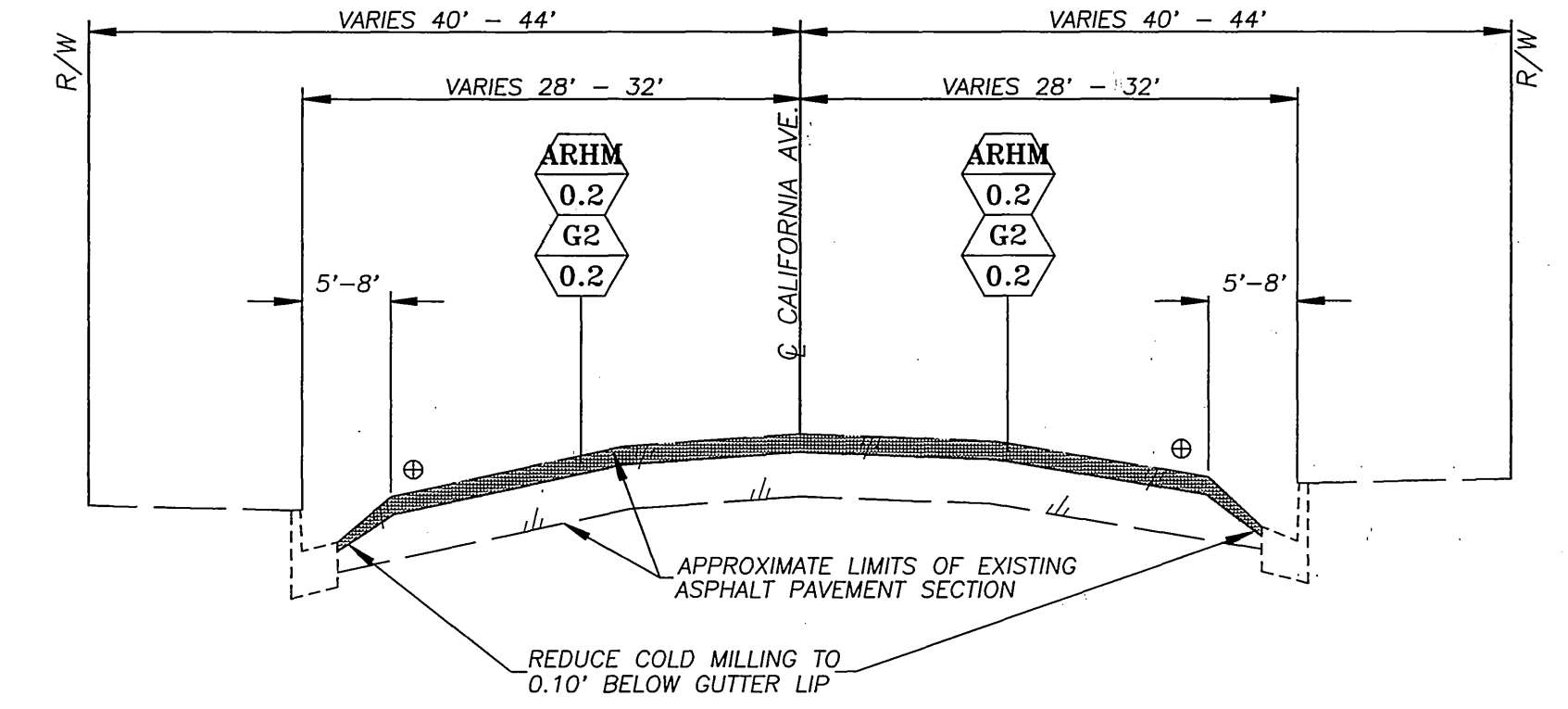

TYPICAL SECTION
SCALE: HORIZ. 1"=10'
VERT. 1"=2'

LEFT SIDE STA. 35+25± TO 64+00±
RIGHT SIDE STA. 34+25± TO 64+00±

ENGINEER IN RESPONSIBLE CHARGE
Ronald C. Mueller
R.C.E. No. 29510 expires 3/31/99
DATE 5-29-96



| | | | | | |
|-------------|-----|----------|-----|------------|-----|
| DESIGNED BY | RVZ | DRAWN BY | RJM | CHECKED BY | ACM |
| REVISIONS | | APPR. | | DATE | |

CITY OF RIVERSIDE, CALIFORNIA
PUBLIC WORKS DEPARTMENT
APPROVED BY: [Signature]
DATE: 6/5/96

REHABILITATION OF ARTERIAL STREETS
STPL -5058 (035) 1995-96
CALIFORNIA AVENUE
MONROE STREET TO JEFFERSON STREET

ACCT. NO. 430-541500-440301-30037
R-3418
SHEET 3 OF 7
FILE NO.

INDEXED 2-11-97 LTH

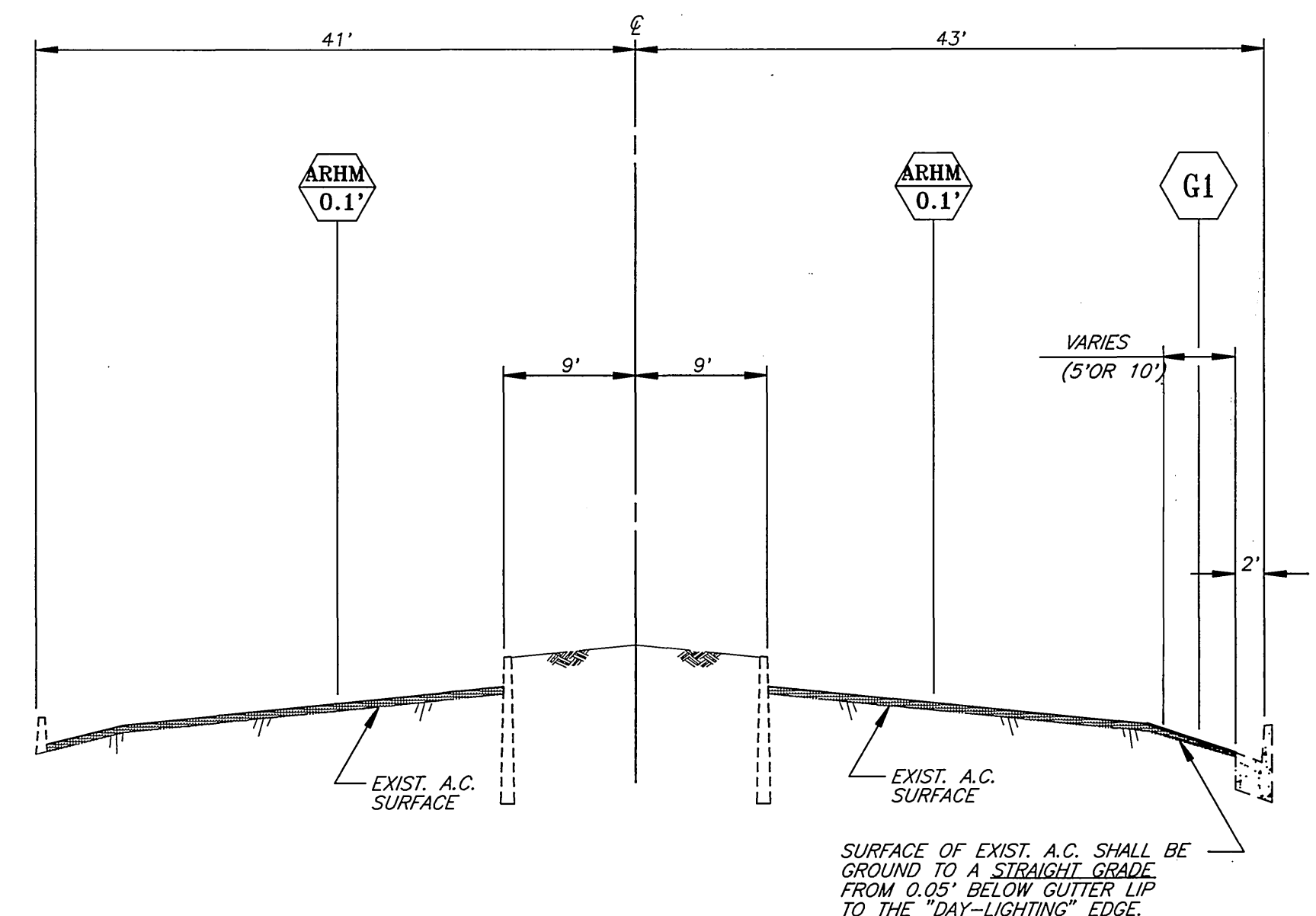
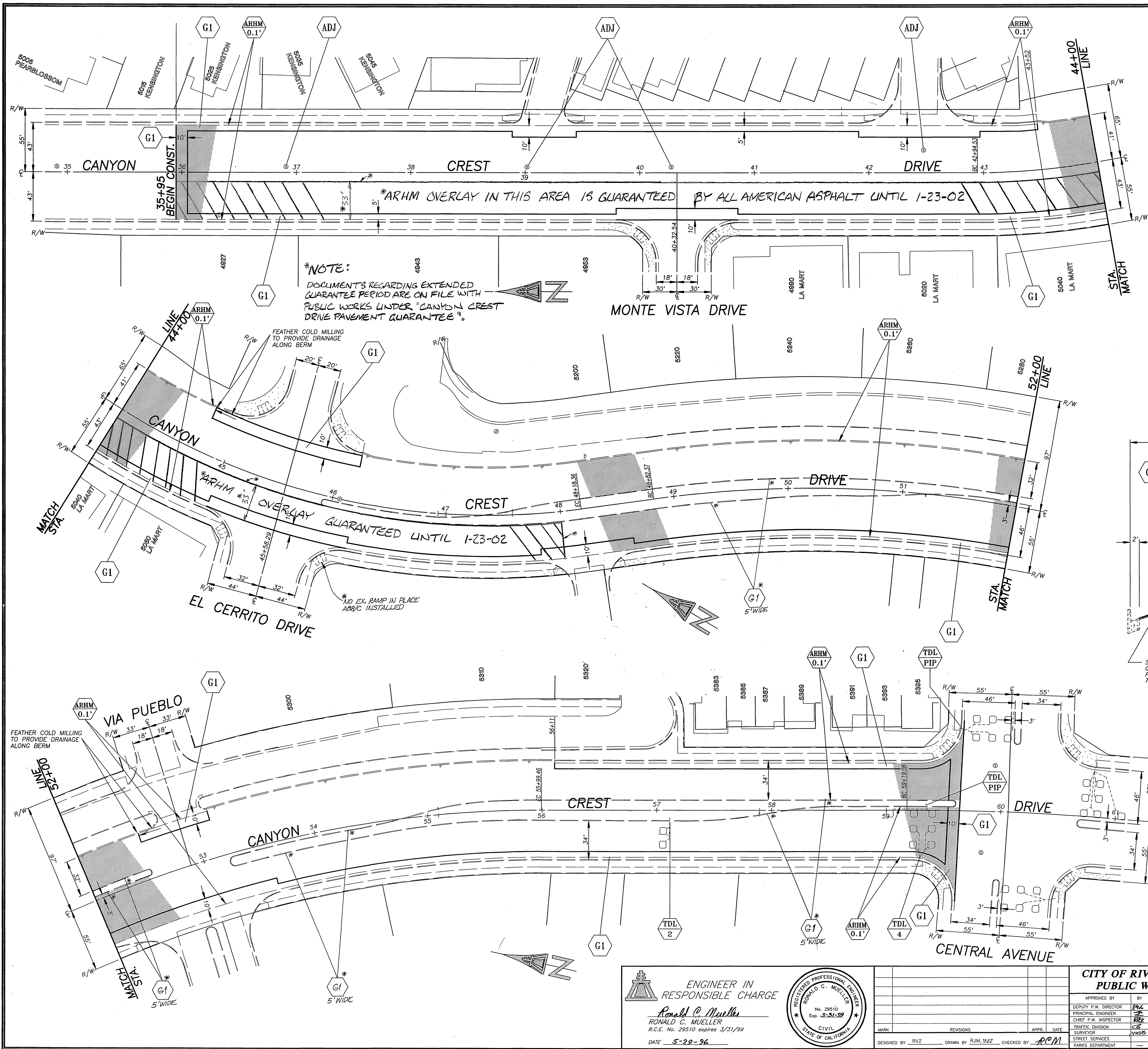

TYPICAL SECTION CANYON CREST DRIVE
 STA. 46+00± TO 59+65±
 SCALE: HORIZ. 1" = 10'
 VERT. 1" = 2'

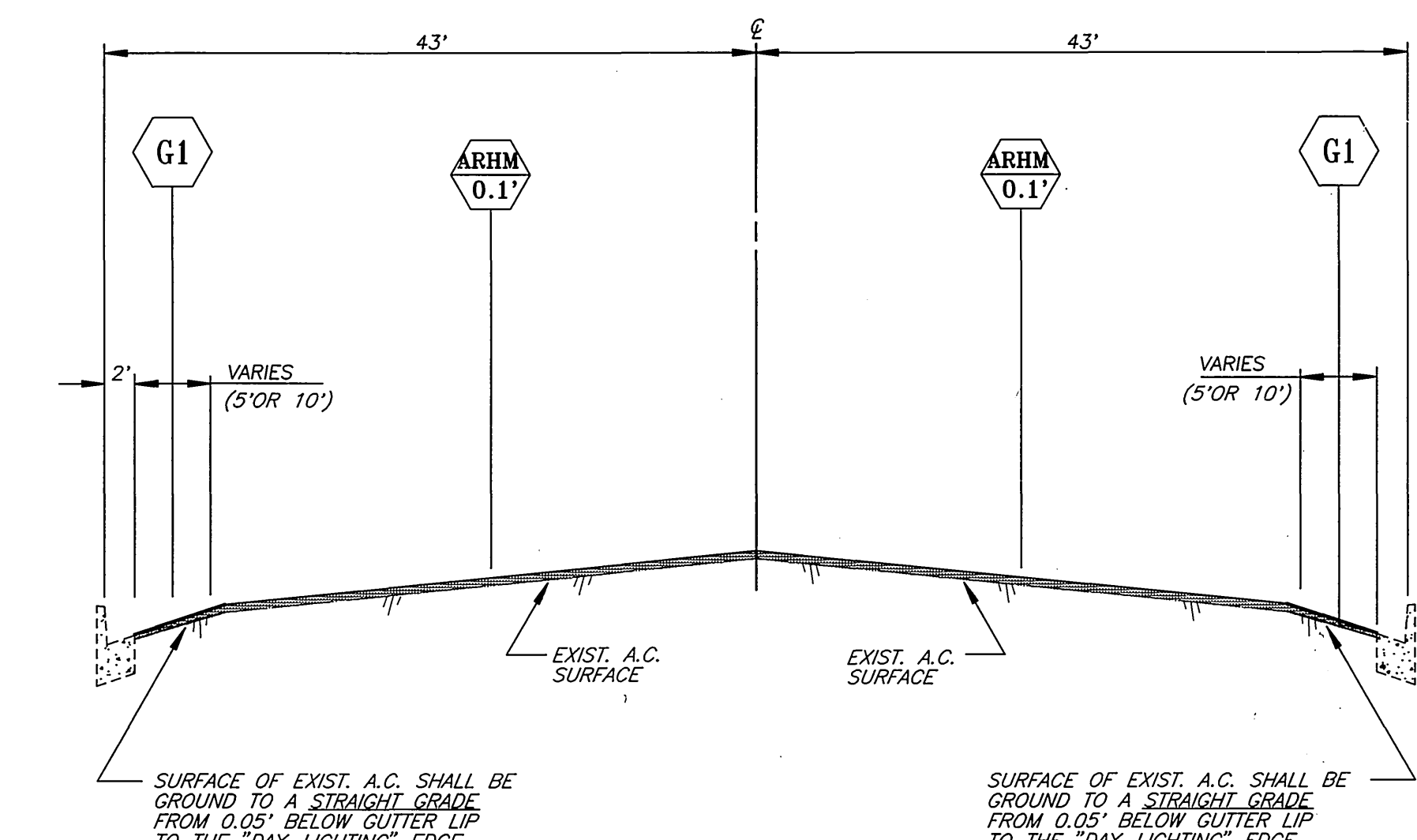

TYPICAL SECTION CANYON CREST AVE.
 STA. 35+95± TO 46+00±
 SCALE: HORIZ. 1" = 10'
 VERT. 1" = 2'

*AS BUILT 9/12/97 R/W

| QUANTITIES FOR CANYON CREST DRIVE | | | |
|---|------------|------------------------------------|------------|
| ITEM | QUANTITY | ITEM | QUANTITY |
| COLD MILLING, TYPE 1 (5' WIDE) | 2,860 LF | CRACK FILL | 8,000 LF |
| COLD MILLING, TYPE 1 (10' WIDE) | 994 LF | CRACK REPAIR | 1,400 LF |
| ASPHALT RUBBER HOT MIX | | TACK COAT | 997 GAL. |
| GAP GRADED | 1,615 TONS | TRAFFIC SIGNAL LOOPS | 6 EA. |
| ADJUST SEWER & S.D. M.H. FRAME & COVER TO GRADE | 4 EA. | RAISED PAVEMENT MARKERS | 4 EA. |
| ADJUST WATER GATE VALVE COVER TO GRADE | 9 EA. | PAVEMENT PREPARATION (0.20" THICK) | 526 CY |
| | | A.C. REMOVAL | 1,067 TONS |
| | | A.C. REPLACEMENT (DGAC) | |

ENGINEER IN RESPONSIBLE CHARGE
 Ronald C. Mueller
 R.C.E. No. 29510 expires 3/31/99
 DATE 5-29-96

CITY OF RIVERSIDE, CALIFORNIA
 PUBLIC WORKS DEPARTMENT

APPROVED BY: [Signature]
 DEPUTY P.W. DIRECTOR

APPROVED BY: [Signature]
 PUBLIC WORKS DIRECTOR

DATE: 6/5/96

REHABILITATION OF ARTERIAL STREETS
 STPL -5058 (035) 1995-96

CANYON CREST DRIVE
 437 N OF MONTE VISTA TO CENTRAL AVENUE

HORIZ. SCALE: 1" = 40'

ACCT. NO. 432-541500-440125-30037

R-3418

SHEET 4 OF 7

FILE NO.

INDEXED 2-11-97 4H

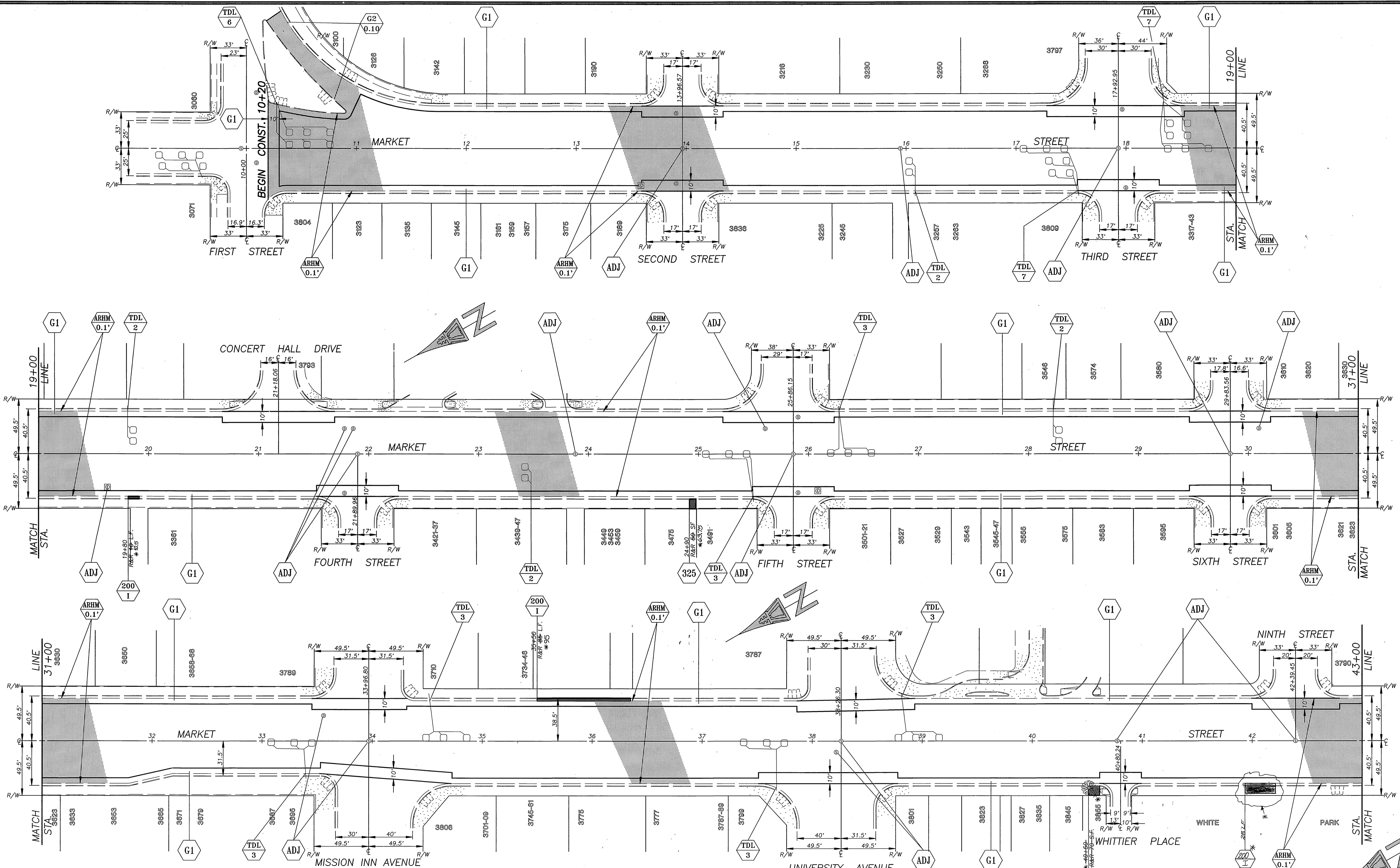

QUANTITIES FOR MARKET STREET

| ITEM | QUANTITY | ITEM | QUANTITY |
|---|------------|------------------------------------|-------------|
| COLD MILLING, TYPE I (5' WIDE) | 8,292 LF | CRACK FILLING | 23,460 LF |
| COLD MILLING, TYPE I (10' WIDE) | 2,134 LF | CRACK REPAIR | 1,500 LF |
| COLD MILLING, TYPE I I | 1,759 SF | R&R C&G, STD. 200-1 (6" CF) | 332 LF |
| ARHM-GG | 3,626 TONS | CONSTRUCT PCC SIDEWALK | 120 SF |
| ADJUST ELECTRIC MANHOLE | 4 EA | ADJUST WATER MANHOLE | 1 EA |
| ADJUST ELECTRIC VAULT | 1 EA | FRAME & COVER TO GRADE | |
| RAISED PAVEMENT MARKERS | 16 EA | TACK COAT | 2,239 GALS. |
| ADJUST SEWER & S.D. M.H. FRAME & COVER TO GRADE | 30 EA | TRAFFIC SIGNAL LOOPS | 55 EA |
| ADJUST WATER GATE VALVE COVER TO GRADE | 36 EA | PAVEMENT PREPARATION (0.75" THICK) | 332 LF |
| | | A.C. REMOVAL | 2,492 CY |
| | | A.C. REPLACEMENT (DGAC) | 5,047 TONS |

ENGINEER IN RESPONSIBLE CHARGE
Ronald C. Mueller
 RONALD C. MUELLER
 R.C.E. No. 29510 expires 3/31/99
 DATE 5-29-96



| MARK | REVISIONS | APPR. | DATE |
|------|-----------|-------|------|
| | | | |

**CITY OF RIVERSIDE, CALIFORNIA
 PUBLIC WORKS DEPARTMENT**

APPROVED BY: *[Signature]* DATE: 6/5/96
 DEPUTY P.W. DIRECTOR
 PRINCIPAL ENGINEER
 CHIEF P.W. INSPECTOR
 SUPERVISOR
 STREET SERVICES
 PARKS DEPARTMENT

**REHABILITATION OF ARTERIAL STREETS
 STPL -5058 (035) 1995-96**

**MARKET STREET
 FIRST STREET TO FOURTEENTH STREET**

HORIZ. SCALE: 1" = 40'

*AS BUILT 8/12/97 RUM
 ACCT. NO. 432-541500-440125-30037
R-3418
 SHEET 5 OF 7
 FILE NO.

INDEXED 2-11-97 JH

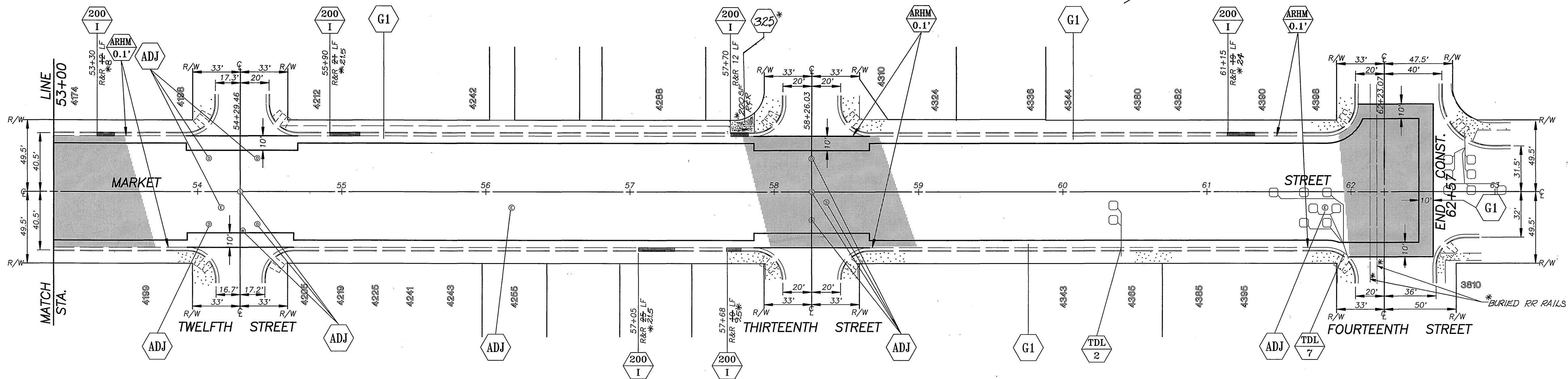
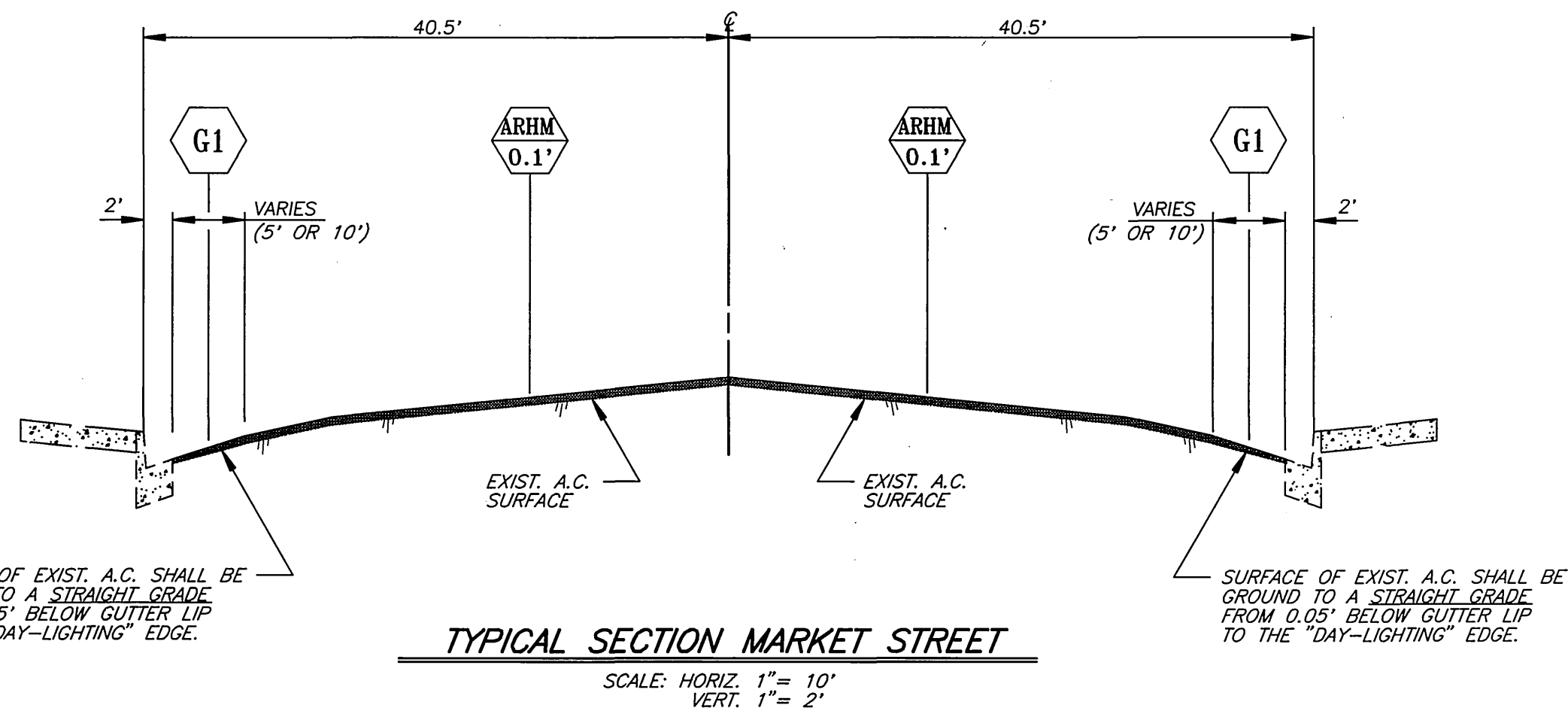
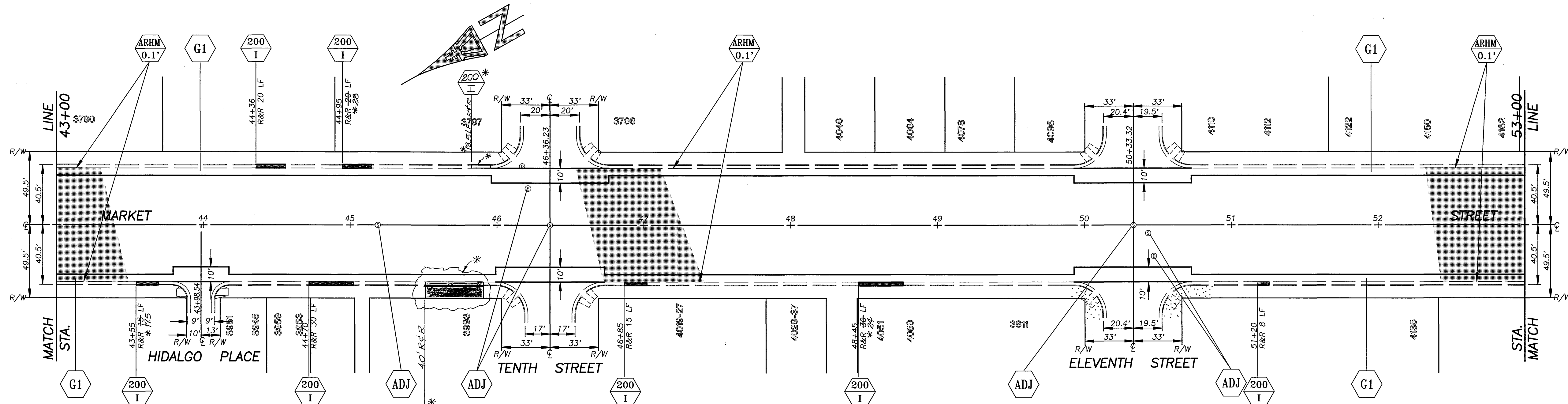

ENGINEER IN RESPONSIBLE CHARGE
Ronald C. Mueller
R.C.E. No. 28510 expires 3/31/99
DATE 5-29-96

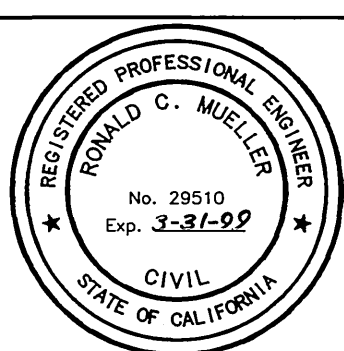

| MARK | REVISIONS | APPR. | DATE |
|------|-----------|-------|------|
| | | | |
| | | | |

CITY OF RIVERSIDE, CALIFORNIA
PUBLIC WORKS DEPARTMENT

| | | | |
|----------------------|-----|--------|-----------------------|
| APPROVED BY | BY | DATE | APPROVED BY |
| DEPUTY P.W. DIRECTOR | RVL | 4/1/96 | <i>Benjamin</i> |
| PRINCIPAL ENGINEER | RVL | 4/1/96 | PUBLIC WORKS DIRECTOR |
| CHIEF P.W. INSPECTOR | RVL | 4/1/96 | |
| SUPERVISOR | RVL | 4/1/96 | |
| STREET SERVICES | RVL | 4/1/96 | |
| PARKS DEPARTMENT | RVL | 4/1/96 | |

DESIGNED BY RVZ DRAWN BY RJM VLT CHECKED BY REM DATE 6/5/96

REHABILITATION OF ARTERIAL STREETS
STPL 5058 (035) 1995-96

MARKET STREET
FIRST STREET TO FOURTEENTH STREET

HORIZ. SCALE: 1" = 40'

AS BUILT 8/19/97 RJM
ACCT. NO. 432-541500-440125-30037

R-3418
SHEET 6 OF 7
FILE NO.

INDEXED 2-11-97 4/1

NOTE: THE ENTIRE PAVEMENT AREA BETWEEN STATION 16+00 AND STATION 17+28 SHALL BE REMOVED TO A DEPTH OF 0.40'. CONTRACTOR SHALL REPLACE THIS AREA WITH 0.10' ARHM OVER 0.30' DGAC. (SEE ROADWAY PROFILE BELOW)

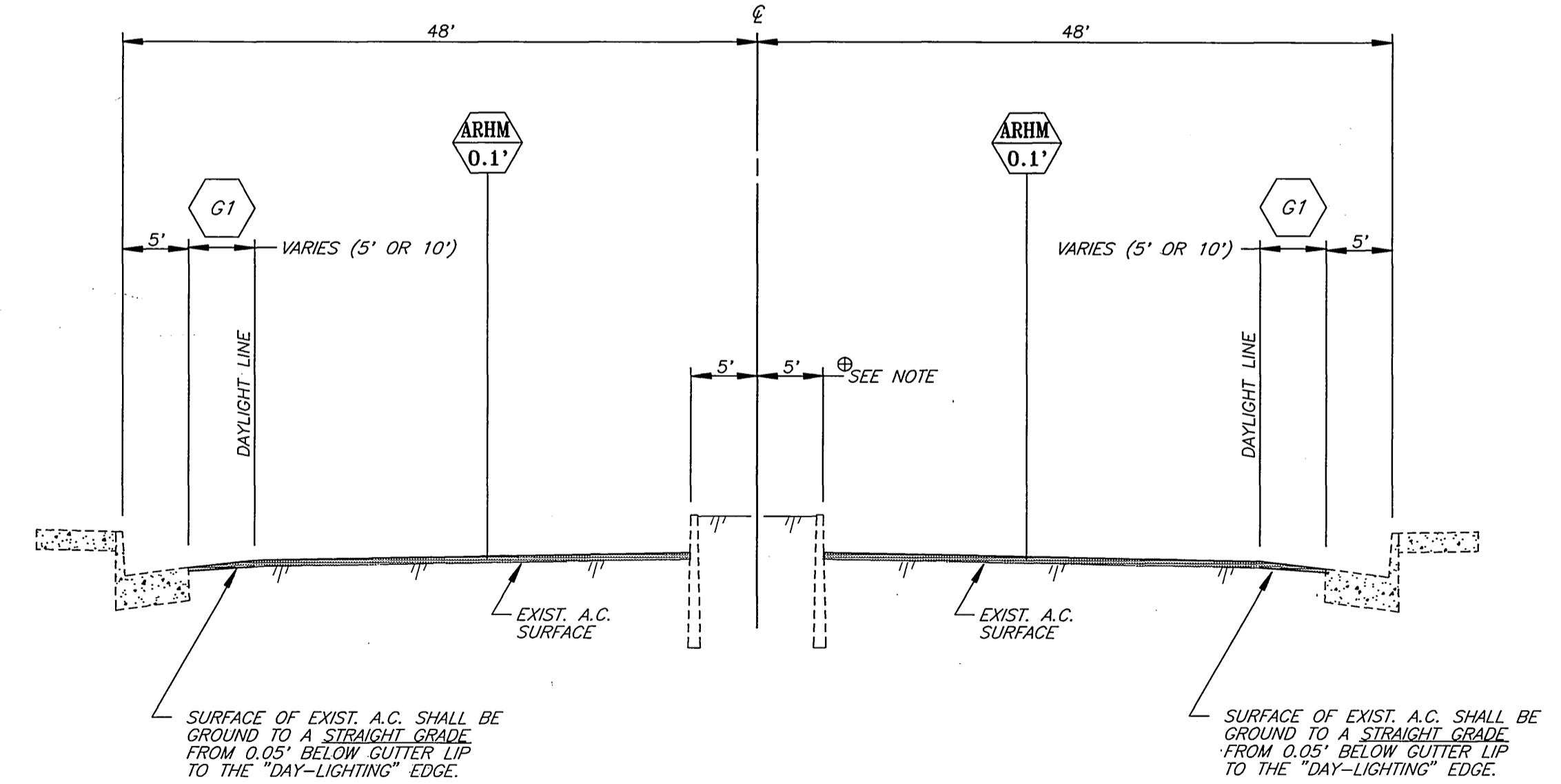
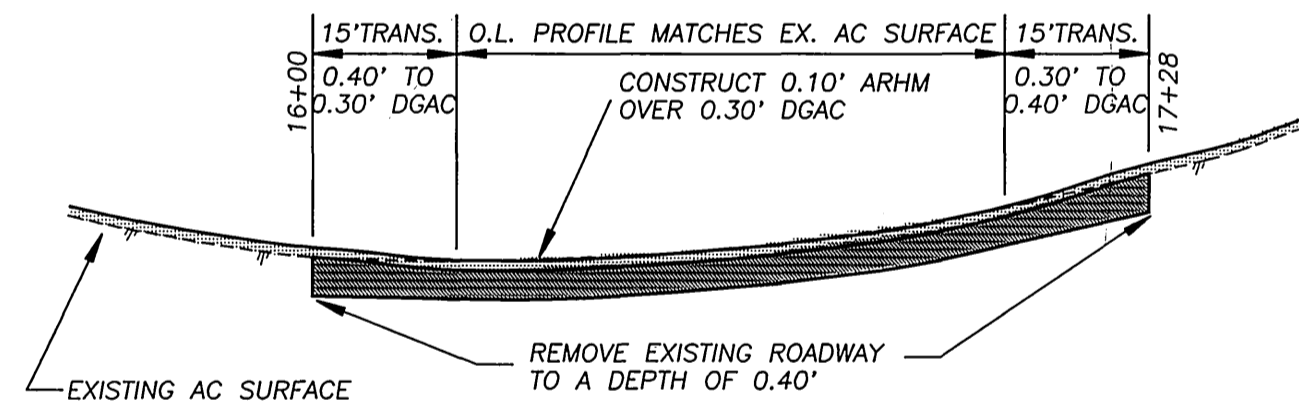
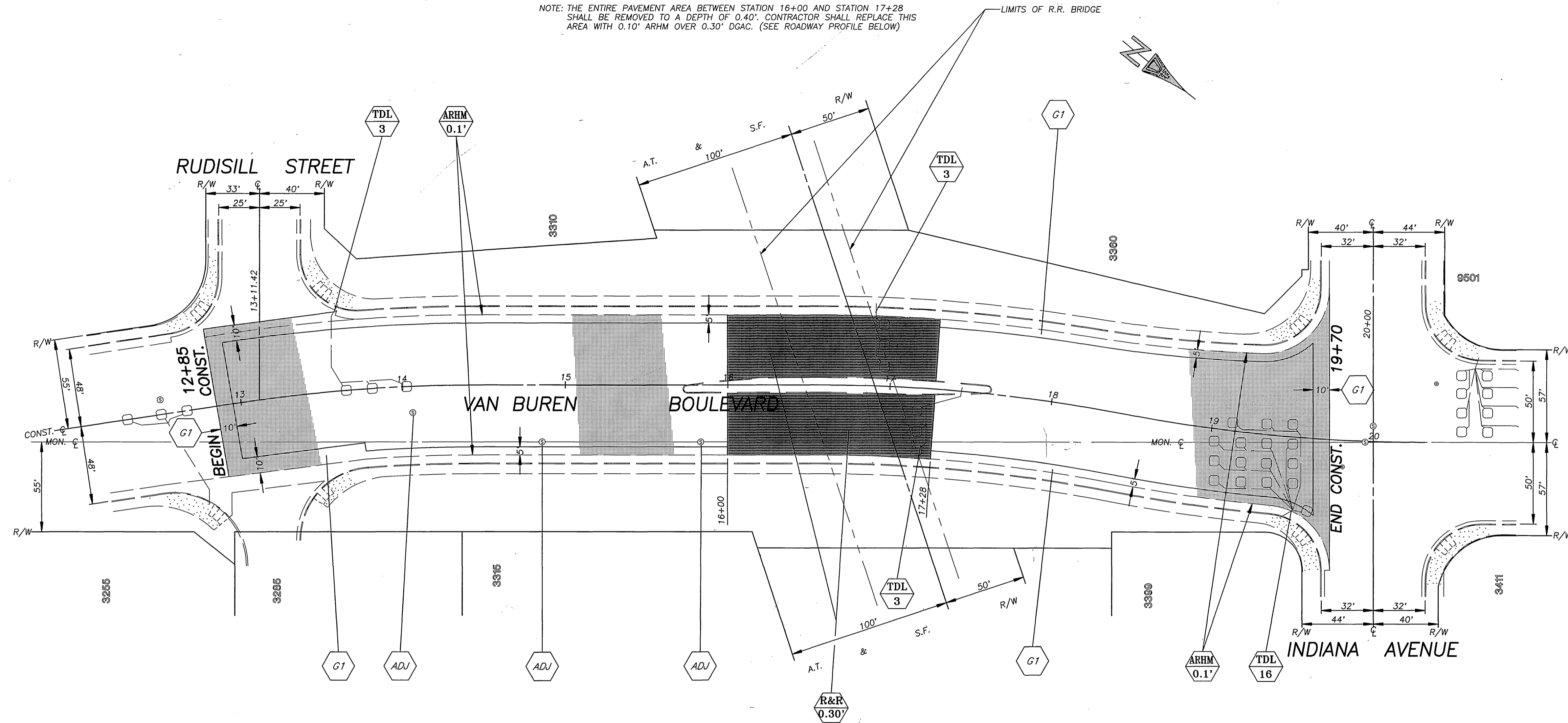

| QUANTITIES FOR VAN BUREN BOULEVARD | | | |
|---|----------|------------------------------------|-----------|
| ITEM | QUANTITY | ITEM | QUANTITY |
| COLD MILLING, TYPE 1 (5' WIDE) | 916 LF | | |
| COLD MILLING, TYPE 1 (10' WIDE) | 385 LF | | |
| RAISED PAVEMENT MARKERS | 2 EA. | | |
| ASPHALT RUBBER HOT MIX GAP GRADED | 525 TONS | | |
| CRACK FILLING | 2,740 LF | TACK COAT | 324 GALS. |
| D/W APPROACH PER STD. 302.1V | SF | TRAFFIC SIGNAL LOOPS | 25 EA. |
| ADJUST SEWER & S.D. M.H. FRAME & COVER TO GRADE | 3 EA. | PAVEMENT PREPARATION (0.30' THICK) | 234 CY |
| ADJUST WATER GATE VALVE COVER TO GRADE | 2 EA. | A.C. REMOVAL | 408 TONS |
| | | A.C. REPLACEMENT (DGAC) | |

ENGINEER IN RESPONSIBLE CHARGE
Ronald C. Mueller
RONALD C. MUELLER
R.C.E. No. 29510 expires 3/31/99
DATE 5-29-96

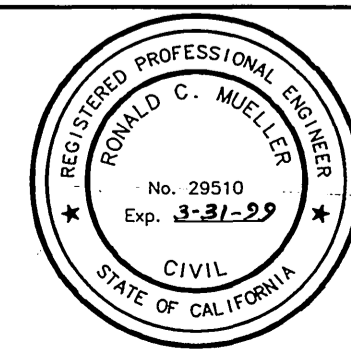

APPROVED BY: [Signature]
DATE: 5/15/96

DESIGNED BY: RVZ DRAWN BY: RJM, VLT CHECKED BY: RCM

CITY OF RIVERSIDE, CALIFORNIA
PUBLIC WORKS DEPARTMENT

APPROVED BY: [Signature]
DATE: 5/15/96

DEPUTY P.W. DIRECTOR
PRINCIPAL ENGINEER
CHIEF P.W. INSPECTOR
SUPERVISOR
STREET SERVICES
PARKS DEPARTMENT

REHABILITATION OF ARTERIAL STREETS
STPL -5058 (035) 1995-96

VAN BUREN BOULEVARD
RUDISILL STREET TO INDIANA AVENUE

HORIZ. SCALE: 1" = 40'

ACCT. NO. 432-541500-440125-30037

R-3418

SHEET 7 OF 7

FILE NO.

INDEXED 2-11-97 GH