

**PARK AND RECREATION NOTES:**

- ALL RELATED STREET TREE WORK SHALL CONFORM TO THE CITY OF RIVERSIDE PARK AND RECREATION DEPT. STANDARDS AND CITY OF RIVERSIDE STREET TREE POLICIES.
- WHEN CALLING FOR INSPECTIONS CONTACT THE STREET TREE INSPECTOR A MIN. OF 48 HOURS IN ADVANCE AT (909) 351-6126 TO SCHEDULE AN INSPECTION. A FIELD NOTICE WILL BE ISSUED AS WRITTEN APPROVAL FOR EACH STAGE OF INSPECTION. A VERBAL APPROVAL WILL NOT BE ACCEPTABLE. INSPECTIONS ARE REQUIRED:
  - AFTER COMPLETION OF FINAL GRADING OF THE LOTS AND WHEN ALL UTILITY SERVICES AND SEWER LATERALS HAVE BEEN MARKED, BUT PRIOR TO DIGGING PLANT PITS, ALL FINAL STREET TREE LOCATIONS ARE TO BE SPOTTED IN THE FIELD BY THE STREET TREE INSPECTOR.
  - WHILE DIGGING PLANT PITS AND PLANTING/RELOCATING TREES.
  - AFTER PLANTING AND ALL OTHER INDICATED OR SPECIFIED WORK HAS BEEN COMPLETED, FOR START OF MAINTENANCE.
  - AT END OF MAINTENANCE PERIOD, THE CONTRACTOR SHALL CALL THE STREET TREE INSPECTOR AT (909) 351-6126 FOR A FINAL ACCEPTANCE INSPECTION IN ORDER TO BE RELEASED FROM MAINTENANCE. CONTRACTORS BONDS WILL NOT BE RELEASED UNTIL AFTER RECEIPT OF WRITTEN NOTIFICATION FROM THE CITY THAT THE TREES PASS FINAL INSPECTION AND THE PARK AND RECREATION DEPT. IS ASSUMING MAINTENANCE RESPONSIBILITY.
- PALM TREE RELOCATIONS SHALL BE AS INDICATED ON PLANS. TREE TYPE AND QUANTITIES SHALL BE AS FOLLOWS:

STREET NAME	COMMON NAME BOTANICAL NAME	MIN. SIZE	APPROX. SPACING	NUMBER TRANSPLANTED
COMMERCE AVENUE	MEXICAN FAN PALM WASHINGTONIA ROBUSTA	RELOCATE FROM ONSITE	70'	# 5

- THE CONTRACTOR SHALL BE RESPONSIBLE FOR MAINTENANCE OF ALL PLANTINGS FOR A MINIMUM PERIOD OF ONE (1) YEAR, EXCEPT AS NOTED IN SPECIAL PROVISIONS.
- BOTH A STREET TREE RELOCATION/REMOVAL PERMIT AS ISSUED BY THE PARK AND RECREATION DEPARTMENT AND A STREET OPENING PERMIT AS ISSUED BY THE PUBLIC WORKS DEPARTMENT ARE REQUIRED PRIOR TO COMMENCEMENT OF TREE RELOCATION AND/OR REMOVAL WORK. FOR ALL EXISTING TREES WITHIN WHAT WILL ULTIMATELY BE THE PUBLIC RIGHT-OF-WAY PAVEMENT AREA, BACKFILL OF ALL HOLES MUST BE INSPECTED BY THE PUBLIC WORKS INSPECTOR FOR PROPER COMPACTION.

**CONSTRUCTION LEGEND:**

- NUMBERS ABOVE 100 IN A HEXAGON ON THE PLAN REFER TO THE RESPECTIVE STANDARD DRAWING AND SHALL BE CONSTRUCTED ACCORDINGLY; UNLESS MODIFICATIONS ARE NOTED ON THE PLAN. ANY NUMBER SHOWN BELOW THE STANDARD DRAWING NUMBER INDICATES THE SPECIFIC ALTERNATE TO BE USED.
- REMOVE RAILROAD RAILS AND TIES. CONSTRUCT STRUCTURAL SECTION OF EITHER 0.90" DGAC OVER NATIVE OR 0.25" ARHM-GG OVER 0.50" DGAC OVER NATIVE. T=10, R=40.
- CONSTRUCT STRUCTURAL SECTION OF EITHER 0.90" DGAC OVER NATIVE OR 0.25" ARHM-GG OVER 0.50" DGAC OVER NATIVE. T=10, R=40.
- PERFORM TYPE 2 GRINDING OF 0.20" THICKNESS AC PAVEMENT REMOVALS (SEE SPECIAL PROVISIONS) AND CONSTRUCT VARIABLE THICKNESS AC OVERLAY, 0.25" THICK MINIMUM OVERLAY MATERIAL TO BE EITHER ARHM-GG OR DGAC (SAME AS TYPE S1 FINAL CAP).
- ADJUST TO GRADE.
- REMOVE EXISTING DROP INLET.

**GENERAL CONSTRUCTION NOTES:**

- EXISTING UTILITIES SHOWN ON THE PLAN ARE PLOTTED FROM UTILITY RECORDS. THE CONTRACTOR IS REQUIRED TO TAKE DUE PRECAUTIONARY MEASURES TO LOCATE AND PROTECT ALL UTILITIES WHETHER OR NOT SHOWN ON THIS PLAN.
- PRIME CONTRACTORS BIDDING THIS WORK SHALL HAVE A CLASS "A" OR "C-12" LICENSE.
- ALL ELEVATIONS SHOWN ON THE PLANS SHALL BE STAKED IN THE FIELD. FINAL GRADES WILL BE DETERMINED AT TIME OF CONSTRUCTION.
- PUBLIC UTILITIES PLAN L5-1114**  
SEE SHEET FOR STREET LIGHT INSTALLATION DETAILS.
- CONSTRUCTION SHALL BE IN ACCORDANCE WITH THE CITY OF RIVERSIDE STANDARD DRAWINGS AND STANDARD SPECIFICATIONS FOR PUBLIC WORKS CONSTRUCTION, 1994 EDITION.
- CONFLICTING UTILITIES IN THE CONSTRUCTION AREA SHALL BE RELOCATED OR ABANDONED.

**SPECIFIC CONSTRUCTION NOTES:**

- CURB FACE SHALL BE 6" EXCEPT WHERE SHOWN.
- CITY FORCES SHALL INSTALL PERMANENT PAVEMENT DELINEATION, PAVEMENT MARKING, AND CURB PAINTING.
- CITY FORCES SHALL PERFORM WATER METER AND FIRE HYDRANT RELOCATIONS.
- APPROXIMATELY 10% OF THE EXISTING PAVEMENT WILL BE REMOVED FOR PAVEMENT REHABILITATION. REMOVAL AREAS SHALL BE SELECTED AT THE TIME OF CONSTRUCTION. REMOVALS MAY NOT BE CONTINUOUS. MINIMUM WIDTH = 6'. SEE SPECIAL PROVISIONS.
- CROSS CUTTER WIDTH SHALL BE 4"

# CITY OF RIVERSIDE



## COMMERCE STREET CUL-DE-SAC

### MISSION INN AVENUE TO NINTH STREET

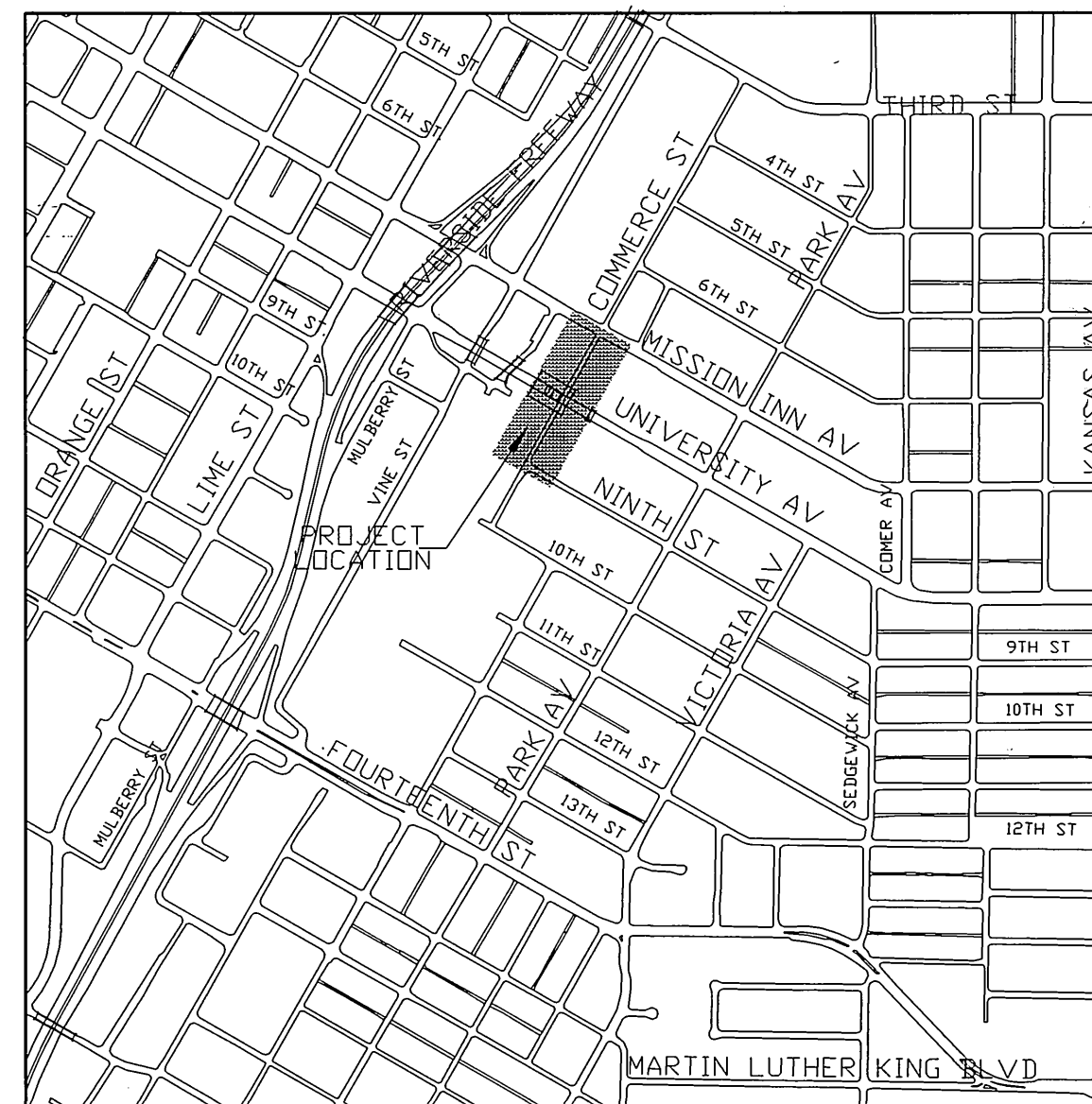

**PROJECT LOCATION PLAN**

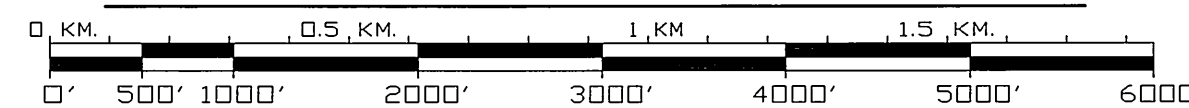

SCALE: 1"=1000'

**STREET LIGHT NOTES AND DETAILS**

- ALL FACILITIES INSTALLED BY THE CONTRACTOR SHALL BE INSPECTED AND APPROVED BY THE DEPARTMENT CONSTRUCTION INSPECTOR (PH. 782-5429). ANY CHANGES SHALL BE APPROVED BY THE DEPARTMENT PRIOR TO EXECUTION. THE CONTRACTOR SHALL BE RESPONSIBLE FOR COORDINATING ALL PHASES OF CONSTRUCTION WITH THE DEPARTMENT CONSTRUCTION INSPECTOR AND DEPARTMENT CONSTRUCTION SUPERINTENDANT (PH. 351-6173).
- PROVIDE, INSTALL, REMOVE, AND SALVAGE ALL STREET LIGHT FACILITIES SHOWN INCLUDING STREET LIGHT CABLE, AS SHOWN IN CONFORMANCE WITH THE FOLLOWING STANDARD DRAWINGS: UGS-800 STREET LIGHT SPECIFICATION #2-6.
- INSTALL A WATERPROOF "IN-LINE" FUSE HOLDER ON THE PHASE LEG CONDUCTOR(S) IN THE BASE OF EACH STREET LIGHT STANDARD. FUSE HOLDER TO BE "BUSMAN TRON" #HEB COMPATIBLE WITH SIZE AND TYPE OF WIRE WITH A "BUSMAN" FNM 10 AMP 250V FUSE OR APPROVED EQUAL.
- MARK INSTALLATION DATE ON PHOTO CONTROLS AND LAMPS AS PROVIDED FOR BY MFG.
- ACQUIRE A STREET OPENING PERMIT PRIOR TO EXCAVATION IN STREET RIGHT-OF-WAY.
- ALL STREET LIGHT FEED POINTS TO BE CONNECTED BY PUBLIC UTILITIES AND ENERGIZED WHEN CLEARED BY DEPARTMENT INSPECTOR.

THIS IS A TWO WIRE, 240-VOLT MULTIPLE SYSTEM.

**DETAILS FOR POST TOP STREET LIGHT** NO SCALE

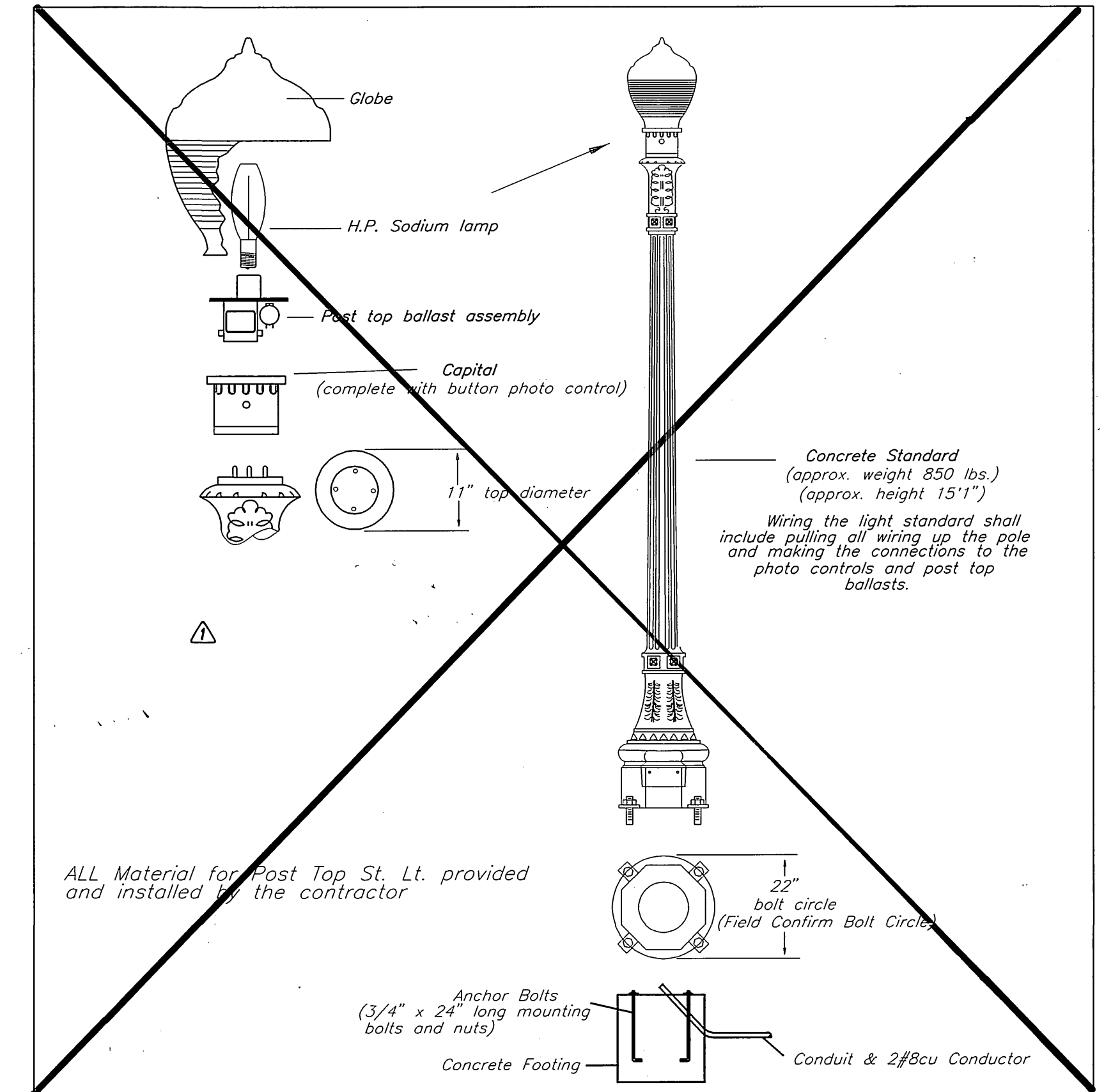

ALL Material for Post Top St. Lt. provided and installed by the contractor

**STREET LIGHT LEGEND**

- EXISTING CONCRETE POST TOP STANDARD
- NEW CONCRETE POST TOP ELECTRODER
- EXISTING STREET LIGHT SERVICE BOX
- ELECTRIC SERVICE BOX (10" X 17" X 12") PER ITEM # P-1 OF UGS-800 (CONCRETE ONLY) INSTALL PER UGS-320
- 1" RIGID PLASTIC (DB) CONDUIT WITH #8 CU 600V CABLES (UNLESS WHERE NOTED)

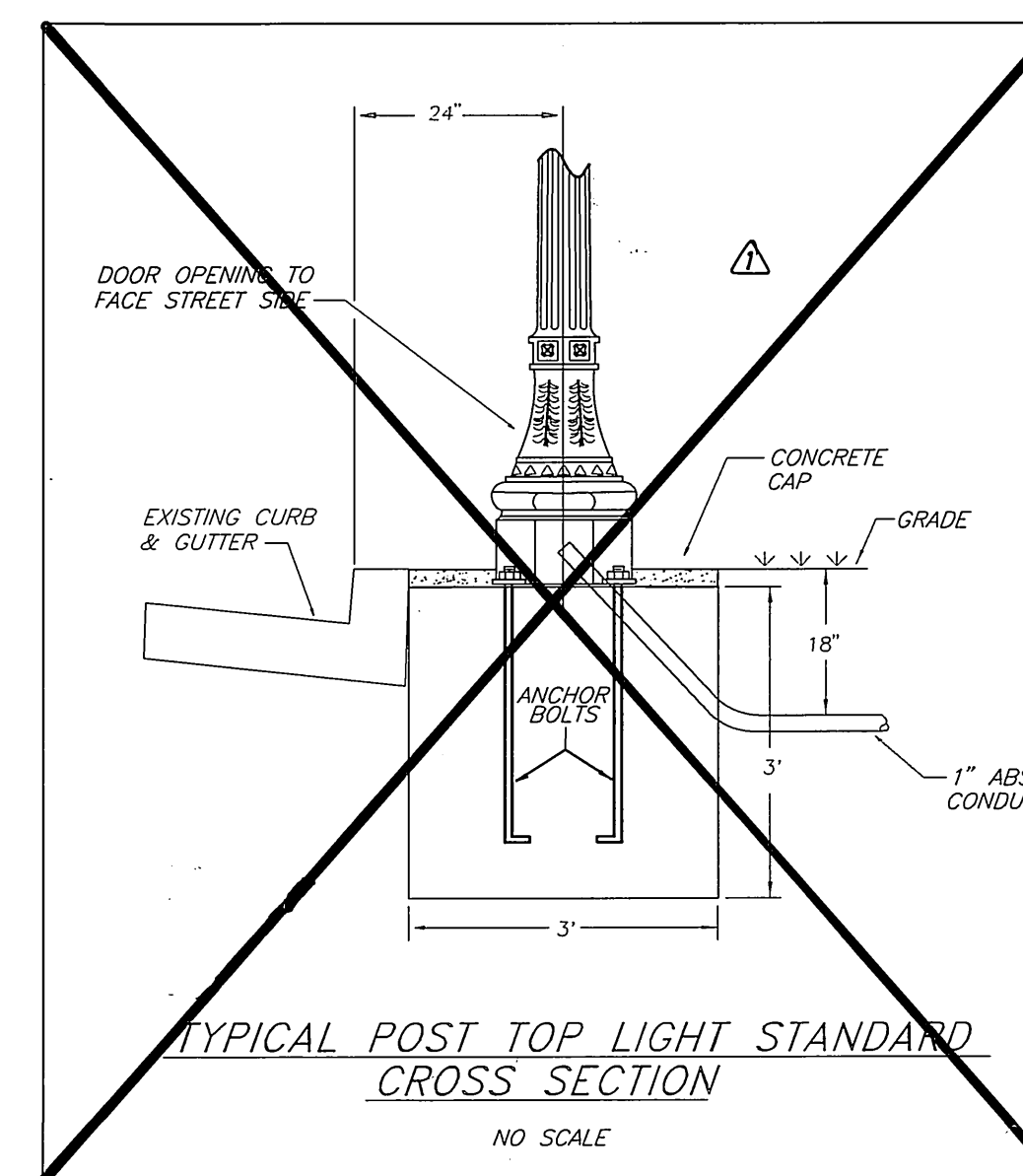

TYPICAL POST TOP LIGHT STANDARD CROSS SECTION NO SCALE

**ITEM SCHEDULE FOR POST TOP STREET LIGHT** NO SCALE

POST TOP LUMINAIRE				
MANUFACTURER	QTY	DESCRIPTION	MANUFACTURER'S CATALOG NUMBER	
King Luminaire Company Inc.	1	Complete with polycarb. globe, 150W 240V regulator type ballast assembly, and cast aluminum capitol with built in button photocell.	RIV-K199E-EPR-III-150-HPS-24 KW9E-PBC-BLK	
Antique St. Lamps Inc.			ANTIQUE - RSL30 cc - sam 150/240 - III	
CONCRETE STANDARD				
MANUFACTURER	QTY	DESCRIPTION	MANUFACTURER'S CATALOG NUMBER	
Ameron Inc. Pole Products Division.	1	Concrete standard with affix-resistant surface and adaptor plate which fits the appropriate luminaire.	20CT15-853 (must specify luminaire to get correct adaptor plate)	
DISTRIBUTED THRU: Pacific Lighting Sales, Inc. (714) 752-7885				
HIGH PRESSURE SODIUM LAMP				
MANUFACTURERS	QTY	DESCRIPTION	SIZE	MANUFACTURER'S CATALOG NUMBER
G.E. Sylvania	1 ea.	clear 55v	150w	G.E. Sylvania S55 S55

**IMPORTANT NOTICE**  
Section 4216/4217 of the Government Code requires a Dig Alert Identification Number to be issued before a "Permit to Excavate" will be void. For your Dig Alert I.D. Number call CALL TOLL FREE 48 HOURS BEFORE YOU DIG UNDERGROUND SERVICE ALERT 1-800-422-4133

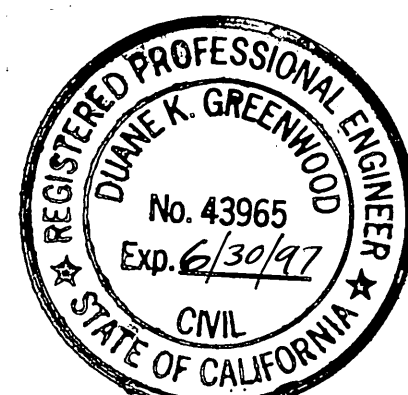

CITY OF RIVERSIDE PUBLIC UTILITIES DEPT. STREET LIGHTING  
APPROVED BY \_\_\_\_\_ DATE \_\_\_\_\_

ENGINEER IN RESPONSIBLE CHARGE  
*Duane K. Greenwood*  
DUANE GREENWOOD  
R.C.E. No. 43965 expires 6/30/97  
DATE 8/2/95

CITY OF RIVERSIDE, CALIFORNIA PUBLIC WORKS DEPARTMENT  
APPROVED BY \_\_\_\_\_ DATE 8/2/95  
DESIGNED BY DPY DRAWN BY OTW CHECKED BY DAB

COMMERCE STREET CUL-DE-SAC MISSION INN TO 9TH ST.  
AS BUILT 6/16/96 RUM  
ACC. NO. 230-541500-440223-30273  
R-3419  
SHEET 1 OF 3  
HORIZ. SCALE: 1" = -- VERT. SCALE: 1" = --



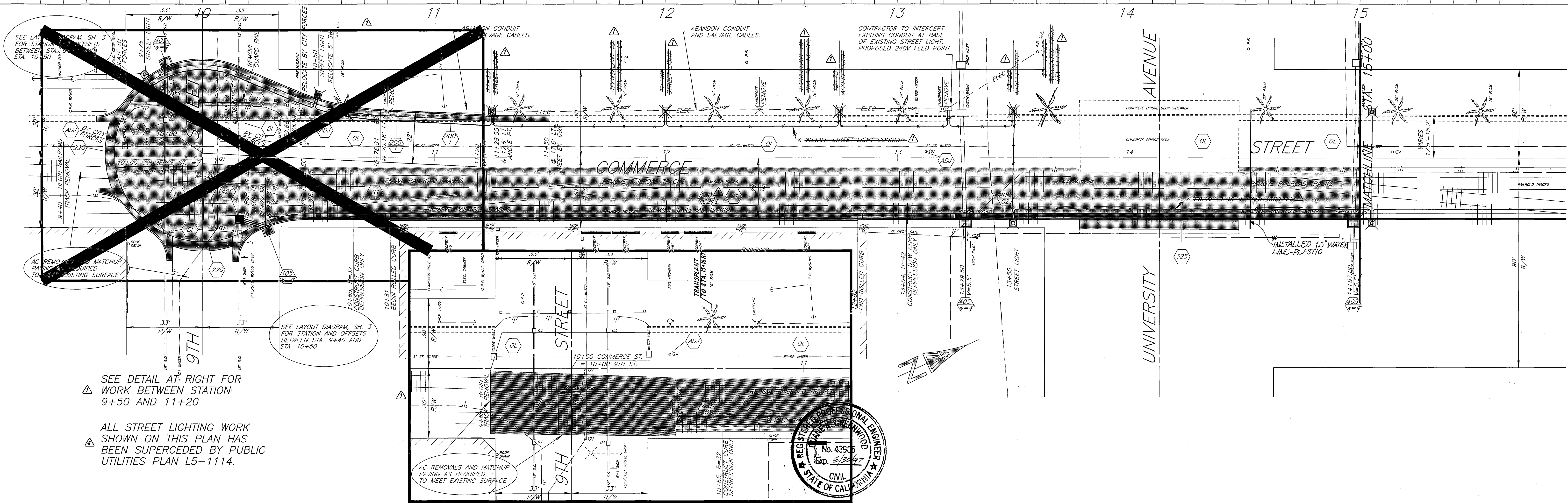
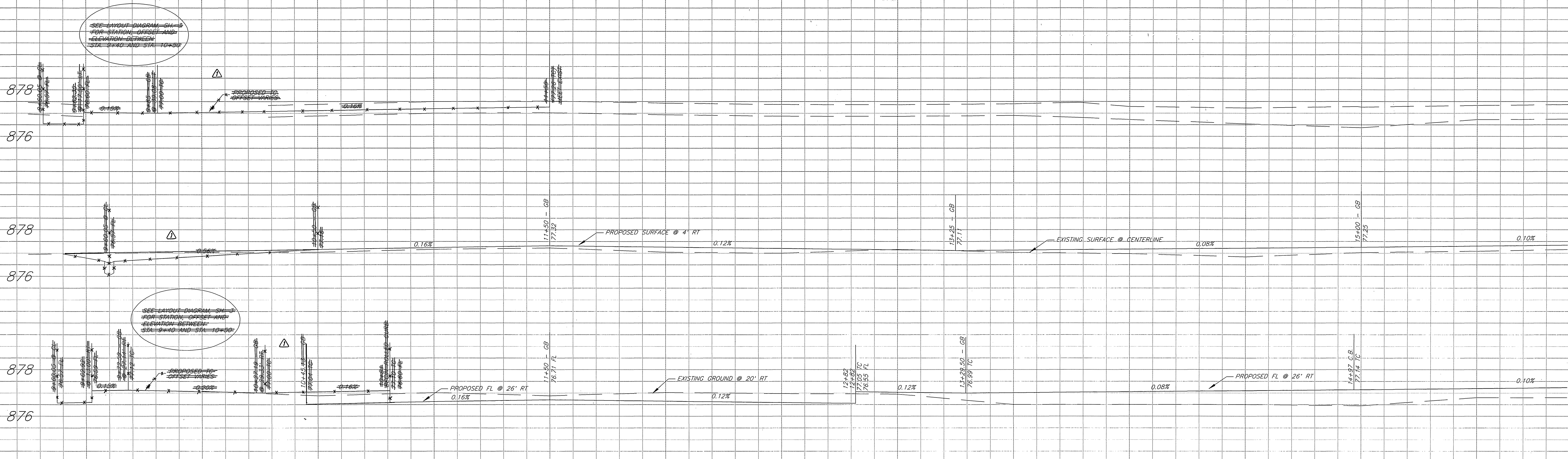

SEE DETAIL AT RIGHT FOR WORK BETWEEN STATION 9+50 AND 11+20

ALL STREET LIGHTING WORK SHOWN ON THIS PLAN HAS BEEN SUPERCEDED BY PUBLIC UTILITIES PLAN L5-1114.

**IMPORTANT NOTICE**  
 Section 4216/4217 of the Government Code requires a Dig Alert Identification Number to be issued before a "Normal to Excavate" will be voided. For your Dig Alert I.D. Number call 48 HOURS BEFORE YOU DIG UNDERGROUND SERVICE ALERT 1-800-422-4133

**BENCHMARK**  
 (17'-1" P.K. NAIL & CITY ENGINEER TAG IN CNTR. OF N'LY HEADWALL OF THE R.W.C. CANAL, 110' +/- - NW OF THE INT. OF COMMERCE ST. AND 10TH ST.) ELEV. 876.441

CITY OF RIVERSIDE PUBLIC UTILITIES DEPT. STREET LIGHTING

ENGINEER IN RESPONSIBLE CHARGE  
 Duane Greenwood  
 DUANE GREENWOOD  
 R.C.E. No. 43965 expires 6/30/97  
 DATE 8/2/95

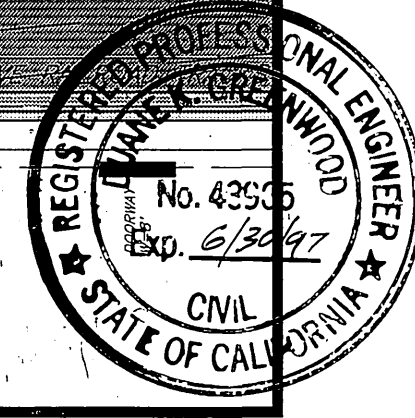

DESIGNED BY DPY DRAWN BY OTW CHECKED BY DKB  
 modified plan L5-1114, palm tree relocations light design superceded by Public Utilities Cul-de-sac at 9th St. eliminated, Street - DRB 6/5/94

CITY OF RIVERSIDE, CALIFORNIA PUBLIC WORKS DEPARTMENT  
 APPROVED BY DATE APPROVED BY DATE  
 DEPUTY P.W. DIRECTOR  
 PRINCIPAL ENGINEER  
 CHIEF P.W. INSPECTOR  
 STREET SERVICES  
 SUPERVISOR  
 TRAFFIC DIVISION  
 PARKS DEPARTMENT

COMMERCE STREET CUL-DE-SAC MISSION INN TO 9TH ST.  
 HORIZ. SCALE: 1" = 20' VERT. SCALE: 1" = 2'

AS BUILT 6/4/96 RUM  
 ACCT. NO. 230-541500-440223-30273  
 R-3419  
 SHEET 2 OF 3



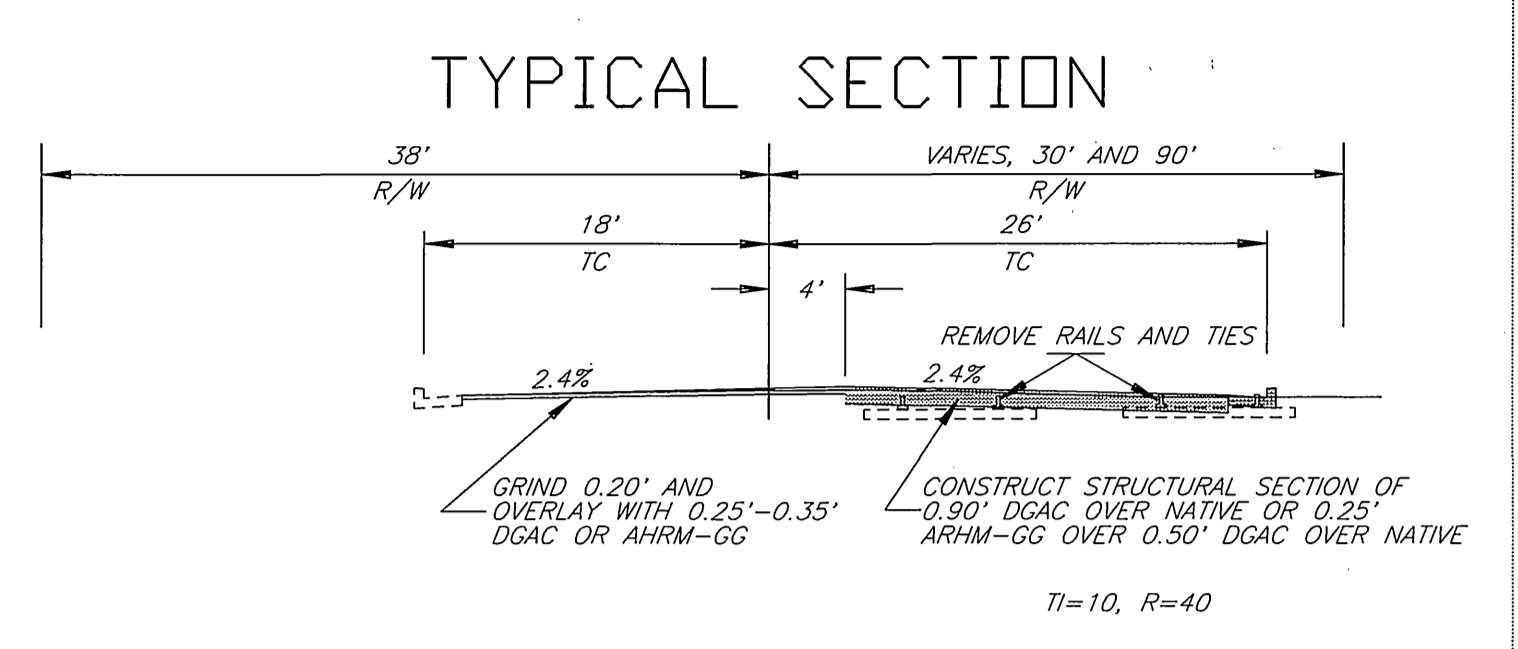
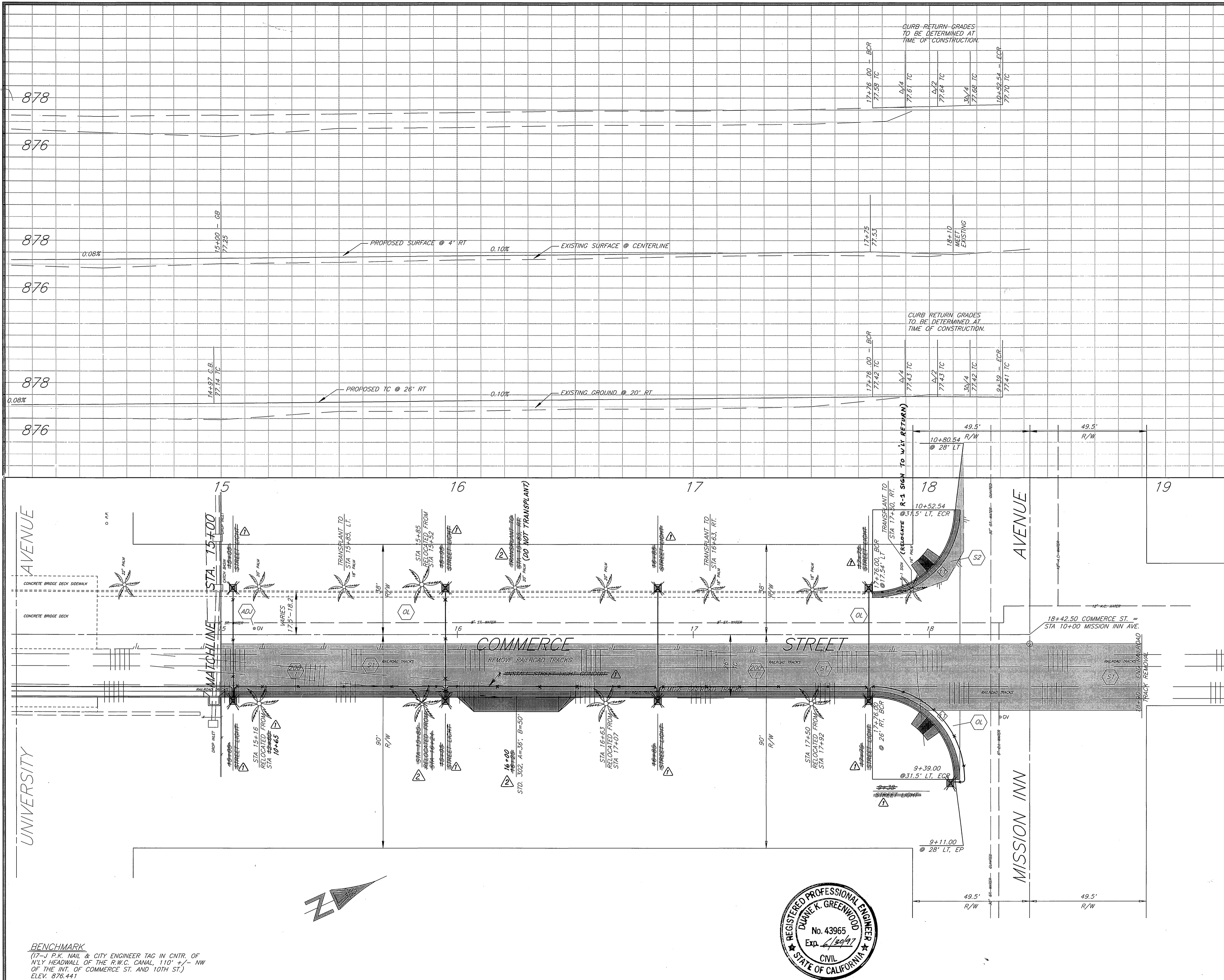

LAYOUT DIAGRAM FOR COMMERCE AND NINTH

CURVE DATA					
Station	Δ	R	L	T	Notes
1	230° 00' 00"	38'	152.54'	N/A	GL
2	27° 08' 15"	50'	24.63'	12.55'	GL
3	20° 00' 00"	10'	38.40'	19.40'	TC
4	79° 10' 59"	40'	38.28'	33.08'	TC
5	56° 18' 14"	15'	14.74'	8.03'	TC
6	54° 25' 17"	15'	14.25'	7.71'	TC
7	21° 21' 57"	40'	14.92'	7.55'	TC
8	56° 56' 39"	15'	14.91'	8.13'	TC
9	64° 22' 51"	15'	16.85'	9.44'	TC
10	25° 37' 09"	50'	22.36'	11.37'	TC

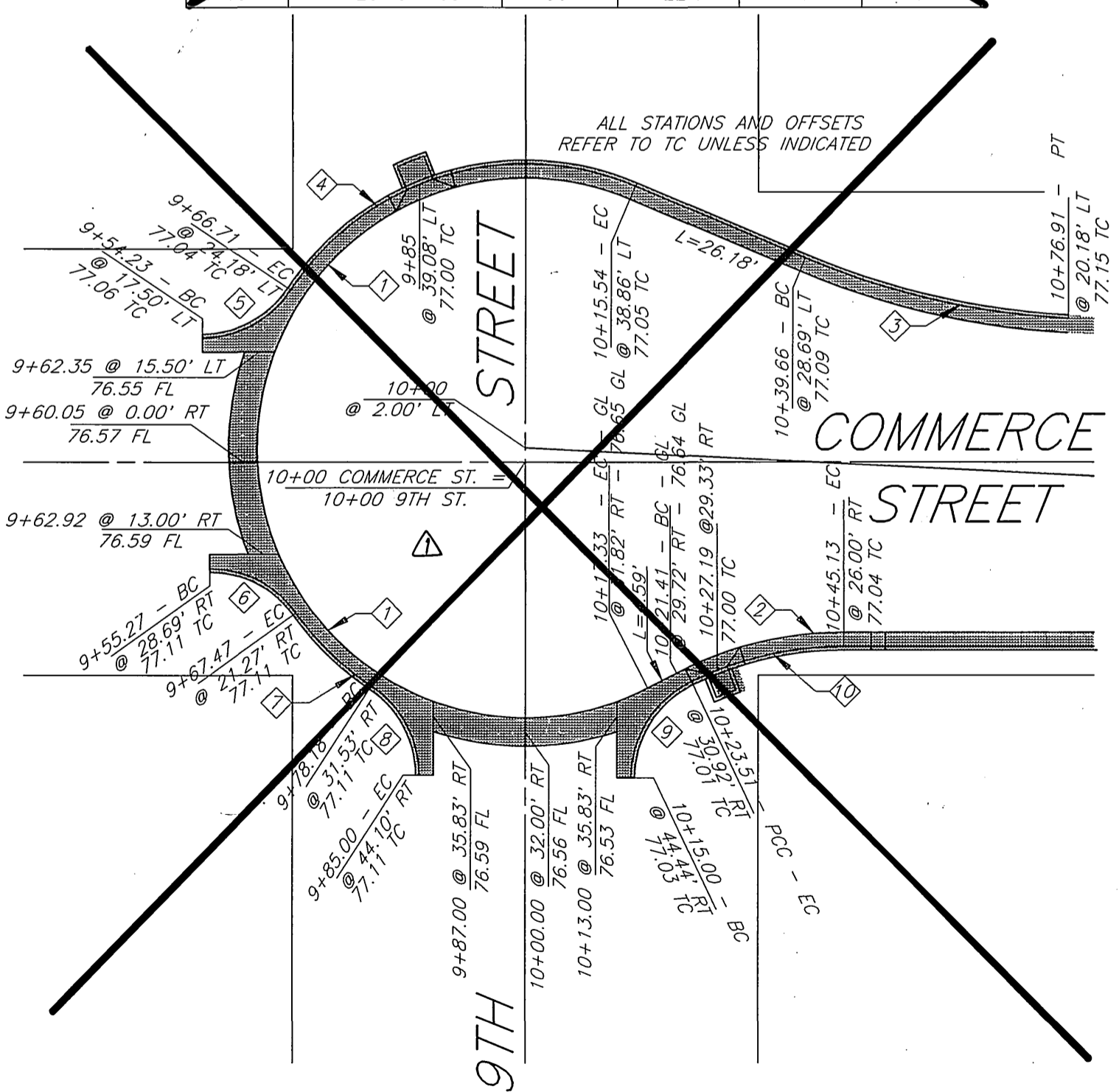

**BENCHMARK**  
 (17-1 P.K. NAIL & CITY ENGINEER TAG IN CNTR. OF NLY HEADWALL OF THE R.W.C. CANAL, 110' +/- NW OF THE INT. OF COMMERCE ST. AND 10TH ST.)  
 ELEV. 876.441



**IMPORTANT NOTICE**  
 Section 4216/4217 of the Government Code requires a flag identification Number to be issued before a "Form to Excavate" will be void. For your flag alert I.D. Number call 48 HOURS BEFORE YOU DIG UNDERGROUND SERVICE ALERT 1-800-422-4133

CURVE DATA				
Station	Δ	R	L	T
11	90° 00' 00"	35'	54.98'	35.00'

CITY OF RIVERSIDE PUBLIC UTILITIES DEPT. STREET LIGHTING

APPROVED BY \_\_\_\_\_ DATE \_\_\_\_\_

ENGINEER IN RESPONSIBLE CHARGE  
**Duane Greenwood**  
 DUANE GREENWOOD  
 R.C.E. No. 43965 expires 6/30/97  
 DATE 8/2/95

DESIGNED BY DPY, DRAWN BY STP, CHECKED BY DRE

REVISIONS: palm transplanting Relocated D/W Apr. 23 '95 LT, Revised 8/2/95 modified plan L5-1114, palm tree relocations light design superceded by Public Utilities Cul-de-sac at 9th St. eliminated Street 8/2/95

CITY OF RIVERSIDE, CALIFORNIA PUBLIC WORKS DEPARTMENT

APPROVED BY: [Signature] DATE: 8/7/95

DEPUTY P.W. DIRECTOR: [Signature] DATE: 8/7/95  
 PRINCIPAL ENGINEER: [Signature] DATE: 8/7/95  
 CHIEF P.W. INSPECTOR: [Signature] DATE: 8/7/95  
 SUPERVISOR: [Signature] DATE: 8/7/95  
 TRAFFIC DIVISION: [Signature] DATE: 8/7/95  
 PARKS DEPARTMENT: [Signature] DATE: 8/7/95

COMMERCE STREET CUL-DE-SAC MISSION INN TO 9TH ST.

HORIZ. SCALE: 1" = 20' VERT. SCALE: 1" = 2'

AS BUILT 6/14/96 RUN

ACCT. NO. 230-541500-440223-30273

R-3419

SHEET 3 OF 3

INDEXED 9-18-95 LF