

CONSTRUCTION LEGEND:

- NUMBERS ABOVE 100 IN A HEXAGON ON THE PLAN REFER TO THE RESPECTIVE STANDARD DRAWING AND SHALL BE CONSTRUCTED ACCORDINGLY, UNLESS MODIFICATIONS ARE NOTED ON THE PLAN. ANY NUMBER SHOWN BELOW THE STANDARD DRAWING NUMBER INDICATES THE SPECIFIC ALTERNATE TO BE CONSTRUCTED.
- REMOVE MAGNOLIA TREE AS CLEARING AND GRUBBING.
- RELOCATE BY CITY FORCES.
- RELOCATE TELEPHONE FACILITIES BY PACIFIC BELL.
- 6" CURB HEIGHT.
- CONSTRUCT STRUCTURAL SECTION OF 0.50' AC OVER 0.82' CLASS 2 BASE. R=40, TI=9.5.
- PLANT 24" BOX MAGNOLIA. SEE TREE PLANTING NOTES.
- CUT AND CAP CLASS 200 PVC IRRIGATION LATERAL. SIZE AS INDICATED IN LOWER HALF.
- EXTEND 1/2" CLASS 200 PVC IRRIGATION LATERAL TO PROPOSED TREE. REUSE SALVAGED SPRAY HEAD OR INSTALL NEW SPRAY HEAD.
- INSTALL CLASS 315 PVC IRRIGATION LINE AND CONTROL WIRE IN SCH 40 PVC SLEEVES WITH MIN. 18" COVER. 1/2" IRRIGATION LINE, 3" SLEEVE, CONTROL WIRE, 2" SLEEVE.
- RELOCATE 1/2" REMOTE CONTROL VALVE AND EXTEND CONTROL WIRES TO PROPOSED MEDIAN.

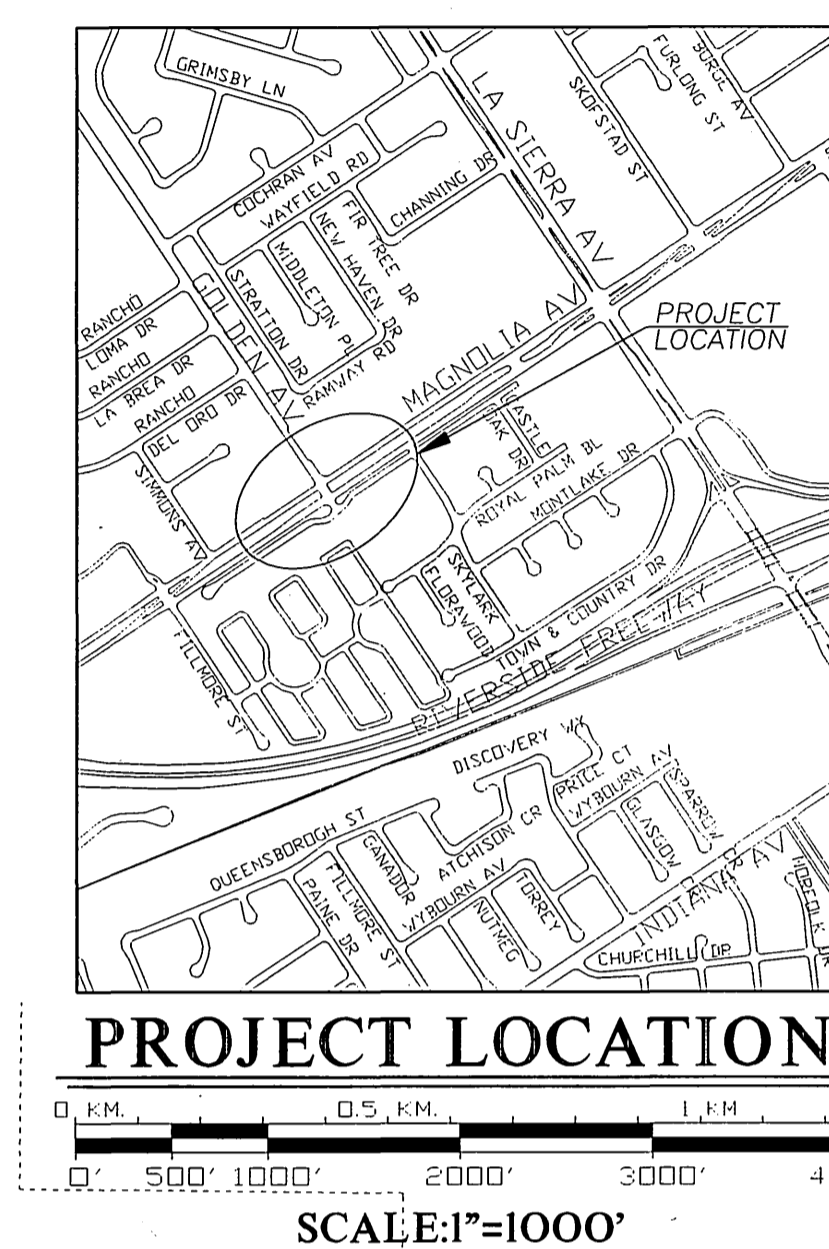
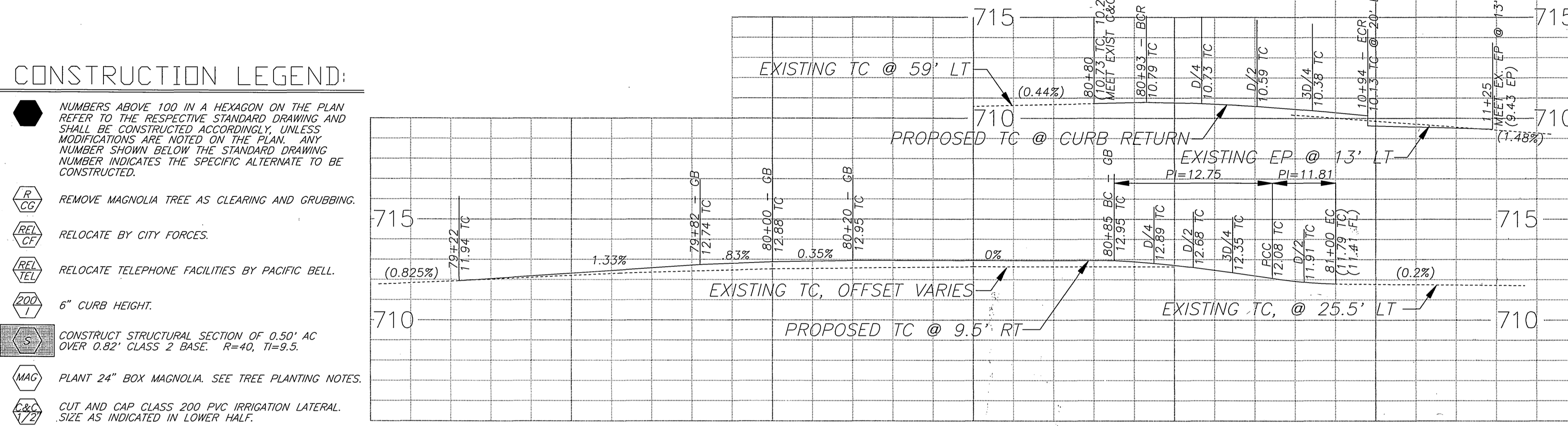
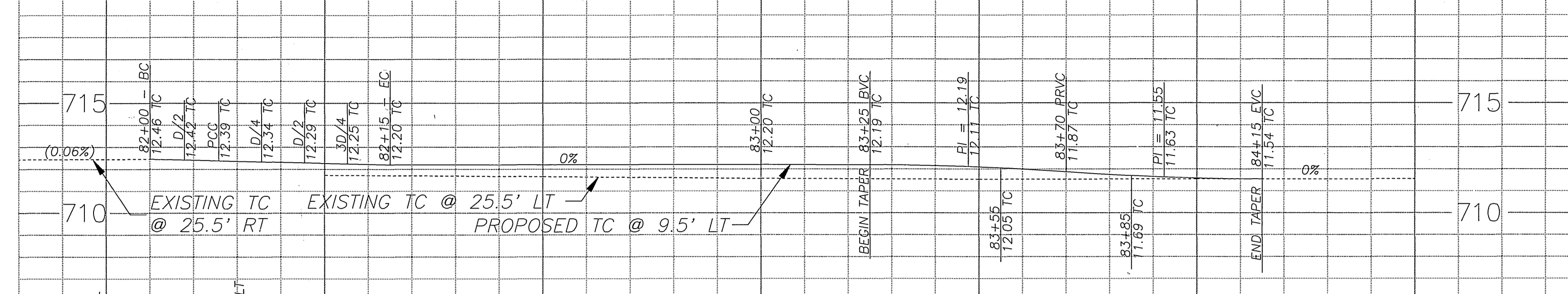

TREE PLANTING & IRRIGATION NOTES

- ALL RELATED WORK SHALL CONFORM TO THE CITY OF RIVERSIDE PARK AND RECREATION DEPARTMENT STANDARDS AND CITY OF RIVERSIDE STREET TREE POLICIES.
- WHEN CALLING FOR INSPECTIONS CONTACT THE STREET TREE INSPECTOR A MINIMUM OF 48 HOURS IN ADVANCE AT (909) 351-6126 TO SCHEDULE AN INSPECTION. A FIELD NOTICE WILL BE ISSUED AS WRITTEN APPROVAL FOR EACH STAGE OF INSPECTION. A VERBAL APPROVAL WILL NOT BE ACCEPTABLE. INSPECTIONS ARE REQUIRED:
- A. AFTER COMPLETION OF FINAL GRADING OF THE LOTS AND WHEN ALL UTILITY SERVICES AND SEWER LATERAL HAVE BEEN MARKED, BUT PRIOR TO DIGGING PLANT PITS, ALL FINAL STREET TREE LOCATIONS ARE TO BE SPOTTED IN THE FIELD BY THE STREET TREE INSPECTOR;
 - B. WHILE DIGGING PLANT PITS AND PLANTING/RELOCATING TREES;
 - C. AFTER PLANTING AND ALL OTHER INDICATED OR SPECIFIED WORK HAS BEEN COMPLETED FOR START OF MAINTENANCE;
 - D. AT END OF THE MAINTENANCE PERIOD, THE CONTRACTOR SHALL CALL THE STREET TREE INSPECTOR AT (909) 351-6126 FOR A FINAL ACCEPTANCE INSPECTION IN ORDER TO BE RELEASED FROM MAINTENANCE. CONTRACTOR'S SURETY WILL NOT BE RELEASED UNTIL AFTER RECEIPT OF WRITTEN NOTIFICATION FROM THE CITY THAT THE TREES PASS FINAL INSPECTION AND THE PARK AND RECREATION DEPARTMENT IS ASSUMING MAINTENANCE RESPONSIBILITIES.
- THE CONTRACTOR SHALL BE RESPONSIBLE TO ACCEPTABLY MAINTAIN ALL PLANTINGS FOR A MINIMUM PERIOD OF ONE (1) YEAR.
- STREET TREE PLANTING SHALL BE AS FOLLOWS:
- | STREET NAME | BOTANICAL NAME/COMMON NAME | MIN. SIZE | APPROX. SPACING | NUMBER REQUIRED |
|---------------------------|-------------------------------|-----------|-----------------|-----------------|
| A. MAGNOLIA AVENUE MEDIAN | MAGNOLIA GRANDIFLORA/MAGNOLIA | 24" BOX | AS SHOWN | 2 |
- BOTH A STREET TREE REMOVAL PERMIT AS ISSUED BY THE PARK AND RECREATION DEPARTMENT AND A STREET OPENING PERMIT AS ISSUED BY THE PUBLIC WORKS DEPARTMENT ARE REQUIRED PRIOR TO COMMENCEMENT OF TREE REMOVAL WORK. FOR ALL EXISTING TREES WITHIN WHAT WILL ULTIMATELY BE THE PUBLIC RIGHT-OF-WAY PAVEMENT AREA, BACKFILL OF ALL HOLES MUST BE INSPECTED BY THE PUBLIC WORKS INSPECTOR FOR PROPER COMPACTION.
- CONTACT PARK PROJECTS INSPECTOR AT (909) 715-3469 A MINIMUM OF 48 HOURS IN ADVANCE TO SCHEDULE AN INSPECTION OF IRRIGATION SYSTEM MODIFICATIONS. ALL WORK SHALL COMPLY WITH CITY OF RIVERSIDE PARK AND RECREATION DEPARTMENT IRRIGATION STANDARDS.
- SALVAGE IRRIGATION HEADS FOR REUSE ON PROPOSED MAGNOLIA TREES. RETURN REMAINING HEADS TO PARK PROJECTS INSPECTOR.
- *NOTE: IN THE INTEREST OF PUBLIC SAFETY AND MAINTENANCE THE STREET TREE INSPECTOR SHALL HAVE THE AUTHORITY TO REVISE THE STREET TREE QUANTITIES AND LOCATIONS SHOWN ON APPROVED PLANS BASED UPON FIELD CONDITIONS FOUND AT THE TIME OF INSTALLATION OF THE TREES.

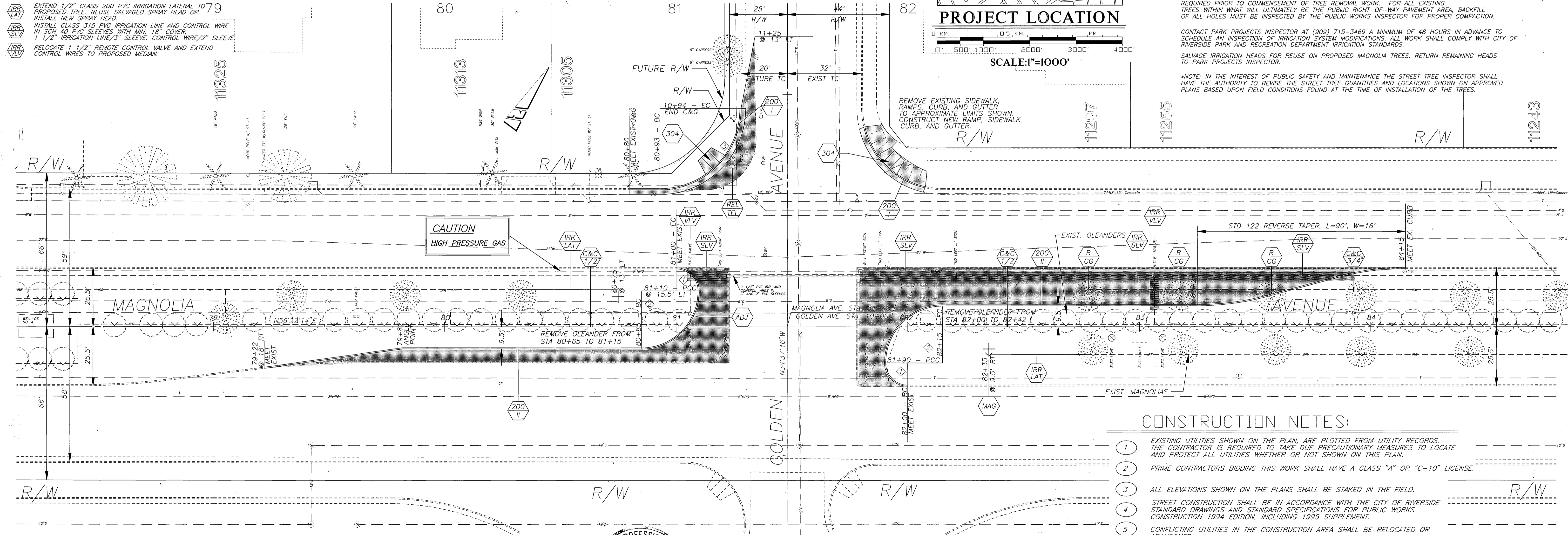

CONSTRUCTION NOTES:

1. EXISTING UTILITIES SHOWN ON THE PLAN, ARE PLOTTED FROM UTILITY RECORDS. THE CONTRACTOR IS REQUIRED TO TAKE DUE PRECAUTIONARY MEASURES TO LOCATE AND PROTECT ALL UTILITIES WHETHER OR NOT SHOWN ON THIS PLAN.
2. PRIME CONTRACTORS BIDDING THIS WORK SHALL HAVE A CLASS "A" OR "C-10" LICENSE.
3. ALL ELEVATIONS SHOWN ON THE PLANS SHALL BE STAKED IN THE FIELD.
4. STREET CONSTRUCTION SHALL BE IN ACCORDANCE WITH THE CITY OF RIVERSIDE STANDARD DRAWINGS AND STANDARD SPECIFICATIONS FOR PUBLIC WORKS CONSTRUCTION 1994 EDITION, INCLUDING 1995 SUPPLEMENT.
5. CONFLICTING UTILITIES IN THE CONSTRUCTION AREA SHALL BE RELOCATED OR ABANDONED.
6. SEE PLAN X-387 FOR TRAFFIC SIGNALIZATION SYSTEM AND DISPOSITION OF SIGNS.

BENCHMARK: E2-0
P.K. NAIL IN S'LY MEDIAN CURB OF MAGNOLIA AVENUE APPROXIMATELY 75' W'LY OF SKYLARK DRIVE.
ELEVATION 712.329'

IMPORTANT NOTICE
Section 4216/4217 of the Government Code requires a Dig Alert Identification Number to be issued before a permit to excavate will be void. For your Dig Alert ID, Number call CALL TOLL FREE TWO WORKING DAYS BEFORE YOU DIG UNDERGROUND SERVICE ALERT 1-800-227-2600

CURVE DATA				
Station	Δ	R	L	T
1	90°00'00"	10	15.71	10
2	90°00'00"	25	39.27	25
3	90°00'00"	35	54.98	35

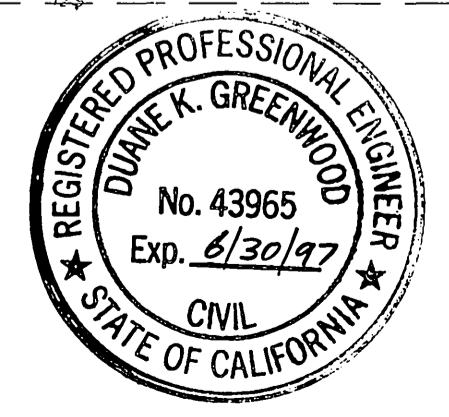

ENGINEER IN RESPONSIBLE CHARGE
Duane K. Greenwood
DUANE K. GREENWOOD
R.C.E. No. 43965 expires 6/30/97
DATE 5/8/96

CITY OF RIVERSIDE, CALIFORNIA
PUBLIC WORKS DEPARTMENT
APPROVED BY: [Signature]
DEPUTY P.W. DIRECTOR
PRINCIPAL ENGINEER
CHIEF P.W. INSPECTOR
TRAFFIC DIVISION
SURVEYOR
STREET SERVICES
PARKS DEPARTMENT

MAGNOLIA-GOLDEN INTERSECTION IMPROVEMENTS
ACCT. NO.: 432-541500-440302-30354
R-3424
SHEET 1 OF 1
PC 3869-M
DATE 5/6/96