

WOOD ROAD  
(N.T.S.)  
T.I. = 7.0

CURVE DATA				
Station	R	L	T	
1	98'37.55"	35'	60.25'	40.71'
2	81'21.35"	35'	49.70'	36.08'
3	180'00.00"	4'	12.57'	
4	168'11.24"	4'	11.78'	40.40'

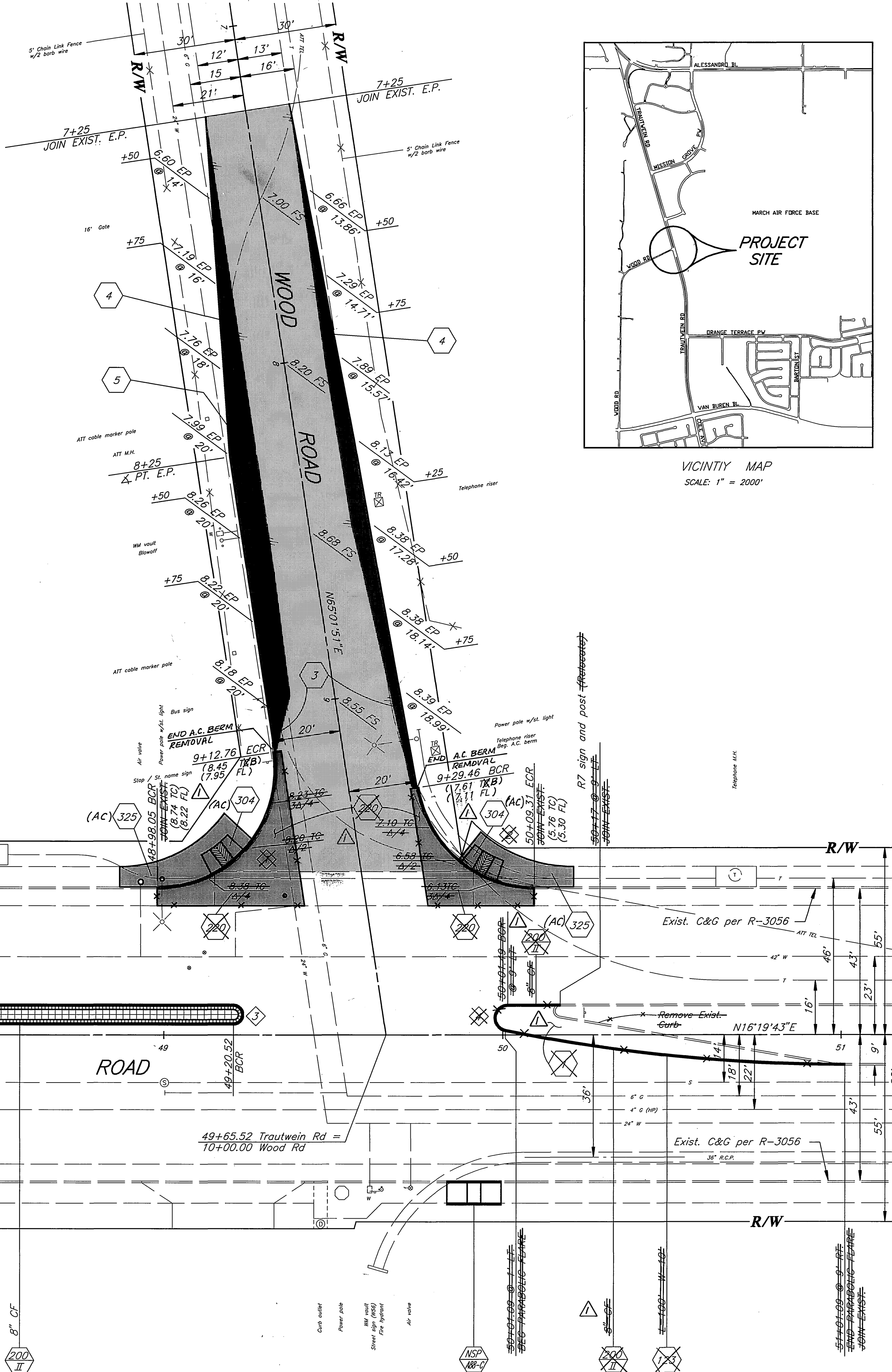
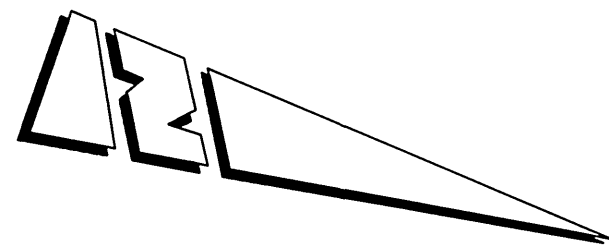

### GENERAL NOTES

- ALL CONSTRUCTION SHALL BE IN ACCORDANCE WITH THE CITY OF RIVERSIDE DEPARTMENT OF PUBLIC WORKS STANDARD DRAWINGS AND THE STANDARD SPECIFICATIONS FOR PUBLIC WORKS CONSTRUCTION, CURRENT EDITION.
- TRIM EDGE OF EXISTING PAVEMENT WHERE NEW PAVEMENT JOINS TO A SMOOTH, STRAIGHT LINE. CONSTRUCT MATCH-UP PAVING AS SHOWN ON THE PLAN AND OVERLAY PAVING AS DIRECTED IN THE FIELD TO PRODUCE A SMOOTH SECTION.
- ALL FLAGGED ELEVATIONS SHALL BE STAKED IN THE FIELD BY THE ENGINEER.
- NOTICE TO CONTRACTOR: THE EXISTENCE AND LOCATION OF ANY UNDERGROUND UTILITY PIPES OR STRUCTURES SHOWN ON THESE PLANS WERE OBTAINED BY A SEARCH OF THE AVAILABLE RECORDS. TO THE BEST OF OUR KNOWLEDGE THERE ARE NO EXISTING UTILITIES EXCEPT AS SHOWN ON THESE PLANS. THE CONTRACTOR IS REQUIRED TO TAKE PRECAUTIONARY MEASURES TO PROTECT THE UTILITY LINES SHOWN AND ANY OTHER LINES NOT OF RECORD OR NOT SHOWN ON THESE PLANS.
- THE CONTRACTOR SHALL CALL IN A LOCATION REQUEST TO UNDERGROUND SERVICE ALERT (USA), PHONE NO. 1-800-227-2600, TWO WORKING DAYS BEFORE DIGGING. NO CONSTRUCTION PERMIT WILL BE ISSUED BY THE PUBLIC WORKS DEPT. INVOLVING EXCAVATION FOR UNDERGROUND FACILITIES UNLESS THE APPLICANT HAS BEEN PROVIDED AN INQUIRY IDENTIFICATION NUMBER BY U.S.A.
- SEE TRAFFIC SIGNAL PLAN X-386 FOR STRIPING AND SIGNING.

### CONSTRUCTION NOTES

- NUMBERS ABOVE 100 IN A HEXAGON ON THE PLAN REFER TO THE RESPECTIVE STANDARD DRAWING AND SHALL BE CONSTRUCTED ACCORDINGLY, UNLESS MODIFICATIONS ARE NOTED ON THE PLAN. ANY NUMBER SHOWN BELOW THE STANDARD DRAWING NUMBER INDICATES THE SPECIFIC ALTERNATE TO BE CONSTRUCTED.
- 1 REMOVE EXIST. STRUCTURAL SECTION BETWEEN PROPOSED CURBS AND FILL WITH CLEAN EARTHEN MATERIAL.
- 2 CONSTRUCT 3 1/2" THICK STAMPED CONCRETE. COLOR AND PATTERN TO MATCH THAT OF THE ADJACENT MEDIAN. THE CONTRACTOR SHALL INSTALL A SAMPLE POUR, A MINIMUM OF 10 S.F., TO DEMONSTRATE THE COLOR AND PATTERN OF THE PROPOSED WORK WHICH WILL BE INSPECTED AND APPROVED BY THE ENGINEER.
- 3 REMOVE EXISTING A.C. BERM.
- 4 INSTALL 2" X 4" REDWOOD HEADER.
- 5 ADJUST EXISTING TELEPHONE MANHOLE TO GRADE. (BY OTHERS)
- AC CONSTRUCT 0.50' FULL DEPTH ASPHALT CONCRETE PAVING OVER COMPACTED NATIVE SOIL.
- OL CONSTRUCT 0.10' THICK AC OVERLAY.
- NSP 88-C CONSTRUCT WHEELCHAIR RAMP PER CALTRANS STANDARD PLAN NO. NSP 88 "CASE C".
- 304 CONSTRUCT WHEELCHAIR RAMP PER CITY OF RIVERSIDE STANDARD DRAWING NO. 304. SEE SPECIAL PROVISIONS REGARDING ADJUSTMENTS IN DIMENSIONS.

ENGINEER IN RESPONSIBLE CHARGE  
**Michael Katusan**  
 MICHAEL KATUSAN  
 R.C.E. No. 36886 expires 6/30/00  
 DATE 10/31/96

REVISIONS

MARK	REVISIONS	DATE
1	REVISED SCOPE OF CONST. @ INTERSECTION	10/31/96

DESIGNED BY: FRED DRAWN BY: FRED CHECKED BY:

CITY OF RIVERSIDE, CALIFORNIA  
 PUBLIC WORKS DEPARTMENT

APPROVED BY: **Barry Paul**  
 DEPUTY P.W. DIRECTOR  
 PRINCIPAL ENGINEER  
 TRAFFIC DIVISION  
 TRAFFIC DEPARTMENT  
 CHIEF P.W. INSPECTOR  
 SURVEYOR

DATE: 11/7/96

TRAUTWEIN ROAD  
 AND WOOD ROAD  
 INTERSECTION IMPROVEMENTS

ACC. NO. 451-570300-455123  
**R-3459**  
 SHEET 1 OF 1  
 FILE NO.

INDEXED 2-11-97 4/11