

B.M. ELEV. 762.695 80D SPK. IN NW
CB. RET. DAWES & MAG.
F.B. 633-20
SCALE: HOR. 1" = 50'
VERT. 1" = 5'

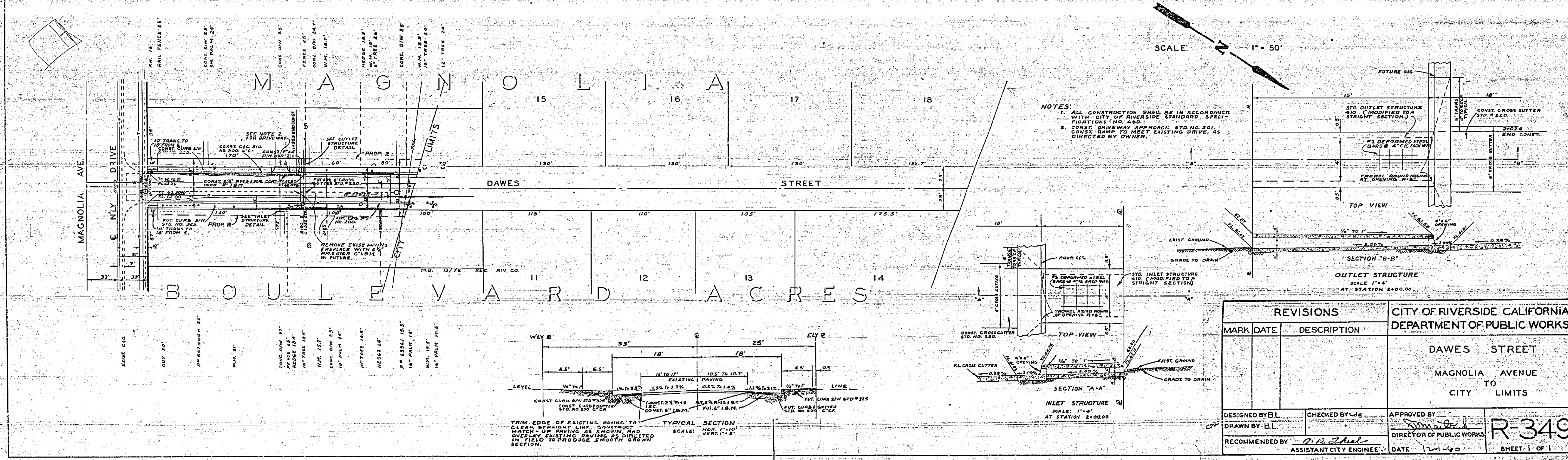

NOTES:
1. ALL CONSTRUCTION SHALL BE IN ACCORDANCE WITH CITY OF RIVERSIDE STANDARD SPECIFICATIONS NO. 400.
2. CONCRETE DRIVEWAY APPROACH STD. NO. 301. CONCRETE RAMP TO MEET EXISTING DRIVE, AS DIRECTED BY OWNER.

SCALE: 1" = 50'

REVISIONS		CITY OF RIVERSIDE CALIFORNIA DEPARTMENT OF PUBLIC WORKS	
MARK	DATE	DESCRIPTION	

DAWES STREET
MAGNOLIA AVENUE
TO
CITY LIMITS

DESIGNED BY B.L.
DRAWN BY B.L.
RECOMMENDED BY *P.A. Zittel*
ASSISTANT CITY ENGINEER

CHECKED BY *W.J.G.*
DATE 1-1-60

APPROVED BY *Wm. J. ...*
DIRECTOR OF PUBLIC WORKS

R-349
SHEET 1 OF 1

