

# RIVERSIDE CALIFORNIA

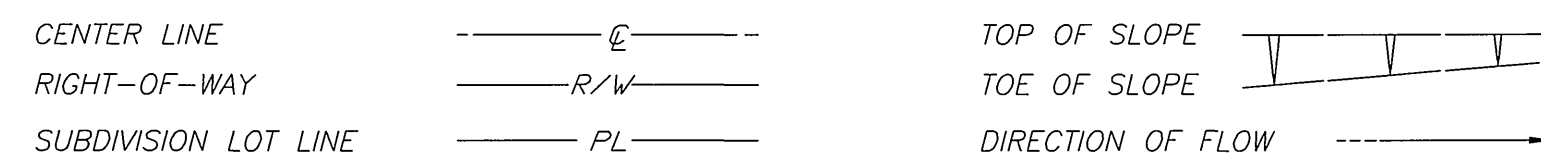

## PUBLIC WORKS DEPARTMENT REHABILITATION OF ARTERIAL STREETS 1997-1998 STPL - 5058 (050)

### CONSTRUCTION LEGEND



### GENERAL CONSTRUCTION NOTES

- 1 CONSTRUCTION SHALL BE IN ACCORDANCE WITH THE CITY OF RIVERSIDE STANDARD DRAWINGS AND STANDARD SPECIFICATIONS FOR PUBLIC WORKS CONSTRUCTION 1997 EDITION.
- 2 EXISTING UTILITIES SHOWN ON THIS PLAN ARE PLOTTED FROM UTILITY RECORDS. THE CONTRACTOR IS REQUIRED TO TAKE DUE PRECAUTIONARY MEASURES TO LOCATE AND PROTECT ALL UTILITIES WHETHER OR NOT SHOWN ON THIS PLAN. IF THE COVER OF A UTILITY IS KNOWN, IT IS SHOWN IN THE PROFILE. UTILITIES SHOWN IN THE PROFILE AS INDICATES THAT THE COVER IS UNKNOWN, BUT THE UTILITY IS NOT EXPECTED TO CONFLICT WITH THE PROPOSED IMPROVEMENTS.
- 3 ALL ELEVATIONS SHOWN ON THE PLANS SHALL BE STAKED IN THE FIELD.
- 4 PRIME CONTRACTORS BIDDING THIS WORK SHALL HAVE A CLASS A OR C-12 LICENSE.
- 5 THE SEAM BETWEEN PASSES OF THE AC OVERLAY SHALL COINCIDE, AS CLOSE AS POSSIBLE, WITH THE LANE LINES.
- 6 GRADE SHEETS SHALL BE REQUIRED FOR CURB, C&G OR EP REMOVALS GREATER THAN 50' IN LENGTH. THE CONTRACTOR SHALL ALLOW 96 HRS AFTER REQUESTING SURVEY FOR SCHEDULING SURVEY AND PROCESSING GRADE SHEETS FOR REPLACEMENT OF THE IMPROVEMENTS.
- 7 ALL CRACKS IN PAVEMENT LESS THAN 1" IN WIDTH SHALL BE FILLED WITH A RUBBERIZED ASPHALT MATERIAL AND ALL CRACKS GREATER THAN 1" IN WIDTH SHALL BE FILLED WITH F-AR-4000 A.C. PRIOR TO APPLICATION OF ARHM (SEE SPECIAL PROVISIONS).
- 8 MANHOLES AND VALVES WITHIN THE GRINDING OR PAVEMENT REPLACEMENT LIMITS SHALL NOT BE ADJUSTED TO GRADE. INSTEAD, ENOUGH GRINDING (OR PVMT. REMOVAL BY OTHER MEANS) SHALL BE DONE TO PROVIDE A SMOOTH FINISHED SURFACE TRANSITION AROUND THE COMPLETE CIRCUMFERENCE OF THE STRUCTURE AS NOTED PER PLAN. EXCEPTIONS TO THIS ARE WHERE MH'S AND VALVES ARE WITHIN PVMT. REMOVAL AREAS BUT ARE TOO CLOSE (WITHIN 3') TO THE ADJACENT PROPOSED A.C. OVERLAY.
- 9 PULL BOXES FOR SPlicing TRAFFIC LOOP DETECTOR CONDUCTORS AND LEAD-IN CABLE ARE NORMALLY ADJACENT TO DETECTORS, UNLESS OTHERWISE SHOWN ON THE PLAN.
- 10 RESURFACING LIMITS SHOWN AT INTERSECTIONS ARE NOT ABSOLUTE. THE INSPECTOR MAY REQUEST GRINDING AND PAVING INTO SIDE STREETS TO IMPROVE RIDE QUALITY AND OTHER STREET CONDITIONS.
- 11 PLANS DO NOT TYPICALLY INDICATE LOCATIONS OF WATER VALVES OR FIRE HYDRANTS TO SIMPLIFY PLAN PREPARATION EFFORT; HOWEVER, THESE FACILITIES MUST BE LOCATED DURING CONSTRUCTION TO MAKE VALVE BOX ADJUSTMENTS AND BLUE HYDRANT MARKER INSTALLATIONS. THE VALVE BOXES MUST BE "TIED OUT" AS PART OF THE CONTRACTORS WORK.
- 12 PAVEMENT PREPARATION SHALL CONSIST OF REMOVAL AND REPLACEMENT (R&R) OF DETERIORATED PAVEMENT AREAS AS MARKED BY THE INSPECTOR AT THE TIME OF CONSTRUCTION. QUANTITIES SHOWN ON THE PLANS ARE BASED UPON R&R SECTIONS AS LISTED IN THE QUANTITY TABLE.

### SPECIFIC CONSTRUCTION NOTES

- NUMBERS ABOVE 100 IN A HEXAGON ON THE PLAN REFER TO THE RESPECTIVE STANDARD DRAWING AND SHALL BE CONSTRUCTED ACCORDINGLY. UNLESS MODIFICATIONS ARE NOTED ON THE PLAN OR COVER SHEET. ANY NUMBER SHOWN BELOW THE STANDARD DRAWING NUMBER INDICATES THE SPECIFIC ALTERNATE TO BE CONSTRUCTED.
- ADJUST SEWER, STORM DRAIN, ELECTRIC OR WATER MANHOLE OR GATE VALVE TO GRADE. ADJUSTMENT TO GRADE OR RELOCATION OF GAS AND TELEPHONE COMPANY'S FACILITIES WILL BE DONE BY OTHERS.
- CONSTRUCT ASPHALT RUBBER HOT MIX GAP GRADED (ARHM-GG) OVERLAY. OVERLAY THICKNESS
- CONSTRUCT A VARIABLE THICKNESS DGAC LEVELING COURSE (0.03' TO 0.30')
- REMOVE EXISTING ROADWAY. CONSTRUCT 0.50' THICK FULL DEPTH AC STRUCTURAL SECTION.
- STATE OF CALIFORNIA, BUSINESS AND TRANSPORTATION AGENCY, DEPT. OF TRANSPORTATION, STANDARD PLANS, DATED JULY 1992.
- GRIND EX. AC 0.08' BELOW GUTTER LIP OR OUTER EDGE, "DAY-LIGHTING" IN 5' (TYPE 1 GRINDING) EXCEPT AS SHOWN OTHERWISE ON PLAN AND DESCRIBED IN SPECIAL PROVISIONS.
- GRIND EX. AC 0.1' BELOW EX. AC SURFACE OR ADJACENT P.C.C. GUTTER (TYPE 2 GRINDING).
- TRAFFIC DETECTOR LOOP INSTALLATIONS  
8 NUMBER OF DETECTOR LOOPS
- TRAFFIC DETECTOR LOOP INSTALLATIONS
- PROTECT IN PLACE

### EXISTING UNDERGROUND & TOPOGRAPHY LEGEND

#### EXISTING UNDERGROUND UTILITIES:

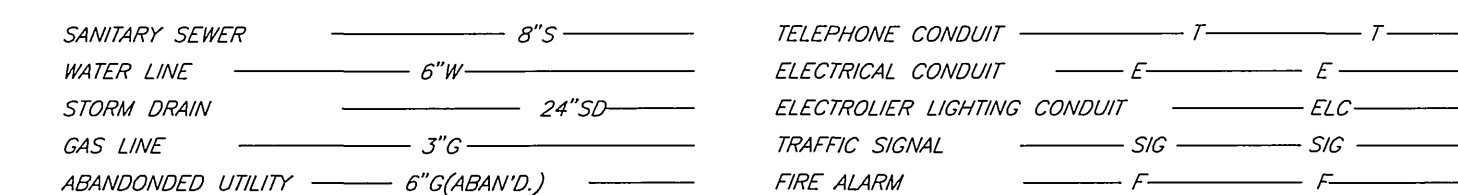

#### EXISTING TOPOGRAPHY:

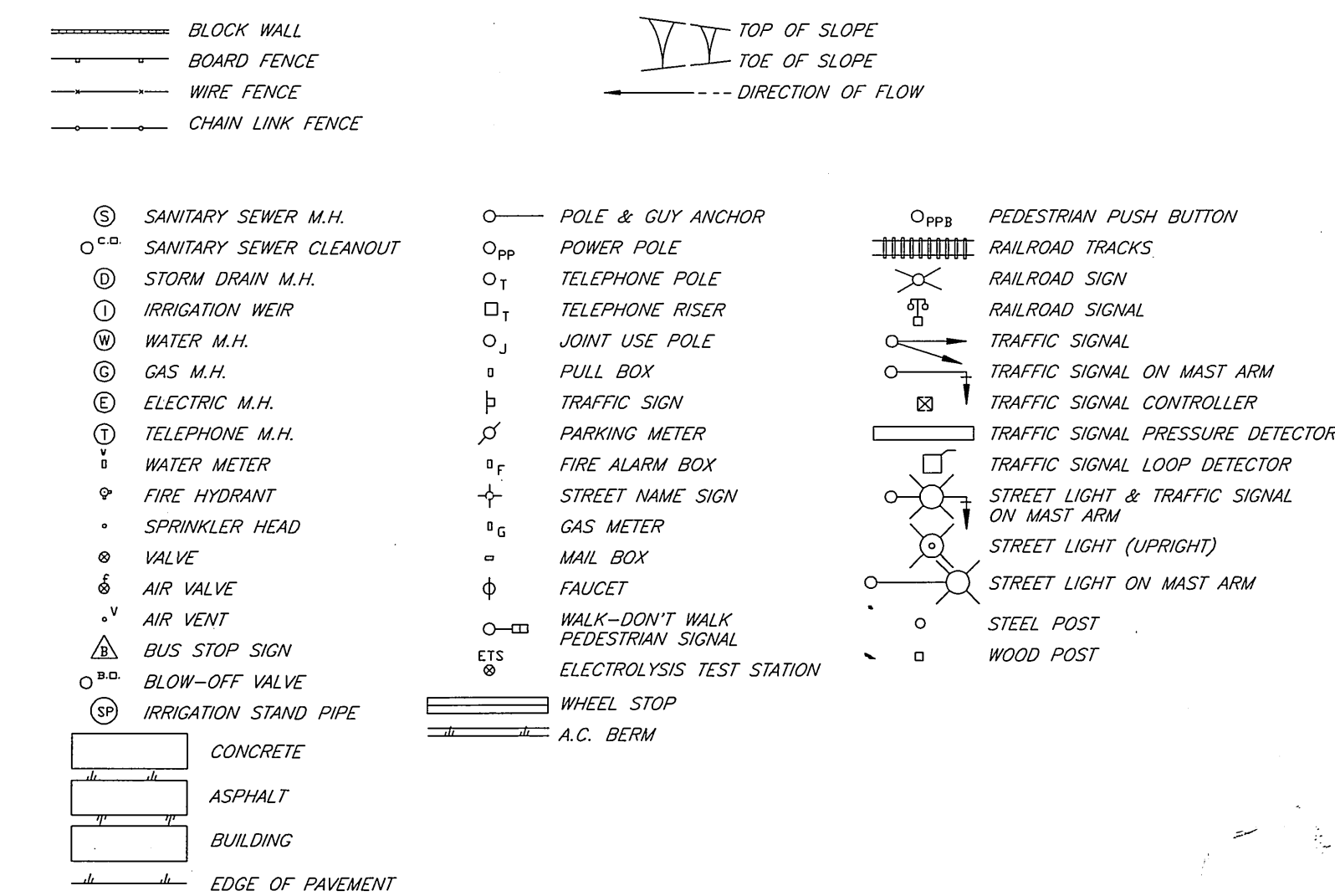

STREET	LIMITS	TRAFFIC INDEX	LENGTH	SH. NO.
1 BROCKTON AVE.	TEQUESQUITE TO MISSION INN	8.5	3,900' 0.74 MILE	2&3
2 PIERCE ST.	MAGNOLIA TO COLLETT	10.0	3,200' 0.61 MILE	4
3 THIRD ST.	COMMERCE TO IOWA	10.0	7,400' 1.40 MILE	5 - 7
4 UNIVERSITY AVE.	PARK TO EUCALYPTUS	10.0	1,700' 0.32 MILE	8
5 VAN BUREN BOULEVARD	WOOD TO BARTON	10.5	5,400' 1.02 MILE	9&10
6 VICTORIA AVE.	LA SIERRA TO BOUNDARY	8.0	3,500' 0.66 MILE	11
<b>TOTAL</b>			<b>25,100' 4.63 MILE</b>	

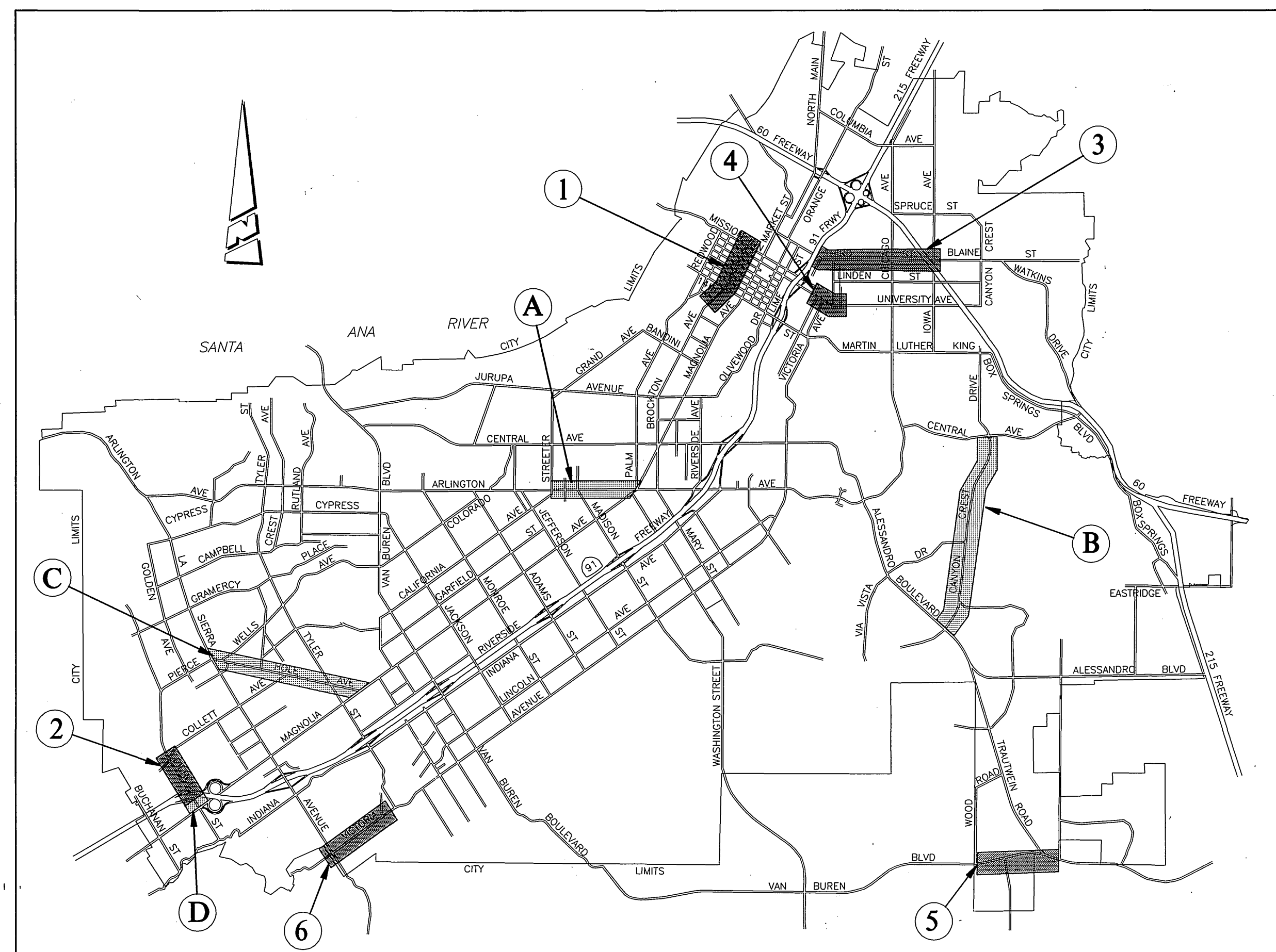

**PROJECT LOCATION MAP**

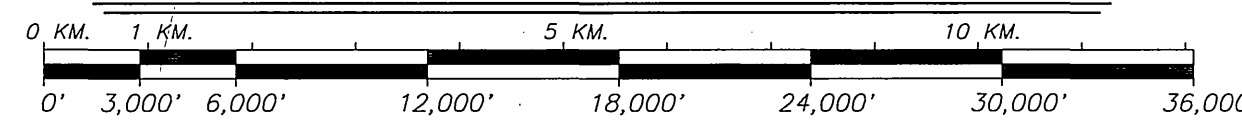

SCALE: 1" = 6,000'

### SLURRY SEAL LOCATIONS AND QUANTITIES

STREET	(A) ARLINGTON AVENUE	(B) CANYON CREST DRIVE	(C) HOLE AVENUE	(D) PIERCE STREET
LIMITS	STREETER TO MAGNOLIA	ALESSANDRO TO CENTRAL	LA SIERRA TO MAGNOLIA	MAGNOLIA TO 91 FREEWAY
LENGTH (L.F.)	5,300	11,500	9,600	800
CRACK FILL (L.F.)	100	500	1,000	100
CRACK REPAIR (L.F.)	-	-	100	-
REMOVAL (C.Y.)	-	-	10	-
DGAC REPLACEMENT (TON)	-	-	25	-
COLD MILLING TYPE II (S.F.)	-	-	1,900	-
LEVELING COURSE (TON)	-	100	15	-
SLURRY (S.Y.)	40,100	69,800	63,300	7,000

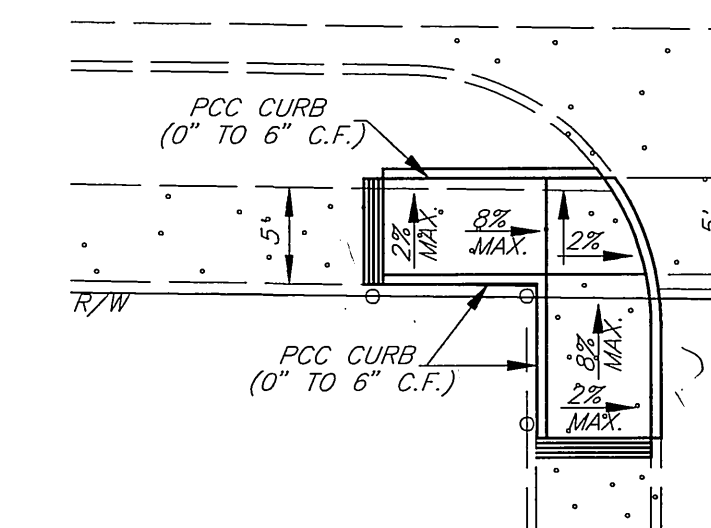

**RAMP DETAIL @ 1550 THIRD ST.**  
SCALE: 1" = 10'

**IMPORTANT NOTICE**  
Section 4216/4217 of the Government Code requires a Dig Alert identification Number to be issued before a "Dig Alert" will be valid. For your Dig Alert I.D. Number call CALL TOLL FREE 1-800-422-4133  
TWO WORKING DAYS BEFORE YOU DIG UNDERGROUND SERVICE ALERT

**ENGINEER IN RESPONSIBLE CHARGE**  
LAUREN F. CALDWELL  
R.C.E. No. 39441 expires 12/31/01  
DATE 7/2/98

DESIGNED BY RVZ DRAWN BY [Signature] CHECKED BY [Signature]

**CITY OF RIVERSIDE, CALIFORNIA PUBLIC WORKS DEPARTMENT**  
APPROVED BY [Signature] DATE 8/27/98  
ENGINEERING MANAGER [Signature]  
PRINCIPAL ENGINEER [Signature]  
TRAFFIC DIVISION [Signature]  
SURVEYOR [Signature]  
STREET SERVICES [Signature]  
PARKS DEPARTMENT [Signature]

**REHABILITATION OF ARTERIAL STREETS 1997-98 STPL - 5058 (050)**  
SCALE: 1" = 40'

ACCT. NO. 430-541500-440125-30039  
**R-3490**  
SHEET 1 OF 11  
FILE NO. VROB\DWG\R3490-01

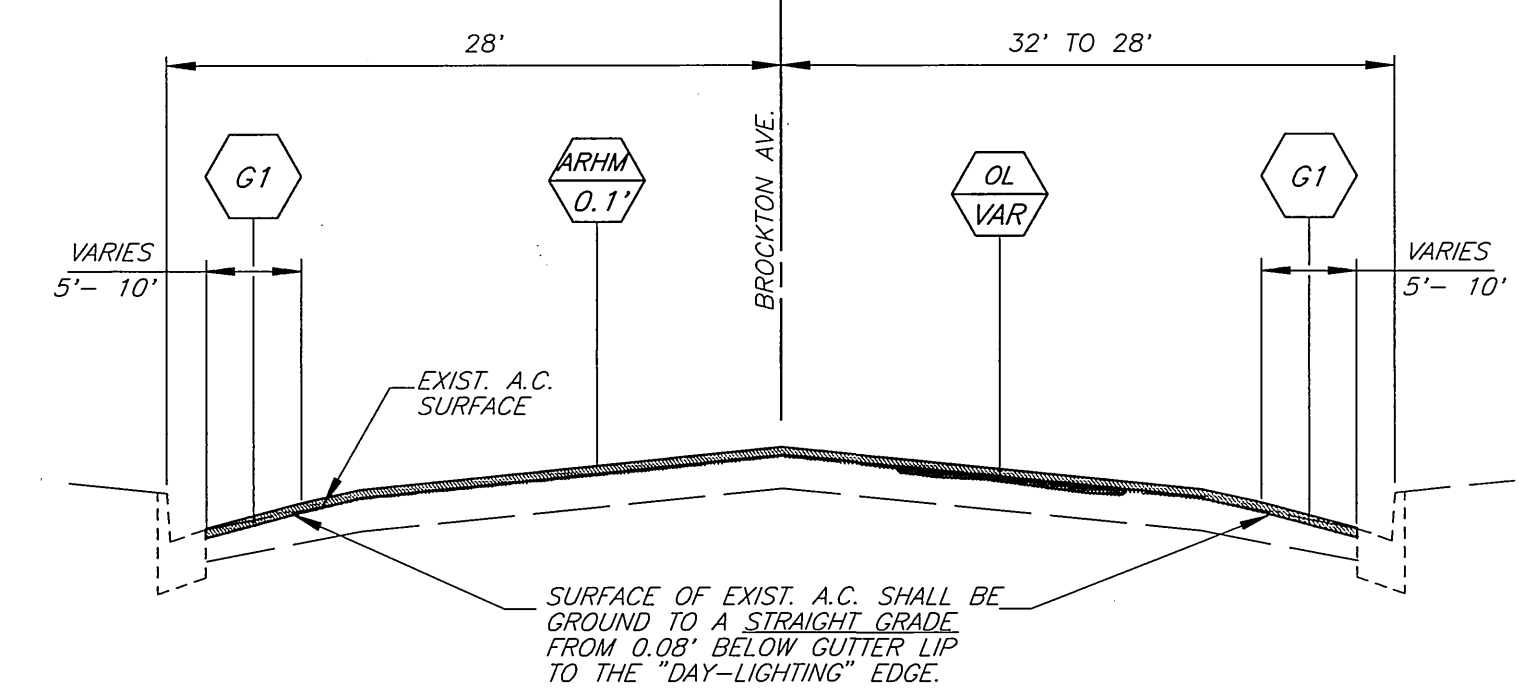
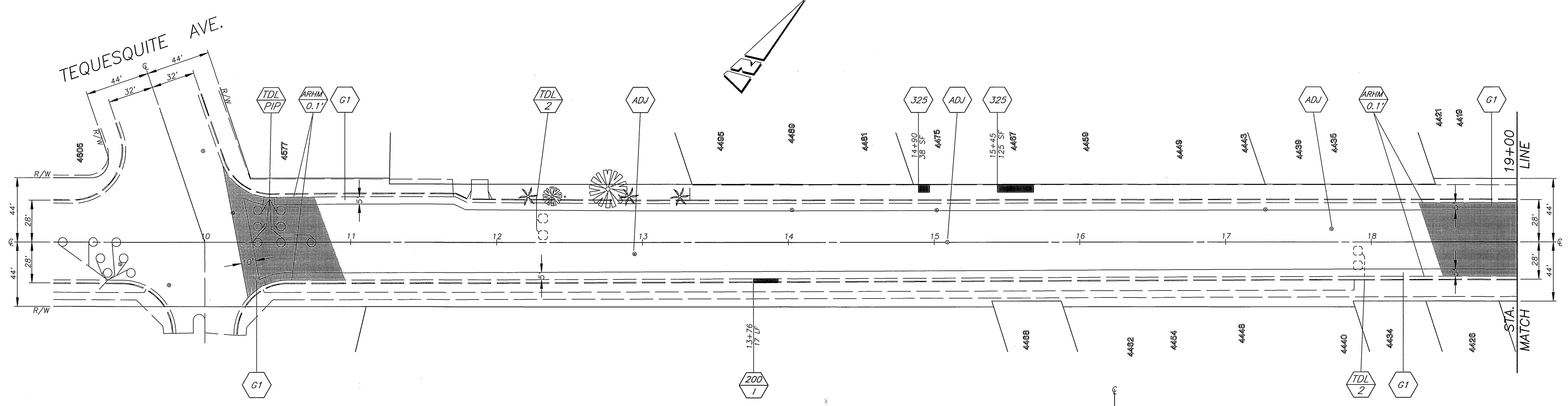

TYPICAL SECTION - BROCKTON AVENUE  
TEQUESQUITE TO MISSION INN  
SCALE: HORIZ. 1" = 10'  
VERT. 1" = 2'

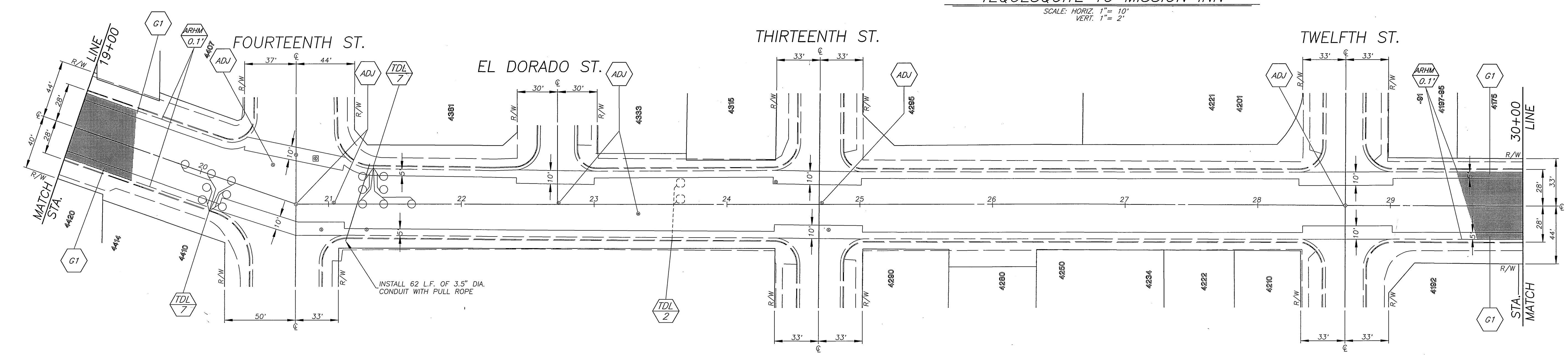

QUANTITIES FOR BROCKTON AVENUE			
ITEM	QUANTITY	ITEM	QUANTITY
COLD MILLING-TYPE 1 (5' WIDE)	6,535 L.F.	TRAFFIC SIGNAL DETECTOR LOOP	38 EA.
COLD MILLING-TYPE 1 (10' WIDE)	1,216 L.F.	ADJUST WATER VALVE FRAME & COVER	30 EA.
CRACK FILL	14,000 L.F.	TWO WAY BLUE REFLECTIVE HYDRANT MARKER	7 EA.
CRACK REPAIR	1,200 L.F.	ASPHALT-RUBBER HOT MIX-GG (0.10')	1,685 TONS
R&R CURB & GUTTER, STD. 200, TYPE 1	87 L.F.	DGAC LEVELING COURSE	15 TONS
R&R P.C.C. SIDEWALK, STD. 325	475 S.F.		
ADJUST S.D. & SEWER MANHOLE	13 EA.	PAVEMENT PREPARATION (0.5" THICK)	
ADJUST WATER MANHOLE	2 EA.	STRUCTURAL SECTION REMOVAL	38 C.Y.
		A.C. PAVEMENT REPLACEMENT (DGAC)	75 TONS

ENGINEER IN RESPONSIBLE CHARGE  
*Lauren F. Caldwell*  
LAUREN F. CALDWELL  
R.C.E. No. 39441 expires 12/31/01  
DATE 7/7/98

MARK	REVISIONS	APPR.	DATE

DESIGNED BY: RVZ DRAWN BY: RJM CHECKED BY: [Signature]

CITY OF RIVERSIDE, CALIFORNIA  
PUBLIC WORKS DEPARTMENT

APPROVED BY: [Signature] DATE: 8-27-98  
BY: [Signature] DATE: 8-27-98  
PRINCIPAL ENGINEER: R. M. Smith  
CHIEF P.W. INSPECTOR: [Signature]  
TRAFFIC DIVISION: [Signature]  
SURVEYOR: [Signature]  
STREET SERVICES: [Signature]

REHABILITATION OF ARTERIAL  
STREETS 1997-98 STPL-5058 (050)

BROCKTON AVENUE  
TEQUESQUITE TO MISSION INN

HORIZ. SCALE: 1" = 40'

ACCT. NO. 430-541500-440125-30039

**R-3490**  
SHEET 2 OF 11

FILE NO. VROB\DWG\R3490BRO

INDEXED 2-11-99 LHM

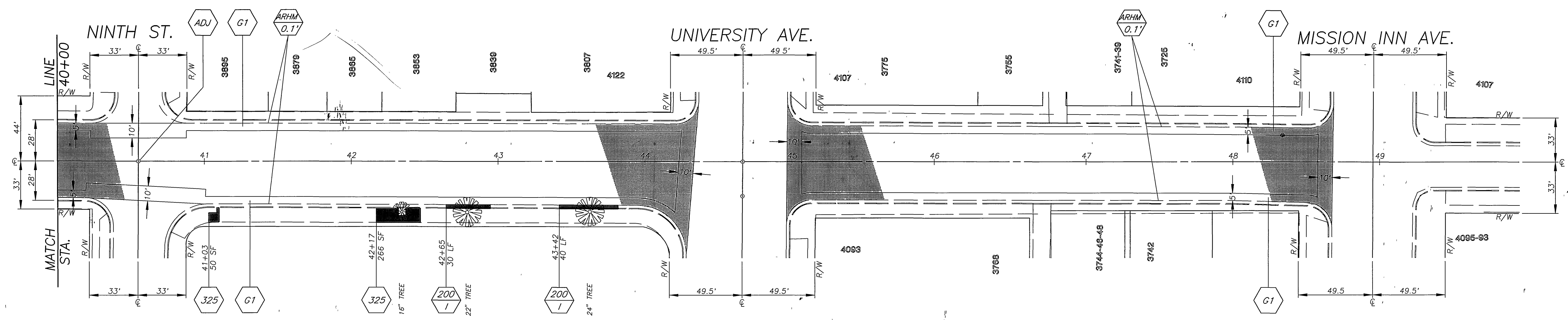
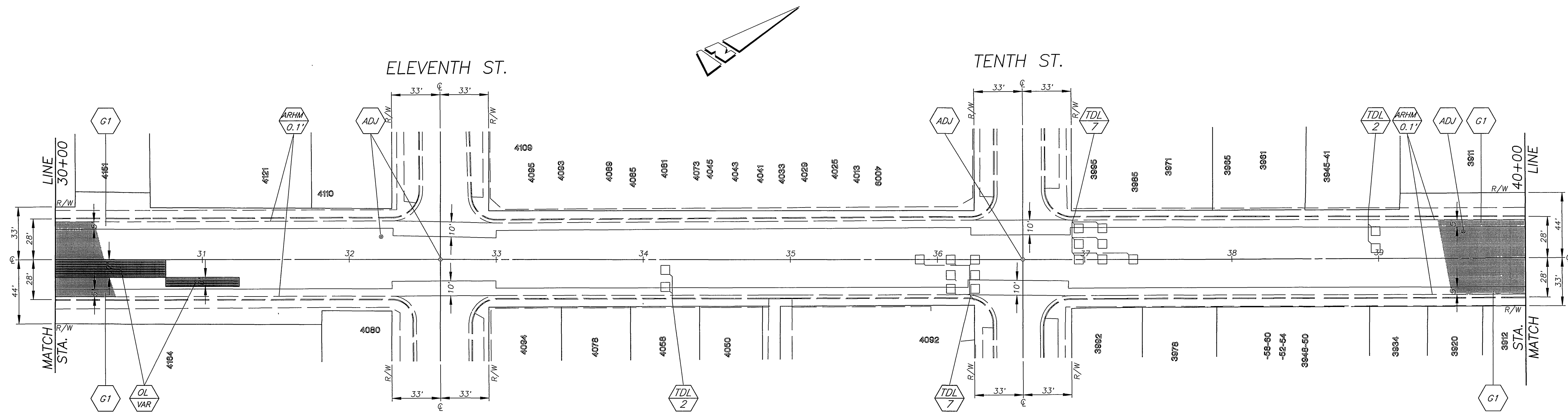

ENGINEER IN RESPONSIBLE CHARGE  
*Lauren F. Caldwell*  
 LAUREN F. CALDWELL  
 R.C.E. No. 39441 expires 12/31/01  
 DATE 7/7/98

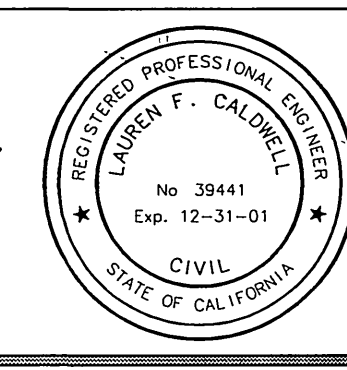

MARK	REVISIONS	APPR	DATE

CITY OF RIVERSIDE, CALIFORNIA  
 PUBLIC WORKS DEPARTMENT

APPROVED BY	BY	DATE	APPROVED BY	BY	DATE
ENGINEERING MANAGER	<i>[Signature]</i>	8-27-98	PRINCIPAL ENGINEER	<i>[Signature]</i>	8-27-98
CHIEF T.W. INSPECTOR	<i>[Signature]</i>	8-27-98	TRAFFIC DIVISION SURVEYOR	<i>[Signature]</i>	8-27-98
			STREET SERVICES	<i>[Signature]</i>	8-27-98
			PARKS DEPARTMENT		

REHABILITATION OF ARTERIAL STREETS 1997-98 STPL-5058 (050)  
 BROCKTON AVENUE TEQUESQUITE TO MISSION INN  
 HORIZ. SCALE 1" = 40'

ACCT NO. 430-541500-440125-30039  
**R-3490**  
 SHEET 3 OF 11  
 FILE NO. VROB\DWG\R3490BRO

INDEXED 2-11-99 L/H

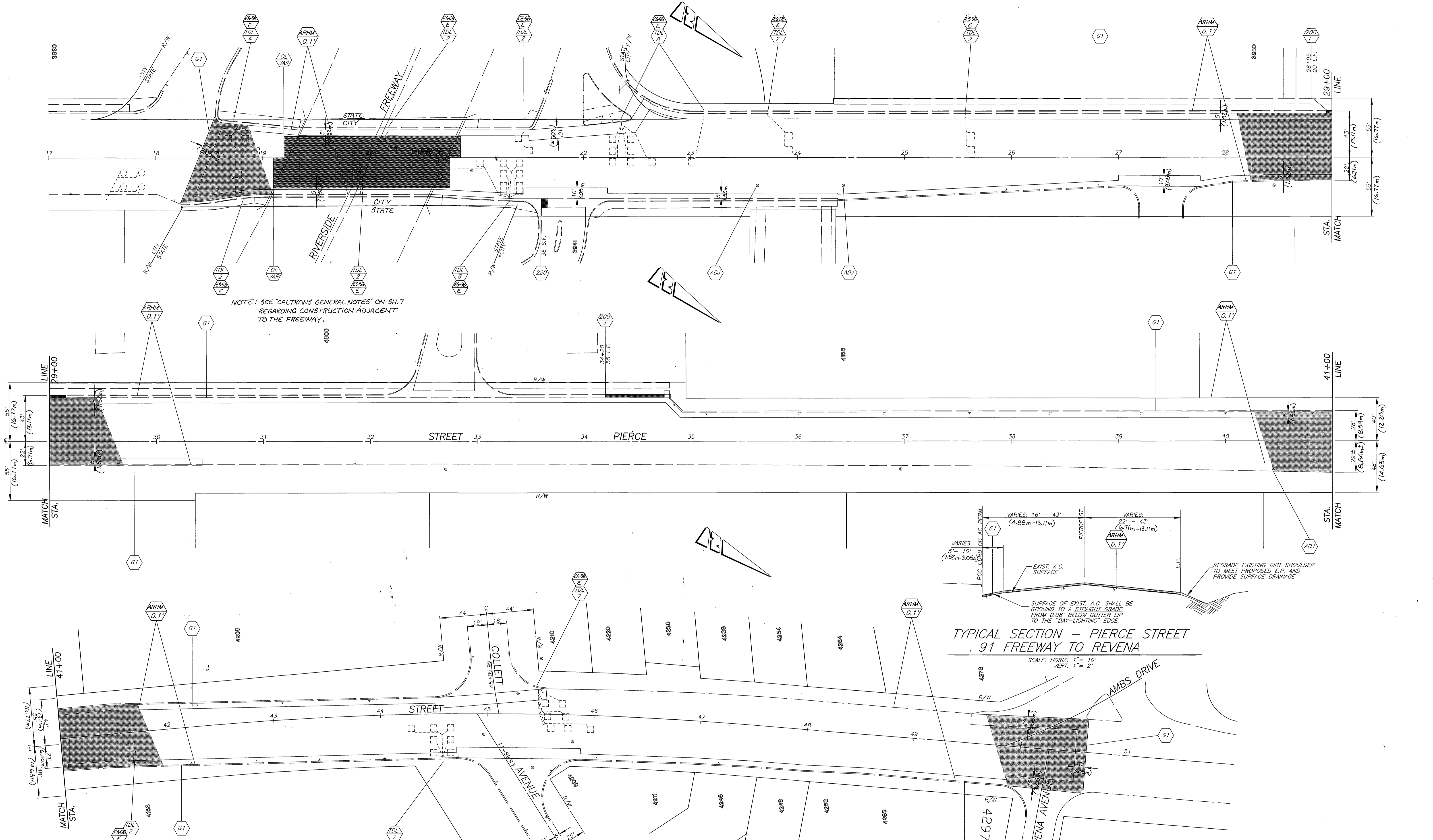

**QUANTITIES FOR PIERCE STREET**

ITEM	QUANTITY	ITEM	QUANTITY
COLD MILLING-TYPE 1 (5' WIDE)	2,775 L.F.	TRAFFIC SIGNAL DETECTOR LOOP	32 EA.
COLD MILLING-TYPE 1 (10' WIDE)	740 L.F.	ADJUST WATER VALVE FRAME & COVER	17 EA.
CRACK FILL	3,000 L.F.	TWO WAY BLUE REFLECTIVE HYDRANT MARKER	6 EA.
R&R CURB & GUTTER, STD. 200, TYPE 1	77 L.F.	ASPHALT-RUBBER HOT MIX-GG (0.10')	1,131 TONS
R&R P.C.C. CROSS GUTTER, STD. 220	36 S.F.	DGAC LEVELING COURSE	90 TONS
R&R P.C.C. SIDEWALK, STD. 325	--- S.F.		
		<b>PAVEMENT PREPARATION</b>	<b>(0.5" THICK)</b>
		STRUCTURAL SECTION REMOVAL	316 C.Y.
		A.C. PAVEMENT REPLACEMENT (DGAC)	640 TONS
ADJUST S.D. & SEWER MANHOLE	8 EA.		

ENGINEER IN RESPONSIBLE CHARGE  
*Lauren F. Caldwell*  
 LAUREN F. CALDWELL  
 R.C.E. No. 39441 expires 12/31/01  
 DATE 7/7/98

MARK	REVISIONS	APPR.	DATE

DESIGNED BY J.V.Z. DRAWN BY R.J.M. CHECKED BY [Signature]

CITY OF RIVERSIDE, CALIFORNIA  
 PUBLIC WORKS DEPARTMENT

APPROVED BY [Signature] DATE 8-27-98  
 R. Mc Guath  
 PUBLIC WORKS DIRECTOR

ENGINEERING MANAGER  
 PRINCIPAL ENGINEER  
 CHIEF P.W. INSPECTOR  
 TRAFFIC DIVISION  
 SURVEYOR  
 STREET SERVICES  
 PARKS DEPARTMENT

REHABILITATION OF ARTERIAL STREETS 1997-98 STPL-5058 (250)

PIERCE STREET  
 FREEWAY 91 TO REVENA

HORIZ. SCALE: 1" = 40'

ACCT. NO. 430-541500-440125-30039

**R-3490**

SHEET 4 OF 11

FILE NO. \PROB\DWG\R3490PIE

INDEXED 2-11-99 L/H

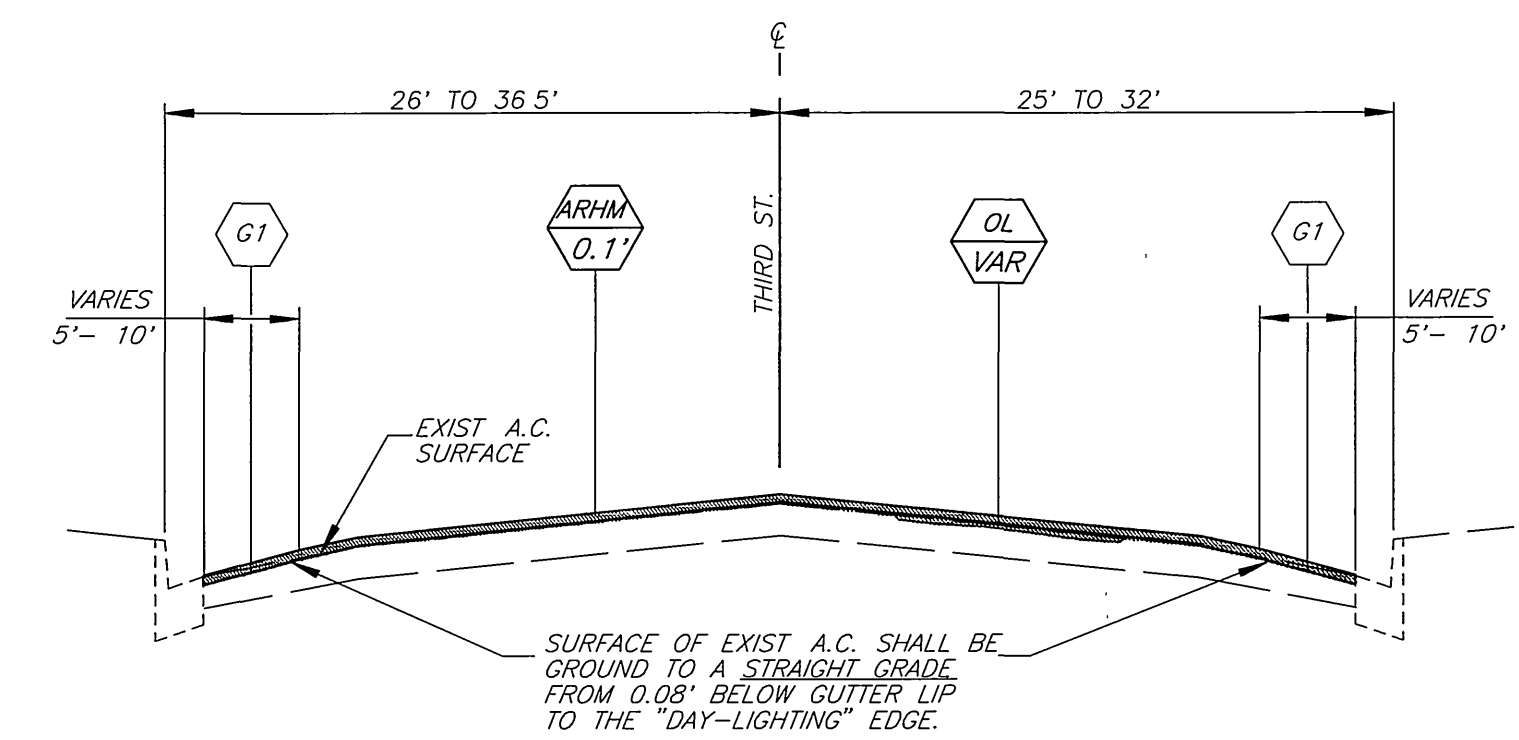
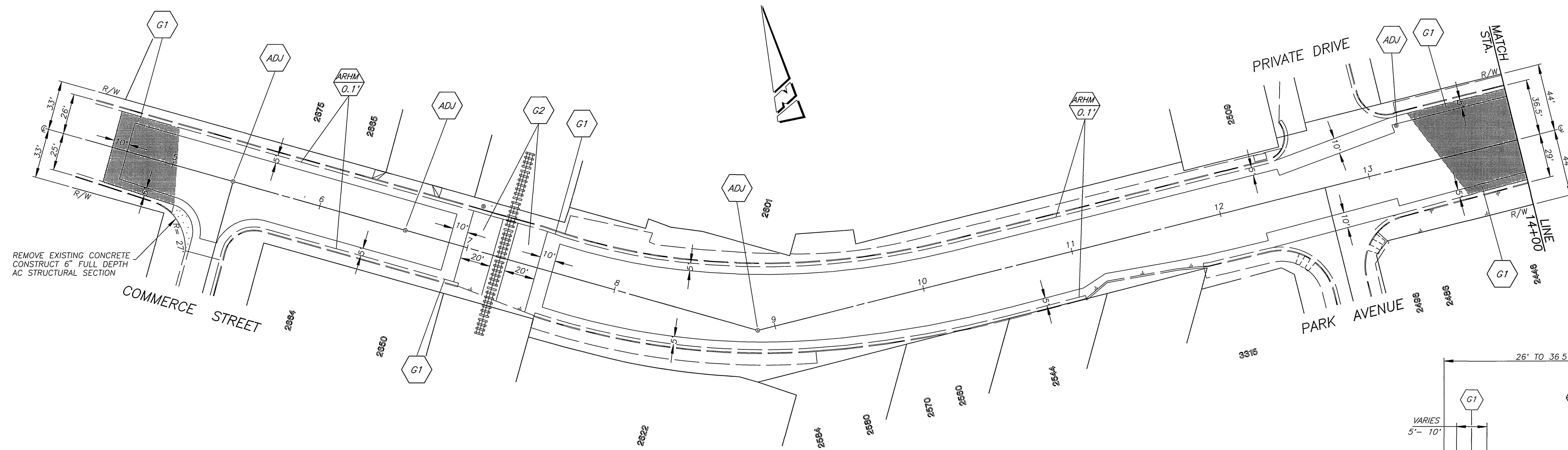

TYPICAL SECTION - THIRD STREET  
 COMMERCER TO IOWA  
 SCALE: HORIZ. 1" = 10'  
 VERT. 1" = 2'

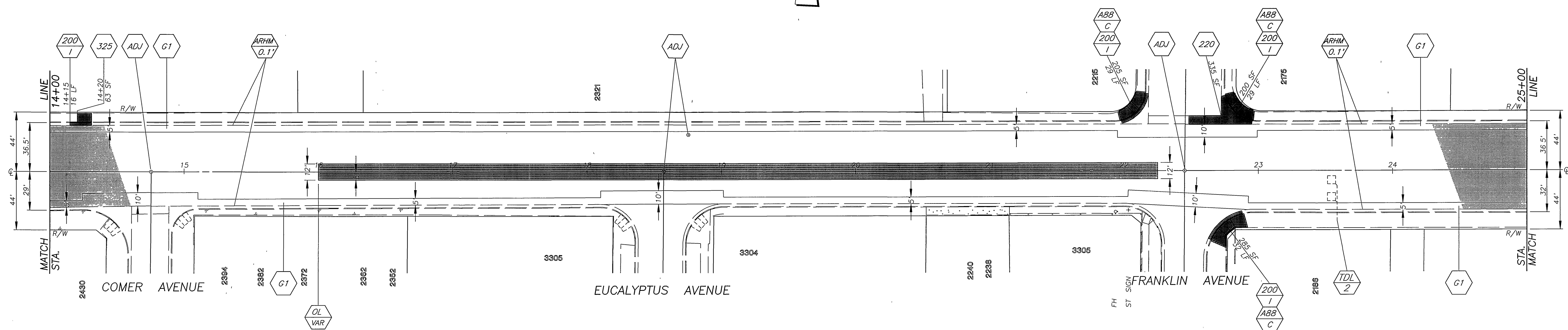

**QUANTITIES FOR THIRD STREET**

ITEM	QUANTITY	ITEM	QUANTITY
COLD MILLING-TYPE 1 (5' WIDE)	11,855 L.F.	TRAFFIC SIGNAL DETECTOR LOOP	77 EA.
COLD MILLING-TYPE 1 (10' WIDE)	2,316 L.F.	ADJUST WATER VALVE FRAME & COVER	50 EA.
COLD MILLING-TYPE 2	18,240 S.F.	TWO WAY BLUE REFLECTIVE HYDRANT MARKER	14 EA.
CRACK FILL	20,000 L.F.	ASPHALT-RUBBER HOT MIX-GG (0.10')	3,745 TONS
CRACK REPAIR	2,000 L.F.	DGAC LEVELING COURSE	195 TONS
R&R CURB & GUTTER, STD. 200, TYPE 1	499 L.F.		
R&R P.C.C. SIDEWALK, STD. 325	2,295 S.F.	PAVEMENT PREPARATION (0.5" THICK)	
R&R PCC DRIVEWAY APPROACH	105 S.F.	STRUCTURAL SECTION REMOVAL	82 C.Y.
ADJUST S.D. & SEWER MANHOLE	19 EA.	A.C. PAVEMENT REPLACEMENT (DGAC)	164 TONS
ADJUST WATER MANHOLE	2 EA.		

ENGINEER IN RESPONSIBLE CHARGE  
*Lauren F. Caldwell*  
 LAUREN F. CALDWELL  
 R.C.E. No. 39441 expires 12/31/01  
 DATE 7/1/98

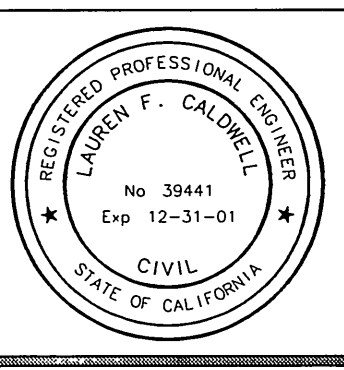

MARK	REVISIONS	APPR	DATE

CITY OF RIVERSIDE, CALIFORNIA  
 PUBLIC WORKS DEPARTMENT

APPROVED BY: [Signature] DATE: 8-27-98  
 ENGINEERING MANAGER  
 PRINCIPAL ENGINEER  
 CHIEF P.W. INSPECTOR  
 TRAFFIC DIVISION  
 SURVEYOR  
 STREET SERVICES  
 PARKS DEPARTMENT

REHABILITATION OF ARTERIAL STREETS 1997-98 STPL-5058 (050)

THIRD STREET  
 COMMERCER TO IOWA

HORIZ. SCALE 1" = 40'

ACCT. NO. 430-541500-440125-30039

**R-3490**

SHEET 5 OF 11

FILE NO. VROB,DWG,R34903RD

INDEXED 2-11-99 LTH

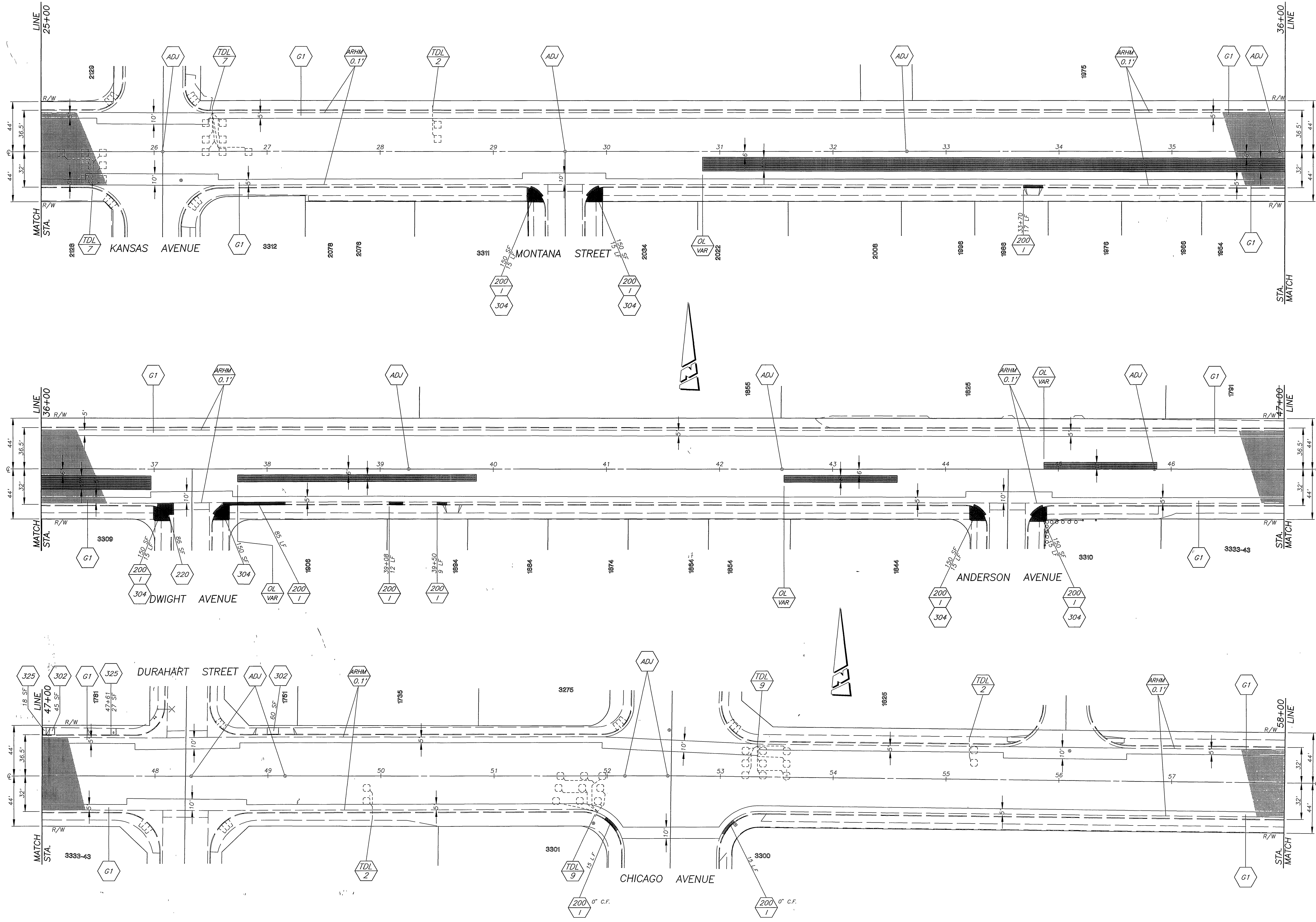

ENGINEER IN RESPONSIBLE CHARGE  
*Lauren F. Caldwell*  
 LAUREN F. CALDWELL  
 R.C.E. No. 39441 expires 12/31/01  
 DATE 7/7/00

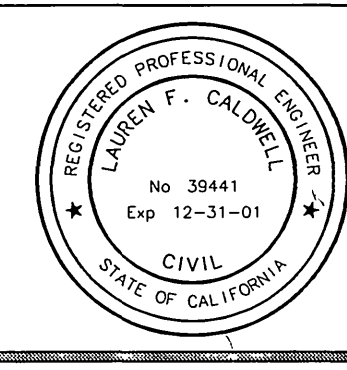

MARK	REVISIONS	APPR.	DATE

CITY OF RIVERSIDE, CALIFORNIA  
 PUBLIC WORKS DEPARTMENT

APPROVED BY	BY	DATE	APPROVED BY
ENGINEERING MANAGER	<i>R. Mc Grath</i>	8-27-98	PUBLIC WORKS DIRECTOR
PRINCIPAL ENGINEER			
CHIEF P.W. INSPECTOR			
TRAFFIC DIVISION SURVEYOR			
STREET SERVICES			
PARKS DEPARTMENT			

REHABILITATION OF ARTERIAL STREETS 1997-98 STPL-5058 (050)  
 THIRD STREET  
 COMMERCE TO IOWA  
 HORIZ.-SCALE. 1" = 40'

ACCT. NO. 430-541500-440125-30039  
**R-3490**  
 SHEET 6 OF 11  
 FILE NO. VROB\DWG\R34903RD

INDEXED 2-11-99 Lfh

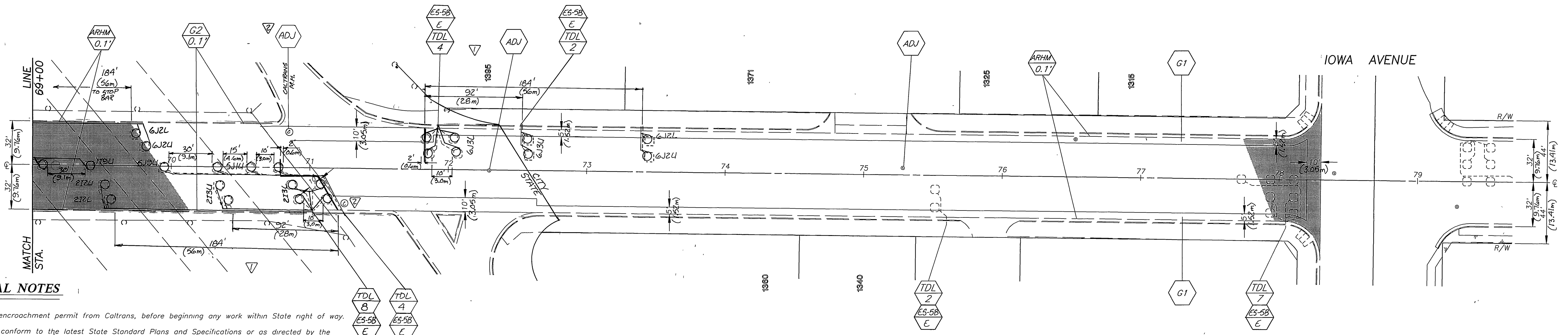
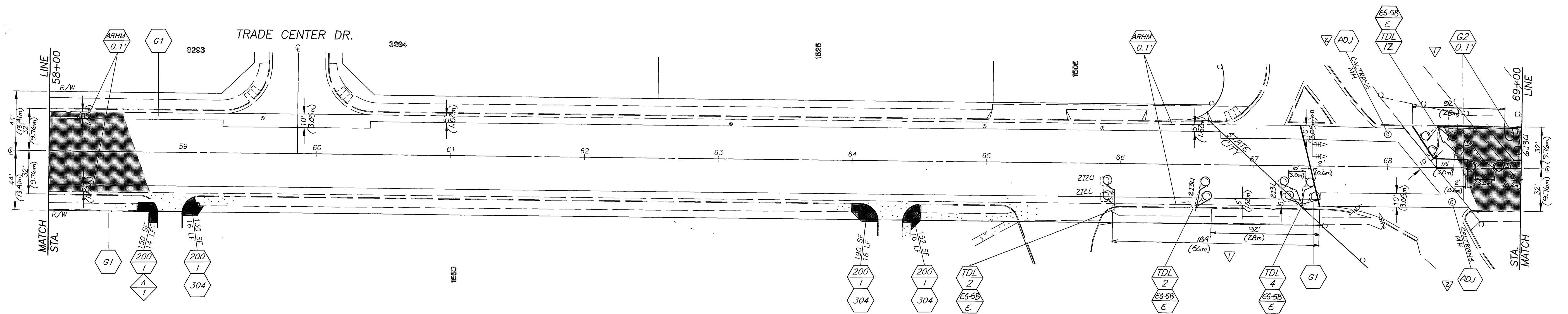

**CALTRANS GENERAL NOTES**

1. The contractor shall apply for and obtain an encroachment permit from Caltrans, before beginning any work within State right of way.
2. All work within the State right-of-way, shall conform to the latest State Standard Plans and Specifications or as directed by the State's Representative. Standards other than State Standards must be pre-approved and justified.
3. No equipment or materials may be stored in the State right of way.
4. All disturbed areas in the State right-of-way must be treated for erosion control (hydro-seeding or equivalent or as directed by the State's Representative). The responsibility for maintaining erosion control will not be released until the seeding is well established. The contractor will be responsible for Caltrans's cost of cleaning any drainage structures or channels cluttered with debris and/or silt as a result of, or caused by the construction project.
5. The contractor shall be responsible for ensuring that any State drainage facility, which is connected to or directly affected by the contractor's operation, shall be operational prior to final acceptance of the permit work by the State. Adequate cleanouts and access openings shall be provided in any construction within the State's right-of-way for future maintenance and repair work as needed. This work shall be furnished at no cost to the State.
6. Where survey monuments exist, they shall be protected or shall be referenced and reset pursuant to Business and Professions Code, Sections 8700 to 8805 (Land Surveyor's Act).
7. Where required, the pavement must be saw-cut at the lane line or a minimum 2 feet from the existing edge of the pavement. The saw-cuts must be perpendicular to, parallel or concentric with the State Highway centerline.
8. All signs, roadside markers, electroliers, etc., shall be protected and/or replaced in-kind, at no cost to the State, in accordance with the current State Standard Plans and the latest edition of the Traffic Manual.
9. No freeway ramps or freeway lanes shall be closed or obstructed at any time unless specifically allowed per the encroachment permit and/or as directed by the State's Representative.
10. All fencing, relocated to facilitate the construction of this project inside the State right-of-way, shall be replaced with type CL-6 fencing as shown in the State's Standard Plans.
11. All signing, striping and pavement markings shall be in conformance with the current edition of the Traffic Manual, published by the State of California, Department of Transportation, and the Special Provisions. All pavement markings shall be thermoplastic unless otherwise noted on the plans.
12. All conflicting striping and pavement markings, not shown on the plans, shall be removed from the pavement by sandblasting by the contractor.
13. Any facility damaged by contractor operations shall be repaired or replaced, at contractor's expense promptly, in accordance with State specifications.

ENGINEER IN RESPONSIBLE CHARGE  
*Lauren F. Caldwell*  
 LAUREN F. CALDWELL  
 R.C.E. No. 39441 expires 12/31/01  
 DATE 7/7/98

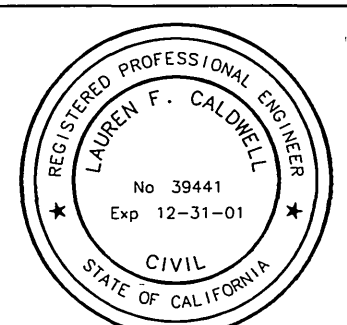

MARK	REVISIONS	APPR	DATE
✓	AS BUILT-ADDED STATE M.I.S.B. FREEWAY	RLC	7/5/98
✓	ADD LOOP DESIGNATIONS AND DIMENSIONS	RLC	7/7/98

CITY OF RIVERSIDE, CALIFORNIA PUBLIC WORKS DEPARTMENT			
APPROVED BY	BY	DATE	APPROVED BY
ENGINEERING MANAGER	RLC	7/7/98	R. Mc Gueth
PRINCIPAL ENGINEER	RLC	7/7/98	PUBLIC WORKS DIRECTOR
CHEF P.W. INSPECTOR			
TRAFFIC DIVISION SURVEYOR			
STREET SERVICES			
PARKS DEPARTMENT			

REHABILITATION OF ARTERIAL STREETS 1997-98 STPL-5058 (050)  
 THIRD STREET  
 COMMERCE TO IOWA  
 HORIZ SCALE 1" = 40'

ACCT. NO. 430-541500-440125-30039  
**R-3490**  
 SHEET 7 OF 11  
 FILE NO. VROB/DWG/R34903RD

INDEXED 2-11-99 L/H

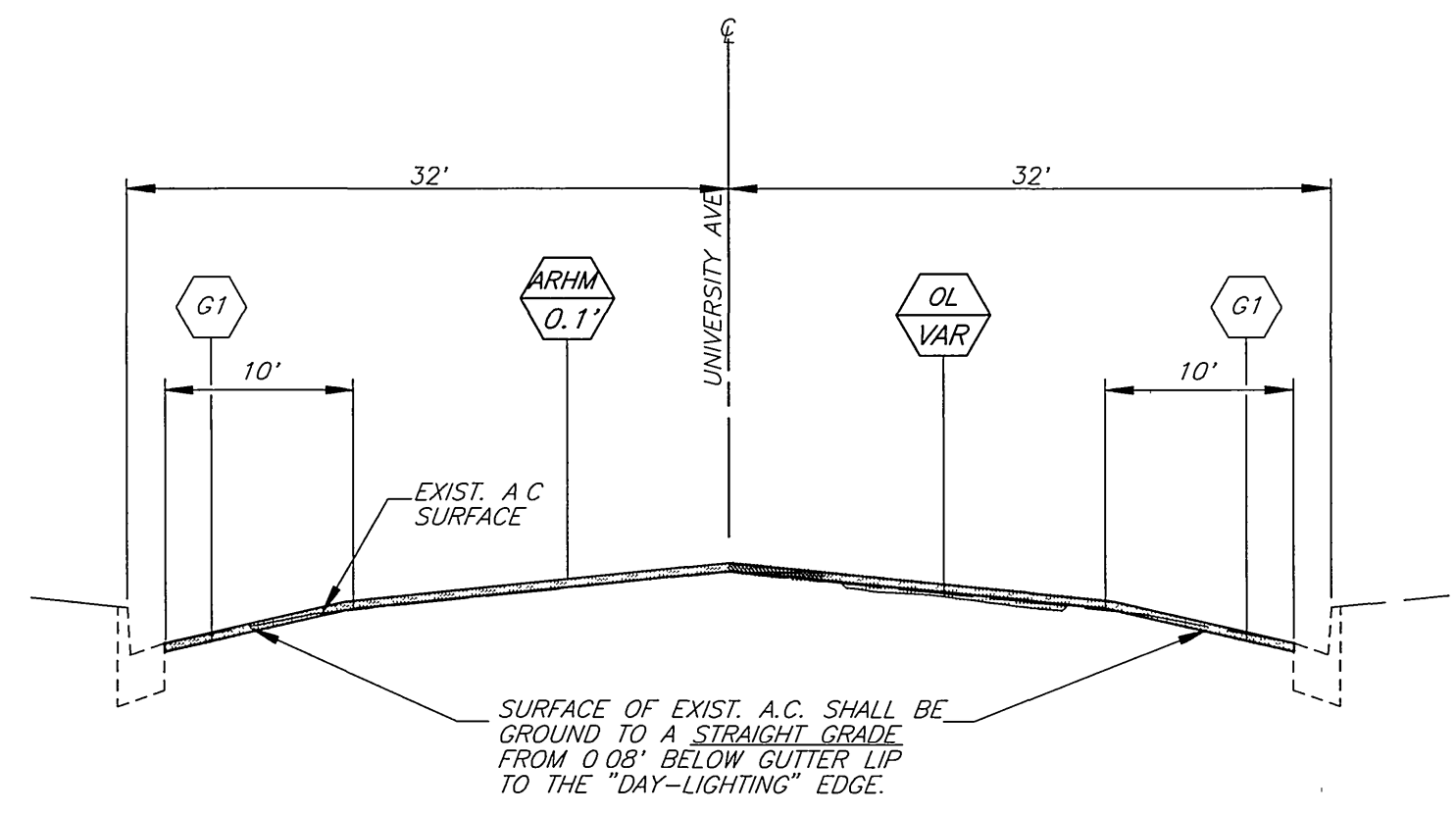
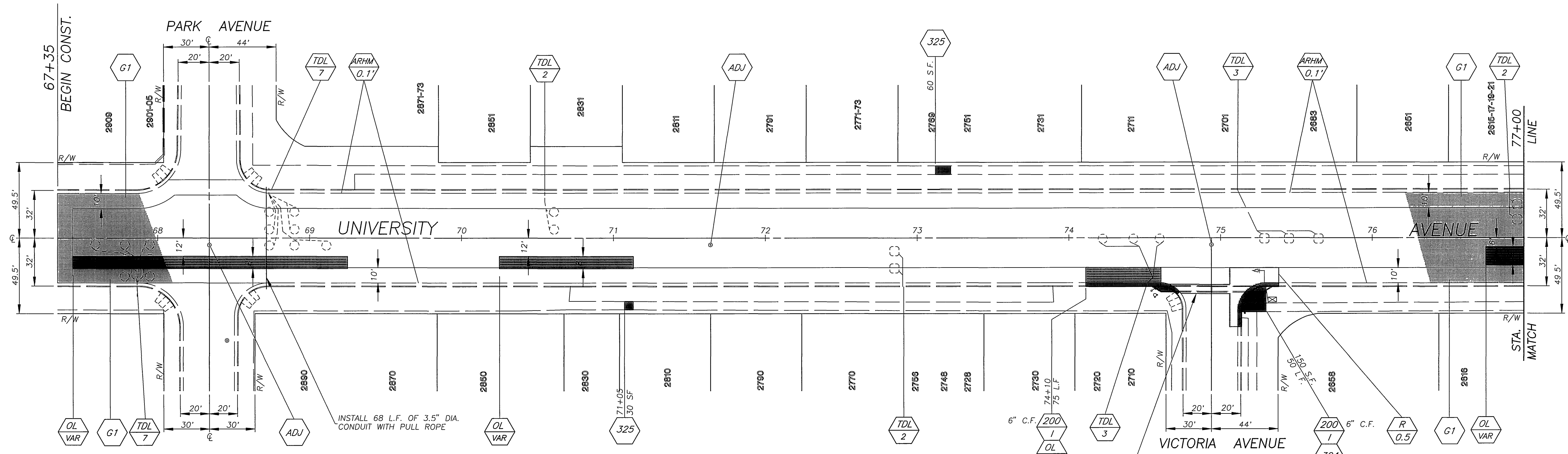

**TYPICAL SECTION UNIVERSITY AVENUE  
PARK TO EUCALYPTUS**  
SCALE: HORIZ. 1" = 10'  
VERT. 1" = 2'

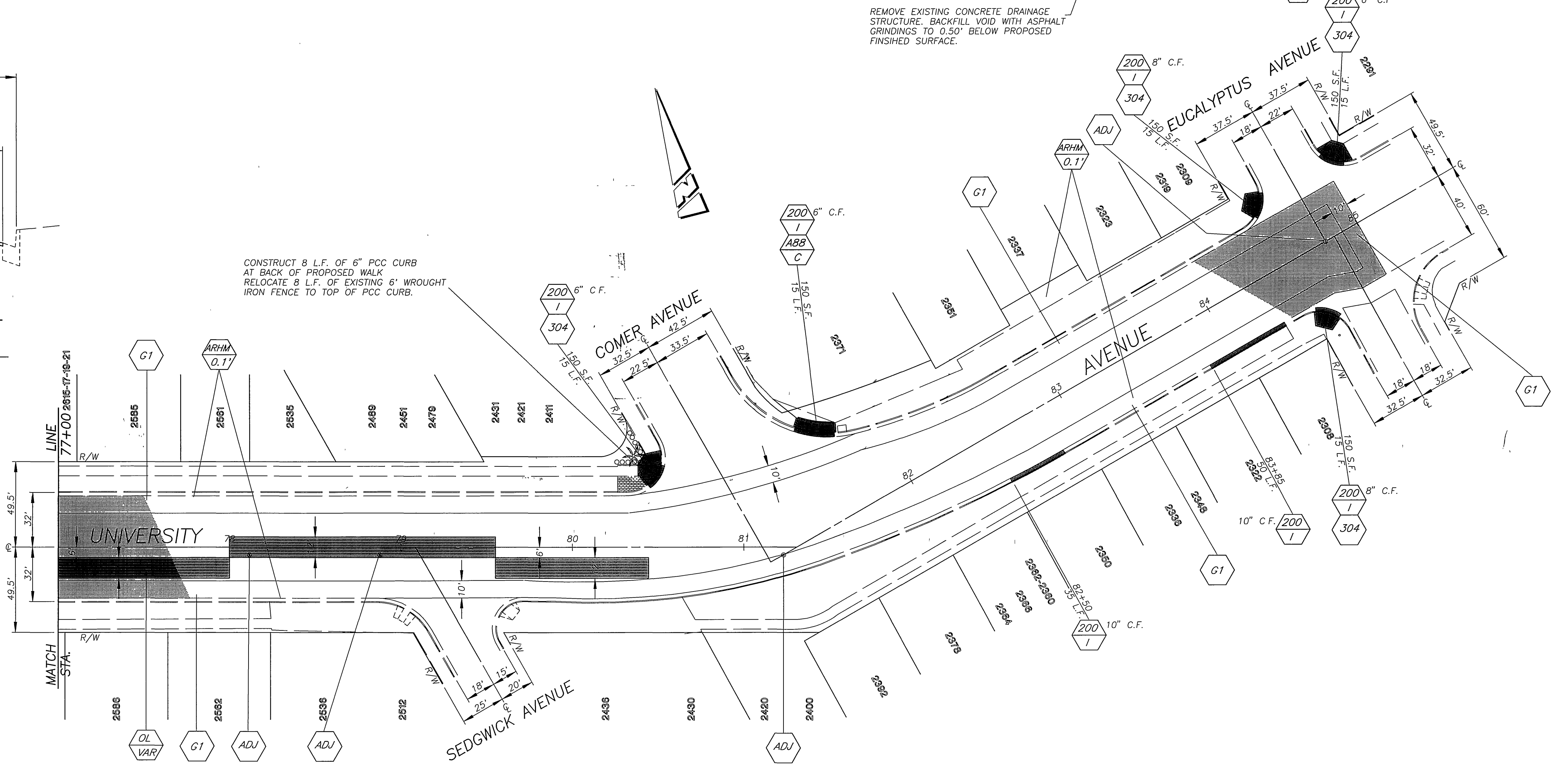

QUANTITIES FOR UNIVERSITY AVENUE			
ITEM	QUANTITY	ITEM	QUANTITY
COLD MILLING-TYPE I (10' WIDE)	3,670 L.F.	TRAFFIC SIGNAL DETECTOR LOOP	26 EA.
CRACK FILL	3,600 L.F.	ADJUST WATER VALVE FRAME & COVER	10 EA.
CRACK REPAIR	0 L.F.	RAISED REFLECTIVE PAVEMENT MARKER	6 EA.
R&R C&G, STD. 200, TYPE I (6" C.F.)	170 L.F.	ASPHALT-RUBBER HOT MIX-GG (0.10')	890 TONS
R&R C&G, STD. 200, TYPE I (8" C.F.)	30 L.F.	DGAC LEVELING COURSE	95 TONS
R&R C&G, STD. 200, TYPE I (10" C.F.)	85 L.F.		
CONST. PCC CURB STD 200, TYPE II	8 L.F.	PAVEMENT PREPARATION (0.5" THICK)	
R&R P.C.C. SIDEWALK, STD. 325	900 S.F.	STRUCTURAL SECTION REMOVAL	64 C.Y.
ADJUST S.D. & SEWER MANHOLE	7 EA.	BACKFILL FOR STRUCTURE REMOVAL	15 C.Y.
		A.C. PAVEMENT REPLACEMENT (DGAC)	127 TONS

ENGINEER IN RESPONSIBLE CHARGE  
*Lauren F. Caldwell*  
LAUREN F. CALDWELL  
R.C.E. No. 39441 expires 12/31/01  
DATE 7/7/98

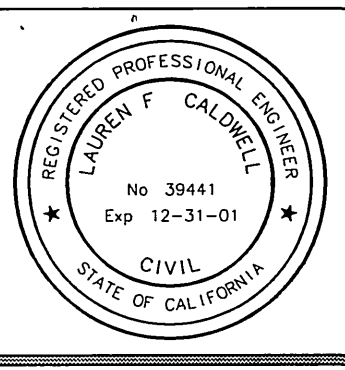

DESIGNED BY: R.V.Z. DRAWN BY: R.J.M. CHECKED BY: [Signature]

CITY OF RIVERSIDE, CALIFORNIA  
PUBLIC WORKS DEPARTMENT  
APPROVED BY: [Signature] R. Mc Guire  
PRINCIPAL ENGINEER  
DATE: 8-27-98

REHABILITATION OF ARTERIAL STREETS 1997-98 STPL-5058 (050)  
UNIVERSITY AVENUE PARK TO EUCALYPTUS  
HORIZ. SCALE: 1" = 40'  
ACCT NO 430-541500-440125-30039  
**R-3490**  
SHEET 8 OF 11  
FILE NO VROB\DWG\R3490\UNI

INDEXED 2-11-99 L/H



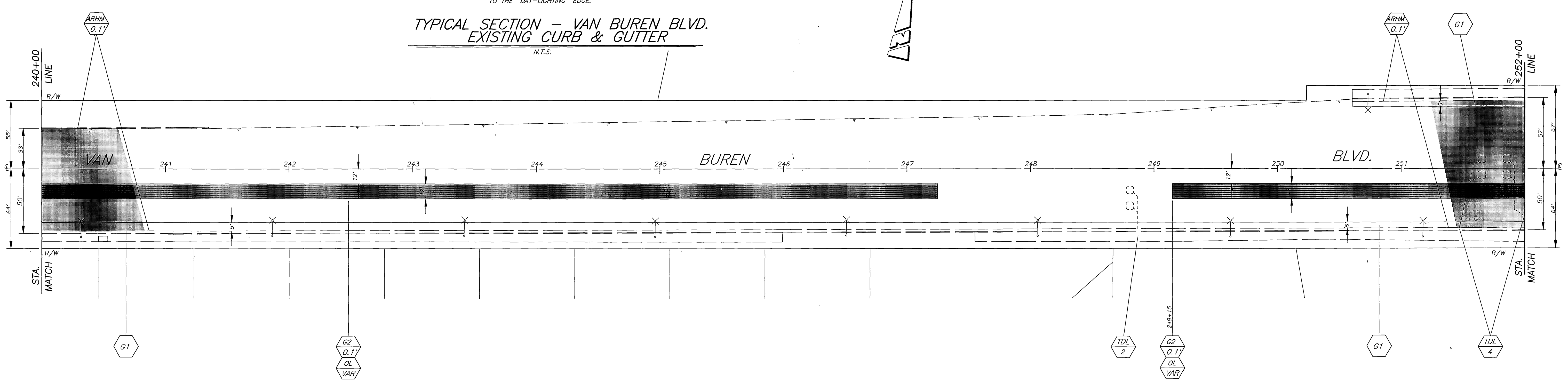
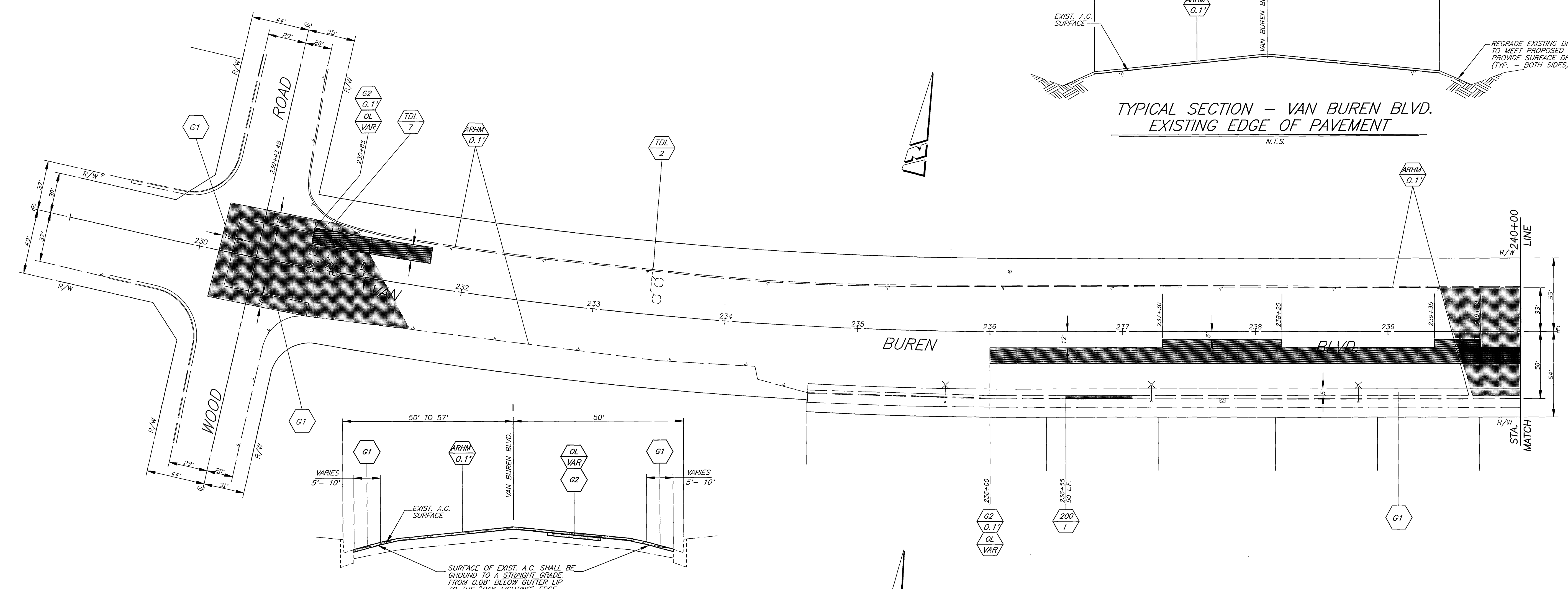
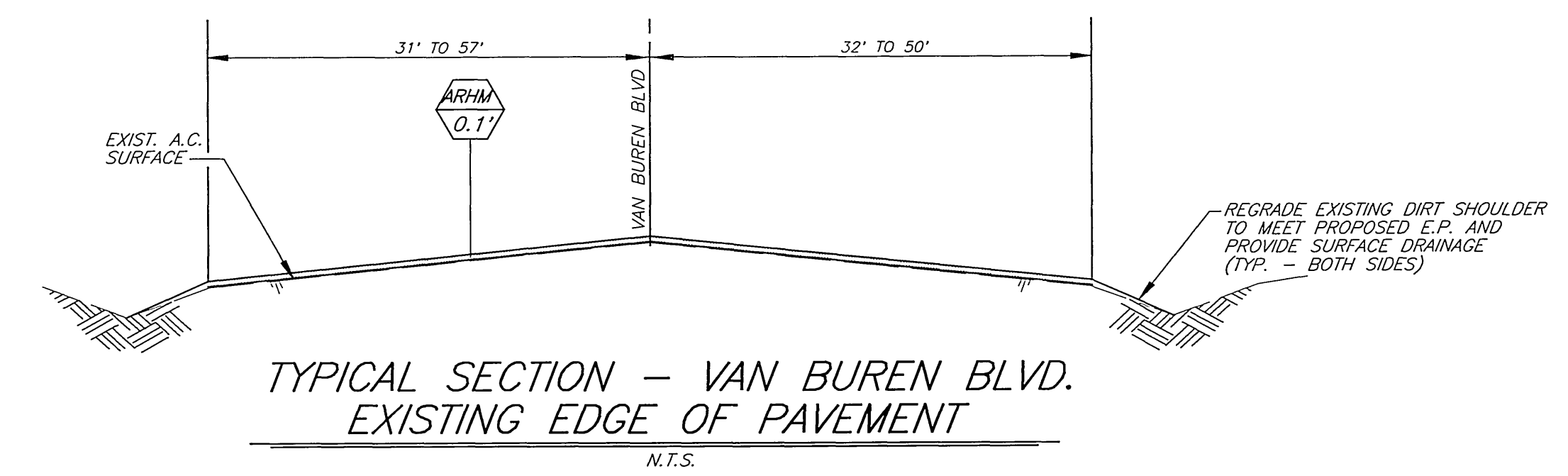

QUANTITIES FOR VAN BUREN BOULEVARD			
ITEM	QUANTITY	ITEM	QUANTITY
GOLD MILLING-TYPE 1 (5' WIDE)	7,360 L.F.	TRAFFIC SIGNAL DETECTOR LOOP	44 EA.
GOLD MILLING-TYPE 1 (10' WIDE)	885 L.F.	ADJUST WATER VALVE FRAME & COVER	0 EA.
CRACK FILL	10,000 L.F.	TWO WAY BLUE REFLECTIVE HYDRANT MARKER	0 EA.
CRACK REPAIR	200 L.F.	ASPHALT-RUBBER HOT MIX-GG (0.10')	3,920 TONS
R&R CURB & GUTTER, STD 200, TYPE 1	50 L.F.	DGAC LEVELING COURSE	155 TONS
P.C.C. SIDEWALK, STD. 325	0 S.F.		
R&R P.C.C. SIDEWALK, STD 325	0 S.F.	PAVEMENT PREPARATION (0.8" THICK)	0 EA.
WHEELCHAIR RAMP	0 EA.	A.C. PAVEMENT REMOVAL	1,150 C.Y.
ADJUST S.D. & SEWER MANHOLE	3 EA.	A.C. PAVEMENT REPLACEMENT (DGAC)	2,300 TONS
ADJUST ELECTRIC VAULT	1 EA.		

RIVERSIDE COUNTY  
TRANSPORTATION DEPARTMENT  
*David S. Beckwith*  
DIRECTOR OF TRANSPORTATION DEPT.  
DATE 8/29/98

ENGINEER IN RESPONSIBLE CHARGE  
*Lauren F. Caldwell*  
LAUREN F. CALDWELL  
R.C.E. No. 39441 expires 12/31/01  
DATE 7/1/00

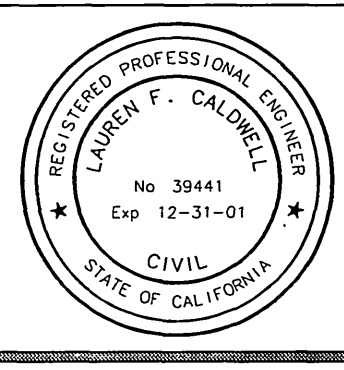

MARK	REVISIONS	APPR.	DATE

DESIGNED BY RVZ DRAWN BY RJM CHECKED BY [Signature]

CITY OF RIVERSIDE, CALIFORNIA  
PUBLIC WORKS DEPARTMENT  
APPROVED BY [Signature] DATE 8-27-98  
PRINCIPAL ENGINEER  
CHIEF P.W. INSPECTOR  
TRAFFIC DIVISION  
SURVEYOR  
STREET SERVICES  
PARKS DEPARTMENT

REHABILITATION OF ARTERIAL  
STREETS 1997-98: STPL-5058 (050)  
VAN BUREN BLVD.  
WOOD ROAD TO BARTON ROAD  
HORIZ. SCALE: 1" = 40'

ACCT. NO. 430-541500-440125-30039  
**R-3490**  
SHEET 9 OF 11  
FILE NO.

INDEXED 2-11-99 4H

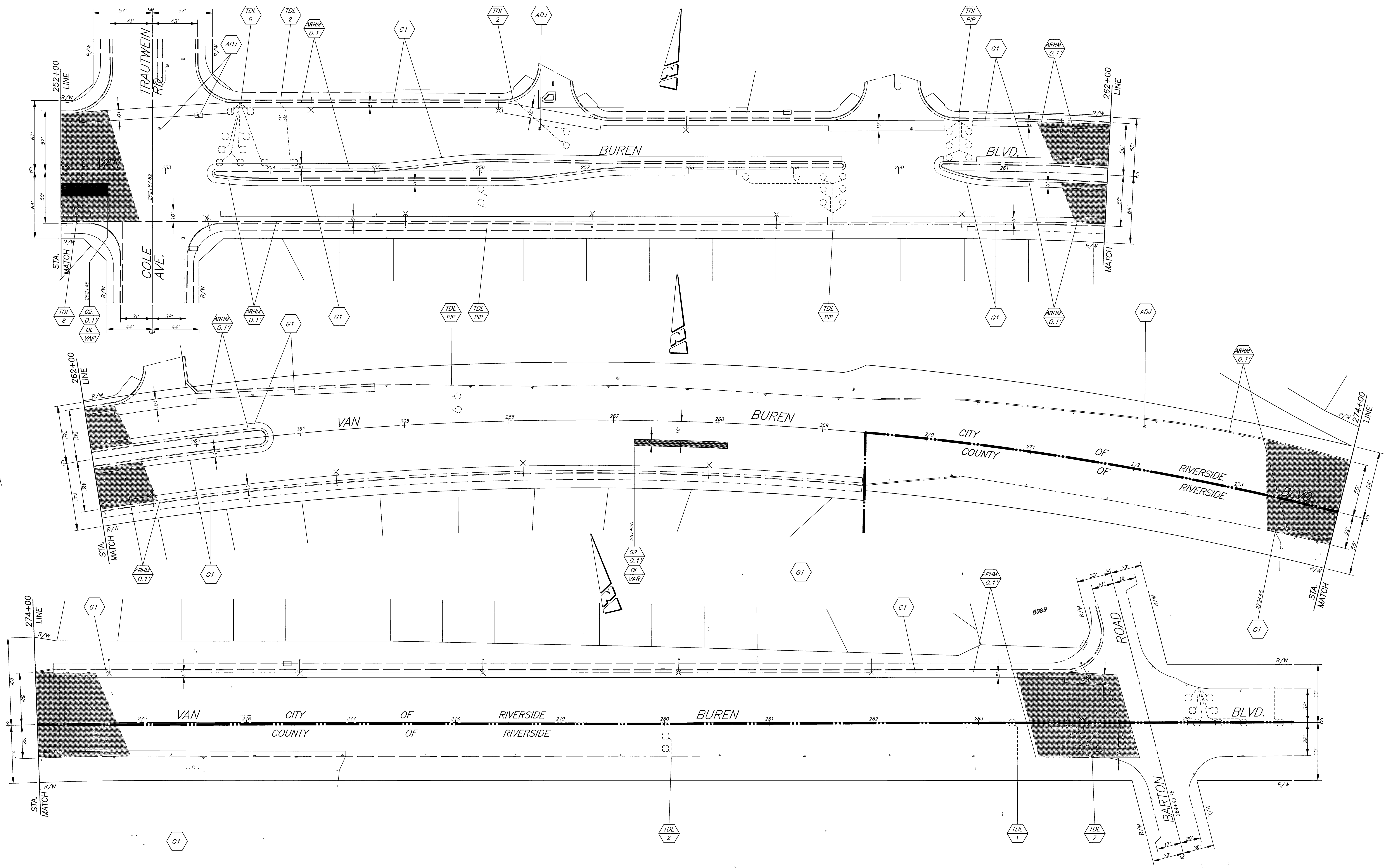

RIVERSIDE COUNTY  
TRANSPORTATION DEPARTMENT  
*Neil S. Bandhart*  
DIRECTOR OF TRANSPORTATION DEPT.  
DATE 8/22/98

ENGINEER IN  
RESPONSIBLE CHARGE  
*Lauren F. Caldwell*  
LAUREN F. CALDWELL  
R.C.E. No 39441 expires 12/31/01  
DATE 7/2/98

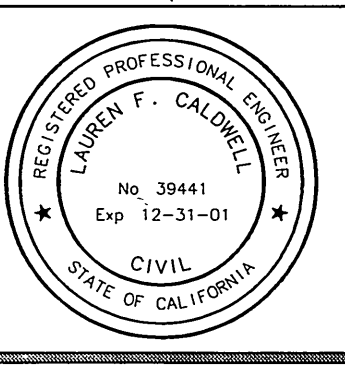

MARK	REVISIONS	APPR.	DATE

DESIGNED BY: RVZ DRAWN BY: RJM CHECKED BY: [Signature]

CITY OF RIVERSIDE, CALIFORNIA  
PUBLIC WORKS DEPARTMENT

APPROVED BY	BY	DATE	APPROVED BY
ENGINEERING MANAGER	[Signature]	8/22/98	PUBLIC WORKS DIRECTOR
PRINCIPAL ENGINEER	[Signature]	8/22/98	
CHIEF P.W. INSPECTOR	[Signature]	8/22/98	
TRAFFIC DIVISION	[Signature]	8/22/98	
SURVEYOR	[Signature]	8/22/98	
STREET SERVICES	[Signature]	8/22/98	
PARKS DEPARTMENT	[Signature]	8/22/98	

REHABILITATION OF ARTERIAL  
STREETS 1997-98 STPL-5058 (250)  
VAN BUREN BLVD.  
WOOD ROAD TO BARTON ROAD  
HORIZ. SCALE: 1" = 40'

ACCT. NO 430-541500-440125-30039  
**R-3490**  
SHEET 10 OF 11  
FILE NO.

INDEXED 2-11-99 L/H

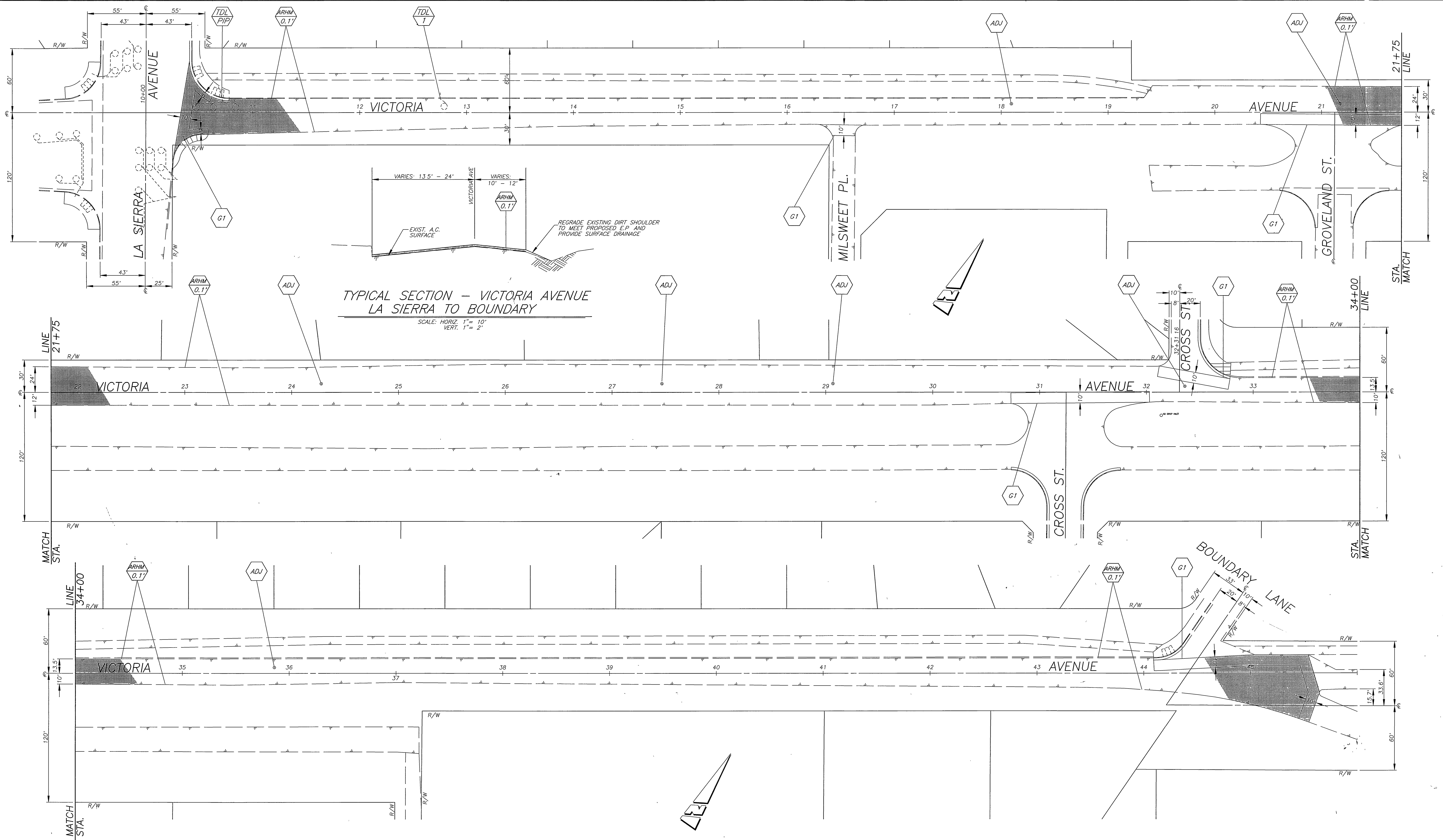

TYPICAL SECTION - VICTORIA AVENUE  
LA SIERRA TO BOUNDARY

SCALE: HORIZ. 1" = 10'  
VERT. 1" = 2'

QUANTITIES FOR VICTORIA AVENUE

ITEM	QUANTITY	ITEM	QUANTITY
COLD MILLING-TYPE 1 (5' WIDE)	53 L.F.	TRAFFIC SIGNAL DETECTOR LOOP	1 EA.
COLD MILLING-TYPE 1 (10' WIDE)	503 L.F.	ADJUST WATER VALVE FRAME & COVER	13 EA.
CRACK FILL	3,600 L.F.	RAISED REFLECTIVE PAVEMENT MARKER	3 EA.
ADJUST S.D. & SEWER MANHOLE	7 EA.	ASPHALT-RUBBER HOT MIX-GG (0.10')	900 TONS
R&R AC BERM	150 L.F.		
		PAVEMENT PREPARATION (0.5' THICK)	
		STRUCTURAL SECTION REMOVAL	455 C Y
		A.C. PAVEMENT REPLACEMENT (DGAC)	920 TONS

ENGINEER IN RESPONSIBLE CHARGE  
*Lauren F. Caldwell*  
LAUREN F. CALDWELL  
R.C.E. No 39441 expires 12/31/01  
DATE 7/2/98

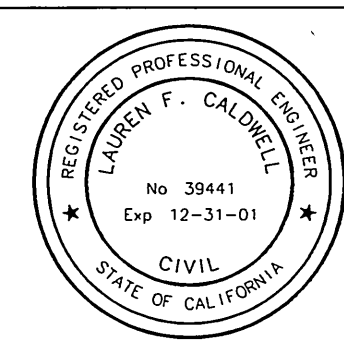

MARK	REVISIONS	APPR.	DATE

CITY OF RIVERSIDE, CALIFORNIA  
PUBLIC WORKS DEPARTMENT

APPROVED BY	BY	DATE	APPROVED BY
ENGINEERING MANAGER	<i>R.M. Kell</i>		PUBLIC WORKS DIRECTOR
PRINCIPAL ENGINEER			
CHIEF P.W. INSPECTOR			
TRAFFIC DIVISION SURVEYOR			
STREET SERVICES			
PARKS DEPARTMENT			

DESIGNED BY R.V.Z. DRAWN BY R.J.M. CHECKED BY

REHABILITATION OF ARTERIAL STREETS 1997-98 STPL-5058 (050)

VICTORIA AVENUE  
LA SIERRA AVE TO BOUNDARY LN.

HORIZ. SCALE: 1" = 40'

ACCT. NO 430-541500-440425-30039

**R-3490**

SHEET 11 OF 11

FILE NO. VROB(DWG)R3490VIC

INDEXED 2-11-99 LTH