

ON GRID MADE IN N.E.Y.  
DIMENSIONS IN FEET

ENGINEER DESIGN CO.  
BY V.L. W.  
REGISTERED ENGINEER

ON GRID MADE IN N.E.Y.  
DIMENSIONS IN FEET

ENGINEER DESIGN CO.  
BY V.L. W.  
REGISTERED ENGINEER

ON GRID MADE IN N.E.Y.  
DIMENSIONS IN FEET

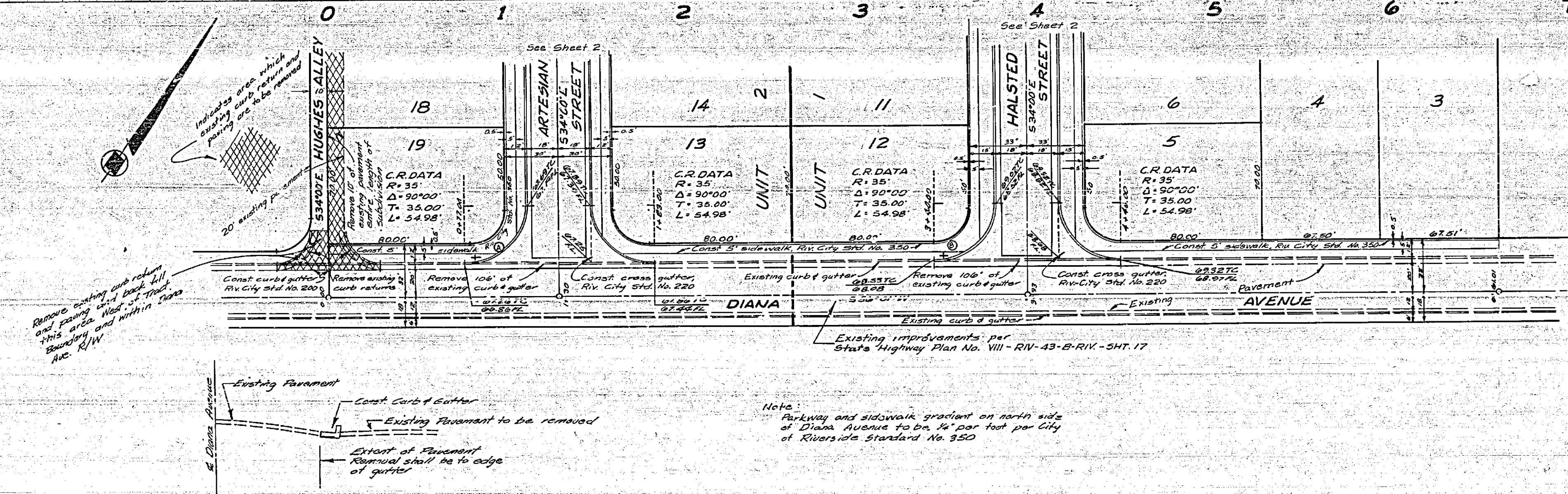
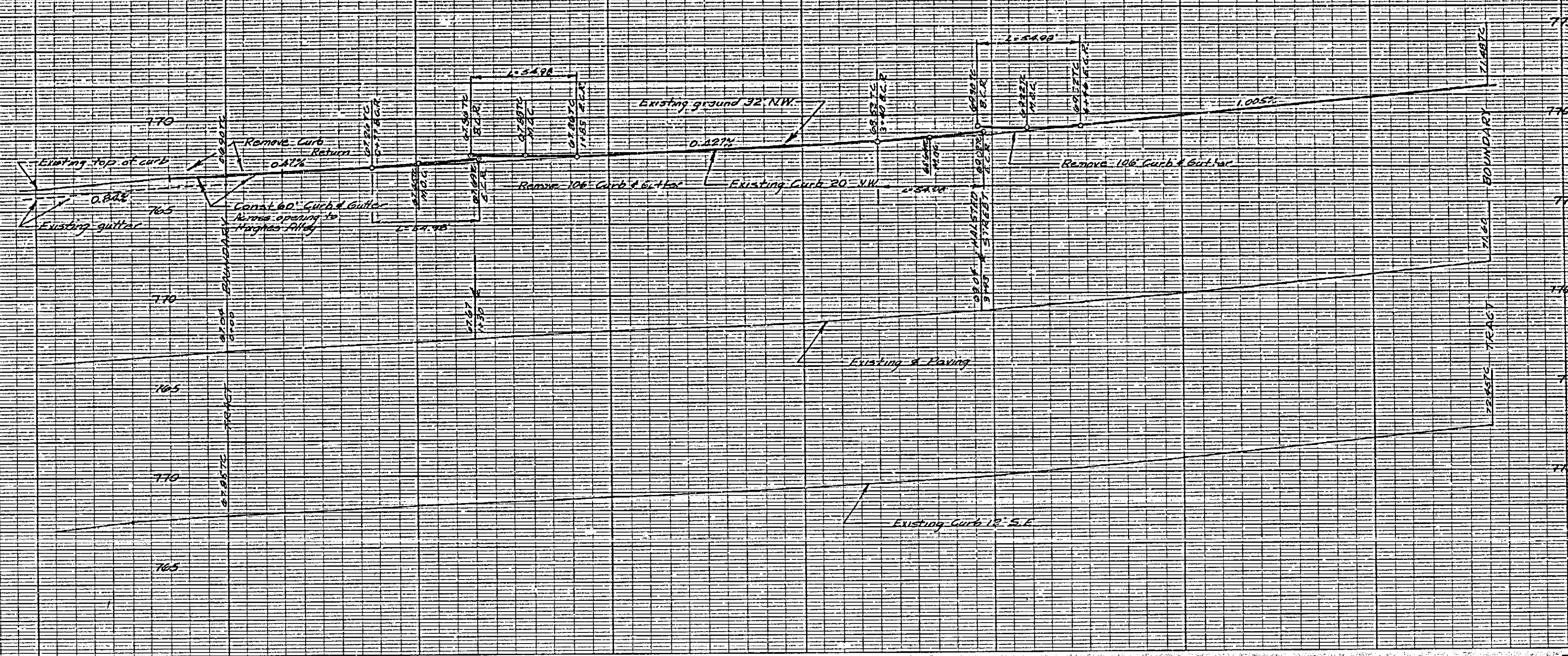

**NOTE**  
If the subdivider desires to reduce requirements on import base material, additional soil tests may be taken at subdividers expense after streets are prepared to rough grade. Subdivider will contact Inspection Division, City of Riverside, before making tests. The City of Riverside will make a test of base material in place. Before paving can be installed, results of this test must indicate that the base material is satisfactory to the Inspection Division.

Concrete removals to be made with a saw cut.

**STREET NAME SIGN SCHEDULE**

LOC	STREET NAME	BLOCK NO.	COR.
A	DIANA AVENUE	10000	N.W.
A	ARTESIAN STREET	3400	N.W.
B	DIANA AVENUE	10000	N.W.
B	HALSTEAD STREET	3400	N.W.

Street Name Signs and Posts to be furnished and installed by Subdivider as per City of Riverside Specs and Std. Draw. No. 652

**Note:**  
Parkway and sidewalk gradient on north side of Diana Avenue to be 1/4" per foot per City of Riverside Standard No. 350

**BENCH MARK**  
Subdiv. set in 140' 25" from west SWly side Hughes Alley W. of Diana Street  
ELEV. 772.81

**J. F. DAVIDSON - CIVIL ENGINEER**  
R.E. NO. 982  
RIVERSIDE, CALIFORNIA  
APPROVED BY: [Signature] DATE 1-18-60

**CITY OF RIVERSIDE, CALIFORNIA**  
DEPARTMENT OF PUBLIC WORKS

**STREET PLAN & PROFILE**  
**DIANA AVENUE**  
UNITS 11 AND 12  
DIANA SUBDIVISION

HORIZ. SCALE 1" = 40' VERT. SCALE 1" = 4'

APPROVED BY: [Signature] NO. **R-350**  
Director of Public Works  
DATE 1-18-60 SHEET 1 OF 2

ENGINEER DIANE CO  
BY V. V.  
REGISTERED

ON GRAIN MADE IN U.S.A.  
PRINTED IN U.S.A.

ENGINEER DIANE CO  
BY V. V.  
REGISTERED

ON GRAIN MADE IN U.S.A.  
PRINTED IN U.S.A.

ENGINEER DIANE CO  
BY V. V.  
REGISTERED

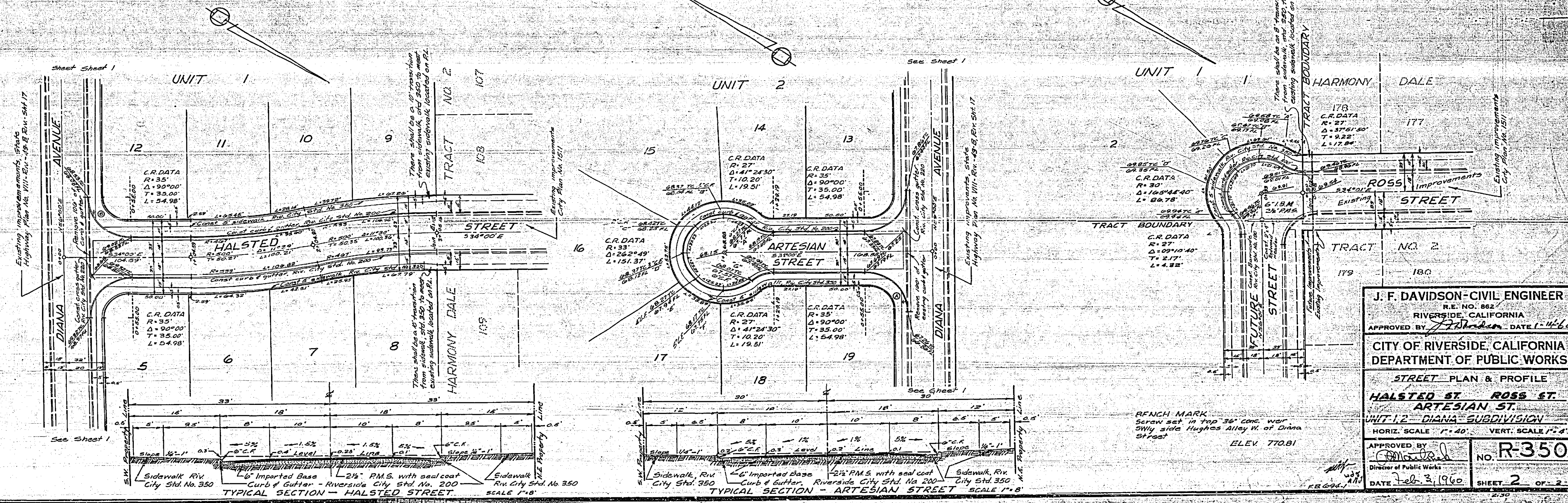
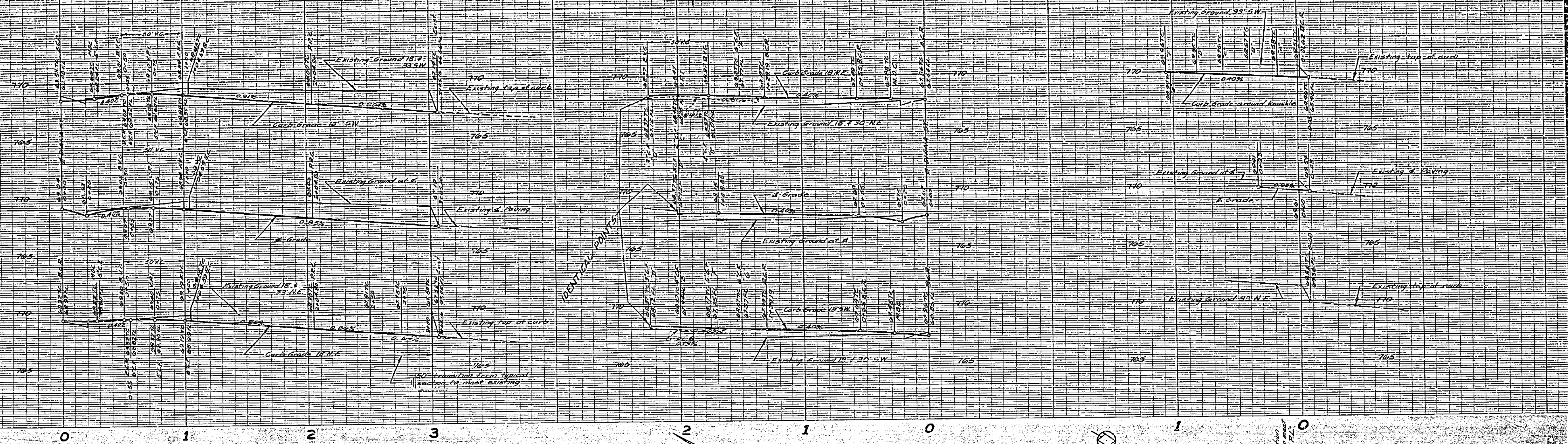

Sheet Sheet 1  
UNIT 1  
12 11 10 9 8 7 6 5  
C.R. DATA  
R=35  
Δ=90°00'  
T=35.00'  
L=54.98'

UNIT 2  
14 13 15 16 17 18 19  
C.R. DATA  
R=27  
Δ=90°00'  
T=35.00'  
L=54.98'

UNIT 1  
178 177  
C.R. DATA  
R=27  
Δ=90°00'  
T=35.00'  
L=54.98'

UNIT 1  
179 180  
C.R. DATA  
R=30  
Δ=108°45'  
T=58.78'  
L=84.98'

**J. F. DAVIDSON - CIVIL ENGINEER**  
R.E. NO. 882  
RIVERSIDE, CALIFORNIA  
APPROVED BY *J. Davidson* DATE 1-14-60  
CITY OF RIVERSIDE, CALIFORNIA  
DEPARTMENT OF PUBLIC WORKS

**STREET PLAN & PROFILE**  
**HALSTED ST ROSS ST**  
**ARTESIAN ST**  
UNIT 1, 2 - DIANA SUBDIVISION  
HORIZ. SCALE 1"=40' VERT. SCALE 1"=4'  
APPROVED BY *[Signature]* NO. **R-350**  
DIRECTOR OF PUBLIC WORKS  
DATE Feb. 3, 1960 SHEET 2 OF 2

TYPICAL SECTION - HALSTED STREET  
Scale 1"=8'

TYPICAL SECTION - ARTESIAN STREET  
Scale 1"=8'

BENCH MARK  
Screw set in top 36" conc. wall  
City side Hughes Alley W. of Diana  
St 1781  
ELEV 770.81