

R DATA:

11+30.00'
11+32.50'
11+35.00'

CURB CURVE DATA:

11+36.00'
11+38.00'
11+40.00'
11+42.00'

C DATA:

11+36.00'
11+38.00'
11+40.00'
11+42.00'

CURB RETURN DATA:

11+36.00'
11+38.00'
11+40.00'
11+42.00'

NOTE: CURB CURVES ARE NOT CONCENTRIC.

CURB RETURN DATA:

11+38.00'
11+40.00'
11+42.00'
11+44.00'

CURB CURVE DATA:

11+38.00'
11+40.00'
11+42.00'
11+44.00'

R DATA:

11+36.00'
11+38.00'
11+40.00'
11+42.00'

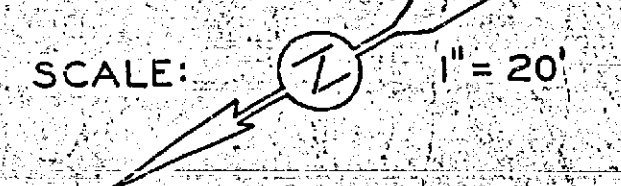
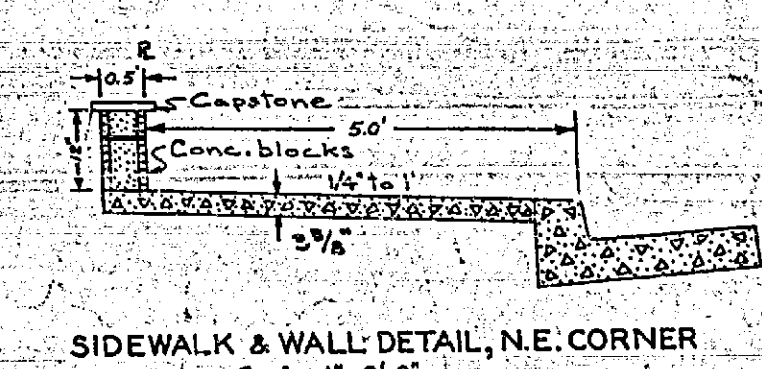
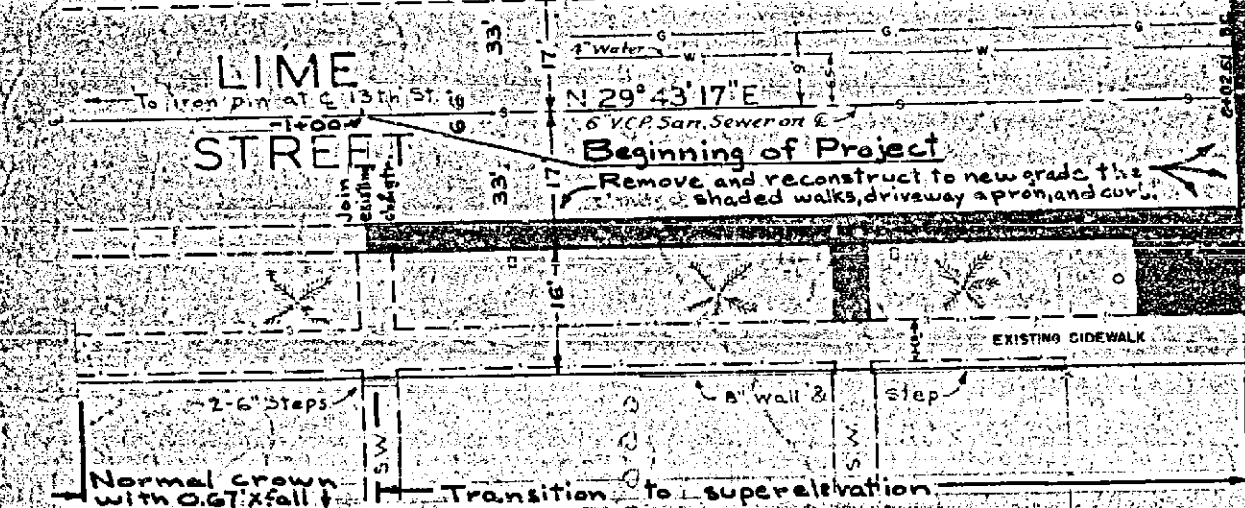

- Notes:**
- Shading indicates pavement removal. Curb and gutter adjacent to shading is to be removed also. (Except from 3+32.60 to 3+50 Rt.)
 - Six palm trees on northeast corner are to be removed and X'd trees on SE and SW corners.
 - See Plans X-12, X-107, and X-105 (Sheet 3) for traffic signal relocation, and street light relocation.
 - Utilities are to be relocated by utility company or department concerned.
 - Mail drop box is to be relocated by Post Office.
 - Curb and gutter are to be Riverside Std. N#200, 6" c.f. except 8" c.f. from 0+02.61 to 1+48.42 L.T.
 - New pavement is to be 2 1/2" P.M.S. over 6" imported base material.
 - Entire intersection is to be sealed coated from -1+00 to 3+50 of improvement, and from 3+60 to 5+15 of 14th St.
 - Profiles and elevations are on Sheet 2 of 3.
 - Striping is not a part of this project.
 11. 11.000 indicates construction of new sidewalk, except as noted "Not in Contract".
 - Call Madison 2-2221 (Los Angeles) collect 24 hrs. before excavation. Across Tel. Cable.
 - New curb to point of tangency with crown of existing paving. From 0+02.61 to 1+13.72 and from 2+73.50 to 3+52.60. The paving surface shall be a plane (no crown).
- * By contractor

C DATA: FB 599/62
 TOPOGRAPHY FROM PLANE TABLE SURVEY.
 BASIS OF BEARINGS: C OF 14TH STREET, GIVEN AS N 60° 15' 13" W
 ON SHEET II OF FREEWAY RIGHT-OF-WAY PLANS.

APPROVED: *[Signature]* DATE: 1/3/60

REVISIONS

MARK	DATE	DESCRIPTION
10-11-59		CR RETURN CHANGED TO "RD"

CITY OF RIVERSIDE, CALIFORNIA
 DEPARTMENT OF PUBLIC WORKS

PROJECT NO. 92
 INTERSECTION OF
 OLIVEWOOD AVENUE,
 LIME STREET & 14TH STREET

DESIGNED BY W.D.G. H.B. CHECKED BY J.J.A.
 DRAWN BY W.D.G. H.B. DIRECTOR OF PUBLIC WORKS
 RECOMMENDED BY *[Signature]* DATE: 11-6-59 ASSISTANT CITY ENGINEER

R-354

SHEET 1 OF 5

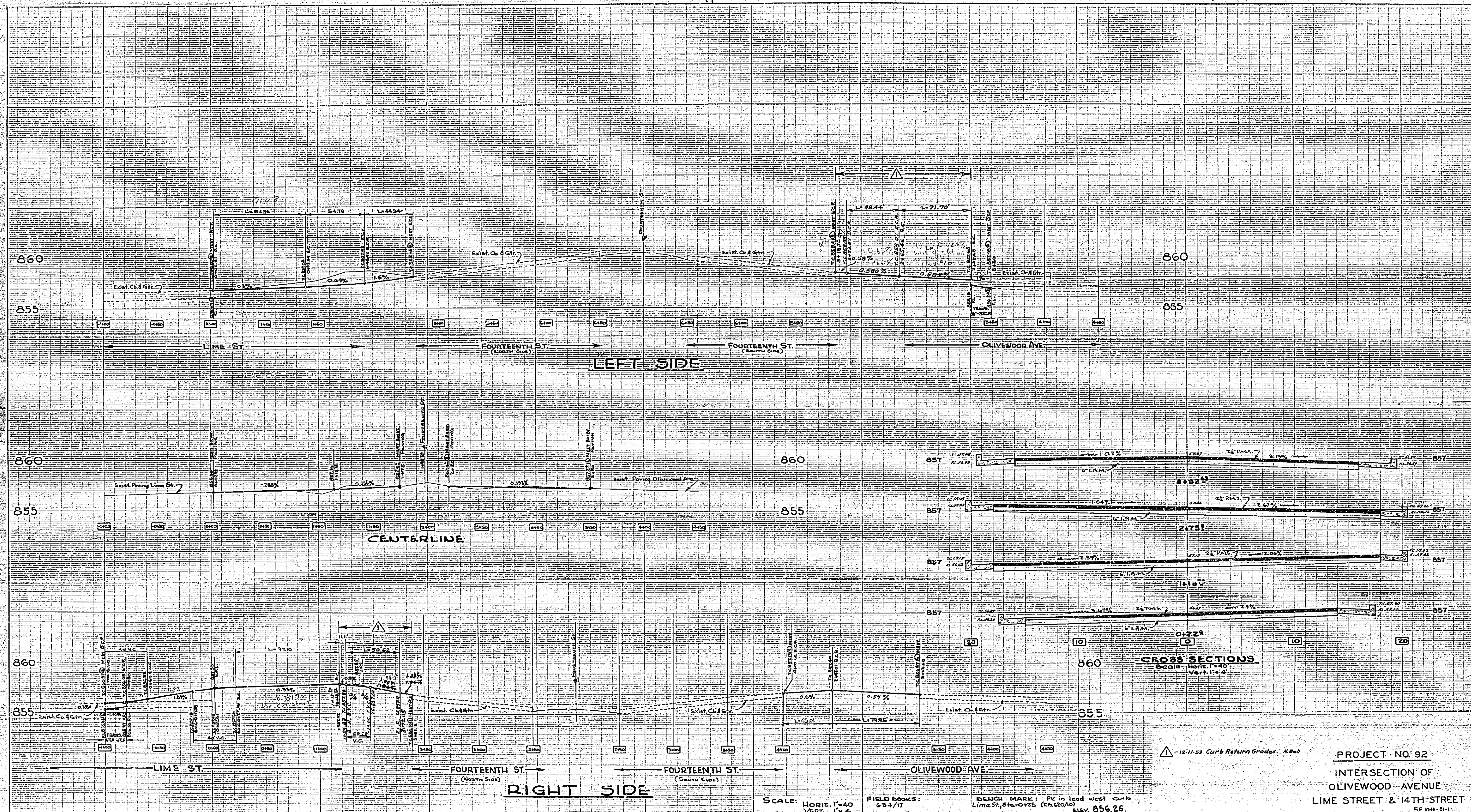

PROJECT NO. 92
 INTERSECTION OF
 OLIVEWOOD AVENUE
 LIME STREET & 14TH STREET
 REF. 104-B-11

wdg
 dtr
 O.P. Kral
 R.C.E. 8154
 11-6-59
R-354
 2-5

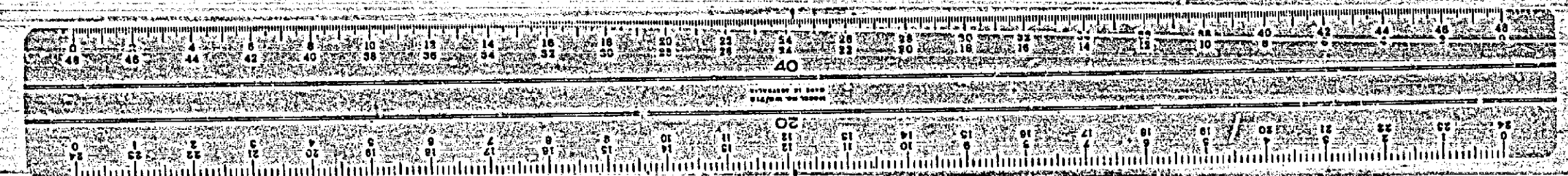

WORK AT THIS LOCATION CONSISTS OF REVISIONS TO EXISTING SIGNALS,
REPLACING CONTROLLER, AND INSTALLING INTERCONNECT DUCT

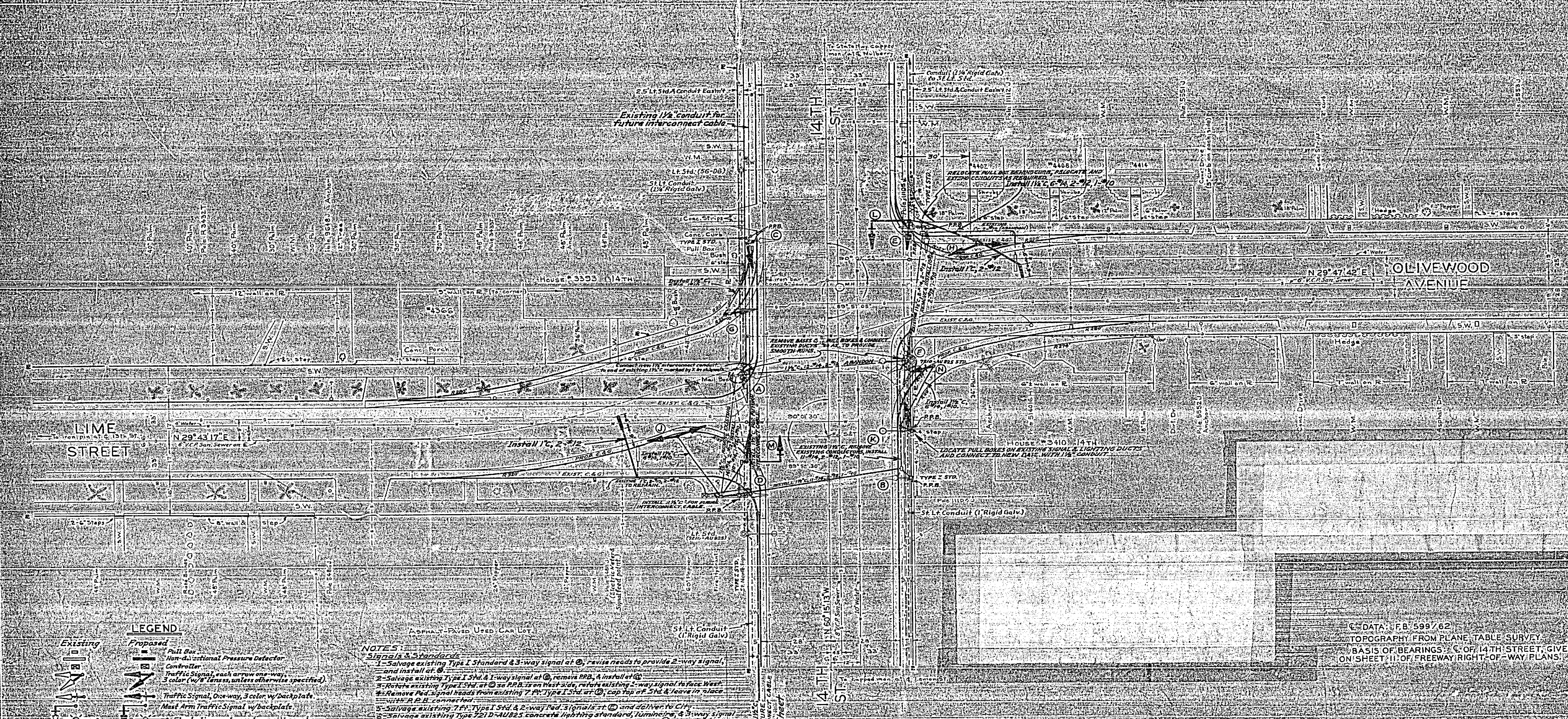

NOTES

- 1-Salvage existing Type I Standard 3-way signal at (A), revise heads to provide 2-way signal, and install at (B).
- 2-Salvage existing Type I Std. 1-way signal at (C), remove P.R.B., & install at (D).
- 3-Relocate existing Type I Std. at (E) to P.R.B. on West side, relocate existing 2-way signal to face West.
- 4-Remove Ped. signal heads from existing 7' P.R. Type I Std. at (F), cap top of Std. & leave in place with P.R.B. connected.
- 5-Salvage existing Type I Std. 1-way signal at (G) and deliver to City.
- 6-Salvage existing Type I Std. 2-way signal at (H) and deliver to City.
- 7-Install new Type I Std. 2-way signal at (I). Use 2 signal heads salvaged from (C).
- 8-Install 2 new Type II Std. w/ 5' mast arms at (J) & (K). Install 2 new brackets, mounted signal lenses and 2 new signal heads with 12" Ped. on mast arms. Install new P.R.B. at (L) only.
- 9-Install new Type I Std. 1-way signal at (M). Use signal head salvaged from (C).

Controller

1-Remove existing Type 2 controller & cabinet and deliver to City. City to furnish Type 3P & 2 controller & Type 6 cabinet for installation by the contractor on existing pedestal.

Detectors

1-Relocate existing detectors as shown.

Conduit

1-Use all existing conductors will not be permitted except as noted on plans to remain. Separate PVC loops shall be run from each P.R.B. to controller.

REVISIONS

MARK	DATE	DESCRIPTION
5-1-59		Signal Revisions Added
7-3-59		Major Revision
12-14-59		Major Revision

CITY OF RIVERSIDE, CALIFORNIA
DEPARTMENT OF PUBLIC WORKS

PROJECT NO. 92
TRAFFIC SIGNALS
OLIVEWOOD AVENUE
LIME STREET & 14TH STREET

DESIGNED BY: [Signature]
DRAWN BY: [Signature]
CHECKED BY: [Signature]
RECOMMENDED BY: [Signature]
DATE: 11-10-59

APPROVED BY: [Signature]
DIRECTOR OF PUBLIC WORKS
DATE: 11-10-59

R-354

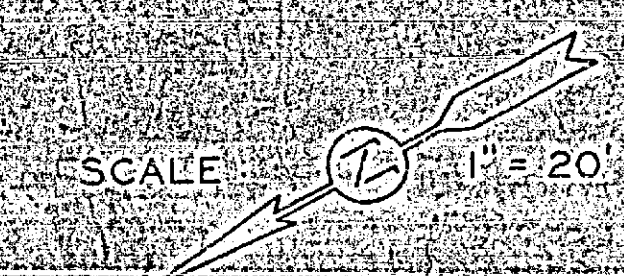

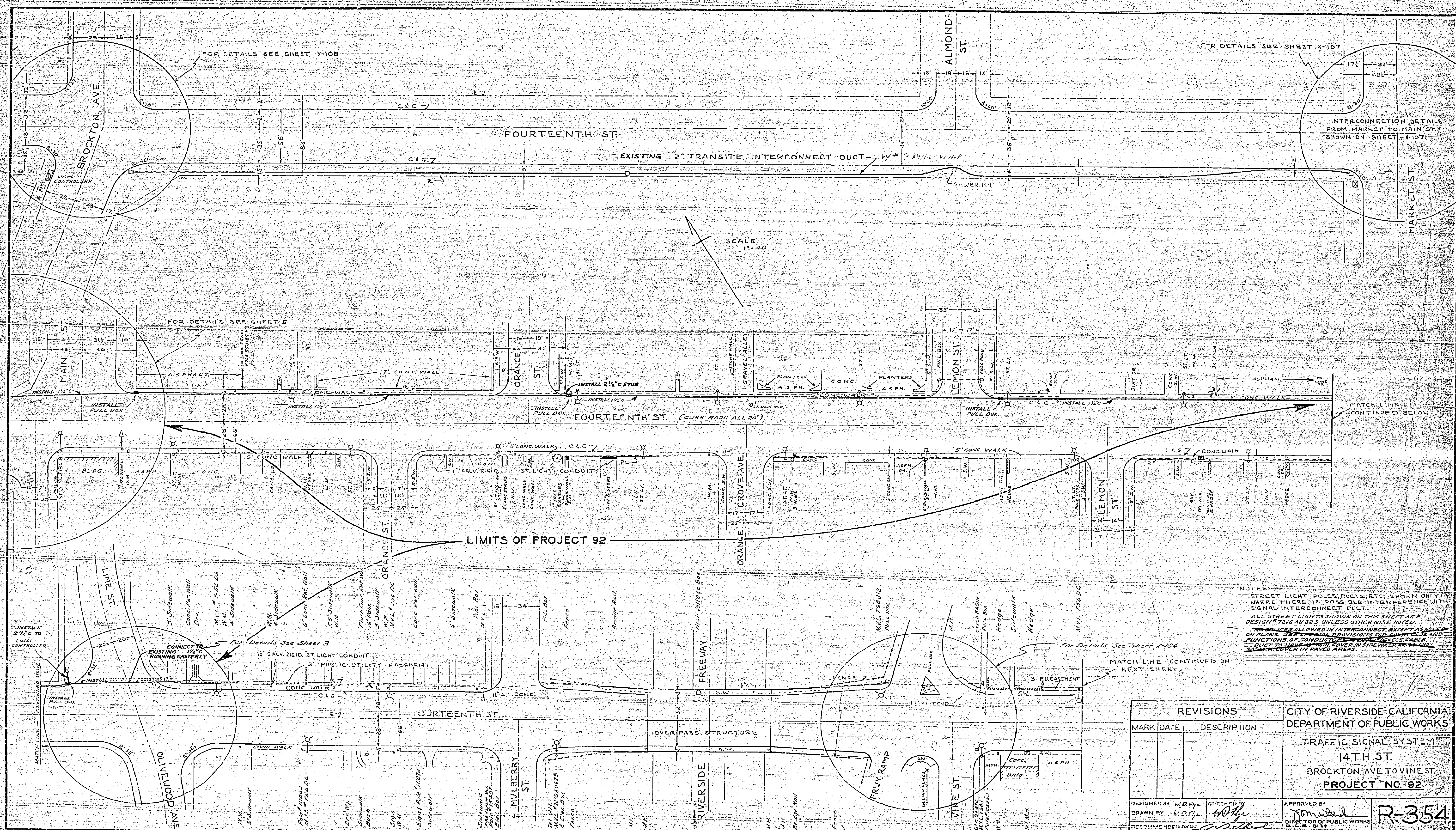

SCALE 1"=40'

FOR DETAILS SEE SHEET X-107

INTERCONNECTION DETAILS FROM MARKET TO MAIN ST. SHOWN ON SHEET X-107

FOR DETAILS SEE SHEET X-108

FOR DETAILS SEE SHEET X-109

MATCH LINE CONTINUED BELOW

LIMITS OF PROJECT 92

NOTES
 STREET LIGHT POLES, DUCTS, ETC. SHOWN ONLY WHERE THERE IS POSSIBLE INTERFERENCE WITH SIGNAL INTERCONNECT DUCT.
 ALL STREET LIGHTS SHOWN ON THIS SHEET ARE DESIGN 7550-04-02 UNLESS OTHERWISE NOTED.
 TO SIGNALS ALLOWED IN INTERCONNECT, EXCEPT AS NOTED ON PLANS. SEE SPECIAL PROVISIONS FOR SIGNALS AND FUNCTIONS OF CONDUITS AND INTERCONNECT DUCT TO BE COVERED IN SIDEWALKS AND IN DRIVEWAYS IN PAVED AREAS.

REVISIONS		CITY OF RIVERSIDE - CALIFORNIA DEPARTMENT OF PUBLIC WORKS
MARK	DATE	
		TRAFFIC SIGNAL SYSTEM 14TH ST. BROCKTON AVE TO VINE ST. PROJECT NO. 92
DESIGNED BY	W.D.F.	APPROVED BY <i>[Signature]</i> DIRECTOR OF PUBLIC WORKS
DRAWN BY	K.C.F.	
RECOMMENDED BY	<i>[Signature]</i>	DATE 11-6-54
		ASSISTANT CITY ENGINEER

R-354
SHEET 4 OF 5

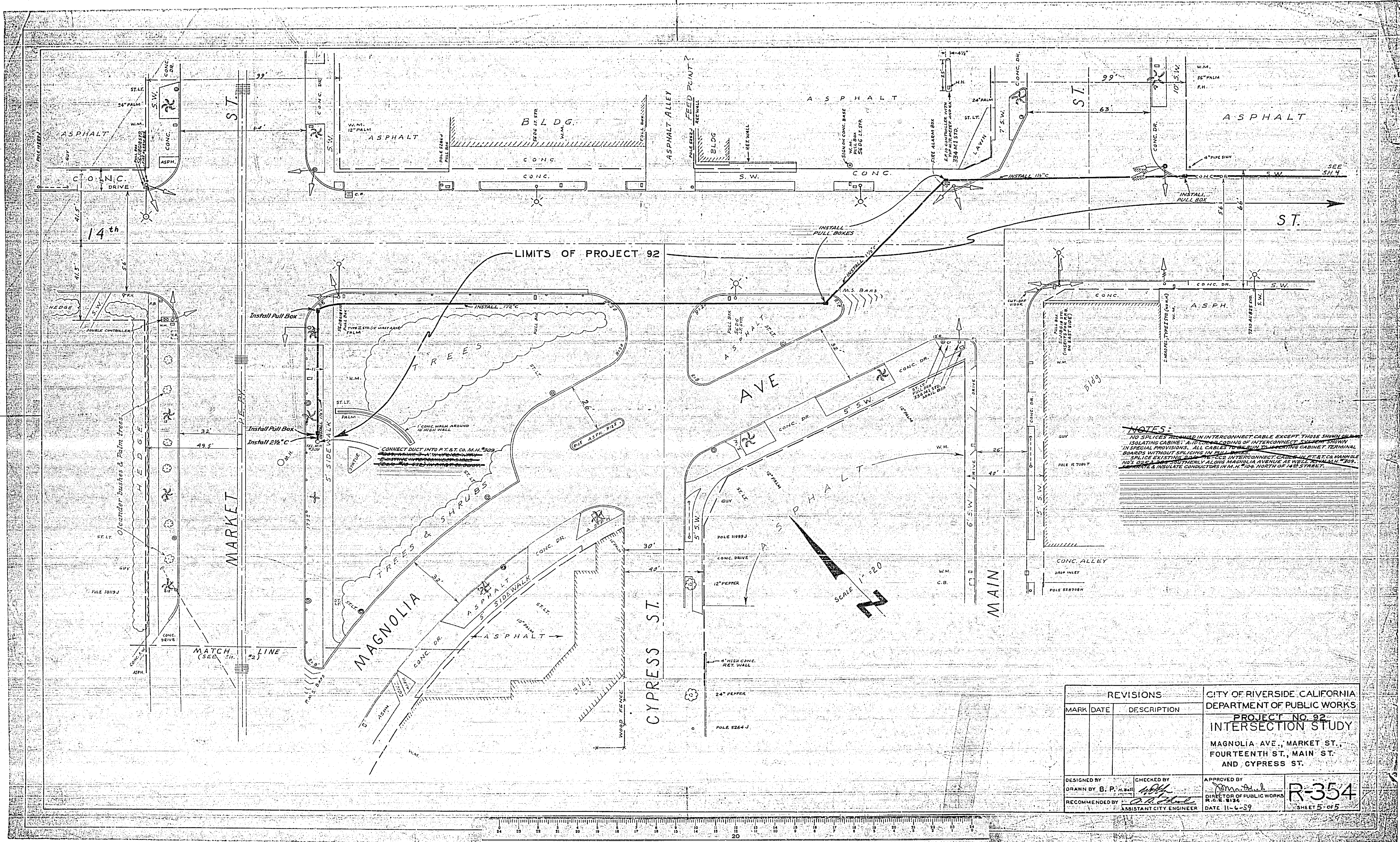

NOTES:
 NO SPLICES PERMITTED IN INTERCONNECT CABLE EXCEPT THOSE SHOWN IN SPECIAL PROVISIONS. ALL CABLES TO BE RUN TO INTERCONNECT CABINET TERMINAL BOARDS WITHOUT SPLICES IN PULL BOXES.
 SPLICE EXISTING BETWEEN INTERCONNECT CABLES IN P.T. & T. CO. MAINLINE NO. 508 & 509 AUTHORITY ALONG MAGNOLIA AVENUE AS PER P.T. & T. CO. 508 & 509.
 WIRE & INSULATE CONNECTORS IN M.H. TUBS NORTH OF 14th STREET.

REVISIONS			CITY OF RIVERSIDE, CALIFORNIA DEPARTMENT OF PUBLIC WORKS
MARK	DATE	DESCRIPTION	
			PROJECT NO. 92 INTERSECTION STUDY MAGNOLIA AVE., MARKET ST., FOURTEENTH ST., MAIN ST. AND CYPRESS ST.

DESIGNED BY B. P. H. 11-21-57	CHECKED BY <i>[Signature]</i> 11-21-57	APPROVED BY <i>[Signature]</i> DIRECTOR OF PUBLIC WORKS R.C.E. 8134	R-354 SHEET 5 OF 5
RECOMMENDED BY <i>[Signature]</i>	ASSISTANT CITY ENGINEER	DATE 11-6-57	

