

RIVERSIDE CITY OF RIVERSIDE CALIFORNIA

PUBLIC WORKS DEPARTMENT ACCESSIBLE PATHWAY (1999/2000) (PHASE III)

GENERAL CONSTRUCTION NOTES

- 1 EXISTING UTILITIES SHOWN ON THIS PLAN ARE PLOTTED FROM UTILITY RECORDS. THE CONTRACTOR IS REQUIRED TO TAKE DUE PRECAUTIONARY MEASURES TO LOCATE AND PROTECT ALL UTILITIES WHETHER OR NOT SHOWN ON THIS PLAN.
- 2 PRIME CONTRACTORS BIDDING THIS WORK SHALL HAVE A CLASS A, C-8 OR C-12 LICENSE.
- 3 CONFLICTING UTILITIES, SHOWN WITHIN CONSTRUCTION AREA, WILL BE RELOCATED PRIOR TO CONSTRUCTION.
- 4 RIGHTS OF ENTRY HAVE BEEN OBTAINED FOR WORK SHOWN OUTSIDE OF CITY RIGHT OF WAY.
- 5 TREES AND SHRUBS, AFFECTED BY THE PROPOSED SIDEWALK CONSTRUCTION, SHALL BE TRIMMED TO AT LEAST 8' VERTICALLY ABOVE THE SIDEWALK SURFACE AND TO AT LEAST 3' LATEROALLY OF THE SIDEWALK, WHERE RIGHT-OF-WAY PERMITS.
- 6 MAIL BOXES, INTERFERING WITH PROPOSED SIDEWALK CONSTRUCTION, SHALL BE TEMPORARILY RELOCATED TO ENABLE PROPERTY OWNERS TO RECEIVE THEIR MAIL AND BE REINSTALLED IN FINAL POSITION BY THE CONTRACTOR.
- 7 WATER METERS, GAS METERS AND ALL STREET PULL BOXES AFFECTED BY CONSTRUCTION, SHALL BE ADJUSTED TO THE PROPOSED SIDEWALK GRADE.
- 8 EXISTING SPRINKLERS AND IRRIGATION LINES, AFFECTED BY THE CONSTRUCTION OF THE PROPOSED SIDEWALK SHALL BE RELOCATED TO THE BACK OF THE SIDEWALK OR MODIFIED TO COVER EXISTING IRRIGATION AREA EXCEPT THE NEW PAVED AREA.

SPECIFIC CONSTRUCTION NOTES

- NUMBERS, ABOVE 100 IN A HEXAGON ON THE PLAN, REFER TO THE RESPECTIVE STANDARD DRAWING AND SHALL BE CONSTRUCTED ACCORDINGLY, UNLESS MODIFICATIONS ARE NOTED ON THE PLAN OR COVER SHEET. ANY NUMBER SHOWN BELOW THE STANDARD DRAWING NUMBER INDICATES THE SPECIFIC ALTERNATE TO BE CONSTRUCTED.
- REMOVE & REPLACE EXISTING PAVEMENT TO CONSTRUCT A 5% MAXIMUM SLOPE AT BOTTOM OF THE WHEELCHAIR RAMP AS SHOWN ON STD. 304.
- FILL** REMOVE EXISTING TREE WELL COVERS AND TREE ROOTS AND FILL IN WITH 3.5" THICK OF CONCRETE.
- GRD** GRIND EXISTING CURB FACE TO 0" AT WHEELCHAIR RAMP DEPRESSION AS SHOWN ON WHEELCHAIR RAMP CURB FACE GRINDING DETAIL (SEE SHEET 1).
- PIP** PROTECT IN PLACE.
- RED** RELOCATE FENCE TO 0.5' OUTSIDE R/W. (NOTE: REUSE EXISTING FENCE FABRIC AND USE NEW IN KIND POSTS)
- T** TRANSPLANT EXISTING PALM TREE AS DIRECTED BY THE INSPECTOR AND AS DESCRIBED IN PARK & RECREATION SECTION OF THE ACCOMPANYING SPECIAL PROVISIONS. FINAL LOCATION TO BE DETERMINED BY THE INSPECTOR. STREET TREE REMOVAL PERMIT REQUIRED.
- WCR** DIRECTIONAL WHEELCHAIR RAMP TYPE I OR TYPE II (SEE SHEET 1).

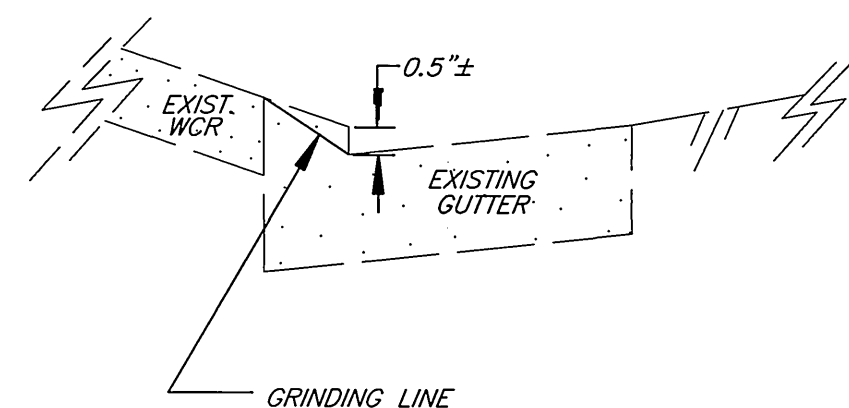

WCR CURB FACE GRINDING DETAIL
(NTS)

| SITE | LOCATION |
|------|----------|
|------|----------|

- | | |
|---|---|
| 1 | OLIVEWOOD AVENUE - FROM PACHAPPA DRIVE TO CITY COLLEGE DRIVE. |
| 2 | HOLDING STREET - FROM ORANGE STREET TO MULBERRY STREET. |

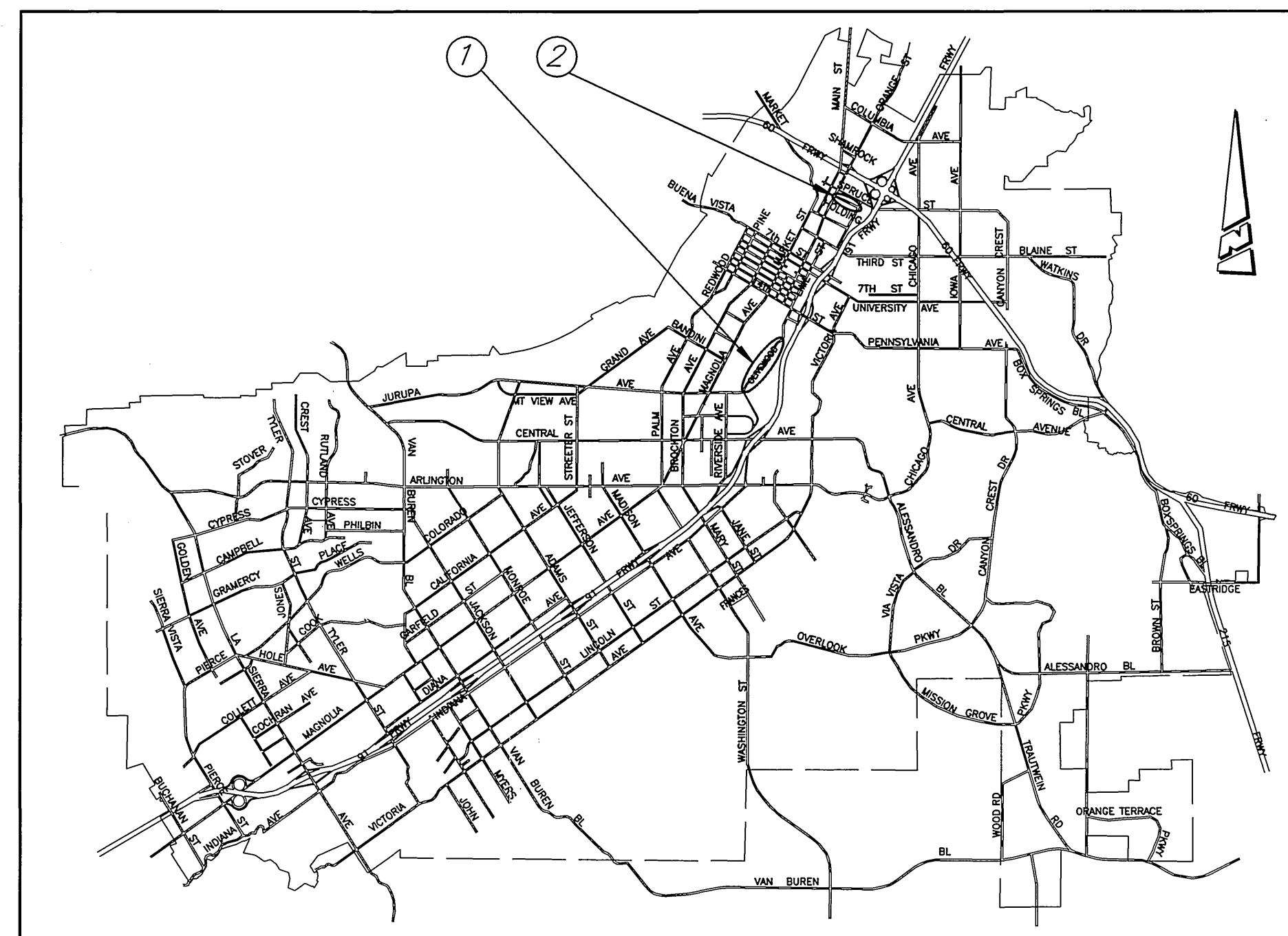

PROJECT LOCATION MAP

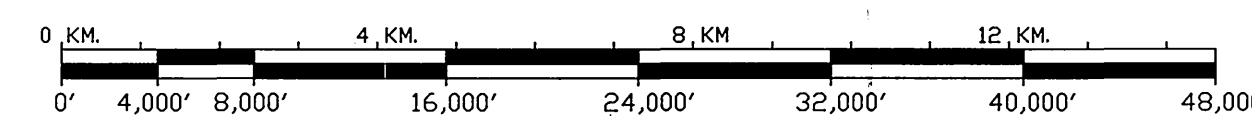

SCALE: 1" = 8,000'

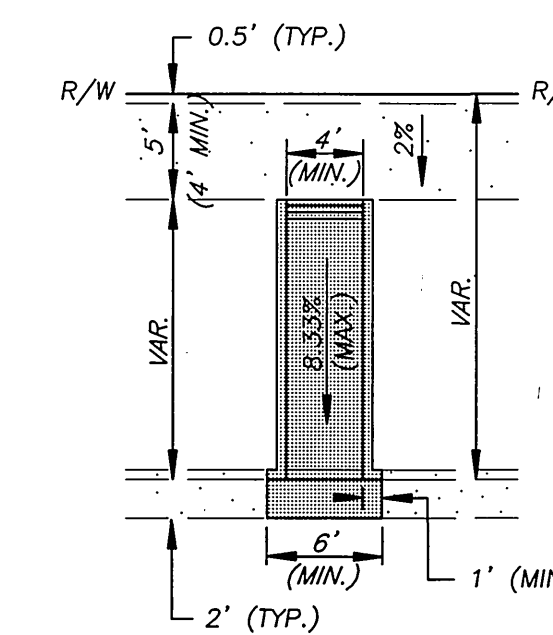

* : 1' MINIMUM GUTTER CROSS SLOPE TRANSITION LENGTH FROM EXIST. SLOPE TO 5% (MAX.) SLOPE.

DIRECTIONAL WCR TYPE D-I
(NTS)

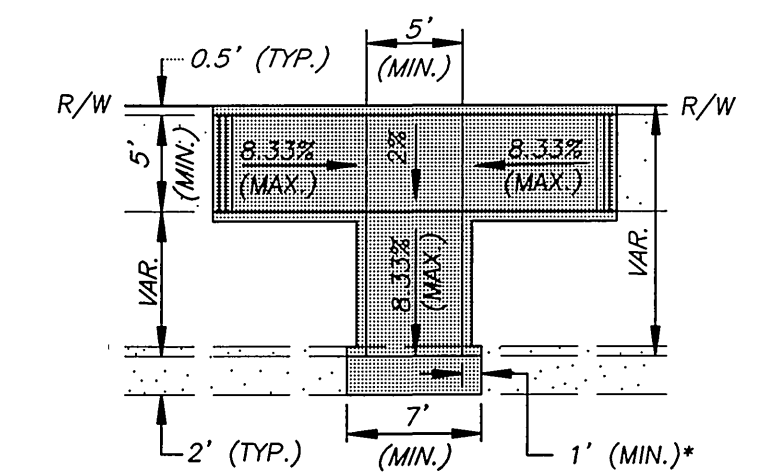

* : 1' MINIMUM GUTTER CROSS SLOPE TRANSITION LENGTH FROM EXIST. SLOPE TO 5% (MAX.) SLOPE.

DIRECTIONAL WCR TYPE D-II
(NTS)

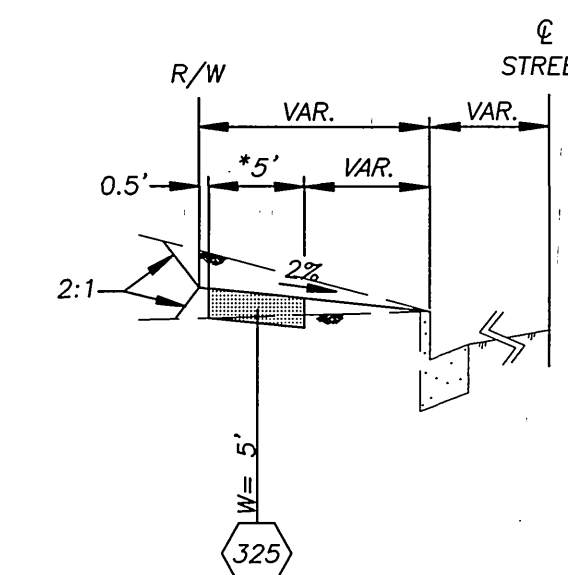

PROPERTY LINE SIDEWALK TYPICAL SECTION
(NTS)

* : SIDEWALK WIDTH SHALL BE ADJUSTED TO PROVIDE A 4' CLEAR PATHWAY AT ANY OBSTRUCTION.

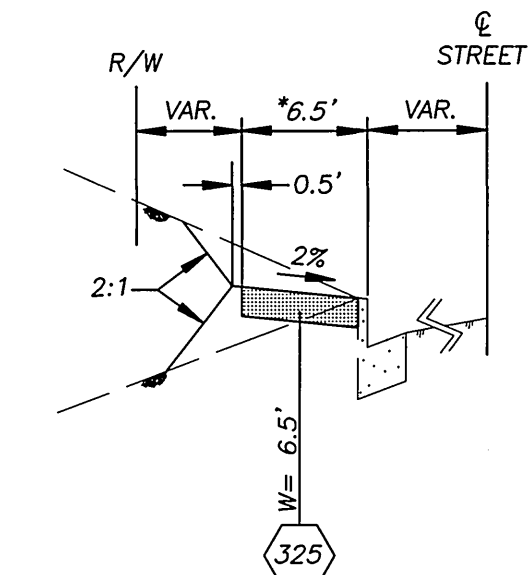

CURB LINE SIDEWALK TYPICAL SECTION
(NTS)

* : SIDEWALK WIDTH SHALL BE ADJUSTED TO PROVIDE A 4' CLEAR PATHWAY AT ANY OBSTRUCTION.

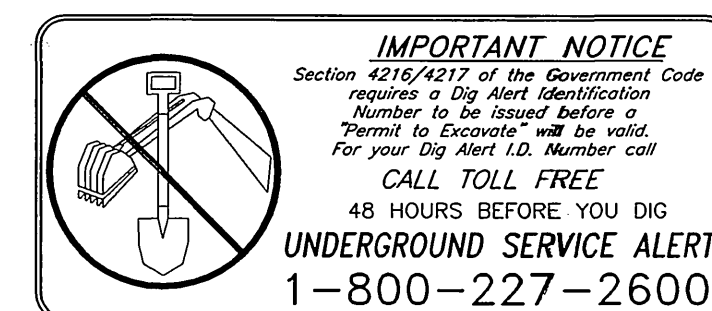

IMPORTANT NOTICE
Section 4216/4217 of the Government Code requires a Dig Alert Identification Number to be issued before a "Permit to Excavate" will be valid. For your Dig Alert I.D. Number call CALL TOLL FREE 48 HOURS BEFORE YOU DIG UNDERGROUND SERVICE ALERT 1-800-227-2600

ENGINEER IN RESPONSIBLE CHARGE
Lauren F. Caldwell
LAUREN F. CALDWELL
R.C.E. No. 39441 expires 12/31/2001
DATE 8/15/00

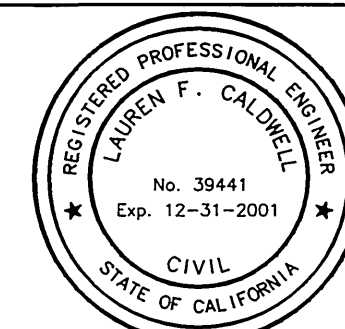

| MARK | REVISIONS | APPR. | DATE |
|------|-----------|-------|------|
| | | | |

CITY OF RIVERSIDE, CALIFORNIA
PUBLIC WORKS DEPARTMENT

| | |
|----------------------|---------|
| APPROVED BY | DATE |
| DEPUTY P.W. DIRECTOR | 8/14/00 |
| PRINCIPAL ENGINEER | 8/14/00 |
| INSPECTION | 8/14/00 |
| STREET SERVICES | 8/14/00 |
| TRAFFIC ENGINEER | 8/14/00 |
| SUPERVISOR | 8/14/00 |
| PARK & REC. DEP. | 8/14/00 |

APPROVED BY
Ruben De Guzman
PUBLIC WORKS DIRECTOR
DATE 8-17-00

* AS-BUILT 9-29-03 Lfh

ACCESSIBLE PATHWAY
1999/2000 (PHASE III)

HORIZ. SCALE: 1" = 100'

ACCT. NO.: 9205300611 453002XX
9215500811 4401200X
R-3564
SHEET 1 OF 2
FILE: LFRANK\U\DWG\R3564-01
Rc-4312-5

INDEXED 8/24/2000 Lfh

OLIVEWOOD AVENUE

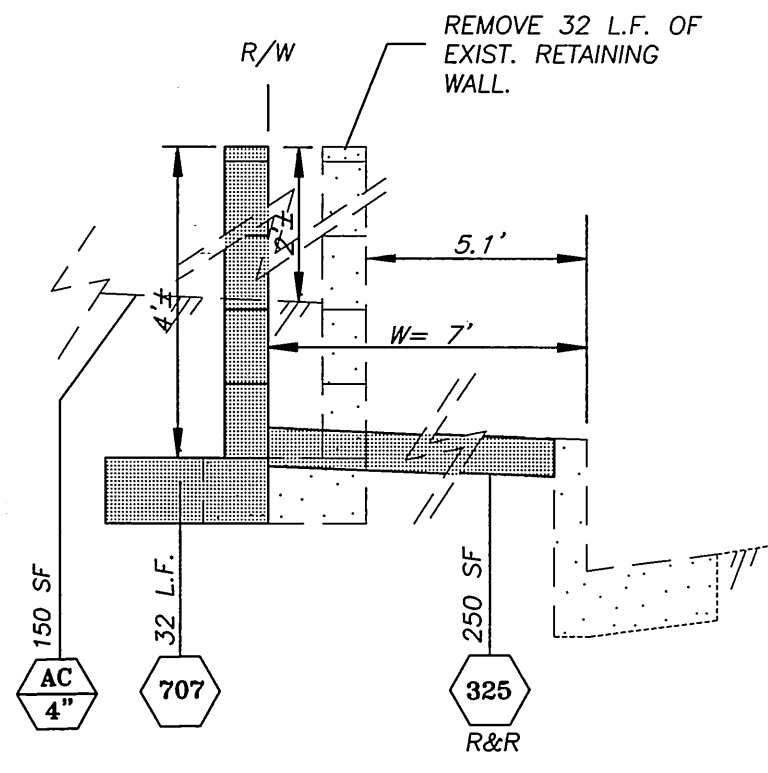

DETAILS OF RETAINING WALL @ 5179 OLIVEWOOD AVENUE
(NTS)

NOTE: CONSTRUCT ONE 3'x4' TREE WELL

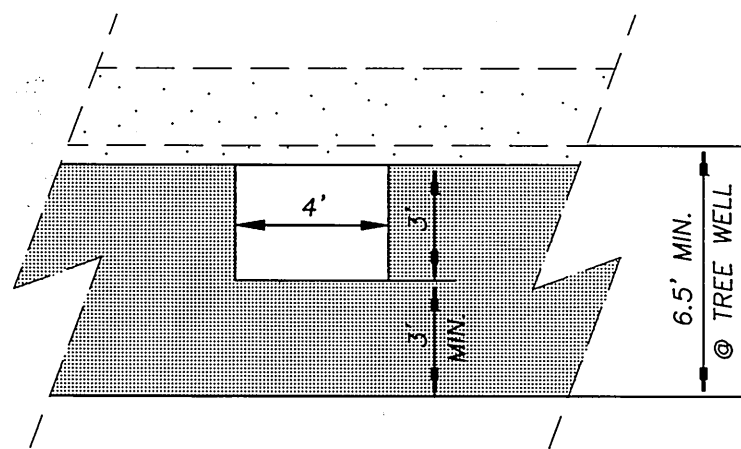

TREE WELL OPENING DETAILS
(NTS)

NOTE: DO NOT CONSTRUCT TREE WELL COVER.

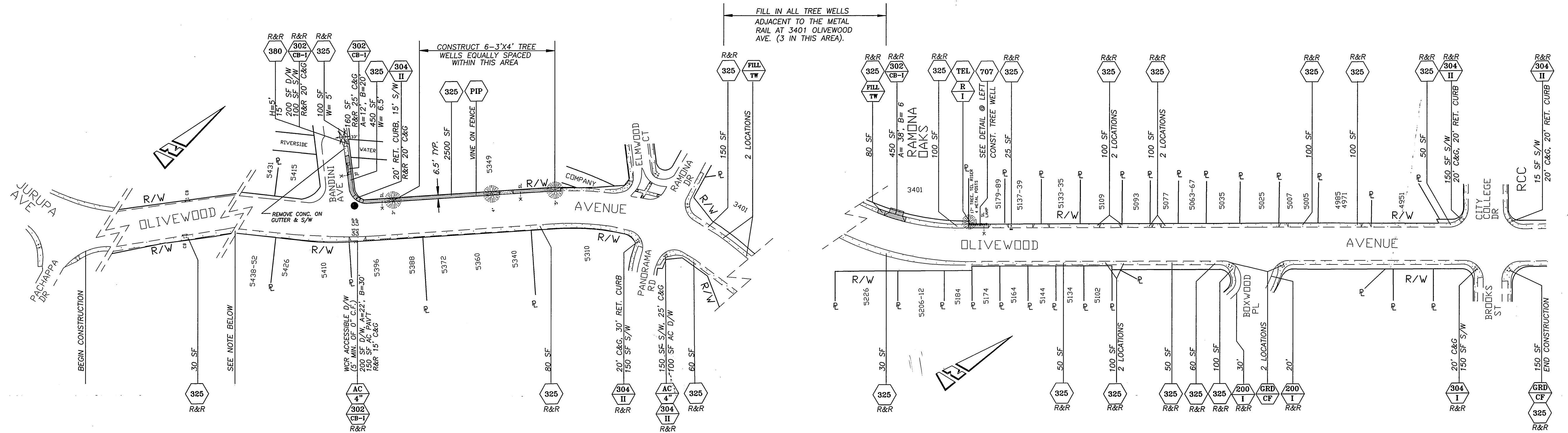

NOTE: CONST. 4" WIDE S/W @ BACK OF TREE WELL LOCATED AT SOUTH SIDE OF APARTMENT ENTRANCE TO 5530 OLIVEWOOD AVENUE.

HOLDING STREET

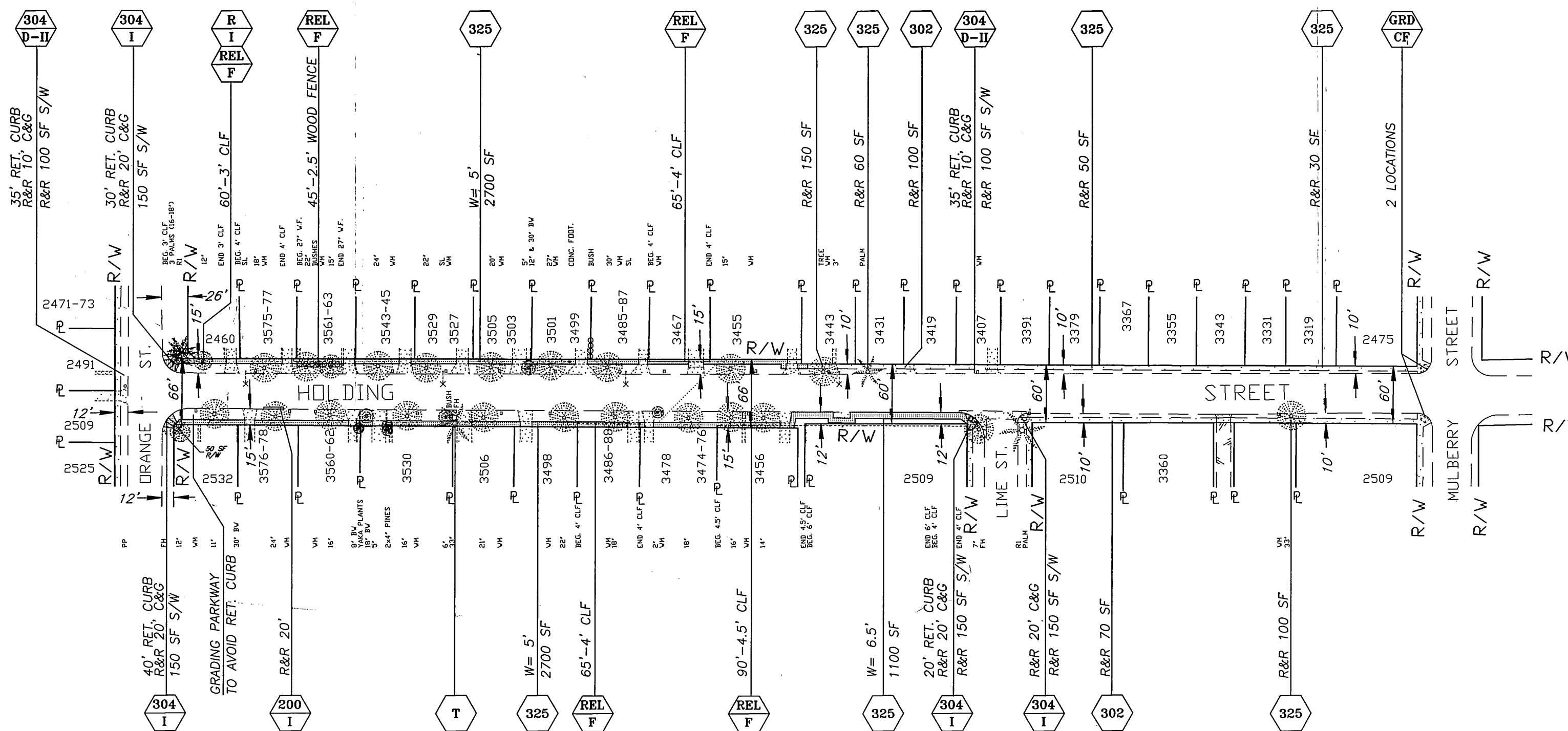

* AS-BUILT 5-29-03 LFT

ENGINEER IN RESPONSIBLE CHARGE
Lauren F. Caldwell
LAUREN F. CALDWELL
R.C.E. No. 39441 expires 12/31/2001
DATE 8/16/2000



| MARK | REVISIONS | APPR. | DATE |
|------|-----------|-------|------|
| | | | |
| | | | |
| | | | |

| CITY OF RIVERSIDE, CALIFORNIA PUBLIC WORKS DEPARTMENT | | |
|--|------------------------|---------|
| APPROVED BY | BY | DATE |
| DEPUTY P.W. DIRECTOR | <i>Richard McNeath</i> | 8/17/00 |
| PRINCIPAL ENGINEER | <i>Richard McNeath</i> | 8/17/00 |
| INSPECTION | <i>Richard McNeath</i> | 8/17/00 |
| STREET SERVICES | <i>Richard McNeath</i> | 8/17/00 |
| TRAFFIC ENGINEER | <i>Richard McNeath</i> | 8/17/00 |
| SURVEYOR | <i>Richard McNeath</i> | 8/17/00 |
| PARK & REC. DEP. | <i>Richard McNeath</i> | 8/17/00 |

ACCESSIBLE PATHWAY 1999/2000 (PHASE III)

ACCT. NO. : 9205300611 4530200X
9215500611 4401200X
R-3564
SHEET 2 OF 2
FILE: LFRANK(U)\DWG\3564-02
PC-9312-S

HORIZ. SCALE: 1" = 100'

INDEXED 8/24/2000 LFT