

CURVE DATA

Station	Angle	R	L	T
21	45° 22' 51"	500'	396.02'	209.02'
22	79° 56' 44"	35'	48.84'	29.34'
23	45° 22' 51"	67'	64.68'	35.11'
24	55° 51' 23"	45'	43.87'	23.85'
25	143° 50' 52"	27'	67.79'	82.72'
26	25° 45' 49"	550'	247.31'	125.78'
27	45° 22' 51"	470'	372.26'	196.51'
28	45° 22' 52"	598'	473.65'	250.03'
29	45° 22' 52"	612'	484.73'	255.89'
30	90° 01' 49"	35'	55'	35.02'
31	89° 59' 15"	35'	54.97'	34.99'
32	89° 59' 15"	20'	31.41'	20'

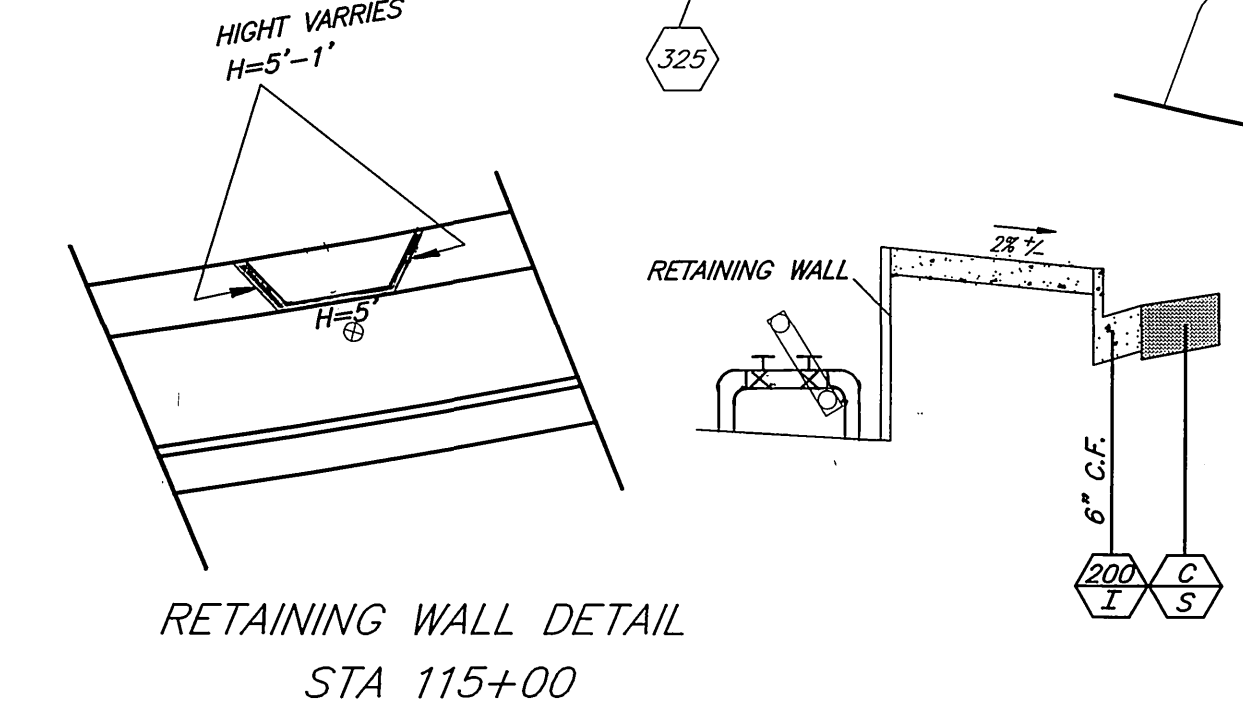

SEE SHEET 8 FOR PENNSYLVANIA AVE.

ENGINEER IN RESPONSIBLE CHARGE
Ronald C. Mueller
 RONALD C. MUELLER
 R.C.E. No. 28510 expires 3/31/03
 DATE 5-25-00

MARK	REVISIONS	APPR.	DATE

CITY OF RIVERSIDE, CALIFORNIA
 PUBLIC WORKS DEPARTMENT

APPROVED BY: *R.M. Sull*
 DEPUTY P.W. DIRECTOR

APPROVED BY: *R.M. Sull*
 PUBLIC WORKS DIRECTOR

DATE: 5-26-2000

14TH ST / MARTIN LUTHER KING BLVD
 STREET IMPROVEMENTS
 BERMUDA TO ANGELO

HORIZ. SCALE: 1" = 20' VERT. SCALE: 1" = 4'

ACCT. No. 9535327152 44022309
R-3571
 SHEET 4 OF 11
 Superseded

INDEXED 6/20/2000 gth

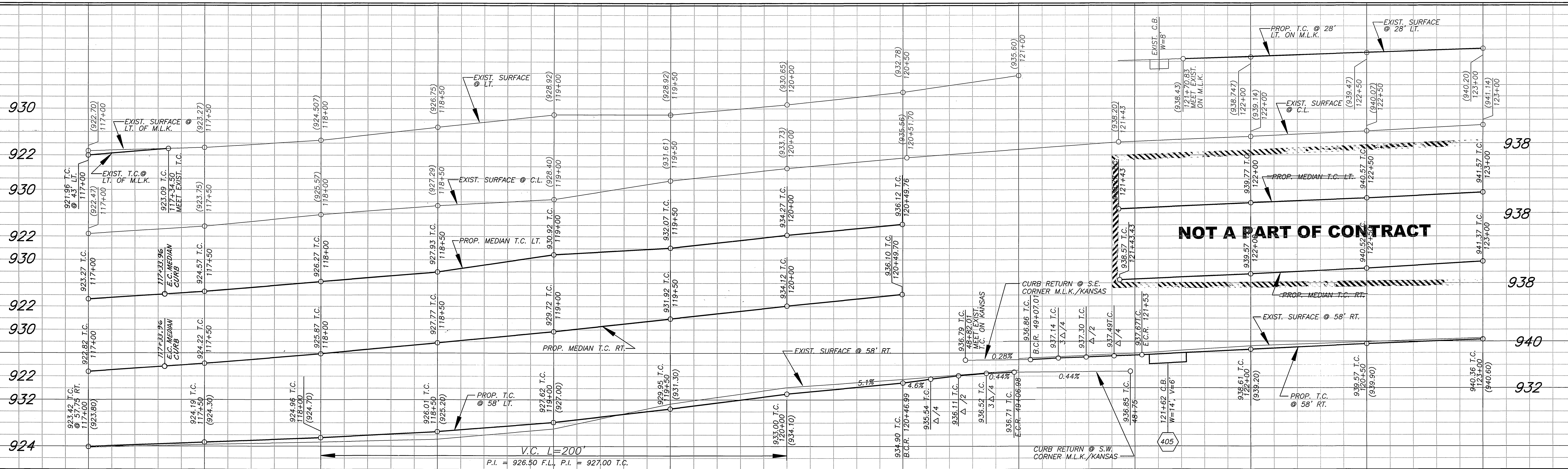

NOT A PART OF CONTRACT

OMIT SIDEWALK NOT A PART OF CONTRACT

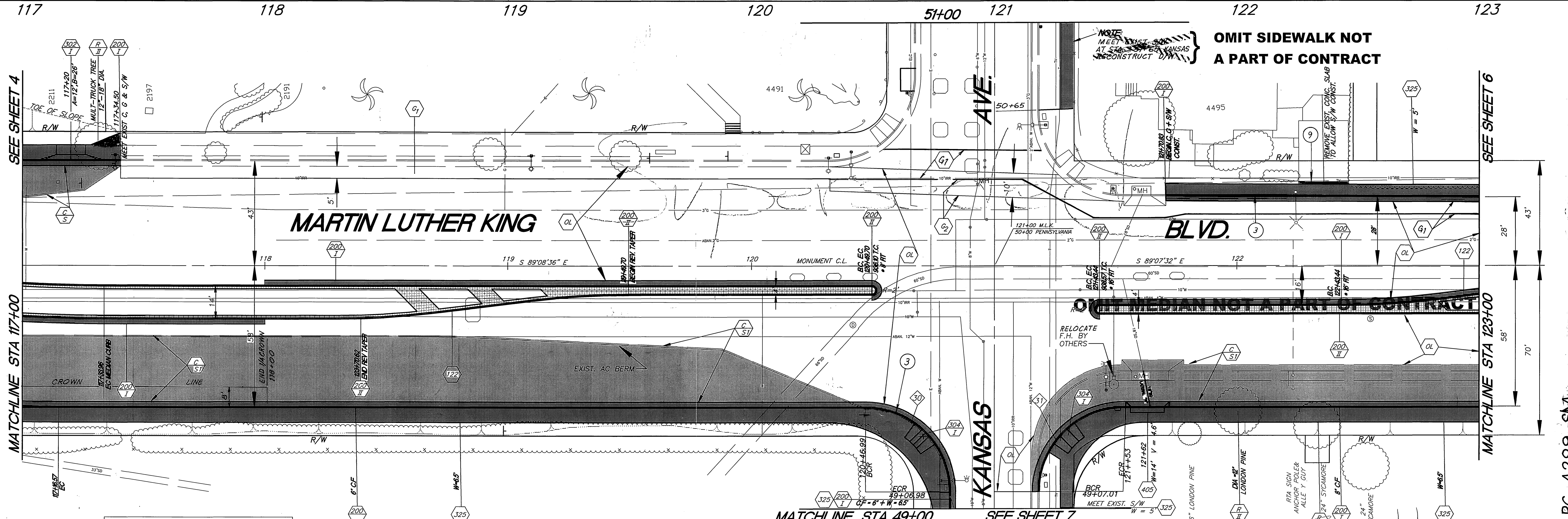

CURVE DATA				
	Δ	R	L	T
30	90° 01' 49"	35'	55'	35.02'
31	89° 59' 15"	35'	54.97'	34.99'

ENGINEER IN RESPONSIBLE CHARGE
Ronald C. Mueller
 R.C.E. No. 29510 expires 3/31/03
 DATE 5-25-00

MARK	REVISIONS	APPR.	DATE

CITY OF RIVERSIDE, CALIFORNIA
 PUBLIC WORKS DEPARTMENT

APPROVED BY: **R. M. Smith**
 DEPUTY P.W. DIRECTOR
 PRINCIPAL ENGINEER
 STREET SERVICES
 SUPERVISOR
 TRAFFIC DIVISION
 PARKS DEPARTMENT

DATE: 5-26-2000

14TH ST / MARTIN LUTHER KING BLVD
 STREET IMPROVEMENTS
 BERMUDA TO ANGELO

ACCT. No. 9535327152 44022309
R-3571
 SHEET 5 OF 11
 Suppended

INDEXED 6/20/2000 6H

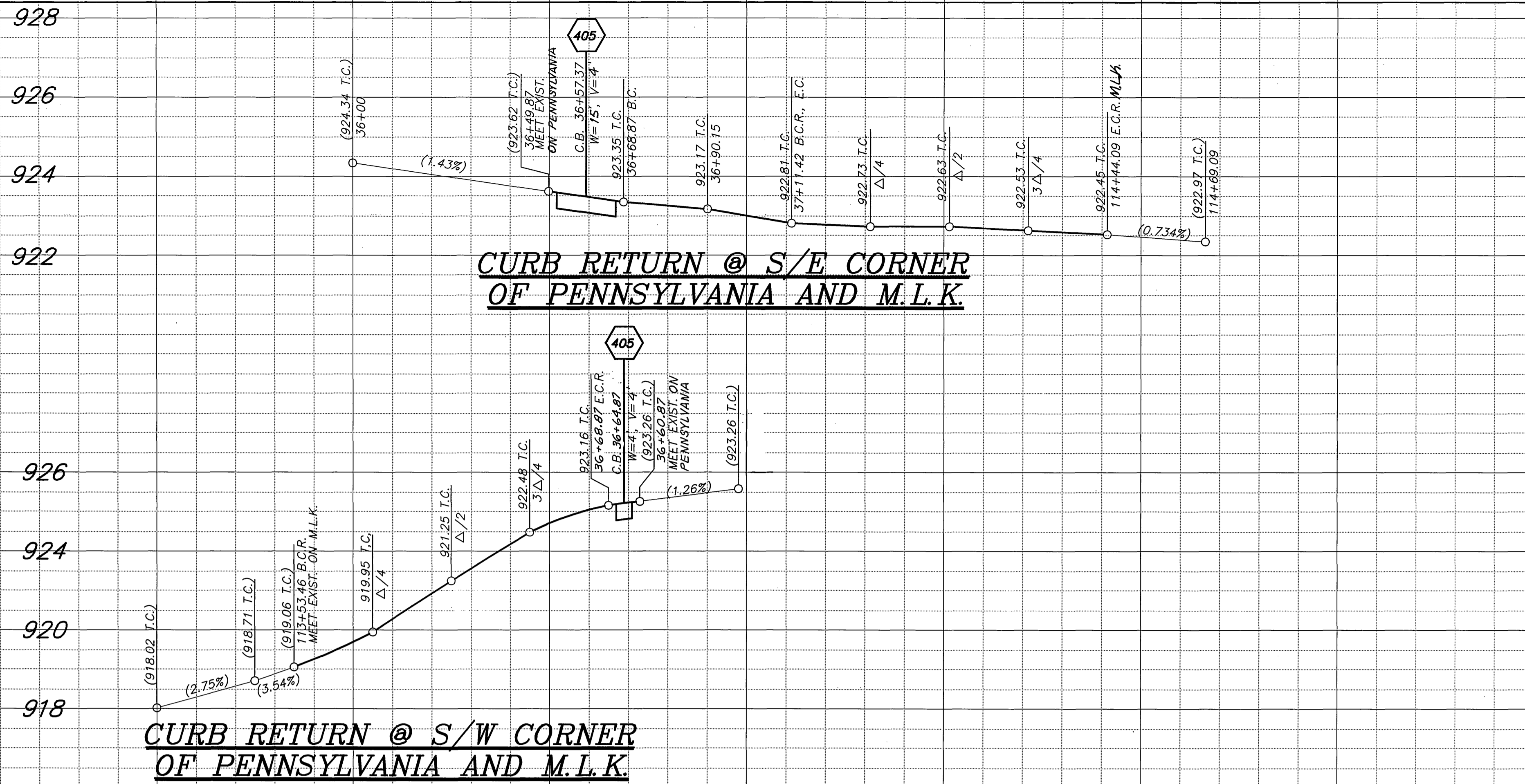

CURB RETURN @ S/W CORNER OF PENNSYLVANIA AND M.L.K.

CURB RETURN @ S/E CORNER OF PENNSYLVANIA AND M.L.K.

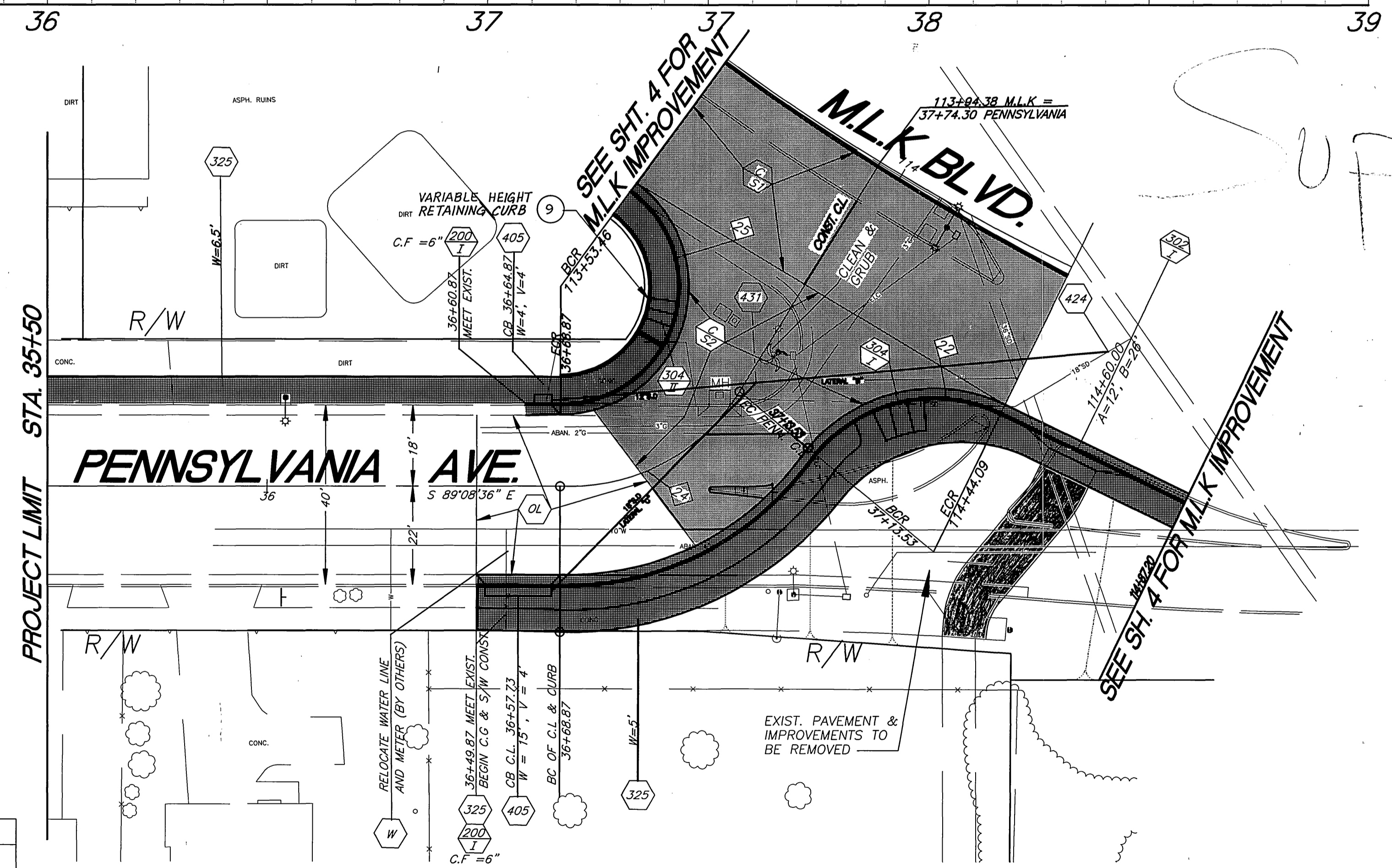

Superseded

CURVE DATA				
Δ	R	L	T	
21	45° 22' 51"	500'	396.02'	209.02'
22	79° 56' 44"	35'	48.84'	29.34'
23	45° 22' 51"	67'	64.68'	35.11'
24	55° 51' 23"	45'	43.87'	23.85'
25	143° 50' 52"	27'	67.79'	82.72'
26	25° 45' 49"	550'	247.31'	125.78'
27	45° 22' 51"	470'	372.26'	196.51'
28	45° 22' 52"	598'	473.65'	250.03'
29	45° 22' 52"	612'	484.73'	255.89'
30	90° 01' 49"	35'	55'	35.02'
31	89° 59' 15"	35'	54.97'	34.99'
32	89° 59' 15"	20'	31.41'	20'

NOTES:
TRAFFIC SIGNS TO BE SALVAGED AS NOTED IN SPECIAL PROVISIONS.
UTILITY POLES TO BE RELOCATED BY OTHERS.

ENGINEER IN RESPONSIBLE CHARGE
Ronald C. Mueller
RONALD C. MUELLER
R.C.E. No. 29510 expires 3/31/03
DATE 6-25-00

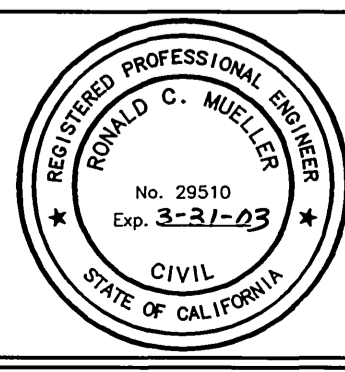

MARK	REVISIONS	APPR.	DATE

CITY OF RIVERSIDE, CALIFORNIA
PUBLIC WORKS DEPARTMENT

APPROVED BY	BY	DATE	APPROVED BY
DEPUTY P.W. DIRECTOR	<i>[Signature]</i>	5/26/00	<i>[Signature]</i>
PRINCIPAL ENGINEER	<i>[Signature]</i>	5/26/00	<i>[Signature]</i>
STREET SERVICES	<i>[Signature]</i>	5/26/00	<i>[Signature]</i>
SURVEYOR	<i>[Signature]</i>	5/26/00	<i>[Signature]</i>
TRAFFIC DIVISION	<i>[Signature]</i>	5/26/00	<i>[Signature]</i>
PARKS DEPARTMENT	<i>[Signature]</i>	5/26/00	<i>[Signature]</i>

Superseded

14TH ST / MARTIN LUTHER KING BLVD
STREET IMPROVEMENTS
BERMUDA TO ANGELO

HORIZ. SCALE: 1" = 20' VERT. SCALE: 1" = 2'

ACCT. No. 9535327152 44022309
R-3571
-SHEET 8 OF 11-
Superseded

PC-4289-S/M

INDEXED 6/20/2000 441