

RIVERSIDE CITY OF RIVERSIDE CALIFORNIA

PUBLIC WORKS DEPARTMENT

MADISON STREET STREETSCAPE IMPROVEMENTS

PHASE 2 - VICTORIA AVE. TO LINCOLN AVE. PHASE 3 - EVANS ST. TO INDIANA AVE.

CONSTRUCTION LEGEND

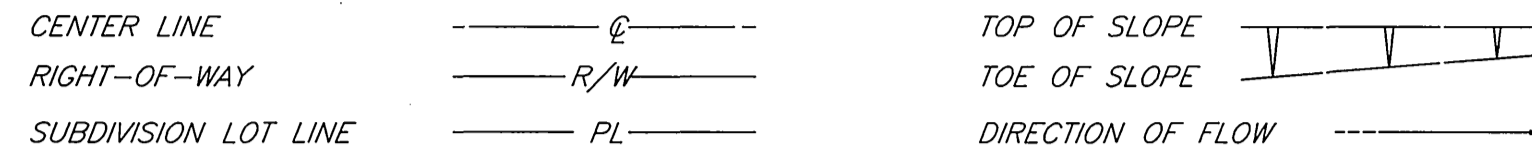

SHEET INDEX

R-3603	SHEET 1	COVER SHEET AND TYPICAL SECTION.
R-3603	SHEETS 2-5	STREET IMPROVEMENT PLANS
R-3603L	SHEET 1-3	MEDIAN ISLAND LANDSCAPING
R-3603I	SHEETS 1-3	MEDIAN ISLAND IRRIGATION
XL-460	SHEETS 1-1	STRIPING PLAN

SPECIFIC CONSTRUCTION NOTES

- NUMBERS ABOVE 100 IN A HEXAGON ON THE PLAN REFER TO THE RESPECTIVE STANDARD DRAWING AND SHALL BE CONSTRUCTED ACCORDINGLY, UNLESS MODIFICATIONS ARE NOTED ON THE PLAN OR COVER SHEET. ANY NUMBER SHOWN BELOW THE STANDARD DRAWING NUMBER INDICATES THE SPECIFIC ALTERNATE TO BE CONSTRUCTED.
- ADJ ADJUST SEWER MANHOLE COVER TO GRADE.
- G.V. ADJUST WATER GATE VALVE COVER TO GRADE.
- G1 WHERE THE PAVEMENT OVERLAY IS ADJACENT TO THE GUTTER LIP, COLD-MILL THE EXISTING PAVEMENT TO THE DEPTH OF 0.08' BELOW THE GUTTER LIP AND DAYLIGHT TO MEET THE EXISTING PAVEMENT IN 5'. WHERE THE PAVEMENT OVERLAY IS TO MEET THE EXISTING PAVEMENT AT THE JOIN LINE, COLD-MILL THE EXISTING PAVEMENT TO A DEPTH OF 0.08' BELOW THE JOIN LINE AND DAYLIGHT TO MEET THE EXISTING PAVEMENT IN A DISTANCE OF 10' FROM THE JOIN LINE.
- C/S1 CONSTRUCT STRUCTURAL SECTION OF 0.50' D.G.A.C. OVER .95' CAB OVER COMPACTED NATIVE SOIL.
- R/S1 REMOVE & REPLACE EXISTING STRUCTURAL SECTION WITH 0.5' D.G.A.C. OVER 0.95' CAB OVER COMPACTED SOIL.
- 304/M CONSTRUCT DIRECTIONAL A.C. WHEELCHAIR RAMP PER STD. 304 MODIFIED AS SHOWN ON THE PLAN. LONGITUDINAL SLOPE SHALL BE 8.33% MAXIMUM. AC PAVING SHALL BE 0.25' THICK.
- OL CONSTRUCT VARIABLE THICKNESS D.G.A.C. OVERLAY. (0.08' MINIMUM THICKNESS)
- W PUBLIC UTILITIES DEPARTMENT, WATER DIVISION, TO RELOCATE OR ADJUST TO GRADE.
- 1 REMOVE EXISTING STRUCTURAL SECTION BETWEEN PROPOSED CURBS AND FILL WITH CLEAN EARTHEN MATERIAL TO ±1" BELOW PROPOSED T.C. ELEVATION COMPACTED TO 85% RELATIVE COMPACTION AT PLANTING AREAS & 95% RELATIVE COMPACTION BENEATH DECORATIVE PAVEMENT. ALLOW FOR SOIL AMENDMENTS PER SECTION 02480.
- 2 CONSTRUCT DRIVEWAY WITH 4" THICK AC OVER COMPACTED NATIVE MATERIAL AS SHOWN ON THE PLAN.
- 3 CONSTRUCT DRIVEWAY WITH 2.5" THICK CRUSHED AGGREGATE BASE OVER COMPACTED NATIVE MATERIAL.
- 4 CONSTRUCT COMPACTED EARTH DRIVEWAY TO MATCH EXISTING.
- 5 SEE MEDIAN ISLAND LANDSCAPE PLAN R-3603L.
- 6 CONSTRUCT 6" THICK FULL DEPTH AC OVER COMPACTED NATIVE MATERIAL AS SHOWN ON THE PLAN.

GENERAL CONSTRUCTION NOTES

- 1 EXISTING UTILITIES SHOWN ON THIS PLAN ARE PLOTTED FROM UTILITY RECORDS. THE CONTRACTOR IS REQUIRED TO TAKE DUE PRECAUTIONARY MEASURES TO LOCATE AND PROTECT ALL UTILITIES WHETHER OR NOT SHOWN ON THIS PLAN. IF THE COVER OF A UTILITY IS KNOWN, IT IS SHOWN IN THE PROFILE. WHEN A UTILITY IS SHOWN IN THE PROFILE AS IT INDICATES THAT THE COVER IS UNKNOWN, BUT THE UTILITY IS NOT EXPECTED TO CONFLICT WITH THE PROPOSED IMPROVEMENTS.
- 2 ALL ELEVATIONS SHOWN ON THE PLAN VIEW SHALL BE STAKED IN THE FIELD.
- 3 PRIME CONTRACTORS BIDDING THIS WORK SHALL HAVE A CLASS "A" LICENSE.
- 4 CONSTRUCTION SHALL BE IN ACCORDANCE WITH THE CITY OF RIVERSIDE STANDARD DWGS AND STANDARD SPECIFICATIONS FOR PUBLIC WORKS CONSTRUCTION, 1997 EDITION.
- 5 CUT AND FILL SLOPES SHALL BE 2:1 OR FLATTER UNLESS OTHERWISE SHOWN ON THE PLAN.

EXISTING UNDERGROUND & TOPOGRAPHY LEGEND

EXISTING UNDERGROUND UTILITIES:

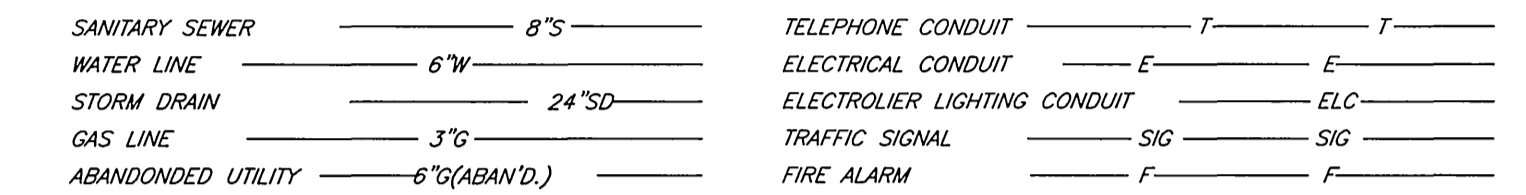

EXISTING TOPOGRAPHY:

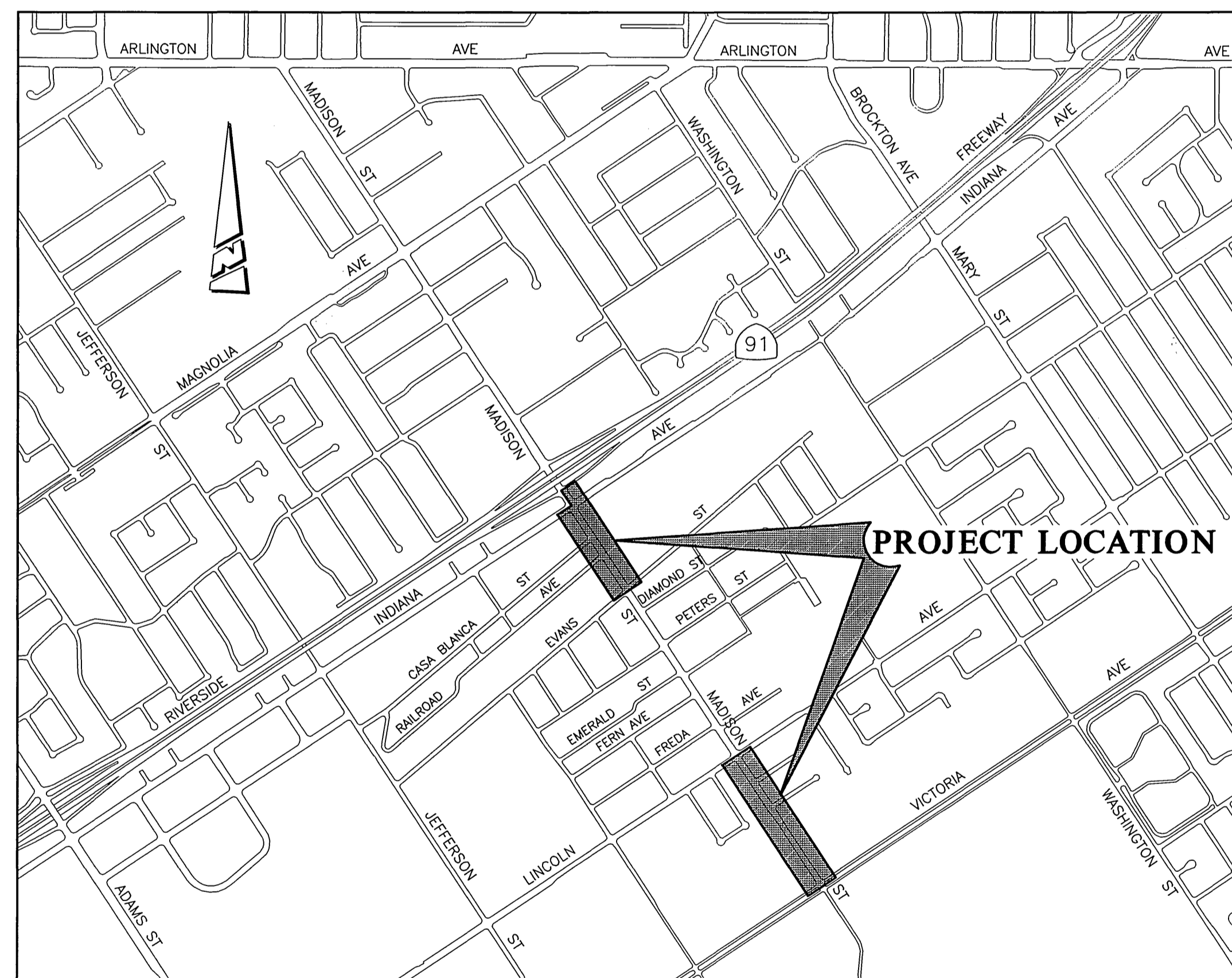
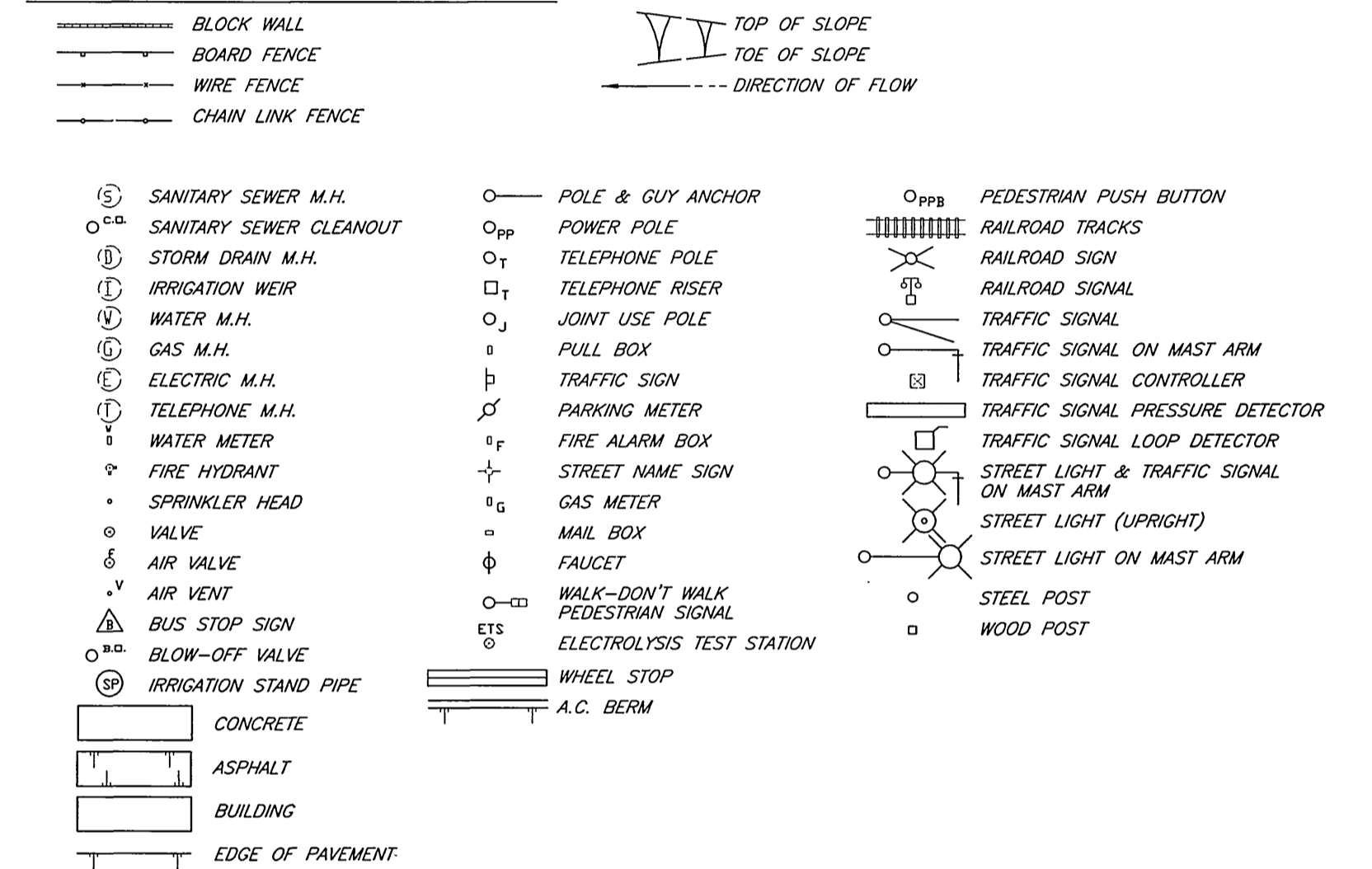

PROJECT LOCATION PLAN

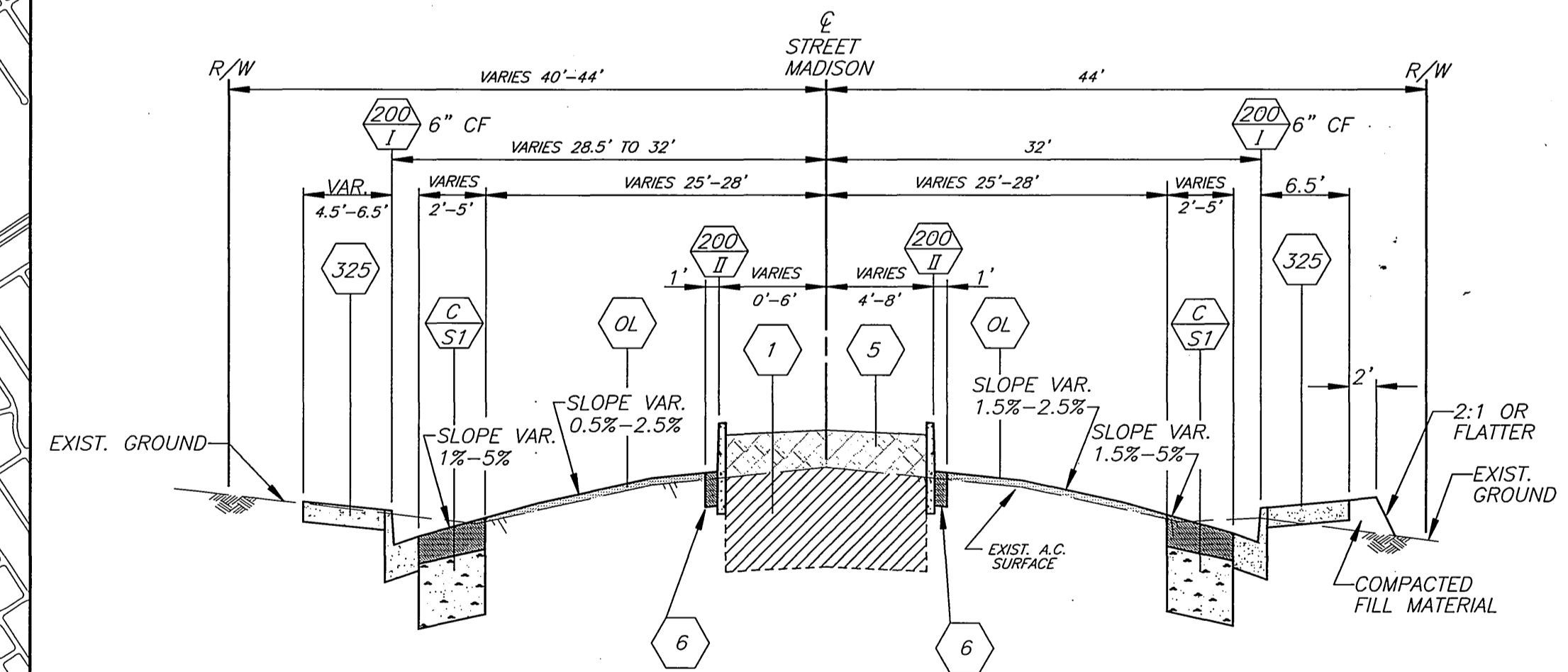
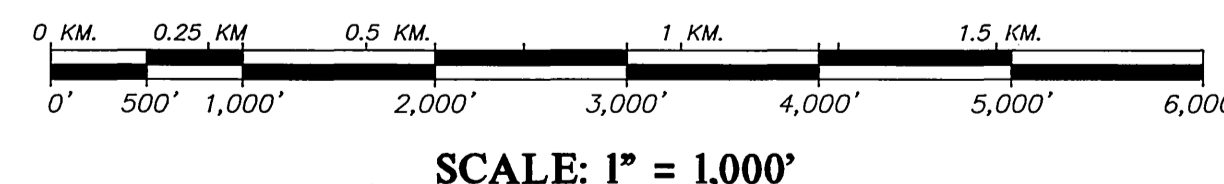

TYPICAL SECTION MADISON STREET
N.T.S.



ENGINEER IN RESPONSIBLE CHARGE
Michael Katusian
MICHAEL KATUSIAN
R.C.E. No. 36886 expires 6/30/04
DATE 12/17/01

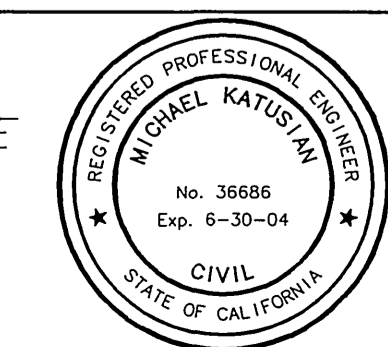

DESIGNED BY	REVISIONS	APPR.	DATE
C.S.S.			
DRAWN BY		CHECKED BY	
L.P.H.			

CITY OF RIVERSIDE, CALIFORNIA
PUBLIC WORKS DEPARTMENT
APPROVED BY: *Tom Brad*
PRINCIPAL ENGINEER
DATE 12/21/01

*AS-BUILT 8-25-03 44
MADISON STREET
STREETSCAPE IMPROVEMENTS
PH. 2-VICTORIA AV. TO LINCOLN AV.
PH. 3-EVANS ST. TO INDIANA AV.

ACCT. NO. 9740700835-440446XX
R-3603
SHEET 1 OF 5

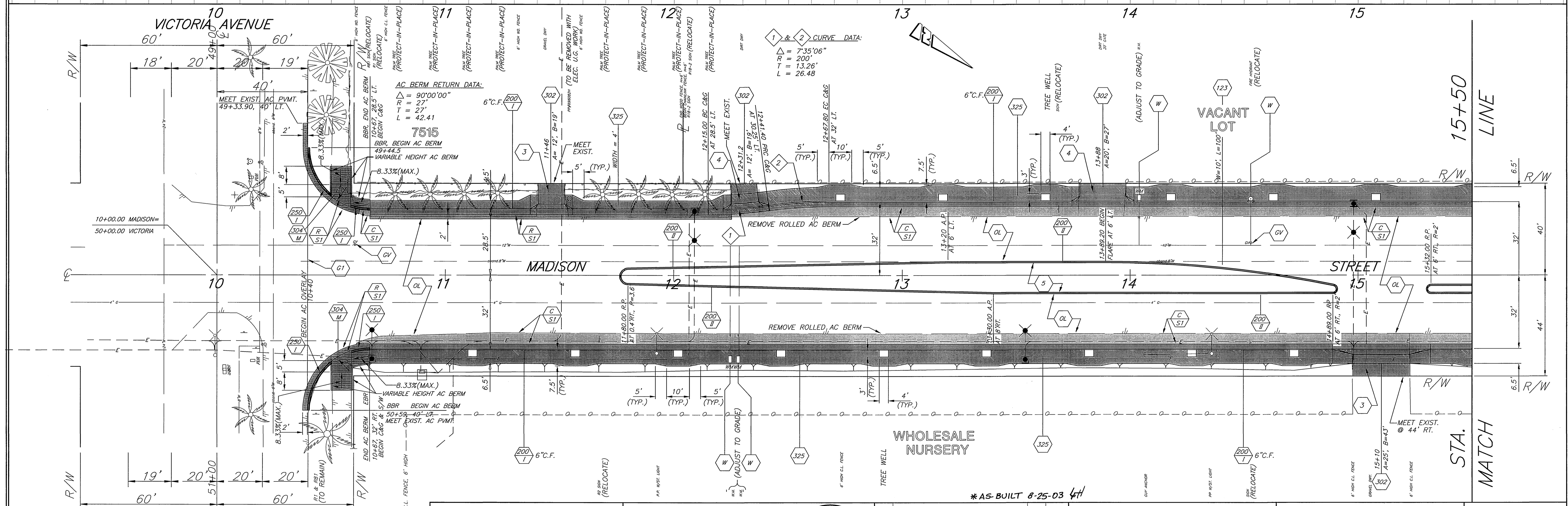
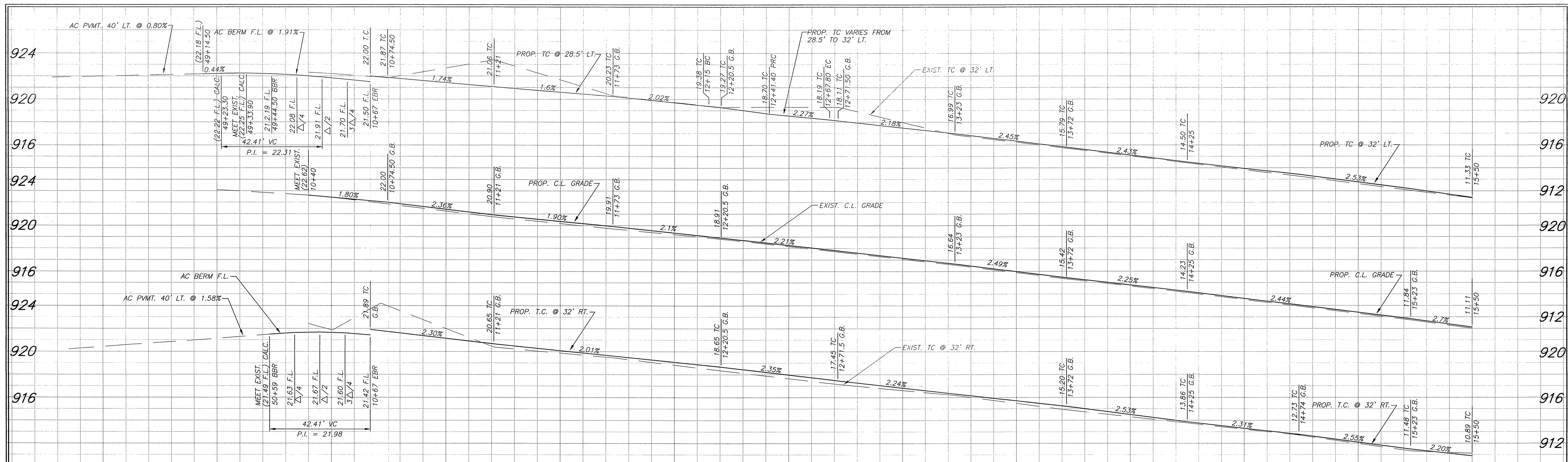

BENCHMARK:
601-17-68: BRONZE DISK IN CONC. POST @ A.T. & S.F. RAILWAY, 91.5' SW OF MADISON ST. C. 22' SE OF THE SE RAIL OF THE MAIN LINE, 15' NW OF NW RAIL OF SPUR LINE.
ELEV.: 861.455

ENGINEER IN RESPONSIBLE CHARGE
Michael Katusian
MICHAEL KATUSIAN
R.C.E. No. 36886 expires 6/30/04
DATE 12/12/01

CITY OF RIVERSIDE, CALIFORNIA
PUBLIC WORKS DEPARTMENT

MADISON STREET
STREETScape IMPROVEMENTS
PHASE 2
VICTORIA AVE. TO LINCOLN AVE.

APPROVED BY: *Thomas Boyd*
PUBLIC WORKS DIRECTOR

APPROVED BY: *Thomas Boyd*
PUBLIC WORKS DIRECTOR

DATE: 12/12/01

ACCT. NO. 9740700835-440460X
R-3603
SHEET 2 OF 5

INDEXED 8-18-03 LH

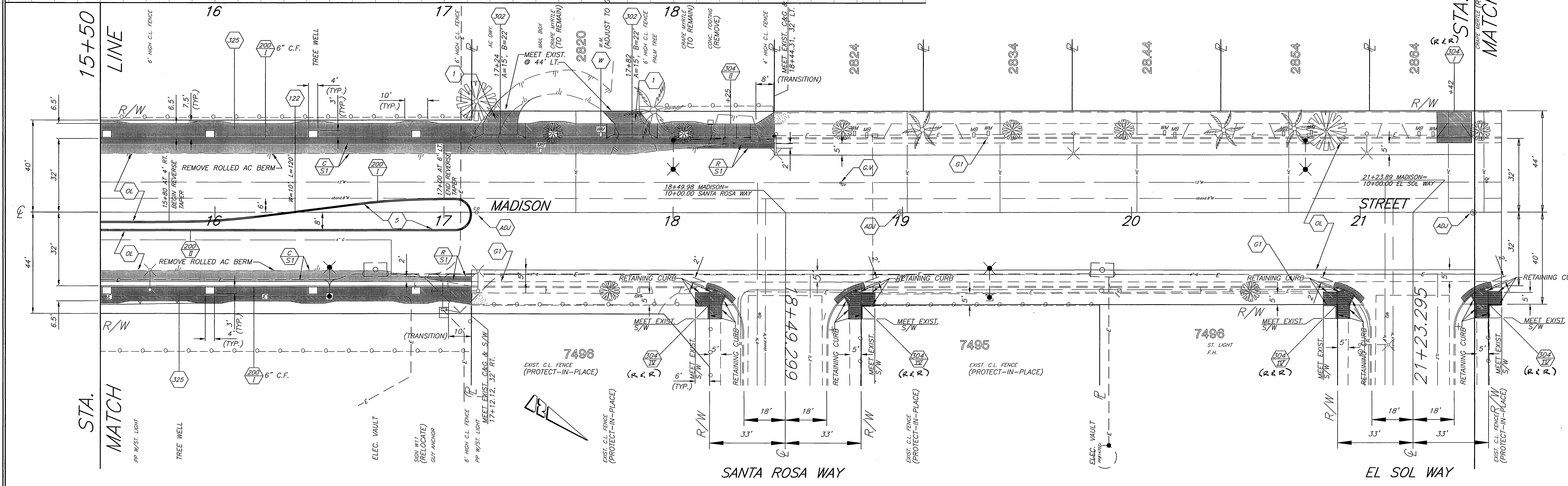
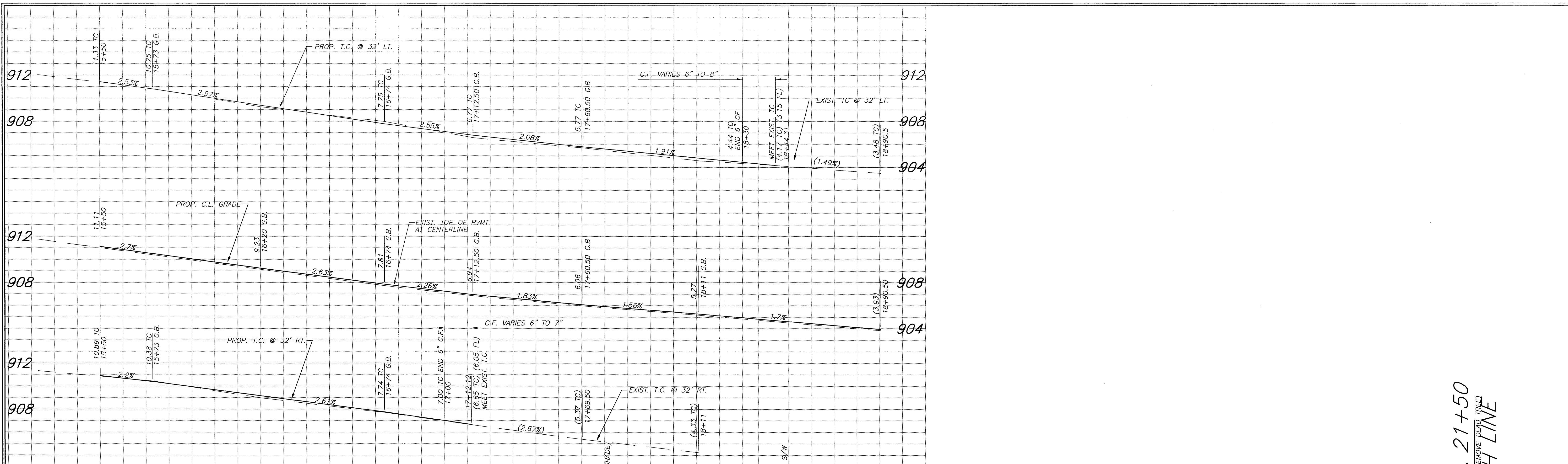

STA. 15+50
MATCH

STA. 21+50
MATCH LINE

ENGINEER IN RESPONSIBLE CHARGE
Michael Katusian
 MICHAEL KATUSIAN
 R.C.E. No. 36886 expires 6/10/04
 DATE 12/17/01

REGISTERED PROFESSIONAL ENGINEER
 MICHAEL KATUSIAN
 No. 36886
 Exp. 6-30-04
 CIVIL
 STATE OF CALIFORNIA

CITY OF RIVERSIDE, CALIFORNIA
 PUBLIC WORKS DEPARTMENT

APPROVED BY	BY	DATE
DEPUTY P/W DIRECTOR/ENGR	<i>Tom Boyd</i>	12/17/01
PRINCIPAL ENGINEER		
STREET SERVICES		
SURVEYOR		
TRAFFIC DIVISION		
PAVING DEPARTMENT		
INSPECTION		

DESIGNED BY *CSS* DRAWN BY *LPH* CHECKED BY

*AS-BUILT 8-25-03 LPH

MADISON STREET
 STREETScape IMPROVEMENTS
 PHASE 2
 VICTORIA AVE. TO LINCOLN AVE.

ACCT. NO. 9740700835-4404460X
 R-3603
 SHEET 3 OF 5
 HORIZ. SCALE: 1" = 20' VERT. SCALE: 1" = 4'

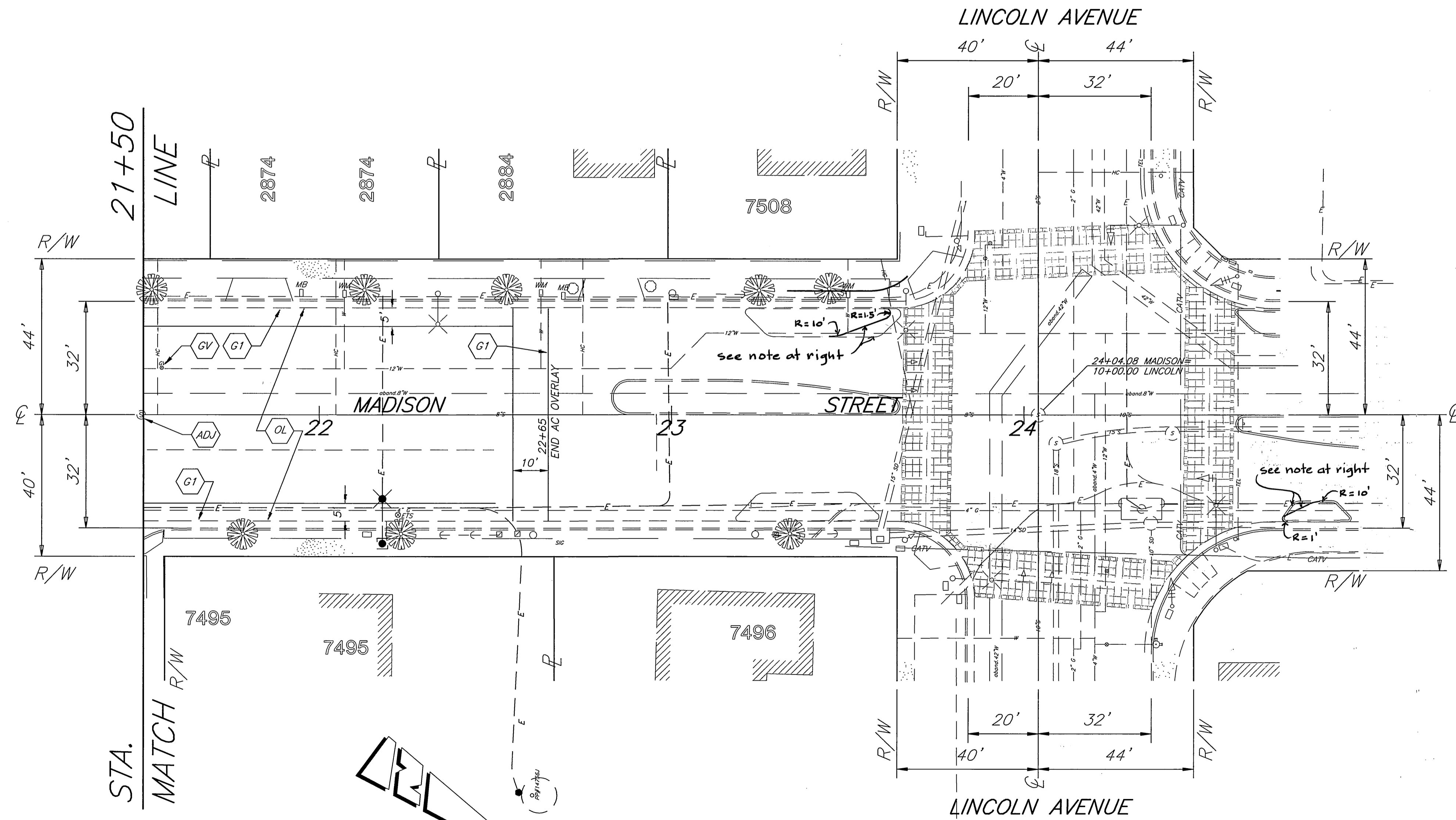

Note:
Remove and reconstruct portions of the existing planter as approximately shown and at the direction of the Engineer.

* AS-BUILT 8-25-03 LHM

ENGINEER IN RESPONSIBLE CHARGE
Michael Katustian
MICHAEL KATUSTIAN
R.C.E. No. 36686 expires 6/30/04
DATE 12/17/01

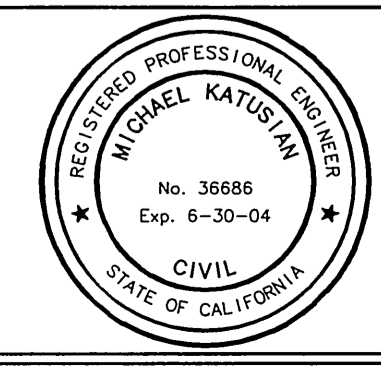

MARK	REVISIONS	APPR.	DATE

CITY OF RIVERSIDE, CALIFORNIA PUBLIC WORKS DEPARTMENT			
APPROVED BY	BY	DATE	APPROVED BY

MADISON STREET
STREETSCAPE IMPROVEMENTS
PHASE 2
VICTORIA AVE. TO LINCOLN AVE.
HORIZ. SCALE: 1" = 20'

ACCT. NO. 9740700835-4404463X
R-3603
SHEET 4 OF 5

INDEXED 8-18-03 LHM

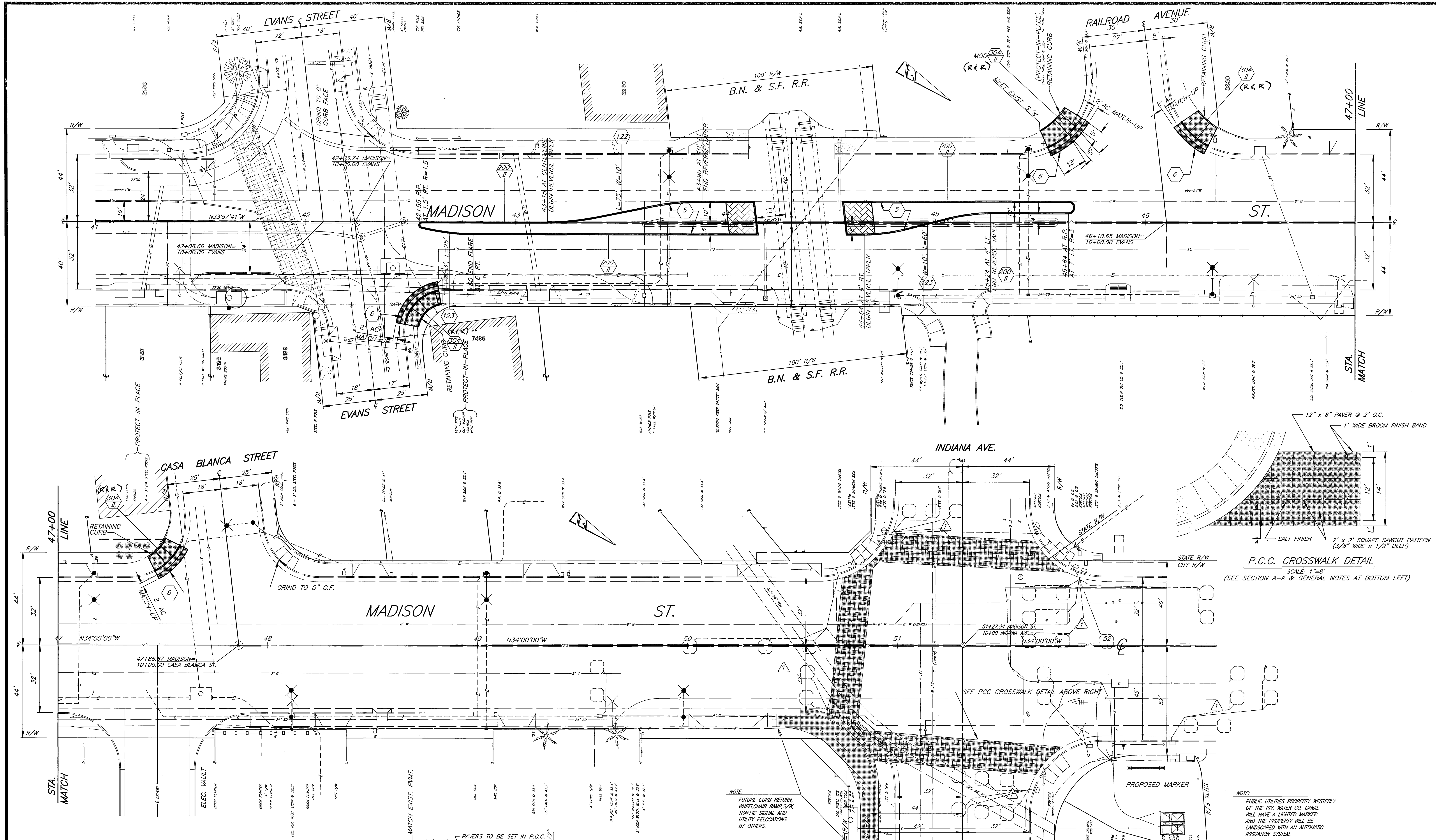

CONSTRUCTION NOTES

6 CONSTRUCT 6" THICK FULL DEPTH AC OVER COMPACTED NATIVE MATERIAL AS SHOWN ON THE PLAN.

GENERAL NOTES

- P.C.C. CROSSWALK SHALL BE NATURAL CONCRETE IN COLOR.
- 12" x 6" PAVERS SHALL BE 4" THICK AND ADDBE TAN IN COLOR. A SAMPLE PAVES SHALL BE SUBMITTED TO THE PUBLIC WORKS DEPARTMENT FOR APPROVAL PRIOR TO CONSTRUCTION.

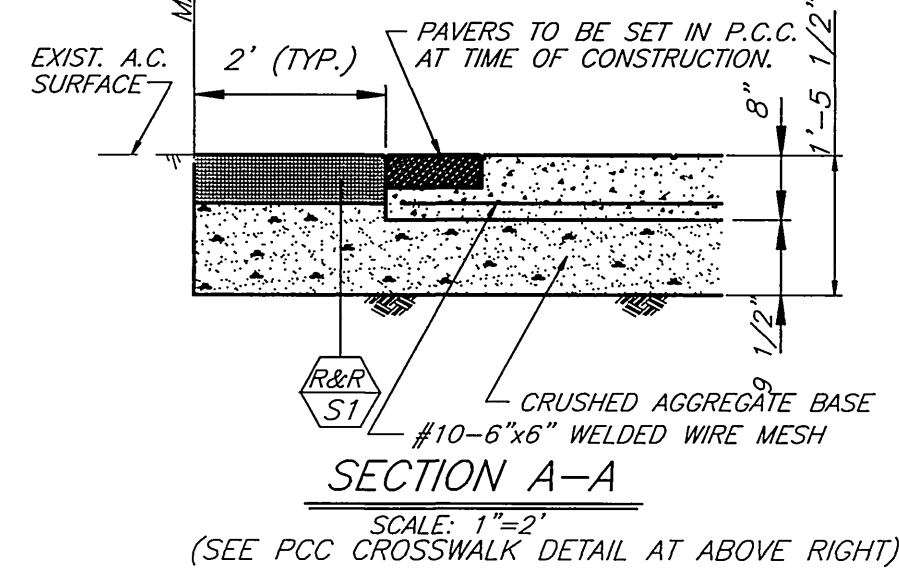

ENGINEER IN RESPONSIBLE CHARGE
Michael Katousian
 MICHAEL KATOUSIAN
 R.C.E. No. 36686 expires 6/30/04
 DATE 12/17/01



MARK	REVISIONS	APPR.	DATE
1	Added signal loops to plan		

CITY OF RIVERSIDE, CALIFORNIA
 PUBLIC WORKS DEPARTMENT

APPROVED BY: *Tom Best*
 DEPUTY PW DIRECTOR/ENGR.
 TRAFFIC DIVISION
 PUBLIC WORKS DIRECTOR
 DATE: 11/1/02

* A5-BUILT 8-25-03 LFH

**MADISON STREET
 STREETSCAPE IMPROVEMENTS**

PHASE 3
 EVANS ST. TO INDIANA AVE.

HORIZ. SCALE: 1" = 20' VERT. SCALE:

ACC. NO. 9740700835-4404463X
R-3603
 SHEET 5 OF 5
 FILE NO.

INDEXED 8-18-03 LFH

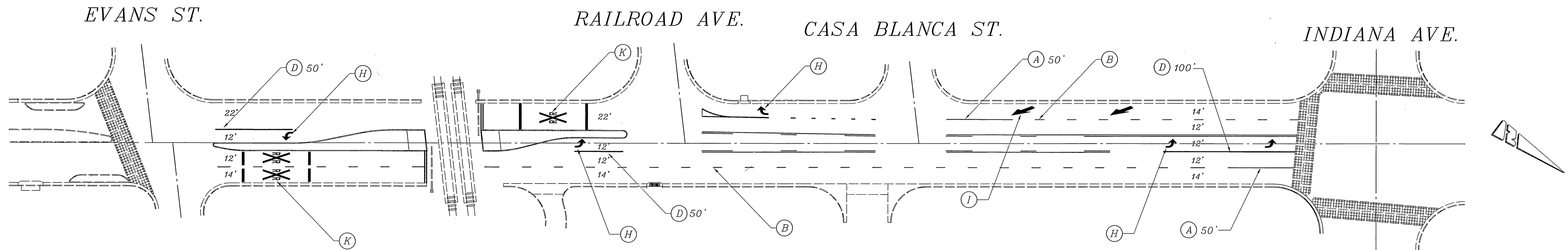
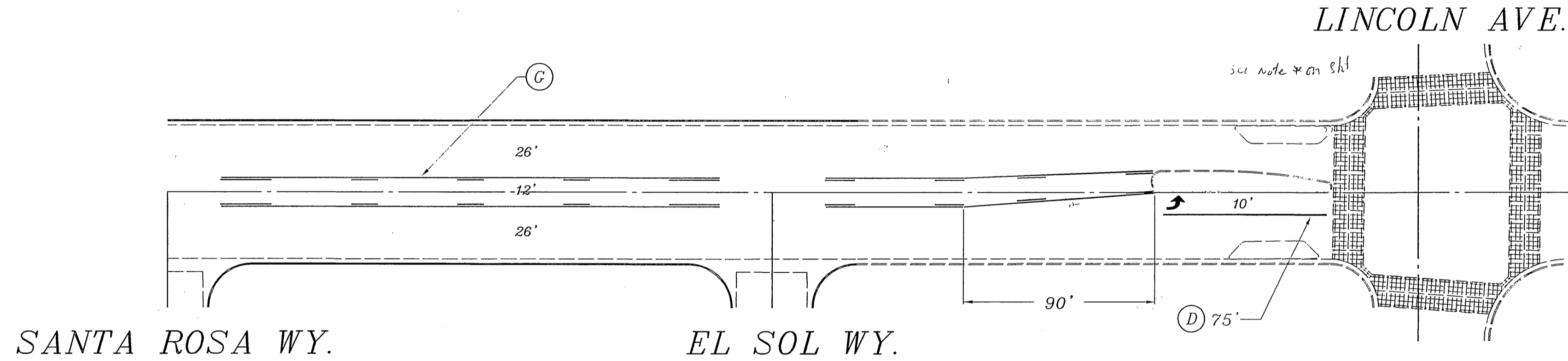
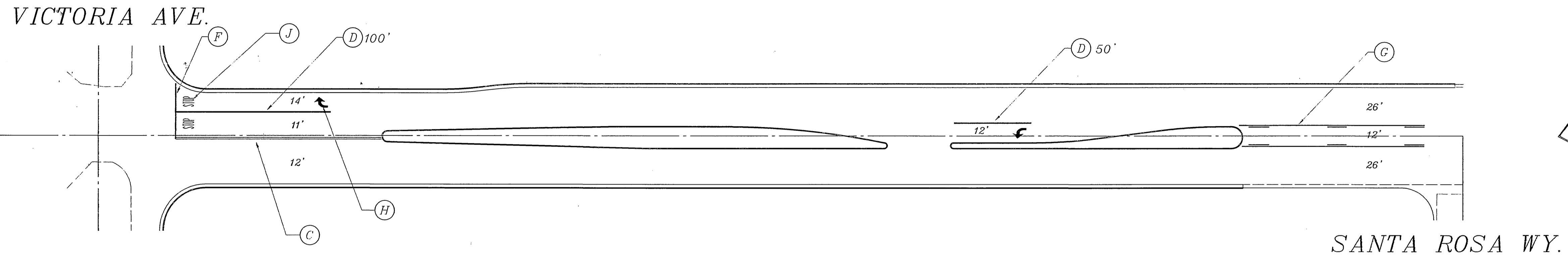

STRIPING & MARKING LEGEND

- (A) 4" SOLID WHITE STRIPE
- (B) 4" DASH WHITE STRIPE (7' STRIPE, 17' GAP)
- (C) 4" SOLID DOUBLE YELLOW
- (D) 8" SOLID WHITE STRIPE
- (E) 8" DASH WHITE STRIPE (3' STRIPE, 12' GAP)
- (F) 12" SOLID WHITE STRIPE
- (G) TWO WAY LEFT TURN
- (H) SOLID WHITE TURN ARROW
- (I) SOLID WHITE LANEDROP ARROW
- (J) SOLID WHITE "STOP" MARKING
- (K) SOLID WHITE "RXR" MARKING

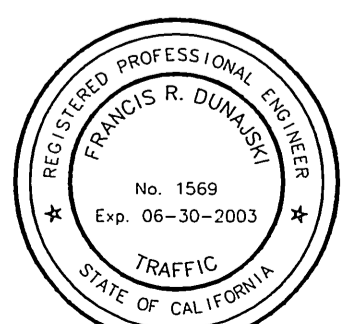

ENGINEER IN RESPONSIBLE CHARGE
 FRAN DUNAJSKI
 DATE 1/3/12

REVISIONS	DATE	APPR.

CITY OF RIVERSIDE, CALIFORNIA DEPARTMENT OF PUBLIC WORKS		
APPROVED BY	BY	DATE
DEPUTY PW DIR./ENG.		
PRINCIPAL ENGINEER		
P.W. INSPECTION		
TRAFFIC DIVISION		
PUBLIC UTILITIES		

STRIPING PLAN
 MADISON STREET
 VICTORIA AVE TO LINCOLN AVE
 EVANS ST TO INDIANA AVE

ACCT. NO.
9740700835-44044600
 XL-460
 SHEET 1 OF 1
 FILE NAME: XL459-1.DWG

FILE W/R-3603
 *AS-BUILT 8-25-03 4H
 INDEXED 8-18-03 4H

SCALE: 1" = 40'