

DATE	BY	REVISIONS

PROFILE SCALES
 Horiz. 1" = 50'
 Vert. 1" = 5'

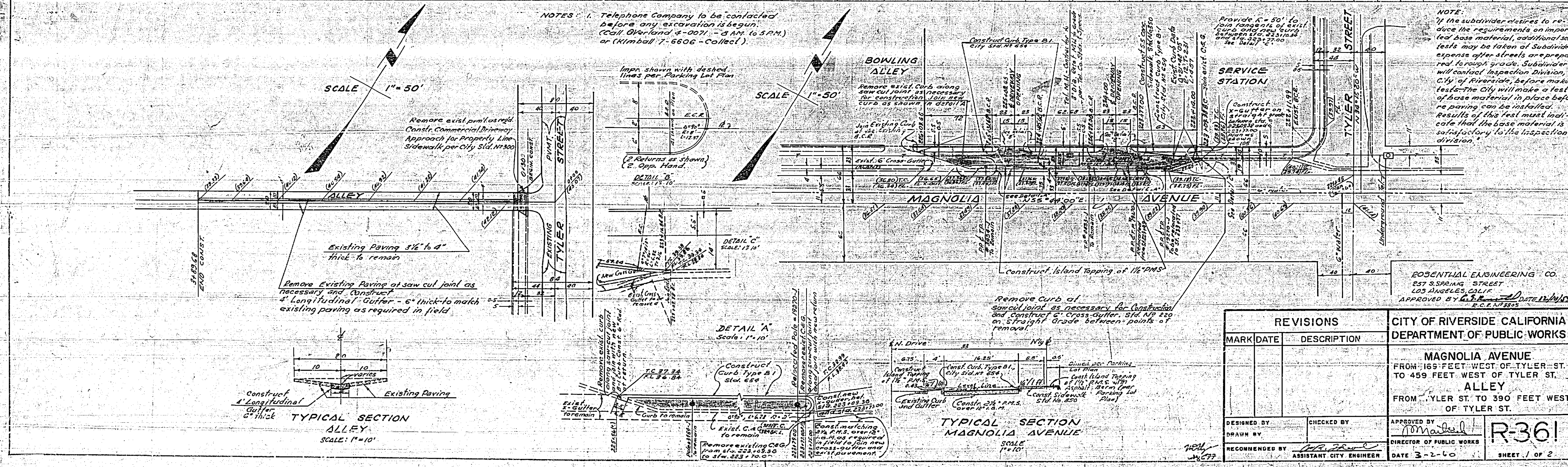

NOTE:
 If the subdivider desires to reduce the requirements on imported base material, additional soil tests may be taken at Subdivider's expense after streets are prepared for rough grade. Subdivider will contact Inspection Division, City of Riverside, before making test. The City will make a test of base material in place before paving can be installed. Results of this test must indicate that the base material is satisfactory to the Inspection Division.

ROSENTHAL ENGINEERING CO.
 257 SPRING STREET
 LOS ANGELES, CALIF.
 APPROVED BY: [Signature] DATE: 12/14/59
 E.C.E. No. 1805

REVISIONS		CITY OF RIVERSIDE, CALIFORNIA DEPARTMENT OF PUBLIC WORKS
MARK	DATE	

DESIGNED BY	CHECKED BY	APPROVED BY	R-36!
DRAWN BY		DIRECTOR OF PUBLIC WORKS	
RECOMMENDED BY	ASSISTANT CITY ENGINEER	DATE 3-2-60	SHEET 1 OF 2



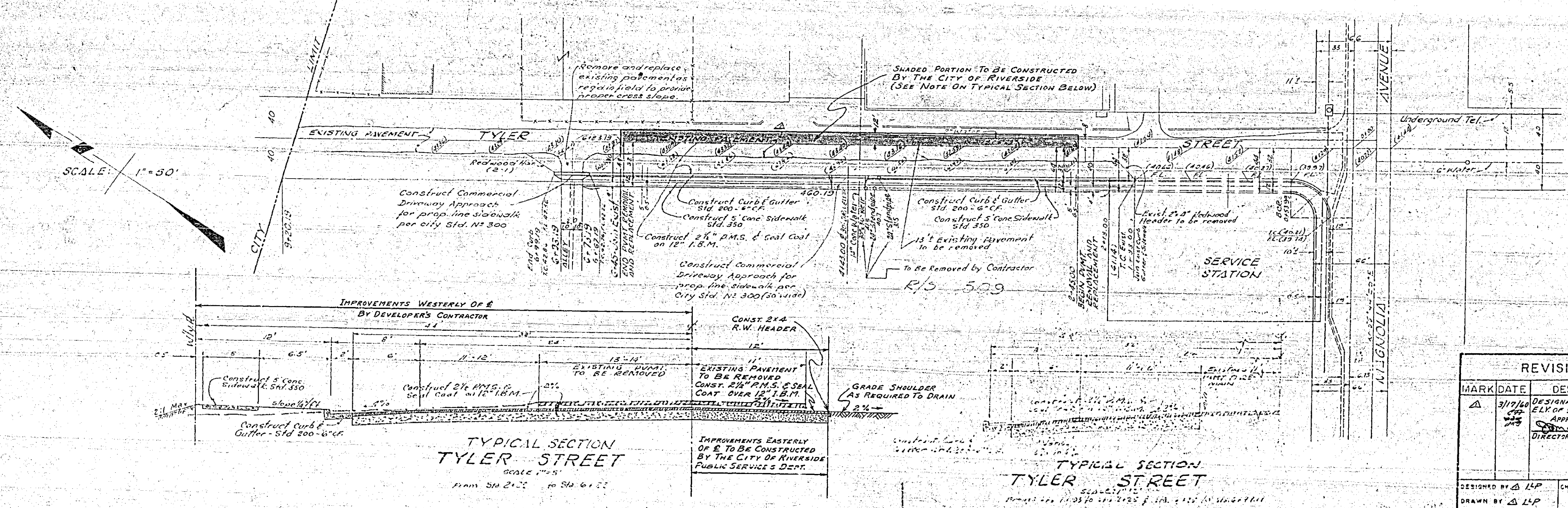
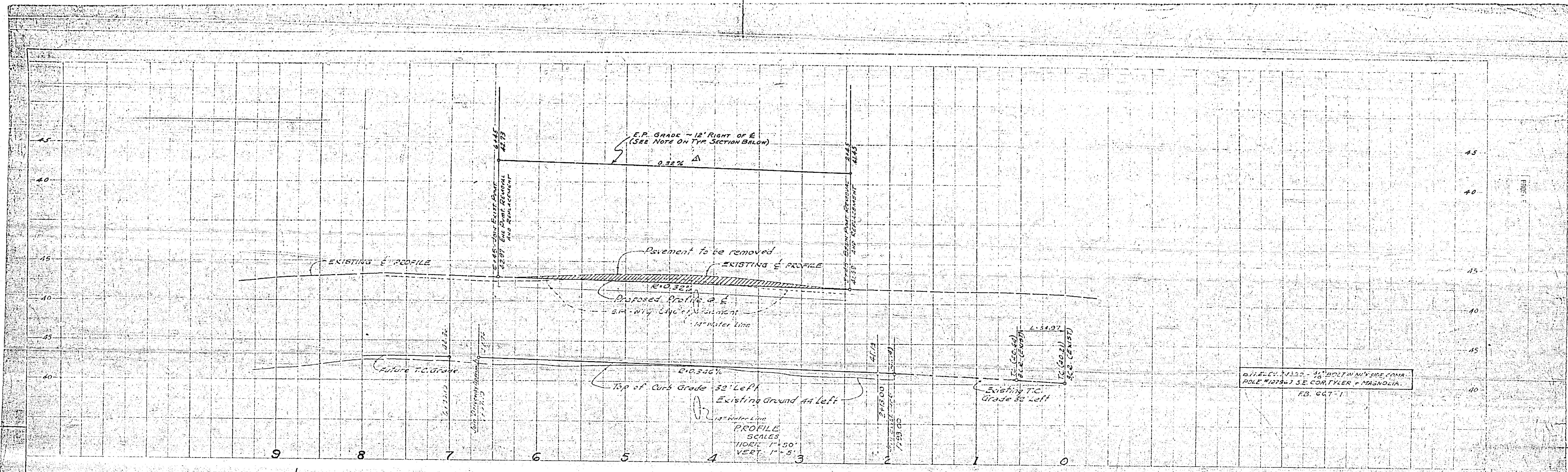

NOTE:
If the Subdivider desires to reduce his requirements on imported base material, additional soil tests may be taken at Subdivider's expense after streets are constructed to rough grade. Subdivider will contact Inspection Division, City of Riverside, before making tests. The City will make a test of base material in place before paving can be installed. Results of this test must indicate that the base material is satisfactory to the Inspection Division.

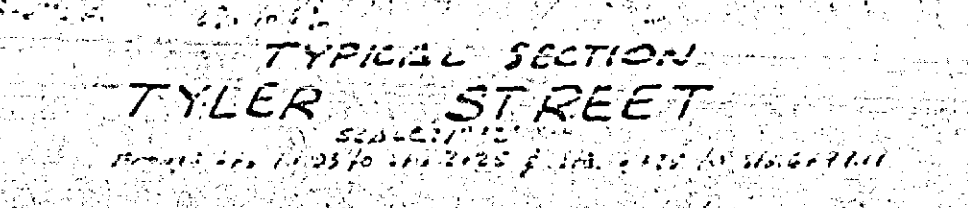
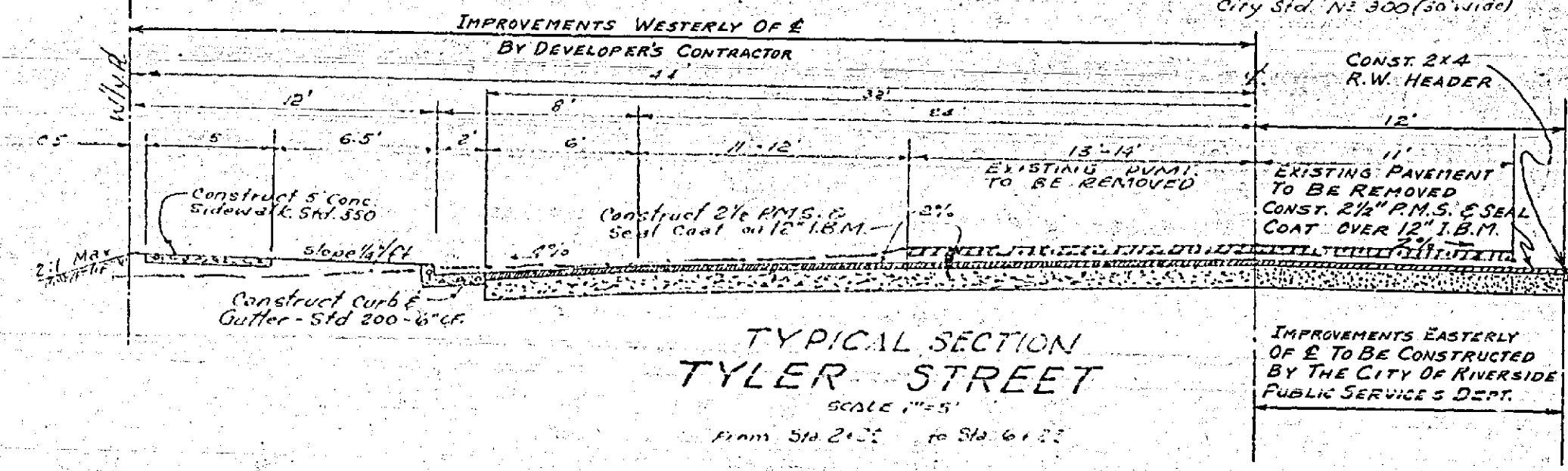

ROSENTHAL ENGINEERING CO.
2578 BARKING STREET
LOS ANGELES, CALIF.
APPROVED BY: [Signature] DATE: 12/14/40
R.C.E. ARCHT.

REVISIONS			CITY OF RIVERSIDE CALIFORNIA DEPARTMENT OF PUBLIC WORKS
MARK	DATE	DESCRIPTION	
Δ	3/17/40	DESIGNATE IMPROVEMENTS ELY. OF E-BY CITY L.P.P. APPROVED BY S. [Signature] DIRECTOR OF PUBLIC WORKS	TYLER STREET FROM 193 FEET NORTHWESTERLY OF MAGNOLIA AVENUE TO 663 FEET NORTHWESTERLY OF MAGNOLIA AVENUE
DESIGNED BY	Δ L.P.P.	CHECKED BY	APPROVED BY
DRAWN BY	Δ L.P.P.		[Signature] DIRECTOR OF PUBLIC WORKS
RECOMMENDED BY	[Signature]	ASSISTANT CITY ENGINEER	DATE 3-2-40

R-361
SHEET 2 OF 2