

# RIVERSIDE CITY OF RIVERSIDE CALIFORNIA

## PUBLIC WORKS DEPARTMENT

# CENTRAL AVENUE WIDENING (AT WILDERNESS AVENUE)

### CONSTRUCTION LEGEND

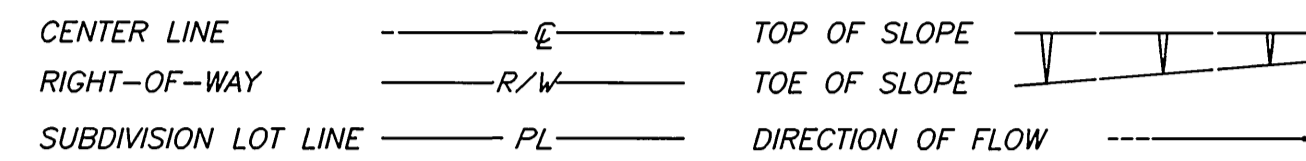

### GENERAL CONSTRUCTION NOTES

- 1 EXISTING UTILITIES SHOWN ON THIS PLAN ARE PLOTTED FROM UTILITY RECORDS. THE CITY CONSTRUCTION UNIT IS REQUIRED TO TAKE DUE PRECAUTIONARY MEASURES TO LOCATE AND PROTECT ALL UTILITIES WHETHER OR NOT SHOWN ON THIS PLAN.
- 2 ALL WORKS SHALL BE IN ACCORDANCE WITH THE CITY OF RIVERSIDE STANDARD DWGS. AND STANDARD SPECIFICATIONS FOR PUBLIC WORKS CONSTRUCTION, 2000 EDITION.
- 3 ALL EXISTING PAVEMENT SHALL BE SAWCUT TO A SMOOTH AND STRAIGHT LINE.
- 4 POTHOLE THE 16" WATER MAIN BEFORE STARTING ANY EXCAVATION.

### SPECIFIC CONSTRUCTION NOTES

NUMBERS ABOVE 100 IN A HEXAGON ON THE PLAN REFER TO THE RESPECTIVE STANDARD DRAWING AND SHALL BE CONSTRUCTED ACCORDINGLY, UNLESS MODIFICATIONS ARE NOTED ON THE PLAN OR COVER SHEET. ANY NUMBER SHOWN BELOW THE STANDARD DRAWING NUMBER INDICATES THE SPECIFIC ALTERNATE TO BE CONSTRUCTED.

- ADJUST EXISTING MANHOLE COVER TO THE FINISHED GRADE.
- ADJUST WATER GATE VALVE COVER TO THE FINISHED GRADE.
- REMOVE & REPLACE EXISTING AC PAVEMENT (APPROXIMATE 4.5" THICK).
- CONSTRUCT STRUCTURE SECTION OF 4.5" AC PAVEMENT OVER 26.5" OF CLASS II AGGREGATE BASE, R-VALUE= 5 PER S.R. NO. 1079 AND C/R PLAN R-3287.
- PAVEMENT STRIPING AND MARKING.

\* POTHOLES CONDUCTED BY PUBLIC UTILITY DEPARTMENT - WATER DIVISION FORCES INDICATE A COVER OF 4.2'± ON TOP OF THE 8" WATER MAIN AT STA. 18+60± AND A COVER OF 3.6'± ON TOP OF THE 12" WATER MAIN AT STA. 19+94±.

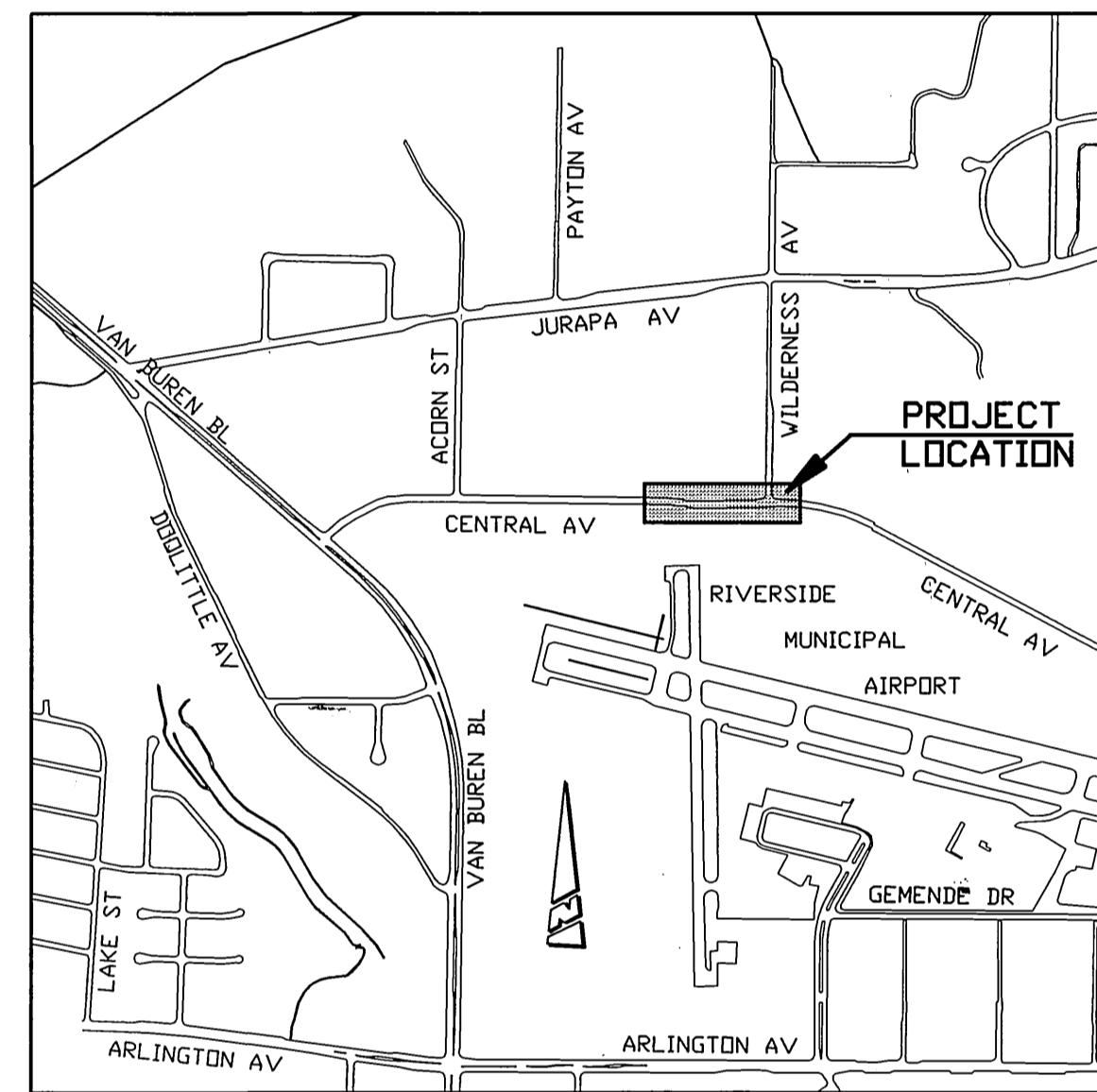

**PROJECT LOCATION MAP**  
(NTS)

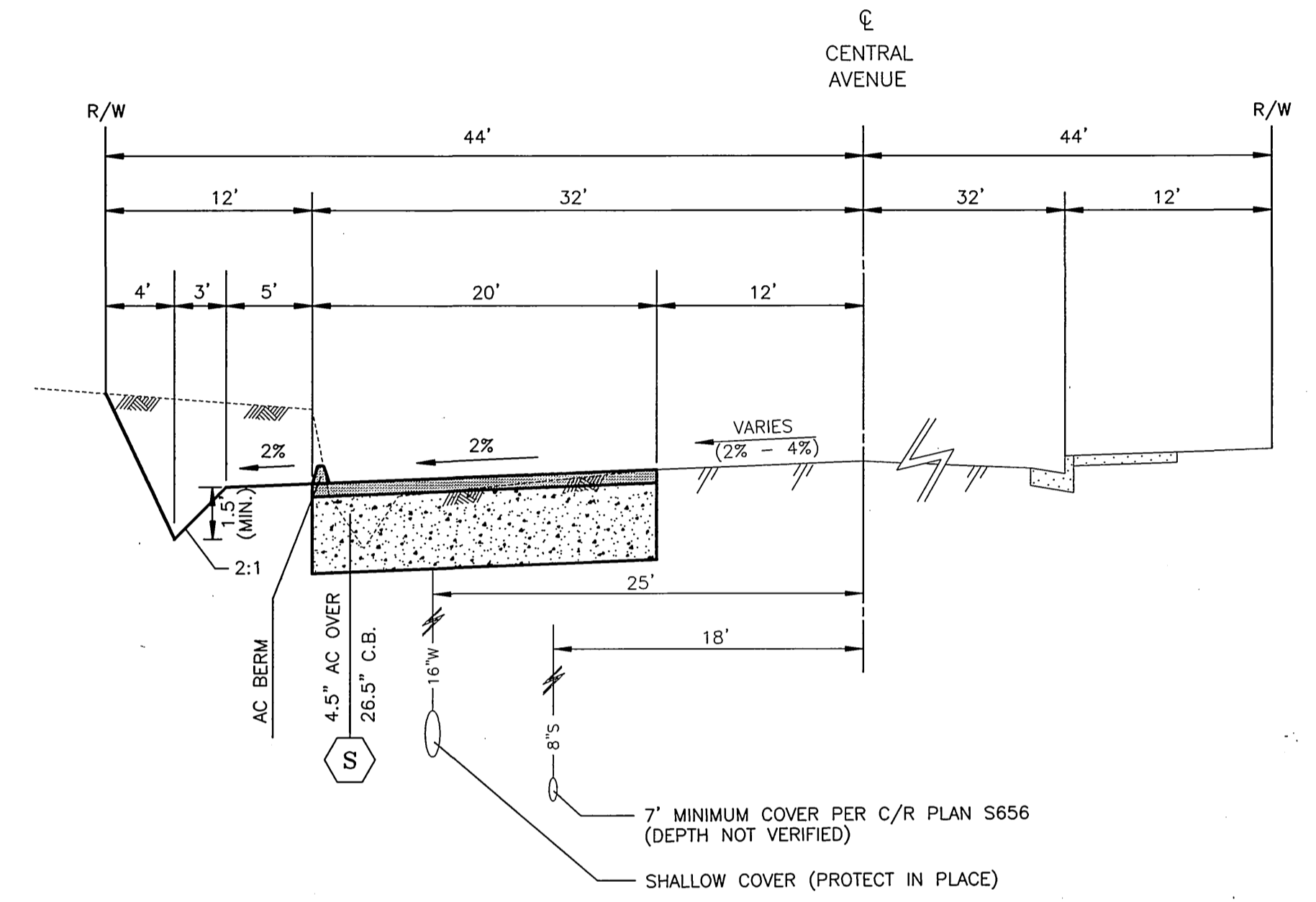

**CENTRAL AVENUE TYPICAL SECTION**  
(NTS)

T.I. = 10 (Per C/R Plan R-3287)

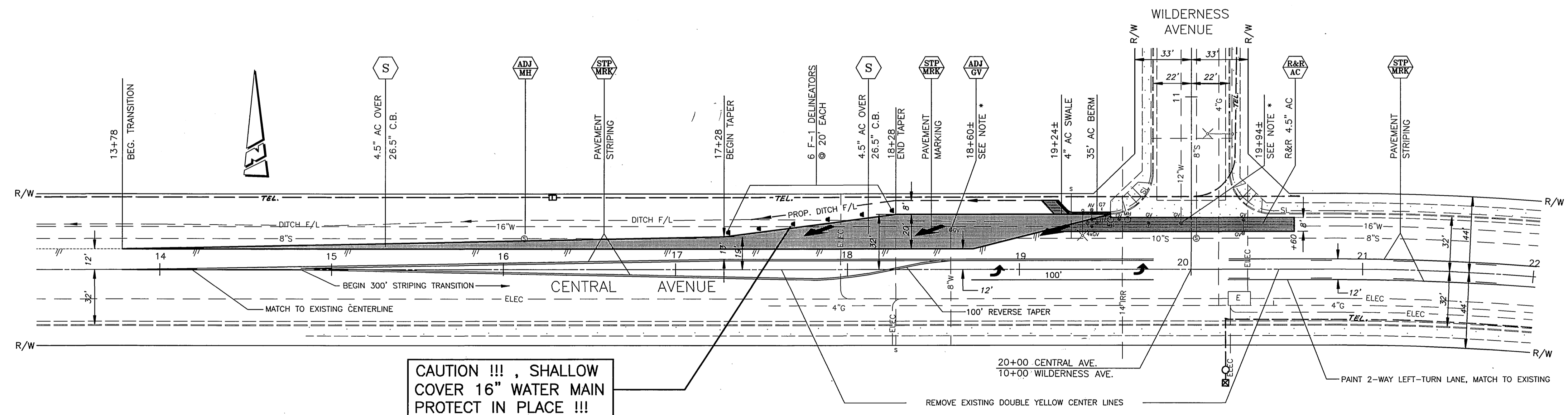

**IMPORTANT NOTICE**  
Section 4216/4217 of the Government Code requires a Dig Alert Identification Number to be issued before a "Permit to Excavate" will be valid. For your Dig Alert I.D. Number call CALL TOLL FREE 48 HOURS BEFORE YOU DIG UNDERGROUND SERVICE ALERT 1-800-227-2600

**ENGINEER IN RESPONSIBLE CHARGE**  
*Michael Katousian*  
MICHAEL KATOUSIAN  
R.C.E. No. 36896 expires 6/30/2004  
DATE 2/16/01

**REGISTERED PROFESSIONAL ENGINEER**  
MICHAEL KATOUSIAN  
No. 36896  
Exp. 6/30/2004  
CIVIL  
STATE OF CALIFORNIA

MARK	REVISIONS	APPR.	DATE

**CITY OF RIVERSIDE, CALIFORNIA PUBLIC WORKS DEPARTMENT**

APPROVED BY	BY	DATE
DEPUTY P.W. DIR./ENCL. PRINCIPAL ENGINEER	<i>[Signature]</i>	2/16/01
INSPECTOR	<i>[Signature]</i>	2/16/01
SURVEYOR	<i>[Signature]</i>	2/16/01
STREET SERVICES	<i>[Signature]</i>	2/16/01
TRAFFIC DIVISION	<i>[Signature]</i>	2/16/01

APPROVED BY: *[Signature]*  
PUBLIC WORKS DIRECTOR  
DATE 3-28-2001

**CENTRAL AVE. WIDENING @ WILDERNESS AVE.**

HORIZ. SCALE: 1" = 40'    VERT. SCALE: 1" = 4'

ACCT. NO.: 9541528234-440304XX  
**R-3612**  
SHEET 1 OF 1  
FILE: (C:\FRANK\DWG)\51743-02

INDEXED 4-12-01 G/H