

IMPROVEMENT PLANS FOR INDIANA AVENUE WIDENING EAST OF MADISON STREET

CU-055-989

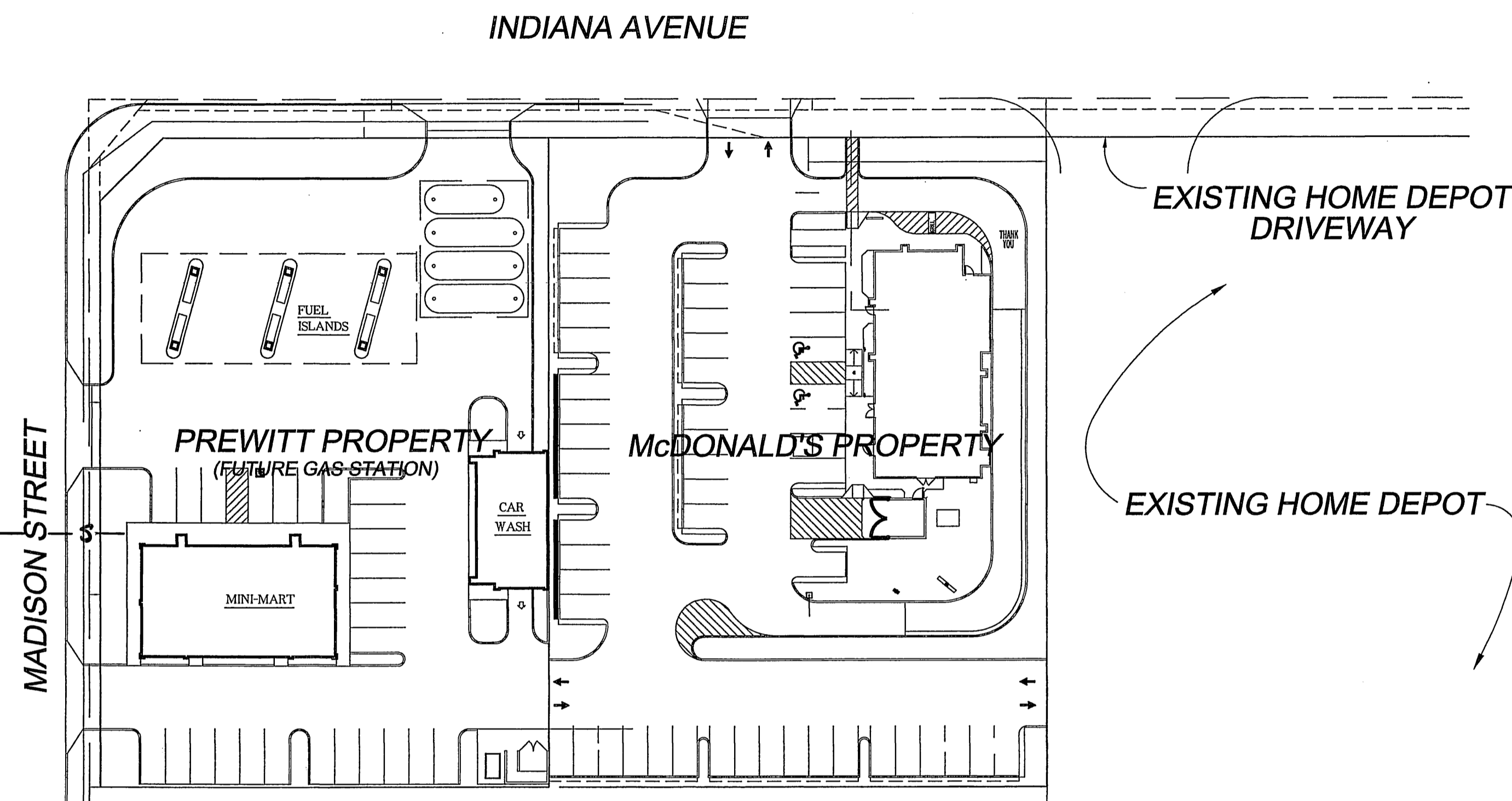

CONSTRUCTION NOTES

- ① CONSTRUCT 6" CURB & GUTTER (TYPE 1) PER CITY STANDARD 200
- ② SAWCUT & REMOVE EXIST. STRUCTURAL SECTION, CURB, GUTTER, SIDEWALK, ETC., AND CONSTRUCT STRUCTURAL SECTION OF 0.50' D.G.A.C. OVER 1.00' C.A.B. OVER COMPACTED NATIVE SOIL. (PER R-3446)
- ③ CONSTRUCT WHEELCHAIR RAMP (TYPE 1) PER CITY STANDARD 304
- ④ RELOCATE EXISTING TREE AS SHOWN
- ⑤ CONSTRUCT DRIVEWAY APPROACH PER CITY STANDARD 302 TYPE CURB 1 (A=30', B=48')
- ⑥ POWER POLE AND/OR GUY TO BE RELOCATED BY CITY FORCES AT DEVELOPER'S EXPENSE. CONTACT RIVERSIDE PUBLIC UTILITIES 90 DAYS IN ADVANCE OF CONSTRUCTION IN ORDER TO COORDINATE POWER POLE RELOCATION SCHEDULE AND EXPENSE
- ⑦ **MODIFY** EXISTING SIGNAL, SERVICE BOX OR PULL BOX PER TRAFFIC SIGNAL PLAN X-422B
- ⑧ CONSTRUCT CURB LINE SIDEWALK PER CITY STANDARD 325
- ⑨ CONSTRUCT 18" RCP (D-2500) AS SHOWN PER CITY STANDARDS
- ⑩ CONSTRUCT JUNCTION STRUCTURE #4 PER CITY STANDARD #423
- ⑪ REMOVE EXISTING STORM DRAIN CLEANOUT & CONSTRUCT NEW CLEANOUT PER CITY OF RIVERSIDE STANDARD NO. 425
- ⑫ CONSTRUCT 18" RCP & CATCH BASIN NO. 1 PER CITY OF RIV. STD 405 $w=4'$ $v=4.2'$
- ⑬ REMOVE EXISTING CATCH BASIN & CLOSE OPENING IN BOX BELOW PER DETAIL "A" ON SHEET 2

NOTE:
DASHED LEADER INDICATES EXISTING LOCATION OF ITEM, SOLID LEADER LINE INDICATES PROPOSED LOCATION OF ITEM

GENERAL NOTES

EXISTING UTILITIES SHOWN ON THIS PLAN ARE PLOTTED FROM UTILITY RECORDS. THE CONTRACTOR IS REQUIRED TO TAKE DUE PRECAUTIONARY MEASURES TO LOCATE AND PROTECT ALL UTILITIES WHETHER OR NOT SHOWN ON THIS PLAN.

ALL FLAGGED ELEVATIONS SHALL BE STAKED IN THE FIELD.

RIGHTS OF ENTRY HAVE BEEN OBTAINED FOR WORK SHOWN OUTSIDE OF CITY RIGHT OF WAY.

ALL PERMANENT PAVEMENT DELINEATION WILL BE PERFORMED BY CITY FORCES.

Station	Elevation @ 19' Rt (Sawcut Line)	Prop. EG Elevation	Cross Slope
10+67	52.71	52.84	+0.62%
10+75	52.82	52.83	+0.05%
11+00	53.08	52.89	-0.90%
11+25	53.40	53.03	-1.76%
11+50	53.56	53.21	-1.67%
11+75	53.82	53.38	-2.10%
12+00	54.03	53.56	-2.24%
12+07.01	54.08	53.61	-2.24%

CENTERLINE ELEVATIONS ARE BASED ON CANTY ENGINEERING GROUP SURVEY DATE SEPT. 19, 2000 BENCHMARK ELEVATION SHOWN BELOW WAS USED AS THE BASE ELEVATION

BENCHMARK:

601-17-68: BRONZE DISK IN CONC. POST @ A.T.&S.F. RAILWAY, 91.5' SW OF MADISON ST. C, 22' SE OF THE SE RAIL OF THE MAIN LINE, 15' NW OF NW RAIL OF SPUR LINE.
ELEV.: 861.455

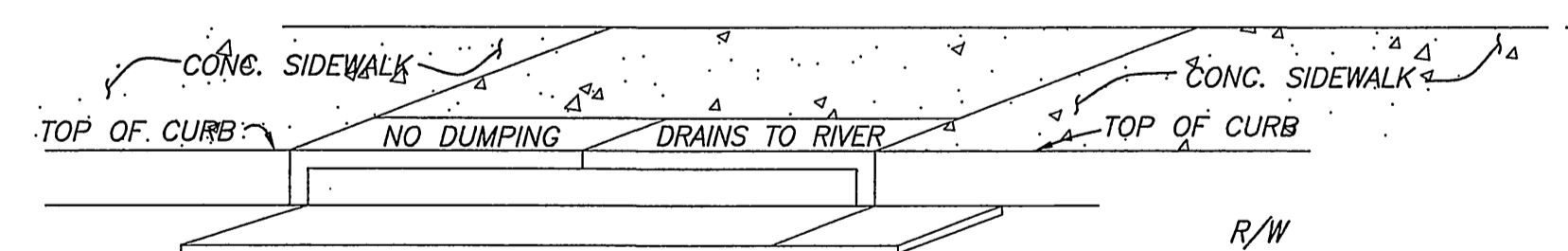

CATCH BASIN STENCILING DETAIL

- N.T.S.
- (A) STENCILS TO HAVE 2" LETTER AS FOLLOWS:
NO DUMPING
DRAINS TO RIVER
 - (B) PLACE BOTH STENCILS CENTERED WITHIN THE CATCHBASIN OPENING AND WITHIN THE TOP OF CURB.
 - (C) SPRAY BOTH STENCILS WITH WHITE PAINT.
 - (D) REMOVE STENCILS WHEN PAINT IS DRY.

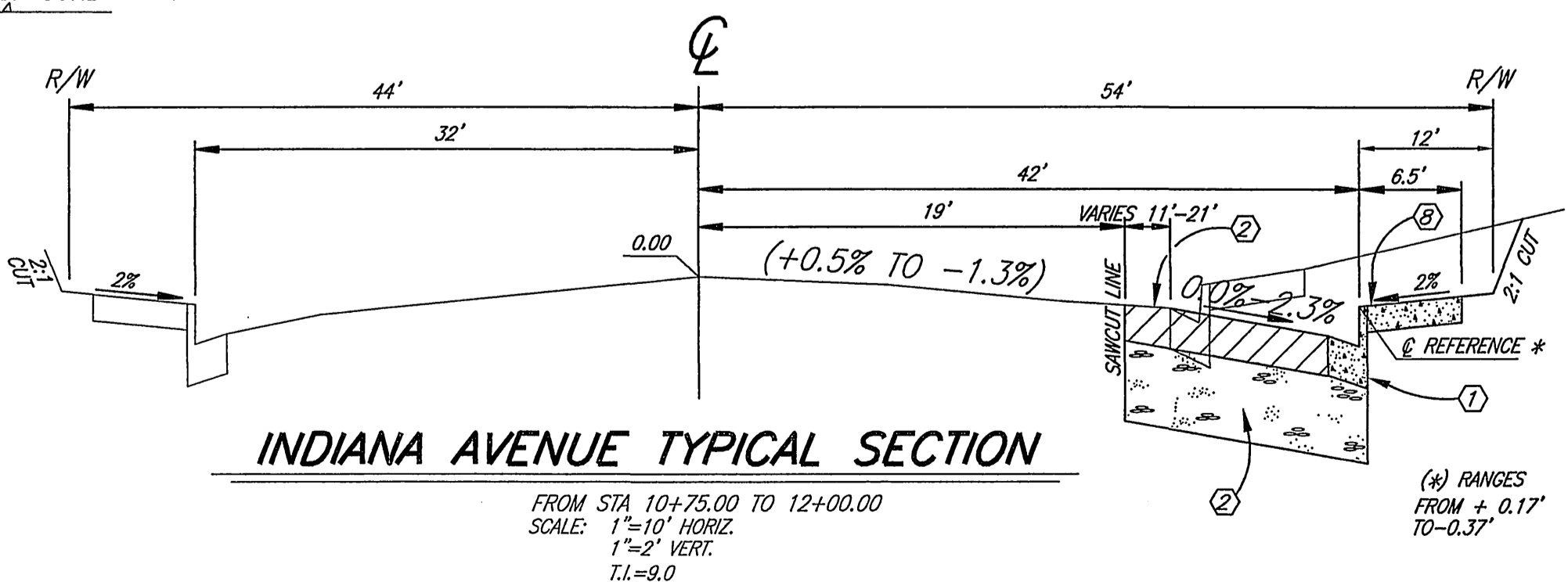

INDIANA AVENUE TYPICAL SECTION

FROM STA 10+75.00 TO 12+00.00
SCALE: 1"=10' HORIZ. 1"=2' VERT. 11.-9.0

STREET TREE NOTES

1. ALL RELATED WORK WITHIN PUBLIC RIGHT OF WAY SHALL CONFORM TO THE CITY OF RIVERSIDE PARK AND RECREATION DEPARTMENT STANDARDS AND CITY OF RIVERSIDE STREET TREE POLICIES.
2. CONTACT THE STREET TREE INSPECTOR A MIN. OF 48 HOURS IN ADVANCE AT (909) 351-6126 TO SCHEDULE INSPECTIONS. A FIELD NOTICE WILL BE ISSUED AS WRITTEN APPROVAL FOR EACH STAGE OF INSPECTION. VERBAL APPROVAL WILL NOT BE ACCEPTABLE. INSPECTIONS ARE REQUIRED AS FOLLOWS:
 - a. AFTER COMPLETION OF FINAL GRADING OF THE LOTS AND WHEN ALL UTILITY SERVICES AND SEWER LATERALS HAVE BEEN MARKED, BUT PRIOR TO DIGGING PLANT PITS, ALL FINAL STREET TREE LOCATIONS ARE TO BE SPOTTED IN THE FIELD BY THE STREET TREE INSPECTOR.
 - b. WHILE DIGGING PLANT PITS AND PLANTING/RELOCATING TREES.
 - c. AFTER PLANTING AND ALL OTHER INDICATED OR SPECIFIED WORK HAS BEEN COMPLETED, FOR START OF MAINTENANCE.
 - d. AT END OF MAINTENANCE PERIOD, THE CONTRACTOR SHALL CALL THE STREET TREE INSPECTOR AT (909) 351-6126 FOR A FINAL ACCEPTANCE INSPECTION IN ORDER TO BE RELEASED FROM MAINTENANCE. CONTRACTOR'S SURETY WILL NOT BE RELEASED UNTIL AFTER RECEIPT OF WRITTEN NOTIFICATION FROM THE CITY THAT THE TREES PASS FINAL INSPECTION AND THE PARK AND RECREATION DEPT. IS ASSUMING MAINTENANCE RESPONSIBILITY.
3. ALL STREET TREES ARE TO BE PLANTED PRIOR TO OCCUPANCY
4. THE DEVELOPER SHALL BE RESPONSIBLE TO ACCEPTABLY MAINTAIN ALL PLANTINGS FOR A MINIMUM PERIOD OF ONE (1) YEAR.
5. STREET TREE PLANTING SHALL BE AS FOLLOWS:

STREET NAME	BOTANICAL NAME/Common Name	MINIMUM SIZE	APPROX. SPACING	NUMBER REQUIRED
INDIANA	EXISTING GUADALUPE PALM	PROTECT IN PLACE		1 EACH
INDIANA	EXISTING GUADALUPE PALM	RELOCATE AS SHOWN		3 EACH

6. BOTH A "STREET TREE RELOCATION/REMOVAL PERMIT" AS ISSUED BY THE PARK AND RECREATION DEPARTMENT, AND A "STREET OPENING PERMIT" AS ISSUED BY THE PUBLIC WORKS DEPARTMENT, ARE REQUIRED PRIOR TO COMMENCEMENT OF TREE RELOCATION AND/OR REMOVAL WORK. FOR ALL EXISTING TREES WITHIN WHAT WILL ULTIMATELY BE THE PUBLIC RIGHT OF WAY PAVEMENT AREA, BACKFILL OF ALL HOLES MUST BE INSPECTED BY THE PUBLIC WORKS INSPECTOR FOR PROPER COMPACTION.
7. ALL STREET TREES MUST BE AUTOMATICALLY IRRIGATED, EXCEPT WHERE ADJACENT TO SINGLE FAMILY OR DUPLEX RESIDENTIAL USES.

NOTE: IN THE INTEREST OF PUBLIC SAFETY AND MAINTENANCE, THE STREET TREE INSPECTOR SHALL HAVE THE AUTHORITY TO REVISE THE STREET TREE QUANTITIES AND LOCATIONS SHOWN ON APPROVED PLANS BASED UPON FIELD CONDITIONS FOUND AT THE TIME OF INSTALLATION OF THE TREES.

INDEX MAP

SCALE: 1" = 40'

Water Note:
DEVELOPER TO GIVE CITY WATER DIVISION FIVE(5) WORKING DAYS WRITTEN NOTICE PRIOR TO START OF CONSTRUCTION AND ALLOW THE CITY TEN (10) WORKING DAYS FOR COMPLETION OF WORK. (909) 351-6268.

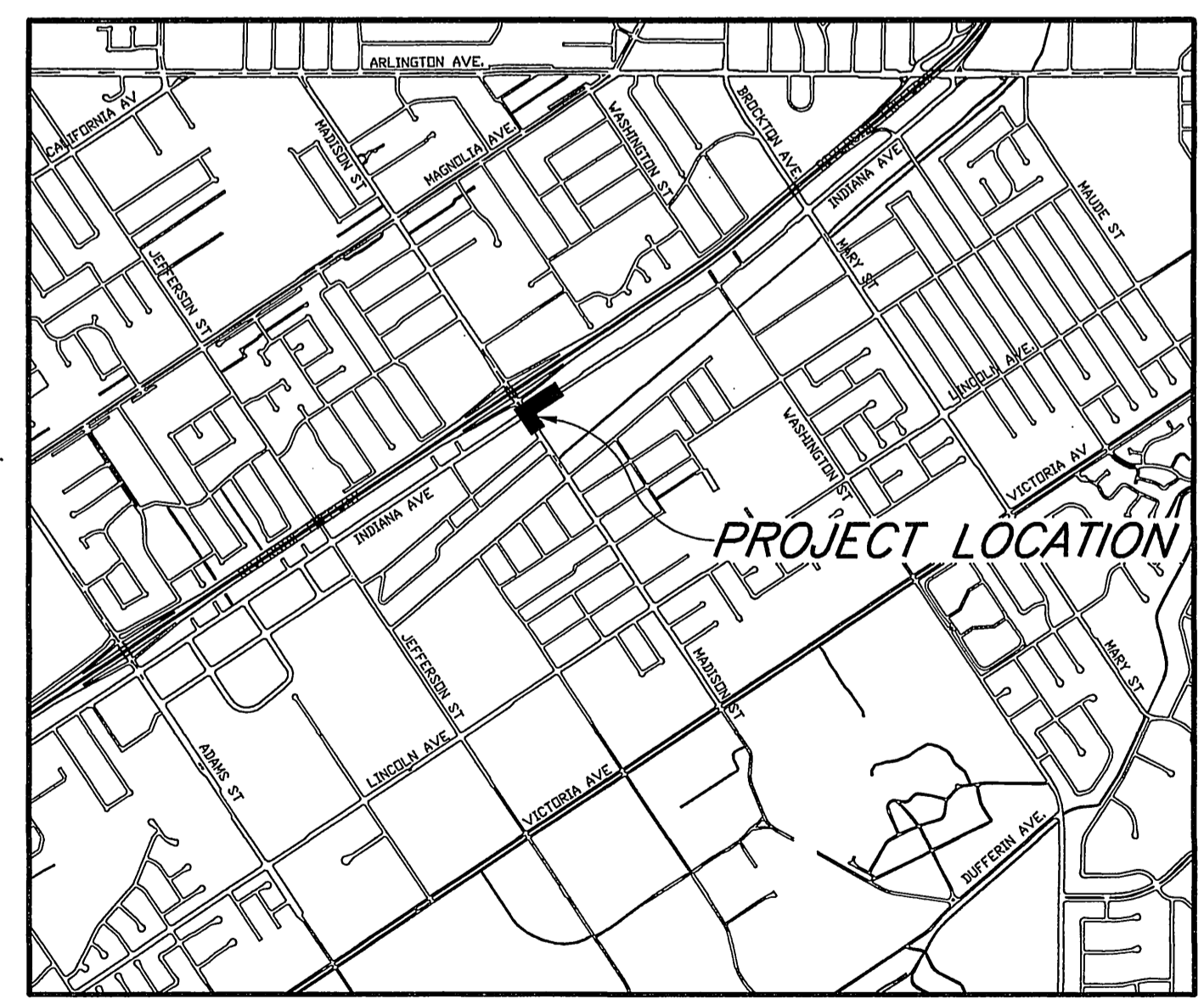

PROJECT LOCATION MAP

SCALE: 1" = 1500'

CITY OF RIVERSIDE PUBLIC UTILITIES DEPT. -ELECTRIC DEPT. OVERHEAD & UNDERGROUND REVIEWED: [Signature] DATE: 7/24/01	CITY OF RIVERSIDE WATER SYSTEM (FOR SH-TS. 1 & 2) APPROVED: [Signature] DATE: 9/26/01	PREPARED UNDER THE SUPERVISION OF: [Signature] DATE: 9/26/01	SEAL JOHN W. CANTY No. 17550 Exp. 08-30-05 CIVIL STATE OF CALIFORNIA	CEG CANTY ENGINEERING GROUP, INC. CIVIL ENGINEERING - PLANNING - SURVEYING 2020 IOWA AVENUE, SUITE 102, P.O. BOX 52050, RIVERSIDE, CA 92517 TEL (909) 683 - 5234 FAX (909) 683 - 5301	CITY OF RIVERSIDE BUSINESS TAX ACCT. NO. 69372 EXP. APRIL 7, 2002	CITY OF RIVERSIDE, CALIFORNIA PUBLIC WORKS DEPARTMENT		CU-055-989 INDIANA AVENUE WIDENING MADISON STREET TO 12+07.01	ACCT. NO. R-3622 SHEET 1 OF 2
						APPROVED BY: [Signature] DEPUTY P.W. DIRECTOR APPROVED BY: [Signature] PUBLIC WORKS DIRECTOR DATE: 10/15/01	SCALE: AS SHOWN INDEXED 1-25-02 Lft		

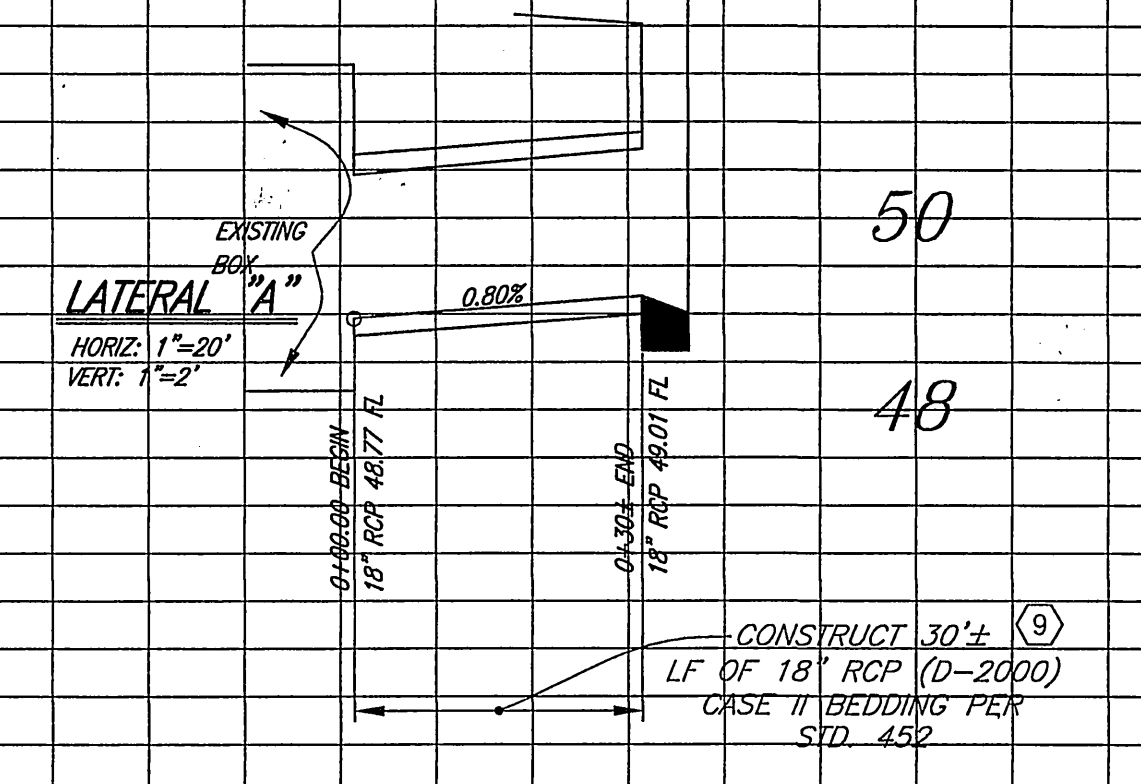
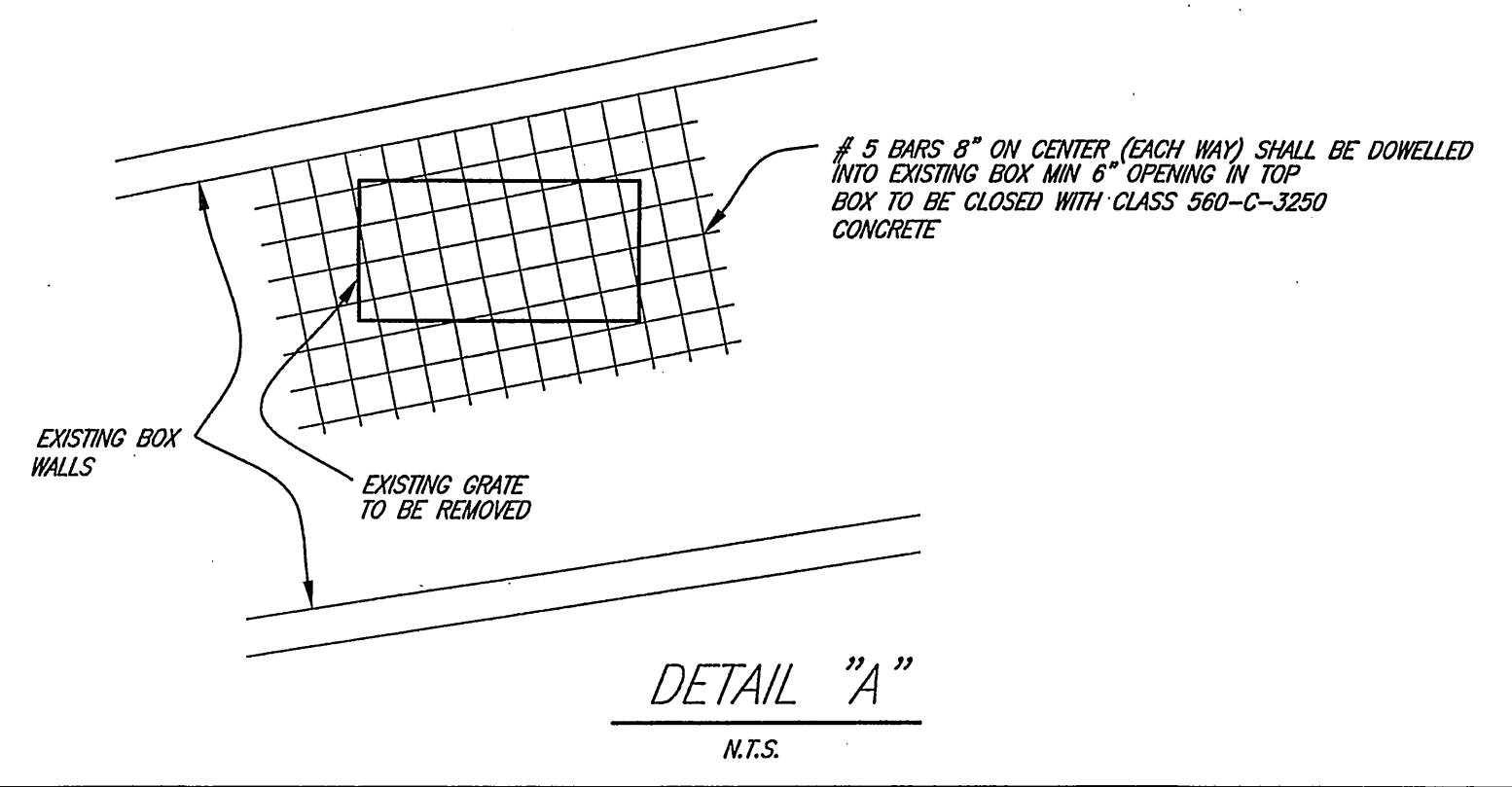
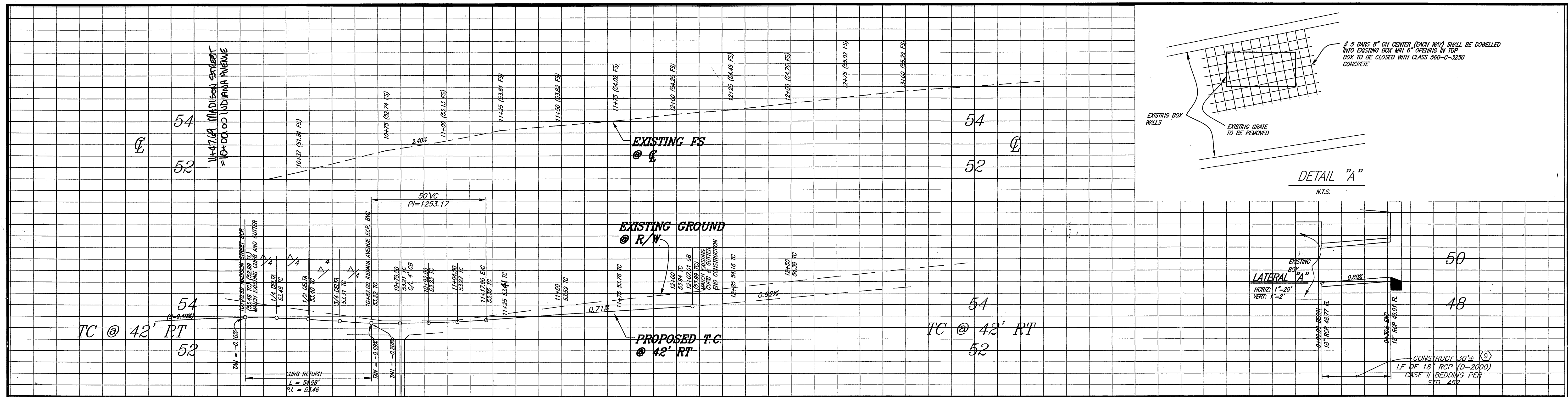

CURVE DATA			
DELTA	RADIUS	LENGTH	TANGENT
90°00'00"	35'	54.98'	35'

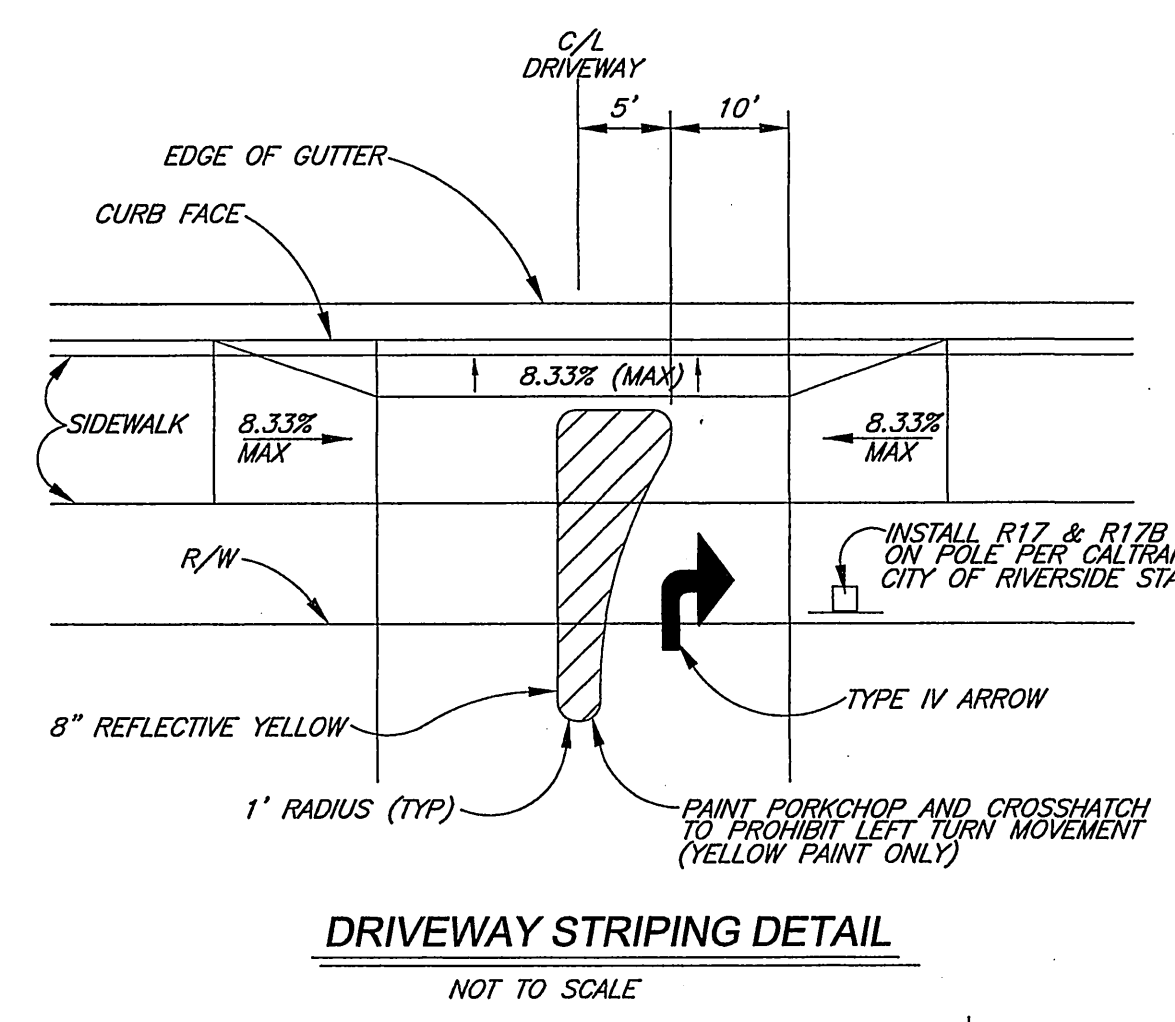

CONSTRUCTION NOTES

- CONSTRUCT 6" CURB & GUTTER (TYPE 1) PER CITY STANDARD 200
- SAWCUT & REMOVE EXIST. STRUCTURAL SECTION CURB, GUTTER, SIDEWALK, ETC., AND CONSTRUCT STRUCTURAL SECTION OF 0.50' D.G.A.C. OVER 1.00' C.A.B. OVER COMPACTED NATIVE SOIL. (PER R-3446)
- CONSTRUCT WHEELCHAIR RAMP (TYPE 1) PER CITY STANDARD 304
- RELOCATE EXISTING TREE AS SHOWN
- CONSTRUCT DRIVEWAY APPROACH PER CITY STANDARD 302 TYPE CURB 1 (A=30', B=48')
- POWER POLE AND/OR GUY TO BE RELOCATED BY CITY FORCES.
- RELOCATE EXISTING SIGNAL, SERVICE BOX PULL BOX PER TRAFFIC SIGNAL PLAN X-422B
- CONSTRUCT CURB LINE SIDEWALK PER CITY STANDARD 325
- CONSTRUCT 18" RCP (D=2500) AS SHOWN PER CITY STANDARDS
- CONSTRUCT JUNCTION STRUCTURE #4 PER CITY STANDARD #423
- REMOVE EXISTING STORM DRAIN CLEANOUT & CONSTRUCT NEW CLEANOUT PER CITY OF RIVERSIDE STANDARD DRAWING NO. 425
- CONSTRUCT CATCH BASIN NO. 1 PER CITY OF RIV. STD 405 W=4' V=4.2'
- REMOVE EXISTING CATCH BASIN & CLOSE OPENING IN BOX BELOW PER DETAIL "A" ABOVE

NOTE:
DASHED LEADER INDICATES EXISTING LOCATION OF ITEM, SOLID LEADER LINE INDICATES PROPOSED LOCATION OF ITEM

BENCHMARK:
601-17-6B: BRONZE DISK IN CONC. POST @ A.T.&S.F. RAILWAY, 91.5' SW OF MADISON ST. @ 22' SE OF THE SE RAIL OF THE MAIN LINE, 15' NW OF NW RAIL OF SPUR LINE.
ELEV.: 861.455

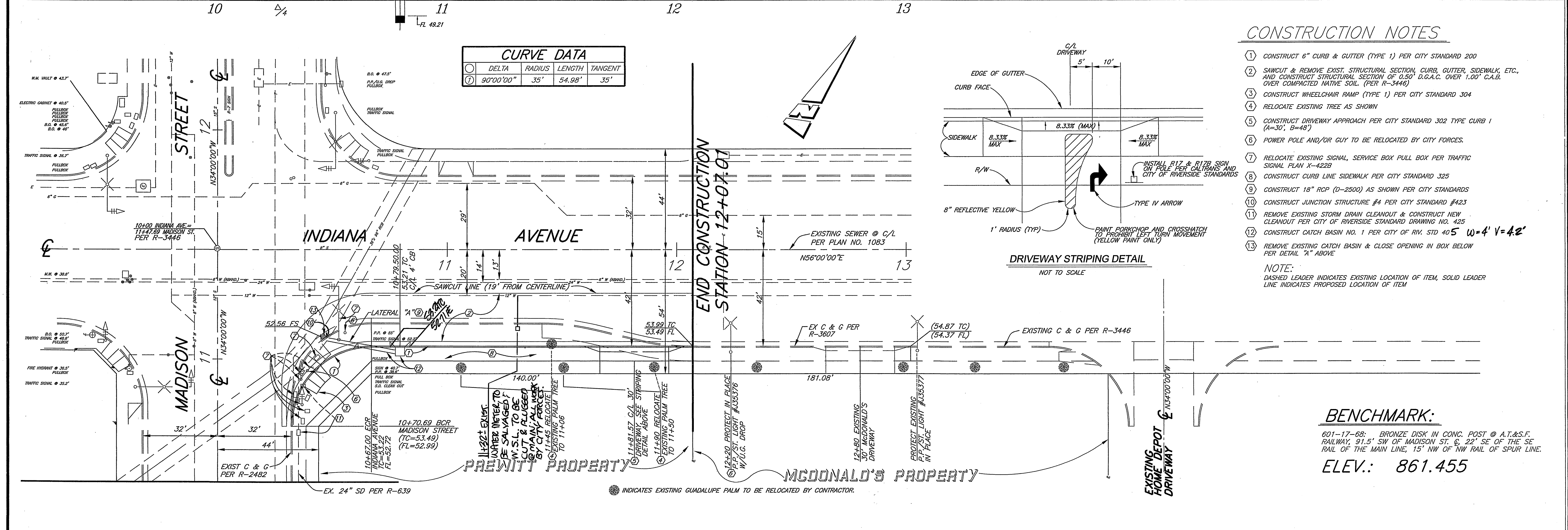

Underground Service Alert
DIAL BEFORE YOU DIG
TWO WORKING DAYS BEFORE YOU DIG
TOLL FREE 1-800-227-2600
A PUBLIC SERVICE BY UNDERGROUND SERVICE ALERT

REGISTERED PROFESSIONAL ENGINEER
JOHN W. CANTY
No. 17850
Exp. 6-30-05
CIVIL
STATE OF CALIFORNIA

PREPARED UNDER THE SUPERVISION OF:
JOHN W. CANTY
DATE 9/26/01

CEC COUNTY ENGINEERING GROUP, INC.
CIVIL ENGINEERING - PLANNING - SURVEYING
2020 IOWA AVENUE, SUITE 102, P.O. BOX 52050, RIVERSIDE, CA 92517
TEL (909) 683 - 5234 FAX (909) 683 - 5301
CITY OF RIVERSIDE BUSINESS TAX ACCT NO. 69372 EXP. APRIL 7, 2002

CITY OF RIVERSIDE, CALIFORNIA
PUBLIC WORKS DEPARTMENT
APPR. TO BY DATE APPROVED BY:
PRINCIPAL ENGINEER: [Signature]
TRAFFIC DIVISION: [Signature]
PUBLIC WORKS DIRECTOR: [Signature]
DESIGNED BY: DC DRAWN BY: DC CHECKED BY: JWC
DATE: 10/15/01

CU-055-989
INDIANA AVENUE WIDENING
MADISON STREET TO 12+07.01
HORIZ. SCALE: 1" = 20' VERT. SCALE: 1" = 2'
ACCT. NO. R-3622
SHEET 2 OF 2
FILE NO. 1175-001
INDEXED 1-25-02 LPH