

GENERAL NOTES:

CITY OF RIVERSIDE STREET IMPROVEMENTS FOR 1691 MAIN STREET

1. No person shall perform any construction activity or install any objects within the public rights-of-way or easements of the City of Riverside without a valid Construction Permit, or a Street Opening Permit, or an Encroachment Permit issued by the City's Public Works Department.
2. It shall be the responsibility of the contractor to clear the right of way in accordance with the provisions of law as it affects each utility including irrigation lines and appurtenances and at no cost to the City.
3. Construction shall be in accordance with the City of Riverside Department of Public Works, Standard Drawings, its Supplemental Notes and the Standard Specifications for Public Works Construction, current edition.
4. The private engineer signing these plans is responsible for assuring the accuracy and acceptability of the work hereon. In the event of discrepancies arising during construction, the private engineer shall be responsible for determining an acceptable solution and revising the plans for approval by the City.
5. Quantities shown are for information only and the City of Riverside is not responsible for their accuracy.
6. The developer shall be responsible for preserving or reestablishing and referencing survey monuments destroyed, disturbed, or buried as a result of construction shown hereon.
7. All flagged elevations shall be staked in the field by the private engineer.
8. Where new pavement is to join the existing pavement, the edge of the existing pavement shall be trimmed in a smooth and straight line. Construct match-up paving as shown on the plans and overlay paving as directed in the field to produce a smooth section.
9. Construct driveway approaches per Standard Drawing 302. Exact size and location to be as shown and staked by the private engineer prior to construction of the curb and gutter.
10. On all areas within public right of way where the fill is one (1) foot or greater, a letter will be required from the Soils Engineer, certifying the compaction of the fill below subgrade, prior to issuance of the Construction Permit/Cut Sheets.
11. The contractor shall call in a location request to Underground Service Alert (USA), phone # 1-800-227-2600, two working days before digging. No construction permit will be issued by the Public Works Department involving excavation for underground facilities unless the applicant has been provided an inquiry identification number by USA.
12. Contractor is to verify sewer elevation prior to construction.
13. Location of laterals to be determined in the field at the direction of the owner. Avoid conflict with proposed and/or existing facilities.
14. No finished floor elevation shall be less than 6" above the upper manhole rim elevation of the sewer line segment being connected to, without having a proper backwater valve installed in the lateral.
15. In pavement overlay areas, any distressed existing pavement shall be removed and replaced as directed by the inspector prior to overlaying with A.C. paving.
16. The contractor shall coordinate trenching for cable television with other trenching within the project.
17. All traffic signs shall be installed prior to opening the streets to traffic.
18. Any traffic control striping obliterated and/or worn during construction shall be restored by the contractor within five days after notification from the City inspectors.
19. Final striping for traffic control and/or pavement marking to be the responsibility of the developer.

LEGAL DESCRIPTION:

THAT PORTION OF LOT 68 ACCORDING TO MAP RECORDED IN BOOK 7, PAGE OF MAPS, RECORDS OF SAN BERNARDINO COUNTY, STATE OF CALIFORNIA

CASE NO.:

RZ-002-012, CU-002-012

ASSESSORS PARCEL NO.:

206-203-012
206-203-013

TOTAL ACREAGE:

0.52 ACRES NET

STREET EXCAVATION:

60± C.Y.

OWNER/DEVELOPER:

GEORGE ECONOMY
3192 PINE ST.
RIVERSIDE, CA 92501
(909) 787-0938

BENCHMARK:

CITY OF RIVERSIDE B.M. NO. 17-G2; A DIVISION OF HIGHWAYS BRASS DISK IN WELL AT THE CL INTERSECTION OF OAKLEY & MAIN ST. ELEV = 825.45

EMERGENCY PHONE NUMBERS:

- CITY OF RIVERSIDE FIRE DEPARTMENT (909) 826-5321
- CITY OF RIVERSIDE POLICE DEPARTMENT (909) 787-7912
- CITY OF RIVERSIDE TRAFFIC DIVISION (909) 826-5366
- CITY OF RIVERSIDE TRAFFIC SIGNALS (909) 351-6096
- STREET SUPERINTENDENT (909) 351-6129
- RIVERSIDE SCHOOLS (909) 788-7132
- GOODHEW AMBULANCE (909) 684-5520
- CORONA REGIONAL MEDICAL CENTER (909) 736-6241
- PACIFIC BELL TELEPHONE (800) 303-3000
- SOUTHERN CALIFORNIA EDISON COMPANY (909) 351-2450
- SOUTHERN CALIFORNIA GAS COMPANY (800) 227-2600
- UNDERGROUND SERVICE ALERT (800) 422-4133

UTILITIES:

- ELECTRIC _____ SO. CAL. EDISON CO.
- GAS _____ SO. CAL. GAS CO.
- WATER _____ CITY OF RIVERSIDE
- SEWER _____ CITY OF RIVERSIDE
- TELEPHONE _____ PACIFIC TELEPHONE

CONSTRUCTION NOTES:

- 1—CONST. CURB & GUTTER PER CITY OF RIVERSIDE STD. 200 (TYPE I) 225 L.F.
- 2—CONST. P.C.C. SIDEWALK PER CITY OF RIVERSIDE STD. 325 1,500 S.F.
- 3—CONST. 4" A.C. OVER 6" C.A.B. PER S.R.1595; R-VALUE = 30 1,100 S.F.
- 4—COLD PLANE EXISTING PAVEMENT 6' WIDE (DEPTH =0.15') 1,700 S.F.
- 4A—OVERLAY TO SMOOTH TRANSITION 3,700 S.F.
- 5—SAWCUT & REMOVE EXISTING SIDEWALK 1,500 S.F.
- 6—SAWCUT & REMOVE EXISTING CURB & GUTTER 265 L.F.
- 7—CONST. DRIVEWAY APPROACH PER CITY OF RIVERSIDE STD. 302 (TYPE CURB-I) LUMP SUM
- 8—REMOVE EXIST. PULL BOX 1 EA.
- 9—ADJUST EXIST. SEWER MH TO GRADE 1 EA.
- 10—REMOVE EXIST. CATCH BASIN LUMP SUM
- 11—CONST. WHEELCHAIR RAMP PER CITY OF RIVERSIDE STD. 304 (TYPE 1) 1 EA.
- 12—INSTALL PULL BOX 3 EA.
- 13—RECONSTRUCT EXIST. DRIVEWAY PER FIELD CONDITION & CITY INSPECTOR LUMP SUM
- 14—CONST. CATCH BASIN PER CITY OF RIVERSIDE STD. 405 1 EA.
- 15—CONST. 24" RCP (2000 D) 10 L.F.
- 16—CONST. 24" CONCRETE COLLAR PER CITY OF RIVERSIDE STD. 424 1 EA.
- 17—REMOVE INTERFERING PORTION OF EXIST. 24" RCP LUMP SUM
- 18—CONST. 8" PVC DRAIN PIPE (PRIVATE DRAIN) 25 L.F.
- 19—RELOCATE NO PARKING (R26) SIGN 1 EA.

QUANTITIES:

NOTICE TO CONTRACTORS:

CONTRACTOR SHALL POT-HOLE AT THE TIE-IN STATIONS AND AT ANY OTHER POINTS OF POTENTIAL CONFLICTS WITH UNDERGROUND FACILITIES BEFORE STARTING CONSTRUCTION. EXISTING SUBSURFACE UTILITY DATA ON DRAWINGS WERE OBTAINED FROM VARIOUS SOURCES. NEITHER THE ACCURACY NOR THE COMPLETENESS OF THE INFORMATION SHOWN IS GUARANTEED PRIOR TO CONSTRUCTION. THE CONTRACTOR SHALL VERIFY THE LOCATION AND ELEVATION OF EXISTING WATER MAINS, GAS MAINS, SANITARY SEWERS, STORM DRAINS, ELECTRIC CONDUITS, TELEPHONE LINES AND ANY OTHER UTILITIES WHICH MAY CONFLICT WITH THE DESIGN AND CONSTRUCTION OF THE PROPOSED IMPROVEMENTS. RIM ELEVATIONS SHOWN ON THESE PLANS ARE APPROXIMATE ONLY. THE RING AND COVER SHALL BE ADJUSTED IN THE FIELD TO MATCH THE FINISHED SURFACE OF THE PAVEMENT TO FORM A SMOOTH DRIVING SURFACE. THE CONTRACTOR IS REQUIRED TO TAKE DUE PRECAUTIONARY MEASURES TO PROTECT ANY UTILITY LINES SHOWN AND ANY OTHER LINES NOT OF RECORD OR NOT SHOWN ON THESE PLANS. THE CONTRACTOR SHALL BE HELD RESPONSIBLE FOR ALL COSTS FOR THE REPAIR OF ANY AND ALL DAMAGE TO THE CONTRACT WORK OR TO ANY UTILITY (WHETHER PREVIOUSLY KNOWN OR DISCLOSED DURING THE WORK) AS MAY BE CAUSED BY HIS OPERATIONS. UTILITIES NOT SHOWN ON THE DRAWING TO BE RELOCATED OR ALTERED BY OTHERS SHALL BE MAINTAINED BY THE CONTRACTOR. AT THE COMPLETION OF THE CONTRACT WORK, THE CONTRACTOR SHALL LEAVE ALL UTILITIES AND APPURTENANCES IN A CONDITION SATISFACTORY TO THE OWNERS AND THE CITY.

ENGINEER'S NOTICE TO CONTRACTORS:

1. THE EXISTENCE AND LOCATION OF ANY UNDERGROUND UTILITY PIPES OR STRUCTURES SHOWN ON THESE PLANS WERE OBTAINED BY A SEARCH OF AVAILABLE RECORDS. THESE LOCATIONS ARE APPROXIMATE AND SHALL BE CONFIRMED IN THE FIELD BY THE CONTRACTOR, SO THAT ANY NECESSARY ADJUSTMENT CAN BE MADE IN ALIGNMENT AND/OR GRADE OF THE PROPOSED IMPROVEMENT. THE CONTRACTOR IS REQUIRED TO TAKE DUE PRECAUTIONARY MEASURES TO PROTECT ANY UTILITY LINES SHOWN AND ANY OTHER LINES NOT OF RECORD OR NOT SHOWN ON THESE PLANS.
2. CARE SHOULD BE TAKEN TO PREVENT GRADED DITCHES AND SWALES FROM UNDERMINING STREET IMPROVEMENTS. UPON INSPECTION OF THE SITES, THE CITY ENGINEER MAY REQUIRE TEMPORARY GUNITE SWALES, ENTERING OR LEAVING IMPROVEMENTS.
3. ALL AREAS SHALL SLOPE A MINIMUM OF 1.0% TO STREETS, DRIVE OR SWALE UNLESS OTHERWISE NOTED.
4. QUANTITIES SHOWN HERE ARE FOR PLAN CHECKING PURPOSES ONLY. CONTRACTOR IS RESPONSIBLE TO PERFORM HIS OWN QUANTITIES TAKEOFF.
5. CONTRACTOR AGREES THAT HE SHALL ASSUME SOLE AND COMPLETE RESPONSIBILITY FOR JOB SITE CONDITIONS; DURING THE COURSE OF CONSTRUCTION OF THIS PROJECT, INCLUDING SAFETY OF ALL PERSONS AND PROPERTY; THAT THE REQUIREMENTS SHALL APPLY CONTINUOUSLY AND NOT BE LIMITED TO NORMAL WORKING HOURS; AND THE CONTRACTOR SHALL DEFEND, INDEMNIFY AND HOLD THE CITY OF RIVERSIDE AND THE ENGINEER HARMLESS FROM ANY AND ALL LIABILITY, REAL OR ALLEGED, IN CONNECTION WITH THE PERFORMANCE OF WORK ON THIS PROJECT, EXCEPTING FOR LIABILITY ARISING FROM THE SOLE NEGLIGENCE OF THE CITY OF RIVERSIDE OR THE ENGINEER.

LEGEND:

- — — — — FLOW LINE
- — — — — PROPERTY LINE
- — — — — CENTER LINE
- — — — — EXISTING WATER LINE
- — — — — EXISTING SANITARY SEWER LINE
- — — — — EXISTING CONTOUR
- E.P. = EDGE OF PAVEMENT
- W.V. = WATER VALVE
- W = WATER MAIN
- W.M. = WATER METER
- FL = FLOW LINE
- T.G. = TOP OF GRATE
- INV. = INVERT ELEVATION
- A.C. = ASPHALT CONCRETE
- FG = FINISHED GRADE
- FS = FINISHED SURFACE
- TC = TOP OF CURB

TRAFFIC & STRIPING NOTES:

- 1 SEE PLAN X-424A FOR TRAFFIC SIGNAL WORK
- 2 SEE PLAN X-424A FOR STRIPING WORK

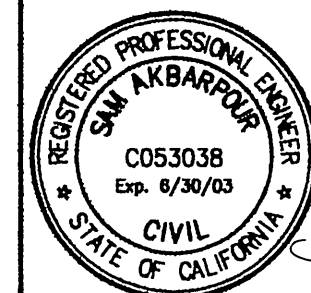
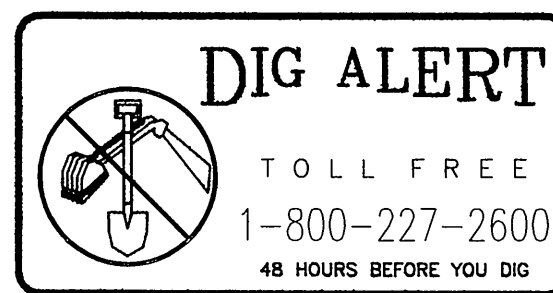
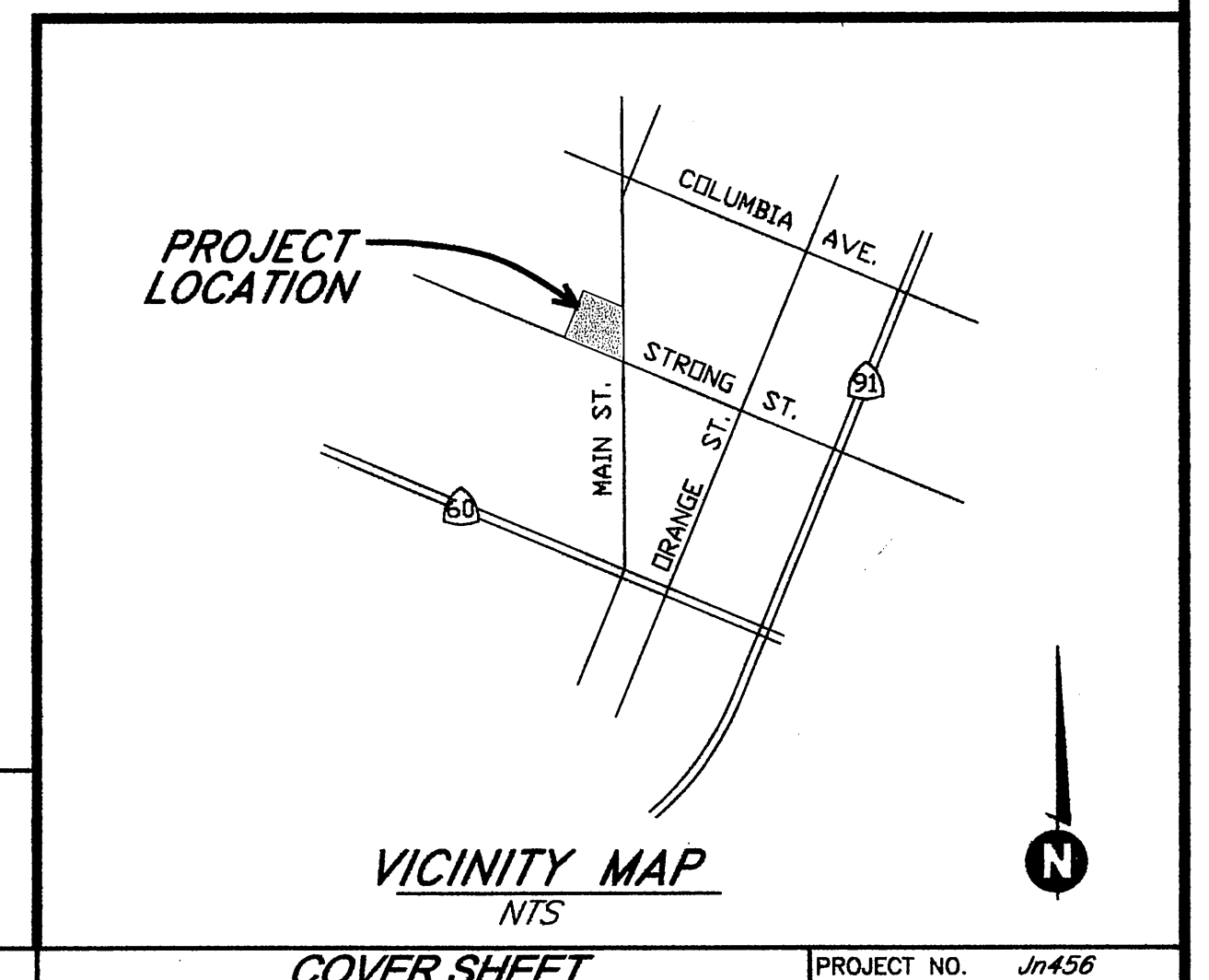

R.C.E. No. DATE

CITY OF RIVERSIDE BUSINESS TAX ACCOUNT #11955 EXP. 3/02/03
DANIEL C. GOMEZ dba LANDMARK SURVEY
9342 NARNIA DR.
RIVERSIDE, CA 92503
(909) 358-1305

SAKE CONSULTING ENGINEERS, INC.
ENGINEERING • ARCHITECTURE • LAND DEVELOPMENT
400 S. RAMONA AVE., STE. 202
CORONA, CALIFORNIA 92709
(909) 279-4041 FAX (909) 279-2830

SOUTHERN CALIFORNIA GAS COMPANY
APPROVED BY *[Signature]* DATE 7/25/02

PACIFIC BELL TELEPHONE
APPROVED BY *[Signature]* DATE 7/26/02

CHARTER COMMUNICATIONS
APPROVED BY *[Signature]* DATE 7/23/02

CITY OF RIVERSIDE PUBLIC UTILITIES DEPARTMENT - ELECTRIC OVERHEAD & UNDERGROUND
APPROVED BY *[Signature]* DATE 7/23/02

CITY OF RIVERSIDE, WATER DIVISION
APPROVED BY *[Signature]* DATE 7/23/02
VOID 1 YEAR AFTER DATE APPROVED

CITY OF RIVERSIDE, CALIFORNIA DEPARTMENT OF PUBLIC WORKS
APPROVED BY *[Signature]* BY DATE APPROVED BY
PRINCIPAL ENGINEER *[Signature]* 7/23/02
PARK DEPARTMENT *[Signature]* 7/23/02
TRAFFIC DIVISION *[Signature]* 7/23/02
DEPUTY P.W. DIRECTOR *[Signature]* DATE 7/23/02

COVER SHEET		PROJECT NO. Jn456
RZ-002-012, CU-002-012 1691 MAIN STREET		R-3659
SHEET 1 OF 2		FILE NO.
HORIZ. SCALE: NONE	VERT. SCALE: NONE	

INDEXED 9-25-02 gft

* FLOWLINE TRANSITIONS FROM BCR & ECR TO CATCH BASIN

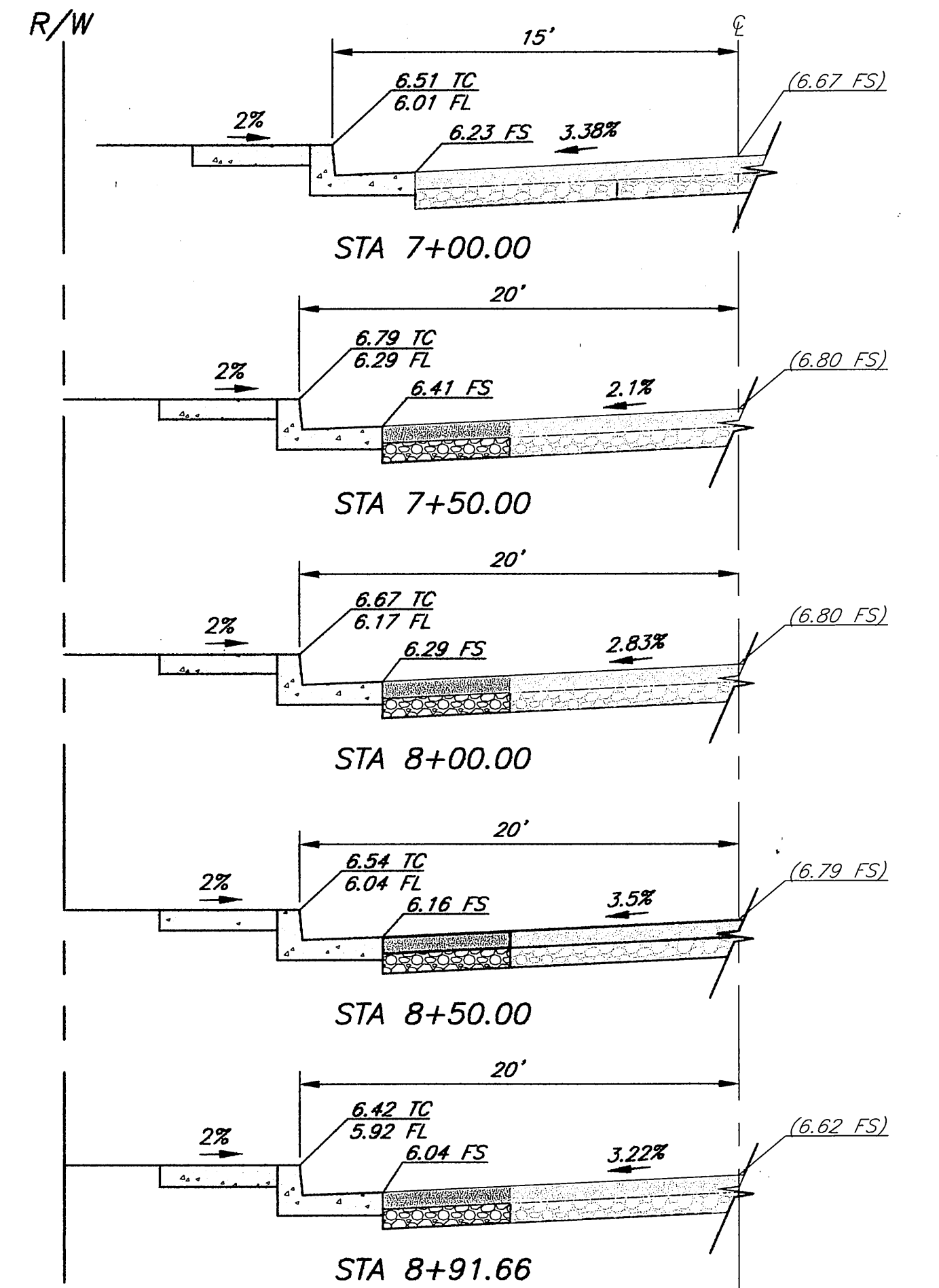
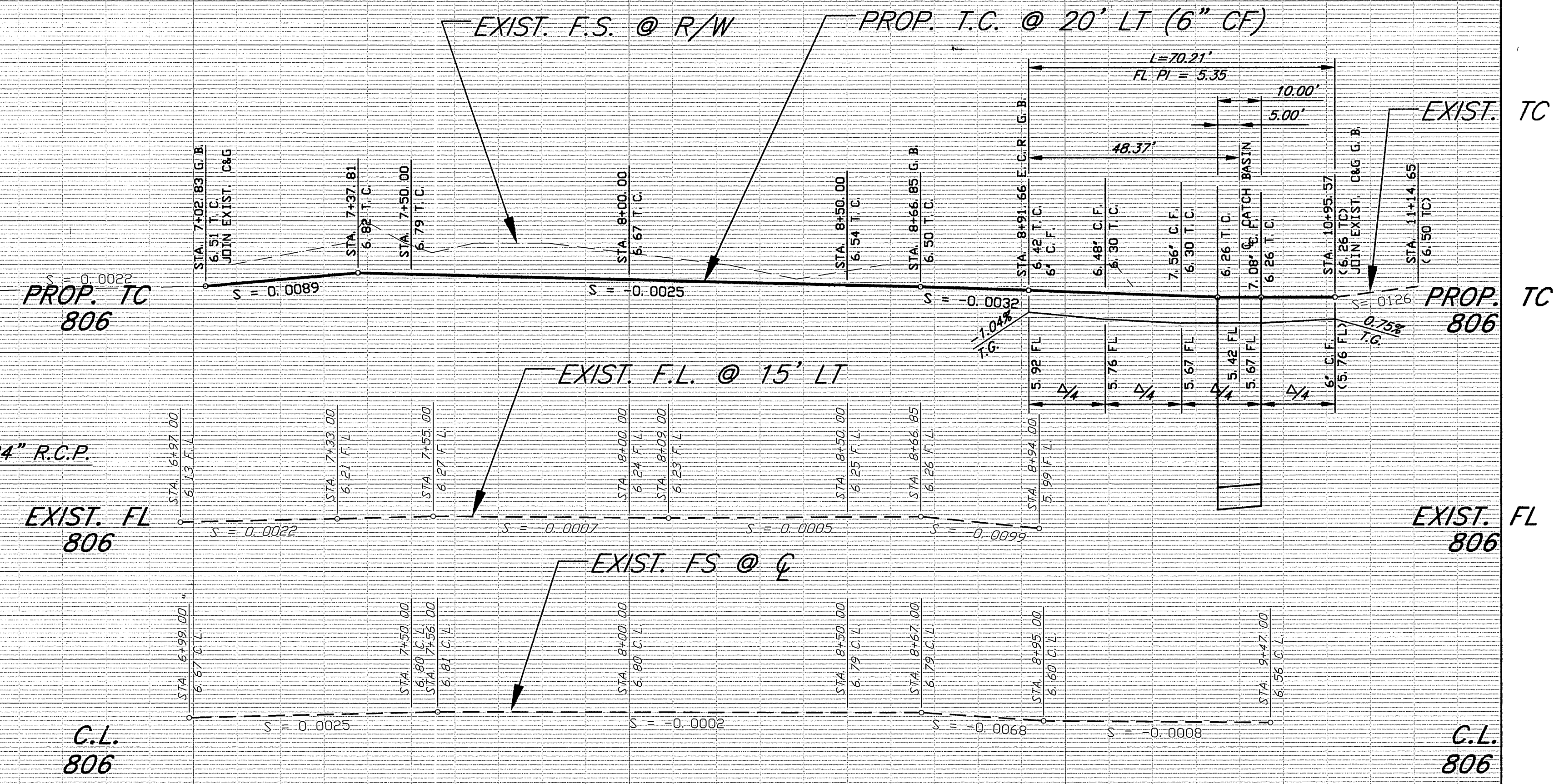
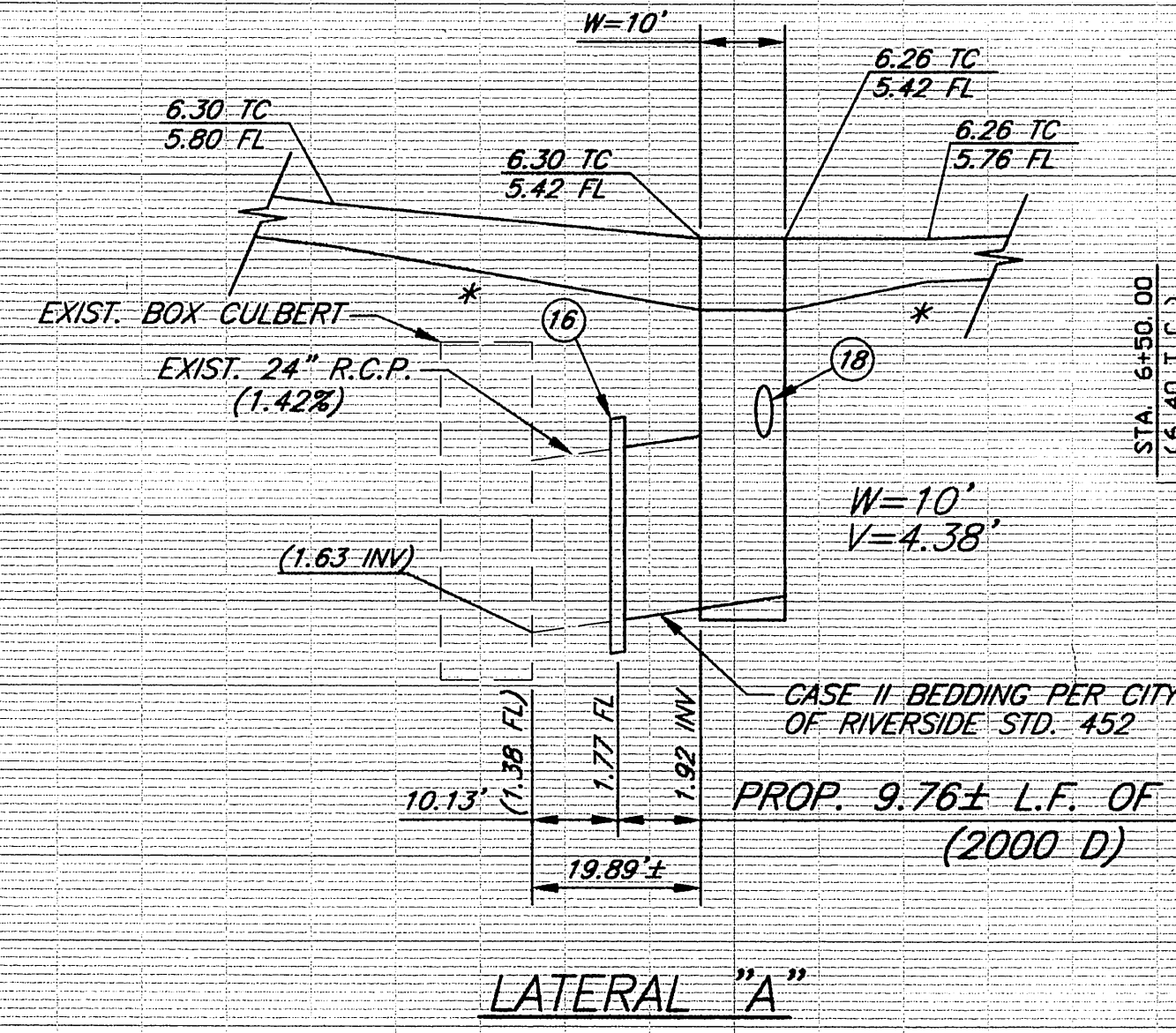

CAUTION: D.S. PROFILE SCALE:
 HORIZ: 1"=20'
 VERT: 1"=2'

C.L. 806

C.L. 806

CROSS SECTIONS N.T.S.

CURVE	CURB RETURN		CURB DATA	
	RADIUS	LENGTH	TANGENT	DELTA
(1)	35.00'	70.21'	54.88	114°56'27"

NOTE:
 * CONTRACTOR TO FIELD VERIFY EXISTING SEWER LATERAL & WATER SERVICE LOCATIONS & UTILIZE FOR THIS PROJECT (SIZE OF EXISTING TO BE VERIFIED WITH UTILITY DEPARTMENT(S))

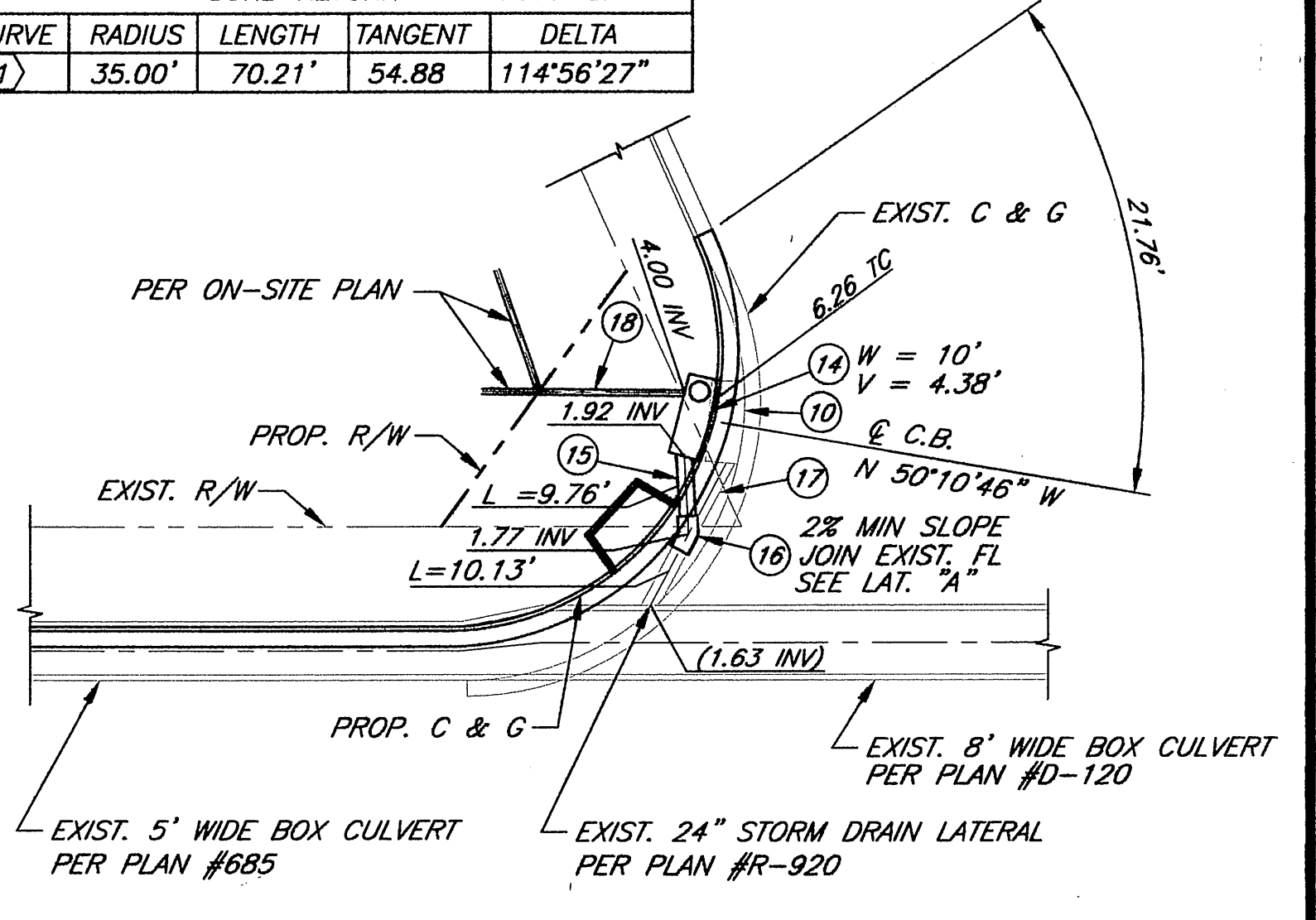
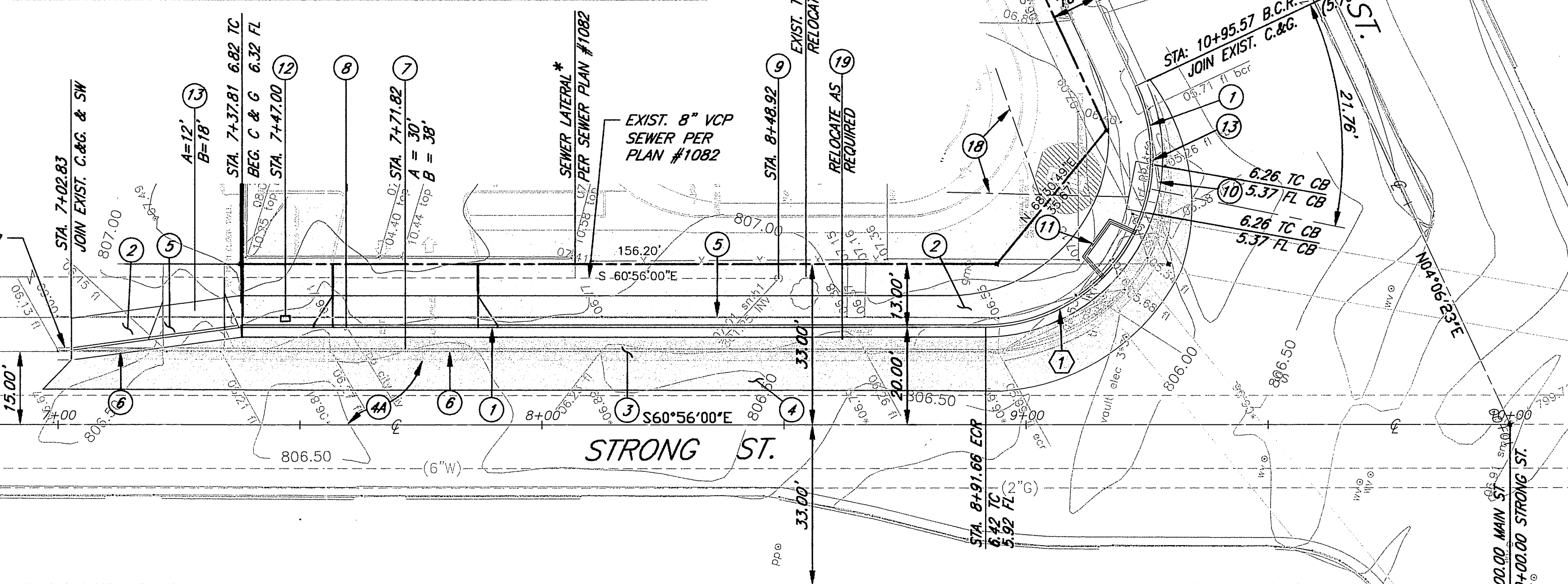

C.B. RELOCATION DETAIL N.T.S.

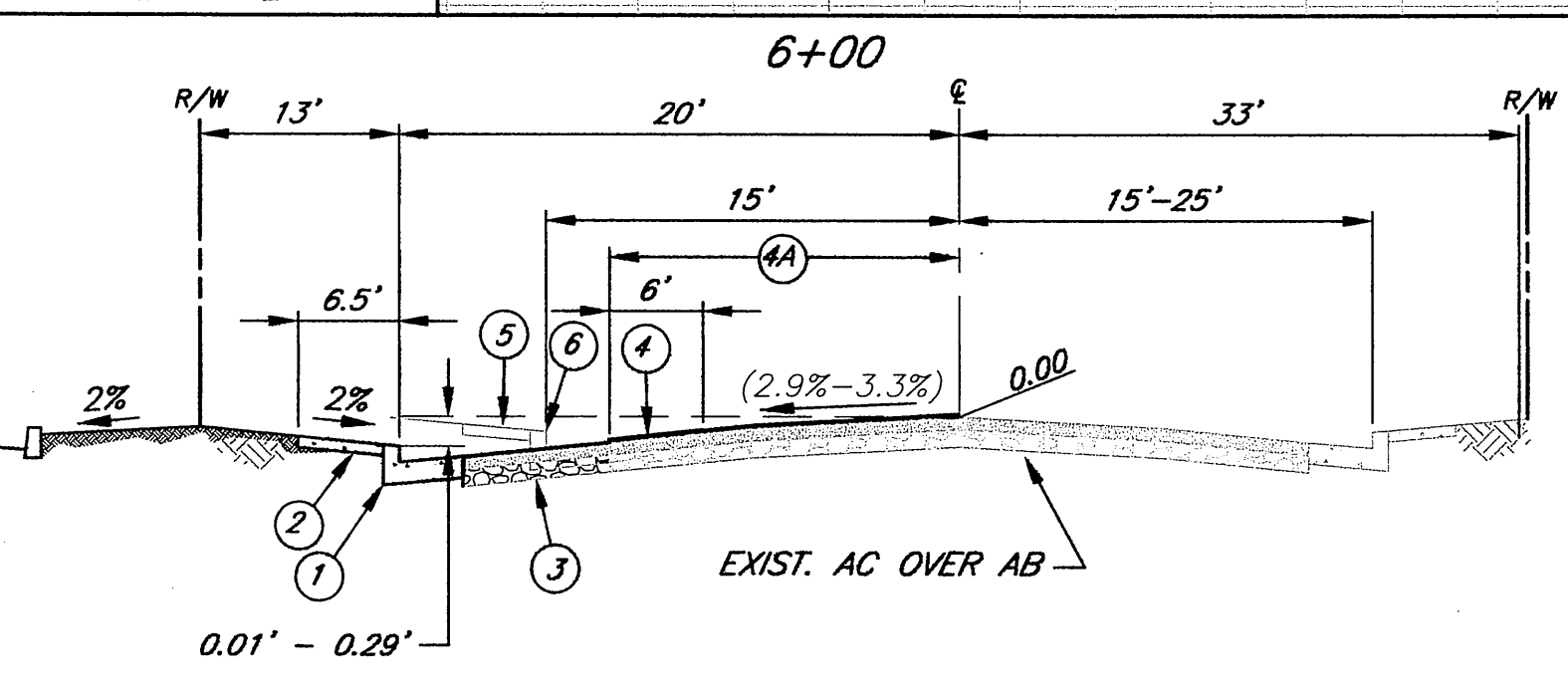

TYPICAL CROSS-SECTION STRONG STREET N.T.S. T.I. = 6

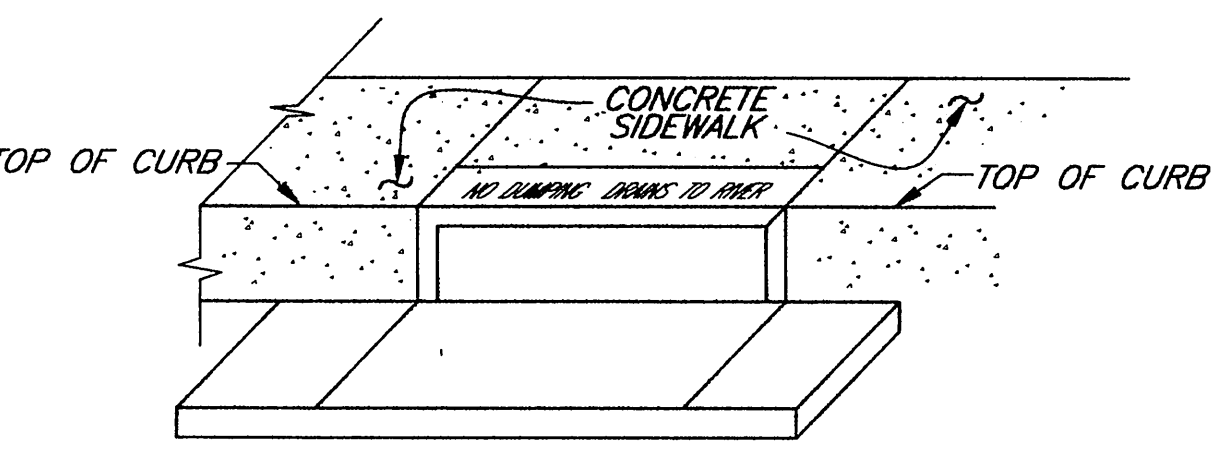

CATCH BASIN STENCILING DETAIL

1. STENCILS TO HAVE 2" LETTERS AS FOLLOWS: "NO DUMPING DRAINS TO RIVER"
2. PALCE BOTH STENCILS CENTERED WITHIN THE CATCHBASIN OPENING AND WITHIN THE TOP OF CURB
3. SPRAY BOTH STENCILS WITH WHITE PAINT
4. REMOVE STENCILS WHEN PAINT IS DRY

BENCHMARK

CITY OF RIVERSIDE B.M. NO. 17-62; A DIVISION OF HIGHWAYS BRASS DISK IN WELL AT THE CL INTERSECTION OF OAKLEY & MAIN ST. ELEV = 825.45

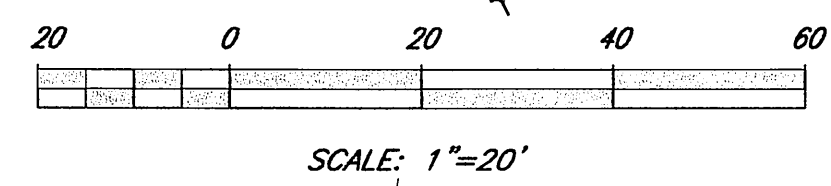
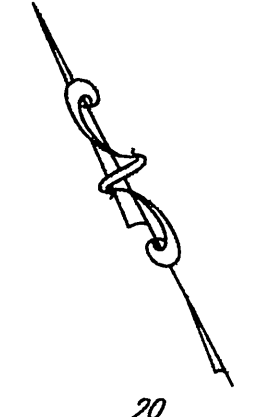

LEGEND

- A.C. OVER A.B.
- A.C. OVERLAY

CONSTRUCTION NOTES:

- 1) CONST. 6" CURB & GUTTER PER CITY OF RIVERSIDE STD. 200 (TYPE 1)
- 2) CONST. P.C.C. SIDEWALK PER CITY OF RIVERSIDE STD. 325
- 3) CONST. 4" A.C. OVER 6" C.B. PER S.R.L.S.P.S.; R-VALUE = 30
- 4) COLD PLANE EXIST. PAVEMENT 6' WIDE (DEPTH = 0.15')
- 4A) OVERLAY TO SMOOTH TRANSITION
- 5) SAWCUT & REMOVE EXISTING SIDEWALK
- 6) SAWCUT & REMOVE EXISTING CURB & GUTTER
- 7) CONST. DRIVEWAY APPROACH PER CITY OF RIVERSIDE STD. 302 (TYPE CURB-1)
- 8) REMOVE EXIST. PULL BOX
- 9) ADJUST EXIST. SEWER MH TO GRADE
- 10) REMOVE EXIST. CATCH BASIN
- 11) CONST. WHEELCHAIR RAMP PER CITY OF RIVERSIDE STD. 304 (TYPE 1)
- 12) INSTALL NEW PULLBOX
- 13) RECONSTRUCT EXIST. DRIVEWAY PER FIELD CONDITION & CITY INSPECTOR
- 14) CONST. CATCH BASIN PER CITY OF RIVERSIDE STD. 405
- 15) CONST. 24" RCP (2000 D)

- 16) CONST. 24" CONCRETE COLLAR PER CITY OF RIVERSIDE STD. 424
- 17) REMOVE INTERFERING PORTION OF EXIST. 24" RCP
- 18) CONST. 8" PVC DRAIN PIPE PER ON-SITE PLAN
- 19) RELOCATE NO PARKING (R26) SIGN



7-22-02
 R.C.E. No. DATE

SAKE CONSULTING ENGINEERS, INC.
 ENGINEERING • ARCHITECTURE • LAND DEVELOPMENT
 400 S. RAMONA AVE., STE. 202
 CORONA, CALIFORNIA 92789
 (909) 279-4041 FAX (909) 279-2830

CITY OF RIVERSIDE, WATER DIVISION
 APPROVED BY: *Ronald J. D... 7/23/02*
 VOID 1 YEAR AFTER DATE APPROVED

CITY OF RIVERSIDE
 PUBLIC UTILITIES DEPARTMENT - ELECTRIC
 OVERHEAD & UNDERGROUND
 APPROVED BY: *Scott M... 7/23/02*
 DATE

CITY OF RIVERSIDE, CALIFORNIA DEPARTMENT OF PUBLIC WORKS
 APPROVED BY: *[Signature]* DATE: *7/23/02*
 PRINCIPAL ENGINEER
 PARK DEPARTMENT
 TRAFFIC DIVISION
 DEPUTY P.W. DIRECTOR

STREET IMPROVEMENT PLAN
STRONG STREET
RZ-002-012, CU-002-012
(1691 MAIN STREET)
 PROJECT NO. Jn456
R-3659
 SHEET 2 OF 2
 HORIZ. SCALE: 1"=20' VERT. SCALE: NONE FILE NO.