

B.M. ELEV. 813.15 R.R. SPIKE IN POLE #2065-J
WEST SIDE OF OLIVEWOOD OPR HOUSE
NO. 4985
F.B. 664 I-13, 69-73
SCALE HOR. 1"=50'
VERT. 10'

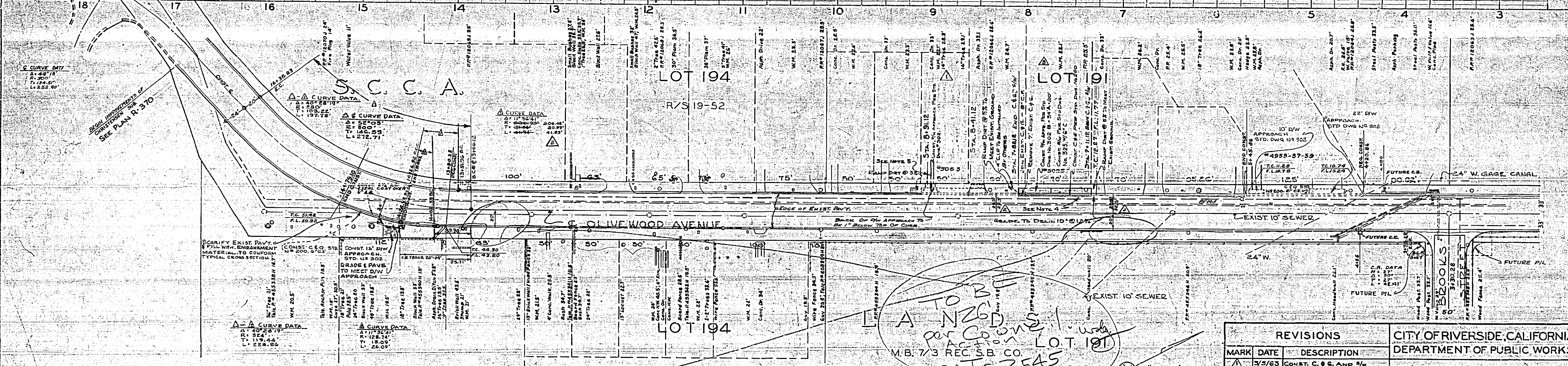

NOTES:
1. IT SHALL BE THE RESPONSIBILITY OF THE CONTRACTOR TO CLEAR THE RIGHT OF WAY IN ACCORDANCE WITH THE PROVISION OF LAW AS IT APPLIES TO EACH UTILITY, INCLUDING IRRIGATION LINES AND APPURTENANCES, AND AT NO COST TO THE CITY OF RIVERSIDE.
2. ALL CONSTRUCTION SHALL BE IN ACCORDANCE WITH STANDARDS AND SPECIFICATIONS OF THE CITY OF RIVERSIDE.
3. CURBS TO CURB WIDTH SHALL BE 18" FROM STA. 1366.12 TO BE WITH CITY FRONT TO 22' OF CURB TO CURB PLAN VIEW.
4. REMOVE EDGE OF EXIST. ASPHALT TO 18" FROM E. OF CURB TO 3" OF A.C. MATCH UP PAVEMENT, PRINT BINDER, FINE COAT & SEAL COAT.
5. EXIST. CONC. RW TO BE RAISED TO JOIN RW APPROACH AT P. A. DIRECTED BY OWNER.

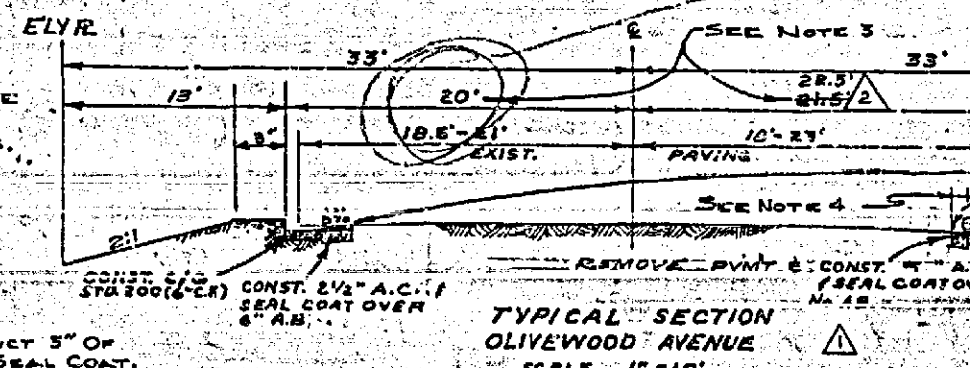

REVISIONS			CITY OF RIVERSIDE, CALIFORNIA DEPARTMENT OF PUBLIC WORKS	
MARK	DATE	DESCRIPTION		
1/2/63		CONST. C. & G. AND S/W	OLIVEWOOD AVENUE	
1/2/63		CONST. C. & G. AND S/W	BROOKS ST TO RAMONA DR	
1/2/63		CONST. C. & G. AND S/W		
1/2/63		CONST. C. & G. AND S/W		
DESIGNED BY	SUBMITTED BY	APPROVED BY	PROJ. NO. R-366	
DRAWN BY	PARK DEPT.	TRAFFIC DIV.	SHEET 1 OF 1	
CHECKED BY	RECOMMENDED BY	DATE		

PROFILE	EXISTING
NOTES	
DATE	
BY	

PLAN	EXISTING
NOTES	
DATE	
BY	