

# IN THE CITY OF RIVERSIDE, CALIFORNIA

# STREET IMPROVEMENT PLANS

## MAGNOLIA AVENUE

### GENERAL NOTES

- NO PERSON SHALL PERFORM ANY CONSTRUCTION ACTIVITY OR INSTALL ANY OBJECTS WITHIN THE PUBLIC RIGHTS-OF-WAY OR EASEMENTS OF THE CITY OF RIVERSIDE WITHOUT A VALID CONSTRUCTION PERMIT OR, A STREET OPENING PERMIT OR AN ENCROACHMENT PERMIT ISSUED BY THE CITY'S PUBLIC WORKS DEPARTMENT.
- IT SHALL BE THE RESPONSIBILITY OF THE CONTRACTOR TO CLEAR THE RIGHT-OF-WAY IN ACCORDANCE WITH THE PROVISIONS OF LAW AS IT AFFECTS EACH UTILITY INCLUDING IRRIGATION LINES AND APPURTENANCES AND AT NO COST TO THE CITY.
- CONSTRUCTION SHALL BE IN ACCORDANCE WITH THE CITY OF RIVERSIDE DEPARTMENT OF PUBLIC WORKS, STANDARD DRAWINGS, ITS SUPPLEMENTAL NOTES AND THE STANDARD SPECIFICATIONS FOR PUBLIC WORKS CONSTRUCTION, CURRENT EDITION.
- THE PRIVATE ENGINEER SIGNING THESE PLANS IS RESPONSIBLE FOR ASSURING THE ACCURACY AND ACCEPTABILITY OF THE WORK HEREON. IN THE EVENT OF DISCREPANCIES ARISING DURING CONSTRUCTION, THE PRIVATE ENGINEER SHALL BE RESPONSIBLE FOR DETERMINING AN ACCEPTABLE SOLUTION AND REVISING THE PLANS FOR APPROVAL BY THE CITY.
- THE DEVELOPER SHALL BE RESPONSIBLE FOR PRESERVING OR RE-ESTABLISHING AND REFERENCING SURVEY MONUMENTS DESTROYED, DISTURBED OR BURIED AS A RESULT OF CONSTRUCTION SHOWN HEREON.
- ALL FLAGGED ELEVATIONS SHALL BE STAKED IN THE FIELD BY THE PRIVATE ENGINEER.
- WHERE NEW PAVEMENT IS TO JOIN THE EXISTING PAVEMENT, THE EDGE OF THE EXISTING PAVEMENT SHALL BE TRIMMED IN A SMOOTH AND STRAIGHT LINE. CONSTRUCT MATCH-UP PAVING AS SHOWN ON THE PLANS AND OVERLAY PAVING AS DIRECTED IN THE FIELD TO PRODUCE A SMOOTH SECTION.
- ON ALL AREAS WITHIN PUBLIC RIGHT-OF-WAY WHERE THE FILL IS ONE (1) FOOT OR GREATER, A LETTER WILL BE REQUIRED FROM THE SOILS ENGINEER, CERTIFYING THE COMPACTION OF THE FILL BELOW SUBGRADE, PRIOR TO ISSUANCE OF THE CONSTRUCTION PERMIT/CUT SHEETS.
- ALL TRAFFIC SIGNS SHALL BE INSTALLED PRIOR TO OPENING THE STREETS TO TRAFFIC.
- ANY TRAFFIC CONTROL STRIPING OBLITERATED AND/OR BADLY WORN DURING CONSTRUCTION SHALL BE RESTORED BY THE CONTRACTOR WITHIN FIVE DAYS AFTER NOTIFICATION FROM THE CITY INSPECTORS.
- FINAL STRIPING FOR TRAFFIC CONTROL AND/OR PAVEMENT MARKING TO BE THE RESPONSIBILITY OF THE CONTRACTOR.
- THE CONTRACTOR SHALL CALL IN A LOCATION REQUEST TO UNDERGROUND SERVICE ALERT (USA), PHONE # 1-800-227-2600, TWO WORKING DAYS BEFORE DIGGING. NO CONSTRUCTION PERMIT WILL BE ISSUED BY THE PUBLIC WORKS DEPARTMENT INVOLVING EXCAVATION FOR UNDERGROUND FACILITIES UNLESS THE APPLICANT HAS BEEN PROVIDED AN INQUIRY IDENTIFICATION NUMBER BY U.S.A.
- QUANTITIES SHOWN ARE FOR INFORMATION ONLY AND THE CITY OF RIVERSIDE IS NOT RESPONSIBLE FOR THEIR ACCURACY.
- IN PAVEMENT OVERLAY AREAS, ANY DISTRESSED EXISTING PAVEMENT SHALL BE REMOVED AND REPLACED AS DIRECTED BY THE INSPECTOR PRIOR TO OVERLAYING WITH A.C. PAVING.
- SEE TRAFFIC SIGNAL PLAN X-357 PER TRAFFIC SIGNAL FACILITIES.

### LEGEND

CENTERLINE	-----
EDGE OF PAVEMENT	-----
PROPOSED A.C. PAVEMENT	-----
EXISTING PAVEMENT TO BE REMOVED	-----
CURB AND GUTTER	-----
EXISTING WATERLINE	-----W-----
EXISTING TELEPHONE	-----T-----
EXISTING SEWER	-----S-----
EXISTING CABLE TELEVISION	-----TV-----
EXISTING ELECTRICAL	-----E-----
EXISTING GAS	-----G-----
CALIFORNIA BAPTIST UNIVERSITY PROPERTY BOUNDARY	-----

### ABBREVIATIONS

GRADE BREAK	GB
TOP OF CURB ELEVATION	TC
FLOW LINE ELEVATION	FL
FINISHED SURFACE ELEVATION	FS
FINISHED GRADE ELEVATION	FG
EDGE OF PAVEMENT ELEVATION	EP

### WORK TO BE DONE

THESE IMPROVEMENTS CONSIST OF THE FOLLOWING WORK TO BE DONE ACCORDING TO THESE PLANS, THE CURRENT CITY OF RIVERSIDE STANDARDS AND SPECIFICATIONS, AND THE LATEST EDITION OF THE STANDARD SPECIFICATIONS FOR PUBLIC WORKS CONSTRUCTION ("GREEN BOOK").

### PRIVATE ENGINEER'S NOTE TO CONTRACTOR

ALL CONTRACTORS AND SUBCONTRACTORS PERFORMING WORK SHOWN ON OR RELATED TO THESE PLANS SHALL CONDUCT THEIR OPERATIONS SO THAT ALL EMPLOYEES ARE PROVIDED A SAFE PLACE TO WORK AND THE PUBLIC IS PROTECTED. ALL CONTRACTORS AND SUBCONTRACTORS SHALL COMPLY WITH THE OCCUPATIONAL SAFETY AND HEALTH REGULATIONS OF THE U.S. DEPARTMENT OF LABOR AND THE STATE OF CALIFORNIA DEPARTMENT OF INDUSTRIAL RELATIONS CONSTRUCTION SAFETY ORDERS. THE CIVIL ENGINEER SHALL NOT BE RESPONSIBLE IN ANY WAY FOR THE CONTRACTOR'S AND SUBCONTRACTOR'S COMPLIANCE WITH SAID REGULATIONS AND ORDERS.

CONTRACTOR FURTHER AGREES THAT HE SHALL ASSUME SOLE AND COMPLETE RESPONSIBILITY FOR JOB-SITE CONDITIONS DURING THE COURSE OF CONSTRUCTION OF THIS PROJECT, INCLUDING SAFETY OF ALL PERSONS AND PROPERTY, THAT THIS REQUIREMENT SHALL APPLY CONTINUOUSLY AND NOT BE LIMITED TO NORMAL WORKING HOURS; AND THAT THE CONTRACTOR SHALL DEFEND, INDEMNIFY AND HOLD THE OWNER AND CIVIL ENGINEER HARMLESS FROM ANY AND ALL LIABILITY, REAL OR ALLEGED, IN CONNECTION WITH THE PERFORMANCE OF WORK ON THIS PROJECT, EXCEPTION FOR LIABILITY ARISING FROM THE SOLE NEGLIGENCE OF THE OWNER OR ENGINEER.

THE EXISTENCE AND APPROXIMATE LOCATIONS OF ANY UNDERGROUND UTILITIES OR STRUCTURES SHOWN ON THESE PLANS ARE OBTAINED BY A SEARCH OF THE AVAILABLE RECORDS. THE CIVIL ENGINEER ASSUMES NO LIABILITY AS TO THE EXACT LOCATION OF SAID LINES NOR FOR UTILITY OR IRRIGATION LINES WHOSE LOCATIONS ARE NOT SHOWN. THE CONTRACTOR SHALL BE RESPONSIBLE FOR NOTIFYING ALL UTILITY AND IRRIGATION COMPANIES PRIOR TO WORK OR EXCAVATION TO DETERMINE THE EXACT LOCATIONS OF ALL LINES AFFECTING THIS WORK, WHETHER OR NOT SHOWN HEREON, AND FOR ANY DAMAGE OR PROTECTION TO THESE LINES.

### OWNER/DEVELOPER

CALIFORNIA BAPTIST UNIVERSITY  
8432 MAGNOLIA AVENUE  
RIVERSIDE, CA 92504  
ATTN: STEVE SMITH  
(909) 343-4393

### CIVIL ENGINEER

RICK ENGINEERING CO.  
1223 UNIVERSITY AVENUE, SUITE 240  
RIVERSIDE, CA 92507  
ATTN: MARTEN L. ANDERSON, RCE  
(909) 782-0707

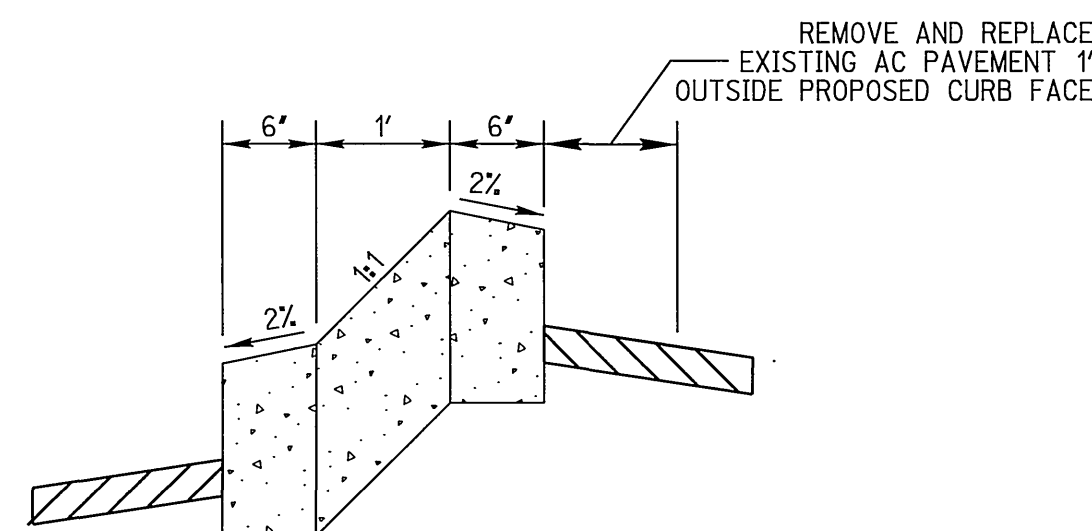
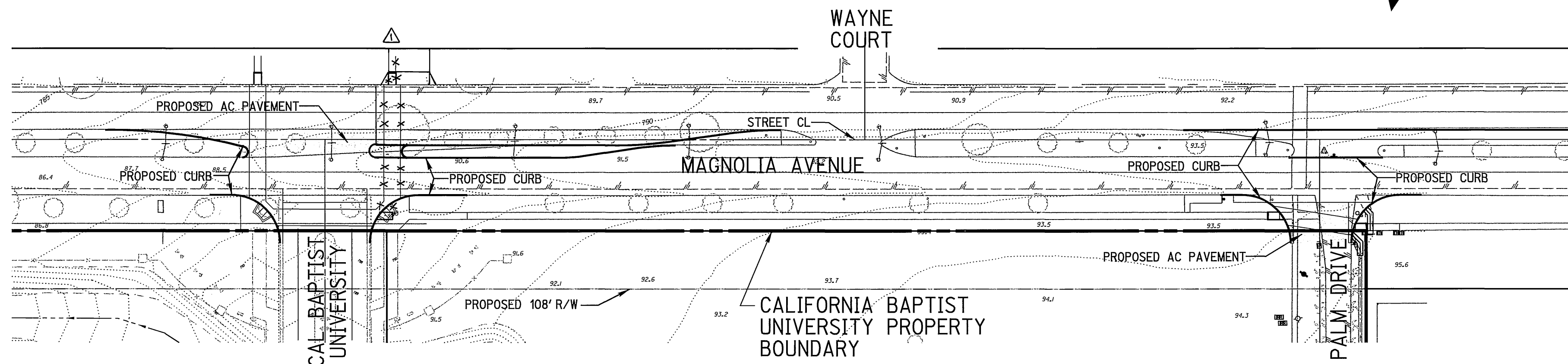

### INDEX MAP

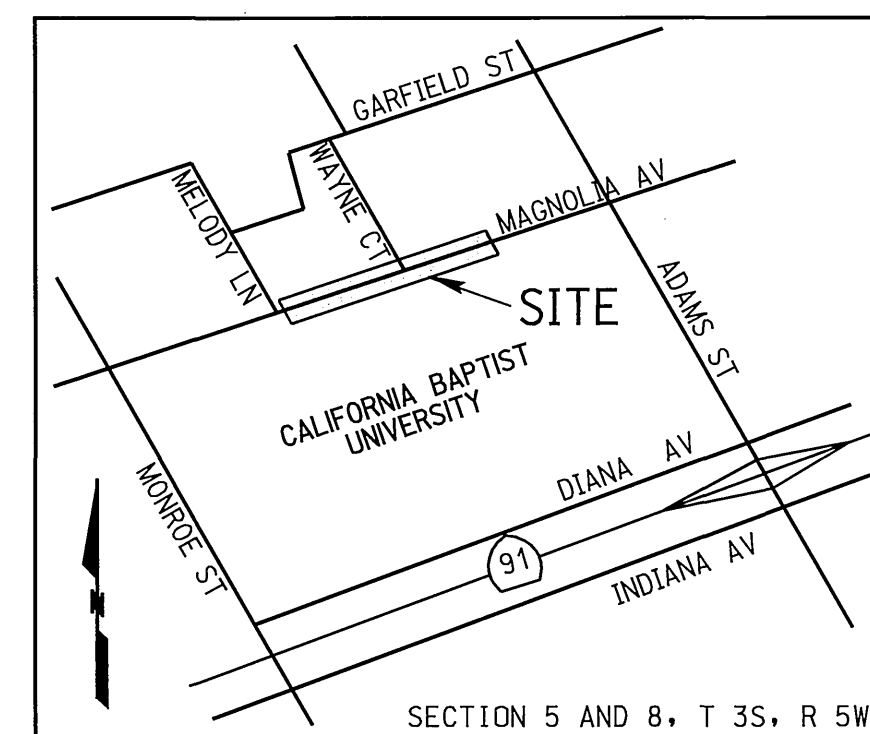
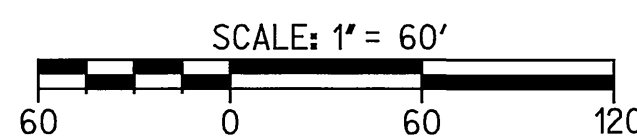

### VICINITY MAP

N.T.S.

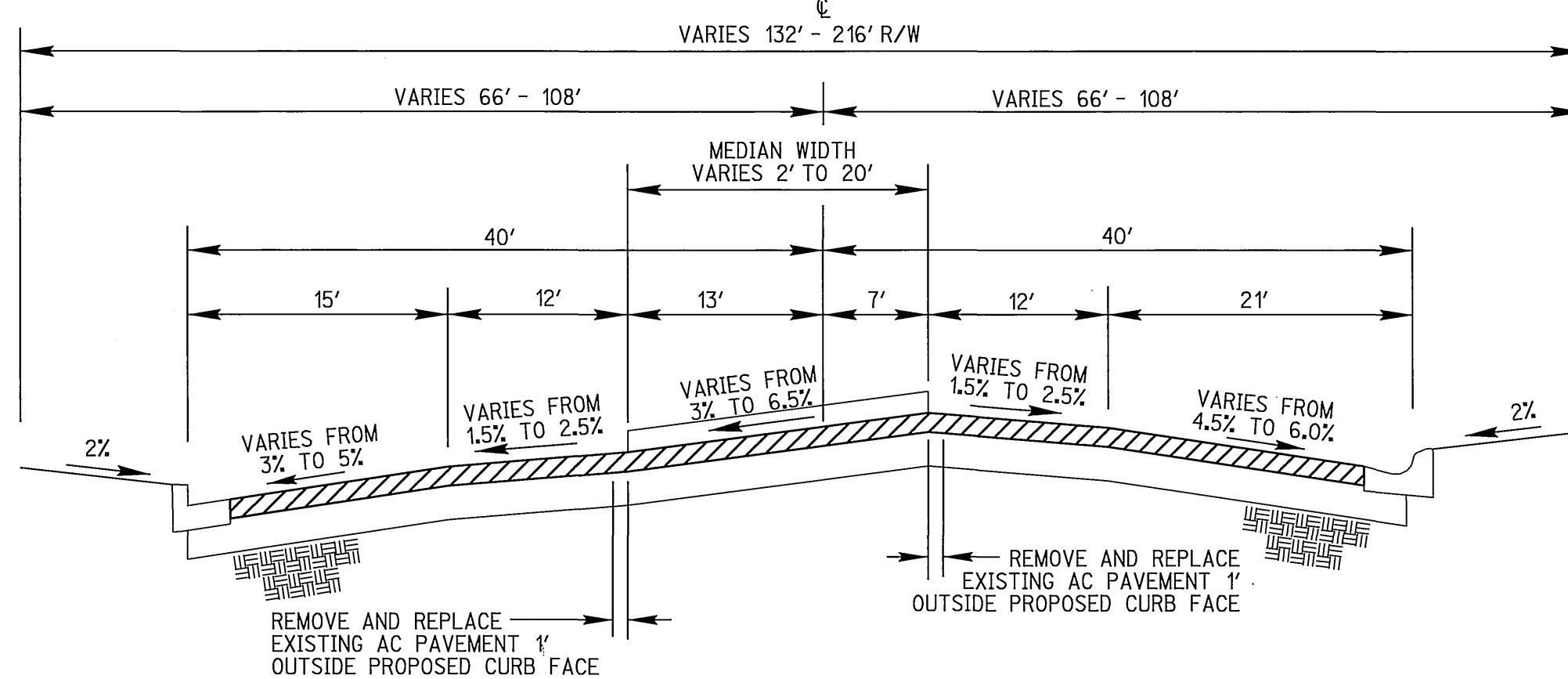

### TYPICAL SECTION MAGNOLIA AVENUE

T1=9.5  
21+00.00 TO 33+00.00  
N.T.S.

### CONSTRUCTION NOTES AND QUANTITY ESTIMATES

1	PLACE 4.5" AC PAVEMENT OVER 22" PER S.R. 1606	CLASS II AGGREGATE BASE	6,200 SF
2	CONSTRUCT 6" CURB AND GUTTER TYPE I PER CITY OF RIVERSIDE STD DWG NO 200		220 LF
3	CONSTRUCT 6" CURB TYPE II PER CITY OF RIVERSIDE STD DWG NO 200		280 LF
4	CONSTRUCT CURB TRANSITION PER CITY OF RIVERSIDE STD DWG NO 210, FROM EXISTING ROLL TYPE CURB AND GUTTER TO 6" TYPE I CURB AND GUTTER.		64 LF
5	CONSTRUCT CURB TRANSITION PER CITY OF RIVERSIDE STD DWG NO 210, FROM EXISTING ROLL TYPE CURB TO 6" TYPE II CURB		122 LF
6	CONSTRUCT WHEELCHAIR RAMP PER CITY OF RIVERSIDE STD DWG NO 304, TYPE I		1 EA
7	CONSTRUCT WHEELCHAIR RAMP PER CITY OF RIVERSIDE STD DWG NO 304, TYPE III (MODIFIED PER DETAIL ON SHEET 3)		1 EA
8	CONSTRUCT SIDEWALK PER CITY OF RIVERSIDE STD DWG NO 325		1,700 SF
9	CONSTRUCT CURB OUTLET PER CITY OF RIVERSIDE STD DWG NO 410		2 EA
10	SAWCUT AND REMOVE EXISTING AC PAVEMENT		6,300 SF
11	APPLY STOP PAVEMENT MARKINGS PER CALTRANS STD PLAN A24D		1 EA
12	APPLY 12" SOLID WHITE CROSSWALK/LIMIT LINES PER CALTRANS STD PLAN A24E		450 LF
13	APPLY 4" SOLID WHITE REFLECTIVE LANELINE PER CALTRANS STD PLAN A20A (DETAIL 12)		24 LF
14	APPLY 8" SOLID WHITE CHANNELIZING LINE PER CALTRANS STD PLAN A20D (DETAIL 38)		330 LF
15	APPLY TURN ARROW TYPE IV PER CALTRANS STD PLAN A24A		4 EA
16	REMOVE EXISTING POWERPOLE BY CITY FORCES		3 EA
17	CONSTRUCT CROSS GUTTER PER CITY OF RIVERSIDE STD DWG NO 220 (W PER PLAN)		3,010 SF
18	RELOCATE EXISTING STOP SIGN (CALTRANS R1) AND STREET NAME SIGN PER CITY OF RIVERSIDE STANDARD DWG NOS 662 AND 666		1 EA
19	INSTALL ONE WAY SIGN (CALTRANS R10 RT) PER CITY OF RIVERSIDE STANDARD DWG 666		1 EA
20	CONSTRUCT WHEELCHAIR RAMP PER CITY OF RIVERSIDE STD DWG NO 304, TYPE III (MODIFIED PER DETAIL ON SHEET 3)		3 EA
21	RELOCATE EXISTING BUS STOP SIGN AND BENCH PER RIVERSIDE TRANSIT AGENCY DESIGN GUIDELINES FOR BUS FACILITIES		1 EA
22	ADJUST SEWER MANHOLE TO GRADE		1 EA
23	ADJUST GAS VALVE COVER TO GRADE		1 EA

RIVERSIDE TRANSIT AGENCY (RTA)  
RELOCATION OF BUS STOP SIGN AND BENCH

APPROVED BY: *Anne Polster* 5-14-03 DATE

SOUTHERN CALIFORNIA GAS COMPANY  
ADJUST VALVE COVER TO GRADE

APPROVED BY: *Bob Dwyer* 5-7-03 DATE

CHARTER COMMUNICATIONS  
CABLE TELEVISION FOR NON-INTERFERENCE COMPLIANCE

APPROVED BY: *Carlo S. Caputo* 5/8/03 DATE

CITY OF RIVERSIDE  
PUBLIC UTILITIES DEPARTMENT-ELECTRIC OVERHEAD AND UNDERGROUND

APPROVED BY: *Michael R. Boyd* 5/14/03 DATE

\*AS-BUILT PER PLANS 9-28-05 4-H

### DIG ALERT



1-800-227-2600  
UNDERGROUND SERVICE ALERT  
Call at least 2 working days prior to excavating.

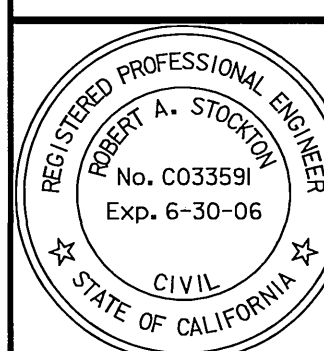

PREPARED UNDER THE DIRECTION OF  
ROBERT A. STOCKTON  
REGISTERED CIVIL ENGINEER NO. 33591  
EXPIRATION DATE 6-30-06



RICK ENGINEERING COMPANY  
San Diego Riverside Orange Phoenix Tucson  
1223 University Ave., Ste. 240 - Riverside, CA 92507-3418 - (909) 782-0707 - FAX (909) 782-0723 - www.rickeng.com  
CITY BUSINESS TAX CERTIFICATE NO. 35225 EXP. DATE 7/20/03

BENCH MARK:  
CITY OF RIVERSIDE BENCHMARK 05-A2, ELEVATION=797.89'. BRASS DISK STAMPED "05-A" IN A MONUMENT WELL AT THE INTERSECTION OF ADAMS STREET AND MAGNOLIA AVENUE.

DESIGNED BY: KMB	DRAWN BY: SS	CHECKED BY: M.L.A.
REVISIONS	APPR	DATE
MARK		

### CITY OF RIVERSIDE PUBLIC WORKS DEPARTMENT

APPROVED BY: *Michael R. Boyd* DATE: 6/3/03  
CITY ENGINEER

STREET IMPROVEMENT PLANS  
8432 MAGNOLIA AVENUE  
CU-027-667  
TITLE SHEET

PROJECT NO. R-3693  
SHEET 1 OF 3

HORIZ. SCALE: SEE ABOVE VERT. SCALE: N/A FILE NO. INDEXED 6-30-03 PLT-DATE: 07-MAY-2003 IN 14077



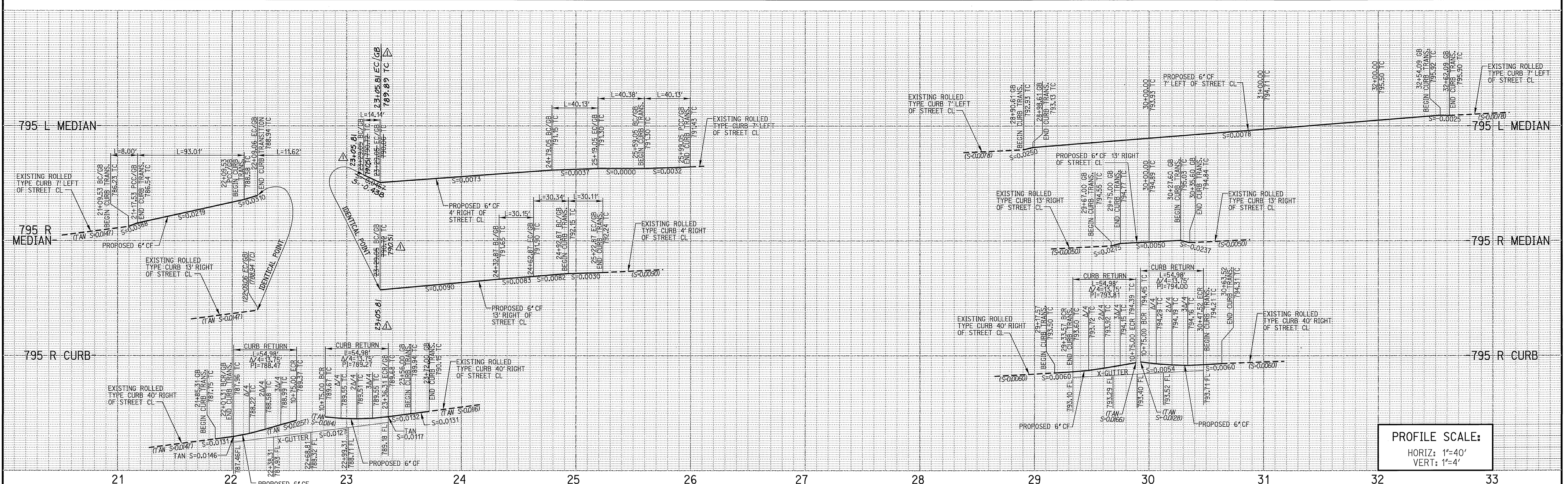

PROFILE SCALE:  
 HORIZ: 1"=40'  
 VERT: 1"=4'

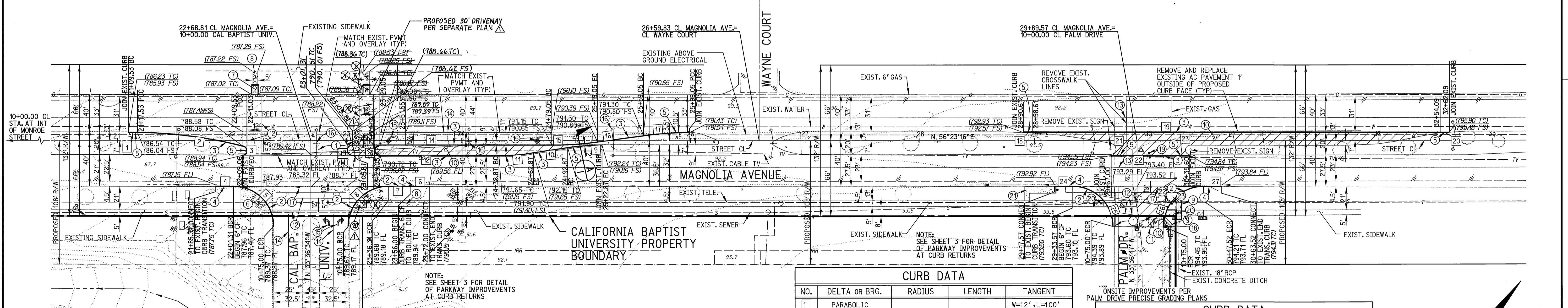

- CONSTRUCTION NOTES**
- PLACE 4.5" AC PAVEMENT OVER 22" CLASS II AGGREGATE BASE PER S.R.-1606, R-VALUE=12
  - CONSTRUCT 6" CURB AND GUTTER TYPE I PER CITY OF RIVERSIDE STD DWG NO 200
  - CONSTRUCT 6" CURB TYPE II PER CITY OF RIVERSIDE STD DWG NO 200
  - CONSTRUCT CURB TRANSITION PER CITY OF RIVERSIDE STD DWG NO 210, FROM EXISTING ROLL TYPE CURB AND GUTTER TO 6" TYPE I CURB AND GUTTER.
  - CONSTRUCT CURB TRANSITION PER CITY OF RIVERSIDE STD DWG NO 210, FROM EXISTING ROLL TYPE CURB TO 6" TYPE II CURB
  - CONSTRUCT WHEELCHAIR RAMP PER CITY OF RIVERSIDE STD DWG NO 304, TYPE I
  - CONSTRUCT WHEELCHAIR RAMP PER CITY OF RIVERSIDE STD DWG NO 304, TYPE III (MODIFIED PER DETAIL ON SHEET 3)
  - CONSTRUCT SIDEWALK PER CITY OF RIVERSIDE STD DWG NO 325. (SEE PARKWAY DETAIL ON SHEET 3 FOR DETAIL OF CONNECTION TO EXISTING SIDEWALK)
  - CONSTRUCT CURB OUTLET PER CITY OF RIVERSIDE STD DWG NO 410. (SEE PARKWAY DETAIL ON SHEET 3 FOR DETAIL OF CONNECTION TO EXISTING STRUCTURE)
  - SAWCUT AND REMOVE EXISTING AC PAVEMENT.
  - APPLY STOP PAVEMENT MARKINGS PER CALTRANS STD PLAN A240.
  - APPLY 12" SOLID WHITE CROSSWALK/LIMIT LINES PER CALTRANS STD PLAN A24E.
  - APPLY 4" SOLID WHITE REFLECTIVE LABELINE PER CALTRANS STD PLAN A20A (DETAIL 12)
  - APPLY 8" SOLID WHITE CHANNELIZING LINE PER CALTRANS STD PLAN A20D (DETAIL 38)
  - APPLY TURN ARROW TYPE IV PER CALTRANS STD PLAN A24A.
  - REMOVE EXISTING POWERPOLE BY CITY FORCES.
  - CONSTRUCT CROSS GUTTER PER CITY OF RIVERSIDE STD DWG NO 220 (W PER PLAN)
  - RELOCATE EXISTING STOP SIGN (CALTRANS R1) AND STREET NAME SIGN PER CITY OF RIVERSIDE STANDARD DWG NOS 662 AND 666
  - INSTALL ONE WAY SIGN (CALTRANS R10 RT) PER CITY OF RIVERSIDE STANDARD DWG 666
  - CONSTRUCT WHEELCHAIR RAMP PER CITY OF RIVERSIDE STD DWG NO 304, TYPE III (MODIFIED PER DETAIL ON SHEET 3)
  - RELOCATE EXISTING BUS STOP SIGN AND BENCH PER RIVERSIDE TRANSIT AGENCY DESIGN GUIDELINES FOR BUS FACILITIES (SEE PARKWAY DETAIL ON SHEET 3)
  - ADJUST SEWER MANHOLE TO GRADE
  - ADJUST GAS VALVE COVER TO GRADE

NOTE: SEE SHEET 3 FOR DETAIL OF PARKWAY IMPROVEMENTS AT CURB RETURNS

**CURB DATA**

NO.	DELTA OR BRG.	RADIUS	LENGTH	TANGENT
1	PARABOLIC			W=12', L=100'
2	PARABOLIC			W=12', L=100'
3	166°30'13"	4.00'	11.62'	33.81'
4	N 56°23'16" E		16.00'	
5	89°59'50"	35.00'	54.98'	35.00'
6	N 56°23'16" E		16.00'	
7	N 56°23'16" E		19.66'	
8	89°59'50"	35.00'	54.98'	35.00'
9	PARABOLIC			W=9', L=90'
10	N 47°51'25" E		30.34'	
11	PARABOLIC			W=9', L=90'
12	N 56°23'16" E		14.14'	103-82+127.06
13	180°00'02"	4.50'	14.14'	1.00'
14	N 56°23'16" E		14.14'	+50-00+173.24
15	PARABOLIC			W=11', L=120'

**CURB DATA**

NO.	DELTA OR BRG.	RADIUS	LENGTH	TANGENT
16	N 48°33'31" E		40.38'	
17	PARABOLIC			L=11', W=120'
18	N 56°23'15" E		8.00'	
19	N 56°23'16" E		355.48'	
20	N 56°23'15" E		8.00'	
21	N 56°23'15" E		8.00'	
22	N 56°23'16" E		52.60'	
23	N 56°23'15" E		8.00'	
24	N 56°23'15" E		16.00'	
25	89°59'57"	35.00'	54.98'	35.00'
26	89°59'57"	35.00'	54.98'	35.00'
27	N 56°23'16" E		16.00'	

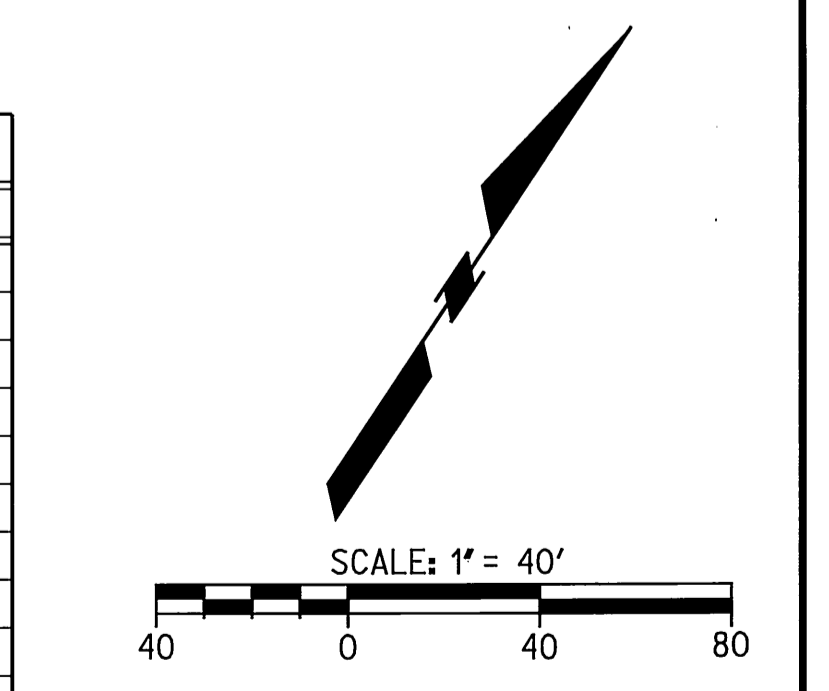

**DIG ALERT**

CALL BEFORE YOU DIG!

1-800-227-2600

UNDERGROUND SERVICE ALERT

Call at least 2 working days prior to excavating.

REGISTERED PROFESSIONAL ENGINEER

ROBERT A. STOCKTON

NO. C03359

EXP. 6-30-06

STATE OF CALIFORNIA

PREPARED UNDER THE DIRECTION OF

**RICK ENGINEERING COMPANY**

San Diego Riverside Orange Phoenix Tucson

1223 University Ave., Ste. 240 - Riverside, CA 92507-9418 - (909)782-0707 - FAX (909)782-0723 - www.rickeng.com

CITY BUSINESS TAX CERTIFICATE NO. 35225 EXP. DATE 7/20/03

BENCH MARK: CITY OF RIVERSIDE BENCHMARK G5-A2, ELEVATION=797.89', BRASS DISK STAMPED "G5-A" IN A MONUMENT WELL AT THE INTERSECTION OF AIMS STREET AND MAGNOLIA AVENUE.

REV. MEDIAN AND REMOVED CROSSWALK

KVZ 16-14

DESIGNED BY: KMB DRAWN BY: SS CHECKED BY: M.L.A.

**CITY OF RIVERSIDE**

PUBLIC WORKS DEPARTMENT

APPROVED BY: *Jim Boyd*

DATE: 6/30/03

**STREET IMPROVEMENT PLANS**

8432 MAGNOLIA AVENUE

CU-027-667

STA. 21+09.53 TO 32+62.09

PROJECT NO. R-3693

SHEET 2 OF 3

FILE NO.

HORIZ. SCALE: 1"=40' VERT. SCALE: 1"=4'

INDEXED 6-30-03 L/H

PLANT DATE: 14-MAY-2003

JN 14077



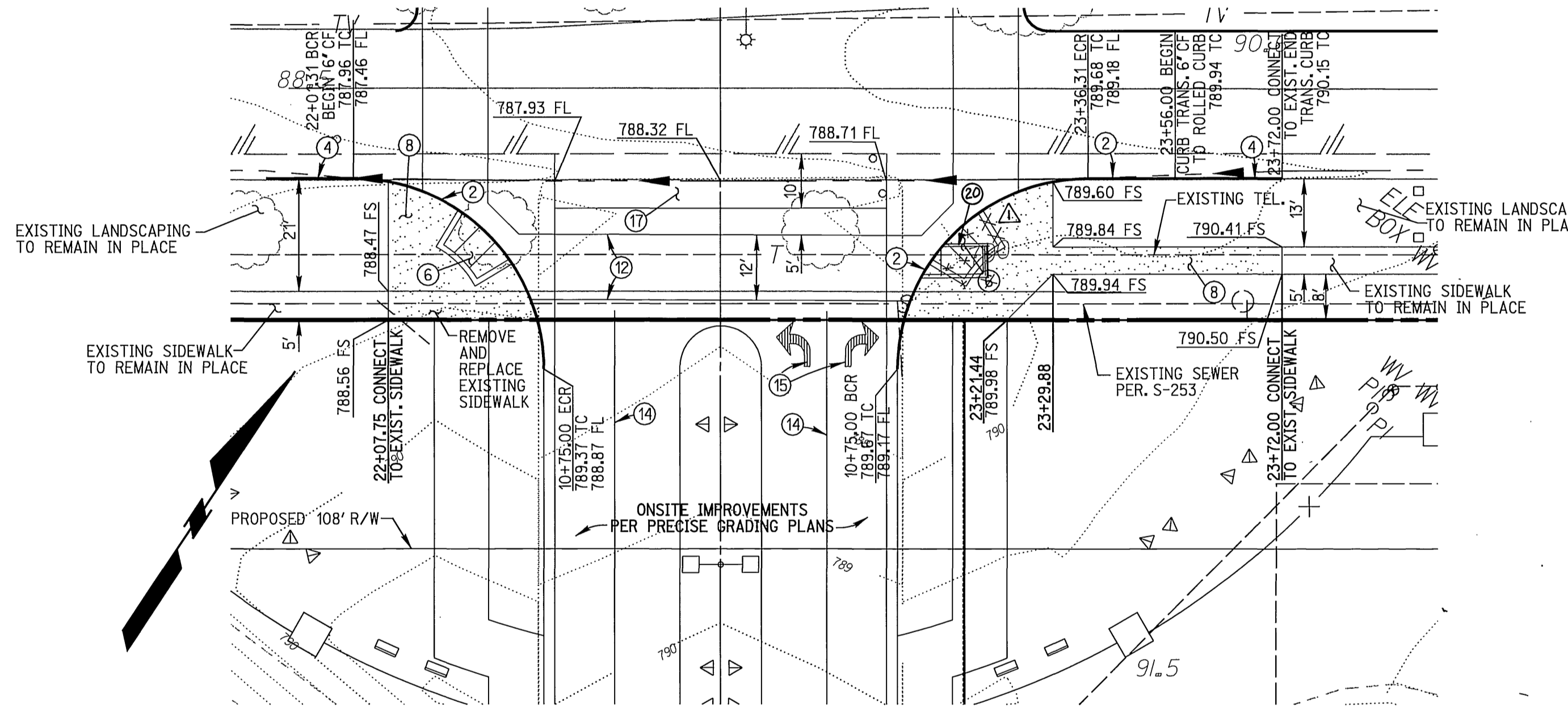
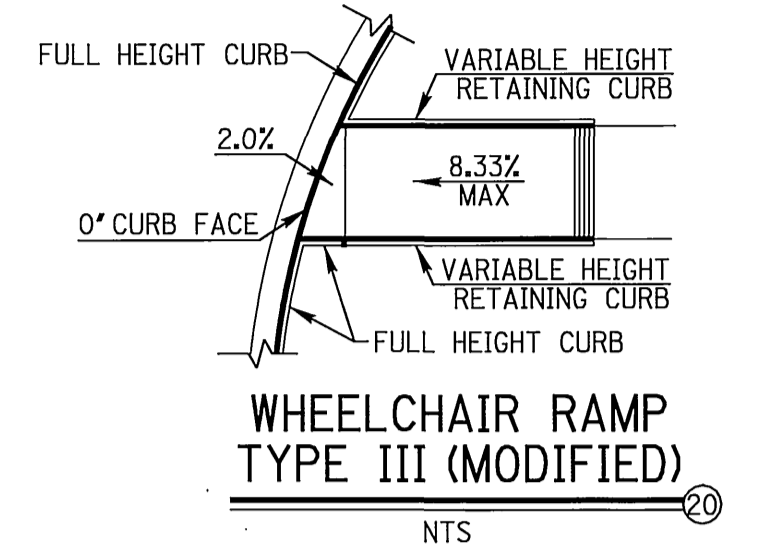
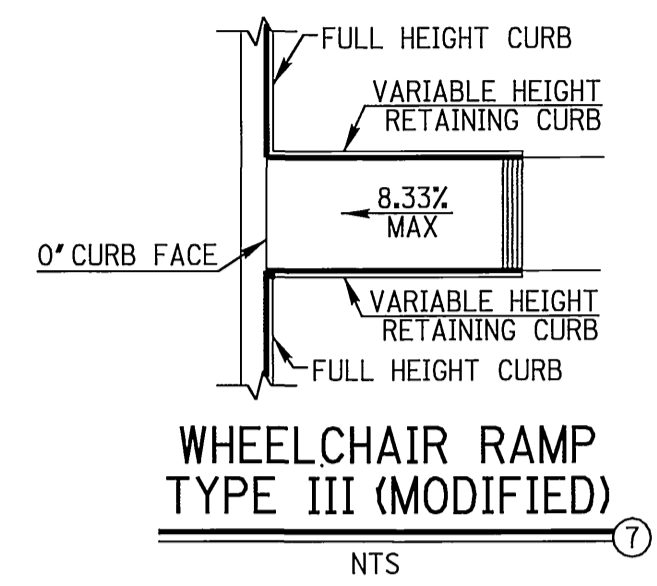

DETAIL OF PARKWAY AT  
CALIFORNIA BAPTIST UNIVERSITY ENTRY ROAD  
1"=20'

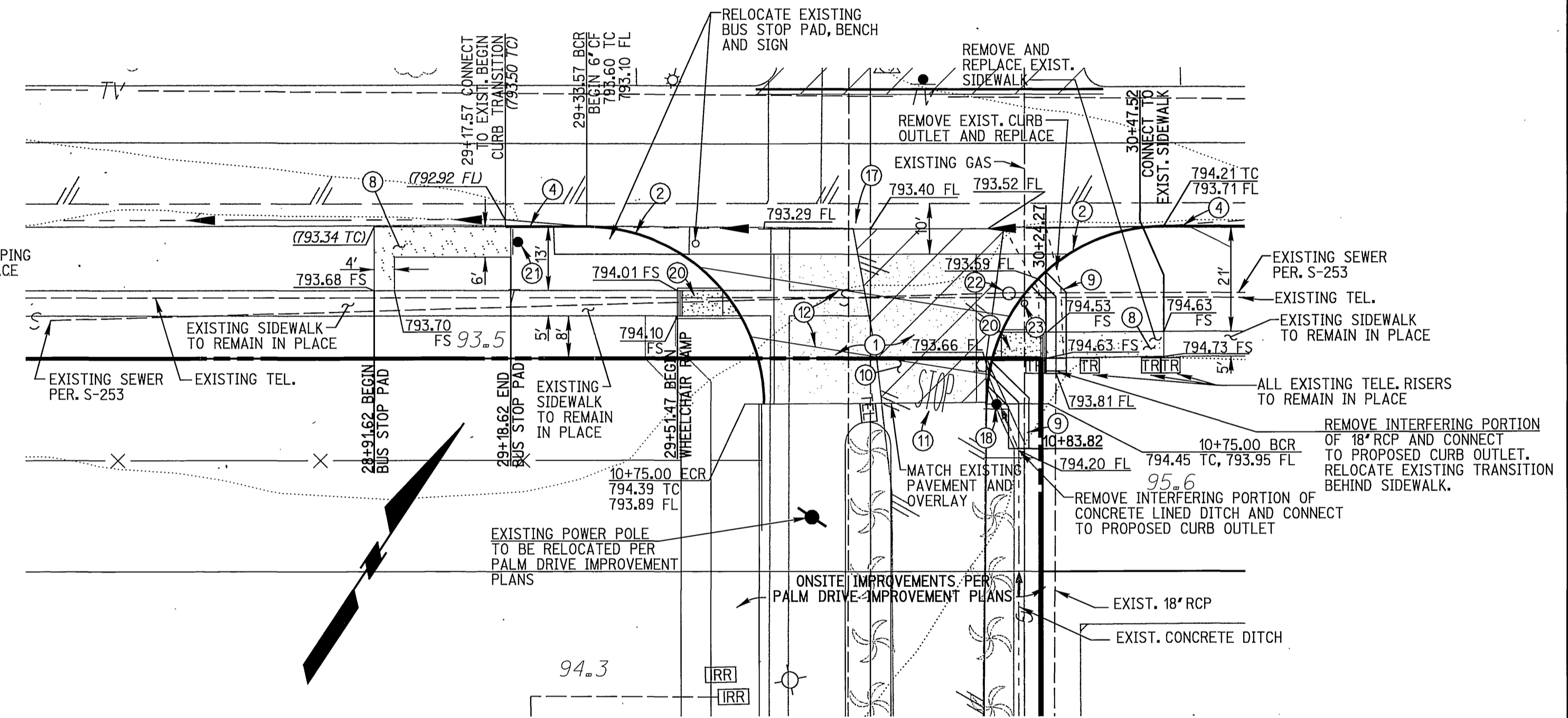

DETAIL OF PARKWAY AT PALM DRIVE  
1"=20'

CONSTRUCTION NOTES

- ① PLACE 4.5" AC PAVEMENT OVER 22" CLASS II AGGREGATE BASE PER S.R. 1608, R-VALUE=12"
- ② CONSTRUCT 6" CURB AND GUTTER TYPE I PER CITY OF RIVERSIDE STD DWG NO 200
- ④ CONSTRUCT CURB TRANSITION PER CITY OF RIVERSIDE STD DWG NO 210, FROM EXISTING ROLL TYPE CURB AND GUTTER TO 6" TYPE I CURB AND GUTTER.
- ⑥ CONSTRUCT WHEELCHAIR RAMP PER CITY OF RIVERSIDE STD DWG NO 304, TYPE I
- ⑧ CONSTRUCT SIDEWALK PER CITY OF RIVERSIDE STD DWG NO 325
- ⑨ CONSTRUCT CURB OUTLET PER CITY OF RIVERSIDE STD DWG NO 410.
- ⑩ SAWCUT AND REMOVE EXISTING AC PAVEMENT.
- ⑪ APPLY STOP PAVEMENT MARKINGS PER CALTRANS STD PLAN A24D.
- ⑫ APPLY 12" SOLID WHITE CROSSWALK/LIMIT LINES PER CALTRANS STD PLAN A24E.
- ⑭ APPLY 8" SOLID WHITE CHANNELIZING LINE PER CALTRANS STD PLAN A20D (DETAIL 38)
- ⑮ APPLY TURN ARROW TYPE IV PER CALTRANS STD PLAN A24A.
- ⑯ CONSTRUCT CROSS GUTTER PER CITY OF RIVERSIDE STD DWG NO 220 (W PER PLAN)
- ⑰ RELOCATE EXISTING STOP SIGN (CALTRANS R1) AND STREET NAME SIGN PER CITY OF RIVERSIDE STANDARD DWG NOS 662 AND 666
- ⑳ CONSTRUCT WHEELCHAIR RAMP PER CITY OF RIVERSIDE STD DWG NO 304, TYPE III (MODIFIED PER DETAIL THIS SHEET)
- ㉑ RELOCATE EXISTING BUS STOP SIGN AND BENCH PER RIVERSIDE TRANSIT AGENCY DESIGN GUIDELINES FOR BUS FACILITIES
- ㉒ ADJUST SEWER MANHOLE TO GRADE
- ㉓ ADJUST GAS VALVE COVER TO GRADE

**DIG ALERT**

CALL BEFORE YOU DIG!

1-800-227-2600  
UNDERGROUND SERVICE ALERT  
Call at least 2 working days prior to excavating.

REGISTERED PROFESSIONAL ENGINEER  
ROBERT A. STOCKTON  
No. C033591  
Exp. 6-30-06  
STATE OF CALIFORNIA

PREPARED UNDER THE DIRECTION OF  
ROBERT A. STOCKTON  
REGISTERED CIVIL ENGINEER NO. 33591  
EXPIRATION DATE 6-30-06

**RICK ENGINEERING COMPANY**

San Diego Riverside Orange Phoenix Tucson  
1223 University Ave., Ste. 240 • Riverside, CA 92507-3418 • (909)782-0707 • FAX (909)782-0723 • www.rickeng.com  
CITY BUSINESS TAX CERTIFICATE NO. 35225 EXP. DATE 1/20/03

BENCH MARK:  
CITY OF RIVERSIDE BENCHMARK G5-A2, ELEVATION=797.89', BRASS DISK STAMPED "G5-A" IN A MONUMENT WELL AT THE INTERSECTION OF ADAMS STREET AND MAGNOLIA AVENUE.

MARK	REVISIONS	APPR	DATE
Δ	REVISED ACCESS RAMP	KVZ	10-14

DESIGNED BY: KMB    DRAWN BY: SS    CHECKED BY: MJA

**CITY OF RIVERSIDE**  
PUBLIC WORKS DEPARTMENT

APPROVED BY: [Signature]  
PRINCIPAL ENGINEER  
TRAFFIC DIVISION

APPROVED BY: [Signature]  
CITY ENGINEER

DATE: 6/13/05

\*AS-BUILT PER PLANS 9-28-05 LFH

STREET IMPROVEMENT PLANS  
8432 MAGNOLIA AVENUE  
CU-027-667  
DETAIL SHEET

PROJECT NO. R-3693  
SHEET 3 OF 3

SEE HORIZ. SCALE: ABOVE    VERT. SCALE: N/A