

# RIVERSIDE CITY OF RIVERSIDE CALIFORNIA

## PUBLIC WORKS DEPARTMENT PHOENIX AVENUE SIDEWALK (CDBG 2002-2003)

### GENERAL CONSTRUCTION NOTES

- EXISTING UTILITIES, SHOWN ON THIS PLAN, ARE PLOTTED FROM UTILITY RECORDS. THE CONTRACTOR IS REQUIRED TO TAKE DUE PRECAUTIONARY MEASURES TO LOCATE AND PROTECT ALL UTILITIES WHETHER OR NOT SHOWN ON THIS PLAN. THE UTILITY IS NOT EXPECTED TO CONFLICT WITH THE PROPOSED IMPROVEMENTS.
- PRIME CONTRACTORS BIDDING THIS WORK SHALL HAVE A CLASS A OR C-B LICENSE.
- CONFLICTING UTILITIES, IF ANY, WITHIN CONSTRUCTION AREA, SHALL BE RELOCATED PRIOR TO CONSTRUCTION.
- TREES AND SHRUBS, AFFECTED BY THE PROPOSED SIDEWALK CONSTRUCTION, SHALL BE TRIMMED TO AT LEAST 8" VERTICALLY ABOVE THE SIDEWALK SURFACE AND TO AT LEAST 3' LATERALLY OF THE SIDEWALK, WHERE RIGHT-OF-WAY PERMITS.
- MAIL BOXES, INTERFERING WITH PROPOSED SIDEWALK CONSTRUCTION, SHALL BE TEMPORARILY RELOCATED TO ENABLE PROPERTY OWNERS TO RECEIVE THEIR MAIL AND BE REINSTALLED IN FINAL POSITION BY THE CONTRACTOR.
- WATER METERS, GAS METERS AND ALL STREET PULL BOXES AFFECTED BY CONSTRUCTION, SHALL BE ADJUSTED TO THE PROPOSED SIDEWALK GRADE.
- EXISTING SPRINKLERS AND IRRIGATION LINES, AFFECTED BY THE CONSTRUCTION OF THE PROPOSED SIDEWALK, SHALL BE RELOCATED TO THE BACK OF THE SIDEWALK OR MODIFIED TO COVER EXISTING IRRIGATION AREA EXCEPT THE NEW PAVED AREA.
- PROPOSED PCC SIDEWALK SHALL BE CONSTRUCTED AT EXISTING DRIVEWAYS PER THE DETAIL SHOWN ON THIS PLAN.

### SPECIFIC CONSTRUCTION NOTES

- NUMBERS, ABOVE 100 IN A HEXAGON ON THE PLAN, REFER TO THE RESPECTIVE STANDARD DRAWING AND SHALL BE CONSTRUCTED ACCORDINGLY, UNLESS MODIFICATIONS ARE NOTED ON THE PLAN OR COVER SHEET. ANY NUMBER SHOWN BELOW THE STANDARD DRAWING NUMBER INDICATES THE SPECIFIC ALTERNATE TO BE CONSTRUCTED.
- RR F** REMOVE AND REPLACE EXISTING WOOD FENCE (H=6') IN KIND AT THE R/W LINE.
- REL F** RELOCATE EXISTING WOOD POST FENCE (H=3') AT R/W LINE AND USE NEW WOOD POST AND MATERIAL WHERE NECESSARY.
- 304 I** CONSTRUCT WHEELCHAIR RAMP PER STD. DWG. 304 TYPE I
- ADJ** ADJUST EXISTING SEWER MANHOLES AND WATER METERS TO GRADE OF NEW SIDEWALK.

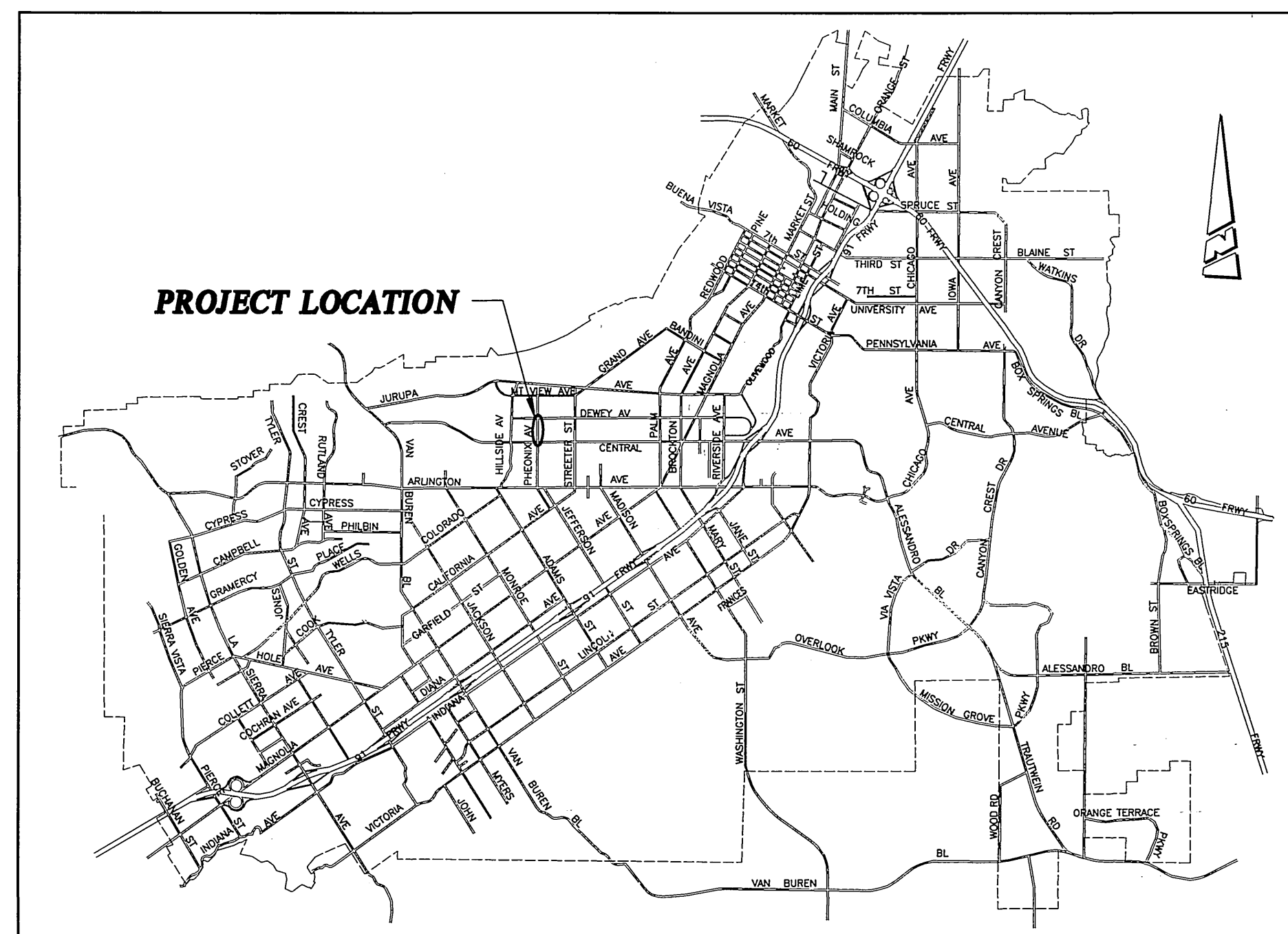

### PROJECT LOCATION MAP

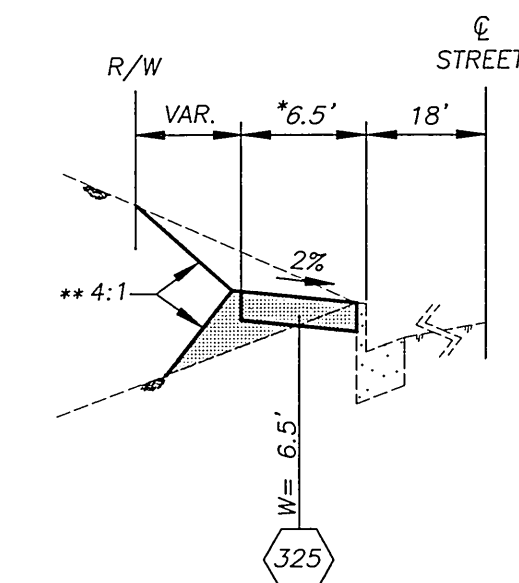
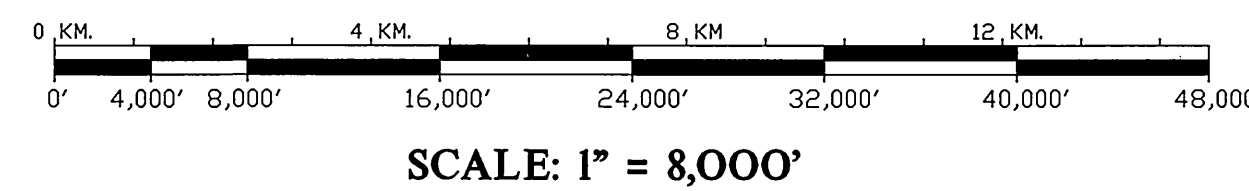

TYPICAL SECTION OF CURB LINE SIDEWALK (NTS)

- SIDEWALK WIDTH SHALL BE ADJUSTED TO PROVIDE A MIN. 4' CLEAR PATHWAY AT ANY OBSTRUCTION.
- SLOPE BEHIND SIDEWALK SHOWN ON THIS PLAN SUPERSEDES SLOPE SHOWN ON STANDARD DRAWING 325.

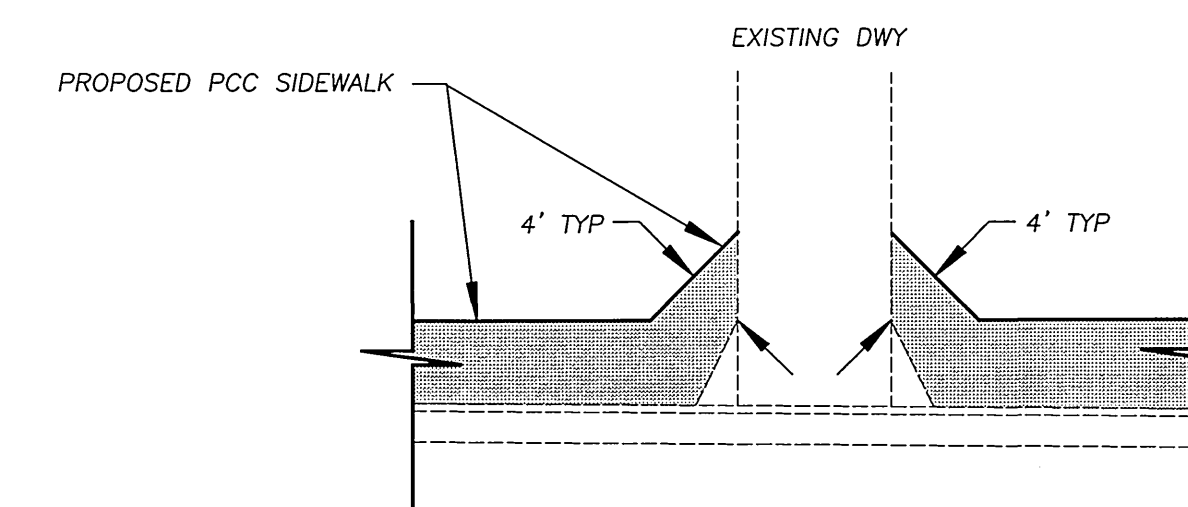

PROPOSED PCC SIDEWALK AT EXISTING DRIVEWAYS (NTS)

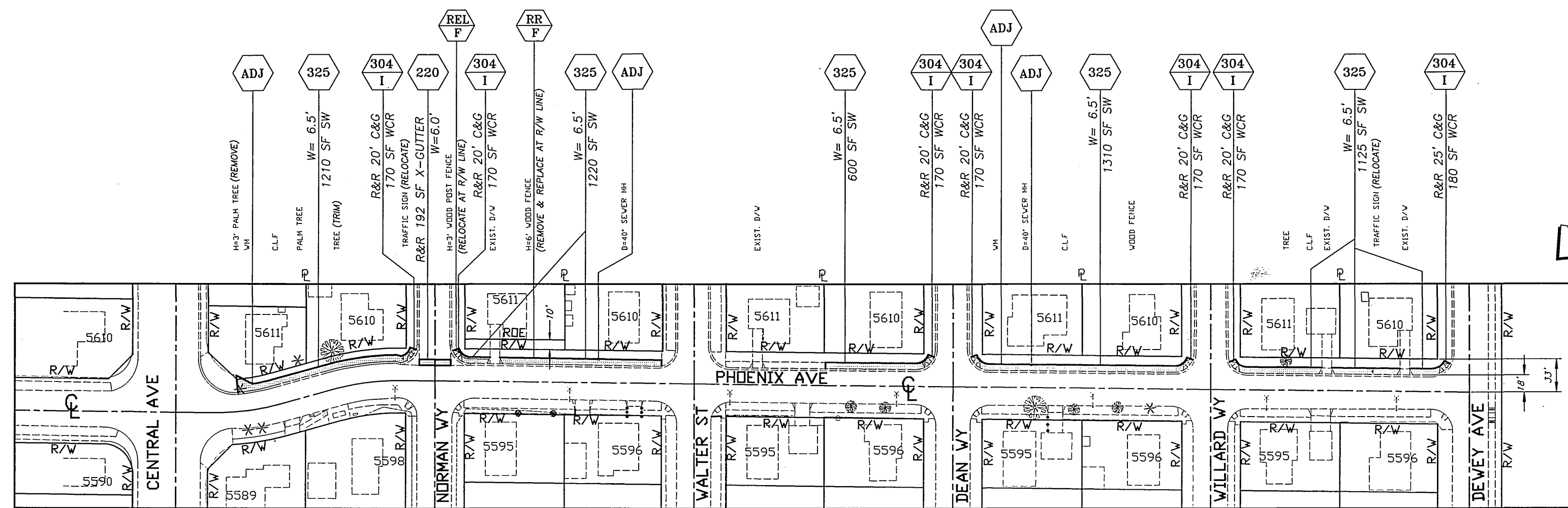

PHOENIX AVE. - CENTRAL AVE. TO DEWEY AVE.

\* AS-BUILT PER PLANS 2-04-04 4#

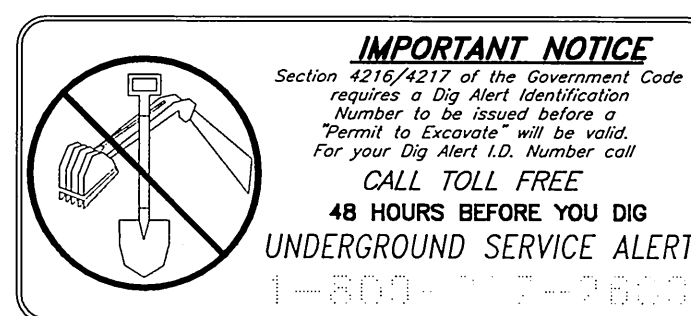

ENGINEER IN RESPONSIBLE CHARGE  
PHILIP L. HANNAWI  
R.C.E. No. 44747 Expires 3/31/2006  
DATE 6/20/03

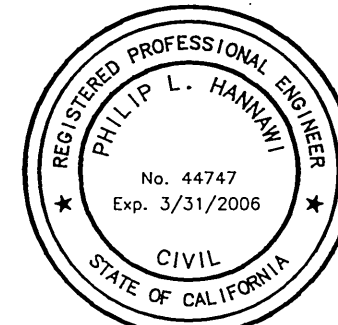

DESIGNED BY	ABE	DRAWN BY	JERRY	CHECKED BY	
DATE		DATE		DATE	

CITY OF RIVERSIDE, CALIFORNIA  
PUBLIC WORKS DEPARTMENT

APPROVED BY	BY	DATE
PRINCIPAL ENGINEER	PH	6/20/03
INSPECTION	PH	6/20/03
STREET SERVICES		
TRAFFIC ENGINEER		

APPROVED BY	DATE
CITY ENGINEER	2/24/03

PHOENIX AVENUE SIDEWALK CONSTRUCTION AT WESTERLY SIDE BETWEEN CENTRAL AVE AND DEWEY AVE (CDBG 2002-2003)

ACCT. NO.: 9216800611-440120XX

R-3702  
SHEET 1 OF 1

HORIZ. SCALE: 1" = 100'

INDEXED 7-28-03 4#